

ORIGINAL SURVEY	SURVEYED	BY	DATE
NOTE BOOK	PLOTTED		
	TEMPLATE		
	AREAS CHECKED		
No.			

FINAL SURVEY	SURVEYED	BY	DATE
NOTE BOOK	PLOTTED		
	TEMPLATE		
	AREAS CHECKED		
No.			

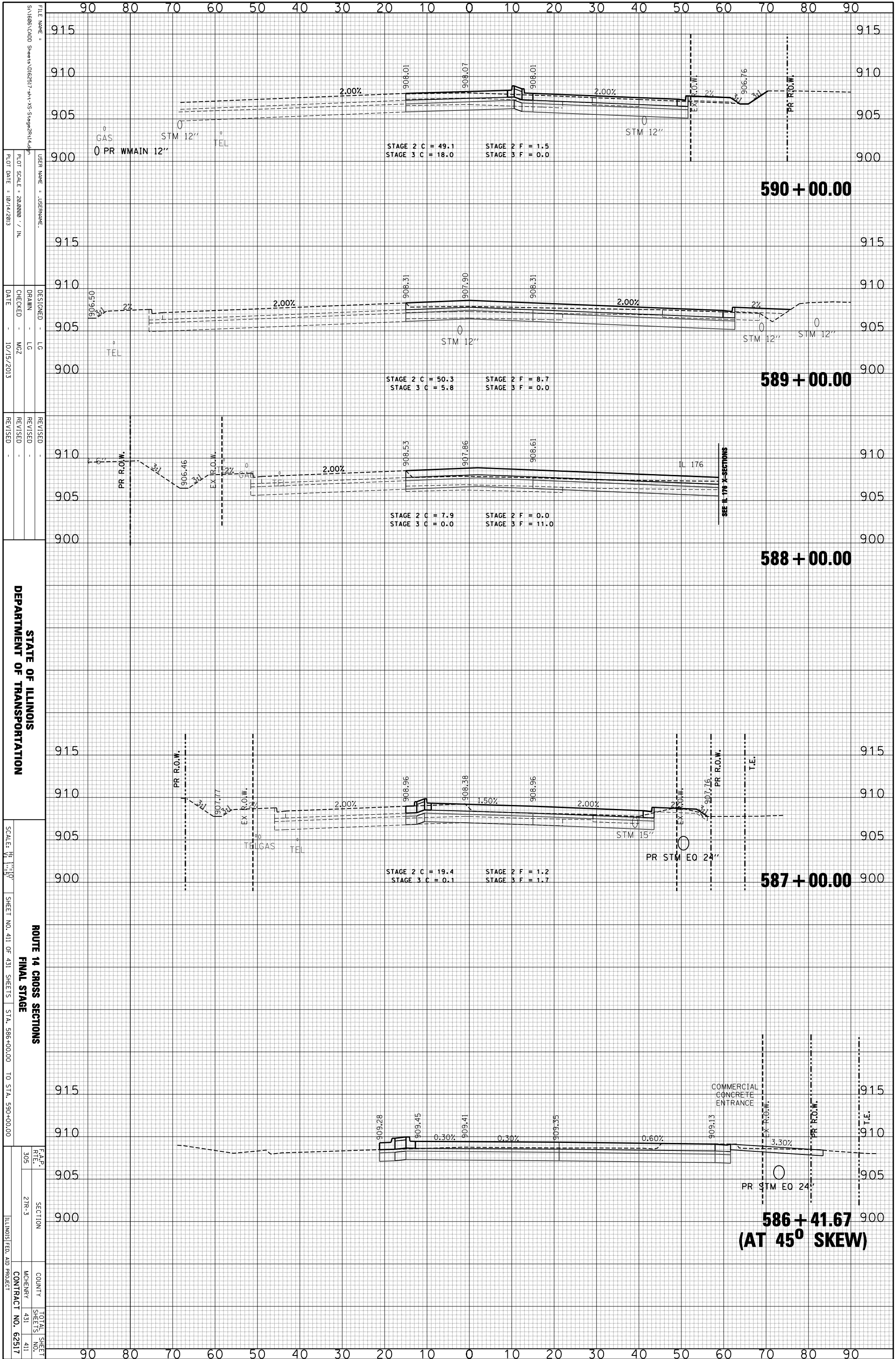

590 + 00.00

589 + 00.00

588 + 00.00

587 + 00.00

**586 + 41.67
(AT 45° SKEW)**

STATE OF ILLINOIS
DEPARTMENT OF TRANSPORTATION

ROUTE 14 CROSS SECTIONS
FINAL STAGE

FILE NAME =	S:1606\CADD Sheets\0162517-sh-r-15-Stage2\14.dgn
USER NAME =	JUSERNAME
DESIGNED -	LG
DRAWN -	LG
CHECKED -	MZ
DATE -	10/15/2013
REVISION	
REVISION	
REVISION	
REVISION	
SCALE: HORIZ. 1"=50'	
SHEET NO. 411 OF 431 SHEETS	STA. 586+00.00 TO STA. 590+00.00
F.A.P. R.T.E.	SECTION
305	21R-3
ILLINOIS FED. AID PROJECT	TOTAL SHEET NO. 411
	COUNTY
	MCHEMERY
	CONTRACT NO. 62517