

ORIGINAL SURVEY	SURVEYED	BY	DATE
NOTE BOOK	PLOTTED		
	TEMPLATE		
	AREAS		
	AREAS CHECKED		
NO.			

FINAL SURVEY	SURVEYED	BY	DATE
NOTE BOOK	PLOTTED		
	TEMPLATE		
	AREAS		
	AREAS CHECKED		
NO.			

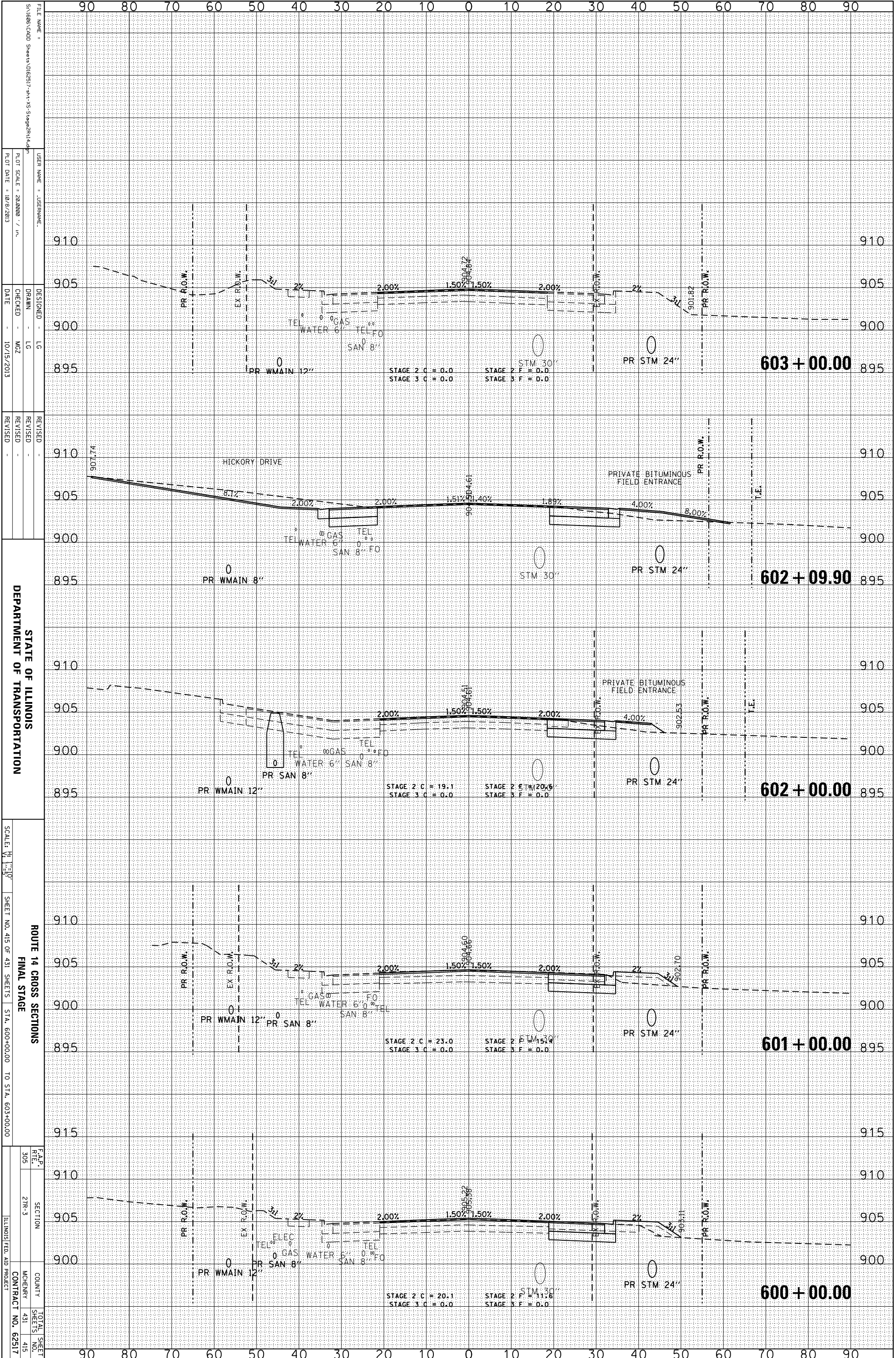

FILE NAME = S:\1606\CADD Sheets\062517-rt-v3-Stage2\14.dwg  
 USER NAME = JUSEPHNAME  
 PLOT SCALE = 28.0000 / in.  
 PLOT DATE = 10/9/2013

DESIGNED - LG  
 DRAWN - LG  
 CHECKED - MZ  
 DATE - 10/15/2013

REVISOR -  
 REVISION -  
 REVISION -  
 REVISION -

STATE OF ILLINOIS  
 DEPARTMENT OF TRANSPORTATION

90 80 70 60 50 40 30 20 10 0 10 20 30 40 50 60 70 80 90

910 905 900 895

910 905 900 895

910 905 900 895

910 905 900 895

915 910 905 900

90 80 70 60 50 40 30 20 10 0 10 20 30 40 50 60 70 80 90

603 + 00.00

602 + 09.90

602 + 00.00

601 + 00.00

600 + 00.00

ROUTE 14 CROSS SECTIONS  
 FINAL STAGE  
 SCALE: 1" = 50'  
 SHEET NO. 415 OF 431 SHEETS STA. 600+00.00 TO STA. 603+00.00

F.A.P. R/L	SECTION	COUNTY	TOTAL SHEETS
305	27R-3	MCHEMERY	431
			415
ILLINOIS FED. AID PROJECT			CONTRACT NO. 62517