

ORIGINAL SURVEY	SURVEYED	BY	DATE
NOTE BOOK	PLOTTED		
	TEMPLATE		
	AREAS		
	CHECKED		

FINAL SURVEY	SURVEYED	BY	DATE
NOTE BOOK	PLOTTED		
	TEMPLATE		
	AREAS		
	CHECKED		

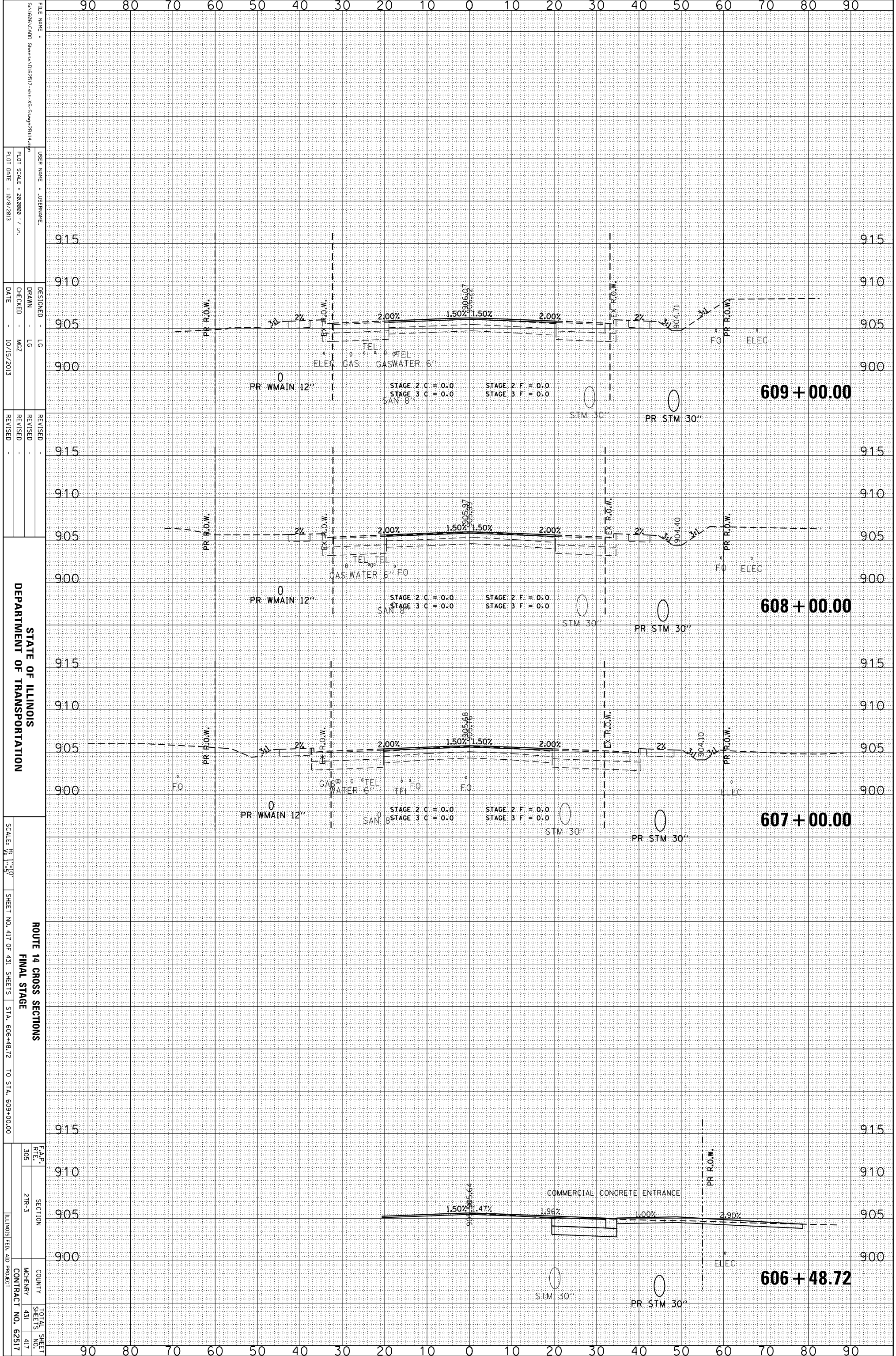

FILE NAME = S:\1606\CADD Sheets\062517-rt-15-Stage2\14.dgn
 USER NAME = JUSEPHNAME
 DESIGNER = LG
 DRAWN = LG
 CHECKED = MZ
 DATE = 10/15/2013

REVISIONS
 REVISION NO. | DATE | DESCRIPTION

STATE OF ILLINOIS
 DEPARTMENT OF TRANSPORTATION

ROUTE 14 CROSS SECTIONS
 FINAL STAGE
 SCALE: 1" = 50'
 SHEET NO. 417 OF 431 SHEETS STA. 606+48.72 TO STA. 609+00.00

F.A.P. R.T.E.	SECTION	COUNTY	TOTAL SHEETS
305	21R-3	MCHEMERY	431
ILLINOIS FED. AID PROJECT		CONTRACT NO.	62517