

PLAN	SURVEYED	DATE
	PLOTTED	
	GRADES CHECKED	
	STRUCTURE NOTATIONS CHECKED	
	NOTE BOOK NO.	
	CADD FILE NAME	

PROFILE	SURVEYED	DATE
	PLOTTED	
	GRADES CHECKED	
	STRUCTURE NOTATIONS CHECKED	
	NOTE BOOK NO.	
	CADD FILE NAME	

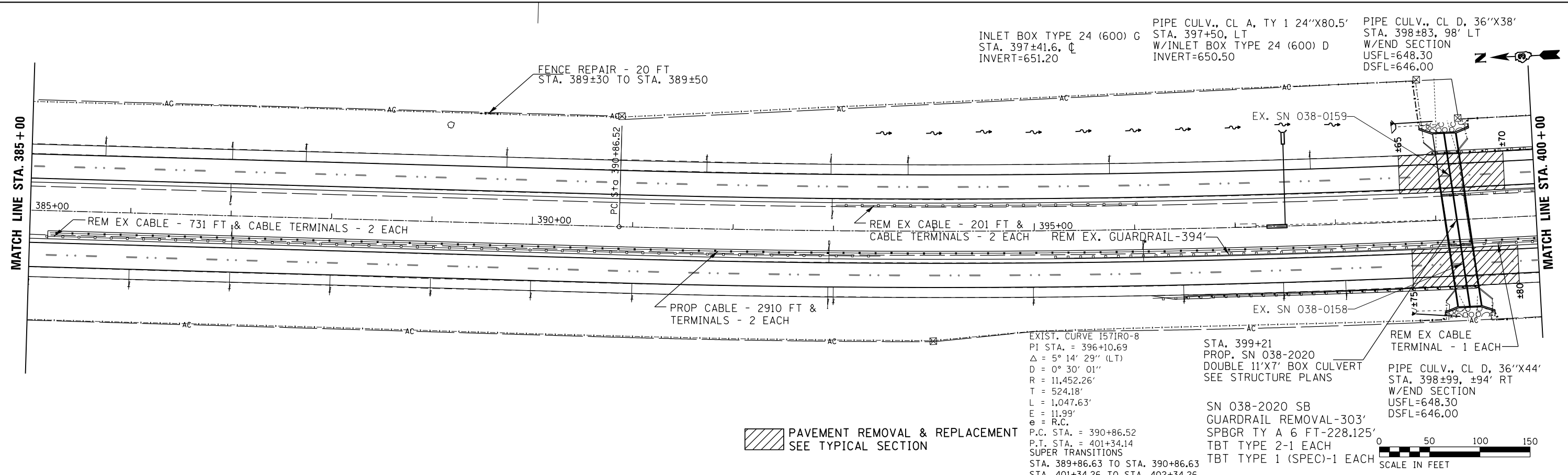

PAVEMENT REMOVAL & REPLACEMENT  
SEE TYPICAL SECTION

EXIST. CURVE 1571R0-8  
PI STA. = 396+10.69  
Δ = 5° 14' 29" (LT)  
D = 0° 30' 01"  
R = 11,452.26'  
T = 524.18'  
L = 1,047.63'  
E = 11.99'  
e = R.C.  
P.C. STA. = 390+86.52  
P.T. STA. = 401+34.14  
SUPER TRANSITIONS  
STA. 389+86.63 TO STA. 390+86.63  
STA. 401+34.26 TO STA. 402+34.26

STA. 399+21  
PROP. SN 038-2020  
DOUBLE 11'X7' BOX CULVERT  
SEE STRUCTURE PLANS  
SN 038-2020 SB  
GUARDRAIL REMOVAL-303'  
SPBGR TY A 6 FT-228.125'  
TBT TYPE 2-1 EACH  
TBT TYPE 1 (SPEC)-1 EACH

REM EX CABLE  
TERMINAL - 1 EACH  
PIPE CULV., CL D, 36'X44'  
STA. 398±99, ±94' RT  
W/END SECTION  
USFL=648.30  
DSFL=646.00

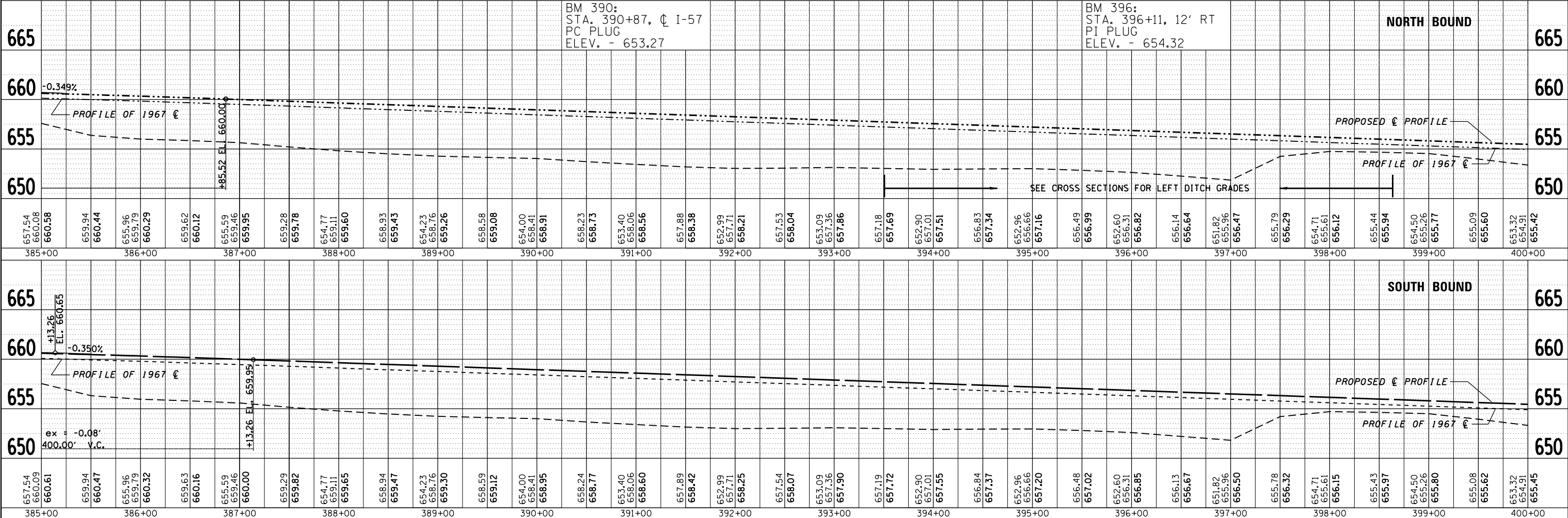

FILE NAME =	USER NAME = duncanbd	DESIGNED -	REVISED -	<p align="center"><b>STATE OF ILLINOIS DEPARTMENT OF TRANSPORTATION</b></p> <p align="center"><b>PLAN AND PROFILE</b></p> <p>SCALE: 1"=50'    SHEET NO. 8 OF 17 SHEETS    STA. 385+00 TO STA. 400+00</p>	F.A.I. R.T.E.	SECTION	COUNTY	TOTAL SHEETS	SHEET NO.
c:\pwwork\pwwork\duncanbd\dms30308\plansheets.dgn		CHECKED -	REVISED -		57	*	IROQUOIS	190	29
PLOT SCALE = 100.0000' / in.		DRAWN -	REVISED -		*(38-4)RS-2, (38-4)BR,BR1,BR3		CONTRACT NO. 66757		
PLOT DATE = 6/2/2014		CHECKED -	REVISED -		FED. ROAD DIST. NO.	ILLINOIS FED. AID PROJECT			