

**HALF SECTION
SHOWING STAGE 1 AT STRUCTURE**

SEE STAGING TYPICAL IN STRUCTURE PLANS FOR ADDITIONAL INFORMATION

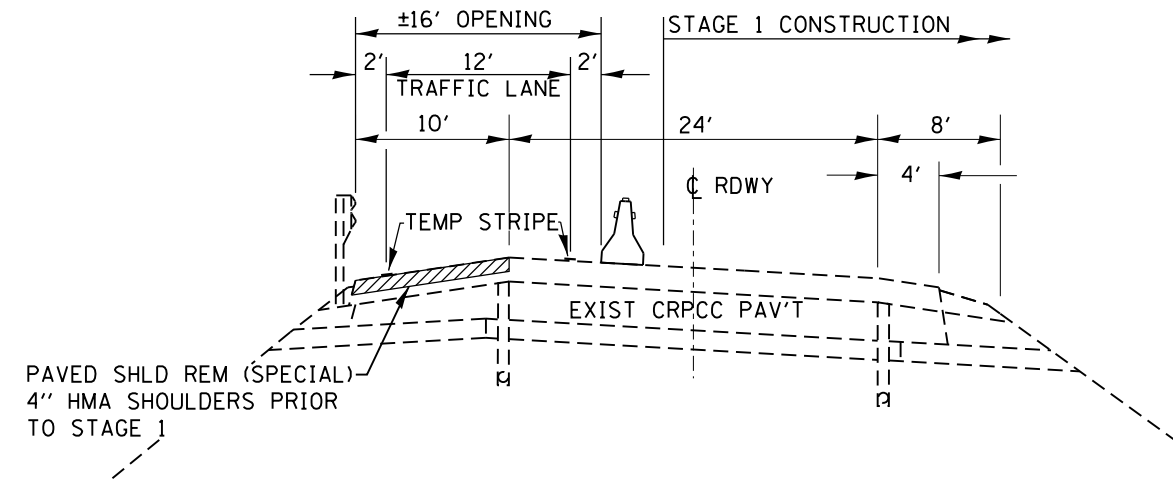

**HALF SECTION
SHOWING STAGE 1 AT ROADWAY**

NOTE:
STAGING TYPICALS ASSUME ROADWAY WORK/CLOSURES BEING PERFORMED AT SAME TIME AS STRUCTURE WORK

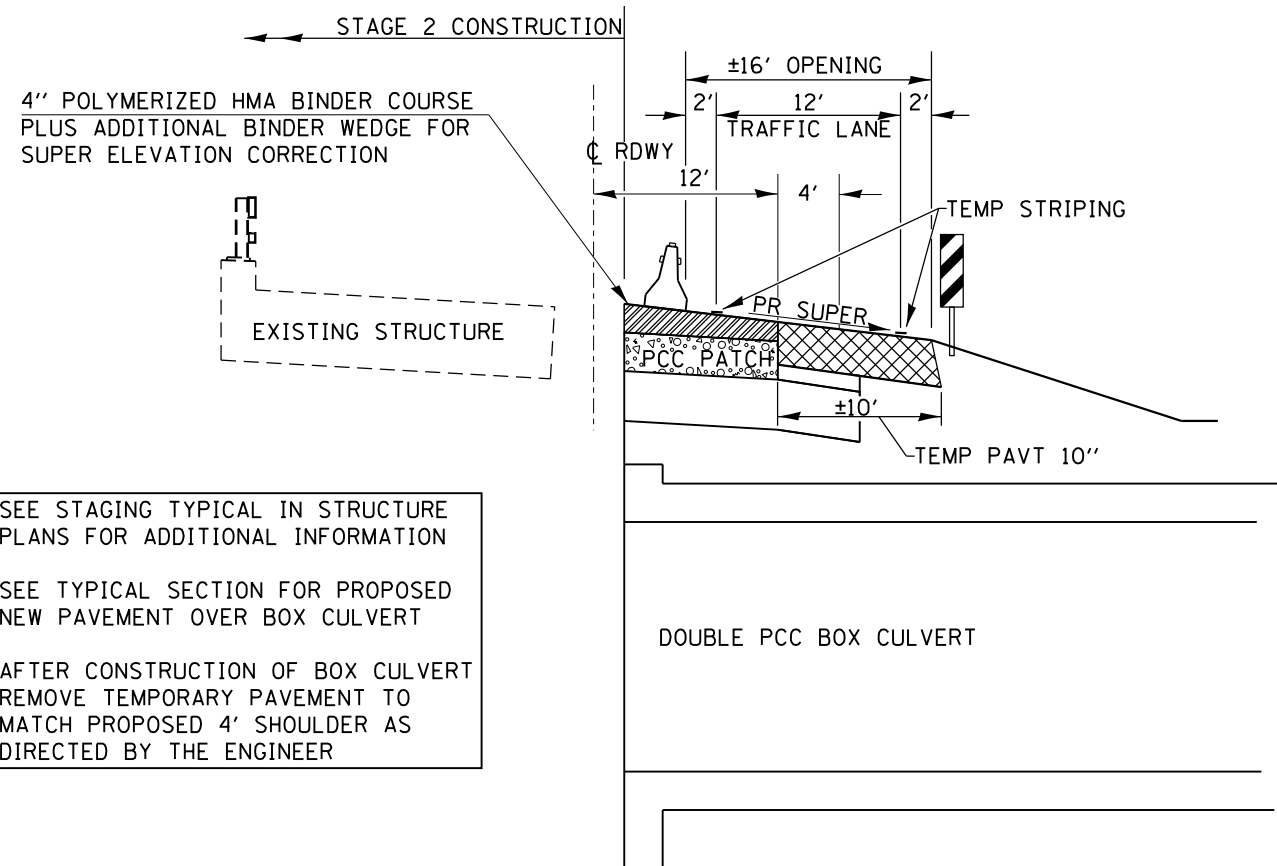

**HALF SECTION
SHOWING STAGE 2 AT STRUCTURE**

SEE STAGING TYPICAL IN STRUCTURE PLANS FOR ADDITIONAL INFORMATION

SEE TYPICAL SECTION FOR PROPOSED NEW PAVEMENT OVER BOX CULVERT

AFTER CONSTRUCTION OF BOX CULVERT REMOVE TEMPORARY PAVEMENT TO MATCH PROPOSED 4' SHOULDER AS DIRECTED BY THE ENGINEER

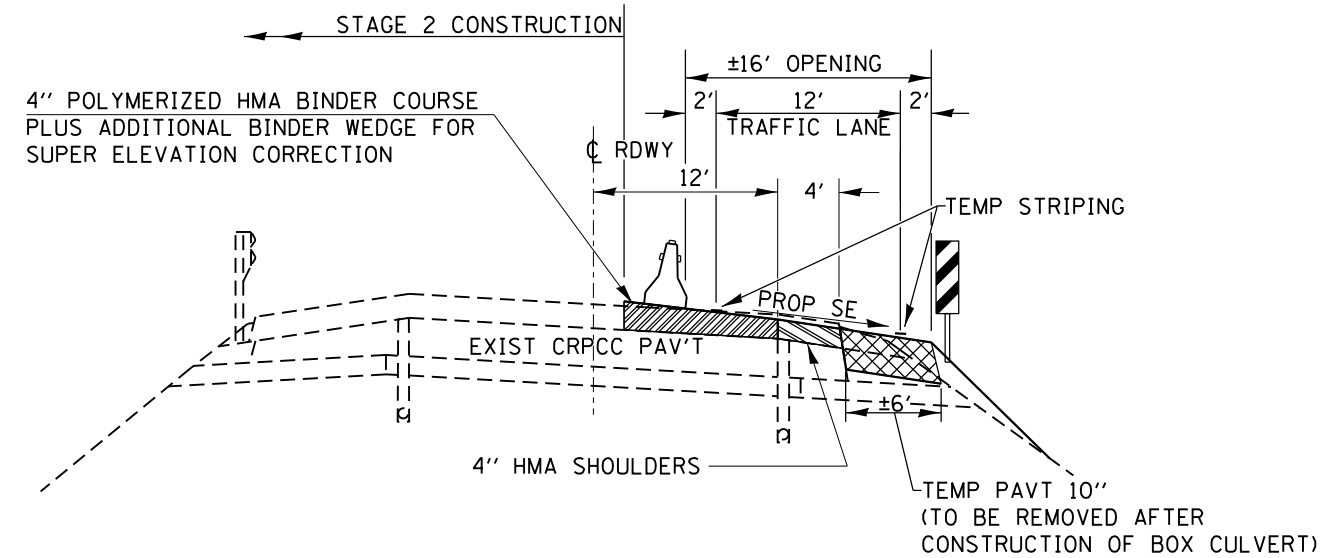

**HALF SECTION
SHOWING STAGE 2 AT ROADWAY**

FILE NAME =	USER NAME = duncanbd	DESIGNED -	REVISED -	STATE OF ILLINOIS DEPARTMENT OF TRANSPORTATION	STAGING TYPICALS AT STRUCTURE REPLACEMENTS			F.A.I. R.T.E.	SECTION	COUNTY	TOTAL SHEETS	SHEET NO.				
et:\pw\work\p\dtdot\duncanbd\dms30308\ep05005-sh1-staging.dgn		DRAWN -	REVISED -		SCALE:	SHEET	OF	SHEETS	STA.	TO	STA.	57	*	IROQUOIS	190	42
		CHECKED -	REVISED -											*138-41RS-2, (38-4)BR,BR1,BR3	CONTRACT NO. 66757	
		DATE -	REVISED -											ILLINOIS FED. AID PROJECT		