

STATE OF ILLINOIS  
DEPARTMENT OF PUBLIC WORKS & BUILDINGS  
DIVISION OF HIGHWAYS

ROUTE NO.	SECTION	COUNTY	TOTAL SHEETS	SHEET NO.	SHEET NO. OF SHEETS
57	X	IROQUOIS	82	25	6

\* 38-4, 4B, 4B-1, 4B-2, 4B-3.

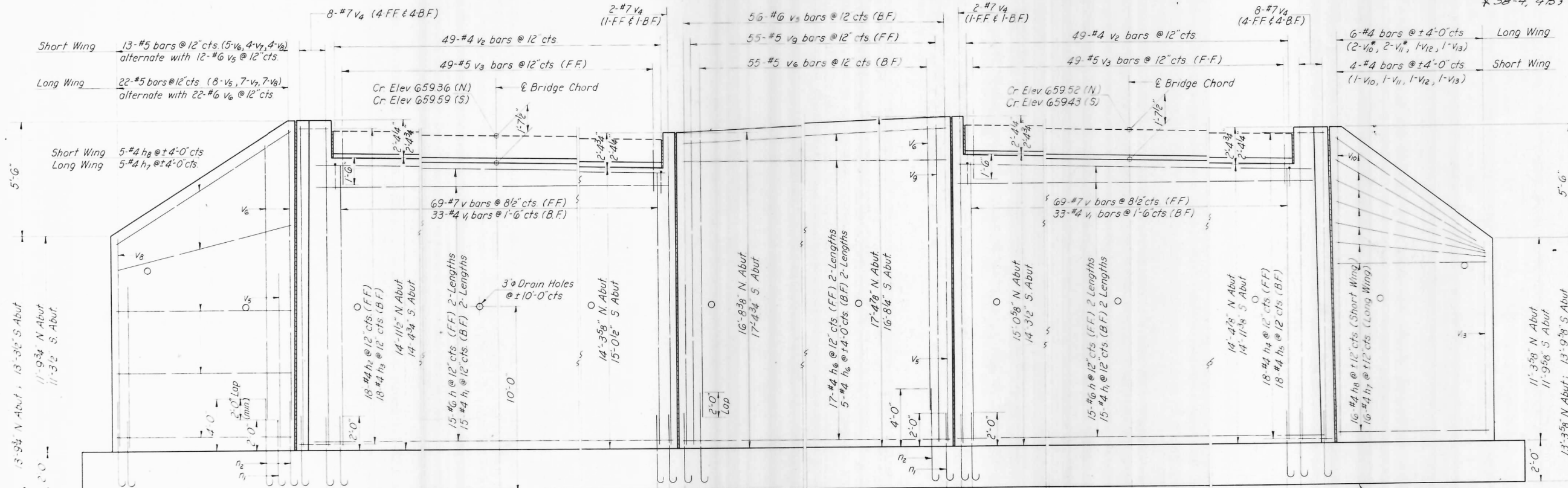

**BILL OF MATERIAL**

Bar	No	Size	Length	Shape
n	20	#6	25'-6"	
h	120	#4	25'-6"	
h2	36	#4	2'-0"	
h3	36	#4	1'-3"	
h4	36	#4	1'-6"	
h5	36	#4	1'-6"	
h6	88	#4	23'-9"	
h7	42	#4	21'-9"	
h8	42	#4	12'-0"	
n	408	#5	4'-4"	
n1	180	#8	4'-10"	
n2	180	#7	6'-7"	
t	428	#5	4'-3"	
t1	112	#7	10'-0"	
t2	112	#6	10'-0"	
t3	80	#7	9'-6"	
t4	80	#6	9'-6"	
v	276	#7	14'-3"	
v1	132	#4	14'-6"	
v2	196	#4	3'-0"	
v3	196	#5	2'-3"	
v4	40	#7	16'-6"	
v5	180	#6	9'-0"	
v6	136	#5	15'-0"	
v7	22	#5	12'-9"	
v8	22	#5	11'-0"	
v9	110	#5	16'-3"	
v10	6	#4	16'-6"	
v11	6	#4	14'-6"	
v12	4	#4	12'-9"	
v13	4	#4	11'-0"	
w	160	#5	29'-0"	
w1	40	#5	21'-6"	
w2	40	#5	14'-0"	
w3	4	#5	9'-6"	
Class "A" Exc. for Str.				Cu.Yds. 470
Class "B" Exc. for Str.				Cu.Yds. 1220
Class X Concrete				Cu.Yds. 455.9
Reinforcement Bars				Lbs. 49490

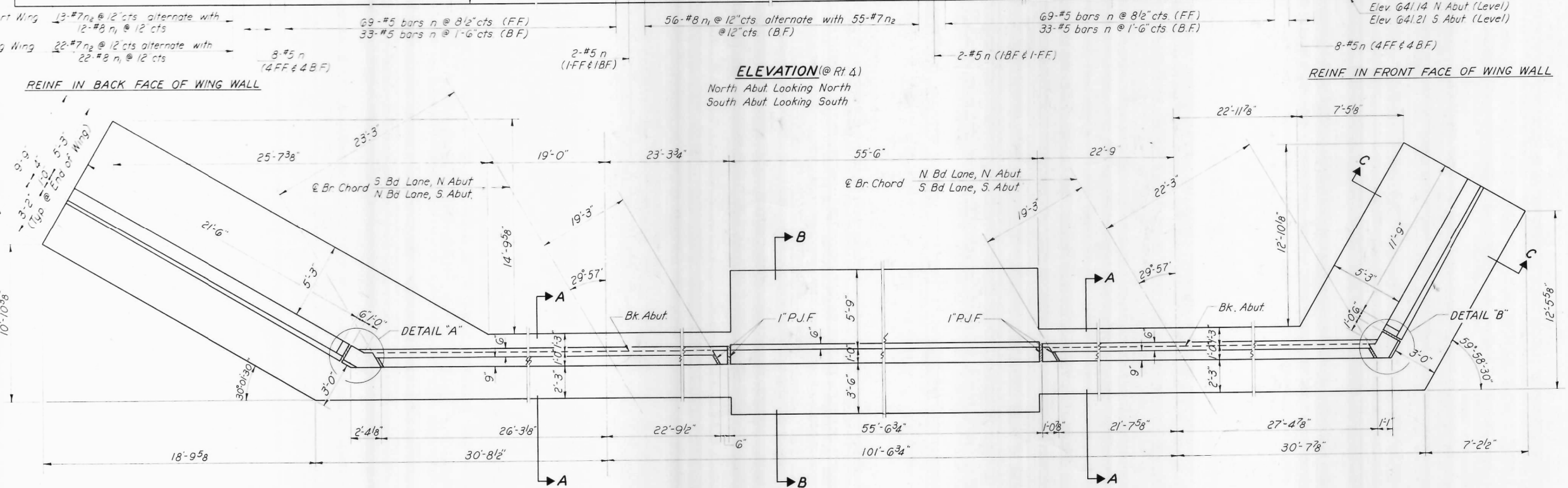

DESIGNED: *W. H. Haines*  
CHECKED: *Richard P. ...*  
DRAWN: *J. L. Armstrong*  
CHECKED: *R. P.*

EXAMINED: *W. C. Baumann*  
PASSED: *E. H. ...*  
APPROVED: *V. E. ...*

Dec. 10 1962

**ABUTMENTS & RETAINING WALLS**  
No. & So. Bd. LANE BRIDGES  
F.A.I. RT 57 SEC. 38-4B  
IROQUOIS COUNTY  
STA. 348+54.5