

D.M. : #14. R.R. Spike in Fence Post of N. Bank of ditch, 180' Lt. Sta. 398+96. Elev. 653.122 No Existing Structure..

STATE OF ILLINOIS  
DEPARTMENT OF PUBLIC WORKS & BUILDINGS  
DIVISION OF HIGHWAYS

ROUTE NO.	SECTION	COUNTY	TOTAL SHEETS	SHEET NO.	SHEET NO. /
57	*	IROQUOIS	82	27	4 SHEETS
FED. ROAD DIST. NO. 7		ILLINOIS	FED. AID PROJECT: I-57-G(83)27B		
* 38-4, 48, 48-1, 48-2, 48-3					

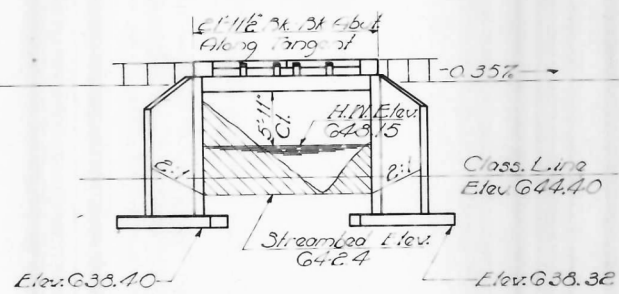

STATION 399+21  
BUILT 196 BY  
STATE OF ILLINOIS  
F.A.I. RT. 57 - SEC. 38-4B-1  
F.A. PROJECT I-57-G(83)  
LOADING H520 & ALT.  
NAME PLATE  
See Std. E113-1

GENERAL NOTES

Class II Concrete shall be used throughout, except in handrail.  
Handrail Concrete shall be used in concrete rail posts and railing.  
The concrete floor slab shall be finished in accordance with Article 51.19 of the Standard Specifications.  
The concrete rail posts and railing shall be poured in separate operations.  
For backfill behind abutments held off the top by Superstructure see Article 50.10 of the Std. Specifications.  
The following surfaces of the bridge shall be waterproofed: the back face of the abutments, retaining walls and wingwalls from the top of the footings to one foot below top of wingwalls.  
Waterproofing shall be done in accordance with Article 51.21 of the Standard Specifications.  
Non metallic water seal used in the wing joints shall extend from the top of the footing to within 6" of the top of the wing.



ELEVATION

CURVE DATA

Pt. Sta. 398+10.78  
Δ = 05°-14'-17.35"  
D = 00°-30'  
T = 521.15  
L = 1047.63  
R = 11459.16  
E = 11.09'  
S.E. = 0.01 (Remove Crain)  
S.E. Affected: 390+36.60 to 391+36.60  
400+84.23 to 401+84.23

TOTAL BILL OF MATERIAL

Item	Unit	Super.	Sub.	Total
Channel Excavation	Cu. Yd.		720	720
Class A Excavation for Structures	Cu. Yd.		430	430
Class B Excavation for Structures	Cu. Yd.		790	790
Class II Concrete	Cu. Yd.	82.2	383.4	465.6
Name Plates	Eacls	2		2
Protective Coat	Sq. Yd.			235
Handrail Concrete	Cu. Yd.	3.4		3.4
Reinforcement Bars	Lb.	24,780	37,580	62,360

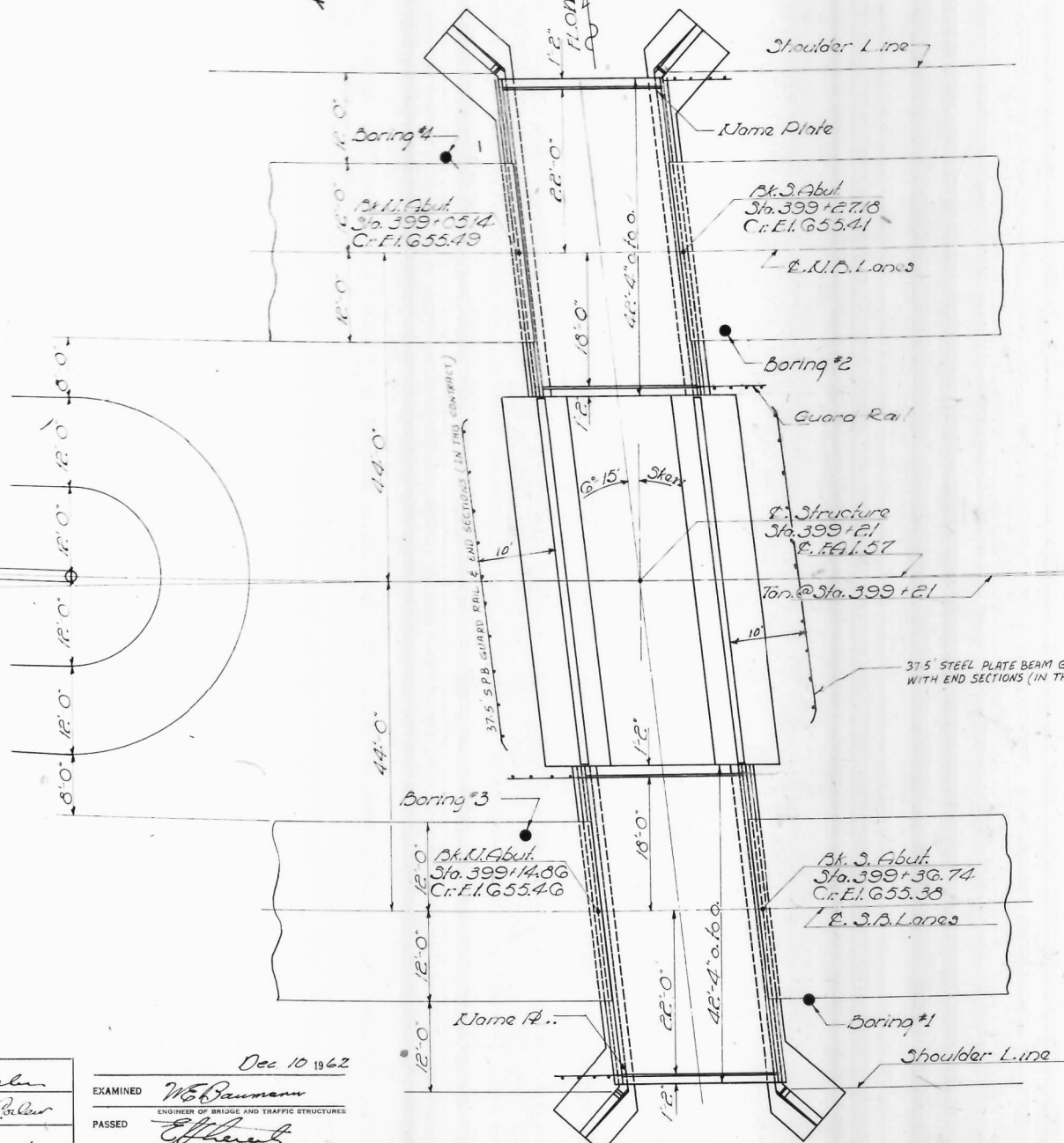

WATERWAY INFORMATION

Drainage Area 420 Acres  
Character Cultivated  
Required Opening (50 Yr. Fl.) 114 Sq. Ft.  
Present Opening ~ 59 Sq. Ft.  
Proposed Opening 114.59 Sq. Ft.  
Ordinary Water Elev. 644.4  
Low Water Elev. 643.4

DESIGN STRESSES

$f_c = 1400$  p.s.i. Super  
 $f_c = 1000$  p.s.i. Sub.  
 $f_s = 20,000$  p.s.i. Reinfr.  
 $v = 75$  p.s.i. Flg.  
 $n = 10$   
LOADING H520-44 & ALT.  
Max. Flg. Pressure = 1.5 T/s.F.

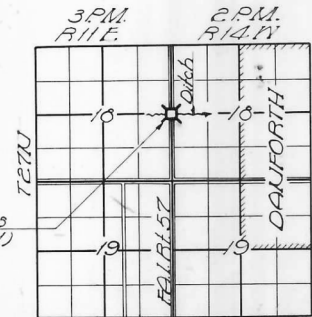

LOCATION SKETCH

DESIGNED *D. Spore*  
CHECKED *C. L. Jacobs*  
DRAWN *del. m. jacob*  
CHECKED *C.L.*

EXAMINED *W. Baumann*  
PASSED *E. Hart*  
APPROVED *V. E. Hoff*  
Dec 10 1962  
ENGINEER OF BRIDGE AND TRAFFIC STRUCTURES  
ENGINEER OF DESIGN  
CHIEF HIGHWAY ENGINEER

PLAN

PROJ. I-57-G(83)27B  
GENERAL PLAN & ELEVATION  
DANFORTH #3 DRAINAGE DITCH  
F.A.I. RT. 57 - SEC. 38-4B-1  
IROQUOIS COUNTY  
STATION 399+21