

PROPOSED HIGHWAY PLANS

F.A.P. ROUTE 68 (IL 23)
SECTION (29,30)RS-4

3P MILLING & RESURFACING
DEKALB COUNTY
C-93-053-14

F.A.P. RTE.	SECTION	COUNTY	TOTAL SHEETS	SHEET NO.
68	(29,30)RS-4	DEKALB	26	1
		ILLINOIS	CONTRACT NO. 66D47	

INDEX OF SHEETS

- 1 COVER SHEET
- 2 GENERAL NOTES & COMMITMENTS
- 3 - 5 SUMMARY OF QUANTITIES
- 6 TYPICAL SECTIONS
- 7 - 11 SCHEDULE OF QUANTITIES
- 12 - 22 PLAN VIEWS
- 23 - 26 DETAILS

HIGHWAY STANDARDS

- 000001-06 STANDARD SYMBOLS, ABBREVIATIONS AND PATTERNS
- 667101-02 PERMANENT SURVEY MARKERS
- 701001-02 OFF-ROAD OPERATIONS 2L, 2W, MORE THAN 15' (4.5 m) AWAY
- 701006-05 OFF-ROAD OPERATIONS 2L, 2W, 15' (4.5 m) TO 24" (600 mm) FROM PAVEMENT EDGE
- 701011-04 OFF-ROAD MOVING OPERATIONS 2L, 2W, DAY ONLY
- 701201-04 LANE CLOSURE, 2L, 2W, DAY ONLY, FOR SPEEDS ≥ 45 MPH
- 701301-04 LANE CLOSURE, 2L, 2W, SHORT TIME OPERATIONS
- 701306-03 LANE CLOSURE, 2L, 2W, SLOW MOVING OPERATIONS DAY ONLY, FOR SPEEDS ≥ 45 MPH
- 701311-03 LANE CLOSURE, 2L, 2W, MOVING OPERATIONS - DAY ONLY
- 701901-03 TRAFFIC CONTROL DEVICES
- 781001-03 TYPICAL APPLICATIONS RAISED REFLECTIVE PAVEMENT MARKERS



LOCATION OF SECTION INDICATED THUS: - [Symbol] -
OTHER PRINCIPAL ARTERIAL

	2013 ADT	PV%	SU%	MU%
US 30 TO PERRY RD	2600	91.3	2.9	5.8
PERRY RD TO GURLER RD	4250	91.6	4.1	4.3

STATE OF ILLINOIS
DEPARTMENT OF TRANSPORTATION
DIVISION OF HIGHWAYS

SUBMITTED June 6 2014
Paul Coete P.E.
DEPUTY DIRECTOR OF HIGHWAYS, REGION ENGINEER

June 27 2014
John D. Baranzola P.E.
ENGINEER OF DESIGN AND ENVIRONMENT

June 27 2014
Omer Gorman P.E.
DIRECTOR OF HIGHWAYS, CHIEF ENGINEER

PRINTED BY THE AUTHORITY
OF THE STATE OF ILLINOIS

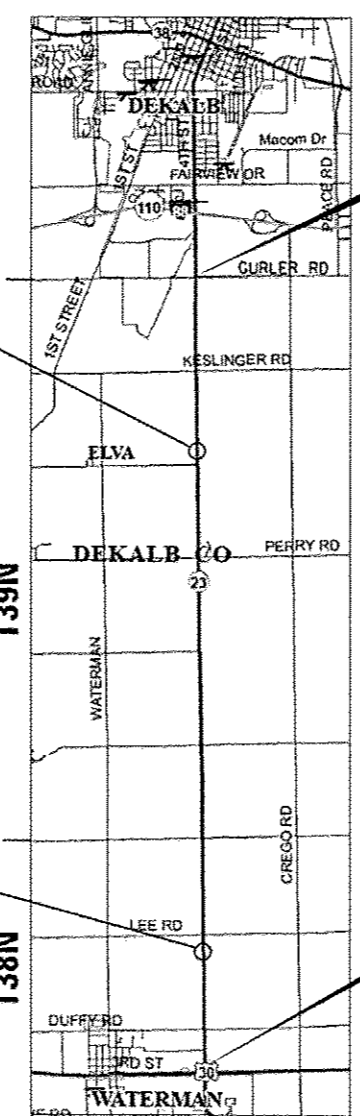

SN 019-0007 OMISSION
STA. 911+29 - STA. 911+85

STATION EQUATION
STA. 997+17.5 BK = STA. 0+00 AH

SN 019-2009 OMISSION
STA. 616+87.5 - STA. 617+38.5

PROJECT START
STA. 549+15

PROJECT END
STA. 997+17.5

MICROFILMED _____
REEL NUMBER _____
AWARDED _____
RESIDENT ENGINEER _____
AS BUILT CHANGES WERE MADE
ON THE FOLLOWING SHEETS _____

J.U.L.I.E.
JOINT UTILITY LOCATION INFORMATION FOR EXCAVATION
1-800-892-0123
OR 811

PROJECT ENGINEER: CRAIG REED, PE
UNIT CHIEF: BRAD DUNCAN, PE
TOWNSHIP(S): CLINTON, AFTON

CONTRACT NO. 66D47

GROSS LENGTH = 44802.5 FT 8.49 MILE
NET LENGTH = 44695.5 FT 8.47 MILE

GENERAL NOTES

THE THICKNESS OF HMA SHOWN ON THE PLANS IS THE NOMINAL THICKNESS. DEVIATIONS FROM THE NOMINAL THICKNESS WILL BE PERMITTED WHEN SUCH DEVIATIONS OCCUR DUE TO IRREGULARITIES IN THE EXISTING SURFACE OR BASE ON WHICH THE HMA IS PLACED.

THE HMA SURFACE OF ALL MAILBOX TURNOUTS, PRIVATE ENTRANCES, COMMERCIAL ENTRANCES, AND SIDE ROADS SHALL BE MADE NEATLY, IN A WORKMANLIKE MANNER, AND SHALL ACCURATELY CONFORM TO THE SHAPES AND DIMENSIONS SHOWN ON THE PLAN DETAILS. IF REQUIRED BY THE ENGINEER, THE CONTRACTOR SHALL SAW CUT THE HMA SURFACE TO CONFORM TO THE SHAPES AND DIMENSIONS SHOWN ON THE PLAN DETAILS. THIS WORK WILL BE INCLUDED IN THE COST OF THE HMA SURFACE.

THE ENGINEER WILL BE THE SOLE JUDGE CONCERNING CURING TIME FOR THE VARIOUS HMA LIFTS.

SEEDING WILL NOT BE PERMITTED AT ANY TIME WHEN THE GROUND IS FROZEN, WET, OR IN AN UNTILLABLE CONDITION. LOCATIONS TO BE SEEDED WILL BE DETERMINED BY THE ENGINEER.

ON EXISTING PAVEMENT WHICH MAY BE SUPERELEVATED, THE NEW HMA PAVEMENT SHALL BE BUILT WITH THE SAME SUPERELEVATION UNLESS NEW SUPERELEVATION RATES ARE GIVEN ON THE PLANS.

THE FOLLOWING RATES OF APPLICATION HAVE BEEN USED IN CALCULATING PLAN QUANTITIES:

GRANULAR MATERIALS	2.05	TONS / CU YD
HMA RESURFACING	112	LBS / SQ YD / IN
SHORT TERM PAVEMENT MARKING	10	FT /100 FT OF APPLICATION
MIX FOR CRACKS, JTS & FLGWYS	0.0003	TONS / SQ YD
LEVEL BINDER (HAND METHOD)	0.0005	TONS / SQ YD

THE CONTRACTOR SHALL CONTACT JULIE AT LEAST 48 HOURS PRIOR TO EXCAVATION TO DETERMINE WHICH UTILITIES ARE IN THE AREA.

STATE OF ILLINOIS
DEPARTMENT OF TRANSPORTATION
DISTRICT THREE

PREPARED BY: Tom Brown
DISTRICT STUDIES & PLANS ENGINEER

DATE: 6-6-14

EXAMINED BY: Deborah J. [Signature]
DISTRICT CONSTRUCTION ENGINEER

Wayne L. Phillips
DISTRICT MATERIALS ENGINEER

James A. [Signature]
DISTRICT OPERATIONS ENGINEER

FILE NAME *	USER NAME * duncanbd	DESIGNED -	REVISED -	STATE OF ILLINOIS DEPARTMENT OF TRANSPORTATION	GENERAL NOTES			F.A.P. RTE.	SECTION	COUNTY	TOTAL SHEETS	SHEET NO.
c:\pwwork\pwwork\duncanbd\0373950\0373950.dwg	047*shl*cover.dgn	DRAWN -	REVISED -					68	(29,30)RS-4	DEKALB	26	2
PLOT SCALE * 100.0000' / in.	CHECKED -	REVISED -	SCALE:		SHEET NO.	OF SHEETS	STA.	TO STA.	CONTRACT NO. 66047			
PLOT DATE * 6/2/2014	DATE -	REVISED -	ILLINOIS FED. AID PROJECT									

CONSTR. CODE

STATE = 100%

ROADWAY

0005

RURAL

CODE NO.	ITEM	UNIT	TOTAL QUANTITY	
20400800	FURNISHED EXCAVATION	CU YD	19	19
25000200	SEEDING, CLASS 2	ACRE	0.1	0.1
25000400	NITROGEN FERTILIZER NUTRIENT	POUND	5	5
25000500	PHOSPHORUS FERTILIZER NUTRIENT	POUND	5	5
25000600	POTASSIUM FERTILIZER NUTRIENT	POUND	5	5
25100630	EROSION CONTROL BLANKET	SQ YD	221	221
40200800	AGGREGATE SURFACE COURSE, TYPE B	TON	128	128
40600400	MIXTURE FOR CRACKS, JOINTS, AND FLANGEWAYS	TON	36	36
40600527	LEVELING BINDER (HAND METHOD), IL-9.5FG, N50	TON	60	60
40600627	LEVELING BINDER (MACHINE METHOD), IL-9.5FG, N50	TON	5006	5006
40600895	CONSTRUCTING TEST STRIP	EACH	1	1
40600990	TEMPORARY RAMP	SQ YD	296	296
40603335	HOT-MIX ASPHALT SURFACE COURSE, MIX "D", N50	TON	10012	10012
40800050	INCIDENTAL HOT-MIX ASPHALT SURFACING	TON	189	189

△ SPECIALTY ITEMS

FILE NAME =	USER NAME = dunoanbd	DESIGNED -	REVISED -
c:\pwork\p1dot\dunoanbd\0373958\0366047-shc-500.dgn		DRAWN -	REVISED -
		CHECKED -	REVISED -
		DATE -	REVISED -

STATE OF ILLINOIS
DEPARTMENT OF TRANSPORTATION

SUMMARY OF QUANTITIES

SCALE: SHEET NO. 1 OF 3 SHEETS STA. TO STA.

F.A.P. RTE.	SECTION	COUNTY	TOTAL SHEETS	SHEET NO.
68	(29.30)RS-4	DEKALB	26	3
CONTRACT NO. 66047			ILLINOIS FED. AID PROJECT	

CONSTR. CODE

STATE = 100%
ROADWAY
0005
RURAL

CODE NO.	ITEM	UNIT	TOTAL QUANTITY	
44000155	HOT-MIX ASPHALT SURFACE REMOVAL, 1 1/2"	50 YD	219853	219853
48102100	AGGREGATE WEDGE SHOULDER, TYPE B	TON	914	914
48203100	HOT-MIX ASPHALT SHOULDERS	TON	11472	11472
66700205	PERMANENT SURVEY MARKERS, TYPE I	EACH	16	16
67000400	ENGINEER'S FIELD OFFICE, TYPE A	CAL MO	3	3
67100100	MOBILIZATION	L SUM	1	1
70100460	TRAFFIC CONTROL AND PROTECTION, STANDARD 701306	L SUM	1	1
70300100	SHORT TERM PAVEMENT MARKING	FOOT	13441	13441
70300210	TEMPORARY PAVEMENT MARKING LETTERS AND SYMBOLS	50 FT	122.4	122.4
70300220	TEMPORARY PAVEMENT MARKING - LINE 4"	FOOT	43340	43340
70300240	TEMPORARY PAVEMENT MARKING - LINE 6"	FOOT	19990	19990
70300280	TEMPORARY PAVEMENT MARKING - LINE 24"	FOOT	48	48
70301000	WORK ZONE PAVEMENT MARKING REMOVAL	50 FT	4480	4480
△ 78008200	POLYUREA PAVEMENT MARKING TYPE I - LETTERS AND SYMBOLS	50 FT	61.2	61.2

△

△ SPECIALTY ITEMS

FILE NAME :	USER NAME : duncanbd	DESIGNED -	REVISED -	STATE OF ILLINOIS DEPARTMENT OF TRANSPORTATION	SUMMARY OF QUANTITIES				F.A.P. RTE.	SECTION	COUNTY	TOTAL SHEETS	SHEET NO.
c:\p-work\p\dot\duncanbd\0373950\0373950-0373950-0047-ans-500.dgn		DRAWN -	REVISED -		SCALE:	SHEET 2 OF 3 SHEETS	STA.	TO STA.	6B	(29,30RS-4	DEKALB	26	4
PLOT SCALE = 100.0000' / in.		CHECKED -	REVISED -						CONTRACT NO. 66047				
PLOT DATE = 6/4/2014		DATE -	REVISED -		ILLINOIS FED. AID PROJECT								

CODE NO.	ITEM	UNIT	TOTAL QUANTITY	CONSTR. CODE
				STATE = 100% ROADWAY 0005 RURAL
△ 78008210	POLYUREA PAVEMENT MARKING TYPE I - LINE 4"	FOOT	111270	111270
△ 78008230	POLYUREA PAVEMENT MARKING TYPE I - LINE 6"	FOOT	10310	10310
△ 78008270	POLYUREA PAVEMENT MARKING TYPE I - LINE 24"	FOOT	24	24
△ 78100100	RAISED REFLECTIVE PAVEMENT MARKER	EACH	564	564
78300200	RAISED REFLECTIVE PAVEMENT MARKER REMOVAL	EACH	564	564
X4060110	BITUMINOUS MATERIALS (PRIME COAT)	POUND	126773	126773
Z0030850	TEMPORARY INFORMATION SIGNING	50 FT	42	42
Z0034105	MATERIAL TRANSFER DEVICE	TON	10012	10012
Z0055300	RUMBLE STRIP	EACH	3	3

9 △ SPECIALTY ITEMS

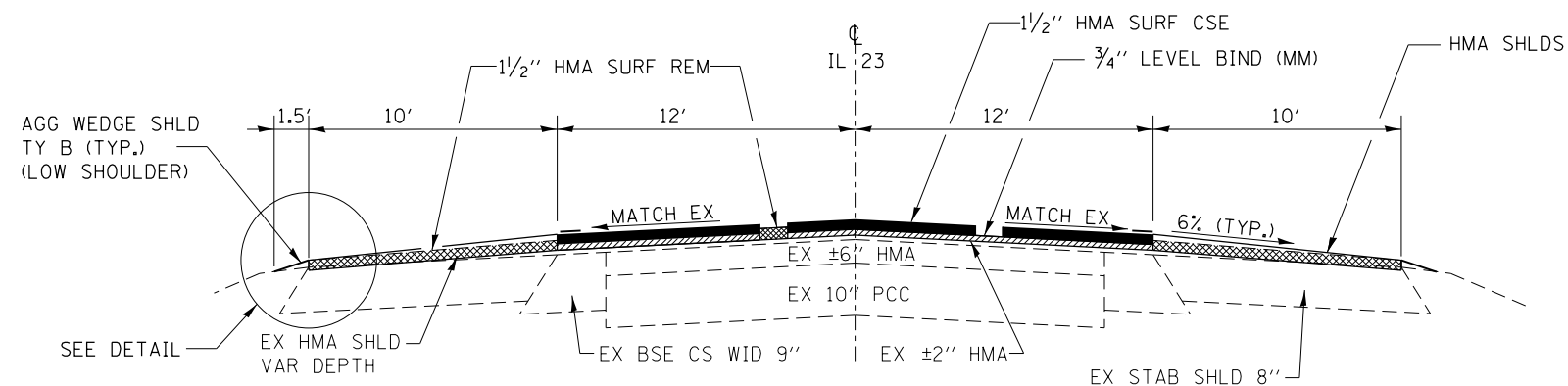

TYPICAL SECTION

STA. 549+15 TO STA. 997+17.5

SN 019-2009 OMISSION STA. 616+87.5 TO STA. 617+38.5
 SN 019-0007 OMISSION STA. 911+29 TO STA. 911+85

MIXTURE TABLE

	HMA SURFACE	HMA LEVEL BINDER	INCIDENTAL HMA SURFACE	HMA SHOULDERS
PG GRADE**	PG64-22	PG64-22	PG64-22	PG64-22
DESIGN AIR VOIDS	4.0% @ N50	4.0% @ N50	4.0% @ N50	4.0% @ N50
MIXTURE COMPOSITION	IL 9.5	IL 9.5FG	IL 9.5	IL 9.5
FRICION AGGREGATE	MIXTURE D		MIXTURE C	MIXTURE C
DENSITY TEST METHOD	CORRELATION	CORRELATION	SATISFACTION OF ENGINEER	CORRELATION

** WHEN RAP/RAS ABR EXCEEDS 20 PERCENT, THE HIGH AND LOW VIRGIN ASPHAL BINDER GRADES SHALL EACH BE REDUCED BY ONE GRADE (I.E. 25% ABR WOULD REQUIRE A VIRGIN ASPHALT BINDER GRADE OF PG 64-22 TO BE REDUCED TO PG 58-28)

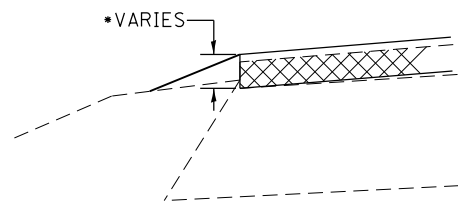

DETAIL

PROPOSED HMA SHOULDERS 6% SLOPE MAXIMUM.

*THE PROPOSED OUTSIDE SHOULDER THICKNESS SHALL MATCH EXISTING. PROPOSED OUTSIDE SHOULDER THICKNESSES WILL VARY AT LOCATIONS WHERE EXISTING SHOULDER SLOPE EXCEEDS THE PROPOSED 6% SLOPE

MAINLINE PAVING SCHEDULE														
STA. TO STA.	LENGTH	MAINLINE		SHOULDER		HMA SURF	HMA SURF	LEV BIND	BIT MAT	MIX JTS	LEV BIND	HMA	AGG	TEMP
		WIDTH	AREA	WIDTH	AREA	REM 1 1/2"	CSE MIX D	(MM) N50	PRIME	CRACKS. &	(HM), N50	SHLDS	WEDGE	RAMP
		FT	SQ YD	FT	SQ YD	SQ YD	N50	FG	COAT	FLANGEWAYS	FG	(NOTE 1)	SHLDS B	SQ YD
549+15 - 551+17	202	24	538.7	20.0	448.9	987.6	45.25	22.62	565.60	0.16	0.27	51.85	2.16	13.33
551+17 - 575+84	2467	24	6578.7	20.0	5482.2	12060.9	552.61	276.30	6907.60	1.97	3.29	633.20	52.68	
575+84 - 579+77	393	24	1048.0	20.0	873.3	1921.3	88.03	44.02	1100.40	0.31	0.52	100.87	1.60	
579+77 - 615+69	3592	24	9578.7	20.0	7982.2	17560.9	804.61	402.30	10057.60	2.87	4.79	921.95	76.70	
615+69 - 616+87.5	118.5	24	316.0	20.0	263.3	579.3	26.54	13.27	331.80	0.09	0.16	30.42	0.27	13.33
616+87.5 - 617+38.5	51	SN 019-2009 OMISSION												
617+38.5 - 618+57	118.5	24	316.0	20.0	263.3	579.3	26.54	13.27	331.80	0.09	0.16	30.42	0.27	13.33
618+57 - 630+04	1147	24	3058.7	20.0	2548.9	5607.6	256.93	128.46	3211.60	0.92	1.53	294.40	24.49	
630+04 - 632+42	238	24	634.7	20.0	528.9	1163.6	53.31	26.66	666.40	0.19	0.32	61.09	2.54	
632+42 - 774+20	14178	24	37808.0	20.0	31506.7	69314.7	3175.87	1587.94	39698.40	11.34	18.90	3639.02	302.76	
774+20 - 776+12	192	24	512.0	20.0	426.7	938.7	43.01	21.50	537.60	0.15	0.26	49.28	2.05	
776+12 - 892+80	11668	24	31114.7	20.0	25928.9	57043.6	2613.63	1306.82	32670.40	9.33	15.56	2994.79	249.16	
892+80 - 911+29	1849	24	4930.7	20.0	4108.9	9039.6	414.18	207.09	5177.20	1.48	2.47	474.58	18.91	13.33
911+29 - 911+85	56	SN 019-0007 OMISSION												
911+85 - 913+20	135	24	360.0	20.0	300.0	660.0	30.24	15.12	378.00	0.11	0.18	34.65	0.61	13.33
913+20 - 945+49	3229	24	8610.7	20.0	7175.6	15786.2	723.30	361.65	9041.20	2.58	4.31	828.78	68.95	
945+49 - 997+17.5	5168.5	24	13782.7	20.0	11485.6	25268.2	1157.74	578.87	14471.80	4.13	6.89	1326.58	110.37	20.00
TOTAL			119188.0		99323	218511	10012	5006	125147	36	60	11472	914	87

NOTE 1: AN ADDITIONAL 10% HMA SHOULDERS WAS INCLUDED FOR THE 6% SLOPE CORRECTION

SIDEROAD & ENTRANCES SCHEDULE																
MAINLINE STATION	SIDE	LOCATION	TYPE	WIDTH	AREA	HMA SURF	AGG SURF	INC HMA	TEMP RAMP	BIT MAT	FURN EXC	SEED CL 2	NIT FERT	PHOS FERT	POT FERT	EROSION CONTROL
						REM 1 1/2"	CSE B	HMA SURF	SQ YD	PR CT	CU YD	ACRE	NUTR	NUTR	NUTR	BLANKET
				FT	SQ YD	SQ YD	TON	TONS	SQ YD	POUND	CU YD	ACRE	POUND	POUND	POUND	SQ YD
549+63	LT	CE	AGG		50.00			5.25		112.50						
549+81	RT	CE	HMA	NO WORK												
551+05	RT	CE	HMA	NO WORK												
552+55	RT	FE	AGG				4.00									
557+90	LT	GARFIELD STREET	HMA	40	233.00	233.00		24.47	22.22	104.85						
569+75	LT	FE	AGG				4.00									
570+43	RT	CE	AGG		50.00			5.25		112.50						
572+89	RT	DUFFY ROAD	HMA	24	63.40	63.40		6.66	13.33	28.53	1.10	0.003	0.27	0.27	0.27	13.00
572+89	LT	DUFFY ROAD	HMA	24	63.40	63.40		6.66	13.33	28.53	1.10	0.003	0.27	0.27	0.27	13.00
580+50	LT	FE	AGG				4.00									
588+56	RT	PE	HMA													
607+38	LT	PE	HMA													
615+00	LT	FE	AGG				4.00									
618+92	RT	FE	AGG				4.00									
626+22	RT	LEE ROAD	HMA	24	63.40	63.40		6.66	13.33	28.53	1.10	0.003	0.27	0.27	0.27	13.00
626+22	LT	LEE ROAD	HMA	24	63.40	63.40		6.66	13.33	28.53	1.10	0.003	0.27	0.27	0.27	13.00
630+64	LT	PE (C&G)	HMA	NO WORK												
639+42	RT	FE	AGG				4.00									
642+85	RT	PE	HMA													
643+60	LT	FE	AGG				4.00									
645+35	RT	FE	AGG				4.00									
645+90	RT	FE	AGG				4.00									
653+50	LT	PE/CE	AGG		50.00			5.25		112.50						
656+25	LT	CE	AGG		50.00			5.25		112.50						
665+68	LT	FE	AGG				4.00									
680+65	RT	MILLER ROAD	HMA	24	62.80	62.80		6.59	13.33	28.26	1.10	0.003	0.27	0.27	0.27	13.00
680+65	LT	MILLER ROAD	HMA	24	62.80	62.80		6.59	13.33	28.26	1.10	0.003	0.27	0.27	0.27	13.00
698+05	RT	FE	AGG				4.00									
700+80	LT	FE	AGG				4.00									
721+05	RT	PE	HMA													
722+10	RT	PE	HMA													
733+63	RT	MCGIRR ROAD	HMA	24	63.40	63.40		6.66	13.33	28.53	1.10	0.003	0.27	0.27	0.27	13.00
733+63	LT	MCGIRR ROAD	HMA	24	63.40	63.40		6.66	13.33	28.53	1.10	0.003	0.27	0.27	0.27	13.00
742+79	LT	PE	HMA													
744+40	RT	PE	HMA													
746+65	RT	PE	HMA													
750+00	LT	FE	AGG				4.00									

SIDEROAD & ENTRANCES SCHEDULE (CONT.)

MAINLINE STATION	SIDE	LOCATION	TYPE	WIDTH	AREA	HMA SURF	AGG SURF	INC HMA	TEMP RAMP	BIT MAT	FURN EXC	SEED CL 2	NIT FERT NUTR	PHOS FERT NUTR	POT FERT NUTR	EROSION CONTROL BLANKET
				FT	SQ YD	REM 1 1/2" SQ YD	CSE B TON	SURF TONS	SQ YD	POUND	CU YD	ACRE	POUND	POUND	POUND	SQ YD
761+68	LT	CE	AGG		50.00			5.25		112.50						
772+45	RT	FE	AGG				4.00									
774+80	RT	PE(C&G)	HMA	NO WORK												
775+42	RT	PE(C&G)	HMA	NO WORK												
776+73	RT	PE	HMA													
786+58	LT	MINNEGAN ROAD	HMA	24	63.40	63.40		6.66	13.33	28.53	1.10	0.003	0.27	0.27	0.27	13.00
799+62	LT	FE	AGG				4.00									
799+76	RT	FE	AGG				4.00									
812+90	RT	CE	AGG		50.00			5.25		112.50						
812+99	LT	FE	AGG				4.00									
825+50	LT	FE	AGG				4.00									
825+50	RT	FE	AGG				4.00									
837+35	RT	PE	HMA													
839+38	RT	PERRY ROAD	HMA	24	137.76	137.76		14.46	13.33	61.99	2.20	0.006	0.54	0.54	0.54	26.00
839+38	LT	PERRY ROAD	HMA	24	137.76	137.76		14.46	13.33	61.99	2.20	0.006	0.54	0.54	0.54	26.00
842+12	RT	PE	HMA													
844+25	RT	PE	HMA													
845+06	RT	PE	HMA													
846+62	RT	PE	HMA													
848+02	RT	PE	HMA													
849+45	RT	PE	HMA													
851+03	RT	PE	HMA													
852+22	RT	PE	HMA													
852+84	RT	PE	HMA													
854+76	RT	PE	HMA													
855+74	LT	PE	HMA													
856+15	RT	PE	HMA													
856+72	LT	PE	AGG		27.00			2.84		60.75						
857+65	RT	PE	HMA													
861+52	RT	PE	HMA													
863+47	RT	PE	HMA													
865+41	RT	PE	HMA													
865+60	LT	FE	AGG				4.00									
868+00	RT	FE	AGG				4.00									
872+14	LT	FE	AGG				4.00									
872+17	RT	FE	AGG				4.00									
877+92	LT	PE	HMA													
879+24	RT	FE	AGG				4.00									
885+65	LT	FE	AGG				4.00									
892+47	LT	ELVA ROAD	HMA	24	137.76	137.76		14.46	13.33	61.99	2.20	0.006	0.54	0.54	0.54	26.00
905+02	LT	PE	HMA													
906+22	LT	PE	HMA													
913+83	LT	FE	AGG				4.00									
913+83	RT	FE	AGG				4.00									
921+00	LT	FE	AGG													
922+17	RT	PE	HMA													
935+30	LT	PE	HMA													
937+84	LT	CE	HMA													
945+49	RT	KESLINGER ROAD	HMA	24	63.40	63.40		6.66	13.33	28.53	1.10	0.003	0.27	0.27	0.27	13.00
945+49	LT	KESLINGER ROAD	HMA	24	63.40	63.40		6.66	13.33	28.53	1.10	0.003	0.27	0.27	0.27	13.00
948+02	RT	CE	HMA													
950+25	RT	CE	HMA													
957+55	RT	PE	HMA													
958+30	LT	CE	AGG		50.00			5.25		112.50						
959+22	LT	PE	AGG		27.00			2.84		60.75						
960+35	LT	PE	HMA													
963+15	LT	PE	HMA													
970+29	RT	FE	AGG				4.00									
970+40	LT	FE	AGG				4.00									
976+10	RT	CE	AGG		50.00			5.25		112.50						
976+77	RT	PE	HMA													
979+01	LT	FE	AGG				4.00									
987+54	RT	FE	AGG				4.00									
987+96	LT	PE	HMA													
991+25	LT	PE	HMA													
993+85	LT	PE	HMA													
995+63	RT	FE	AGG				4.00									
995+64	LT	PE	HMA													
TOTAL						1342	128	189	209	1626	19	0.1	5	5	5	221

- NOTES:**
- FOR ENTRANCES LABELED AS "NO WORK" IT WAS ASSUMED THAT NO RESURFACING WOULD BE NEEDED DUE TO THE SHOULDER MATCHING EXISTING ELEVATION AT THE 10' SHOULDER EDGE.
 - QUANTITIES WERE INCLUDED AT ENTRANCES THAT ARE SHOWN ON THE SCHEDULE ABOVE FOR THOSE ENTRANCES AFFECTD BY THE PROPOSED 6% SHOULDER SLOPE. THESE QUANTITIES ARE THEORETICAL AND ACTUAL QUANTITES SHALL BE DETERMINED IN THE FIELD IF NEEDED.
 - QUANTITIES WERE INCLUDED AT ENTRANCES THAT ARE AGGREGATE.

FILE NAME =	USER NAME = duncanbd	DESIGNED -	REVISED -	STATE OF ILLINOIS DEPARTMENT OF TRANSPORTATION	SCHEDULES	F.A.P. RTE.	SECTION	COUNTY	TOTAL SHEETS	SHEET NO.
et:\pw\work\p1dot\duncanbd\0373950\036047-shit-schedule.dgn	DRAWN -	REVISED -	68			(29,30)RS-4	DEKALB	26	8	
PLOT SCALE = 100.0000' / 1in.	CHECKED -	REVISED -	CONTRACT NO. 66D47							
PLOT DATE = 6/4/2014	DATE -	REVISED -	ILLINOIS FED. AID PROJECT							
					SCALE:	SHEET 2 OF 6 SHEETS		STA.	TO STA.	

EOLDER 23-21 ILL RTE. 23				SOUTH OF ILL RTE 38 TO GURLER ROAD		DEKALB CO.		CONTRACT NO. 66E05	
GPS POINT NUMBER OR INDEX NUMBER	DESCRIPTION	EXISTING MONUMENT TYPE	PROPOSED MONUMENT TYPE	MONUMENT RECORDED TO BE RECORDED	RESPONSIBILITY				
23722	SW COR SEC 35-T40N-R4E OF THE 3RD PM	MAG NAIL STEM	TYPE 1	YES	1				
23721	W QTR COR SEC 2-T39N-R4E OF THE 3RD PM	PK OVER RR SPK	TYPE 1	YES	1				
23720	SW COR SEC 2-T39N-R4E OF THE 3RD PM	NAIL STEM	TYPE 1	YES	1				
23719	NOTE: MAG NAIL 1' SW NOT TO BE RESET PI STATION NAIL	MAG NAIL	MAG NAIL	NO	2				
23718	PI STATION NAIL	MAG NAIL	MAG NAIL	NO	2				
23717	E QTR COR SEC 10-T39N-R4E OF THE 3RD PM	SPINDLE	PK NAIL	YES	1				
23716	PI STATION NAIL	MAG NAIL	MAG NAIL	NO	2				
23715	NW COR SEC 14-T39N-R4E OF THE 3RD PM	SPINDLE	TYPE 1	YES	1				
23714	W QTR COR SEC 14-T39N-R4E OF THE 3RD PM	PK NAIL	TYPE 1	YES	1				
23713	SW COR SEC 14-T39N-R4E OF THE 3RD PM	MAG NAIL	TYPE 1	YES	1				
23711	NW COR SEC 26-T39N-R4E OF THE 3RD PM	MAG NAIL	TYPE 1	YES	1				
23710	W QTR COR SEC 26-T39N-R4E OF THE 3RD PM	MAG NAIL	MAG NAIL	NO	2				
23709	NW COR SEC 35-T39N-R4E OF THE 3RD PM	PK OVER I BAR	TYPE 1	YES	1				
23705	SW COR SEC 35-T39N-R4E OF THE 3RD PM	PK OVER PIPE	TYPE 1	YES	1				
23706	NW COR SEC 2-T38N-R4E OF THE 3RD PM	3/4" PIPE	TYPE 1	YES	1				
23707	NW COR SEC 2-T38N-R4E OF THE 3RD PM	1/2" REBAR							
	PLATS AND PLANS TO DETERMINE WHICH LOCATION TO SET TYPE 1								
23704	W QTR COR SEC 2-T38N-R4E OF THE 3RD PM	SPINDLE	TYPE 1	YES	1				
23703	SW COR SEC 2-T38N-R4E OF THE 3RD PM	3/4" PIPE	TYPE 1	YES	1				
23702	W QTR COR SEC 11-T38N-R4E OF THE 3RD PM	PK NAIL	TYPE 1	YES	1				
23701	NE COR SEC 15-T38N-R4E OF THE 3RD PM	RR SPIKE	TYPE 1	YES	1				
23700	E QTR COR SEC 15-T38N-R4E OF THE 3RD PM SOUTH OF TRACKS - OFF JOB LIMITS	BRASS PLAQUE	TYPE 1	YES	1				

THIS NOTE TO BE INCLUDED IN PLANS:
LISTED MONUMENT LOCATIONS HAVE BEEN RECORDED BY GPS. PRE CONSTRUCTION TIES BY THE R.E. ARE NOT REQUIRED.
IF AN UNLISTED MONUMENT IS FOUND, IT MUST BE TIED BY THE R.E. AND BROUGHT TO THE ATTENTION OF THE PLATS AND PLANS MANAGER.
AFTER RESURFACING, THE R.E. IS TO CONTACT THE PLATS AND PLANS MANAGER TO ESTABLISH LOCATIONS FOR PERMANENT SURVEY MARKER CORING.

RESPONSIBILITY:
1) RESIDENT TO RE-ESTABLISH MONUMENT (PAY ITEM REQUIRED. PERMANENT SURVEY MARKER, TYPE 1)
2) PLATS AND PLANS TO RE-ESTABLISH MONUMENT

PAVEMENT MARKINGS											
STA. TO STA.	POLYUREA TYPE 1					RAISED REFL PAVT MARK EACH	TEMPORARY			LETTERS & SYMBOLS SQ FT	SHORT TERM (3 APP) FOOT
	4"		6"		24"		4"	6"	24"		
	YELLOW FOOT	WHITE FOOT	YELLOW FOOT	WHITE FOOT	SO FT		(2 APPLICATIONS) FOOT				
549+15 - 555+50			160			8		320			0
CENTERLINE EDGELINE		1270									
NO PASSING ZONE RAILROAD STOPBAR	635				61.2		1270			122.4	
555+50 - 564+22			220			11		440			0
CENTERLINE EDGELINE		1744									
564+22 - 571+89			180			10		360			0
CENTERLINE EDGELINE	767						1534				
NO PASSING ZONE EDGELINE		1534									
571+89 - 574+15						3		904			0
NO PASSING ZONE EDGELINE	452		452								
574+15 - 580+15			150			7		300			0
CENTERLINE NO PASSING ZONE EDGELINE	600						1200				
580+15 - 592+65			320			15		640			0
CENTERLINE EDGELINE		2500									
592+65 - 601+00			210			11		420			0
CENTERLINE NO PASSING ZONE EDGELINE	835						1670				
601+00 - 605+30						6		1720			0
NO PASSING ZONE EDGELINE	860		860								
605+30 - 614+72			240			12		480			0
CENTERLINE NO PASSING ZONE EDGELINE	952						1904				
614+72 - 624+62			250			12		250			0
CENTERLINE EDGELINE		1884									
624+62 - 633+84			230			12		460			0
CENTERLINE NO PASSING ZONE EDGELINE	922						1844				
633+84 - 643+80						13		3992			0
NO PASSING ZONE EDGELINE	1996		1996								
643+80 - 652+43			220			11		440			0
CENTERLINE NO PASSING ZONE EDGELINE	863						1726				
652+43 - 700+00			1190			59		2380			0
CENTERLINE EDGELINE		9514									
700+00 - 708+10			200			11		400			0
CENTERLINE NO PASSING ZONE EDGELINE	810						1620				
708+10 - 722+01						18		5564			0
NO PASSING ZONE EDGELINE	2782		2782								
722+01 - 734+60			320			16		640			0
CENTERLINE NO PASSING ZONE EDGELINE	1250						2518				
		2518									

PAVEMENT MARKINGS											
STA. TO STA.	POLYUREA TYPE 1					RAISED REFL PAVT MARK EACH	TEMPORARY			LETTERS & SYMBOLS SQ FT	SHORT TERM (3 APP) FOOT
	4"		6"		24"		4"	6"	24"		
	YELLOW FOOT	WHITE FOOT	YELLOW FOOT	WHITE FOOT	LETTERS & SYMBOLS SQ FT		(2 APPLICATIONS) FOOT FOOT FOOT				
734+60 - 744+30			240			12		480			0
CENTERLINE											
EDGELINE		1940									
744+30 - 752+19			200			10		400			0
CENTERLINE											
NO PASSING ZONE	789						1578				
EDGELINE		1578									
752+19 - 761+52			230			12		460			0
CENTERLINE											
NO PASSING ZONE	933						1866				
EDGELINE		1866									
761+52 - 774+50			330			16		660			0
CENTERLINE											
EDGELINE		2596									
774+50 - 784+19			240			12		480			0
CENTERLINE											
NO PASSING ZONE	969						1938				
EDGELINE		1938									
784+19 - 797+50						17		5324			0
NO PASSING ZONE	2662										
EDGELINE		2662									
797+50 - 806+93			240			12		480			0
CENTERLINE											
NO PASSING ZONE	943						1886				
EDGELINE		1886									
806+93 - 868+05			1530			76		3060			0
CENTERLINE											
EDGELINE		12224									
868+05 - 876+66			210			11		420			0
CENTERLINE											
NO PASSING ZONE	861						1722				
EDGELINE		1722									
876+66 - 878+40			40			2		80			0
CENTERLINE											
EDGELINE		348									
878+40 - 886+20			380			10		380			0
CENTERLINE											
NO PASSING ZONE	780						1560				
EDGELINE		1560									
886+20 - 945+49			1490			74		2980			0
CENTERLINE											
EDGELINE		11858									
945+49 - 997+17.5			1290			65		2580			0
CENTERLINE											
EDGELINE		10337									
TOTAL	21661	89609	10310	24	61.2	564	43340	19990	48	122.4	13441

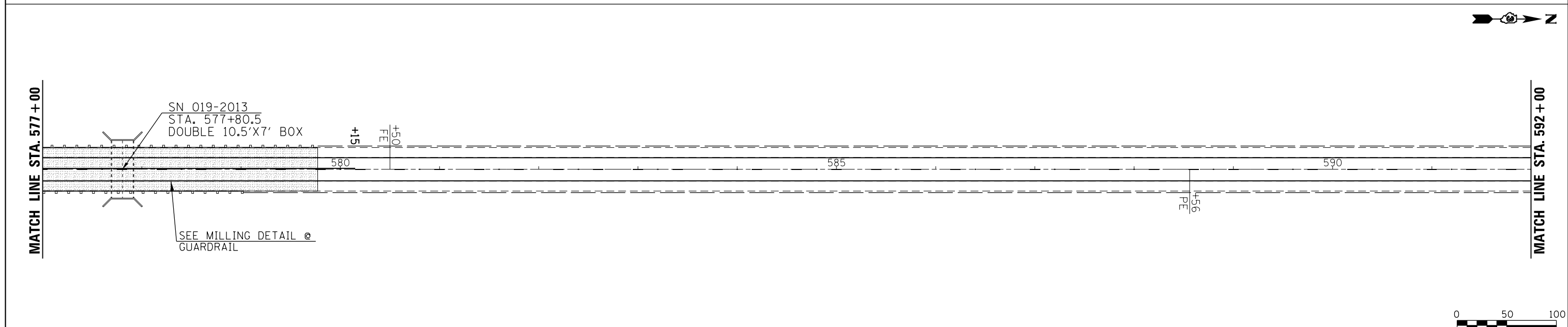
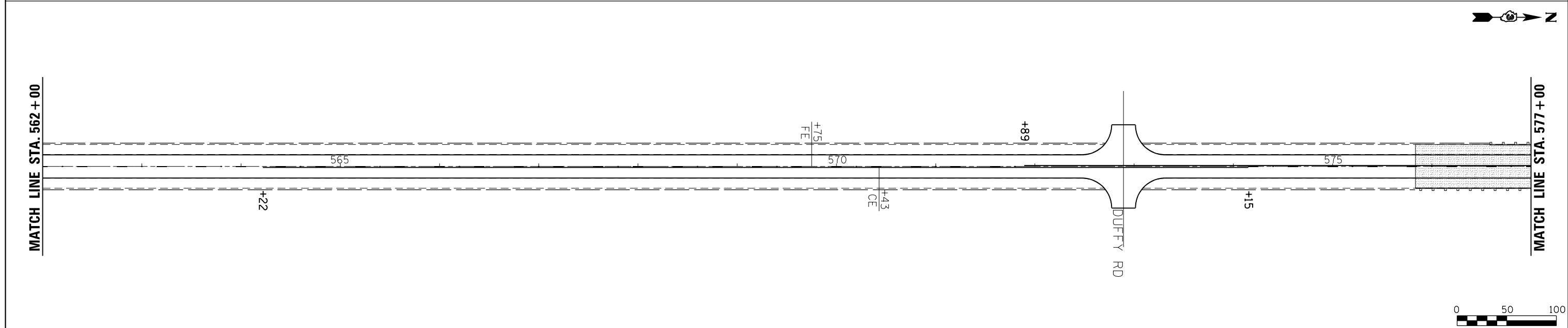
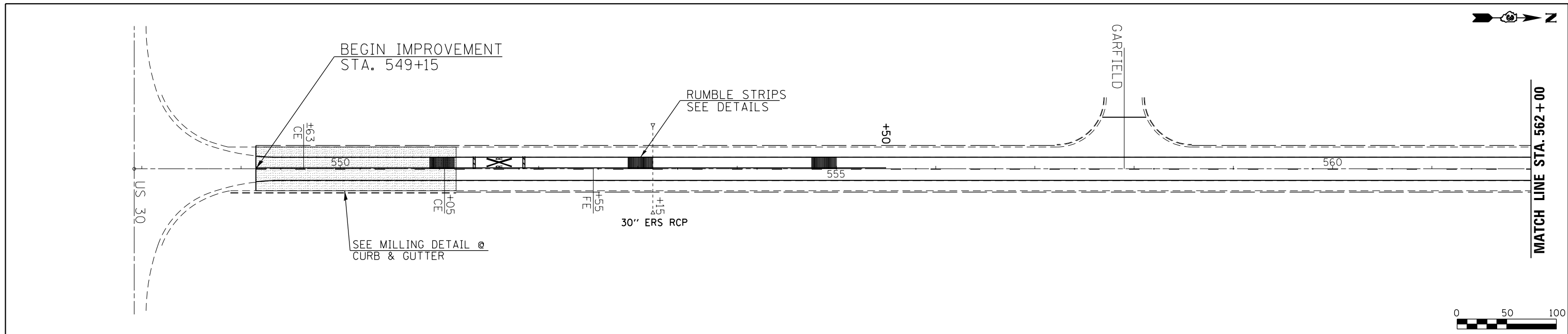

FILE NAME =	USER NAME = duncanbd	DESIGNED -	REVISED -	STATE OF ILLINOIS DEPARTMENT OF TRANSPORTATION	PLAN VIEW			F.A.P. RTE.	SECTION	COUNTY	TOTAL SHEETS	SHEET NO.
ei:\pw\work\p\dot\duncanbd\0373950\0386047-sh1-plan.dgn		DRAWN -	REVISED -		SCALE: 1:50	SHEET NO. 1 OF 17 SHEETS	STA. 548+00 TO STA. 592+00	68	(29,30)RS-4	DEKALB	26	12
		CHECKED -	REVISED -		CONTRACT NO. 66952							
		DATE -	REVISED -		ILLINOIS FED. AID PROJECT							



MATCH LINE STA. 592+00

MATCH LINE STA. 607+00

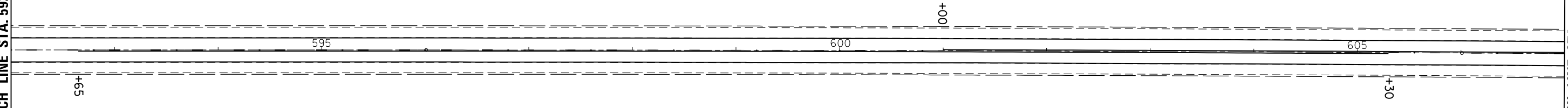

MATCH LINE STA. 607+00

MATCH LINE STA. 622+00

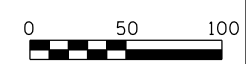
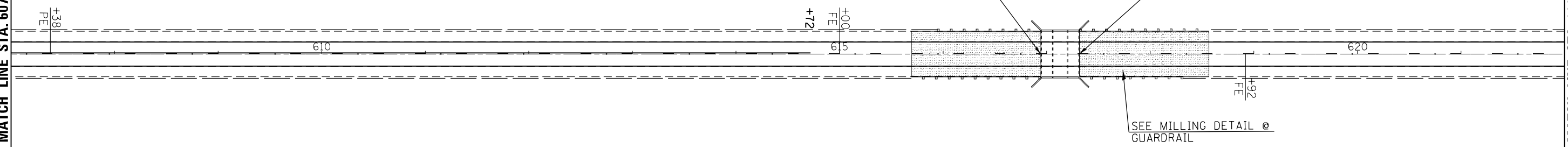

MATCH LINE STA. 622+00

MATCH LINE STA. 637+00

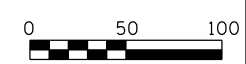
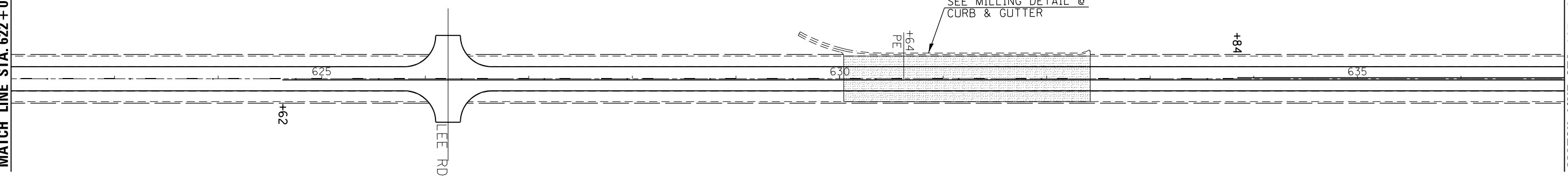

FILE NAME =	USER NAME = duncanbd	DESIGNED -	REVISED -
ei:\pwwork\pwwork\duncanbd\0373950\0386047-sh1-plan.dgn		DRAWN -	REVISED -
	PLOT SCALE = 100.0000' / in.	CHECKED -	REVISED -
	PLOT DATE = 6/4/2014	DATE -	REVISED -

**STATE OF ILLINOIS
DEPARTMENT OF TRANSPORTATION**

PLAN VIEW

SCALE: 1=50 SHEET NO. 2 OF 17 SHEETS STA. 592+00 TO STA. 637+00

F.A.P. RTE.	SECTION	COUNTY	TOTAL SHEETS	SHEET NO.
68	(29,30)RS-4	DEKALB	26	13
CONTRACT NO. 66952				
ILLINOIS FED. AID PROJECT				



MATCH LINE STA. 637+00

MATCH LINE STA. 652+00

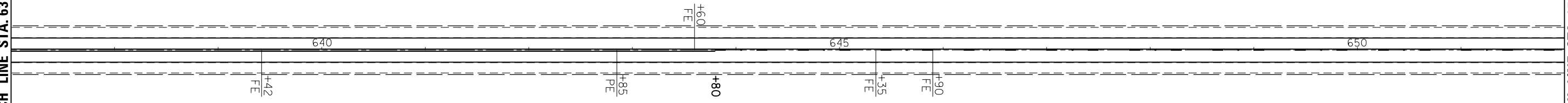

MATCH LINE STA. 652+00

MATCH LINE STA. 667+00

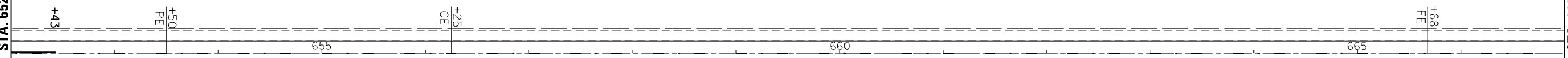

MATCH LINE STA. 667+00

MATCH LINE STA. 682+00

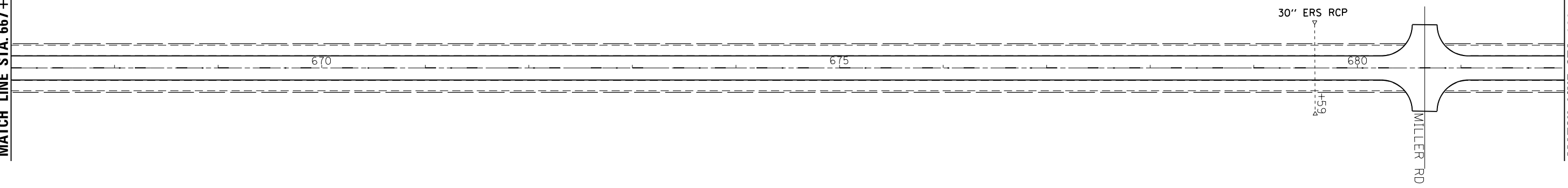

FILE NAME =	USER NAME = duncanbd	DESIGNED -	REVISED -
ei:\pw\work\p\midot\duncanbd\0373950\0386047-sh1-plan.dgn		DRAWN -	REVISED -
	PLOT SCALE = 100.0000' / in.	CHECKED -	REVISED -
	PLOT DATE = 6/4/2014	DATE -	REVISED -

**STATE OF ILLINOIS
DEPARTMENT OF TRANSPORTATION**

PLAN VIEW

SCALE: 1=50 SHEET NO. 2 OF 17 SHEETS STA. 637+00 TO STA. 682+00

F.A.P. RTE.	SECTION	COUNTY	TOTAL SHEETS	SHEET NO.
68	(29,30)RS-4	DEKALB	26	14
CONTRACT NO. 66952				
ILLINOIS FED. AID PROJECT				

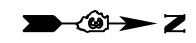

MATCH LINE STA. 682+00

MATCH LINE STA. 697+00

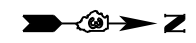
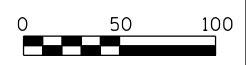
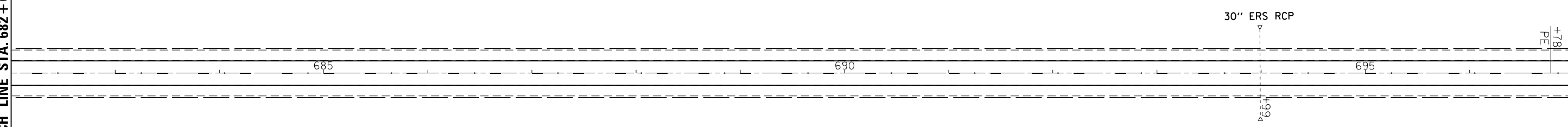

MATCH LINE STA. 697+00

MATCH LINE STA. 712+00

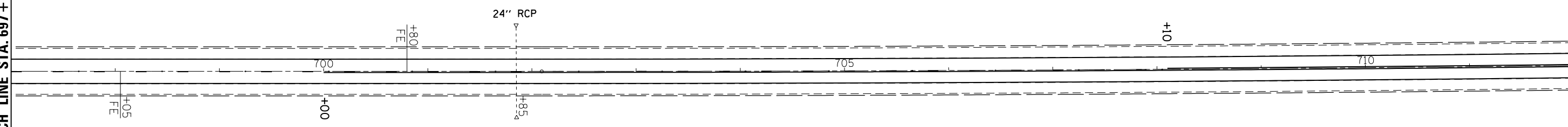

MATCH LINE STA. 712+00

MATCH LINE STA. 727+00

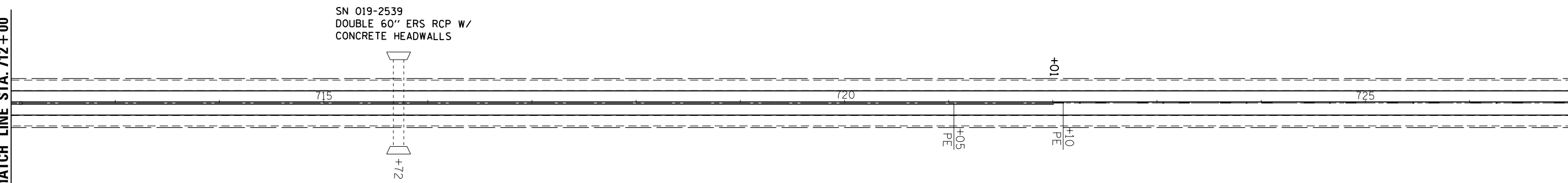

FILE NAME =	USER NAME = duncanbd	DESIGNED -	REVISED -
c:\pwork\work\pwork\duncanbd\0373950\038047-shit-plan.dgn		DRAWN -	REVISED -
	PLOT SCALE = 100.0000' / in.	CHECKED -	REVISED -
	PLOT DATE = 6/4/2014	DATE -	REVISED -

**STATE OF ILLINOIS
DEPARTMENT OF TRANSPORTATION**

PLAN VIEW

SCALE: 1=50 SHEET NO. 4 OF 17 SHEETS STA. 682+00 TO STA. 727+00

F.A.P. RTE.	SECTION	COUNTY	TOTAL SHEETS	SHEET NO.
68	(29,30)RS-4	DEKALB	26	15
CONTRACT NO. 66952				
ILLINOIS FED. AID PROJECT				

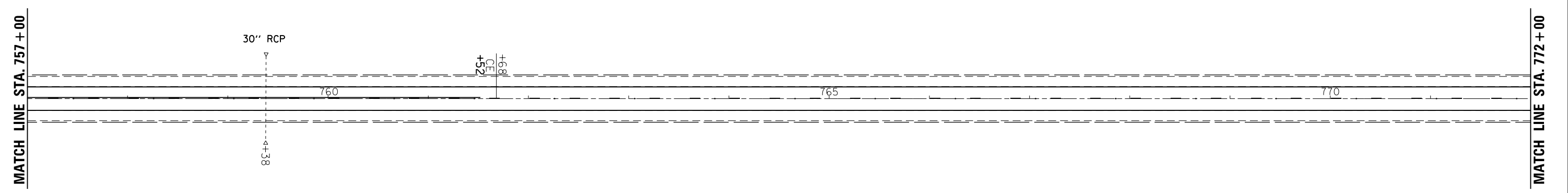
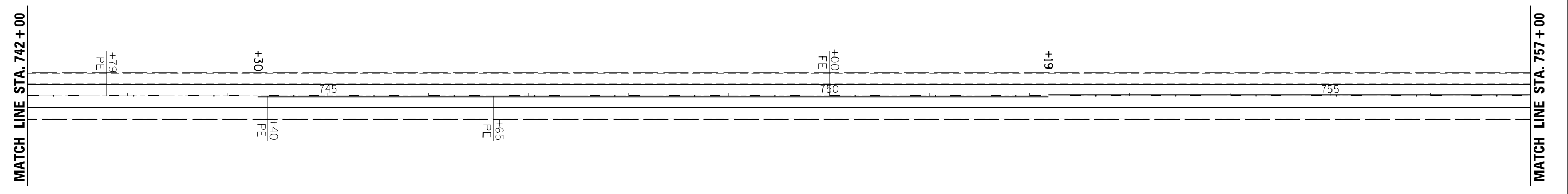
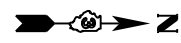
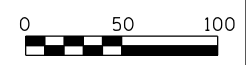
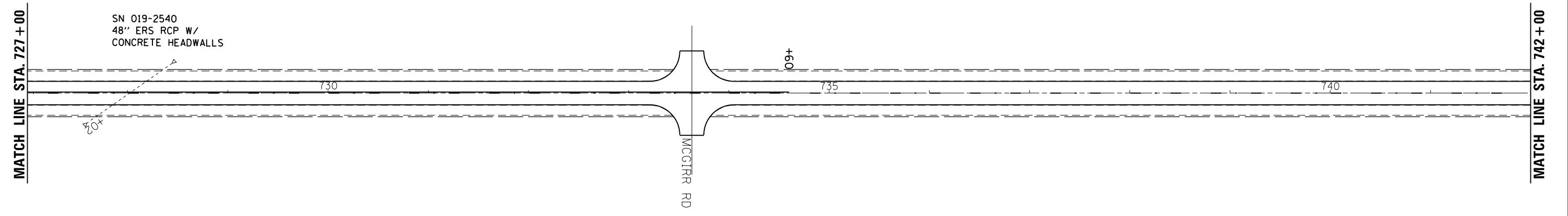
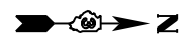

FILE NAME =	USER NAME = duncanbd	DESIGNED -	REVISED -
c:\pwwork\pwwork\duncanbd\0373950\0386047-sh1-plan.dgn		DRAWN -	REVISED -
	PLOT SCALE = 100.0000' / in.	CHECKED -	REVISED -
	PLOT DATE = 6/4/2014	DATE -	REVISED -

**STATE OF ILLINOIS
DEPARTMENT OF TRANSPORTATION**

PLAN VIEW

SCALE: 1=50 SHEET NO. 5 OF 17 SHEETS STA. 727+00 TO STA. 772+00

F.A.P. RTE.	SECTION	COUNTY	TOTAL SHEETS	SHEET NO.
68	(29,30)RS-4	DEKALB	26	16
CONTRACT NO. 66952				
ILLINOIS FED. AID PROJECT				

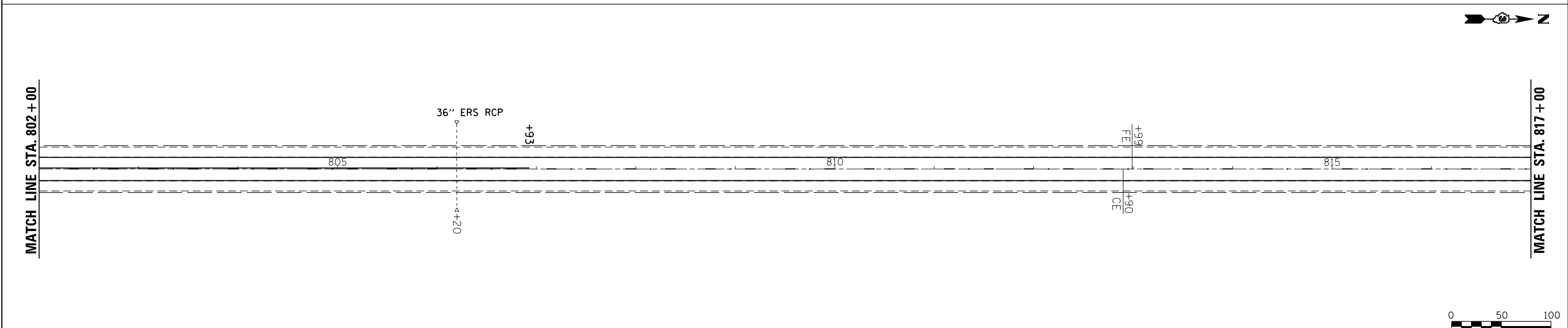
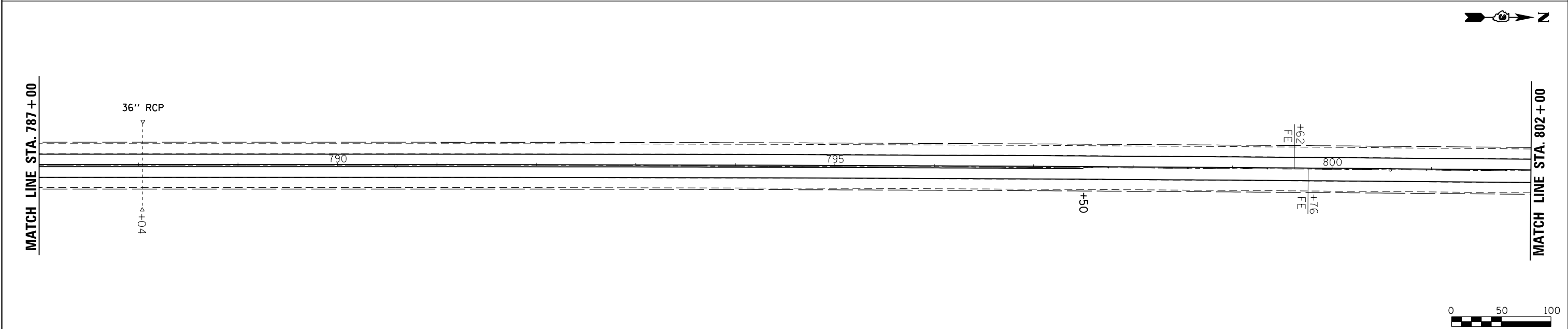
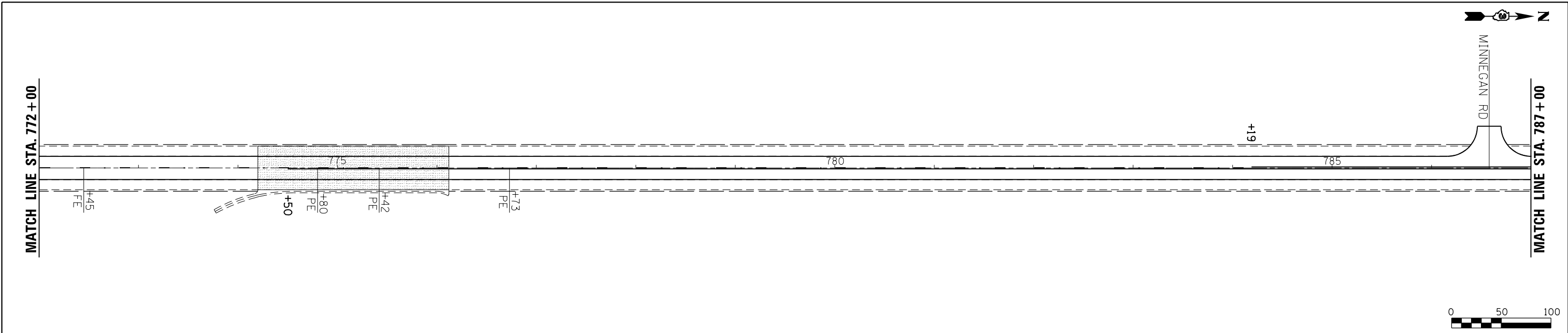

FILE NAME =	USER NAME = duncanbd	DESIGNED -	REVISED -	STATE OF ILLINOIS DEPARTMENT OF TRANSPORTATION	PLAN VIEW			F.A.P. RTÉ.	SECTION	COUNTY	TOTAL SHEETS	SHEET NO.
c:\pwwork\pwwork\duncanbd\0373950\036047-sh1-plan.dgn		DRAWN -	REVISED -		SCALE: 1:50	SHEET NO. 6 OF 17 SHEETS	STA. 772+00 TO STA. 817+00	68	(29,30)RS-4	DEKALB	26	17
		CHECKED -	REVISED -		CONTRACT NO. 66952							
		DATE -	REVISED -		ILLINOIS FED. AID PROJECT							



MATCH LINE STA. 817+00

MATCH LINE STA. 832+00

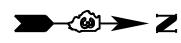
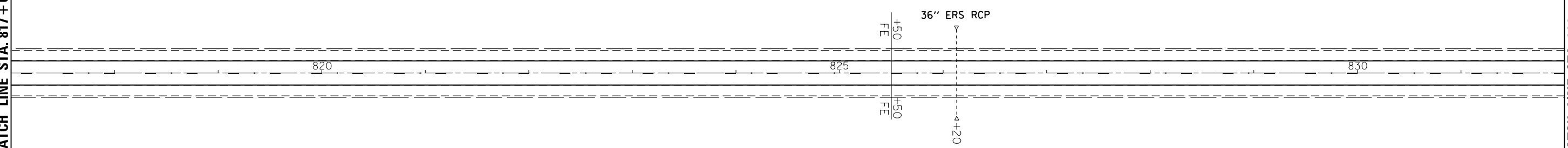

MATCH LINE STA. 832+00

MATCH LINE STA. 847+00

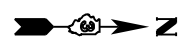
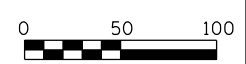
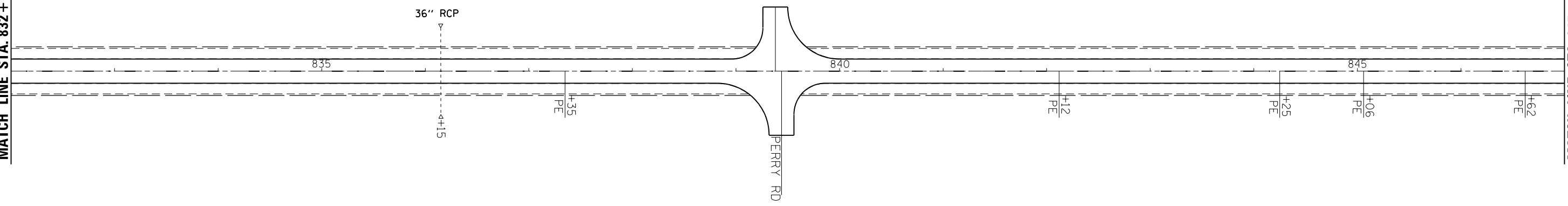

MATCH LINE STA. 847+00

MATCH LINE STA. 862+00

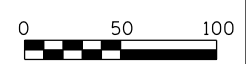
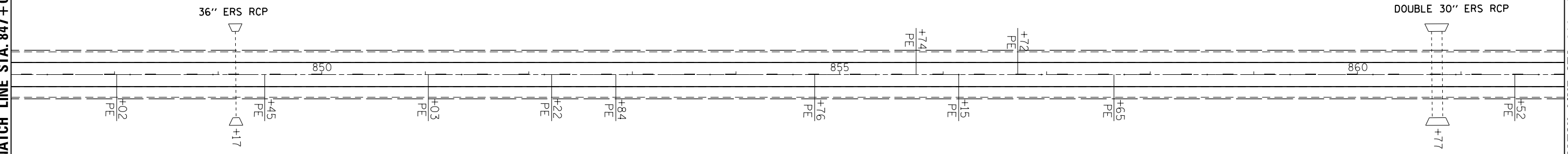

FILE NAME =	USER NAME = duncanbd	DESIGNED -	REVISED -
ei:\pw\work\p\dot\duncanbd\0373950\036047-sh1-plan.dgn		DRAWN -	REVISED -
	PLOT SCALE = 100.0000' / in.	CHECKED -	REVISED -
	PLOT DATE = 6/4/2014	DATE -	REVISED -

**STATE OF ILLINOIS
DEPARTMENT OF TRANSPORTATION**

PLAN VIEW

SCALE: 1=50 SHEET NO. 7 OF 17 SHEETS STA. 817+00 TO STA. 862+00

F.A.P. RTE.	SECTION	COUNTY	TOTAL SHEETS	SHEET NO.
68	(29,30)RS-4	DEKALB	26	18
CONTRACT NO. 66952				
ILLINOIS FED. AID PROJECT				

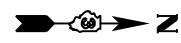

MATCH LINE STA. 862+00

MATCH LINE STA. 877+00

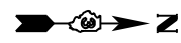
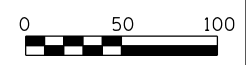
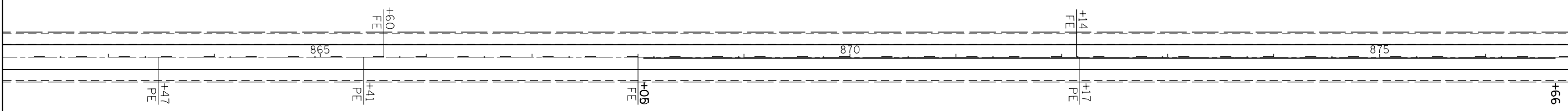

MATCH LINE STA. 877+00

MATCH LINE STA. 892+00

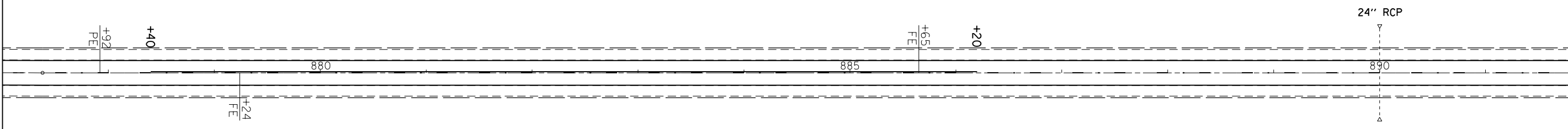

MATCH LINE STA. 892+00

MATCH LINE STA. 907+00

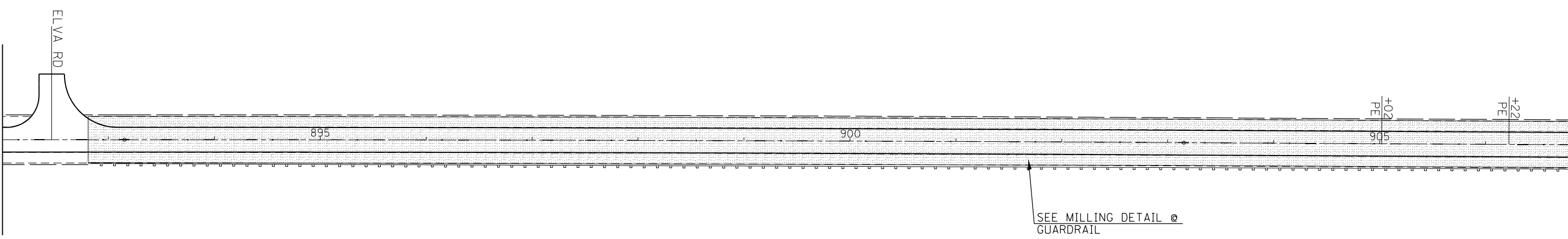

FILE NAME =	USER NAME = duncanbd	DESIGNED -	REVISED -
ei:\pwork\pwork\dot\duncanbd\0373950\0386047-sh1-plan.dgn		DRAWN -	REVISED -
	PLOT SCALE = 100.0000' / in.	CHECKED -	REVISED -
	PLOT DATE = 6/4/2014	DATE -	REVISED -

**STATE OF ILLINOIS
DEPARTMENT OF TRANSPORTATION**

PLAN VIEW

SCALE: 1=50 SHEET NO. 8 OF 17 SHEETS STA. 862+00 TO STA. 907+00

F.A.P. RTE.	SECTION	COUNTY	TOTAL SHEETS	SHEET NO.
68	(29,30)RS-4	DEKALB	26	19
CONTRACT NO. 66952				
ILLINOIS FED. AID PROJECT				



SN 019-0007 OMISSION
STA. 911+29 - STA. 911+85

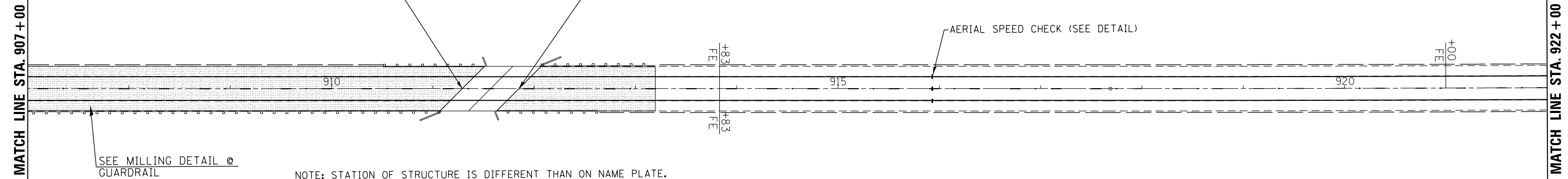

NOTE: STATION OF STRUCTURE IS DIFFERENT THAN ON NAME PLATE.
SUPER REPLACEMENT IN 2006 USED DIFFERENT STATION THAN ORIGINAL STRUCTURE

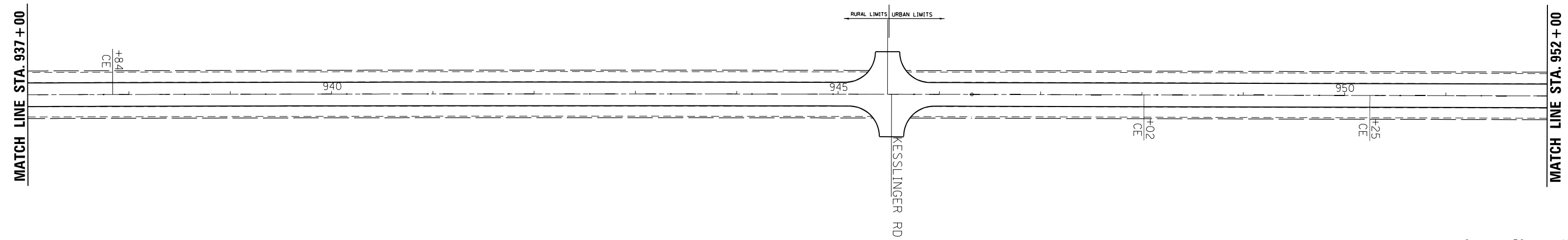
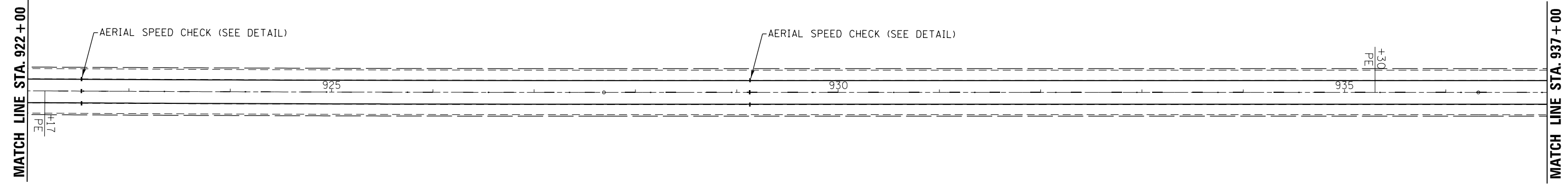
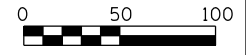

FILE NAME =	USER NAME = duncanbd	DESIGNED -	REVISED -
et:\pwork\pwork\pwork\duncanbd\0373950\038047-shit-plan.dgn		DRAWN -	REVISED -
	PLOT SCALE = 100.0000' / in.	CHECKED -	REVISED -
	PLOT DATE = 6/4/2014	DATE -	REVISED -

**STATE OF ILLINOIS
DEPARTMENT OF TRANSPORTATION**

PLAN VIEW
SCALE: 1:50 SHEET NO. 9 OF 17 SHEETS STA. 907+00 TO STA. 952+00

F.A.P. RTE.	SECTION	COUNTY	TOTAL SHEETS	SHEET NO.
68	(29,30)RS-4	DEKALB	26	20
CONTRACT NO. 66952				
ILLINOIS FED. AID PROJECT				

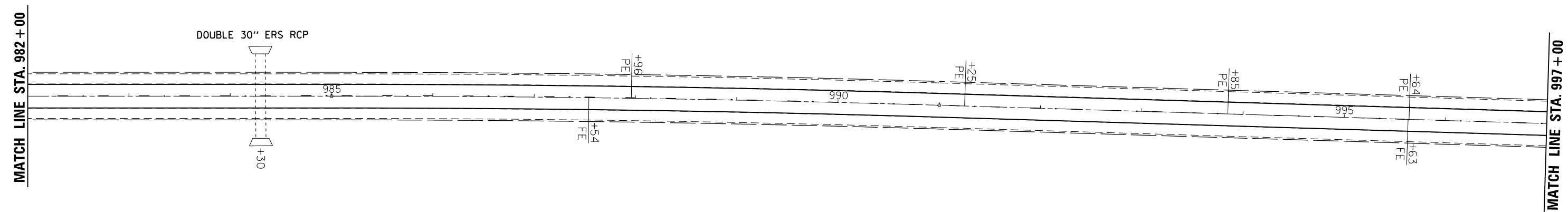
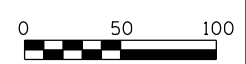
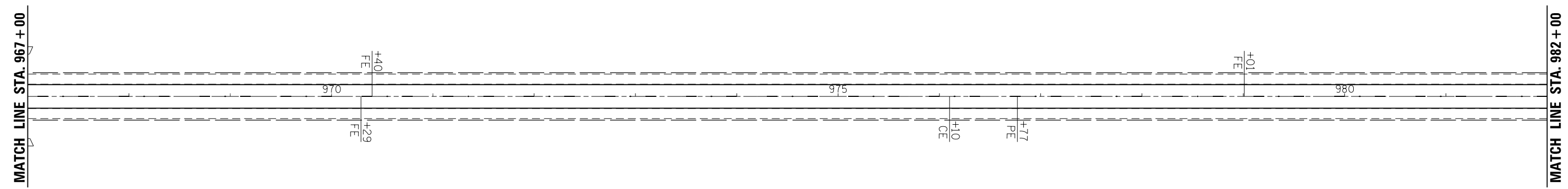
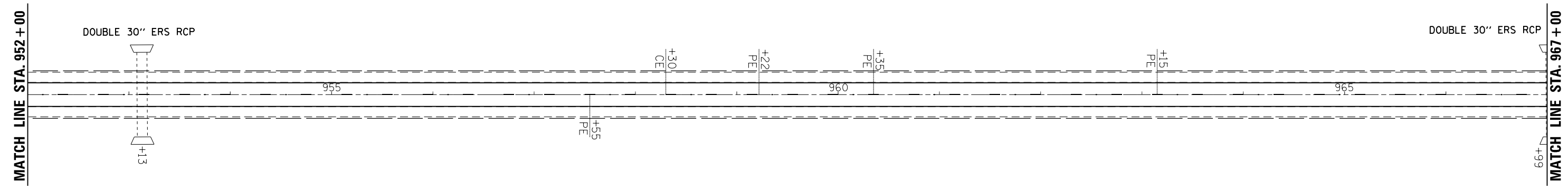

FILE NAME =	USER NAME = duncanbd	DESIGNED -	REVISED -
ei:\pwwork\pwwork\duncanbd\0373950\036047-shit-plan.dgn		DRAWN -	REVISED -
	PLOT SCALE = 100.0000' / in.	CHECKED -	REVISED -
	PLOT DATE = 6/4/2014	DATE -	REVISED -

**STATE OF ILLINOIS
DEPARTMENT OF TRANSPORTATION**

PLAN VIEW

SCALE: 1=50 SHEET NO. 10 OF 17 SHEETS STA. 952+00 TO STA. 997+00

F.A.P. RTE.	SECTION	COUNTY	TOTAL SHEETS	SHEET NO.
68	(29,30)RS-4	DEKALB	26	21
CONTRACT NO. 66952				
ILLINOIS FED. AID PROJECT				

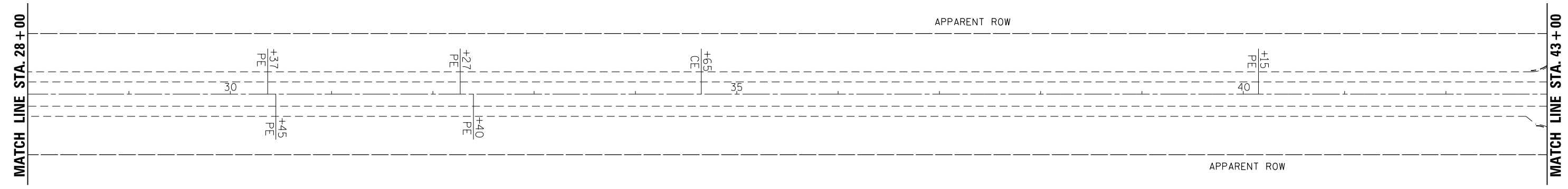
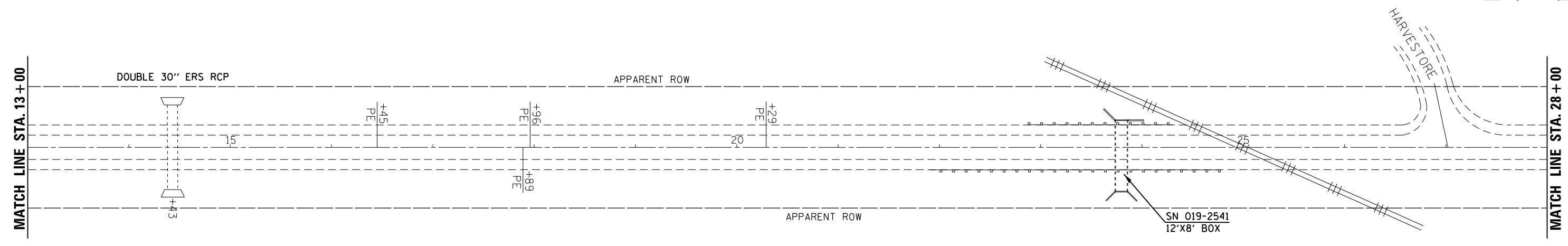
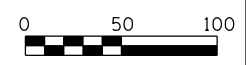
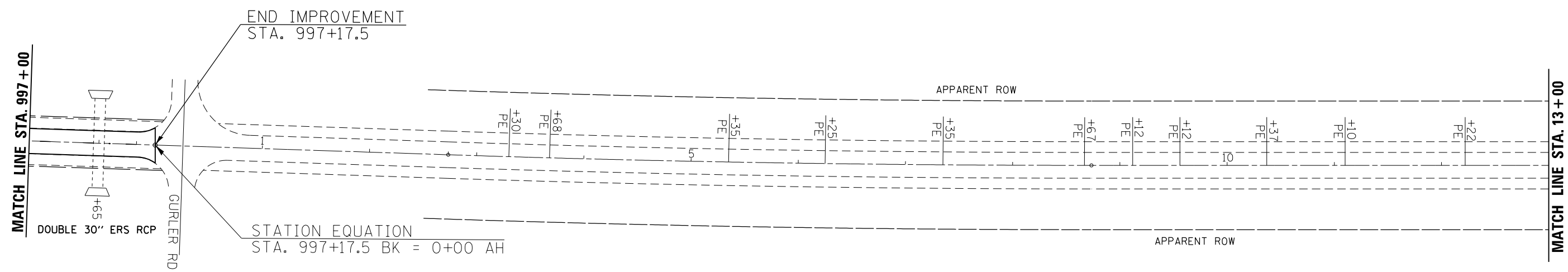

FILE NAME = c:\pw\work\p1\dot\duncanbd\8373950\036047-sh1-plan.dgn	USER NAME = duncanbd	DESIGNED -	REVISED -	STATE OF ILLINOIS DEPARTMENT OF TRANSPORTATION	PLAN VIEW			F.A.P. RTE. = 68	SECTION = (29,30)RS-4	COUNTY = DEKALB	TOTAL SHEETS = 26	SHEET NO. = 22
	PLOT SCALE = 100.0000' / in.	CHECKED -	REVISED -		SCALE: 1:50	SHEET NO. 11 OF 17 SHEETS	STA. 997+00 TO STA. 43+00	CONTRACT NO. 66952				
PLOT DATE = 6/4/2014	DATE -	REVISED -	REVISED -		ILLINOIS FED. AID PROJECT							

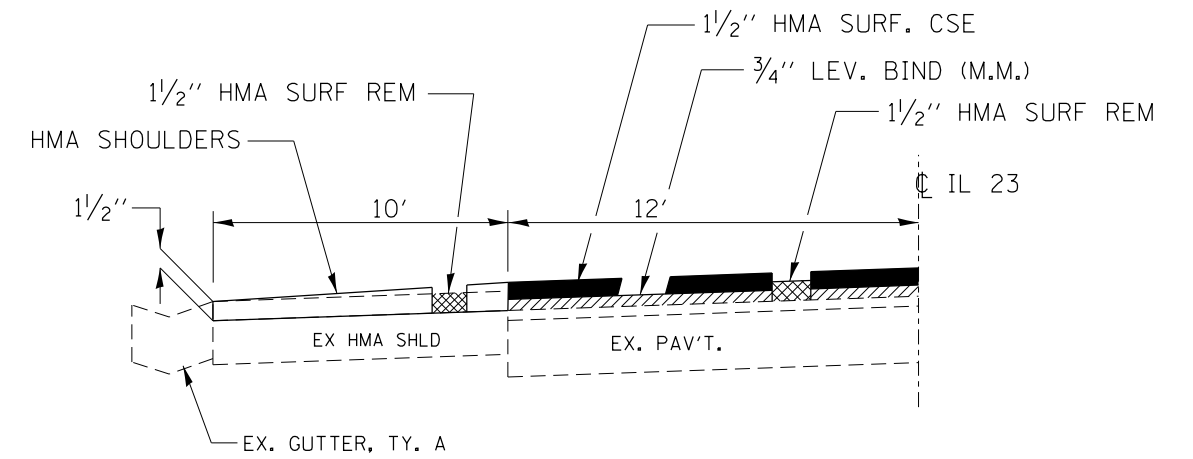
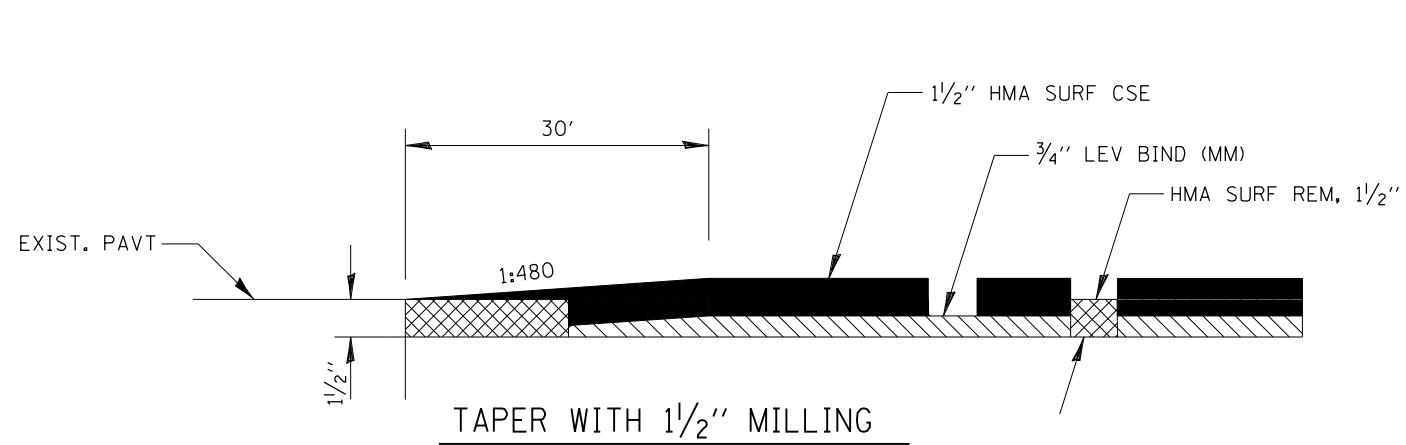

MILLING AT GUTTER

STA. 630+04 TO STA. 632+42 LT
 STA. 774+20 TO STA. 776+12 RT

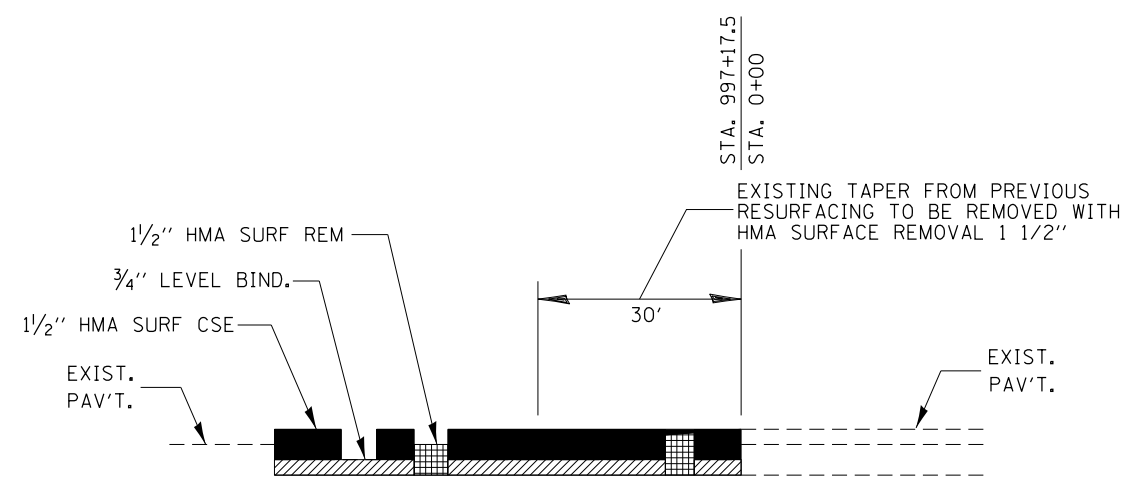

END OF PROJECT

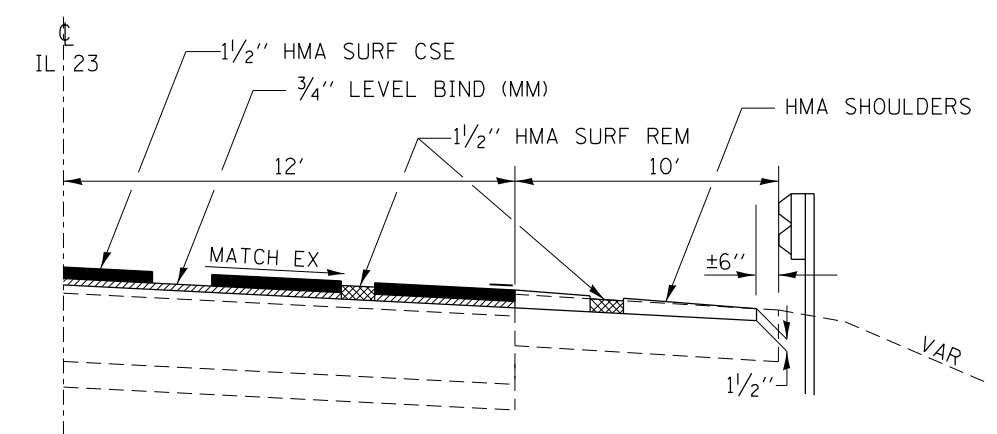

FILE NAME =	USER NAME = duncanbd	DESIGNED -	REVISED -
et:\pw\work\p1dot\duncanbd\0373950\038047-sh1-details.dgn		DRAWN -	REVISED -
		CHECKED -	REVISED -
		DATE -	REVISED -

**STATE OF ILLINOIS
 DEPARTMENT OF TRANSPORTATION**

DETAILS			
SCALE:	SHEET NO.	OF SHEETS	STA. TO STA.

F.A.P. RTE.	SECTION	COUNTY	TOTAL SHEETS	SHEET NO.
68	(29,30)RS-4	DEKALB	26	23
CONTRACT NO. 66952				
ILLINOIS FED. AID PROJECT				

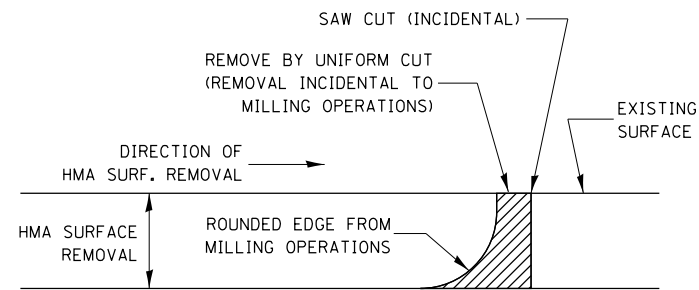

NOTE:
 WHEN MILLING OPERATIONS PRODUCE A ROUNDED EDGE, THEN A SAW CUT SHALL BE USED TO MANUFACTURE A PERPENDICULAR EDGE AS SHOWN IN THE DETAIL. THE ENGINEER SHALL BE THE SOLE JUDGE CONCERNING THE USE OF THIS DETAIL

HMA DETAIL AT BUTT JOINTS

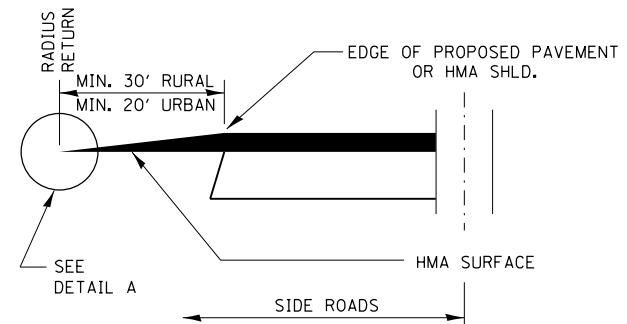

**SECTION A-A
 DETAILS AT SIDE ROADS**

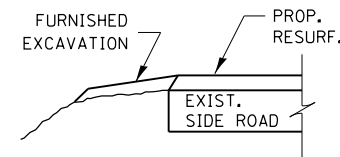

SECTION B-B

THE COST OF REMOVAL AT EXISTING HMA OR P.C.C. LOCATIONS SHALL BE PAID FOR PER SQ. YD. BY THE APPROPRIATE PAY ITEM. REMOVAL AT THE EXISTING AGG. LOCATIONS SHALL BE INCIDENTAL TO THE HMA. A-3 LOCATIONS SHALL BE FEATHER TAPERED.

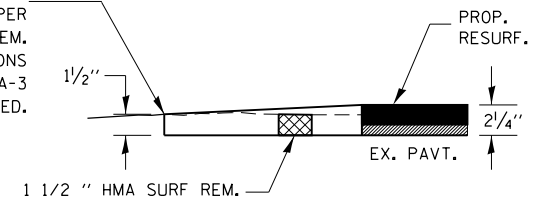

DETAIL A

SIDEROADS IN RURAL SECTION. IN URBAN SECTION MILLING & RESURFACING WILL BE 2 1/4'

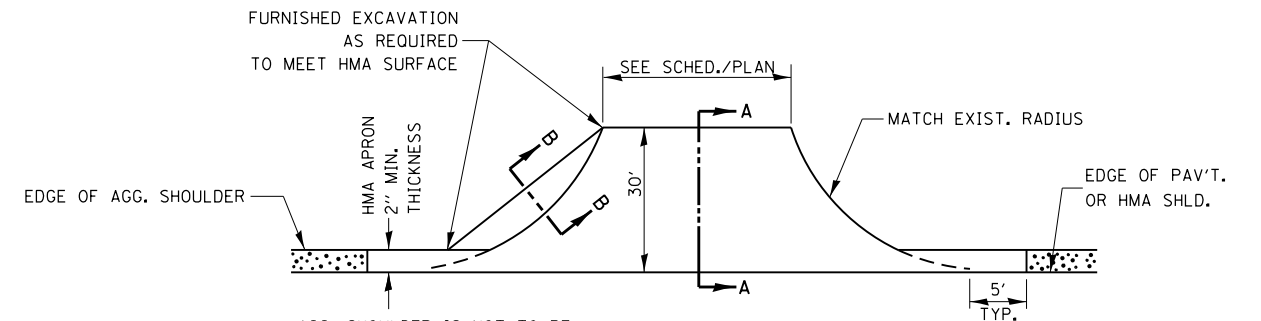

AGG. SHOULDER IS NOT TO BE PLACED AROUND SIDE ROAD RADII

PROP. HMA SHLD. SHALL NOT BE CONSTRUCTED THRU HMA SIDEROADS.

PLAN AT SIDE ROADS

FILE NAME =	USER NAME = duncanbd	DESIGNED -	REVISED -
et:\pw\work\p1dot\duncanbd\0373950\0386047-sh1-deta1s.dgn		DRAWN -	REVISED -
	PLOT SCALE = 100.0000' / in.	CHECKED -	REVISED -
	PLOT DATE = 6/4/2014	DATE -	REVISED -

**STATE OF ILLINOIS
 DEPARTMENT OF TRANSPORTATION**

DETAILS

SCALE: SHEET NO. OF SHEETS STA. TO STA.

F.A.P. RTE.	SECTION	COUNTY	TOTAL SHEETS	SHEET NO.
68	(29,30)RS-4	DEKALB	26	24
CONTRACT NO. 66952				
ILLINOIS FED. AID PROJECT				

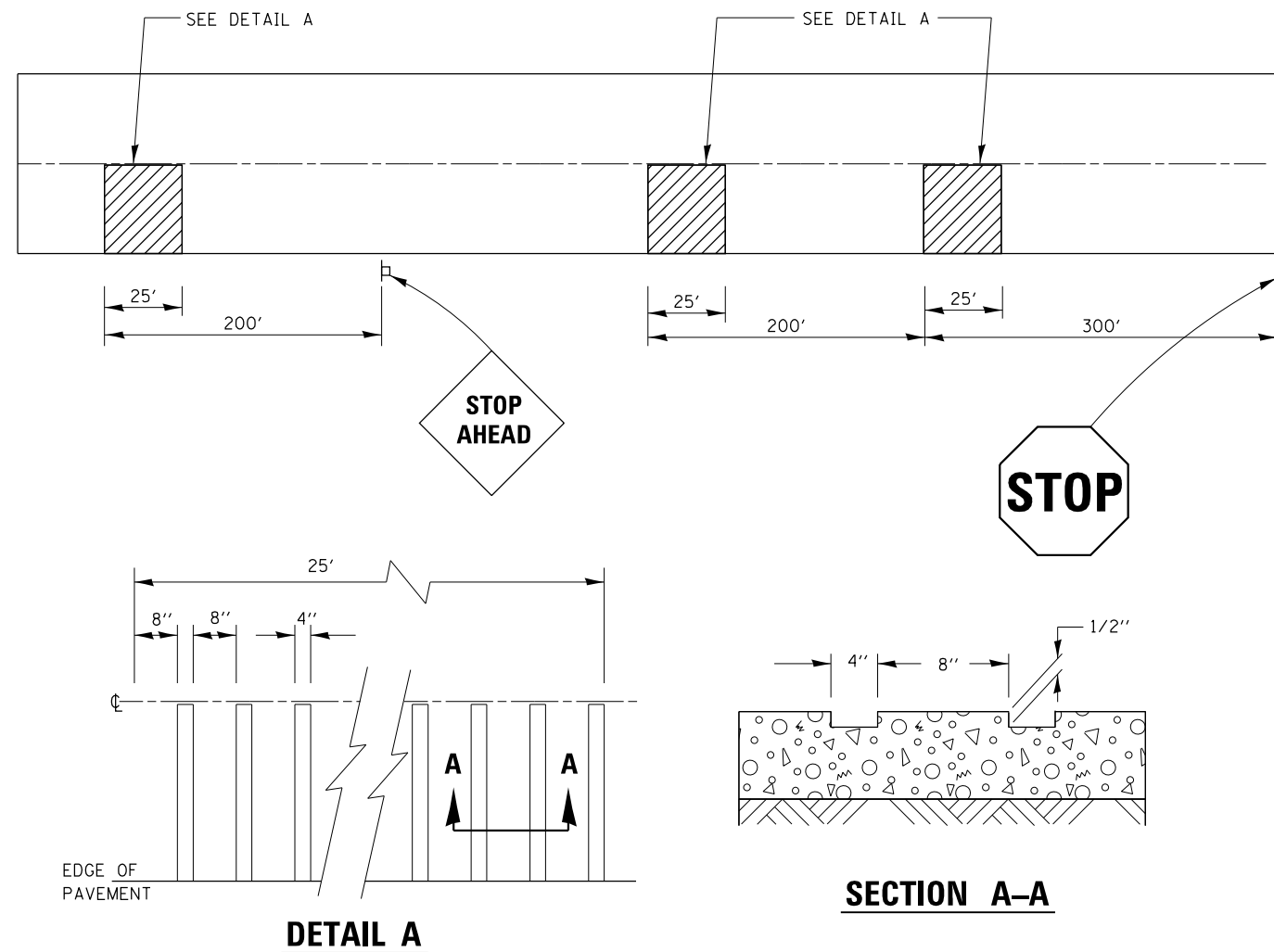

**TYPICAL GROOVED RUMBLE STRIP
APPLICATION IN ADVANCE OF AN INTERSECTION**

APPROXIMATE LOCATIONS:
 STA. 550+90 TO STA. 551+15
 STA. 553+15 TO STA. 552+90
 STA. 554+75 TO STA. 555+00

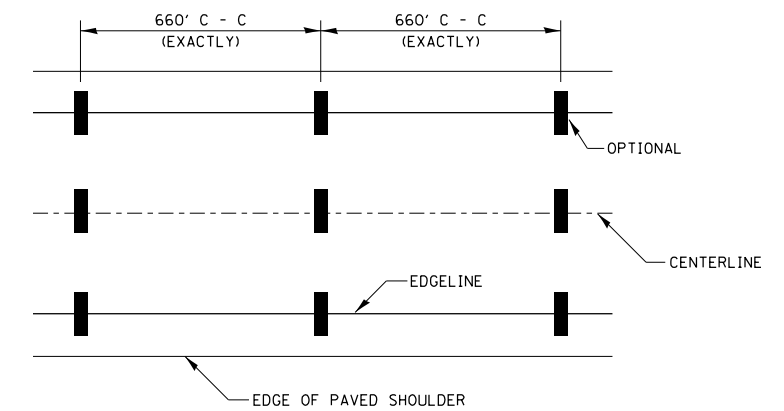

IT WILL BE NECESSARY TO HAVE A REPRESENTATIVE OF THE STATE POLICE PRESENT SO THAT THE ACCURACY OF MEASUREMENT CAN BE ATTESTED TO IN COURT.

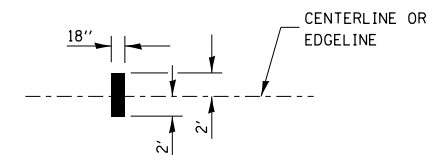

AERIAL SPEED CHECK ZONES

STA. 915+93
 STA. 922+53
 STA. 929+13

FILE NAME = c:\pwork\pwork\dot\duncanbd\0373950\0386047-shit-details.dgn	USER NAME = duncanbd	DESIGNED -	REVISED -	STATE OF ILLINOIS DEPARTMENT OF TRANSPORTATION	DETAILS			F.A.P. RTE.	SECTION	COUNTY	TOTAL SHEETS	SHEET NO.
	PLOT SCALE = 100.0000' / in.	DRAWN -	REVISED -					68	(29,30)RS-4	DEKALB	26	25
PLOT DATE = 6/4/2014	CHECKED -	REVISED -	SCALE:		SHEET NO.	OF SHEETS	STA.	TO STA.	CONTRACT NO. 66952			
	DATE -	REVISED -							ILLINOIS FED. AID PROJECT			

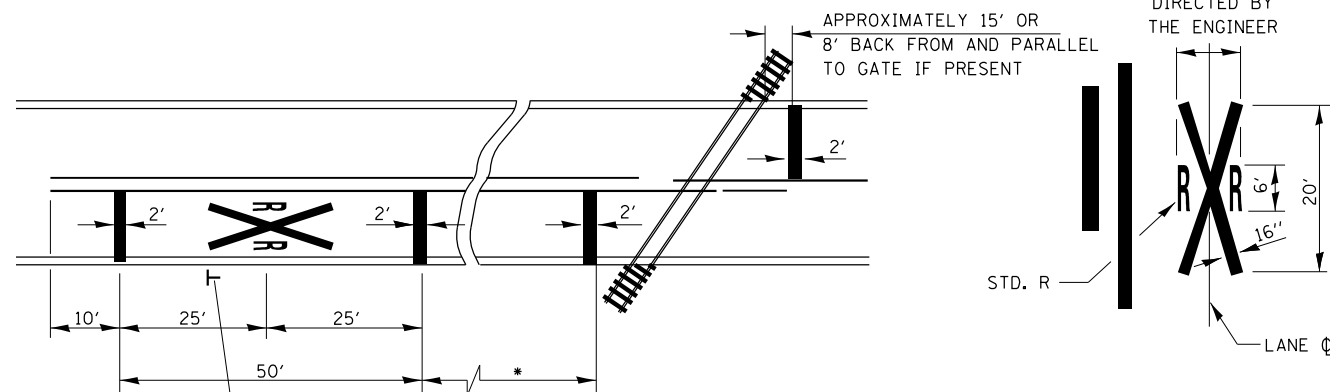

* MINIMUM DISTANCE
 400' FOR 55 MPH
 250' FOR 45 MPH
 100' FOR 35 MPH OR LESS

PAVEMENT MARKINGS AT RAILROAD-HIGHWAY GRADE CROSSING

NOTES:
 THE TRANSVERSE SPREAD OF THE "X" MAY VARY ACCORDING TO LANE WIDTH.
 ON MULTI-LANE ROADS, THE STOP LINES SHALL EXTEND ACROSS ALL APPROACH LANES AND SEPARATE RXR SYMBOLS SHALL BE PLACED ADJACENT TO EACH OTHER IN EACH LANE.

WHEN THE PAVEMENT MARKING SYMBOL IS USED, A PORTION OF THE SYMBOL SHOULD BE LOCATED DIRECTLY ADJACENT TO THE ADVANCE WARNING SIGN (W10-1).

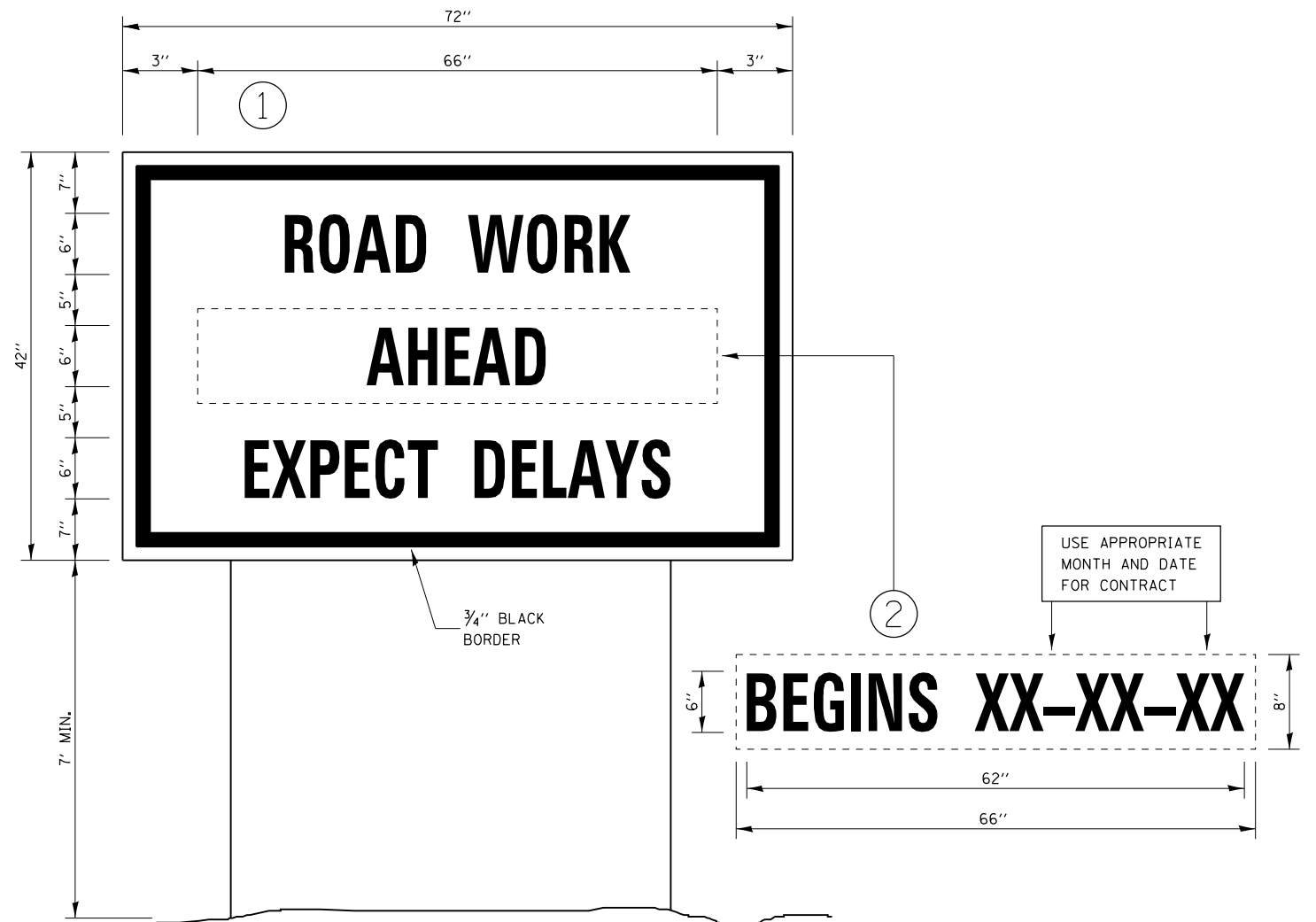

TEMPORARY INFORMATION SIGNING

NOTES:

- USE 6" D BLACK LETTERING ON FLOURESENT ORANGE BACKGROUND.
- ERECT SIGNS AT LOCATIONS IN ADVANCE OF THE "ROAD CONSTRUCTION AHEAD" SIGNS AS DIRECTED BY THE ENGINEER.
- ERECT SIGN ① WITH INSTALLED PANEL ② A MINIMUM OF ONE WEEK PRIOR TO THE START OF THE LANE CLOSURE.
- REMOVE PANEL ② ON THAT DATE.
- SEE SPECIAL PROVISION "TEMPORARY INFORMATION SIGNING" FOR ADDITIONAL INFORMATION.
- WILL BE PAID FOR PER SQ FT AS "TEMPORARY INFORMATION SIGNING". EACH SIGN = 21 SQ FT AND THE DATE PANEL ② WILL NOT BE MEASURED SEPARATELY FOR PAYMENT.

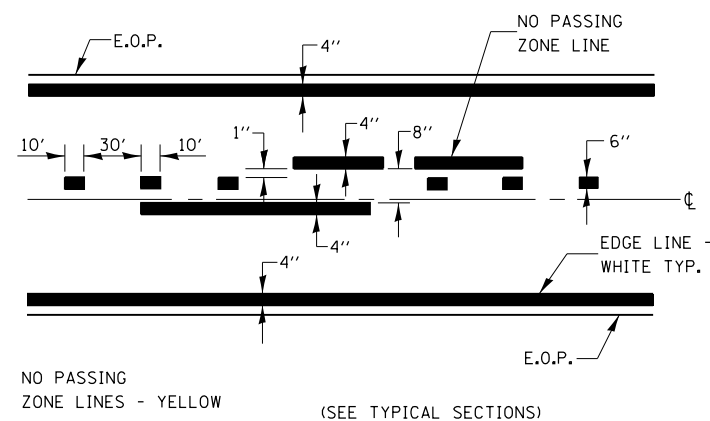

PAVEMENT MARKING

FILE NAME =	USER NAME = duncanbd	DESIGNED -	REVISED -
et:\pw\work\p1dot\duncanbd\0373950\0386047-sht-details.dgn		DRAWN -	REVISED -
	PLOT SCALE = 100.0000' / 1"	CHECKED -	REVISED -
	PLOT DATE = 6/4/2014	DATE -	REVISED -

STATE OF ILLINOIS
 DEPARTMENT OF TRANSPORTATION

DETAILS			
SCALE:	SHEET NO.	OF SHEETS	STA. TO STA.

F.A.P. RTE.	SECTION	COUNTY	TOTAL SHEETS	SHEET NO.
68	(29,30)RS-4	DEKALB	26	26
CONTRACT NO. 66952				
FED. ROAD DIST. NO. ILLINOIS FED. AID PROJECT				