

NOTE: SEE SHEET 58 FOR BUTT JOINT
AND TRANSITION DETAILS

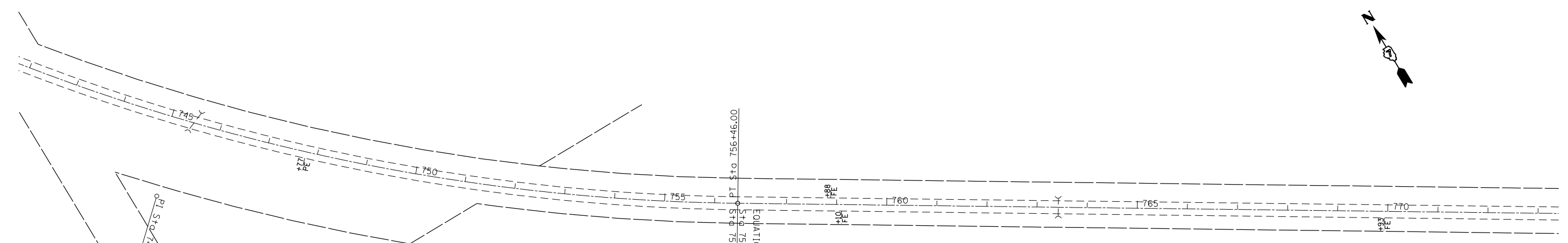
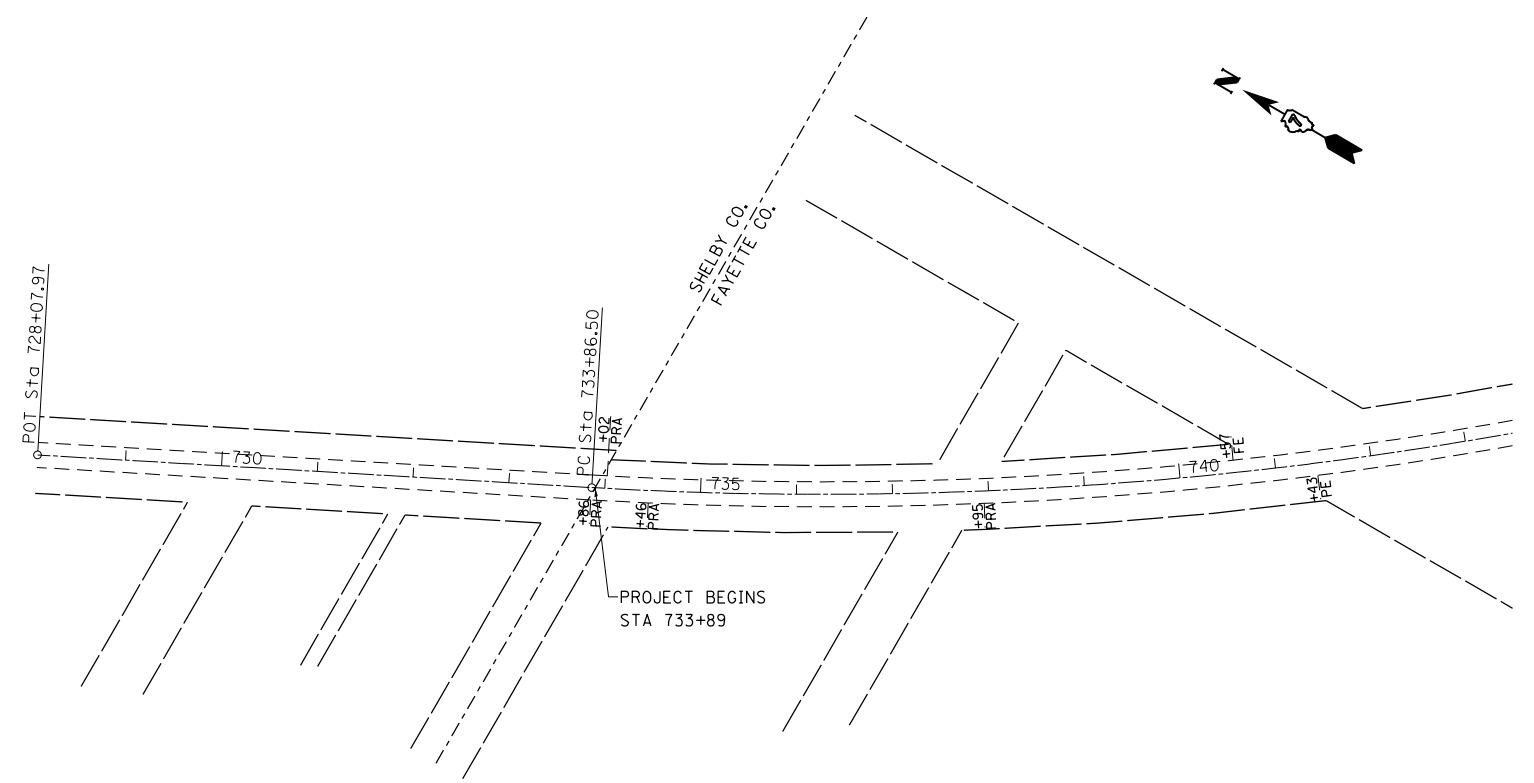

EXIST. CURVE C4
 PI STA. = 745+45.88
 Δ = 31° 38' 59" (LT)
 D = 1° 24' 03"
 R = 4,090.41'
 T = 1,159.38'
 L = 2,259.50'
 E = 161.13'
 e = -----
 T.R. = -----
 S.E. RUN = -----
 P.C. STA. = 733+86.50
 P.T. STA. = 756+46.00

FILE NAME =	USER NAME = steffenmk	DESIGNED -	REVISED -
c:\pw\work\p\dot\stef\enmk\d0121426\074052-shr-plan.dgn		DRAWN -	REVISED -
	PLOT SCALE = 200.0000' / in.	CHECKED -	REVISED -
	PLOT DATE = 6/6/2014	DATE -	REVISED -

**STATE OF ILLINOIS
DEPARTMENT OF TRANSPORTATION**

RESURFACING PLAN SHEET

SCALE: 100 SHEET NO. 1 OF 12 SHEETS STA. 880+00 TO STA. 940+00

F.A.S. RTE.	SECTION	COUNTY	TOTAL SHEETS	SHEET NO.
2801	102RS-3.103RS-2.102N	•	84	24
• Effingham, Fayette			CONTRACT NO. 74052	
ILLINOIS FED. AID PROJECT				