

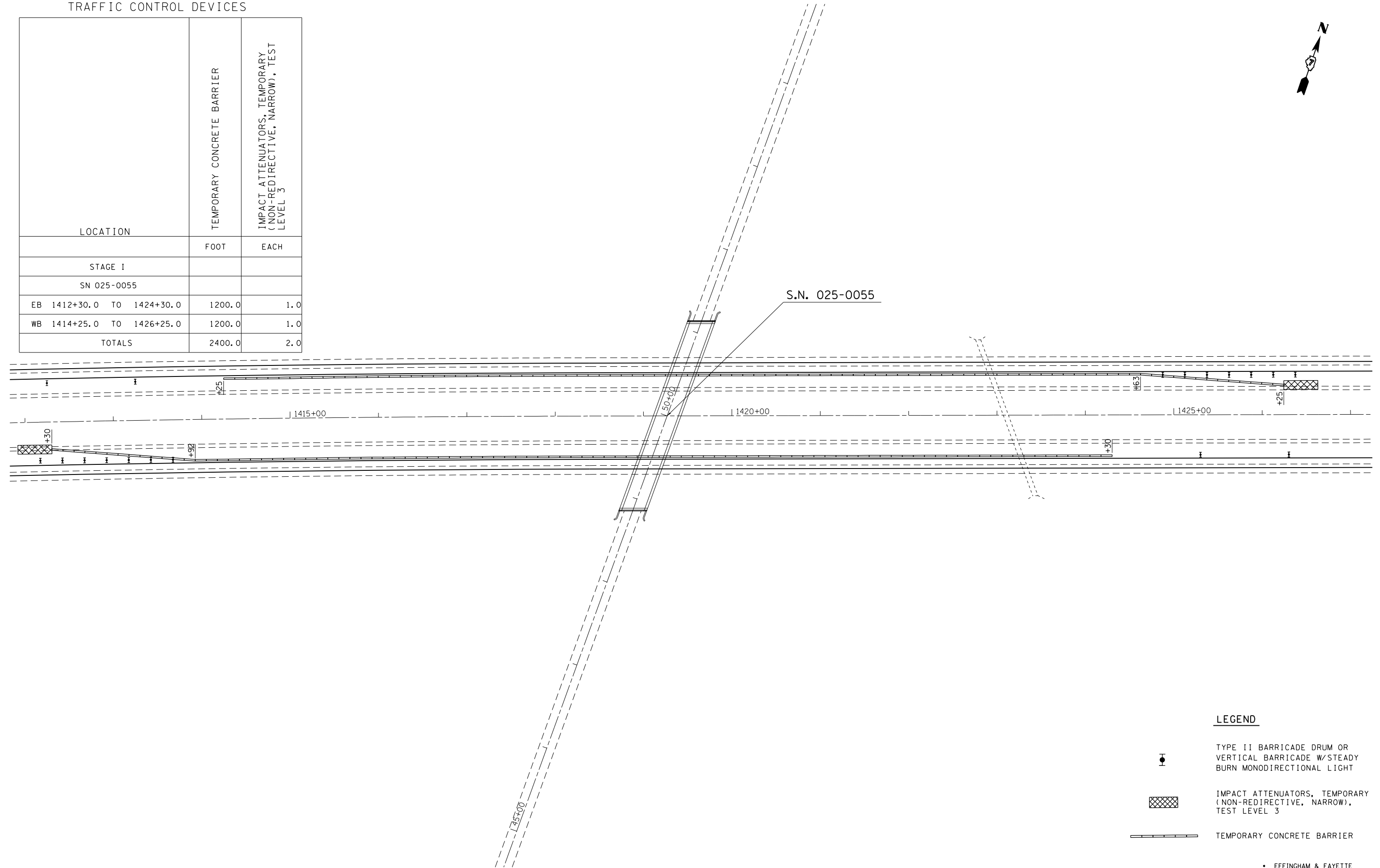



TRAFFIC CONTROL DEVICES

LOCATION	TEMPORARY CONCRETE BARRIER	IMPACT ATTENUATORS, TEMPORARY (NON-REDIRECTIVE, NARROW), TEST LEVEL 3
	FOOT	EACH
STAGE I		
SN 025-0055		
EB 1412+30.0 TO 1424+30.0	1200.0	1.0
WB 1414+25.0 TO 1426+25.0	1200.0	1.0
TOTALS	2400.0	2.0



LEGEND

-  TYPE II BARRICADE DRUM OR VERTICAL BARRICADE W/STEADY BURN MONODIRECTIONAL LIGHT
-  IMPACT ATTENUATORS, TEMPORARY (NON-REDIRECTIVE, NARROW), TEST LEVEL 3
-  TEMPORARY CONCRETE BARRIER

• EFFINGHAM & FAYETTE

FILE NAME =	USER NAME = swartzrw	DESIGNED -	REVISED -	<b>STATE OF ILLINOIS DEPARTMENT OF TRANSPORTATION</b>	<b>STAGE 1 PAVEMENT REMOVAL TRAFFIC CONTROL</b>	F.A.I. RTE.	SECTION	COUNTY	TOTAL SHEETS	SHEET NO.	
ci:\pw\work\p\dot\swartzrw\d0186577\077469-sht-staging.dgn		DRAWN -	REVISED -			70	(26-5,26-5-1,25-1-1)R	•	92	53	
PLOT SCALE = 100.0000' / in.		CHECKED -	REVISED -			CONTRACT NO. 74469					
PLOT DATE = 6/5/2014		DATE -	REVISED -			SCALE: 50	SHEET NO. 5 OF 5 SHEETS	STA. 1412+00 TO STA. 1427+00	ILLINOIS FED. AID PROJECT		