



RELOCATE TEMPORARY CONCRETE BARRIER

47+25 TO 48+12	87.5 FOOT
48+12 TO 51+87	375.0 FOOT
51+87 TO 52+75	87.5 FOOT
TOTAL =	550.0 FOOT

PAVEMENT REMOVAL

48+36 TO 48+60	36.7 SQ YD
51+41 TO 51+63	45.2 SQ YD
TOTAL =	82.0 SQ YD

IMPACT ATTENUATORS, RELOCATE (NON-REDIRECTIVE), TEST LEVEL 2



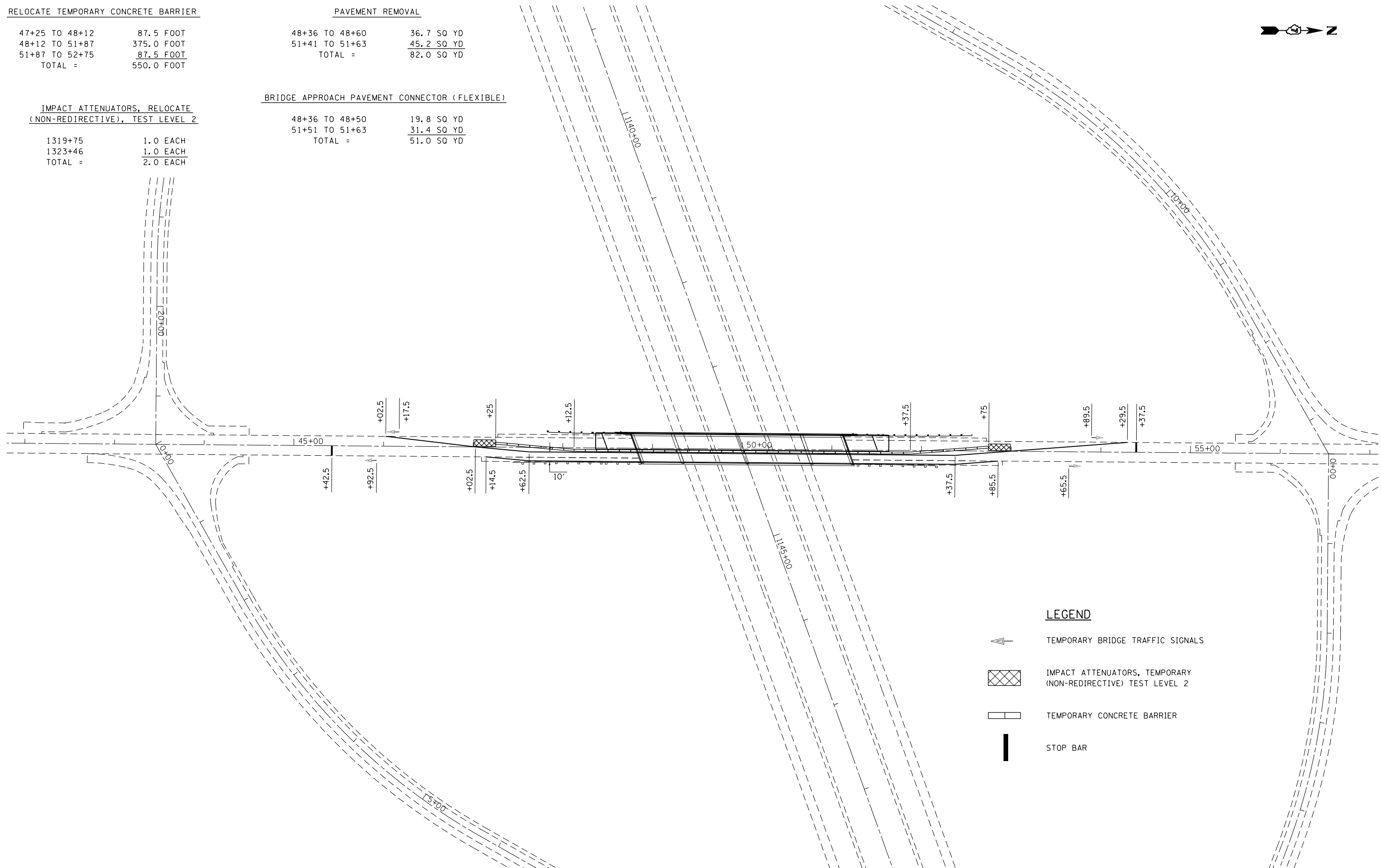

1319+75	1.0 EACH
1323+46	1.0 EACH
TOTAL =	2.0 EACH

BRIDGE APPROACH PAVEMENT CONNECTOR (FLEXIBLE)

48+36 TO 48+50	19.8 SQ YD
51+51 TO 51+63	31.4 SQ YD
TOTAL =	51.0 SQ YD

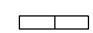

LEGEND

-  TEMPORARY BRIDGE TRAFFIC SIGNALS
-  IMPACT ATTENUATORS, TEMPORARY (NON-REDIRECTIVE) TEST LEVEL 2
-  TEMPORARY CONCRETE BARRIER
-  STOP BAR

EFFINGHAM & FAYETTE

FILE NAME =	USER NAME = swartzrw	DESIGNED -	REVISED -
ei:\pw\work\p\dot\swartzrw\d0186577\077469-sht-staging.dgn		DRAWN -	REVISED -
	PLOT SCALE = 100.0000' / in.	CHECKED -	REVISED -
	PLOT DATE = 6/5/2014	DATE -	REVISED -

STATE OF ILLINOIS
DEPARTMENT OF TRANSPORTATION

STAGE 2 TRAFFIC CONTROL
STRUCTURE NUMBER 026-0055

SCALE: 50 SHEET NO. 2 OF 2 SHEETS STA. 42+00 TO STA. 57+00

F.A.I. RTE.	SECTION	COUNTY	TOTAL SHEETS	SHEET NO.
70	(26-5,26-5-1,25-1-1)R		92	60
CONTRACT NO. 74469			ILLINOIS FED. AID PROJECT	