

**UN053**

REVISIONS		
NUMBER	BY	DATE

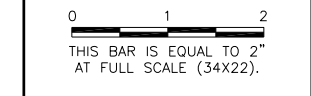

- CONSTRUCTION ACTIVITY PHASE 9 NOTES**
1. WORK LIMITS FOR THIS PHASE SHALL BE ALONG RUNWAY 18/36 AND AT TAXIWAY B1, B2 AND B.
  2. WORK ITEMS TO BE COMPLETED DURING THIS PHASE SHALL INCLUDE: PAVEMENT MARKING REMOVAL, NEW PAVEMENT MARKING, LIGHTING AND SIGNAGE REMOVAL AND ASSOCIATED CABLING AND BARRICADE PLACEMENT.
  3. WORK IN THIS PHASE WILL NOT BE CONSIDERED TO BE PART OF THE CRITICAL PATH.
  4. WORK WITHIN THE RUNWAY 14L/32R RSA SHALL BE DONE DURING THE RUNWAY CLOSURE OF PHASE 1B
  5. WORK WITHIN THE RUNWAY 4/22 RSA SHALL BE DONE DURING THE RUNWAY CLOSURE OF PHASE 4B
  6. ANTICIPATED DURATION OF THIS PHASE IS 20 WORKING DAYS.
  7. BARRICADES ALONG TAXIWAY B SHALL BE PLACED WHERE WORK IS DONE ON THE HARD SURFACE OF TAXIWAY B, OR WITHIN THE TOFA OF TAXIWAY B. ANTICIPATED DIRECTION OF TAXIWAY CLOSURE WILL BE 5 DAYS.
  8. PAVEMENT REMOVAL AND PAVEMENT MARKING CAN BE CONCURRENT WITH OTHER OTHER PHASES PROVIDED THAT RUNWAY CLOSURES DO NOT CAUSE SHUT DOWN OF BOTH 14L/32R AND 4/22.
  9. BARRICADES SHALL NOT BE PLACED UNTILL THE COMPLETION OF PHASE 4.

**CRITICAL POINT TABLE**

POINT	LATITUDE	LONGITUDE	GROUND ELEVATION	ABOVE GROUND	TOP ELEVATION
CP 1	N 040° 01' 48.8161"	W 088° 16' 59.6625"	746.75	25'	771.75
CP 2	N 040° 01' 50.4783"	W 088° 17' 02.1461"	748.01	25'	773.01
CP 3	N 040° 01' 54.6142"	W 088° 16' 57.4619"	747.56	25'	772.56
CP 4	N 040° 02' 02.1605"	W 088° 16' 58.8501"	750.09	25'	775.09
CP 5	N 040° 02' 43.3143"	W 088° 16' 59.4473"	752.81	25'	777.81
CP 6	N 040° 02' 51.0127"	W 088° 16' 58.2240"	749.96	25'	774.96
CP 7	N 040° 02' 48.2154"	W 088° 16' 54.3284"	750.37	25'	775.37
CP 8	N 040° 02' 38.1721"	W 088° 16' 52.9258"	751.13	25'	776.13
CP 9	N 040° 02' 07.8093"	W 088° 16' 52.4576"	749.30	25'	774.30
CP 10	N 040° 02' 02.9289"	W 088° 16' 53.7171"	747.66	25'	772.66
CP 11	N 040° 02' 02.7396"	W 088° 16' 43.8808"	747.68	25'	772.68

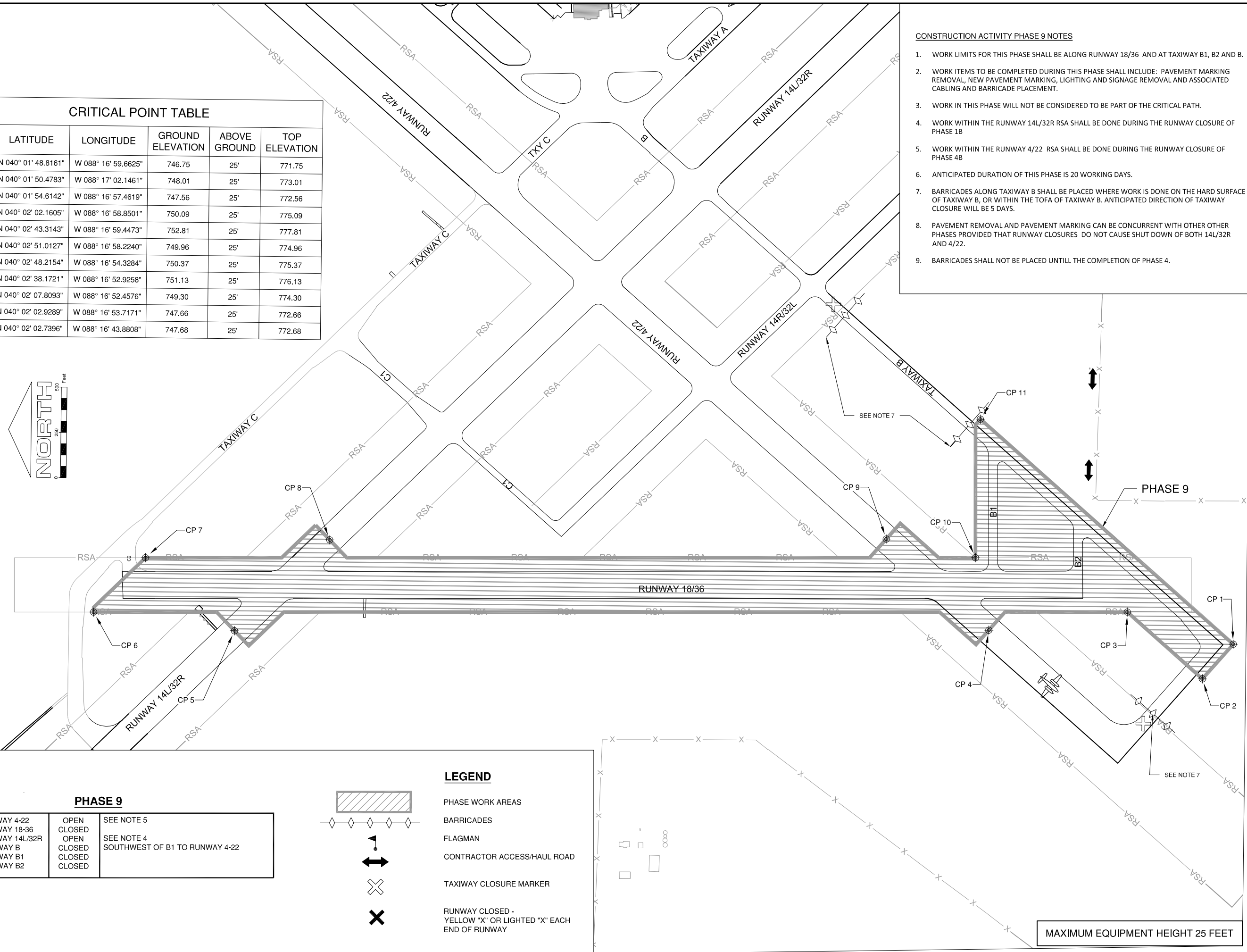
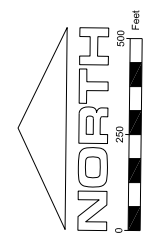

**PHASE 9**

RUNWAY 4-22	OPEN	SEE NOTE 5
RUNWAY 18-36	CLOSED	
RUNWAY 14L/32R	OPEN	SEE NOTE 4
TAXIWAY B	CLOSED	SOUTHWEST OF B1 TO RUNWAY 4-22
TAXIWAY B1	CLOSED	
TAXIWAY B2	CLOSED	

- LEGEND**
- PHASE WORK AREAS
  - BARRICADES
  - FLAGMAN
  - CONTRACTOR ACCESS/HAUL ROAD
  - TAXIWAY CLOSURE MARKER
  - RUNWAY CLOSED - YELLOW "X" OR LIGHTED "X" EACH END OF RUNWAY

MAXIMUM EQUIPMENT HEIGHT 25 FEET

UNIVERSITY OF ILLINOIS  
 WILLARD AIRPORT  
 SAVOY, ILLINOIS

**BASE BID - REALIGN AND WIDEN TAXIWAY C  
 CONSTRUCTION ACTIVITY PLAN - PHASE 9**

**CMT**  
 CRAWFORD, MURPHY & TILLY, INC.  
 CONSULTING ENGINEERS  
 License No. 184-000613

DESIGN BY:	CBG
DRAWN BY:	ADD
CHECKED BY:	CET
APPROVED BY:	CET
DATE:	JUNE 27, 2014
JOB No:	13059-02-00

IL PROJ. NO. CMI-4347  
 AIP PROJ. NO. 3-17-0016-XX