

**KEY MAP**

THIS SHEET

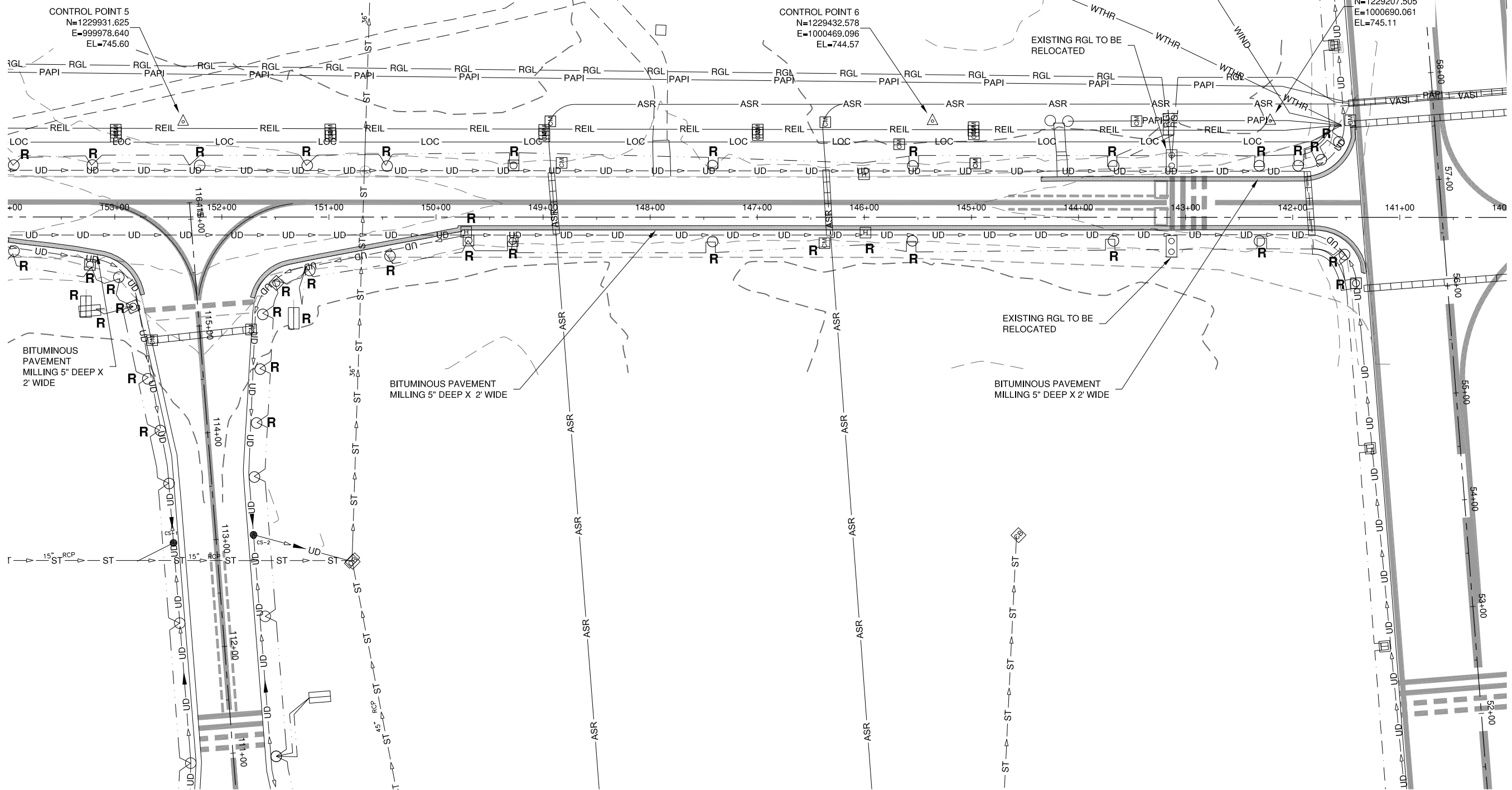

FILE: CMI4347-1305902-CD103.dwg  
 UPDATE BY: Chris Groth  
 PLOT DATE: 7/10/2014 7:06 PM  
 CMI-V-AERL  
 CMI 1305902-V-AF2D  
 CMI 1305902-C-SPAL  
 KEYMAP  
 UTILITY\_CMI  
 CMI PAVEMENT MARKING

**UN053**

REVISIONS		
NUMBER	BY	DATE

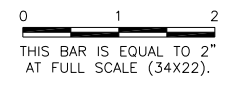

UNIVERSITY OF ILLINOIS  
 WILLARD AIRPORT  
 SAVOY, ILLINOIS

**BASE BID - REALIGN AND WIDEN TAXWAY C  
 EXISTING CONDITIONS AND REMOVALS  
 SHEET 3**

© Copyright CMT, Inc.  
  
**CMT**  
 CRAWFORD, MURPHY & TILLY, INC.  
 CONSULTING ENGINEERS  
 License No. 184-000613

DESIGN BY:	CBG
DRAWN BY:	ADD
CHECKED BY:	CET
APPROVED BY:	CET
DATE:	JUNE 27, 2014
JOB No:	13059-02-00
IL PROJ. NO. CMI-4347 AIP PROJ. NO. 3-17-0016-XX	
SHEET 23 OF 83 SHEETS	

K:\Champsig\p\1305902\Draw\Sheets