

**UN053**

REVISIONS		
NUMBER	BY	DATE

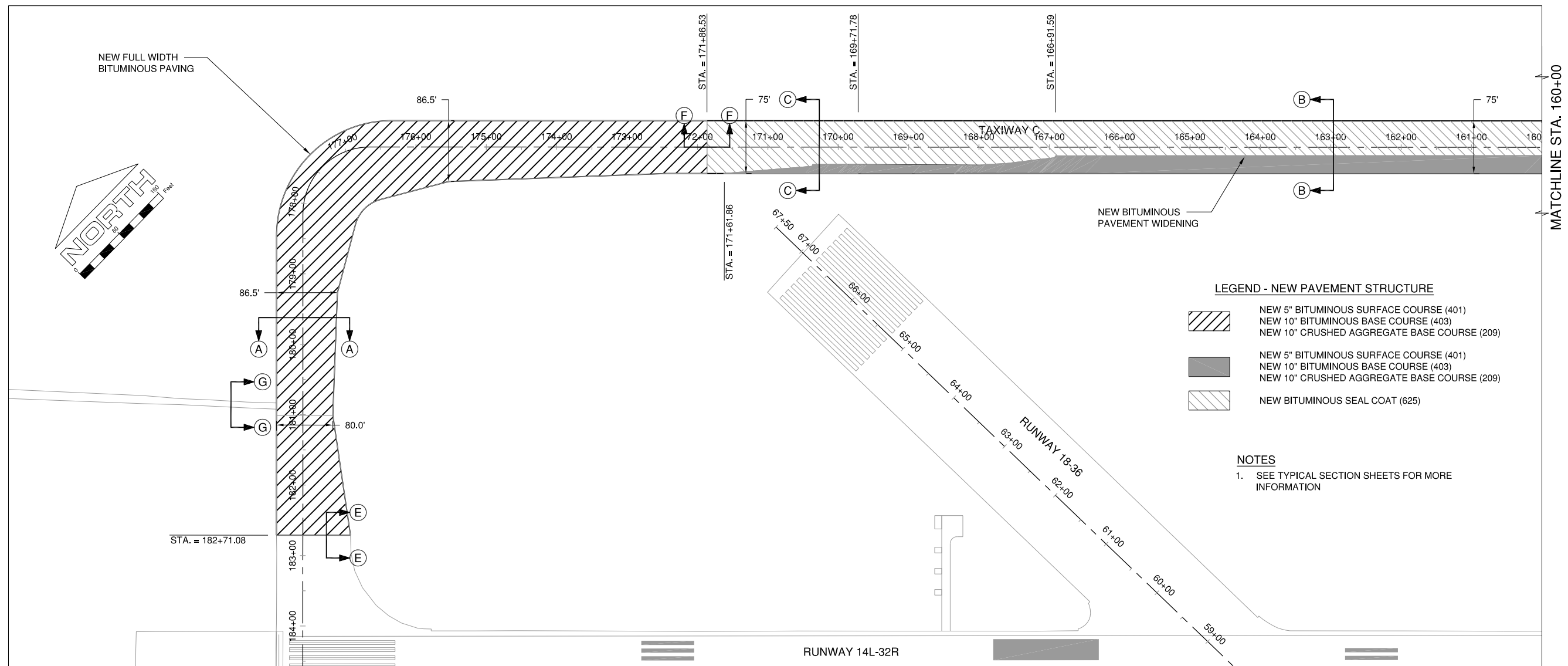
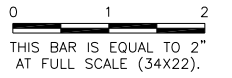

**LEGEND - NEW PAVEMENT STRUCTURE**

- NEW 5" BITUMINOUS SURFACE COURSE (401)  
 NEW 10" BITUMINOUS BASE COURSE (403)  
 NEW 10" CRUSHED AGGREGATE BASE COURSE (209)
- NEW 5" BITUMINOUS SURFACE COURSE (401)  
 NEW 10" BITUMINOUS BASE COURSE (403)  
 NEW 10" CRUSHED AGGREGATE BASE COURSE (209)
- NEW BITUMINOUS SEAL COAT (625)

**NOTES**

1. SEE TYPICAL SECTION SHEETS FOR MORE INFORMATION

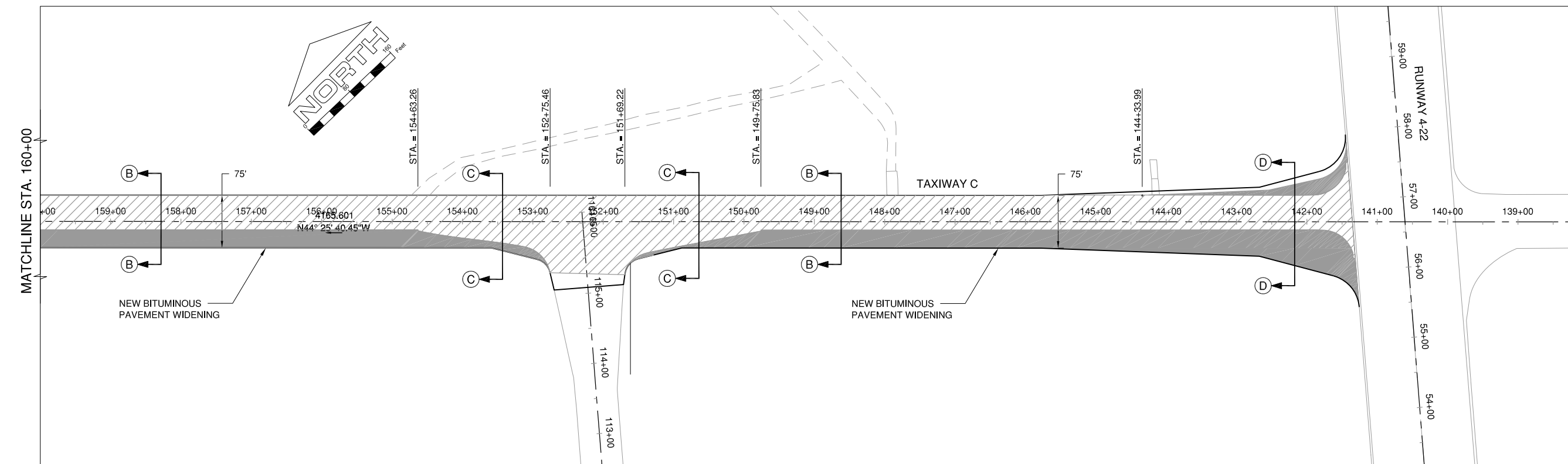

UNIVERSITY OF ILLINOIS  
 WILLARD AIRPORT  
 SAVOY, ILLINOIS

**BASE BID - REALIGN AND WIDEN TAXIWAY C  
 PROPOSED IMPROVEMENTS**

© Copyright CMT, Inc.



DESIGN BY:	CBG
DRAWN BY:	CMT
CHECKED BY:	CET
APPROVED BY:	CET
DATE:	JUNE 27, 2014
JOB No:	13059-02-00

IL PROJ. NO. CMI-4347  
 AIP PROJ. NO. 3-17-0016-XX