

UN053

REVISIONS		
NUMBER	BY	DATE

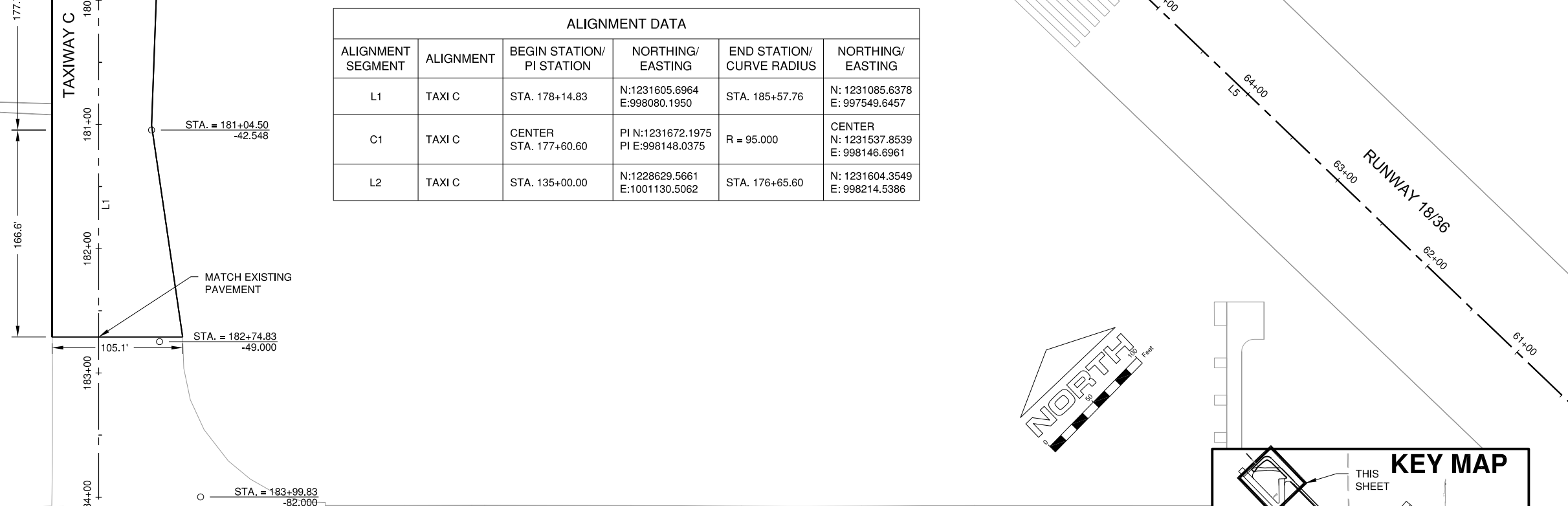
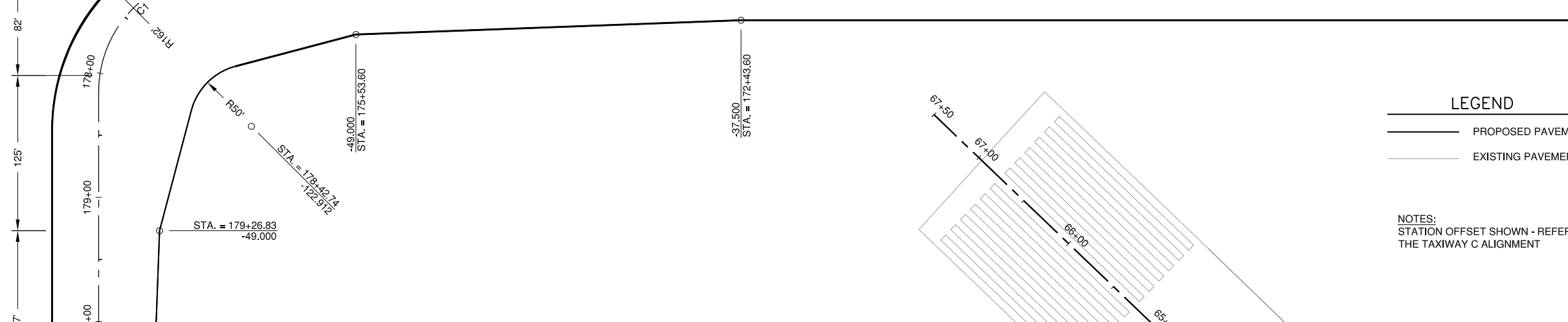
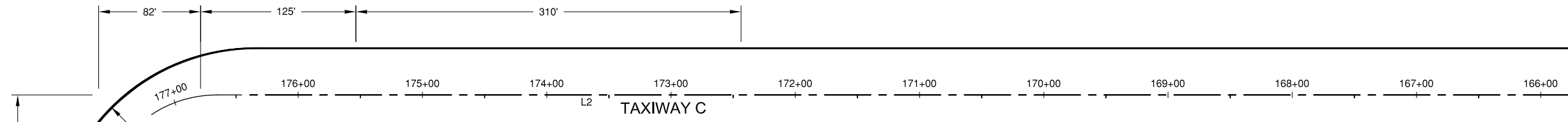
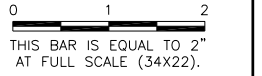

ALIGNMENT DATA					
ALIGNMENT SEGMENT	ALIGNMENT	BEGIN STATION/ PI STATION	NORTHING/ EASTING	END STATION/ CURVE RADIUS	NORTHING/ EASTING
L1	TAXI C	STA. 178+14.83	N:1231605.6964 E:998080.1950	STA. 185+57.76	N: 1231085.6378 E: 997549.6457
C1	TAXI C	CENTER STA. 177+60.60	PI N:1231672.1975 PI E:998148.0375	R = 95.000	CENTER N: 1231537.8539 E: 998146.6961
L2	TAXI C	STA. 135+00.00	N:1228629.5661 E:1001130.5062	STA. 176+65.60	N: 1231604.3549 E: 998214.5386

LEGEND
 ——— PROPOSED PAVEMENT
 - - - - - EXISTING PAVEMENT

NOTES:
 STATION OFFSET SHOWN - REFERENCE
 THE TAXIWAY C ALIGNMENT

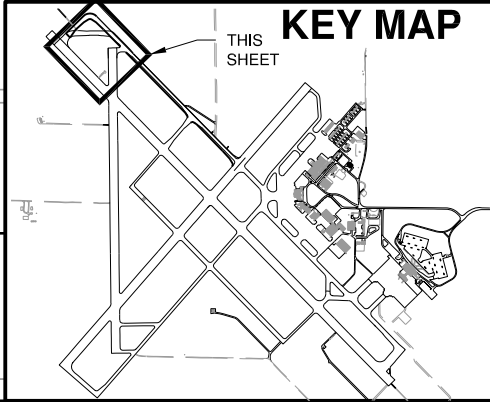
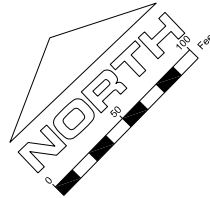
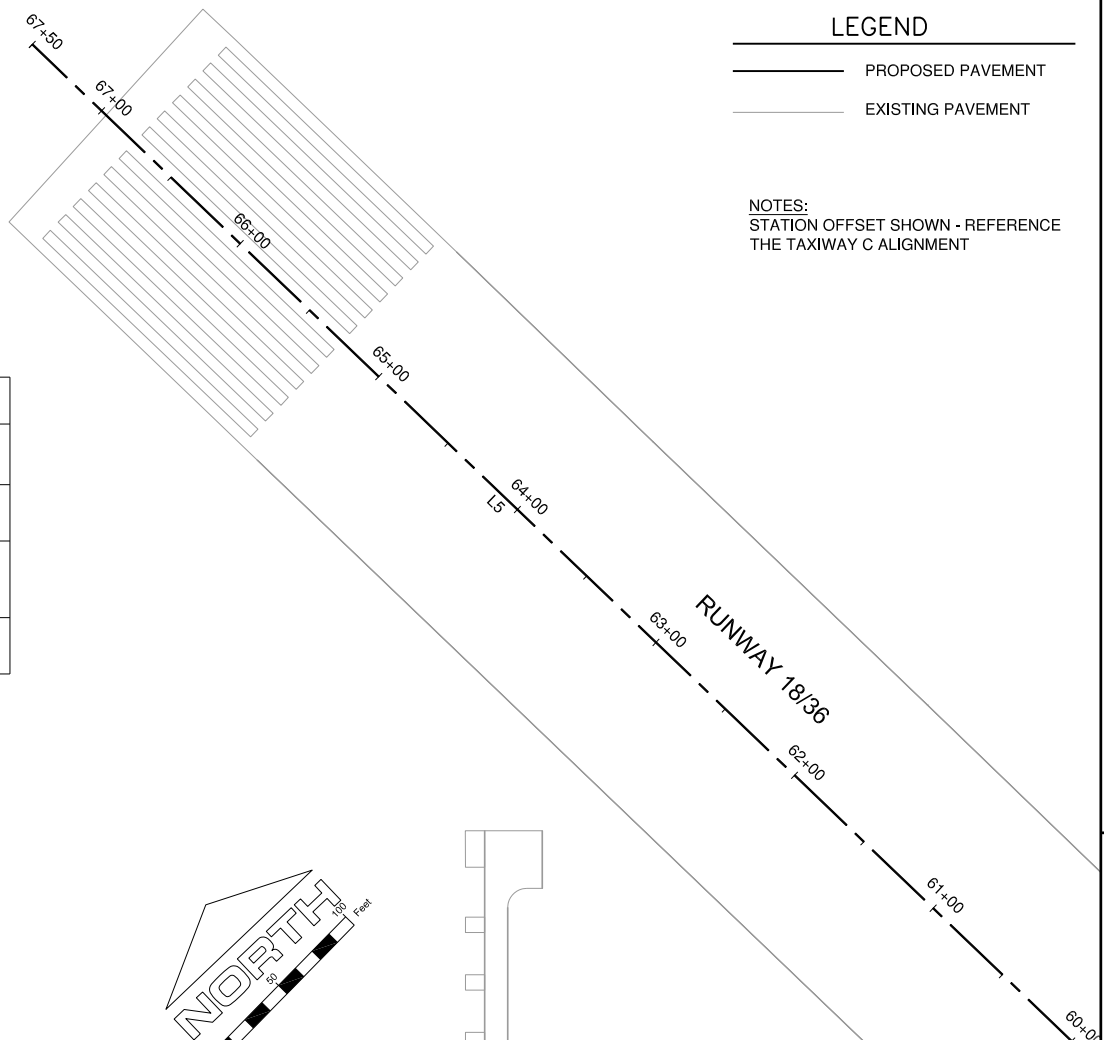

UNIVERSITY OF ILLINOIS
 WILLARD AIRPORT
 SAVOY, ILLINOIS

**BASE BID - REALIGN AND WIDEN TAXIWAY C
 PROPOSED GEOMETRY SHEET 1**

© Copyright CMT, Inc.
CMT
 CRAWFORD, MURPHY & TILLY, INC.
 CONSULTING ENGINEERS
 License No. 184-000613

DESIGN BY:	CBG
DRAWN BY:	CMT
CHECKED BY:	CET
APPROVED BY:	CET
DATE:	JUNE 27, 2014
JOB No:	13059-02-00
IL PROJ. NO.	CMI-4347
AIP PROJ. NO.	3-17-0016-XX
SHEET	27 OF 83 SHEETS