

**UN053**

REVISIONS		
NUMBER	BY	DATE

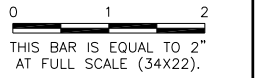

UNIVERSITY OF ILLINOIS  
 WILLARD AIRPORT  
 SAVOY, ILLINOIS

**BASE BID - REALIGN AND WIDEN TAXIWAY C  
 PROPOSED LIGHTING LAYOUT 1**

© Copyright CMT, Inc.

**CMT**  
 CRAWFORD, MURPHY & TILLY, INC.  
 CONSULTING ENGINEERS  
 License No. 184-000613



DESIGN BY:	CBG
DRAWN BY:	ADD
CHECKED BY:	CET
APPROVED BY:	CET
DATE:	JUNE 27, 2014
JOB No:	13059-02-00
IL PROJ. NO.	CMI-4347
AIP PROJ. NO.	3-17-0016-XX
SHEET	40 OF 83 SHEETS

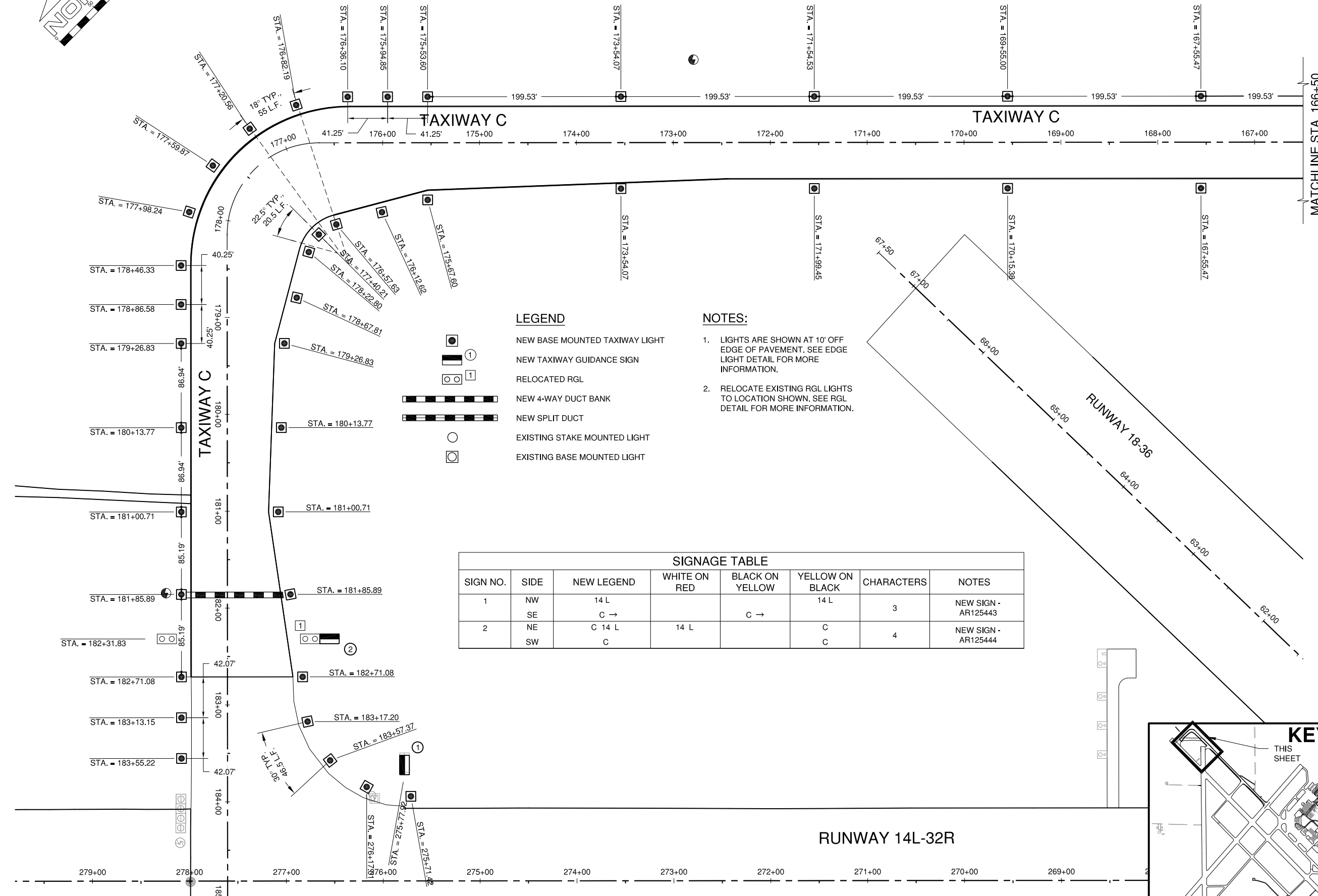
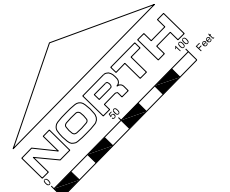

**LEGEND**

	NEW BASE MOUNTED TAXIWAY LIGHT
	NEW TAXIWAY GUIDANCE SIGN
	RELOCATED RGL
	NEW 4-WAY DUCT BANK
	NEW SPLIT DUCT
	EXISTING STAKE MOUNTED LIGHT
	EXISTING BASE MOUNTED LIGHT

- NOTES:**
- LIGHTS ARE SHOWN AT 10' OFF EDGE OF PAVEMENT. SEE EDGE LIGHT DETAIL FOR MORE INFORMATION.
  - RELOCATE EXISTING RGL LIGHTS TO LOCATION SHOWN. SEE RGL DETAIL FOR MORE INFORMATION.

**SIGNAGE TABLE**

SIGN NO.	SIDE	NEW LEGEND	WHITE ON RED	BLACK ON YELLOW	YELLOW ON BLACK	CHARACTERS	NOTES
1	NW SE	14 L C →			14 L C →	3	NEW SIGN - AR125443
2	NE SW	C 14 L C	14 L		C C	4	NEW SIGN - AR125444

