

FOR INDEX OF SHEETS, SEE SHEET NO. 2

TRAFFIC DATA

MADISON COUNTY LINE TO OHIO ST.

2023 ADT = 13500 (ACTUAL)  
2026 ADT = 13700 (ESTMATED)  
2046 ADT = 15100 (ESTIMATED)  
SU = 4.4% MU = 2.8%

OHIO ST. TO EBWB I-55

2023 ADT = 17200 (ACTUAL)  
2026 ADT = 17500 (ESTMATED)  
2046 ADT = 19300 (ESTIMATED)  
SU = 8.7% MU = 11.9%

EBWB I-55 TO COLLINSVILLE RD

2023 ADT = 3500 (ACTUAL)  
2026 ADT = 3600 (ESTMATED)  
2046 ADT = 3900 (ESTIMATED)  
SU = 10.7% MU = 5.1%

INTERSECTION OMISSION

N.B. STA. 137 + 20.00 TO 142 + 38.00  
S.B. STA. 136 + 54.00 TO 138 + 30.

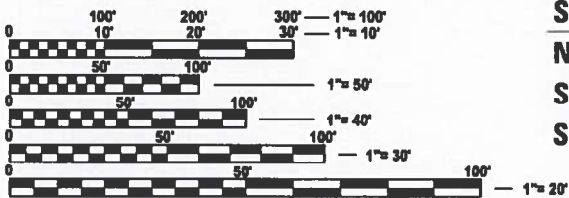

FULL SIZE PLANS HAVE BEEN PREPARED USING STANDARD ENGINEERING SCALES. REDUCED SIZED PLANS WILL NOT CONFORM TO STANDARD SCALES. IN MAKING MEASUREMENTS ON REDUCED PLANS, THE ABOVE SCALES MAY BE USED.

J.U.L.I.E.  
JOINT UTILITY LOCATION INFORMATION FOR EXCAVATION  
1-800-892-0123  
OR 811

PROJECT ENGINEER: CHERYL KEPLAR  
PROJECT MANAGER: BRANDON HUMPHREYS

CONTRACT NO. 76M55

STATE OF ILLINOIS  
DEPARTMENT OF TRANSPORTATION

PROPOSED  
HIGHWAY PLANS

FAP/FAU ROUTE 594/9213 (IL 203)  
SECTION (580,581)RS-2  
PROJECT NHPP-D5M6(311)  
DESIGNED OVERLAY - ADA  
ST. CLAIR COUNTY

C-98-088-19

END PROJECT  
MADISON COUNTY LINE  
STA. 168 + 35.50  
LAT: 38.65996  
LONG: -90.13759

PROJECT OMISSION  
S.B. IL 203  
STA. 144 + 46.00 TO  
STA. 157 + 06.00

STATION EQUATION  
N.B. IL 203  
STA. 142 + 49.76 (BK) =  
STA. 140 + 00.50 (AH)

STATION EQUATION  
S.B. IL 203  
STA. 38 + 10.00 (BK) =  
STA. 129 + 00.00 (AH)

BRIDGE OMISSION  
S.N. 082-0029  
STA. 5 + 50.00 TO  
STA. 7 + 73.00

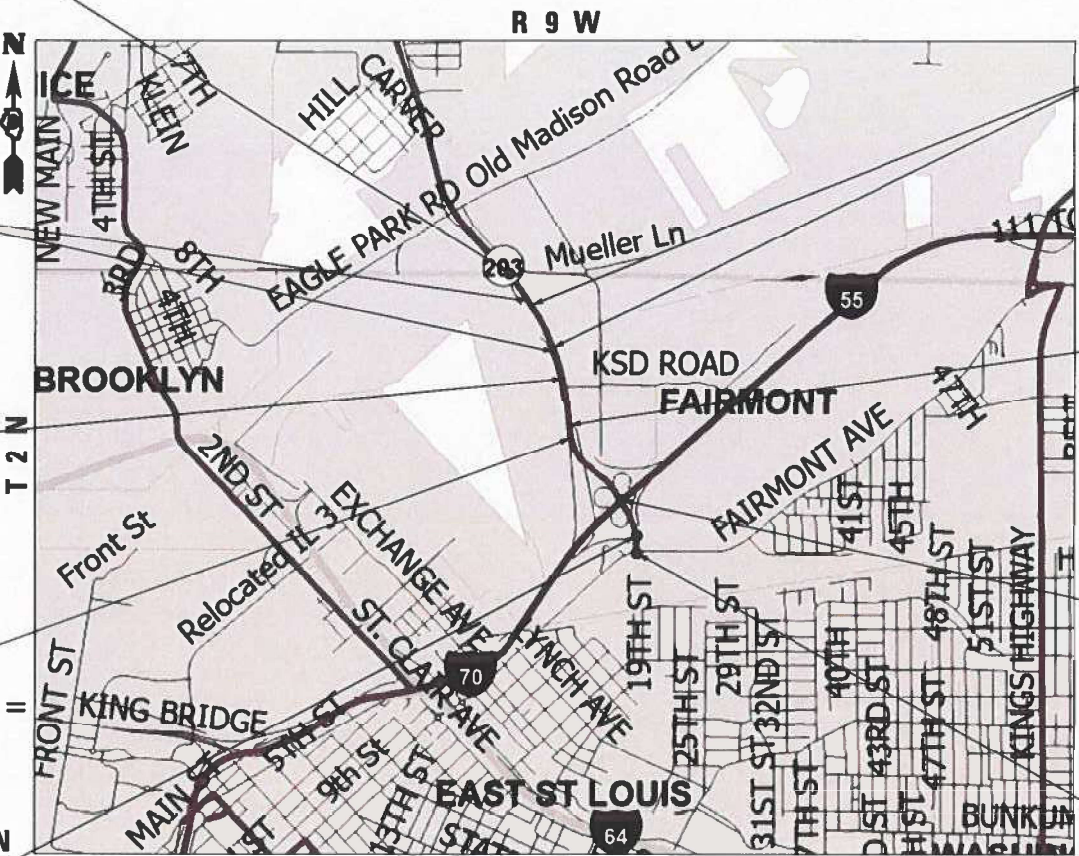

GROSS LENGTH = 7307.76 FT. = 1.38 MILE  
NET LENGTH = 4908.76 FT. = 0.93 MILE

PROJECT OMISSION  
N.B. IL 203  
STA. 145 + 75.50 TO  
STA. 157 + 45.50

STATION EQUATION  
N.B. IL 203  
STA. 35 + 86.00 (BK) =  
STA. 131 + 55.00 (AH)

BRIDGE OMISSION  
S.N. 082-0028  
STA. 13 + 35.00 TO  
STA. 16 + 74.00

BEGIN PROJECT  
COLLINSVILLE RD  
STA. 2 + 08.00  
LAT: 38.64191  
LONG: -90.12711

| F.A. RTE.          | SECTION       | COUNTY    | TOTAL SHEETS       | SHEET NO. |
|--------------------|---------------|-----------|--------------------|-----------|
| * FAP 594/FAU 9213 | (580,581)RS-2 | ST. CLAIR | 44*                | 1         |
| ILLINOIS           |               |           | CONTRACT NO. 76M55 |           |

\* 44 + 7 = 51 TOTAL SHEETS

D-98-069-19

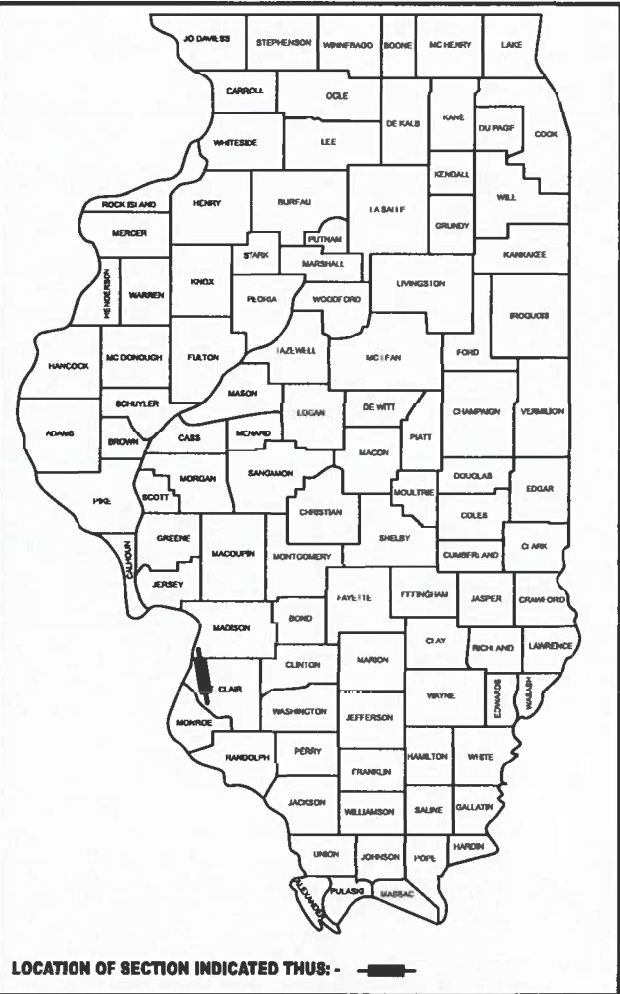

FUNCTIONAL CLASSIFICATION  
OTHER PRINCIPAL ARTERIAL

STATE OF ILLINOIS  
DEPARTMENT OF TRANSPORTATION

SUBMITTED May 9 2025 the REGIONAL ENGINEER

June 27 2025 See Ed etc ENGINEER OF DESIGN AND ENVIRONMENT

June 27 2025 Garvey 5 DIRECTOR OF HIGHWAYS PROJECT IMPLEMENTATION

PRINTED BY THE AUTHORITY  
OF THE STATE OF ILLINOIS



INDEX OF SHEETS

|         |  |
|---------|--|
| 1       | COVER SHEET  |
| 2       | INDEX OF SHEETS, HIGHWAY STANDARDS, GENERAL NOTES, MIXTURE REQUIREMENT AND COMMITMENTS |
| 3-7     | SUMMARY OF QUANTITIES  |
| 8-18    | TYPICAL SECTIONS   |
| 19-29A  | SCHEDULE OF QUANTITIES   |
| 30      | REMOVAL PLAN   |
| 31      | INTERSECTION DETAILS IL 203 @ COLLINSVILLE RD.   |
| 32-32C  | INTERSECTION DETAILS IL 203 @ OHIO ST.   |
| 32D-32G | TRAFFIC SIGNAL PLANS   |
| 33-35   | PAVEMENT MARKING   |
| 36-38   | GUARDRAIL PLANS  |
| 39-41   | DETECTOR LOOP  |
| 42-43   | DETAIL   |
| 44      | LOCATION MAP   |

GENERAL NOTES

1. UTILITIES KNOWN TO HAVE FACILITIES WITHIN THE PROJECT AREA:  

AMEREN ILLINOIS  
AT&T ILLINOIS  
CHARTER COMMUNICATIONS, INC.  
ILLINOIS AMERICAN WATER COMPANY  
VERIZON BUSINESS  
METRO EAST SANITARY DISTRICT  
ZAYO GROUP LLC
2. THE PROPOSED PAVEMENT MARKING SHALL MATCH THE LOCATIONS OF THE EXISTING PAVEMENT MARKING, AS DIRECTED BY THE ENGINEER.
3. FOUR CHANGEABLE MESSAGE SIGNS SHALL BE REQUIRED FOR THIS PROJECT. THEY SHALL BE PLACED TWO WEEKS PRIOR TO ANY LANE CLOSURE AND SHALL REMAIN UP FOR THE DURATION OF THE PROJECT. THE CHANGEABLE MESSAGE SIGNS SHALL BE PLACED ALONG IL 203 OR AT THE DIRECTION OF THE ENGINEER.
4. THE CONTRACTOR SHALL PROVIDE POSITIVE AND ADEQUATE DRAINAGE AT ALL TIMES.
5. THE DEPARTMENT STRONGLY ENCOURAGES THE PRIME CONTRACTOR AND THEIR APPROVED SUB-CONTRACTORS TO HIRE MINORITY, WOMEN AND DISADVANTAGED INDIVIDUALS FROM ITS FEDERALLY FUNDED HIGHWAY CONSTRUCTION CAREERS TRAINING PROGRAM (HCCTP) TO HELP MEET WORKFORCE AND TRAINEE GOALS. THIS PROGRAM IS TRAINING MINORITIES, WOMEN AND DISADVANTAGED INDIVIDUALS IN HIGHWAY CONSTRUCTION-RELATED SKILLS, E.G., MATH FOR THE TRADES, JOB READINESS, TECHNICAL SKILLS COURSEWORK (CARPENTRY, CONCRETE FLATWORK, BLUEPRINT READING, SITE PLANS, SITE WORK, TOOLS USE, ETC.) AND OSHA 10 HOUR CERTIFICATION, TO PREPARE THEM FOR A CAREER IN THE HIGHWAY CONSTRUCTION TRADES. GRADUATES ARE WELL-TRAINED AND READY TO BECOME PRODUCTIVE ENTRY-LEVEL CONSTRUCTION WORKERS. CONTACT THE DISTRICT 8 EEO OFFICE AT 618-346-3360 AND/OR THE HCCTP COORDINATOR AT 618-874-6528 TO LEARN MORE ABOUT THE PROGRAM AND FOR ASSISTANCE IN MEETING WORKFORCE AND TRAINEE GOALS.
6. THE INTENT OF THE MILLING IS TO REMOVE THE HMA RESURFACING ONLY. THE UNDERLYING CONCRETE PAVEMENT SHALL NOT BE DISTURBED.
7. THE CONTRACTOR SHOULD BE ADVISED THAT IDOT CONTRACT 76T17 (BRIDGE REPLACEMENT, INTERSECTION RECONSTRUCTION ON IL 203) WILL BE UNDER CONSTRUCTION AT OR AROUND THE TIME OF LETTING OF THIS PROJECT. ALL WORK DONE ON CONTRACT 76T17 IS BEING OMITTED FROM THIS PROJECT.
8. ONLY SHORT TERM PAVEMENT MARKING REMOVAL FROM THE FINAL SURFACE SHALL BE PAID FOR AS "SHORT TERM PAVEMENT MARKING REMOVAL."
9. ALL REMOVED GUADRAIL COMPONENTS ARE THE PROPERTY OF THE CONTRACTOR, AND THE SALVAGE VALUE OF SAID COMPONENTS SHALL BE REFLECTED IN THE CONTRACTOR'S BID.
10. THE TEMPORARY RAMPs USED ON ALL SIDE STREETS AND ENTRANCES SHALL BE 3 FEET IN LENGTH SO AS NOT TO INTERFERE WITH THE THRU TRAFFIC LANES.
11. ALL PATCHING ON THIS PROJECT SHALL BE COMPLETED PRIOR TO BITUMINOUS SURFACE REMOVAL.
12. ALL CURB, CURB AND GUTTER, AND MEDIAN REPLACEMENT SHALL BE COMPLETED PRIOR TO THE HMA SURFACE BEING PLACED.
13. THE CONTRACTOR SHALL PROVIDE POSITIVE AND ADEQUATE DRAINAGE AT ALL TIMES.
14. TRAFFIC SHALL NOT BE ALLOWED ON MILLED SURFACE, EXCEPT TO CROSS AT SIDE ROADS. BINDER MUST BE PLACED PRIOR TO ALLOWING TRAFFIC TO UTILIZE THE LANE.
15. BASED ON STRUCTURAL ANALYSIS CONDUCTED BY IDOT, THE FOLLOWING STRUCTURES CAN BE CROSSED WITH AN EMPTY MTD WITH THE FOLLOWING MAXIMUM GROSS WEIGHT RESTRICTION:

• 082-0026 (40 TONS)

• 082-0027 (40 TONS)

• 082-0028 (40 TONS)

• 082-0029 (40 TONS)

IF THE SAME MTD IS USED THROUGHOUT THE ENTIRE CONTRACT, THEN IT MUST BE LIMITED TO AN EMPTY GROSS WEIGHT ≤ 40 TONS

HIGHWAY STANDARDS

|           |   |
|-----------|---|
| 000001-08 | STANDARD SYMBOLS, ABBREVIATION AND PATTERNS                                   |
| 001006    | DECIMAL OF AN INCH AND OF A FOOT  |
| 420001-10 | PAVEMENT JOINTS   |
| 420701-03 | PAVEMENT WELDED WIRE REINFORCEMENT  |
| 424001-12 | PERPENDICULAR CURB RAMPs FOR SIDEWALKS  |
| 424006-06 | DIAGONAL CURB RAMPs FOR SIDEWALKS   |
| 424031-03 | MEDIAN PEDESTRIAN CROSSINGS   |
| 442101-09 | CLASS B PATCHES   |
| 606301-04 | PC CONCRETE ISLANDS AND MEDIAN  |
| 630001-13 | STEEL PLATE BEAM GUARDRAIL  |
| 630301-09 | SHOULDER WIDENING FOR TYPE 1 (SPECIAL) GUARDRAIL TERMINALS                    |
| 631011-10 | TRAFFIC BARRIER TERMINAL, TYPE 2  |
| 631026-06 | TRAFFIC BARRIER TERMINAL, TYPE 5  |
| 631031-18 | TRAFFIC BARRIER TERMINAL, TYPE 6  |
| 631033-09 | TRAFFIC BARRIER TERMINAL, TYPE 6B   |
| 701101-05 | OFF-ROAD OPERATIONS, MULTILANE, 15' TO 24' FROM PAVEMENT EDGE                 |
| 701301-04 | LANE CLOSURE, 2L, 2W, SHORT TIME OPERATIONS                                   |
| 701311-03 | LANE CLOSURE, 2L, 2W MOVING OPERATIONS - DAY ONLY                             |
| 701411-09 | LANE CLOSURE, MULTILANE, AT ENTRANCE OR EXIT RAMP, FOR SPEEDS ≥ 45MPH         |
| 701421-08 | LANE CLOSURE, MULTILANE, DAY OPERARTIONS ONLY, FOR SPEEDS ≥ 45 MPH TO 55 MPH  |
| 701422-10 | LANE CLOSURE, MULTILANE, FOR SPEEDS ≥ 45 MPH TO 55 MPH                        |
| 701426-09 | LANE CLOSURE, MULTILANE, INTERMITTENT OR MOVING OPERATIONS FOR SPEED ≥ 45 MPH |
| 701456-05 | PARTIAL EXIT RAMP CLOSURE, FREEWAY/EXPRESSWAY                                 |
| 701606-10 | URBAN SINGLE LANE CLOSURE, MULTILANE, 2W WITH MOUNTABLE MEDIAN                |
| 701611-01 | URBAN HALF ROAD CLOSURE, MULTILANE, 2W WITH MOUNTABLE MEDIAN                  |
| 701701-10 | URBAN LANE CLOSURE, MULTILANE INTERSECTION                                    |
| 701801-06 | SIDEWALK, CORNER OR CROSSWALK CLOSURE   |
| 701901-10 | TRAFFIC CONTROL DEVICES   |
| 720001-01 | SIGN PANEL MOUNTING DETAILS   |
| 725001-01 | OBJECT AND TERMINAL MARKERS   |
| 780001-05 | TYPICAL PAVEMENT MARKINGS   |
| 781001-04 | TYPICAL APPLICATIONS RAISED REFLECTIVE PAVEMENT MARKERS                       |
| 782001-01 | CURB REFLECTORS   |
| 782006-01 | GUARDRAIL AND BARRIER WALL REFLECTOR MOUNTING DETAILS                         |
| 814006-03 | DOUBLE HANDHOLES  |
| 857001-01 | STANDARD PHASE DESIGNATION DIAGRAMS - PHASE SEQUENCE                          |
| 873001-02 | TRAFFIC SIGNAL GROUNDING & BONDING  |
| 876001-04 | PEDESTRIAN PUSH BUTTON POST   |
| 877001-08 | STEEL MAST ARM ASSEMBLY AND POLE 16' THROUGH 55'                              |
| 878001-11 | CONCRETE FOUNDATION DETAILS   |
| 880006-01 | TRAFFIC SIGNAL MOUNTING DETAILS   |
| 886001-01 | DETECTOR LOOP INSTALLATIONS   |
| 886006-01 | TYPICAL LAYOUT FOR DETECTOR LOOPS   |

COMMITMENTS

NONE

MIXTURE REQUIREMENTS

| MIXTURE REQUIREMENTS        |                |                |                  |                    |
|-----------------------------|----------------|----------------|------------------|--------------------|
|                             |                |                |                  |                    |
| MIXTURE USE                 | POLY SURFACE   | BINDER         | SHOULDER (lower) | SHOULDER (surface) |
| AC/PG                       | SBS PG 70-28   | PG 64-22       | PG 64-22         | PG 64-22           |
| DESIGN AIR VOIDS            | 4.0% @ Ndes=90 | 4.0% @ Ndes=90 | 4.0% @ Ndes=30   | 4.0% @ Ndes=30     |
| MIX COMPOSITION (GRADATION) | IL 9.5         | IL 19.0        | IL 19.0L         | IL 9.5L            |
| FRICTION AGG                | MIXTURE "D"    | MIXTURE "B"    |                  |                    |
| QUALITY MGMT PROGRAM        | QCP            | QCP            | QC/QA            | QC/QA              |
| MatTranDev Required?        | YES            | YES            | NO               | NO                 |
|                             |                |                |                  |                    |
| TURN LANES < 500 FEET       |                |                |                  |                    |
| MIXTURE USE                 | POLY SURFACE   | BINDER         |                  |                    |
| AC/PG                       | SBS PG 70-28   | PG 64-22       |                  |                    |
| DESIGN AIR VOIDS            | 4.0% @ Ndes=90 | 4.0% @ Ndes=90 |                  |                    |
| MIX COMPOSITION (GRADATION) | IL 9.5         | IL 19.0        |                  |                    |
| FRICTION AGG                | MIXTURE "D"    | MIXTURE "B"    |                  |                    |
| QUALITY MGMT PROGRAM        | QC/QA          | QC/QA          |                  |                    |
| MatTranDev Required?        | NO             | NO             |                  |                    |

 REVISED SHEET 7-21-2025

STATE OF ILLINOIS  
DEPARTMENT OF TRANSPORTATION

INDEX OF SHEETS, HIGHWAY STANDARDS,  
GENERAL NOTES, COMMITMENTS AND MIXTURE REQUIREMENT

SCALE: NTS    SHEET 1    OF   1    SHEETS    STA.    TO STA.

| F.A.* RTE.         | SECTION       | COUNTY             | TOTAL SHEETS     | SHEET NO. |
|--------------------|---------------|--------------------|------------------|-----------|
| *                  | (580,581)RS-2 | ST. CLAIR          | 46               | 2         |
| * FAP 594/FAU 9213 |               | CONTRACT NO. 76M55 |                  |           |
|                    |               | ILLINOIS           | FED. AID PROJECT |           |

MODEL: Gen Notes (Sheet)  
FILE NAME: c:\paw\_work\pawdot\illinois.gov\edison.zohfonyl@illinois.gov\1086652D76M55-shh-gennote.dgn

|  |                             |            |           |
|--|-----------------------------|------------|-----------|
|  | USER NAME = edison.zohfonyl | DESIGNED - | REVISED - |
|  |                             | DRAWN -    | REVISED - |
|  |                             | CHECKED -  | REVISED - |
|  | PLOT DATE = 7/16/2025       | DATE -     | REVISED - |



MODEL: SQQ-1 [Sheet]  
FILE NAME: c:\paw\work\paw\illinois.gov\id106652D76M55-sht-SQQ.dgn

| CODE NO. | ITEM   | UNIT  | TOTAL QUANTITY | CONSTRUCTION CODE    |               |
|----------|--|-------|----------------|----------------------|---------------|
|          |  |       |                | 80% FED<br>20% STATE |               |
|          |  |       |                | ROADWAY              | SAFETY        |
|          |  |       |                | 0005<br>URBAN        | 0021<br>URBAN |
| 31101200 | SUBBASE GRANULAR MATERIAL, TYPE B 4"                             | SQ YD | 376            | 376                  |               |
| 40600290 | BITUMINOUS MATERIALS (TACK COAT)                                 | POUND | 29559          | 29559                |               |
| 40600370 | LONGITUDINAL JOINT SEALANT                                       | FOOT  | 11428          | 11428                |               |
| 40600405 | MATERIAL TRANSFER DEVICE   | TON   | 6314           | 6314                 |               |
| 40600982 | HOT-MIX ASPHALT SURFACE REMOVAL - BUTT JOINT                     | SQ YD | 5106           | 5106                 |               |
| 40600990 | TEMPORARY RAMP   | SQ YD | 1444           | 1444                 |               |
| 40603090 | HOT-MIX ASPHALT BINDER COURSE, IL-19.0, N90                      | TON   | 4073           | 4073                 |               |
| 40604164 | POLYMERIZED HOT-MIX ASPHALT SURFACE COURSE, IL-9.5, MIX "D", N90 | TON   | 2715           | 2715                 |               |
| 42400100 | PORTLAND CEMENT CONCRETE SIDEWALK 4 INCH                         | SQ FT | 1529           | 1529                 |               |
| 42400800 | DETECTABLE WARNINGS  | SQ FT | 113            | 113                  |               |
| 44000100 | PAVEMENT REMOVAL   | SQ YD | 378            | 378                  |               |
| 44000158 | HOT-MIX ASPHALT SURFACE REMOVAL, 2 1/4"                          | SQ YD | 46635          | 46635                |               |
| 44000500 | COMBINATION CURB AND GUTTER REMOVAL                              | FOOT  | 2605           | 2605                 |               |
| 44000600 | SIDEWALK REMOVAL   | SQ FT | 2567           | 2567                 |               |

| CODE NO. | ITEM  | UNIT  | TOTAL QUANTITY | CONSTRUCTION CODE    |               |
|----------|---|-------|----------------|----------------------|---------------|
|          |   |       |                | 80% FED<br>20% STATE |               |
|          |   |       |                | ROADWAY              | SAFETY        |
|          |   |       |                | 0005<br>URBAN        | 0021<br>URBAN |
| 44001980 | CONCRETE BARRIER REMOVAL                          | FOOT  | 186            | 186                  |               |
| 44003100 | MEDIAN REMOVAL                                    | SQ FT | 1389           | 1389                 |               |
| 44200050 | WELDED WIRE REINFORCEMENT                         | SQ YD | 4368           | 4368                 |               |
| 44201007 | CLASS B PATCHES, TYPE II, 13 INCH                 | SQ YD | 644            | 644                  |               |
| 44201011 | CLASS B PATCHES, TYPE III, 13 INCH                | SQ YD | 154            | 154                  |               |
| 44201013 | CLASS B PATCHES, TYPE IV, 13 INCH                 | SQ YD | 4368           | 4368                 |               |
| 44201299 | DOWEL BARS 1 1/2"                                 | EACH  | 1972           | 1972                 |               |
| 44213200 | SAW CUTS  | FOOT  | 7244           | 7244                 |               |
| 44213204 | TIE BARS 3/4"                                     | EACH  | 575            | 575                  |               |
| 48102100 | AGGREGATE WEDGE SHOULDER, TYPE B                  | TON   | 776            | 776                  |               |
| 48203100 | HOT-MIX ASPHALT SHOULDERS                         | TON   | 2857           | 2857                 |               |
| 60605000 | COMBINATION CONCRETE CURB AND GUTTER, TYPE B-6.24 | FOOT  | 422            | 422                  |               |
| 60608600 | COMBINATION CONCRETE CURB AND GUTTER, TYPE M-6.06 | FOOT  | 2468           | 2468                 |               |
| 60610400 | COMBINATION CONCRETE CURB AND GUTTER, TYPE M-6.24 | FOOT  | 86             | 86                   |               |

THE FOLLOWING PAY ITEMS HAVE BEEN DELETED FROM THIS PAGE:  
20101400      20101500  
20101600      25000210

 REVISED SHEET 7-21-2025

|  |                                |               |              |   |                     |  |  |  |                    |               |                  |           |                 |              |        |      |         |
|--|--------------------------------|---------------|--------------|---|---------------------|--|--|--|--------------------|---------------|------------------|-----------|-----------------|--------------|--------|------|---------|
|  | USER NAME    = edison.zohfanyi | DESIGNED    - | REVISED    - | STATE OF ILLINOIS<br>DEPARTMENT OF TRANSPORTATION | SUMMARY OF QUANTITY |  |  |  | F.A.*<br>RTE.      | SECTION       |                  | COUNTY    | TOTAL<br>SHEETS | SHEET<br>NO. |        |      |         |
|  |                                | DRAWN    -    | REVISED    - |   |                     |  |  |  | *                  | (580,581)RS-2 |                  | ST. CLAIR | 44              | 3            |        |      |         |
|  |                                | CHECKED   -   | REVISED    - |   |                     |  |  |  | * FAP 594/FAU 9213 |               |                  |           |                 |              |        |      |         |
|  | PLOT DATE    = 7/16/2025       | DATE    -     | REVISED   -  |   |                     |  |  |  | SCALE:             |               |                  |           | SHEET 1         | OF 5         | SHEETS | STA. | TO STA. |
|  |                                |               |              |   |                     |  |  |  | ILLINOIS           |               | FED. AID PROJECT |           |                 |              |        |      |         |



MODEL: SQQ-2 [Sheet]  
FILE NAME: c:\paw\work\paw\illinois.gov\id106652D\76M55-sht-SQQ.dgn

| CODE NO.   | ITEM   | UNIT  | TOTAL QUANTITY | CONSTRUCTION CODE    |        |
|------------|--|-------|----------------|----------------------|--------|
|            |  |       |                | 80% FED<br>20% STATE |        |
|            |  |       |                | ROADWAY              | SAFETY |
|            |  |       |                | 0005                 | 0021   |
|            |  |       |                | URBAN                | URBAN  |
| 60618300   | CONCRETE MEDIAN SURFACE, 4 INCH                    | SQ FT | 223            | 223                  |        |
| 60618320   | CONCRETE MEDIAN SURFACE, 6 INCH                    | SQ FT | 6880           | 6880                 |        |
| 60620000   | CONCRETE MEDIAN, TYPE SB-6.24                      | SQ FT | 288            | 288                  |        |
| * 63000003 | STEEL PLATE BEAM GUARDRAIL, TYPE A, 9 FOOT POSTS   | FOOT  | 1350           | 1350                 |        |
| * 63100045 | TRAFFIC BARRIER TERMINAL, TYPE 2                   | EACH  | 8              | 8                    |        |
| * 63100070 | TRAFFIC BARRIER TERMINAL, TYPE 5                   | EACH  | 1              | 1                    |        |
| * 63100085 | TRAFFIC BARRIER TERMINAL, TYPE 6                   | EACH  | 4              | 4                    |        |
| * 63100089 | TRAFFIC BARRIER TERMINAL, TYPE 6B                  | EACH  | 2              | 2                    |        |
| * 63100167 | TRAFFIC BARRIER TERMINAL, TYPE 1 (SPECIAL) TANGENT | EACH  | 9              | 9                    |        |
| 63200310   | GUARDRAIL REMOVAL                                  | FOOT  | 2197.25        | 2197.25              |        |
| 67100100   | MOBILIZATION                                       | L SUM | 1              | 1                    |        |
| 70100310   | TRAFFIC CONTROL AND PROTECTION, STANDARD 701421    | L SUM | 1              | 1                    |        |
| 70100320   | TRAFFIC CONTROL AND PROTECTION, STANDARD 701422    | L SUM | 1              | 1                    |        |
| 70100420   | TRAFFIC CONTROL AND PROTECTION, STANDARD 701411    | EACH  | 6              | 6                    |        |

\* SPECIALTY ITEM

| CODE NO. | ITEM   | UNIT   | TOTAL QUANTITY | CONSTRUCTION CODE    |        |
|----------|--|--------|----------------|----------------------|--------|
|          |  |        |                | 80% FED<br>20% STATE |        |
|          |  |        |                | ROADWAY              | SAFETY |
|          |  |        |                | 0005                 | 0021   |
|          |  |        |                | URBAN                | URBAN  |
| 70100825 | TRAFFIC CONTROL AND PROTECTION, STANDARD 701456        | L SUM  | 1              | 1                    |        |
| 70102625 | TRAFFIC CONTROL AND PROTECTION, STANDARD 701606        | L SUM  | 1              | 1                    |        |
| 70102634 | TRAFFIC CONTROL AND PROTECTION, STANDARD 701611        | L SUM  | 1              | 1                    |        |
| 70102635 | TRAFFIC CONTROL AND PROTECTION, STANDARD 701701        | L SUM  | 1              | 1                    |        |
| 70102640 | TRAFFIC CONTROL AND PROTECTION, STANDARD 701801        | L SUM  | 1              | 1                    |        |
| 70107025 | CHANGEABLE MESSAGE SIGN                                | CAL DA | 616            | 616                  |        |
| 70300100 | SHORT TERM PAVEMENT MARKING                            | FOOT   | 6530           | 6530                 |        |
| 70300150 | SHORT TERM PAVEMENT MARKING REMOVAL                    | SQ FT  | 2193           | 2193                 |        |
| 70300211 | TEMPORARY PAVEMENT MARKING LETTERS AND SYMBOLS - PAINT | SQ FT  | 450            | 450                  |        |
| 70300241 | TEMPORARY PAVEMENT MARKING - LINE 6"- PAINT            | FOOT   | 30713          | 30713                |        |
| 70300251 | TEMPORARY PAVEMENT MARKING - LINE 8"- PAINT            | FOOT   | 371            | 371                  |        |
| 70300261 | TEMPORARY PAVEMENT MARKING - LINE 12"- PAINT           | FOOT   | 689            | 689                  |        |
| 70300281 | TEMPORARY PAVEMENT MARKING - LINE 24"- PAINT           | FOOT   | 179            | 179                  |        |
| 72000100 | SIGN PANEL - TYPE 1                                    | SQ FT  | 13.1           |                      | 13.1   |

 REVISED SHEET 7-21-2025

|  | USER NAME = edison.zohfonyi | DESIGNED - | REVISED - | STATE OF ILLINOIS<br>DEPARTMENT OF TRANSPORTATION | SUMMARY OF QUANTITY |  |  | F.A.*<br>RTE.             | SECTION       | COUNTY    | TOTAL<br>SHEETS | SHEET<br>NO. |
|--|-----------------------------|------------|-----------|---|---------------------|--|--|---------------------------|---------------|-----------|-----------------|--------------|
|  |                             | DRAWN -    | REVISED - |   |                     |  |  | *                         | (580,581)RS-2 | ST. CLAIR | 44              | 4            |
|  |                             | CHECKED -  | REVISED - |   | SCALE:              |  |  | * FAP 594/FAU 9213        |               |           |                 |              |
|  | PLOT DATE = 7/16/2025       | DATE -     | REVISED - |   | SHEET 2 OF 5 SHEETS |  |  | ILLINOIS FED. AID PROJECT |               |           |                 |              |



MODEL: SQQ-3 [Sheet]  
FILE NAME: c:\paw\work\paw\illinois.gov\id106652D\76M55-sht-SQQ.dgn

| CODE NO.   | ITEM   | UNIT  | TOTAL QUANTITY | CONSTRUCTION CODE |        |
|------------|--|-------|----------------|-------------------|--------|
|            |  |       |                | ROADWAY           | SAFETY |
|            |  |       |                |                   |        |
|            |  |       |                |                   |        |
|            |  |       |                | 0005              | 0021   |
|            |  |       |                | URBAN             | URBAN  |
|            |  |       |                |                   |        |
| * 72501000 | TERMINAL MARKER - DIRECT APPLIED                     | EACH  | 9              | 9                 |        |
|            |  |       |                |                   |        |
| * 78000100 | THERMOPLASTIC PAVEMENT MARKING - LETTERS AND SYMBOLS | SQ FT | 450            | 450               |        |
|            |  |       |                |                   |        |
| * 78000400 | THERMOPLASTIC PAVEMENT MARKING - LINE 6"             | FOOT  | 30713          | 30713             |        |
|            |  |       |                |                   |        |
| * 78000500 | THERMOPLASTIC PAVEMENT MARKING - LINE 8"             | FOOT  | 371            | 371               |        |
|            |  |       |                |                   |        |
| * 78000600 | THERMOPLASTIC PAVEMENT MARKING - LINE 12"            | FOOT  | 689            | 689               |        |
|            |  |       |                |                   |        |
| * 78000650 | THERMOPLASTIC PAVEMENT MARKING - LINE 24"            | FOOT  | 179            | 179               |        |
|            |  |       |                |                   |        |
| * 78100100 | RAISED REFLECTIVE PAVEMENT MARKER                    | EACH  | 192            | 192               |        |
|            |  |       |                |                   |        |
| * 78200005 | GUARDRAIL REFLECTORS, TYPE A                         | EACH  | 37             | 37                |        |
|            |  |       |                |                   |        |
| * 78200020 | CURB REFLECTORS                                      | EACH  | 122            | 122               |        |
|            |  |       |                |                   |        |
| 78300200   | RAISED REFLECTIVE PAVEMENT MARKER REMOVAL            | EACH  | 192            | 192               |        |
|            |  |       |                |                   |        |
| 78300202   | PAVEMENT MARKING REMOVAL - WATER BLASTING            | SQ FT | 16575          | 16575             |        |
|            |  |       |                |                   |        |
| * 81028350 | UNDERGROUND CONDUIT, PVC, 2" DIA.                    | FOOT  | 16             |                   | 16     |
|            |  |       |                |                   |        |
| * 81028370 | UNDERGROUND CONDUIT, PVC, 3" DIA.                    | FOOT  | 136            |                   | 136    |
|            |  |       |                |                   |        |
| * 81028390 | UNDERGROUND CONDUIT, PVC, 4" DIA.                    | FOOT  | 191            |                   | 191    |
|            |  |       |                |                   |        |

\* SPECIALTY ITEM

THE FOLLOWING PAY ITEMS HAVE BEEN DELETED FROM THIS PAGE:

72400710      87502670      87700260      87800400  
81028220      87700140      87700270

| CODE NO.   | ITEM   | UNIT | TOTAL QUANTITY | CONSTRUCTION CODE |        |
|------------|--|------|----------------|-------------------|--------|
|            |  |      |                | ROADWAY           | SAFETY |
|            |  |      |                |                   |        |
|            |  |      |                |                   |        |
|            |  |      |                | 0005              | 0021   |
|            |  |      |                | URBAN             | URBAN  |
|            |  |      |                |                   |        |
| * 81028400 | UNDERGROUND CONDUIT, PVC, 5" DIA.                                  | FOOT | 128            |                   | 128    |
|            |  |      |                |                   |        |
| * 81028730 | UNDERGROUND CONDUIT, COILABLE NONMETALLIC CONDUIT, 1 1/4" DIA.     | FOOT | 47             |                   | 47     |
|            |  |      |                |                   |        |
| * 81400300 | DOUBLE HANDHOLE  | EACH | 1              |                   | 1      |
|            |  |      |                |                   |        |
| * 85000200 | MAINTENANCE OF EXISTING TRAFFIC SIGNAL INSTALLATION                | EACH | 1              |                   | 1      |
|            |  |      |                |                   |        |
| * 87301215 | ELECTRIC CABLE IN CONDUIT, SIGNAL NO. 14 2C                        | FOOT | 1540           |                   | 1540   |
|            |  |      |                |                   |        |
| * 87301235 | ELECTRIC CABLE IN CONDUIT, SIGNAL NO. 14 4C                        | FOOT | 1550           |                   | 1550   |
|            |  |      |                |                   |        |
| * 87301245 | ELECTRIC CABLE IN CONDUIT, SIGNAL NO. 14 5C                        | FOOT | 3160           |                   | 3160   |
|            |  |      |                |                   |        |
| * 87301255 | ELECTRIC CABLE IN CONDUIT, SIGNAL NO. 14 7C                        | FOOT | 780            |                   | 780    |
|            |  |      |                |                   |        |
| * 87301305 | ELECTRIC CABLE IN CONDUIT, LEAD-IN, NO. 14 1 PAIR                  | FOOT | 1840           |                   | 1840   |
|            |  |      |                |                   |        |
| * 87301900 | ELECTRIC CABLE IN CONDUIT, EQUIPMENT GROUNDING CONDUCTOR, NO. 6 1C | FOOT | 910            |                   | 910    |
|            |  |      |                |                   |        |
| * 87501100 | TRAFFIC SIGNAL POST, 15 FT.  | EACH | 3              |                   | 3      |
|            |  |      |                |                   |        |
| * 87600100 | PEDESTRIAN PUSH-BUTTON POST, TYPE I                                | EACH | 1              |                   | 1      |
|            |  |      |                |                   |        |
| * 87700190 | STEEL MAST ARM ASSEMBLY AND POLE, 30 FT.                           | EACH | 1              |                   | 1      |
|            |  |      |                |                   |        |
| * 87800100 | CONCRETE FOUNDATION, TYPE A  | FOOT | 12             |                   | 12     |
|            |  |      |                |                   |        |

1 REVISED SHEET 7-21-2025

|  | USER NAME = edison.zohfonyi | DESIGNED - | REVISED - | STATE OF ILLINOIS<br>DEPARTMENT OF TRANSPORTATION | SUMMARY OF QUANTITY |                     | F.A.*<br>RTE.      | SECTION       | COUNTY                      | TOTAL<br>SHEETS | SHEET<br>NO. |
|--|-----------------------------|------------|-----------|---|---------------------|---------------------|--------------------|---------------|-----------------------------|-----------------|--------------|
|  |                             |            |           |   |                     |                     |                    |               |                             |                 |              |
|  |                             |            |           |   |                     |                     |                    |               |                             |                 |              |
|  |                             |            |           |   |                     |                     |                    |               |                             |                 |              |
|  |                             | DRAWN -    | REVISED - |   |                     |                     | *                  | (580,581)RS-2 | ST. CLAIR                   | 44              | 5            |
|  |                             | CHECKED -  | REVISED - |   |                     |                     | * FAP 594/FAU 9213 |               | CONTRACT NO. 76M55          |                 |              |
|  | PLOT DATE = 7/16/2025       | DATE -     | REVISED - |   | SCALE:              | SHEET 3 OF 5 SHEETS | STA.               | TO STA.       | ILLINOIS   FED. AID PROJECT |                 |              |



MODEL: SQ-4 [Sheet]  
FILE NAME: c:\pw\work\widot\illinois.gov edison.zohfony@illinois.gov\1086652\ID76M55-sht-SQ.dgn

|            |   |      |                | CONSTRUCTION CODE    |        |
|------------|---|------|----------------|----------------------|--------|
|            |   |      |                |                      |        |
| CODE NO.   | ITEM  | UNIT | TOTAL QUANTITY | 80% FED<br>20% STATE |        |
|            |   |      |                | ROADWAY              | SAFETY |
|            |   |      |                | 0005                 | 0021   |
|            |   |      |                | URBAN                | URBAN  |
| * 87800415 | CONCRETE FOUNDATION, TYPE E 36-INCH DIAMETER                              | FOOT | 11             |                      | 11     |
| * 87900200 | DRILL EXISTING HANDHOLE   | EACH | 9              |                      | 9      |
| * 88030020 | SIGNAL HEAD, LED, 1-FACE, 3-SECTION, MAST-ARM MOUNTED                     | EACH | 2              |                      | 2      |
| * 88030050 | SIGNAL HEAD, LED, 1-FACE, 3-SECTION, BRACKET MOUNTED                      | EACH | 4              |                      | 4      |
| * 88030070 | SIGNAL HEAD, LED, 1-FACE, 4-SECTION, BRACKET MOUNTED                      | EACH | 1              |                      | 1      |
| * 88030080 | SIGNAL HEAD, LED, 1-FACE, 4-SECTION, MAST ARM MOUNTED                     | EACH | 1              |                      | 1      |
| * 88102717 | PEDESTRIAN SIGNAL HEAD, LED, 1-FACE, BRACKET MOUNTED WITH COUNTDOWN TIMER | EACH | 4              |                      | 4      |
| * 88102747 | PEDESTRIAN SIGNAL HEAD, LED, 2-FACE, BRACKET MOUNTED WITH COUNTDOWN TIMER | EACH | 1              |                      | 1      |
| * 88200100 | TRAFFIC SIGNAL BACKPLATE  | EACH | 3              |                      | 3      |
| * 88500100 | INDUCTIVE LOOP DETECTOR   | EACH | 2              |                      | 2      |
| * 88600100 | DETECTOR LOOP, TYPE I   | FOOT | 1240           |                      | 1240   |
| * 89500100 | RELOCATE EXISTING SIGNAL HEAD   | EACH | 5              |                      | 5      |
| * 89502200 | MODIFY EXISTING CONTROLLER  | EACH | 1              |                      | 1      |
| 89502375   | REMOVE EXISTING TRAFFIC SIGNAL EQUIPMENT                                  | EACH | 1              |                      | 1      |

THE FOLLOWING PAY ITEMS HAVE BEEN DELETED FROM THIS PAGE:

|          |          |          |          |
|----------|----------|----------|----------|
| 88030100 | 89500200 | 89502350 | X8760201 |
| 88030110 | 89502300 | X1400031 |          |

|            |                             |            |           |   |                     |         |             |      |               |                    |                             |                    |              |
|------------|-----------------------------|------------|-----------|---|---------------------|---------|-------------|------|---------------|--------------------|-----------------------------|--------------------|--------------|
| FILE NAME: | USER NAME = edison.zohfonyi | DESIGNED - | REVISED - | STATE OF ILLINOIS<br>DEPARTMENT OF TRANSPORTATION | SUMMARY OF QUANTITY |         |             |      | F.A.*<br>RTE. | SECTION            | COUNTY                      | TOTAL<br>SHEETS    | SHEET<br>NO. |
|            |                             | DRAWN -    | REVISED - |   |                     |         |             |      | *             | (580,581)RS-2      | ST. CLAIR                   | 44                 | 6            |
|            |                             | CHECKED -  | REVISED - |   |                     |         |             |      |               |                    |                             |                    |              |
|            | PLOT DATE = 7/16/2025       | DATE -     | REVISED - |   | SCALE:              | SHEET 4 | OF 5 SHEETS | STA. | TO STA.       | * FAP 594/FAU 9213 |                             | CONTRACT NO. 76M55 |              |
|            |                             |            |           |   |                     |         |             |      |               |                    | ILLINOIS   FED. AID PROJECT |                    |              |



MODEL: SOQ-5 [Sheet]  
FILE NAME: c:\pw\work\widot\illinois.gov\_edison.zohfony\illinois.gov1086652\ID76M55-sht-SOQ.dgn

[illegible]

\* SPECIALTY ITEM

THE FOLLOWING PAY ITEMS HAVE BEEN DELETED FROM THIS PAGE:

X8760204

X8950307

|            |                             |            |           |   |                             |  |  |  |               |               |           |                 |                    |                    |
|------------|-----------------------------|------------|-----------|---|-----------------------------|--|--|--|---------------|---------------|-----------|-----------------|--------------------|--------------------|
| FILE NAME: | USER NAME = edison.zohfonyi | DESIGNED - | REVISED - | STATE OF ILLINOIS<br>DEPARTMENT OF TRANSPORTATION | SUMMARY OF QUANTITY         |  |  |  | F.A.*<br>RTE. | SECTION       | COUNTY    | TOTAL<br>SHEETS | SHEET<br>NO.       |                    |
|            |                             | DRAWN -    | REVISED - |   |                             |  |  |  | *             | (580.581)RS-2 | ST. CLAIR | 44              | 7                  |                    |
|            |                             | CHECKED -  | REVISED - |   |                             |  |  |  |               |               |           |                 |                    |                    |
|            | PLOT DATE = 7/16/2025       | DATE -     | REVISED - |   | SCALE:                      |  |  |  | SHEET 5       | OF 5 SHEETS   | STA.      | TO STA.         | * FAP 594/FAU 9213 | CONTRACT NO. 76M55 |
|            |                             |            |           |   |                             |  |  |  |               |               |           |                 |                    |                    |
|            |                             |            |           |   | ILLINOIS   FED. AID PROJECT |  |  |  |               |               |           |                 |                    |                    |



MODEL: Schedule of Quantity [Sheet]  
FILE NAME: c:\paw\_work\wtd\illinois.gov\edison.zohfanyi\1086652D76M55-sh-schedule.dgn

| RESURFACING SCHEDULE N.B. IL 203                 |           |                               |       |                               |                               |  |  |   |   |  |  |                                |
|--|-----------|-------------------------------|-------|-------------------------------|-------------------------------|--|--|---|---|--|--|--------------------------------|
| STATION  |           | DIMENSION                     |       | HMA SURFACE<br>REMOVAL 2 1/4" | LONGITUDINAL<br>JOINT SEALANT | BITUMINOUS<br>MATERIALS<br>(TACK COAT)<br>1ST PASS | BITUMINOUS<br>MATERIALS<br>(TACK COAT)<br>2ND PASS | HMA BINDER<br>COURSE IL-19.0<br>MIX "B" N90<br>(MAINLINE) | HMA BINDER<br>COURSE IL-19.0<br>MIX "B" N90<br>(TURN LANES) | POLYMERIZED HMA<br>SURFACE COURSE IL-9.5<br>MIX "D" N90 (MAINLINE) | POLYMERIZED HMA<br>SURFACE COURSE IL-9.5<br>MIX "D" N90 (TURN LANES) | MATERIAL<br>TRANSFER<br>DEVICE |
|  |           | LENGTH                        | WIDTH |                               |                               |  |  |   |   |  |  |                                |
| FROM   | TO        | FEET                          | FEET  | SQ YD                         | FEET                          | POUND  | POUND  | TON   | TON   | TON  | TON  | TON                            |
| 2+08.00  | 5+50.00   | 342.00                        | 24    | 912.0                         | 342.0                         | 410.4  | 205.2  | 114.91  |   | 76.6   |  | 191.5                          |
| 5+50.00  | 7+29.00   | BRIDGE OMISSION SN - 082-0029 |       |                               |                               |  |  |   |   |  |  |                                |
| 7+29.00  | 13+35.00  | 606.00                        | 24    | 1616.0                        | 606.0                         | 727.2  | 363.6  | 203.62  |   | 135.7  |  | 339.4                          |
| 13+35.00   | 16+74.00  | BRIDGE OMISSION SN - 082-0028 |       |                               |                               |  |  |   |   |  |  |                                |
| 16+74.00   | 20+59.00  | 385.00                        | 24    | 1026.7                        | 770.0                         | 462.0  | 231  | 129.36  |   | 86.2   |  | 215.6                          |
| 20+59.00   | 26+69.00  | 610.00                        | 16    | 1084.4                        |                               | 488.0  | 244  | 136.64  |   | 91.1   |  | 227.7                          |
| 26+69.00   | 32+64.00  | 595.00                        | 32    | 2115.6                        | 595.0                         | 952.0  | 476  | 266.56  |   | 177.7  |  | 444.3                          |
| 32+64.00   | 35+86.00  | 322.00                        | 16    | 572.4                         |                               | 257.6  | 128.8  | 72.13   |   | 48.1   |  | 120.2                          |
| STATION EQUATION STA. 35+86.00 BK = 131+55.00 AH |           |                               |       |                               |                               |  |  |   |   |  |  |                                |
| 131+55.00  | 133+85.00 | 230.00                        | 36    | 920.0                         | 460.0                         | 414.0  | 207  | 115.92  |   | 77.3   |  | 193.2                          |
| 133+85.00  | 137+20.00 | 335.00                        | 36    | 2010.0                        | 1340.0                        | 603.0  | 301.5  | 168.84  | 84.42   | 112.6  | 56.3   | 281.4                          |
| 137+20.00  | 142+38.00 | INTERSECTION OMISSION         |       |                               |                               |  |  |   |   |  |  |                                |
| 142+38.00  | 142+49.76 | 11.76                         | 24    | 31.4                          | 11.8                          | 14.1   | 7.06   | 3.95  |   | 2.6  |  | 6.6                            |
| STATION EQUATION STA. 142+49.76 BK = 140+00.5 AH |           |                               |       |                               |                               |  |  |   |   |  |  |                                |
| 140+00.50  | 145+75.50 | 575.00                        | 24    | 2300.0                        | 1150.0                        | 690.0  | 345  | 193.20  | 96.60   | 128.8  | 64.4   | 322.0                          |
| 145+75.50  | 157+45.50 | PROJECT OMISSION              |       |                               |                               |  |  |   |   |  |  |                                |
| 157+45.50  | 168+35.50 | 1090.00                       | 24    | 2906.7                        | 1090.0                        | 1308.0   | 654  | 366.24  |   | 244.2  |  | 610.4                          |
|  |           |                               |       |                               |                               |  |  |   |   |  |  |                                |
| RAMP H   |           |                               |       |                               |                               |  |  |   |   |  |  |                                |
| 130+05.00  | 131+55.00 | 150.00                        | 24    | 400.0                         | 150.0                         | 180.0  | 90   | 50.40   |   | 33.6   |  | 84.0                           |
|  |           |                               |       |                               |                               |  |  |   |   |  |  |                                |
| RAMP D   |           |                               |       |                               |                               |  |  |   |   |  |  |                                |
| 1+00.00  | 2+67.00   | 167.00                        | 16    | 296.9                         |                               | 133.6  | 66.8   | 37.41   |   | 24.9   |  | 62.3                           |
|  |           |                               |       |                               |                               |  |  |   |   |  |  |                                |
| RAMP E   |           |                               |       |                               |                               |  |  |   |   |  |  |                                |
| 0+00.00  | 2+74.00   | 274.00                        | 16    | 487.1                         |                               | 219.2  | 109.6  | 61.38   |   | 40.9   |  | 102.3                          |
|  |           |                               |       |                               |                               |  |  |   |   |  |  |                                |
| TOTAL  |           |                               |       | 16679                         | 6515                          | 6859   | 3430   | 1921  | 181   | 1280   | 121  | 3201                           |

| SIDEWALK AND MEDIAN SCHEDULE   |          |                                    |                                    |                     |                   |                     |                             |
|--------------------------------|----------|------------------------------------|------------------------------------|---------------------|-------------------|---------------------|-----------------------------|
| STATION                        |          | CONCRETE MEDIAN<br>SURFACE REMOVAL | CONCRETE MEDIAN<br>SURFACE, 6 INCH | SIDEWALK<br>REMOVAL | MEDIAN<br>REMOVAL | PAVEMENT<br>REMOVAL | CONCRETE BARRIER<br>REMOVAL |
| FROM                           | TO       | SQ FT                              | SQ FT                              | SQ FT               | SQ FT             | SQ YD               | FOOT                        |
| 2+25.00                        | 4+87.00  | 2880                               | 2880                               |                     |                   |                     |                             |
| 4+87.00                        | 5+72.00  |                                    | 362                                |                     |                   |                     | 71                          |
| 5+72.00                        | 7+32.00  | BRIDGE OMISSION SN - 082-0029      |                                    |                     |                   |                     |                             |
| 7+32.00                        | 7+43.00  | 50                                 | 50                                 |                     |                   |                     |                             |
| 8+44.00                        | 13+35.00 | 1736                               | 1736                               |                     |                   |                     |                             |
| 13+35.00                       | 16+74.00 | BRIDGE OMISSION SN - 082-0028      |                                    |                     |                   |                     |                             |
| 16+74.00                       | 20+59.00 | 1852                               | 1852                               |                     |                   |                     |                             |
| NE QUADRANT AT OHIO ST.        |          |                                    |                                    | 2567                |                   | 290                 | 115                         |
| NE QUADRANT ISLAND AT OHIO ST. |          |                                    |                                    |                     | 344               |                     |                             |
| SE QUADRANT ISLAND AT OHIO ST. |          |                                    |                                    |                     | 216               |                     |                             |
| SE QUADRANT AT OHIO ST.        |          |                                    |                                    |                     |                   | 88                  |                             |
| NW QUADRANT AT AT OHIO ST. LT  |          |                                    |                                    |                     | 367               |                     |                             |
| NW QUADRANT AT AT OHIO ST. RT  |          |                                    |                                    |                     | 462               |                     |                             |
| TOTAL                          |          | 2880                               | 6880                               | 2567                | 1389              | 378                 | 186                         |

1

1 REVISED 7-21-2025

|  |                               |              |             |   |                        |  |  |  |                                |               |                            |                 |                    |  |
|--|-------------------------------|--------------|-------------|---|------------------------|--|--|--|--------------------------------|---------------|----------------------------|-----------------|--------------------|--|
|  | USER NAME   = edison.zohfanyi | DESIGNED   - | REVISED   - | STATE OF ILLINOIS<br>DEPARTMENT OF TRANSPORTATION | SCHEDULE OF QUANTITIES |  |  |  | F.A.*<br>RTE.                  | SECTION       | COUNTY                     | TOTAL<br>SHEETS | SHEET<br>NO.       |  |
|  |                               | DRAWN    -   | REVISED   - |   |                        |  |  |  | *                              | (580,581)RS-2 | ST. CLAIR                  | 44              | 19                 |  |
|  |                               | CHECKED   -  | REVISED   - |   | SCALE:                 |  |  |  | SHEET 1       OF   11   SHEETS |               | STA.               TO STA. |                 |                    |  |
|  | PLOT DATE   = 7/16/2025       | DATE       - | REVISED   - |   |                        |  |  |  |                                |               | * FAP 594/FAU 9213         |                 |                    |  |
|  |                               |              |             |   |                        |  |  |  | ILLINOIS                       |               | FED. AID PROJECT           |                 | CONTRACT NO. 76M55 |  |



AGGREGATE WEDGE SHOULDER, TYPE B, N.B.  
IL 203

| STATION  |           | DEPTH                         | DIMENSIONS |       |      | AREA   | AGGREGATE WEDGE SHOULDER, TYPE B |
|--|-----------|-------------------------------|------------|-------|------|--------|----------------------------------|
|  |           |                               | LENGTH     | WIDTH |      |        |                                  |
|  |           |                               |            | EAST  | WEST |        |                                  |
| FROM   | TO        | INCH                          | FEET       | FEET  | FEET | SQ YD  | TON                              |
| 2+08.00  | 5+50.00   | 3                             | 342        | 3     | 0    | 114.00 | 19.95                            |
| 5+50.00  | 7+29.00   | BRIDGE OMISSION SN - 082-0029 |            |       |      |        |                                  |
| 7+29.00  | 7+72.00   | 3                             | 43         | 3     | 0    | 14.33  | 2.51                             |
| 8+32.00  | 10+15.00  | 3                             | 183        | 3     | 0    | 61.00  | 10.67                            |
| 10+69.00   | 13+35.00  | 3                             | 266        | 3     | 0    | 88.67  | 15.52                            |
| 13+35.00   | 16+74.00  | BRIDGE OMISSION SN - 082-0028 |            |       |      |        |                                  |
| 16+74.00   | 20+59.00  | 3                             | 385        | 3     | 0    | 128.33 | 22.46                            |
| 20+59.00   | 26+69.00  | 3                             | 610        | 3     | 3    | 406.67 | 71.17                            |
| 26+69.00   | 32+64.00  | 3                             | 595        | 3     | 3    | 396.67 | 69.42                            |
| 32+64.00   | 35+86.00  | 3                             | 322        | 3     | 3    | 214.67 | 37.57                            |
| STATION EQUATION STA. 38+86.00 BK = 131+55.00 AH |           |                               |            |       |      |        |                                  |
| 141+70.00  | 142+49.76 | 3                             | 79.76      | 0     | 3    | 26.59  | 4.65                             |
| STATION EQUATION STA. 142+49.76 BK = 140+00.5 AH |           |                               |            |       |      |        |                                  |
| 140+00.50  | 145+75.50 | 3                             | 575        | 3     | 0    | 191.67 | 33.54                            |
| 145+75.50  | 157+45.50 | PROJECT OMISSION              |            |       |      |        |                                  |
| 157+45.50  | 168+35.50 | 3                             | 1090       | 3     | 0    | 363.33 | 63.58                            |
|  |           |                               |            |       |      |        |                                  |
| RAMP H   |           |                               |            |       |      |        |                                  |
| 130+05.00  | 131+55.00 | 3                             | 150        | 3     | 3    | 100.00 | 17.50                            |
|  |           |                               |            |       |      |        |                                  |
| RAMP D   |           |                               |            |       |      |        |                                  |
| 1+00.00  | 2+67.00   | 3                             | 167        | 3     | 0    | 55.67  | 9.74                             |
|  |           |                               |            |       |      |        |                                  |
| RAMP E   |           |                               |            |       |      |        |                                  |
| 0+00.00  | 2+74.00   | 3                             | 274        | 3     | 0    | 91.33  | 15.98                            |
|  |           |                               |            |       |      |        |                                  |
| TOTAL  |           |                               |            |       |      |        | 394                              |

AGGREGATE WEDGE SHOULDER, TYPE B, S.B. IL  
203

| STATION  |           | DEPTH                         | DIMENSIONS |       |      | AREA   | AGGREGATE WEDGE SHOULDER, TYPE B |
|--|-----------|-------------------------------|------------|-------|------|--------|----------------------------------|
|  |           |                               | LENGTH     | WIDTH |      |        |                                  |
|  |           |                               |            | EAST  | WEST |        |                                  |
| FROM   | TO        | INCH                          | FEET       | FEET  | FEET | SQ YD  | TON                              |
| 2+08.00  | 4+47.00   | 3                             | 239        | 0     | 3    | 79.67  | 13.94                            |
| 4+83.00  | 5+55.00   | 3                             | 72         | 0     | 3    | 24.00  | 4.20                             |
| 5+50.00  | 7+32.00   | BRIDGE OMISSION SN - 082-0029 |            |       |      |        |                                  |
| 7+32.00  | 11+65.00  | 3                             | 433        | 3     | 0    | 144.33 | 25.26                            |
| 12+49.00   | 13+35.00  | 3                             | 86         | 3     | 0    | 28.67  | 5.02                             |
| 13+35.00   | 16+74.00  | BRIDGE OMISSION SN - 082-0028 |            |       |      |        |                                  |
| 16+74.00   | 20+59.00  | 3                             | 385        | 0     | 3    | 128.33 | 22.46                            |
| 20+59.00   | 27+55.00  | 3                             | 696        | 0     | 3    | 232.00 | 40.60                            |
| 27+55.00   | 28+88.00  | PCC PAVEMENT OMISSION         |            |       |      |        |                                  |
| 28+88.00   | 38+10.00  | 3                             | 922        | 3     | 3    | 614.67 | 107.57                           |
| STATION EQUATION STA. 38+10.00 BK = 129+00.00 AH |           |                               |            |       |      |        |                                  |
| 138+29.00  | 144+46.00 | 3                             | 617        | 0     | 3    | 205.67 | 35.99                            |
| 144+46.00  | 157+06.00 | PROJECT OMISSION              |            |       |      |        |                                  |
| 157+06.00  | 168+35.50 | 3                             | 1129.5     | 0     | 3    | 376.50 | 65.89                            |
|  |           |                               |            |       |      |        |                                  |
| RAMP G   |           |                               |            |       |      |        |                                  |
| 124+91.34  | 129+00.00 | 3                             | 408.66     | 3     | 3    | 272.44 | 47.68                            |
|  |           |                               |            |       |      |        |                                  |
| RAMP A   |           |                               |            |       |      |        |                                  |
| 16+20.00   | 17+05.00  | 3                             | 85         | 3     | 0    | 28.33  | 4.96                             |
|  |           |                               |            |       |      |        |                                  |
| RAMP B   |           |                               |            |       |      |        |                                  |
| 2+00.00  | 3+45.00   | 3                             | 145        | 3     | 0    | 48.33  | 8.46                             |
|  |           |                               |            |       |      |        |                                  |
| TOTAL  |           |                               |            |       |      |        | 382                              |

CURB AND GUTTER SCHEDULE IL 203 AT COLLINSVILLE RD.

| STATION  |          | COMBINATION CONCRETE CURB & GUTTER REMOVAL | COMBINATION CONCRETE CURB & GUTTER TYPE M-6.06 | COMBINATION CONCRETE CURB & GUTTER TYPE M-6.24 | CURB REFLECTORS | PAINT CURB |
|--|----------|--|--|--|-----------------|------------|
| FROM   | TO       | FEET                                       | FEET   |  | EACH            | FEET       |
| 2+25.00  | 2+94.00  | 138  | 138  |  | 8               | 58         |
| 2+94.00  | 4+87.00  | 386  | 386  |  | 14              |            |
| 4+87.00  | 5+72.00  | 170  | 170  |  | 6               |            |
| 5+72.00  | 7+32.00  | BRIDGE OMISSION SN - 082-0029              |  |  |                 |            |
| 7+32.00  | 7+43.00  | 22   | 22   |  | 1               |            |
| 8+44.00  | 13+35.00 | 982  | 982  |  | 37              |            |
| 13+35.00   | 16+74.00 | BRIDGE OMISSION SN - 082-0028              |  |  |                 |            |
| 16+74.00   | 20+59.00 | 770  | 770  |  | 29              | 58         |
| SOUTHWEST CONNER ISLAND IL 203 AT COLLINSVILLE RD. |          |  |  |  | 15              | 76         |
| SOUTHEAST CONNER ISLAND IL 203 AT OHIO ST.         |          | 45   |  | 86   | 11              | 65         |
| NORTHEAST CONNER ISLAND IL 203 AT OHIO ST.         |          | 65   |  |  |                 |            |
| NE QUADRANT AT OHIO ST.                            |          |  |  |  |                 |            |
| SE QUADRANT AT OHIO ST.                            |          | 27   |  |  |                 |            |
| TOTAL  |          | 2605                                       | 2468   | 86   | 122             | 257        |

1

1 REVISED 7-21-2025

MODEL: Schedule of Quantities-4 (Sheet)  
FILE NAME: c:\paw\work\il203\il203.edison.zohfonyl@illinois.gov\1086652D76M55-sh-schedule.dgn

|  |                             |            |           |
|--|-----------------------------|------------|-----------|
|  | USER NAME = edison.zohfonyl | DESIGNED - | REVISED - |
|  |                             | DRAWN -    | REVISED - |
|  |                             | CHECKED -  | REVISED - |
|  | PLOT DATE = 7/16/2025       | DATE -     | REVISED - |

STATE OF ILLINOIS  
DEPARTMENT OF TRANSPORTATION

SCHEDULE OF QUANTITIES

SCALE: SHEET 5 OF 11 SHEETS STA. TO STA.

| F.A.<br>RTE.       | SECTION       | COUNTY             | TOTAL<br>SHEETS | SHEET<br>NO. |
|--------------------|---------------|--------------------|-----------------|--------------|
| *                  | (580,581)RS-2 | ST. CLAIR          | 44              | 23           |
| * FAP 594/FAU 9213 |               | CONTRACT NO. 76M55 |                 |              |
| ILLINOIS           |               | FED. AID PROJECT   |                 |              |



MODEL: Schedule of Quantities-7 (Sheet)  
FILE NAME: c:\paw\_work\work\illinois.gov\edison.zohfanyi\1086552D76M55-sh-schedule.dgn

| PAVEMENT MARKING SCHEDULE N.B. IL 203 |           |  |                 |              |                      |                     |                     |                     |   |                             |                                     |                                   |               |   |
|---------------------------------------|-----------|--|-----------------|--------------|----------------------|---------------------|---------------------|---------------------|---|-----------------------------|-------------------------------------|-----------------------------------|---------------|---|
| LOCATION                              |           | THERMOPLASTIC AND TEMPORARY PAVEMENT MARKING     |                 |              |                      |                     |                     |                     | PAVEMENT MARKING REMOVAL - WATER BLASTING | SHORT TERM PAVEMENT MARKING | SHORT TERM PAVEMENT MARKING REMOVAL | RAISED REFLECTIVE PAVEMENT MARKER |               | RAISED REFLECTIVE PAVEMENT MARKER REMOVAL |
| STATION                               |           | LINE - 6"  |                 |              | 12" WHITE SOLID LINE | 8" WHITE SOLID LINE | 24" WHITE STOP LINE | FILLERS AND SYMBOLS |   |                             |                                     | ONE WAY CRYSTAL                   | TWO WAY AMBER |   |
| FROM                                  | TO        | WHITE SOLID                                      | WHITE SKIP-DASH | YELLOW SOLID |                      |                     |                     |                     |   |                             |                                     |                                   |               |   |
| 2+08.00                               | 2+26.00   | 18   | 10              |              |                      |                     |                     |                     | 14  | 10                          | 4                                   |                                   |               |   |
| 2+26.00                               | 5+50.00   | 324  | 90              | 324          |                      |                     |                     |                     | 369                                       | 150                         | 50                                  | 5                                 |               | 5   |
| 5+50.00                               | 7+29.00   | 179  | 50              | 179          |                      |                     |                     |                     | 204                                       | 90                          | 30                                  | 3                                 |               | 3   |
| 7+29.00                               | 9+96.00   | 267  | 70              | 267          |                      |                     |                     |                     | 302                                       | 130                         | 44                                  | 4                                 |               | 4   |
| 9+96.00                               | 10+54.00  |  | 20              | 58           |                      |                     |                     |                     | 39  | 20                          | 7                                   | 1                                 |               | 1   |
| 10+54.00                              | 13+35.00  | 281  | 80              | 281          |                      |                     |                     |                     | 321                                       | 130                         | 44                                  | 4                                 |               | 4   |
| 13+35.00                              | 16+74.00  | 339  | 90              | 339          |                      |                     |                     |                     | 384                                       | 160                         | 54                                  | 5                                 |               | 5   |
| 16+74.00                              | 26+96.00  | 1022   | 260             |              |                      |                     |                     |                     | 641                                       | 470                         | 157                                 | 13                                |               | 13  |
| 26+96.00                              | 27+10.00  | 14   |                 | 14           |                      |                     |                     |                     | 14  | 10                          | 4                                   |                                   |               |   |
| 27+10.00                              | 29+20.00  | 210  | 60              | 210          |                      |                     |                     |                     | 240                                       | 100                         | 34                                  | 3                                 |               | 3   |
| 29+20.00                              | 34+59.00  | 539  | 140             | 539          |                      |                     |                     |                     | 609                                       | 250                         | 84                                  |                                   |               |   |
| 34+59.00                              | 35+86.00  | 127  | 40              | 127          |                      |                     |                     |                     | 147                                       | 60                          | 20                                  |                                   |               |   |
| 35+86.00                              | 131+55.00 | STATION EQUATION STA. 35+86.00 BK = 131+55.00 AH |                 |              |                      |                     |                     |                     |   |                             |                                     |                                   |               |   |
| 131+55.00                             | 134+01.00 | 246  | 140             | 246          |                      |                     |                     |                     | 316                                       | 50                          | 17                                  | 8                                 |               | 8   |
| 134+01.00                             | 135+42.00 | 141  | 110             | 141          |                      |                     |                     |                     | 196                                       | 70                          | 24                                  | 4                                 |               | 4   |
| 135+42.00                             | 137+24.00 | 182  | 140             | 182          |                      |                     |                     |                     | 252                                       | 50                          | 17                                  | 6                                 |               | 6   |
| 137+24.00                             | 140+84.00 | 720  | 180             | 360          | 177                  | 160                 | 91                  | 220                 | 1032                                      | 480                         | 160                                 | 20                                |               | 20  |
| 141+51.00                             | 142+49.76 |  | 30              | 98.76        | 116                  |                     |                     |                     | 65  | 50                          | 17                                  | 2                                 |               | 2   |
| 141+51.00                             | 140+00.50 | STATION EQUATION STA. 142+49.76 BK = 140+00.5 AH |                 |              |                      |                     |                     |                     |   |                             |                                     |                                   |               |   |
| 140+00.50                             | 142+26.50 | 226  | 60              | 226          |                      |                     |                     |                     | 256                                       | 110                         | 37                                  | 3                                 |               | 3   |
| 142+26.50                             | 145+75.50 | 698  | 90              | 349          |                      |                     |                     | 40                  | 609                                       | 80                          | 27                                  | 5                                 |               | 5   |
| 145+75.50                             | 157+45.50 | PROJECT OMISSION                                 |                 |              |                      |                     |                     |                     |   |                             |                                     |                                   |               |   |
| 157+45.50                             | 168+35.50 | 1090   | 280             | 1090         |                      |                     |                     |                     | 1230                                      | 400                         | 134                                 | 14                                |               | 14  |
|                                       |           |  |                 |              |                      |                     |                     |                     |   |                             |                                     |                                   |               |   |
| RAMP H                                |           |  |                 |              |                      |                     |                     |                     |   |                             |                                     |                                   |               |   |
| 130+05.00                             | 131+55.00 | 150  | 40              | 150          |                      |                     |                     |                     | 170                                       | 60                          | 20                                  | 2                                 |               | 2   |
|                                       |           |  |                 |              |                      |                     |                     |                     |   |                             |                                     |                                   |               |   |
| RAMP D                                |           |  |                 |              |                      |                     |                     |                     |   |                             |                                     |                                   |               |   |
| 1+00.00                               | 2+67.00   | 167  |                 | 167          |                      |                     |                     |                     | 167                                       | 70                          | 24                                  |                                   |               |   |
|                                       |           |  |                 |              |                      |                     |                     |                     |   |                             |                                     |                                   |               |   |
| RAMP E                                |           |  |                 |              |                      |                     |                     |                     |   |                             |                                     |                                   |               |   |
| 0+00.00                               | 2+74.00   | 274  |                 | 274          |                      |                     |                     |                     | 274                                       | 100                         | 34                                  |                                   |               |   |
|                                       |           |  |                 |              |                      |                     |                     |                     |   |                             |                                     |                                   |               |   |
| OHIO ST.                              |           | 156  | 100             | 312          | 130                  |                     | 28                  | 70                  | 410                                       | 160                         | 54                                  |                                   |               |   |
|                                       |           |  |                 |              |                      |                     |                     |                     |   |                             |                                     |                                   |               |   |
| TOTAL                                 |           | 7370   | 2080            | 5934         | 423                  | 160                 | 119                 | 330                 | 8261                                      | 3260                        | 1097                                | 102                               | 0             | 102                                       |

 REVISED SHEET 7-21-2025

|  |                             |            |           |   |  |  |  |                    |               |                    |              |           |
|--|-----------------------------|------------|-----------|---|--|--|--|--------------------|---------------|--------------------|--------------|-----------|
|  | USER NAME = edison.zohfanyi | DESIGNED - | REVISED - | STATE OF ILLINOIS<br>DEPARTMENT OF TRANSPORTATION | SCHEDULE OF QUANTITIES                   |  |  | F.A.* RTE.         | SECTION       | COUNTY             | TOTAL SHEETS | SHEET NO. |
|  |                             | DRAWN -    | REVISED - |   |  |  |  | *                  | (580,581)RS-2 | ST. CLAIR          | 44           | 26        |
|  |                             | CHECKED -  | REVISED - |   | SCALE: SHEET 8 OF 11 SHEETS STA. TO STA. |  |  | * FAP 594/FAU 9213 |               | CONTRACT NO. 76M55 |              |           |
|  | PLOT DATE = 6/24/2025       | DATE -     | REVISED - |   |  |  |  | ILLINOIS           |               | FED. AID PROJECT   |              |           |



MODEL: Schedule of Quantities (Sheet)  
FILE NAME: c:\paw\_work\work\illinois.gov\edison.zohfanyi\108652D76M55-sh-schedule.dgn

| PAVEMENT MARKING SCHEDULE S.B. IL 203 |           |  |                 |              |                      |                     |                      |                     |                     |   |                             |                                     |                                   |               |   |
|---------------------------------------|-----------|--|-----------------|--------------|----------------------|---------------------|----------------------|---------------------|---------------------|---|-----------------------------|-------------------------------------|-----------------------------------|---------------|---|
| LOCATION                              |           | THERMOPLASTIC AND TEMPORARY PAVEMENT MARKING     |                 |              |                      |                     |                      |                     |                     | PAVEMENT MARKING REMOVAL - WATER BLASTING | SHORT TERM PAVEMENT MARKING | SHORT TERM PAVEMENT MARKING REMOVAL | RAISED REFLECTIVE PAVEMENT MARKER |               | RAISED REFLECTIVE PAVEMENT MARKER REMOVAL |
| STATION                               |           | LINE - 6"  |                 |              | LINE - 12"           | 8" WHITE SOLID LINE | 12" WHITE SOLID LINE | 24" WHITE STOP LINE | LETTERS AND SYMBOLS |   |                             |                                     | ONE WAY CRYSTAL                   | TWO WAY AMBER |   |
| FROM                                  | TO        | WHITE SOLID                                      | WHITE SKIP-DASH | YELLOW SOLID | YELLOW LINE DIAGONAL |                     |                      |                     |                     |   |                             |                                     |                                   |               |   |
|                                       |           | FEET   | FEET            | FEET         | FEET                 | FEET                | FEET                 | FEET                | SQ FT               | SQ FT                                     | FEET                        | SQ FT                               | EACH                              | EACH          | EACH                                      |
| 2+08.00                               | 2+26.00   | 18   | 10              |              |                      |                     |                      | 24                  |                     | 62  | 40                          | 14                                  |                                   |               |   |
| 2+26.00                               | 4+40.00   | 214  | 60              | 214          |                      | 211                 |                      |                     | 40                  | 425                                       | 140                         | 47                                  | 3                                 |               | 3   |
| 4+40.00                               | 5+55.00   |  | 30              | 115          |                      |                     |                      |                     |                     | 73  | 60                          | 20                                  | 2                                 |               | 2   |
| 5+55.00                               | 7+32.00   | 111  | 50              | 111          |                      |                     |                      |                     |                     | 202                                       | 90                          | 30                                  | 3                                 |               | 3   |
| 7+32.00                               | 12+13.00  | 481  | 130             | 481          |                      |                     |                      |                     |                     | 546                                       | 220                         | 74                                  | 7                                 |               | 7   |
| 12+13.00                              | 12+79.00  |  | 20              | 66           |                      |                     |                      |                     |                     | 43  | 20                          | 7                                   | 1                                 |               | 1   |
| 12+79.00                              | 13+35.00  | 56   | 20              | 56           |                      |                     |                      |                     |                     | 66  | 30                          | 10                                  | 1                                 |               | 1   |
| 13+35.00                              | 16+74.00  | 339  | 90              | 339          |                      |                     |                      |                     |                     | 384                                       | 160                         | 54                                  | 5                                 |               | 5   |
| 16+74.00                              | 27+55.00  | 1081   |                 | 1081         |                      |                     |                      |                     |                     | 1081                                      | 500                         | 167                                 | 14                                |               | 14  |
| 27+55.00                              | 28+88.00  | 133  | 40              | 133          |                      |                     |                      |                     |                     | 153                                       | 70                          | 24                                  | 2                                 |               | 2   |
| 28+88.00                              | 35+99.00  | 711  |                 | 711          |                      |                     |                      |                     |                     | 711                                       | 330                         | 110                                 |                                   |               |   |
| 35+99.00                              | 38+10.00  | 211  | 60              | 211          |                      |                     |                      |                     |                     | 241                                       | 100                         | 34                                  | 3                                 |               | 3   |
| 38+10.00                              | 129+00.00 | STATION EQUATION STA. 38+10.00 BK = 129+00.00 AH |                 |              |                      |                     |                      |                     |                     |   |                             |                                     |                                   |               |   |
| 129+00.00                             | 137+48.00 | 848  | 220             | 848          |                      |                     |                      |                     |                     | 958                                       | 390                         | 130                                 | 11                                |               | 11  |
| 138+19.00                             | 140+46.00 | 454  | 60              | 227          | 65                   |                     | 116                  | 36                  | 40                  | 664                                       | 180                         | 60                                  | 6                                 |               | 6   |
| 140+46.00                             | 144+46.00 | 400  | 100             | 400          |                      |                     |                      |                     |                     | 450                                       | 190                         | 64                                  | 5                                 |               | 5   |
| 144+46.00                             | 157+06.00 | PROJECT OMISSION                                 |                 |              |                      |                     |                      |                     |                     |   |                             |                                     |                                   |               |   |
| 157+06.00                             | 168+35.50 | 1129.5   | 290             | 1129.5       |                      |                     |                      |                     |                     | 1275                                      | 420                         | 140                                 | 15                                |               | 15  |
|                                       |           |  |                 |              |                      |                     |                      |                     |                     |   |                             |                                     |                                   |               |   |
| RAMP C                                |           |  |                 |              |                      |                     |                      |                     |                     |   |                             |                                     |                                   |               |   |
| 124+91.34                             | 129+00.00 | 408.66   | 110             | 408.66       |                      |                     |                      |                     |                     | 464                                       | 150                         | 50                                  | 6                                 |               | 6   |
|                                       |           |  |                 |              |                      |                     |                      |                     |                     |   |                             |                                     |                                   |               |   |
| RAMP A                                |           |  |                 |              |                      |                     |                      |                     |                     |   |                             |                                     |                                   |               |   |
| 16+20.00                              | 17+05.00  | 85   |                 | 85           |                      |                     |                      |                     |                     | 85  | 40                          | 14                                  |                                   |               |   |
|                                       |           |  |                 |              |                      |                     |                      |                     |                     |   |                             |                                     |                                   |               |   |
| RAMP B                                |           |  |                 |              |                      |                     |                      |                     |                     |   |                             |                                     |                                   |               |   |
| 2+00.00                               | 3+45.00   | 145  |                 | 145          |                      |                     |                      |                     |                     | 145                                       | 60                          | 20                                  |                                   |               |   |
|                                       |           |  |                 |              |                      |                     |                      |                     |                     |   |                             |                                     |                                   |               |   |
| RAMP C                                |           |  |                 |              |                      |                     |                      |                     |                     |   |                             |                                     |                                   |               |   |
| 11+88.00                              | 12+39.25  |  |                 | 51.25        |                      |                     |                      |                     |                     | 26  | 20                          | 7                                   |                                   |               |   |
|                                       |           |  |                 |              |                      |                     |                      |                     |                     |   |                             |                                     |                                   |               |   |
| RACE TRACK ENTRANCE                   |           | 54   |                 | 216          |                      |                     | 85                   |                     | 40                  | 260                                       | 60                          | 20                                  |                                   | 6             | 6   |
|                                       |           |  |                 |              |                      |                     |                      |                     |                     |   |                             |                                     |                                   |               |   |
| TOTAL                                 |           | 6945   | 1290            | 7094         | 65                   | 211                 | 201                  | 60                  | 120                 | 8314                                      | 3270                        | 1096                                | 84                                | 6             | 90  |

 REVISED SHEET 7-21-2025

|  |                             |            |           |   |                        |  |              |                    |               |                    |              |           |
|--|-----------------------------|------------|-----------|---|------------------------|--|--------------|--------------------|---------------|--------------------|--------------|-----------|
|  | USER NAME = edison.zohfanyi | DESIGNED - | REVISED - | STATE OF ILLINOIS<br>DEPARTMENT OF TRANSPORTATION | SCHEDULE OF QUANTITIES |  |              | F.A.* RTE.         | SECTION       | COUNTY             | TOTAL SHEETS | SHEET NO. |
|  |                             | DRAWN -    | REVISED - |   |                        |  |              | *                  | (580,581)RS-2 | ST. CLAIR          | 44           | 27        |
|  |                             | CHECKED -  | REVISED - |   | SCALE:                 |  |              | * FAP 594/FAU 9213 |               | CONTRACT NO. 76M55 |              |           |
|  | PLOT DATE = 6/24/2025       | DATE -     | REVISED - |   | SHEET 9                |  | OF 11 SHEETS | STA.               |               | TO STA.            |              |           |







MODEL: RAMP DETAILS [Sheet]  
FILE NAME: c:\pwworking\illinois.gov\edison.zohfonyi\108652D876M55-shl-Intersec-RAMPS.dgn

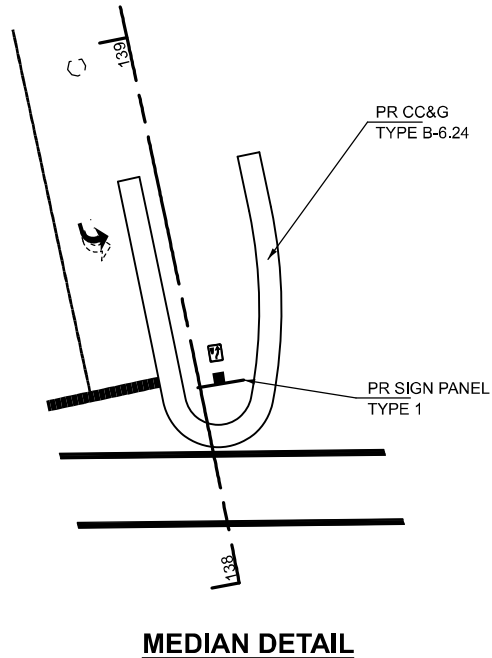
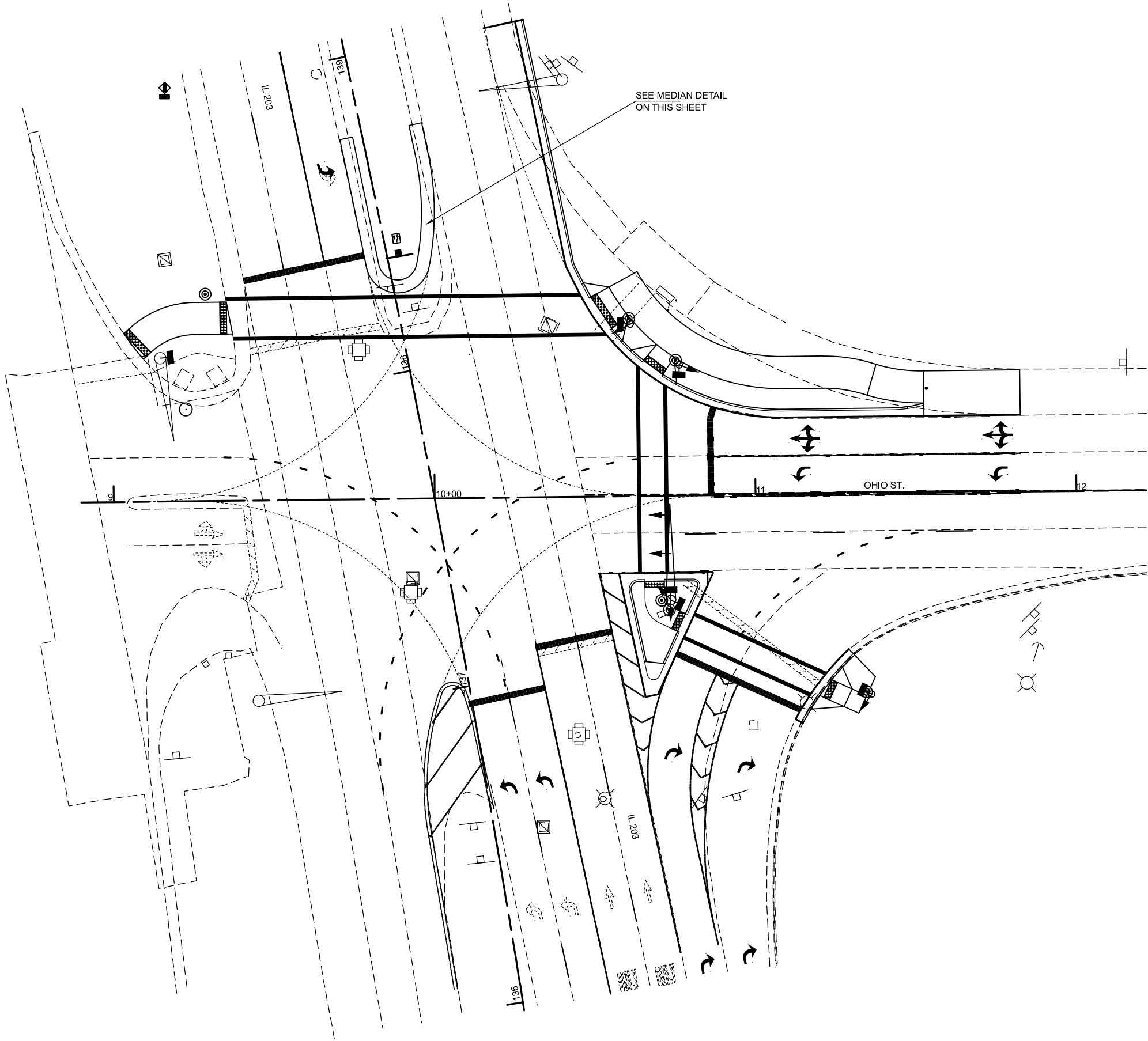

 REVISED SHEET 7-21-2025

|  |                               |              |             |   |  |         |      |        |      |                    |               |                             |           |                 |              |
|--|-------------------------------|--------------|-------------|---|--|---------|------|--------|------|--------------------|---------------|-----------------------------|-----------|-----------------|--------------|
|  | USER NAME   = edison.zohfonyi | DESIGNED   - | REVISED   - | STATE OF ILLINOIS<br>DEPARTMENT OF TRANSPORTATION | INTERSECTION DETAILS<br>IL 203 AT OHIO ST. |         |      |        |      | F.A.*<br>RTE.      | SECTION       |                             | COUNTY    | TOTAL<br>SHEETS | SHEET<br>NO. |
|  |                               | DRAWN    -   | REVISED   - |   |  |         |      |        |      | *                  | (580,581)RS-2 |                             | ST. CLAIR | 44              | 32           |
|  |                               | CHECKED   -  | REVISED   - |   | * FAP 594/FAU 9213                         |         |      |        |      | CONTRACT NO. 76M55 |               |                             |           |                 |              |
|  | PLOT DATE   = 7/16/2025       | DATE       - | REVISED   - |   | SCALE: NTS                                 | SHEET 1 | OF 1 | SHEETS | STA. | TO STA.            |               | ILLINOIS   FED. AID PROJECT |           |                 |              |
|  |                               |              |             |   |  |         |      |        |      |                    |               |                             |           |                 |              |



| POINT | ELEVATION |
|-------|-----------|
| A1    | (408.90)  |
| A2    | (408.98)  |
| A3    | (409.16)  |
| A4    | N/A       |
| A5    | (409.77)  |
| A6    | (410.17)  |
| A7    | (410.19)  |
| A8    | (410.27)  |
| A9    | (410.33)  |
| B1    | 408.88    |
| B2    | 408.94    |
| B3    | 409.09    |
| B4    | 409.15    |
| B5    | 409.74    |
| B6    | 410.08    |
| B7    | 410.19    |
| B8    | 410.23    |
| B9    | 410.26    |
| C1    | 408.68    |
| C2    | 408.98    |
| C3    | 409.13    |
| C4    | N/A       |
| C5    | 410.24    |
| C6    | 410.58    |
| C7    | 410.19    |
| C8    | 410.27    |
| C9    | 409.98    |
| D1    | 409.24    |
| D2    | 409.84    |
| D3    | 410.22    |
| E1    | 409.09    |
| E2    | 409.91    |

**LEGEND**  
XXX.XX PR. ELEVATION  
(XXX.XX) EX. ELEVATION

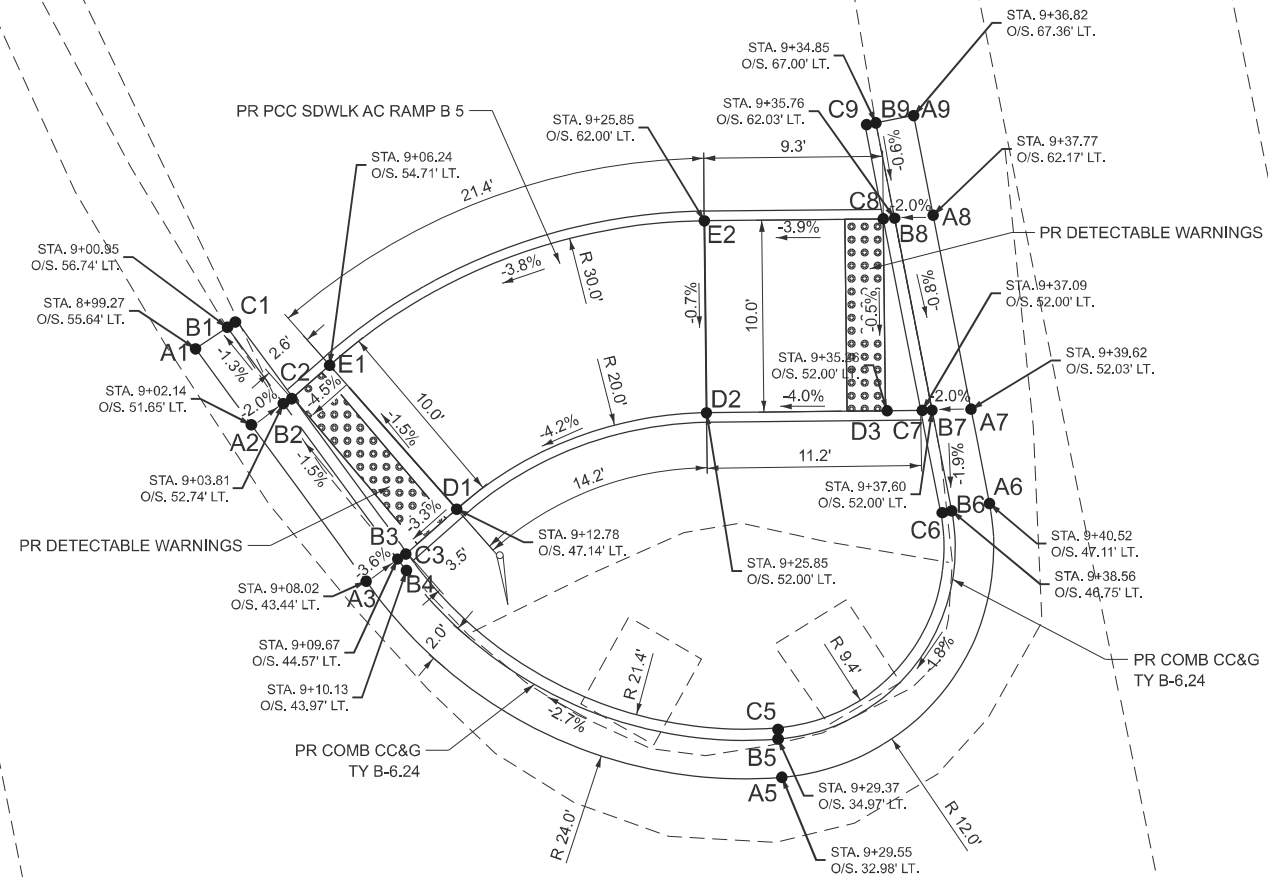
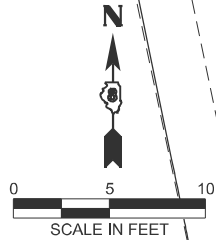

PR CURVE  
PI STA = 137+85.35  
 $\Delta = 03^\circ 42' 21''$  (LT)  
D = 01°00'00"  
R = 5,729.58'  
T = 185.35'  
L = 370.58'  
E = 3.00'  
e = \_\_\_\_\_  
TR = \_\_\_\_\_  
SE RUN = \_\_\_\_\_  
PC STA = 136+00.00  
PT STA = 139+70.58

REVISED SHEET 7-21-2025

MODEL: w CURB RAMP [Sheet]  
FILE NAME: c:\p\proj\jaatagana\cornershifrin.com\isolutions\29707\0876M55-shi-intersec.dgn



|           |             |
|-----------|-------------|
| USER NAME | = jaatagana |
| DRAWN     | -           |
| CHECKED   | -           |
| DATE      | -           |
| PLOT DATE | = 7/17/2025 |

|          |   |
|----------|---|
| DESIGNED | - |
| DRAWN    | - |
| CHECKED  | - |
| DATE     | - |

|         |   |
|---------|---|
| REVISED | - |
| REVISED | - |
| REVISED | - |
| REVISED | - |

STATE OF ILLINOIS  
DEPARTMENT OF TRANSPORTATION

CURB RAMP DETAILS  
IL ROUTE 203 AND OHIO ST.

SCALE: 1" = 5'

SHEET 1

OF 3

SHEETS

STA.

TO STA.

| F.A. RTE.          | SECTION        | COUNTY             | TOTAL SHEETS     | SHEET NO. |
|--------------------|----------------|--------------------|------------------|-----------|
| *                  | (580,581) RS-2 | ST. CLAIR          | 44               | 32A       |
| * FAP 594/FAU 9213 |                | CONTRACT NO. 76M55 |                  |           |
|                    |                | ILLINOIS           | FED. AID PROJECT |           |



| POINT | ELEVATION |
|-------|-----------|
| A1    | (410.32)  |
| A2    | (410.25)  |
| A3    | (410.17)  |
| A4    | (410.10)  |
| B1    | 410.29    |
| B2    | 410.21    |
| B3    | 410.13    |
| B4    | 410.06    |
| B5    | 410.11    |
| B6    | 410.01    |
| B7    | 410.45    |
| B8    | 410.33    |
| B9    | 410.49    |
| B10   | 410.34    |
| C1    | 410.33    |
| C2    | 410.25    |
| C3    | 410.17    |
| C4    | 410.10    |
| C5    | 410.61    |
| C6    | 410.51    |
| C7    | 410.95    |
| C8    | 410.83    |
| C9    | 410.99    |
| C10   | 410.84    |
| D1    | 410.19    |
| D2    | 410.16    |
| E1    | 410.28    |
| E2    | 410.22    |

LEGEND  
XXX.XX PR. ELEVATION  
(XXX.XX) EX. ELEVATION

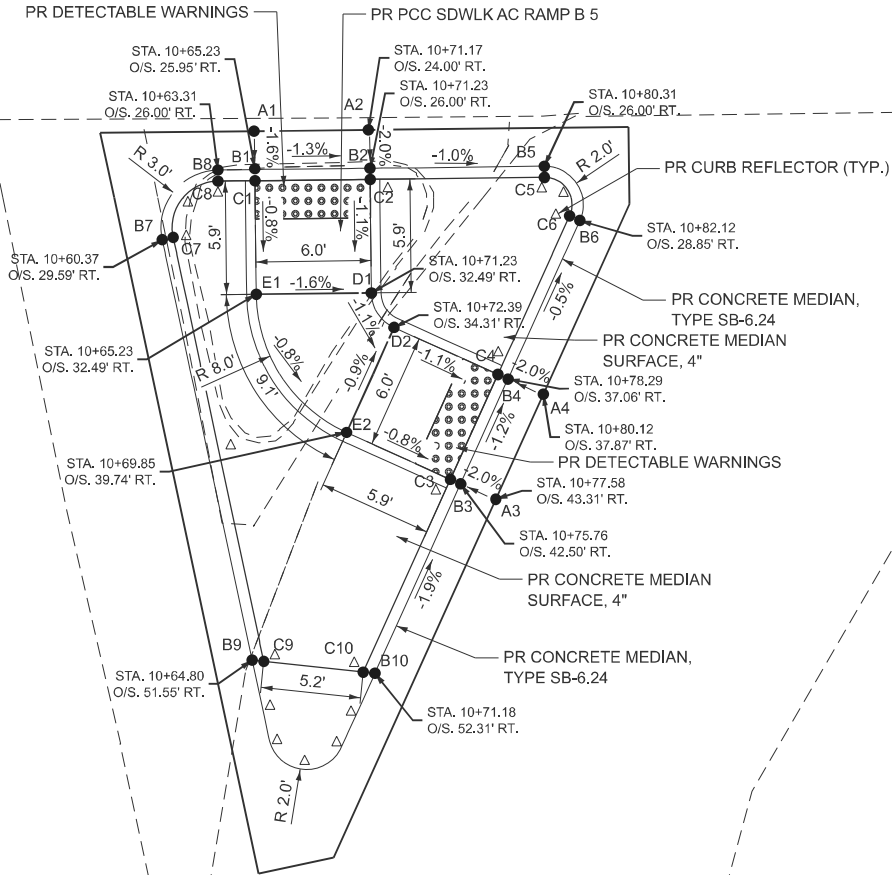

OHIO ST.

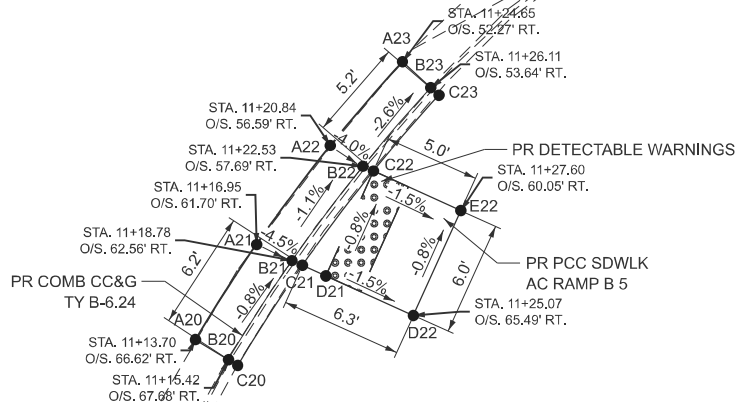
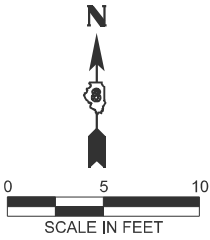

| POINT | ELEVATION |
|-------|-----------|
| A20   | (409.44)  |
| A21   | (409.37)  |
| A22   | (409.29)  |
| A23   | (409.22)  |
| B20   | (409.33)  |
| B21   | 409.28    |
| B22   | 409.21    |
| B23   | (409.07)  |
| C20   | (409.78)  |
| C21   | 409.32    |
| C22   | 409.25    |
| C23   | (409.35)  |
| D21   | 409.3     |
| D22   | 409.22    |
| E22   | 409.18    |

△ REVISED SHEET 7-21-2025

MODEL: S CURB RAMP [Sheet]  
FILE NAME: c:\p\p\c\jaatagana\cornershifrin.com\isolutions\29707\0876M55-shi-intersec.dgn



|                       |            |           |
|-----------------------|------------|-----------|
| USER NAME = jaatagana | DESIGNED - | REVISED - |
|                       | DRAWN -    | REVISED - |
|                       | CHECKED -  | REVISED - |
| PLOT DATE = 7/17/2025 | DATE -     | REVISED - |

STATE OF ILLINOIS  
DEPARTMENT OF TRANSPORTATION

CURB RAMP DETAILS  
IL ROUTE 203 AND OHIO ST.

SCALE: 1" = 5'    SHEET 2    OF 3    SHEETS    STA.    TO STA.

| F.A. RTE. | SECTION            | COUNTY             | TOTAL SHEETS | SHEET NO. |
|-----------|--------------------|--------------------|--------------|-----------|
| *         | (580,581) RS-2     | ST. CLAIR          | 44           | 32B       |
|           | * FAP 594/FAU 9213 | CONTRACT NO. 76M55 |              |           |
|           | ILLINOIS           | FED. AID PROJECT   |              |           |



| POINT | ELEVATION |
|-------|-----------|
| A1    | (410.36)  |
| A2    | (410.36)  |
| A3    | (410.33)  |
| A4    | (410.14)  |
| A5    | (410.08)  |
| A6    | N/A       |
| A7    | (409.50)  |
| A8    | N/A       |
| A9    | 409.01    |
| A10   | (408.79)  |
| B1    | (410.32)  |
| B2    | 410.26    |
| B3    | 410.22    |
| B4    | 410.1     |
| B5    | 410.01    |
| B6    | N/A       |
| B7    | 409.46    |
| B8    | N/A       |
| B9    | 408.97    |
| B10   | (408.74)  |
| C1    | 410.82    |
| C2    | 410.3     |
| C3    | 410.36    |
| C4    | 410.14    |
| C5    | 410.05    |
| C6    | N/A       |
| C7    | 409.96    |
| C8    | N/A       |
| C9    | 409.47    |
| C10   | (408.73)  |
| D1    | 410.28    |
| D2    | 410.32    |
| D3    | 410.35    |
| D4    | 410.42    |
| D5    | 410.33    |
| D6    | 410.57    |
| D7    | 410.22    |
| D8    | 409.93    |
| D9    | 409.65    |
| E1    | 410.43    |
| E2    | 410.6     |
| E3    | 410.5     |
| E4    | 410.57    |
| E5    | 410.48    |
| E6    | 410.72    |
| E7    | 410.37    |
| E8    | 410.05    |
| E9    | 409.65    |
| E10   | (408.55)  |

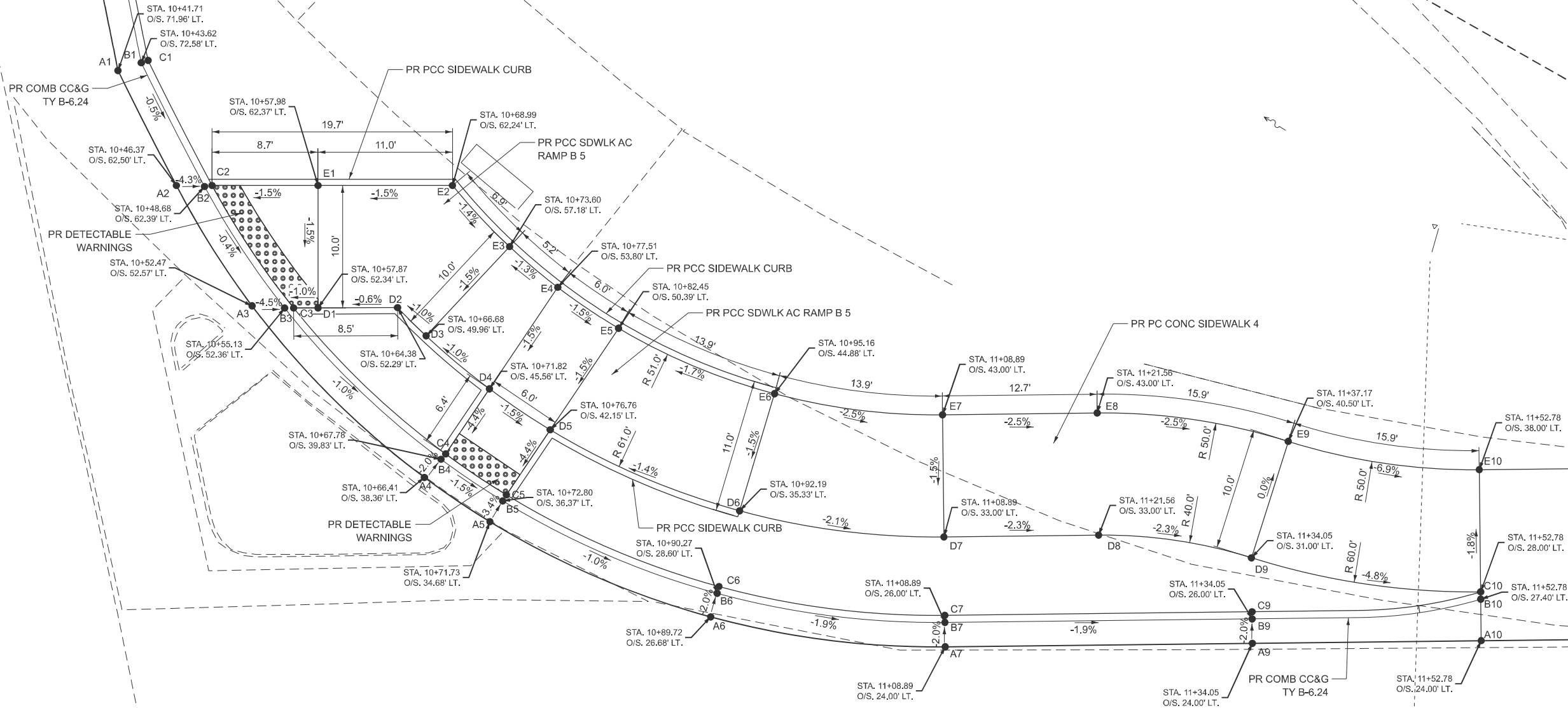

OHIO ST.

1 SHEET ADDED 7-21-2025

MODEL: E CURB RAMP [Sheet]  
FILE NAME: c:\p\p\c\jaatagana\horner\shifrin\com\isolutions\29707\0876M55-shi-intersec.dgn



|                       |            |           |
|-----------------------|------------|-----------|
| USER NAME = jaatagana | DESIGNED - | REVISED - |
|                       | DRAWN -    | REVISED - |
|                       | CHECKED -  | REVISED - |
| PLOT DATE = 7/17/2025 | DATE -     | REVISED - |

STATE OF ILLINOIS  
DEPARTMENT OF TRANSPORTATION

CURB RAMP DETAILS  
IL ROUTE 203 AND OHIO ST.

SCALE: 1" = 5'    SHEET 3    OF 3    SHEETS    STA.    TO STA.

| F.A. RTE. | SECTION            | COUNTY             | TOTAL SHEETS | SHEET NO. |
|-----------|--------------------|--------------------|--------------|-----------|
| *         | (580,581) RS-2     | ST. CLAIR          | 44           | 32C       |
|           | * FAP 594/FAU 9213 | CONTRACT NO. 76M55 |              |           |
|           | ILLINOIS           | FED. AID PROJECT   |              |           |



TRAFFIC SIGNAL GENERAL NOTES

1.

ALL VEHICLE AND PEDESTRIAN SIGNAL HEADS SHALL HAVE 12" L.E.D. SECTIONS. ALL MOUNTING HARDWARE, SIGNAL POSTS, AND BASES SHALL BE UNPAINTED ALUMINUM. ALL BOLTS, SCREWS, NUTS AND WASHERS SHALL BE STAINLESS STEEL. ANTI-SEIZE PASTE COMPOUND SHALL BE USED ON ALL MOUNTING HARDWARE FIELD CONNECTIONS.
2.

BACKPLATES SHALL BE ABS PLASTIC.
3.

THE LOCATION OF MAST ARM SUPPORTS SHALL BE APPROVED BY THE ENGINEER BEFORE FOUNDATIONS ARE CONSTRUCTED. MAST ARM POLES SHALL BE LOCATED A MINIMUM OF 10 FEET FROM THE EDGE OF PAVEMENT OR 2 FEET FROM THE EDGE OF SHOULDER, WHICHEVER DISTANCE IS GREATER. IN CURBED SECTIONS, THE MAST ARM POLES SHALL BE LOCATED A MINIMUM OF 5 FEET FROM THE FACE OF THE CURB. THESE DISTANCES ARE TO THE NEAR FACE OF THE MAST ARM POLE. ALL MAST ARMS AND POLES SHALL BE GALVANIZED.
4.

ALL TRAFFIC SIGNAL CABLES SHALL BE #14 AWG STRANDED COPPER UNLESS OTHERWISE SPECIFIED.
5.

THE LOCATION OF ALL DETECTOR LOOPS SHALL BE APPROVED BY THE ENGINEER BEFORE ANY SLOTS ARE SAWED IN THE PAVEMENT.
6.

DETECTOR LOOP LEAD-IN SPLICES SHALL BE MADE IN A HANDHOLE PER ARTICLE 873.03 OF THE STANDARD SPECIFICATIONS FOR ROAD AND BRIDGE CONSTRUCTION AND STANDARD DRAWING 886001. CONDUCTORS SHALL BE SPLICED IN A RIGID MOLD. ROSIN-CORE SOLDER SHALL BE USED.
7.

CALL DELAY SHALL NOT FUNCTION WHEN THE RELATED PHASES ARE IN THE GREEN MODE.
8.

ALL HANDHOLES SHALL BE CAST-IN-PLACE PORTLAND CEMENT CONCRETE (PER ARTICLE 814.03(A)). THE CAST IN PLACE LEGEND IN THE COVER SHALL BE "TRAFFIC SIGNALS". SLOPE HANDHOLE COVERS TO MATCH PROPOSED GRADE ELEVATIONS.
9.

ALL UTILITIES SHALL BE LOCATED IN THE FIELD PRIOR TO ANY ATTEMPT TO CONSTRUCT ANY COMPONENT OF THE VARIOUS TRAFFIC SIGNAL INSTALLATION. AGENCIES KNOWN TO HAVE UNDERGROUND FACILITIES WITHIN THE LIMITS OF THIS IMPROVEMENT ARE THE FOLLOWING: MEMBER OF J.U.L.I.E. PHONE (800) 892-0123 ARE INDICATED BY \* (CALL ONE WEEK BEFORE YOU PLAN TO DIG).

\*ILLINOIS AMERICAN WATER (WATER AND SEWER)

\*AT&T ILLINOIS (COMMUNICATION)

\*AMEREN ILLINOIS POWER (ELECTRIC AND GAS)
10.

ALL INDUCTIVE LOOP DETECTORS SUPPLIED FOR THIS PROJECT SHALL HAVE THE CAPACITY OF OPERATING WITH BOTH DELAY AND EXTENSION MODES ACTIVE, IF A TIME SETTING IS PROGRAMMED. THEY SHALL BE RACK MOUNTED.
11.

A 1/4" NYLON PULL ROPE SHALL BE FURNISHED AND INSTALLED IN ALL SIGNAL CONDUITS, THIS WORK SHALL BE INCLUDED WITH THE CONDUIT PAY ITEM.
12.

ALL THE PEDESTRIAN PUSH BUTTON LOCATIONS SHALL FOLLOW THE GUIDELINES FROM ADA AND PROWAG. THE LOCATION OF THE PEDESTRIAN PUSH BUTTON MUST BE PARALLEL TO THE CROSSWALK. A PEDESTRIAN PUSH BUTTON EXTENSION MAY BE NEEDED FOR THE ACCESSIBILITY AND CORRECT ALIGNMENT OF PEDESTRIAN PUSH BUTTON. THE EXTENSION SHALL BE INCLUDED IN THE COST IN THE PAY ITEM "ACCESSIBLE PEDESTRIAN SYSTEM".
13.

RESTORATION OF THE TRAFFIC SIGNAL WORK AREA SHALL BE INCIDENTAL TO THE RELATED PAY ITEM SUCH AS FOUNDATION, CONDUIT, HANDHOLE, TRENCH AND BACKFILL, ETC., AND NO EXTRA COMPENSATION SHALL BE ALLOWED. ALL ROADWAY SURFACES SUCH AS SHOULDERS, MEDIANS, SIDEWALKS, PAVEMENT, ETC. SHALL BE REPLACED IN KIND. ALL DAMAGE TO MOWED LAWNS SHALL BE REPLACED WITH AN APPROVED SOD, AND ALL DAMAGE TO UNMOWED FIELDS SHALL BE SEEDED IN ACCORDANCE WITH STANDARD SPECIFICATIONS 252 AND 250, RESPECTIVELY.

HIGHWAY STANDARDS

|           |  |
|-----------|--|
| 720001-01 | SIGN PANEL MOUNTING DETAILS                          |
| 814006-03 | DOUBLE HANDHOLES                                     |
| 857001-01 | STANDARD PHASE DESIGNATION DIAGRAMS - PHASE SEQUENCE |
| 873001-02 | TRAFFIC SIGNAL GROUNDING AND BONDING                 |
| 876001-04 | PEDESTRIAN PUSH BUTTON POST                          |
| 877001-08 | STEEL MAST ARM ASSEMBLY AND POLE 16' THROUGH 55'     |
| 878001-11 | CONCRETE FOUNDATION DETAILS                          |
| 880006-01 | TRAFFIC SIGNAL MOUNTING DETAILS                      |
| 886001-01 | DETECTOR LOOP INSTALLATIONS                          |
| 886006-01 | TYPICAL LAYOUTS FOR DETECTION LOOPS                  |

DETECTOR LOOP REQUIREMENTS  
AND CALCULATIONS

|   | LOOP       | PHASE<br>(Φ) | LOOP SIZE<br>(FT) | REQUIRED<br># OF<br>TURNS | CALCULATED<br>INDUCTANCE<br>MICROHENRIES<br>(μH) | CALCULATED<br>RESISTANCE<br>OHMS<br>(Ω) |
|---|------------|--------------|-------------------|---------------------------|--|---|
| 1 | WB THRU CD | 1            | 6' X 50' (Q)      | 3-6-3                     | 859.3  | 3.3                                     |
| 2 | WB LT CD   | 1            | 6' X 50' (Q)      | 3-6-3                     | 856.4  | 3.2                                     |
| 3 | NB LT CD   | 3            | 6' X 50' (Q)      | 3-6-3                     | 834.0  | 2.7                                     |
| 4 | NB LT CD   | 3            | 6' X 50' (Q)      | 3-6-3                     | 831.3  | 2.6                                     |
| 5 | SB LT CD   | 7            | 6' X 50' (Q)      | 3-6-3                     | 833.1  | 2.7                                     |
| 6 | NB RT CD   | 8            | 6' X 40' (Q)      | 3-6-3                     | 675.6  | 2.2                                     |
| 7 | NB RT CD   | 8            | 6' X 40' (Q)      | 3-6-3                     | 694.3  | 2.6                                     |
| 8 | NB RT CD   | 8            | 6' X 40' (Q)      | 3-6-3                     | 693.6  | 2.6                                     |

THE ABOVE VALUES ARE CALCULATED OF COMBINED LOOP AND LEAD-IN INDUCTANCE AND RESISTANCE. ACTUAL MEASURED VALUES SHOULD BE WITHIN +/- 20% OF THESE VALUES.

| SCHEDULE OF QUANTITIES |   |       | IL ROUTE 203 &<br>OHIO STREET |
|------------------------|---|-------|-------------------------------|
| CODE NO.               | ITEM  | UNIT  |                               |
| 72000100               | SIGN PANEL, TYPE 1  | SQ FT | 13.1                          |
| 81028350               | UNDERGROUND CONDUIT, PVC, 2" DIA.   | FOOT  | 16                            |
| 81028370               | UNDERGROUND CONDUIT, PVC, 3" DIA.   | FOOT  | 136                           |
| 81028390               | UNDERGROUND CONDUIT, PVC, 4" DIA.   | FOOT  | 191                           |
| 81028400               | UNDERGROUND CONDUIT, PVC, 5" DIA.   | FOOT  | 128                           |
| 81028730               | UNDERGROUND CONDUIT, COILABLE NONMETALLIC CONDUIT, 1 1/4" DIA.            | FOOT  | 47                            |
| 81400300               | DOUBLE HANDHOLE   | EACH  | 1                             |
| 85000200               | MAINTENANCE OF EXISTING TRAFFIC SIGNAL INSTALLATION                       | EACH  | 1                             |
| 87301215               | ELECTRIC CABLE IN CONDUIT, SIGNAL NO. 14 2C                               | FOOT  | 1540                          |
| 87301235               | ELECTRIC CABLE IN CONDUIT, SIGNAL NO. 14 4C                               | FOOT  | 1550                          |
| 87301245               | ELECTRIC CABLE IN CONDUIT, SIGNAL NO. 14 5C                               | FOOT  | 3160                          |
| 87301255               | ELECTRIC CABLE IN CONDUIT, SIGNAL NO. 14 7C                               | FOOT  | 780                           |
| 87301305               | ELECTRIC CABLE IN CONDUIT, LEAD-IN, NO. 14 1PAIR                          | FOOT  | 1840                          |
| 87301900               | ELECTRIC CABLE IN CONDUIT, EQUIPMENT GROUNDING CONDUCTOR, NO. 6 1C        | FOOT  | 910                           |
| 87501100               | TRAFFIC SIGNAL POST, 15 FT.   | EACH  | 3                             |
| 87600100               | PEDESTRIAN PUSH-BUTTON POST, TYPE I                                       | EACH  | 1                             |
| 87700190               | STEEL MAST ARM ASSEMBLY AND POLE, 30 FT.                                  | EACH  | 1                             |
| 87800100               | CONCRETE FOUNDATION, TYPE A   | FOOT  | 16                            |
| 87800415               | CONCRETE FOUNDATION, TYPE E 36-INCH DIAMETER                              | FOOT  | 11                            |
| 87900200               | DRILL EXISTING HANDHOLE   | EACH  | 9                             |
| 88030020               | SIGNAL HEAD, LED, 1-FACE, 3-SECTION, MAST-ARM MOUNTED                     | EACH  | 2                             |
| 88030050               | SIGNAL HEAD, LED, 1-FACE, 3-SECTION, BRACKET MOUNTED                      | EACH  | 4                             |
| 88030070               | SIGNAL HEAD, LED, 1-FACE, 4-SECTION, BRACKET MOUNTED                      | EACH  | 1                             |
| 88030080               | SIGNAL HEAD, LED, 1-FACE, 4-SECTION, MAST-ARM MOUNTED                     | EACH  | 1                             |
| 88102717               | PEDESTRIAN SIGNAL HEAD, LED, 1-FACE, BRACKET MOUNTED WITH COUNTDOWN TIMER | EACH  | 4                             |
| 88102747               | PEDESTRIAN SIGNAL HEAD, LED, 2-FACE, BRACKET MOUNTED WITH COUNTDOWN TIMER | EACH  | 1                             |
| 88200100               | TRAFFIC SIGNAL BACKPLATE  | EACH  | 3                             |
| 88500100               | INDUCTIVE LOOP DETECTOR   | EACH  | 2                             |
| 88600100               | DETECTOR LOOP, TYPE I   | FOOT  | 1240                          |
| 89500100               | RELOCATE EXISTING SIGNAL HEAD   | EACH  | 5                             |
| 89602200               | MODIFY EXISTING CONTROLLER  | EACH  | 1                             |
| 89502375               | REMOVE EXISTING TRAFFIC SIGNAL EQUIPMENT                                  | EACH  | 1                             |
| 89502380               | REMOVE EXISTING HANDHOLE  | EACH  | 1                             |
| 89502385               | REMOVE EXISTING CONCRETE FOUNDATION                                       | EACH  | 3                             |
| X8760200               | ACCESSIBLE PEDESTRIAN SIGNALS   | EACH  | 6                             |

△ SHEET ADDED 7-21-2025

MODEL: TS01 [Sheet]  
FILE NAME: c:\p\p\o\ahernandez\hornershifrin.com\td\tdms29\07\08\76\6M55-sh-t-TS01.dgn



|                         |            |           |
|-------------------------|------------|-----------|
| USER NAME = ahernandez  | DESIGNED - | REVISED - |
|                         | DRAWN -    | REVISED - |
| PLOT SCALE = \$\$CALE\$ | CHECKED -  | REVISED - |
| PLOT DATE = 7/17/2025   | DATE -     | REVISED - |

STATE OF ILLINOIS  
DEPARTMENT OF TRANSPORTATION

TRAFFIC SIGNAL DETAILS  
IL ROUTE 203 AND OHIO AVE

SCALE: N/A    SHEET 1    OF   4    SHEETS    STA.    TO STA.

| F.A.<br>RTE.       | SECTION        | COUNTY                      | TOTAL<br>SHEETS | SHEET<br>NO. |
|--------------------|----------------|-----------------------------|-----------------|--------------|
| *                  | (580,581) RS-2 | ST. CLAIR                   | 44              | 32D          |
| * FAP 594/FAU 9213 |                | CONTRACT NO. 76M55          |                 |              |
|                    |                | ILLINOIS   FED. AID PROJECT |                 |              |



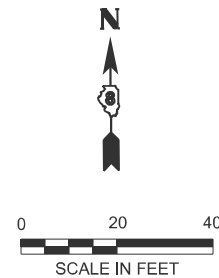

TRAFFIC SIGNAL FACES

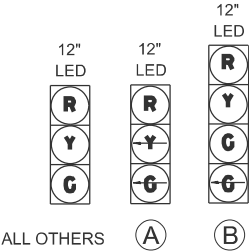

PHASE DESIGNATION DIAGRAM

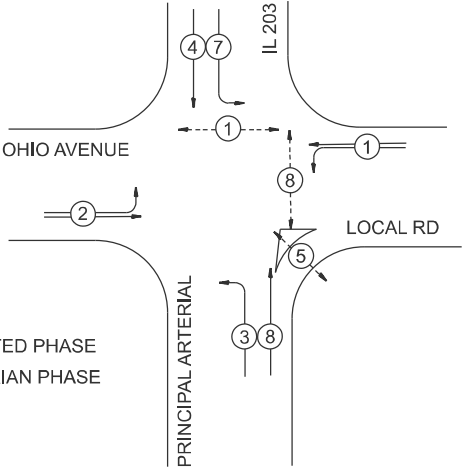

LEGEND



SIGNS



①  
R10-10  
30" x 36"

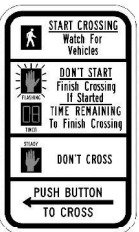

②  
R10-3eL  
9" x 15"



③  
R10-3eR  
9" x 15"

ENTRANCE TO  
TECHNOLOGY  
RACEWAY

TRAFFIC SIGNAL LEGEND

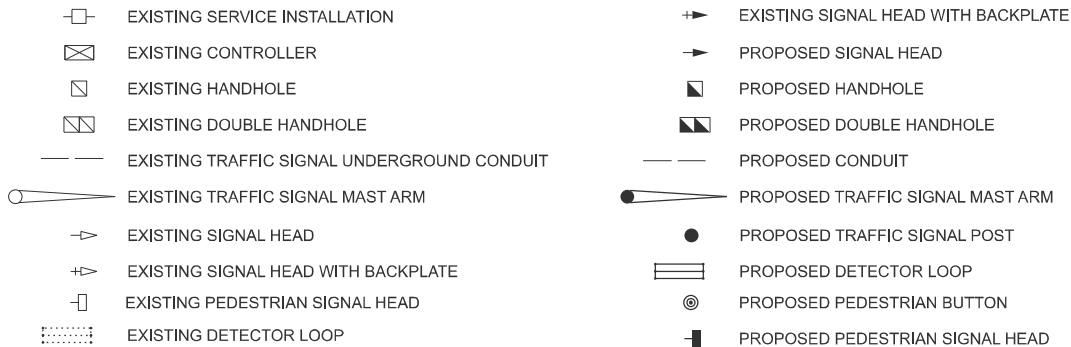

NOTES:

- EXISTING TRAFFIC SIGNAL EQUIPMENT AND HANDHOLES NOTED ON THIS SHEET SHALL BE REMOVED BY THE CONTRACTOR AND SHALL BE DISPOSED OF BY THEM OUTSIDE THE RIGHT-OF-WAY AT THEIR EXPENSE. THE SALVAGE VALUE OF THE REMOVED EQUIPMENT SHALL BE REFLECTED IN THE CONTRACT UNIT COST FOR "REMOVE EXISTING TRAFFIC SIGNAL EQUIPMENT".
- REMOVAL OF EXISTING SIGNAL ELECTRIC CABLE SHALL BE INCLUDED IN THE CONTRACT UNIT COST FOR "REMOVE EXISTING TRAFFIC SIGNAL EQUIPMENT". THE SALVAGE VALUE OF THE REMOVED CABLES SHALL BE REFLECTED IN THE CONTRACT BID PRICE. EXISTING TRAFFIC SIGNAL CONDUIT CAN BE ABANDONED IN PLACE, AS NEEDED.
- EACH DETECTOR LOOP SHALL HAVE ITS OWN 1 1/4" COILABLE NON-METALLIC CONDUIT BETWEEN THE EDGE OF PAVEMENT AND THE ADJACENT HANDHOLE, AS SHOWN ON THE PLANS AND STANDARD PLAN 886001.

△ SHEET ADDED 7-21-2025

STATE OF ILLINOIS  
DEPARTMENT OF TRANSPORTATION

TRAFFIC SIGNAL PLANS  
IL ROUTE 203 AND OHIO AVE

SCALE: 1"=20' SHEET 2 OF 4 SHEETS STA. TO STA.

| F.A. RTE.          | SECTION        | COUNTY             | TOTAL SHEETS | SHEET NO. |
|--------------------|----------------|--------------------|--------------|-----------|
| *                  | (580,581) RS-2 | ST. CLAIR          | 44           | 32E       |
| * FAP 594/FAU 9213 |                | CONTRACT NO. 76M55 |              |           |
| ILLINOIS           |                | FED. AID PROJECT   |              |           |

MODEL: TS-02 [Sheet]  
FILE NAME: c:\p\p\p\ahernandez\ahernandez\ts02\ts02.dgn



|                        |            |           |
|------------------------|------------|-----------|
| USER NAME = ahernandez | DESIGNED - | REVISED - |
|                        | DRAWN -    | REVISED - |
|                        | CHECKED -  | REVISED - |
| PLOT DATE = 7/17/2025  | DATE -     | REVISED - |











THERMOPLASTIC PAVEMENT  
MARKING - LINE 6" SOLID WHITE

RAISED REFLECTIVE PAVEMENT  
MARKER - ONE WAY CRYSTAL (TYP)

THERMOPLASTIC PAVEMENT  
MARKING - LINE 24" WHITE  
(TYP)

THERMOPLASTIC PAVEMENT  
MARKING - LINE 12" SOLID WHITE

THERMOPLASTIC PAVEMENT  
MARKING - LINE 6" DOUBLE YELLOW

THERMOPLASTIC PAVEMENT  
MARKING - LINE 6" SOLID WHITE

THERMOPLASTIC PAVEMENT  
MARKING - LINE 12" WHITE LINE  
AT 20' O.C. (TYP)

THERMOPLASTIC PAVEMENT  
MARKING - LINE 12" YELLOW LINE  
AT 30' O.C. (TYP)

THERMOPLASTIC PAVEMENT  
MARKING - LINE 6" DOUBLE YELLOW

THERMOPLASTIC PAVEMENT  
MARKING - LINE 6" SOLID YELLOW

THERMOPLASTIC PAVEMENT  
MARKING - LINE 6" SOLID WHITE

THERMOPLASTIC PAVEMENT  
MARKING - LINE 6" WHITE SKIP  
DASH 10'-30' (TYP)

THERMOPLASTIC PAVEMENT  
MARKING - LINE 6" WHITE 2'-6"  
SKIP DASH LINE (TYP)

OHIO ST.

THERMOPLASTIC PAVEMENT  
MARKING - LINE 12" WHITE LINE  
AT 20' O.C. (TYP)

THERMOPLASTIC PAVEMENT  
MARKING - LETTERS & SYMBOLS  
(TYP)

THERMOPLASTIC PAVEMENT  
MARKING - LINE 8" WHITE (TYP)

RAISED REFLECTIVE PAVEMENT  
MARKER - ONE WAY CRYSTAL (TYP)



MATCHLINE STA. 139+35.09

MATCHLINE STA. 135+97.95

MODEL: Pavement Marking [Sheet]  
FILE NAME: c:\pav\_work\pav\illinois.gov\_edison.zohfanyi\108652D76M55-sh-pmk.dgn

STATE OF ILLINOIS  
DEPARTMENT OF TRANSPORTATION

PAVEMENT MARKING  
IL 203 AT OHIO ST.

SCALE: 1:20 SHEET 1 OF 3 SHEETS STA. TO STA.

1 REVISED SHEET 7-21-2025

|                             |            |           |
|-----------------------------|------------|-----------|
| USER NAME = edison.zohfanyi | DESIGNED - | REVISED - |
|                             | DRAWN -    | REVISED - |
|                             | CHECKED -  | REVISED - |
| PLOT DATE = 6/20/2025       | DATE -     | REVISED - |

| F.A.*<br>RTE.      | SECTION       | COUNTY             | TOTAL<br>SHEETS  | SHEET<br>NO. |
|--------------------|---------------|--------------------|------------------|--------------|
| *                  | (580,581)RS-2 | ST. CLAIR          | 44               | 33           |
| * FAP 594/FAU 9213 |               | CONTRACT NO. 76M55 |                  |              |
|                    |               | ILLINOIS           | FED. AID PROJECT |              |



| SCHEDULE OF QUANTITIES |                           |      | TOTAL<br>QUANTITIES | IL 203<br>AT<br>OHIO ST. |
|------------------------|---------------------------|------|---------------------|--------------------------|
| CODE NO                | ITEM                      | UNIT |                     |                          |
| X8860105               | DETECTOR LOOP REPLACEMENT | FOOT | 1548                | 1548                     |



HIGHWAY STANDARDS

886001-01 DETECTOR LOOP INSTALLATIONS  
886006-01 TYPICAL LAYOUT FOR DETECTOR LOOPS

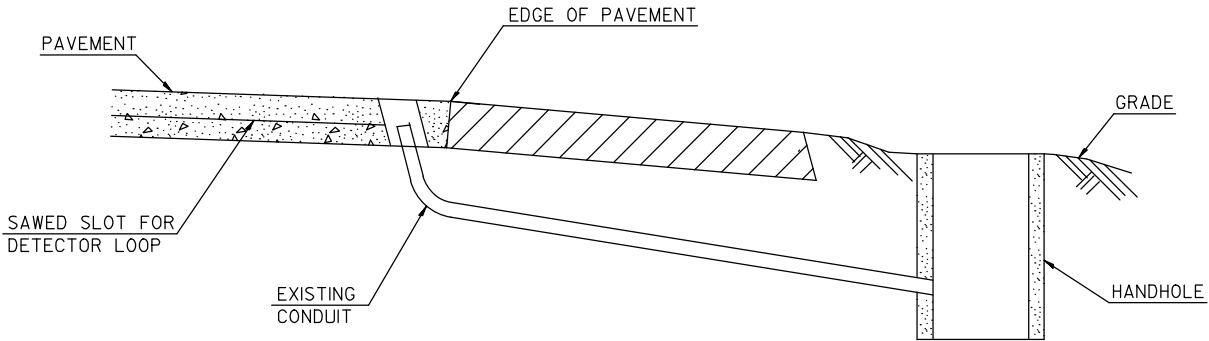

DETAIL  
(NO SCALE)

RE-USE EXISTING DETECTOR LOOP LEAD-IN CONDUIT

- 1 DRILL OUT PAVEMENT SEALANT AND CLEAN EXISTING CONDUIT.
- 2 REMOVE EXISTING CABLE TO HANDHOLE.
- 3 INSTALL LOOP LEAD-IN CONDUCTORS IN CONDUIT.
- 4 SPLICE NEW DETECTOR LOOP LEAD-IN CONDUCTORS TO EXISTING LEAD-IN CABLE IN HANDHOLE.
- 5 FILL HOLE WITH APPROVED SEALER. PREVENT SEALER FROM ENTERING INTO CONDUIT.

NOT A PAY ITEM. THE COST OF THIS WORK SHALL BE INCLUDED IN THE PAY ITEM "DETECTOR LOOP, TYPE I"

△1 REVISED 7-21-2025

MODEL: Detector loop-1 [Sheet]  
FILE NAME: c:\p\work\pwt\illinois.gov\edison.zohfanyi\illinois.gov\edison.zohfanyi\08652D76M55-shs.dgn

|  |                             |            |           |   |  |         |      |                                       |               |           |                           |              |
|--|-----------------------------|------------|-----------|---|--|---------|------|---------------------------------------|---------------|-----------|---------------------------|--------------|
|  | USER NAME = edison.zohfanyi | DESIGNED - | REVISED - | STATE OF ILLINOIS<br>DEPARTMENT OF TRANSPORTATION | DETECTOR LOOP REPLACEMENT, HIGHWAY STANDARD,<br>GENERAL NOTES, SCHEDULE OF QUANTITIES AND DETAIL |         |      | F.A.*<br>RTE.                         | SECTION       | COUNTY    | TOTAL<br>SHEETS           | SHEET<br>NO. |
|  |                             | DRAWN -    | REVISED - |   |  |         |      | *                                     | (580,581)RS-2 | ST. CLAIR | 44                        | 39           |
|  |                             | CHECKED -  | REVISED - |   |  |         |      | * FAP 594/FAU 9213 CONTRACT NO. 76M55 |               |           |                           |              |
|  | PLOT DATE = 7/16/2025       | DATE -     | REVISED - |   | SCALE: NTS   | SHEET 1 | OF 3 | SHEETS                                | STA.          | TO STA.   | ILLINOIS FED. AID PROJECT |              |



MODEL: Detector loop-2 [Sheet]  
FILE NAME: c:\p\work\pvt\illinois.gov\108652\2076M55-shs.dgn

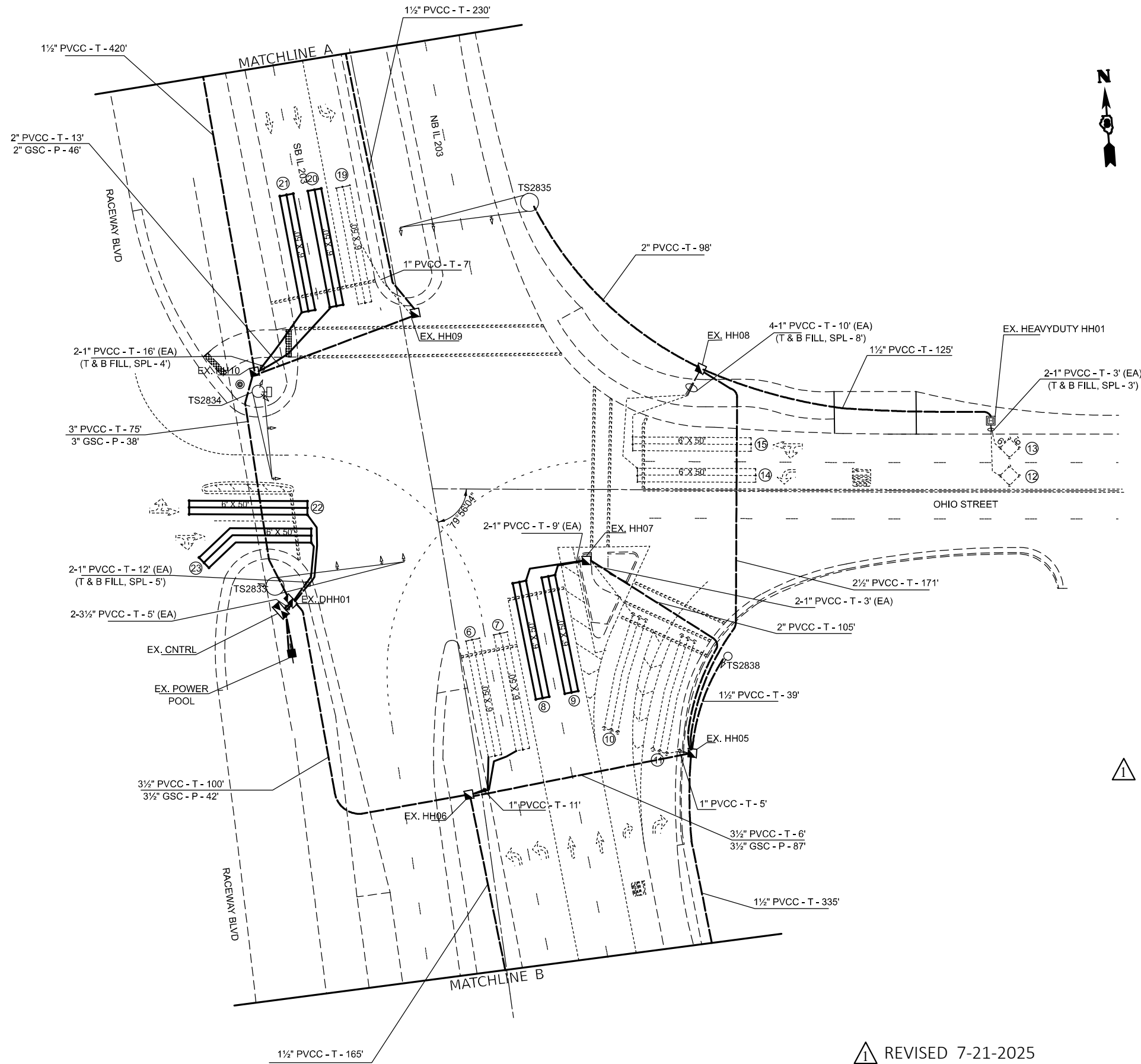

1 REVISD 7-21-2025

1

| LOOP              | PHASE<br>(Φ) | LOOP<br>SIZE<br>(FT. X FT.) | REQUIRED<br># OF<br>TURNS | CACULATED<br>INDUCTANCE<br>MICROHENRIES<br>(μH) | CALCULATED<br>RESISTANCE<br>OHMS<br>(Ω) |
|-------------------|--------------|-----------------------------|---------------------------|---|---|
| 1. NB CCO         | 2            | 6' X 6'                     | 7                         | 502.87  | 3.53                                    |
| 2. NB CCO         | 2            | 6' X 6'                     | 7                         | 502.21  | 3.52                                    |
| 3. NB CCO         |              | 6' X 6'                     | 7                         | 499.79  | 3.46                                    |
| 4. NB LT CCO      | 5            | 6' X 6'                     | 6                         | 326.16  | 1.98                                    |
| 5. NB LT CCO      | 5            | 6' X 6'                     | 6                         | 328.58  | 2.04                                    |
| 6. NB LT CD       | 5            | 6' X 50'(Q)                 | 3-6-3                     | 858.82  | 3.25                                    |
| 7. NB LT CD       | 5            | 6' X 50'(Q)                 | 3-6-3                     | 862.34  | 3.33                                    |
| 8. NB THRU CD     | 2            | 6' X 50'(Q)                 | 3-6-3                     | 868.28  | 3.46                                    |
| 9. NB THRU CD     | 2            | 6' X 50'(Q)                 | 3-6-3                     | 866.74  | 3.43                                    |
| 10. NB RT CD      |              | 6' X 50'(Q)                 | 3-6-3                     | 866.74  | 3.43                                    |
| 11. NB RT CD      |              | 6' X 50'(Q)                 | 3-6-3                     | 811.08  | 2.16                                    |
| 12. WB CCO        |              | 6' X 6'                     | 6                         | 308.78  | 1.59                                    |
| 13. WB CCO        |              | 6' X 6'                     | 6                         | 306.14  | 1.53                                    |
| 14. WB LT CD      |              | 6' X 50'(Q)                 | 3-6-3                     | 853.98  | 3.14                                    |
| 15. WB LT/THRU CD |              | 6' X 50'(Q)                 | 3-6-3                     | 851.12  | 3.07                                    |
| 16. SB LT CCO     | 1            | 6' X 6'                     | 6                         | 309.78  | 1.59                                    |
| 17. SB CCO        | 6            | 6' X 6'                     | 7                         | 491.65  | 3.28                                    |
| 18. SB CCO        | 6            | 6' X 6'                     | 7                         | 488.35  | 3.2                                     |
| 19. SB LT CD      | 1            | 6' X 50'(Q)                 | 3-6-3                     | 840.78  | 2.84                                    |
| 20. SB THRU CD    | 6            | 6' X 50'(Q)                 | 3-6-3                     | 819.66  | 2.36                                    |
| 21. SB THRU CD    | 6            | 6' X 50'(Q)                 | 3-6-3                     | 816.8   | 2.29                                    |
| 22. EB LT/THRU CD |              | 6' X 50'(Q)                 | 3-6-3                     | 795.9   | 1.82                                    |
| 23. EB RT/THRU CD |              | 6' X 50'(Q)                 | 3-6-3                     | 792.82  | 1.75                                    |

THE ABOVE VALUES ARE CALCULATED OF COMBINED LOOP AND LEAD-IN INDUCTANCE AND RESISTANCE. ACTUAL MEASURED VALUES SHOULD BE WITHIN +/- 20% OF THESE VALUES.

Q=QUADRAPOLE

|                             |            |           |
|-----------------------------|------------|-----------|
| USER NAME = edison.zohfonyl | DESIGNED - | REVISED - |
|                             | DRAWN -    | REVISED - |
|                             | CHECKED -  | REVISED - |
| PLOT DATE = 7/16/2025       | DATE -     | REVISED - |

STATE OF ILLINOIS  
DEPARTMENT OF TRANSPORTATION

DETECTOR LOOP REPLACEMENT PLAN  
RELATED TO RESURFACING, IL 203 AT OHIO ST.

SCALE: 1:50

SHEET 2 OF 3 SHEETS

STA.

TO STA.

| F.A.*<br>RTE.      | SECTION       | COUNTY             | TOTAL<br>SHEETS  | SHEET<br>NO. |
|--------------------|---------------|--------------------|------------------|--------------|
| *                  | (580.581)RS-2 | ST. CLAIR          | 44               | 40           |
| * FAP 594/FAU 9213 |               | CONTRACT NO. 76M55 |                  |              |
|                    |               | ILLINOIS           | FED. AID PROJECT |              |



MODEL: Detector loop-3 [Sheet]  
FILE NAME: c:\p\work\pvt\illinois.gov\108652\76M55-shs.dgn

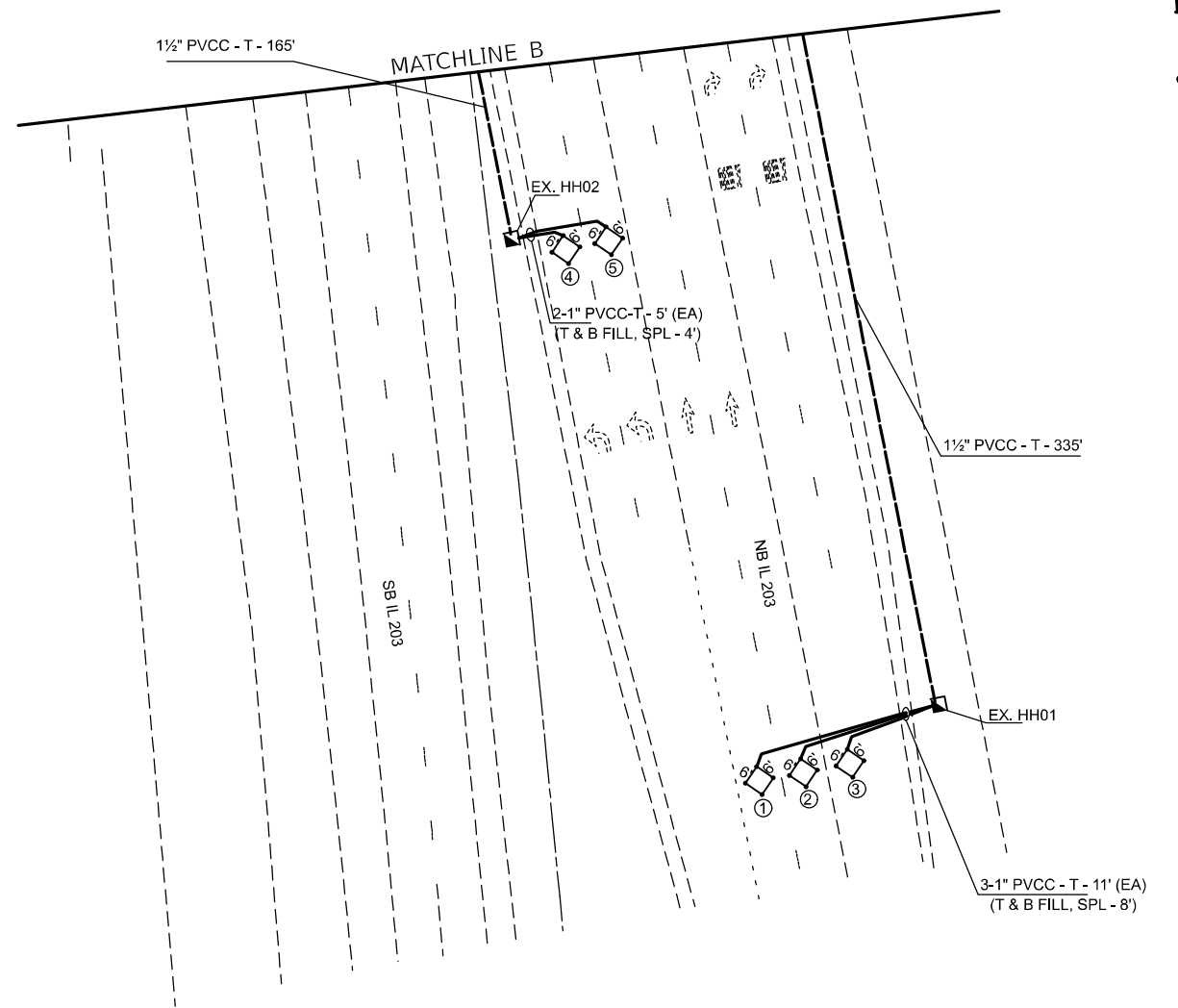
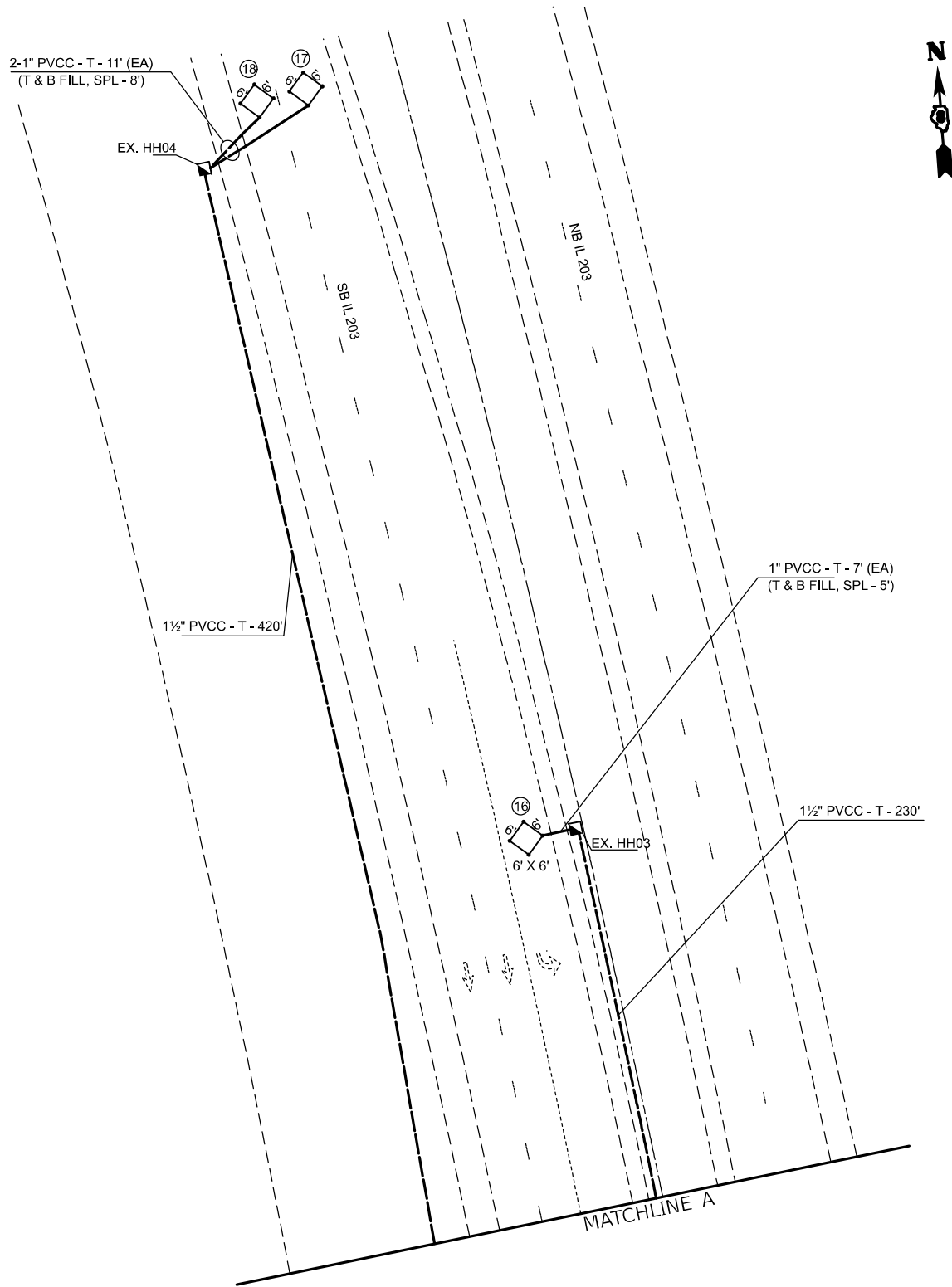

1 REVISED SHEET 7-21-2025

|                             |            |           |
|-----------------------------|------------|-----------|
| USER NAME = edison.zohforyi | DESIGNED - | REVISED - |
|                             | DRAWN -    | REVISED - |
|                             | CHECKED -  | REVISED - |
| PLOT DATE = 7/16/2025       | DATE -     | REVISED - |

STATE OF ILLINOIS  
DEPARTMENT OF TRANSPORTATION

DETECTOR LOOP REPLACEMENT PLAN  
RELATED TO RESURFACING, IL 203 AT OHIO ST.

SCALE: 1:50 SHEET 3 OF 3 SHEETS STA. TO STA.

| F.A.*<br>RTE.      | SECTION       | COUNTY                    | TOTAL<br>SHEETS | SHEET<br>NO. |
|--------------------|---------------|---------------------------|-----------------|--------------|
| *                  | (580,581)RS-2 | ST. CLAIR                 | 44              | 41           |
| * FAP 594/FAU 9213 |               | CONTRACT NO. 76M55        |                 |              |
|                    |               | ILLINOIS FED. AID PROJECT |                 |              |