

STATE OF ILLINOIS
DEPARTMENT OF TRANSPORTATION
DIVISION OF HIGHWAYS

**PROPOSED
HIGHWAY PLANS**

F.A.P. ROUTE 531: MANHATTAN-MONEE RD
SCHOOLHOUSE ROAD TO CENTER ROAD
SECTION: 40X-RS-9
RESURFACING
WILL COUNTY
C-91-341-11

F.A.P. RTE.	SECTION	COUNTY	TOTAL SHEETS	SHEET NO.
531	40X-RS-9	WILL	18	1
ILLINOIS			CONTRACT NO. 60N71	

FOR INDEX OF SHEETS, SEE SHEET NO. 2

IMPROVEMENT LOCATED IN MANHATTAN &
GREEN GARDEN TOWNSHIPS

TRAFFIC DATA

2008 ADT = 4,600
POSTED SPEED LIMIT: 55 MPH

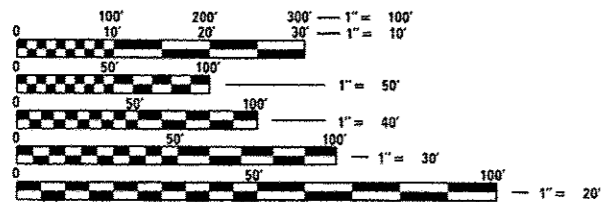

FULL SIZE PLANS HAVE BEEN PREPARED USING STANDARD ENGINEERING SCALES. REDUCED SIZED PLANS WILL NOT CONFORM TO STANDARD SCALES. IN MAKING MEASUREMENTS ON REDUCED PLANS, THE ABOVE SCALES MAY BE USED.

J.U.L.I.E.
JOINT UTILITY LOCATION INFORMATION FOR EXCAVATION
1-800-892-0123
OR 811

PROJECT ENGINEER: J. ALAIN MIDY (847) 221-3056
PROJECT MANAGER: ISSAM RAYYAN (847) 705-4178

CONTRACT NO. 60N71

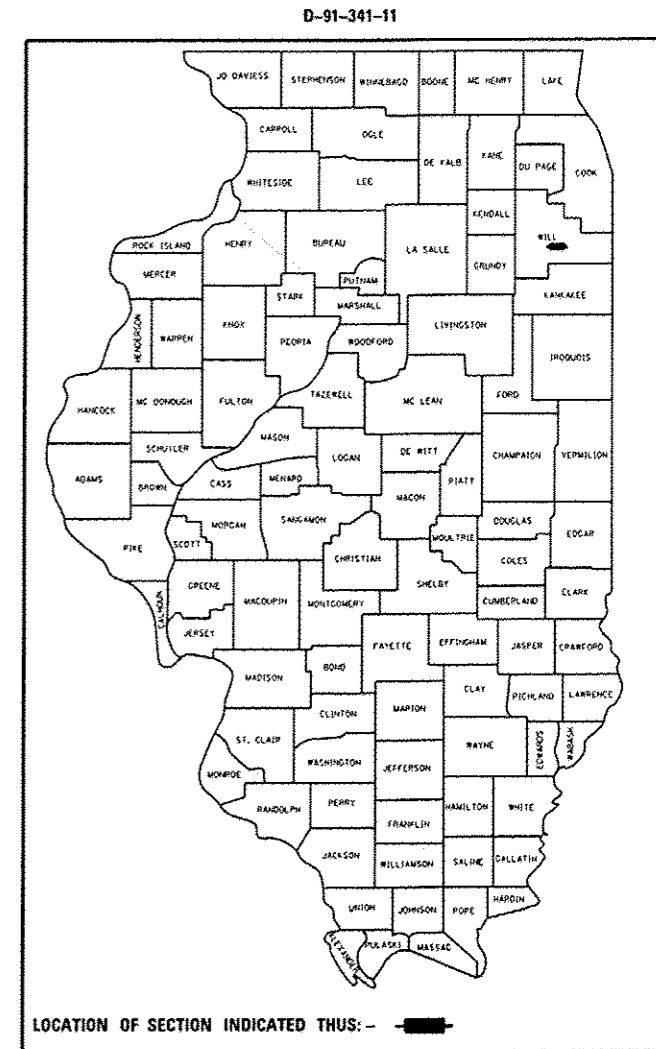

LOCATION OF SECTION INDICATED THUS: - [black rectangle]

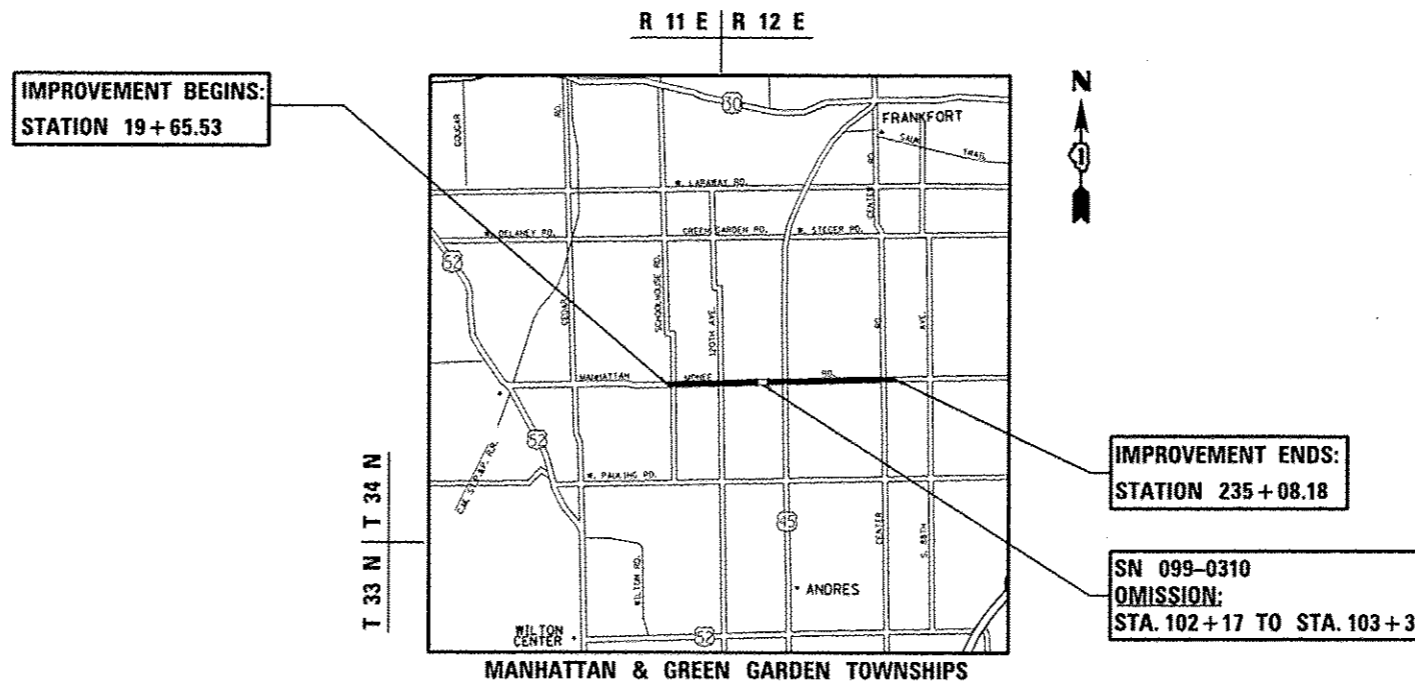

GROSS LENGTH OF IMPROVEMENT = 21,542.65 FEET = 4.08 MILES
NET LENGTH OF IMPROVEMENT = 21,423.65 FEET = 4.06 MILES

IMPROVEMENT ENDS:
STATION 235+08.18

SN 099-0310
OMISSION:
STA. 102+17 TO STA. 103+36

STATE OF ILLINOIS
DEPARTMENT OF TRANSPORTATION
DIVISION OF HIGHWAYS

SUBMITTED *January 31, 2013*
John P. ...
DEPUTY DIRECTOR OF HIGHWAYS, REGION ENGINEER

March 22, 2013
John D. ...
ENGINEER OF DESIGN AND ENVIRONMENT

March 22, 2013
Orin ...
DIRECTOR OF HIGHWAYS, CHIEF ENGINEER

PRINTED BY THE AUTHORITY
OF THE STATE OF ILLINOIS

INDEX OF SHEETS:

SHEET:	DESCRIPTION:
1	TITLE SHEET
2	INDEX OF SHEETS, STATE STANDARDS AND GENERAL NOTES
3	SUMMARY OF QUANTITIES
4	TYPICAL ROADWAY CROSS-SECTIONS
5 - 12	ROADWAY & PAVEMENT MARKING PLAN
13	PAVEMENT PATCHING FOR HMA SURFACED PAVEMENT (BD-22)
14	BUTT JOINT AND HMA TAPER DETAILS (BD-32)
15	TRAFFIC CONTROL AND PROTECTION FOR SIDE ROADS, INTERSECTIONS AND DRIVEWAYS (TC-10)
16	TYPICAL APPLICATIONS RAISED REFLECTIVE PAVEMENT MARKERS (SNOW PLOW RESISTANT) (TC-11)
17	DISTRICT ONE TYPICAL PAVEMENT MARKINGS (TC-13)
18	ARTERIAL ROAD INFORMATION SIGN (TC-22)

STATE STANDARDS:

442201-03	CLASS C AND D PATCHES
701011-03	OFF-RD MOVING OPERATIONS, 2L, 2W, DAY ONLY
701301-04	LANE CLOSURE, 2L, 2W, SHORT TIME OPERATIONS
701306-03	LANE CLOSURE, 2L, 2W, SLOW MOVING OPERATIONS DAY ONLY, FOR SPEEDS > 45MPH
701311-03	LANE CLOSURE, 2L, 2W, MOVING OPERATIONS - DAY ONLY
701336-06	LANE CLOSURE, 2L, 2W, WORK AREAS IN SERIES FOR SPEEDS > 45 MPH
701901-02	TRAFFIC CONTROL DEVICES

GENERAL NOTES:

BEFORE STARTING ANY EXCAVATION, THE CONTRACTOR SHALL CALL "JULIE" AT 800-892-0123 OR 811 FOR FIELD LOCATIONS OF BURIED ELECTRIC, TELEPHONE AND GAS FACILITIES. 48 HOUR NOTIFICATION IS REQUIRED.

THE CONTRACTOR SHALL COORDINATE CONSTRUCTION ACTIVITIES WITH UTILITY COMPANIES AND MANHATTAN TOWNSHIP.

THE CONTRACTOR WILL NOT BE ALLOWED TO SET UP A YARD OR FIELD OFFICE ON STATE PROPERTY WITHOUT WRITTEN PERMISSION FROM THE DEPARTMENT.

ANY PAVEMENT MARKINGS AND RAISED REFLECTIVE PAVEMENT MARKERS OBLITERATED BY MILLING AND RESURFACING OPERATIONS ON SIDE STREETS AND ENTRANCES SHALL BE REPLACED AND PAID FOR IN KIND.

ALL DAMAGE TO EXISTING PAVEMENT MARKINGS OR RAISED REFLECTIVE PAVEMENT MARKERS OUTSIDE THE REMOVAL LINE SHOWN ON THE PLANS SHALL BE REPLACED AT NO ADDITIONAL COST TO THE DEPARTMENT.

BEFORE BEGINNING ANY WORK, THE CONTRACTOR SHALL RETAIN AND RECORD FOR FUTURE REFERENCE, ALL EXISTING PAVEMENT MARKING LINES (AND RAISED REFLECTIVE PAVEMENT MARKERS) IN ORDER THAT THESE LOCATIONS CAN BE RE-ESTABLISHED FOR STRIPING. EXACT LOCATIONS OF ALL PAVEMENT MARKINGS SHALL BE AS DIRECTED BY THE ENGINEER.

ALL PAVEMENT PATCHING LOCATIONS WILL BE DETERMINED IN THE FIELD BY THE ENGINEER.

IT SHALL BE THE CONTRACTOR'S RESPONSIBILITY TO VERIFY ALL DIMENSIONS AND CONDITIONS EXISTING IN THE FIELD PRIOR TO CONSTRUCTION AND ORDERING OF MATERIALS.

THE CONTRACTOR SHALL CONTACT THE DISTRICT ONE TRAFFIC CONTROL SUPERVISOR AT (847)705-4470 A MINIMUM OF 72 HOURS IN ADVANCE OF BEGINNING WORK.

THE ENGINEER SHALL CONTACT CORY JUCIUS, ARTERIAL TRAFFIC OPERATION ENGINEER, AT (847) 705-4411 A MINIMUM OF TWO (2) WEEKS PRIOR TO THE PLACEMENT OF PERMANENT PAVEMENT MARKINGS.

THE THICKNESS OF THE HMA MIXTURE SHOWN ON THE PLANS IS THE NOMINAL THICKNESS. DEVIATIONS FROM THE NOMINAL THICKNESS WILL BE PERMITTED WHEN SUCH DEVIATIONS OCCUR DUE TO IRREGULARITIES IN THE EXISTING SURFACE OR BASE ON WHICH THE HMA MIXTURE IS PLACED.

THE CONTRACTOR SHALL BE REQUIRED TO PROVIDE ACCESS TO ABUTTING PROPERTY AT ALL TIMES DURING THE CONSTRUCTION OF THIS PROJECT.

DO NOT SCALE PLANS FOR CONSTRUCTION DIMENSIONS.

PAVEMENT MARKING TAPE, TYPE III SHALL BE USED FOR SHORT TERM PAVEMENT MARKINGS ON ALL FINAL SURFACES. THE COST OF THE PAVEMENT MARKING TAPE, TYPE III AND ITS REMOVAL SHALL BE INCLUDED IN THE COST OF SHORT TERM PAVEMENT MARKING.

WHEN THE MILLED PAVEMENT IS OPEN TO TRAFFIC THE MAXIMUM GRADE DIFFERENTIAL BETWEEN PASSES OF THE MILLING MACHINE SHALL NOT EXCEED 1 1/2 INCHES (40 mm) WHERE THE SPEED LIMIT IS 40 MPH (80 km/h) OR LESS AND 1 INCH (25 mm) WHERE THE SPEED LIMIT IS GREATER THAN 40 MPH (80 km/h). WITH WRITTEN APPROVAL OF THE ENGINEER, A MAXIMUM GRADE DIFFERENTIAL OF 3 INCHES (75 mm) MAY BE ALLOWED IF THE EDGE OF THE MILLING IS SLOPED A MINIMUM 1:3 (V:H).

OVERNIGHT LANE CLOSURES SHALL NOT BE ALLOWED FOR REHABILITATION PROJECTS INVOLVING DAYTIME MILLING AND RESURFACING OPERATIONS AND CLASS D PATCHING UNLESS OTHER CONDITIONS WARRANT EXTENDED LANE CLOSURES AS DETERMINED AND APPROVED IN WRITING BY THE ENGINEER OR AS PROVIDED FOR IN THE CONTRACT SPECIFICATIONS.

ALL GROUND PAVEMENT MARKINGS SHALL BE REMOVED FROM PAVEMENT BEFORE HOT-IN-PLACE RECYCLING OPERATION BEGINS.

FILE NAME *	USER NAME * pyzranovskirb	DESIGNED -	REVISED -	STATE OF ILLINOIS DEPARTMENT OF TRANSPORTATION	MANHATTAN-MONEE ROAD (SCHOOLHOUSE RD. TO CENTER RD.) INDEX OF SHEETS, STATE STANDARDS, AND GENERAL NOTES	F.A.P. RTE.	SECTION	COUNTY	TOTAL SHEETS	SHEET NO.
c:\pwork\pwork\pyzranovskirb\0206500\0134111-ahc-plan.dgn	0134111-ahc-plan.dgn	DRAWN -	REVISED -			531	40X-RS-9	WILL	18	2
PLOT SCALE * 1/8"=1'-0"	1/8"=1'-0"	CHECKED -	REVISED -			CONTRACT NO. 60N71				
PLOT DATE * 1/14/2013	1/14/2013	DATE -	REVISED -			ILLINOIS FED. AID PROJECT				
				SCALE: 1"= 50'		SHEET NO. OF SHEETS STA.		TO STA.		

SUMMARY OF QUANTITIES				CONSTRUCTION TYPE CODE					SUMMARY OF QUANTITIES				CONSTRUCTION TYPE CODE				
CODE NO	ITEM	UNIT	TOTAL QUANTITIES	0005					CODE NO	ITEM	UNIT	TOTAL QUANTITIES	0005				
40600200	BITUMINOUS MATERIALS (PRIME COAT)	TON	48	48					70300100	SHORT TERM PAVEMENT MARKING	FOOT	2438	2438				
40600300	AGGREGATE (PRIME COAT)	TON	213	213					70300220	TEMPORARY PAVEMENT MARKING - LINE 4"	FOOT	55739	55739				
40600895	CONSTRUCTING TEST STRIP	EACH	2	2					70300280	TEMPORARY PAVEMENT MARKING - LINE 24"	FOOT	121	121				
40600982	HOT-MIX ASPHALT SURFACE REMOVAL - BUTT JOINT	SO YD	700	700					70301000	WORK ZONE PAVEMENT MARKING REMOVAL	SO FT	18580	18580				
40601005	HOT-MIX ASPHALT REPLACEMENT OVER PATCHES	TON	247	247				*78000200	THERMOPLASTIC PAVEMENT MARKING - LINE 4"	FOOT	55739	55739					
40603085	HOT-MIX ASPHALT BINDER COURSE, IL-19.0, N70	TON	7438	7438				*78000650	THERMOPLASTIC PAVEMENT MARKING - LINE 24"	FOOT	121	121					
40603340	HOT-MIX ASPHALT SURFACE COURSE, MIX "D", N70	TON	4761	4761				*78100100	RAISED REFLECTIVE PAVEMENT MARKER	EACH	389	389					
44002216	HOT-MIX ASPHALT REMOVAL OVER PATCHES, 4"	SO YD	1100	1100				78300100	PAVEMENT MARKING REMOVAL	SO FT	18620	18620					
44201729	CLASS D PATCHES, TYPE II, 7 INCH	SO YD	294	294				78300200	RAISED REFLECTIVE PAVEMENT MARKER REMOVAL	EACH	377	377					
44201733	CLASS D PATCHES, TYPE III, 7 INCH	SO YD	430	430				LR400510	REJUVENATING AGENT	GALLON	5430	5430					
44201735	CLASS D PATCHES, TYPE IV, 7 INCH	SO YD	354	354				X2020110	GRADING AND SHAPING SHOULDERS	UNIT	429	429					
44201809	CLASS D PATCHES, TYPE IV, 13 INCH	SO YD	14,373	14,373				Z0010619	HOT IN-PLACE RECYCLING	SO YD	53127	53127					
48102100	AGGREGATE WEDGE SHOULDER, TYPE B	TON	3870	3870				Z0030850	TEMPORARY INFORMATION SIGNING	SO FT	257	257					
67000400	ENGINEER'S FIELD OFFICE, TYPE A	CAL MO	4	4													
67100100	MOBILIZATION	L SUM	1	1													
70100460	TRAFFIC CONTROL AND PROTECTION, STANDARD 701306	L SUM	1	1													

©Z0076604 TRAINEE-TRAINING PROGRAM GRADUATE HOUR 500 500

©0042
*Specialty Items

FILE NAME =	USER NAME = pr2009-0110	DESIGNED -	REVISIONS -	STATE OF ILLINOIS DEPARTMENT OF TRANSPORTATION	MANHATTAN-MONEE ROAD (SCHOOLHOUSE RD. TO CENTER RD.) SUMMARY OF QUANTITIES	F.A.P. RTE.	SECTION	COUNTY	TOTAL SHEETS	SHEET NO.	
C:\pr_2009\pr2009-0110\0200000103401.sht	PLANT SCALE = 100,000' / 1"	DRAWN -	REVISIONS -			531	40X-RS-9	WILL	18	3	
	PLANT DATE = 11/14/2013	CHECKED -	REVISIONS -			CONTRACT NO. 60N71		FED. ROAD DIST. NO. 1 ILLINOIS FED. AID PROJECT			
		DATE -	REVISIONS -			SCALE:	SHEET NO. OF SHEETS	STA.	TO STA.		

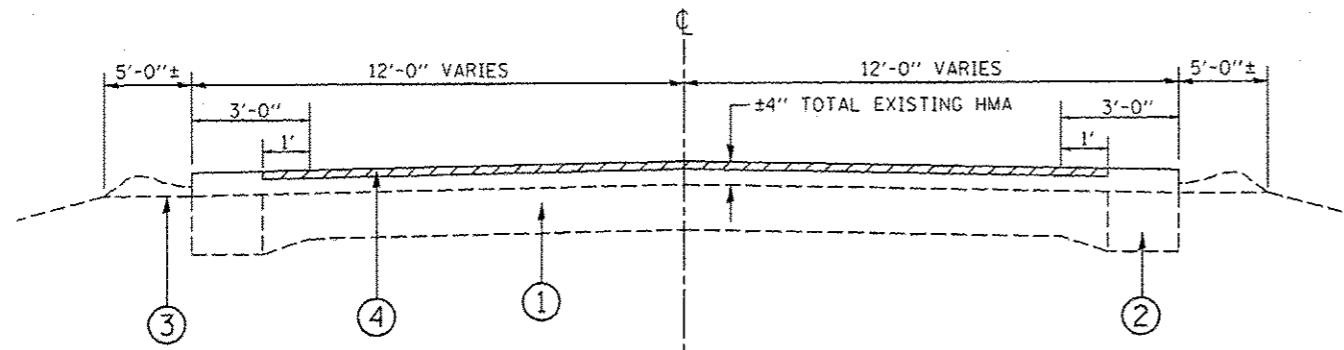

**MANHATTAN-MONEE ROAD
EXISTING TYPICAL SECTION**

STA.18+94 TO STA.102+17 &
STA.103+36 TO STA.235+08.18

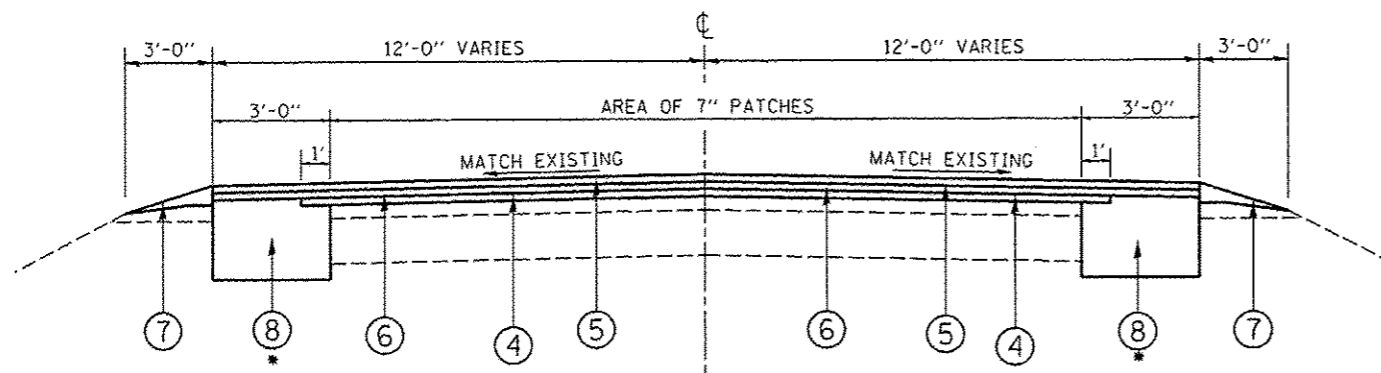

**MANHATTAN-MONEE ROAD
PROPOSED TYPICAL SECTION**

STA.18+94 TO STA.102+17 &
STA.103+36 TO STA.235+08.18

LEGEND

- ① EXISTING 9"- 7"- 9" P.C.C. PAVEMENT
- ② EXISTING HOT-MIX ASPHALT BASE COURSE WIDENING, 9"
- ③ EXISTING AGGREGATE SHOULDER
- ④ PROPOSED HOT IN-PLACE RECYCLING, 1"
- ⑤ PROPOSED HOT-MIX ASPHALT SURFACE COURSE, MIX "D" N70, 1 1/2"
- ⑥ PROPOSED HOT-MIX ASPHALT BINDER COURSE, IL-19.0, N70, 2 1/2"
- ⑦ PROPOSED AGGREGATE WEDGE SHOULDER, TYPE B
- ⑧ PROPOSED CLASS D PATCH, TYPE IV, 13"

*CLASS D PATCH WILL BE USED TO REPLACE THE OUTER 3' ON EACH SIDE ALONG THE LENGTH OF THE JOB AND SHALL BE DONE AS FULL DEPTH.

HOT-MIX ASPHALT MIXTURE REQUIREMENTS

	MIXTURE USE	AIR VOIDS (%) @ N _{DES}
ROADWAY	HOT-MIX ASPHALT SURFACE COURSE, MIX "D", N70 (IL 9.5 mm)	4% @ 70 GYR
	HOT-MIX ASPHALT BINDER COURSE, IL-19.0, N70	4% @ 70 GYR
PATCHES	CLASS D PATCHES (HMA BINDER IL-19 mm)	4% @ 70 GYR
	HMA REPLACEMENT OVER PATCHES, SURFACE COURSE	4% @ 70 GYR

THE UNIT WEIGHT USED TO CALCULATE ALL HOT-MIX ASPHALT SURFACE MIXTURE QUANTITIES IS 112 LBS/SY/IN.

THE AC TYPE FOR POLYMERIZED HMA MIXTURES SHALL BE SBS/SBR PG 76 -22 AND FOR NON-POLYMERIZED HMA THE AC TYPE SHALL BE PG 64 -22 UNLESS MODIFIED BY DISTRICT ONE SPECIAL PROVISIONS.

FOR USE OF RECYCLED MATERIALS, SEE SPECIAL PROVISIONS

HMA REPLACEMENT OVER PATCHES ONLY APPLIES TO 7 INCH PATCHES.

NOTE:
CLASS D PATCHES HAVE TO BE DONE BEFORE HOT-IN-PLACE OPERATIONS.

FILE NAME *	USER NAME * pyrzano=skirb	DESIGNED -	REVISED -	STATE OF ILLINOIS DEPARTMENT OF TRANSPORTATION	MANHATTAN-MONEE ROAD (SCHOOLHOUSE RD. TO CENTER RD.) EXISTING & PROPOSED TYPICAL SECTIONS	F.A.P. RTE. *	SECTION	COUNTY	TOTAL SHEETS	SHEET NO.	
c:\pe_work\p1\dot\pyrzano=skirb\d020600	D134111-ant-plen.dgn	DRAWN -	REVISED -			531	40X-R5-9	WILL	18	4	
	PLOT SCALE * 100.0000 "/ in.	CHECKED -	REVISED -			CONTRACT NO. 60N71					
	PLOT DATE * 5/29/2013	DATE -	REVISED -			ILLINOIS FED. AID PROJECT					

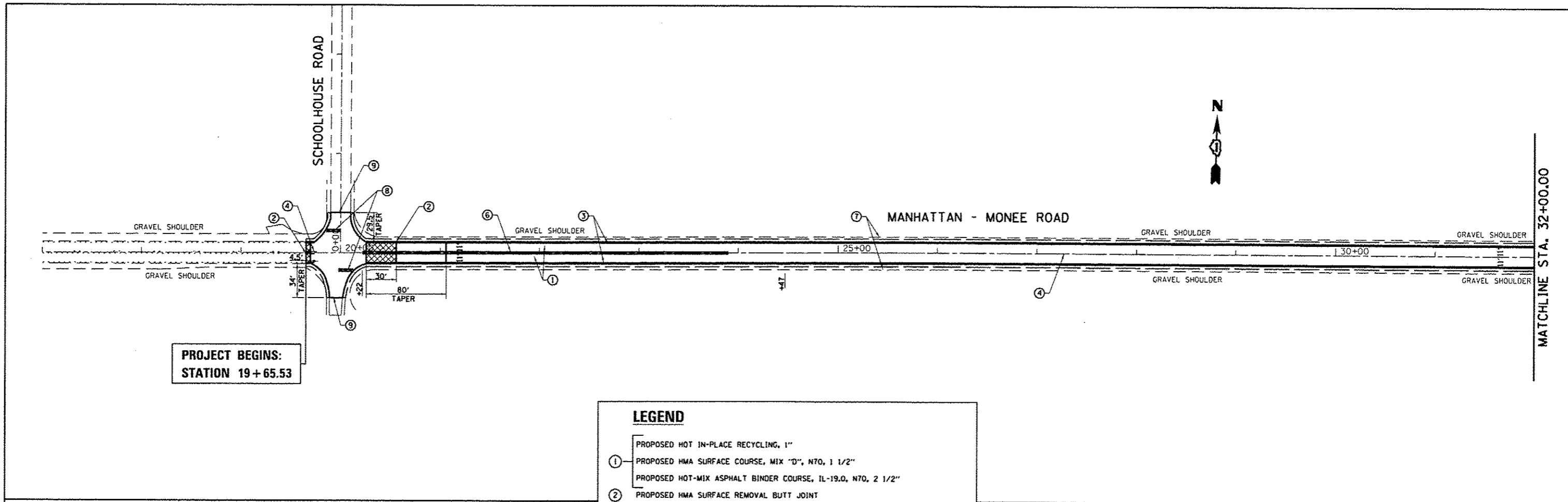

**PROJECT BEGINS:
STATION 19 + 65.53**

LEGEND	
	PROPOSED HOT IN-PLACE RECYCLING, 1"
①	PROPOSED HMA SURFACE COURSE, MIX "D", N70, 1 1/2"
	PROPOSED HOT-MIX ASPHALT BINDER COURSE, IL-19.0, N70, 2 1/2"
②	PROPOSED HMA SURFACE REMOVAL BUTT JOINT
③	PROPOSED THERMOPLASTIC PAVEMENT MARKING 4", EDGE LINE, WHITE (TYPICAL)
④	PROPOSED THERMOPLASTIC PAVEMENT MARKING 4", SKIP DASH, YELLOW (TYPICAL)
⑤	PROPOSED THERMOPLASTIC PAVEMENT MARKING 4", SOLID, YELLOW (TYPICAL)
⑥	PROPOSED THERMOPLASTIC PAVEMENT MARKING 4", DOUBLE, YELLOW (TYPICAL)
⑦	PROPOSED AGGREGATE WEDGE SHOULDER, TYPE B (TYPICAL)
⑧	PROPOSED THERMOPLASTIC PAVEMENT MARKING 24", STOP BAR, WHITE (TYPICAL)
⑨	LIMIT OF RESURFACING (TYPICAL)

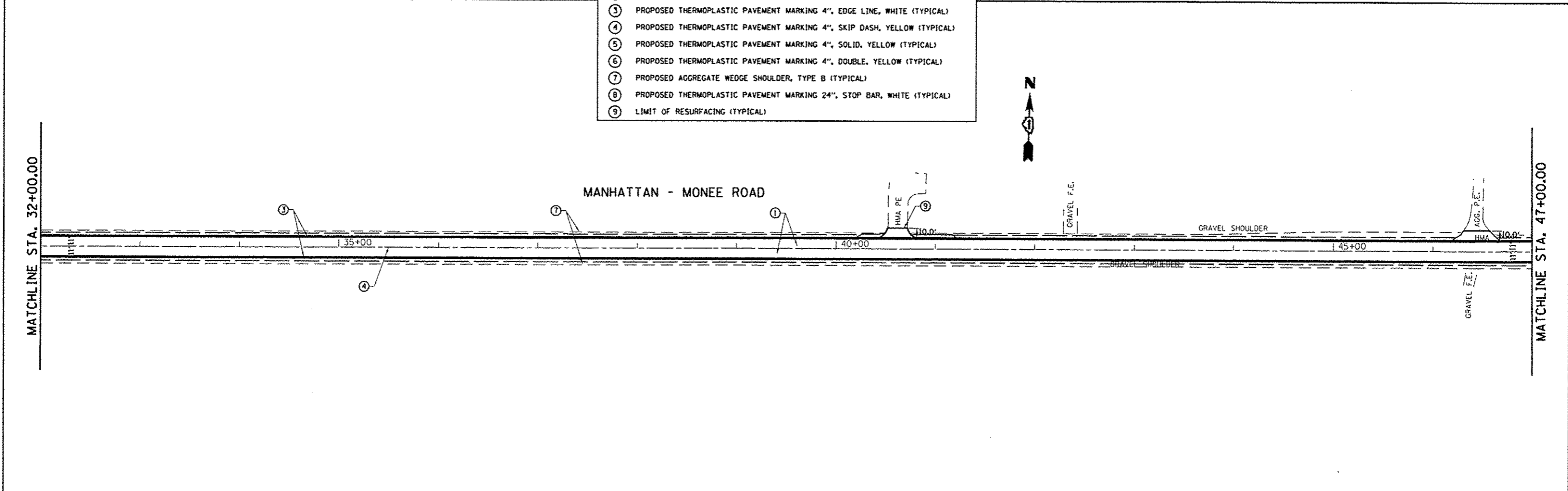

FILE NAME : c:\pwwork\pvidot\pyrzanovskirb\020608	USER NAME : pyrzanovskirb VDI24111-shr-plan.dgn	DESIGNED - DRAWN -	REVISED - REVISED -	STATE OF ILLINOIS DEPARTMENT OF TRANSPORTATION	MANHATTAN-MONEE ROAD (SCHOOLHOUSE RD. TO CENTER RD.) ROADWAY PLAN	F.A.P. RTE. 531	SECTION 40X-RS-9	COUNTY WILL	TOTAL SHEETS 18	SHEET NO. 5	
	PLOT SCALE = 100.0000' / 1"	CHECKED -	REVISED -			SCALE: 1" = 50'		SHEET OF SHEETS		STA. 17+00.00 TO STA. 47+00.00	
	PLOT DATE = 1/11/2013	DATE -	REVISED -			CONTRACT NO. 60N71					
ILLINOIS FED. AID PROJECT											

MATCHLINE STA. 47+00.00

MATCHLINE STA. 62+00.00

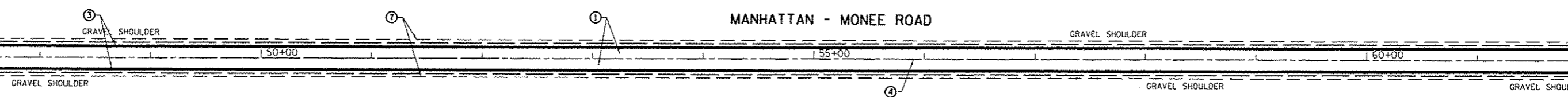

LEGEND

- ① PROPOSED HOT IN-PLACE RECYCLING, 1"
- ① PROPOSED HMA SURFACE COURSE, MIX "D", N70, 1 1/2"
- PROPOSED HOT-MIX ASPHALT BINDER COURSE, IL-19.0, N70, 2 1/2"
- ② PROPOSED HMA SURFACE REMOVAL BUTT JOINT
- ③ PROPOSED THERMOPLASTIC PAVEMENT MARKING 4", EDGE LINE, WHITE (TYPICAL)
- ④ PROPOSED THERMOPLASTIC PAVEMENT MARKING 4", SKIP DASH, YELLOW (TYPICAL)
- ⑤ PROPOSED THERMOPLASTIC PAVEMENT MARKING 4", SOLID, YELLOW (TYPICAL)
- ⑥ PROPOSED THERMOPLASTIC PAVEMENT MARKING 4", DOUBLE, YELLOW (TYPICAL)
- ⑦ PROPOSED AGGREGATE WEDGE SHOULDER, TYPE B (TYPICAL)
- ⑧ PROPOSED THERMOPLASTIC PAVEMENT MARKING 24", STOP BAR, WHITE (TYPICAL)
- ⑨ LIMIT OF RESURFACING (TYPICAL)

MATCHLINE STA. 62+00.00

MATCHLINE STA. 77+00.00

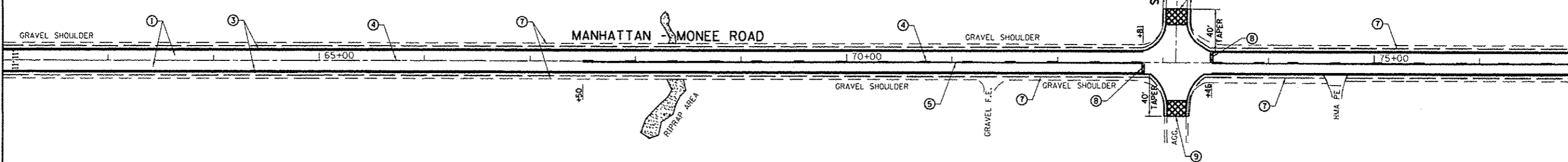

FILE NAME :	USER NAME : pyznowskirb	DESIGNED -	REVISED -	STATE OF ILLINOIS DEPARTMENT OF TRANSPORTATION	MANHATTAN-MONEE ROAD (SCHOOLHOUSE RD. TO CENTER RD.) ROADWAY PLAN	F.A.P. RTE.	SECTION	COUNTY	TOTAL SHEETS	SHEET NO.	
ci\pwr\work\pavidat\pyznowskirb\0828698	10134111-sh1-plan.dgn	DRAWN -	REVISED -			531	40X-RS-9	WILL	18	6	
	PLOT SCALE = 100.0000' / 1"	CHECKED -	REVISED -			CONTRACT NO. 60N71					
	PLOT DATE = 1/11/2013	DATE -	REVISED -			ILLINOIS FED. AID PROJECT					
					SCALE: 1" = 50'	SHEET OF SHEETS		STA. 47+00.00 TO STA. 77+00.00			

MATCHLINE STA. 77+00.00

MATCHLINE STA. 92+00.00



LEGEND

- ① PROPOSED HOT IN-PLACE RECYCLING, 1"
- ① PROPOSED HMA SURFACE COURSE, MIX "D", N70, 1 1/2"
- PROPOSED HOT-MIX ASPHALT BINDER COURSE, IL-19.0, N70, 2 1/2"
- ② PROPOSED HMA SURFACE REMOVAL BUTT JOINT
- ③ PROPOSED THERMOPLASTIC PAVEMENT MARKING 4", EDGE LINE, WHITE (TYPICAL)
- ④ PROPOSED THERMOPLASTIC PAVEMENT MARKING 4", SKIP DASH, YELLOW (TYPICAL)
- ⑤ PROPOSED THERMOPLASTIC PAVEMENT MARKING 4", SOLID, YELLOW (TYPICAL)
- ⑥ PROPOSED THERMOPLASTIC PAVEMENT MARKING 4", DOUBLE, YELLOW (TYPICAL)
- ⑦ PROPOSED AGGREGATE WEDGE SHOULDER, TYPE B (TYPICAL)
- ⑧ PROPOSED THERMOPLASTIC PAVEMENT MARKING 24", STOP BAR, WHITE (TYPICAL)
- ⑨ LIMIT OF RESURFACING (TYPICAL)

MATCHLINE STA. 92+00.00

MATCHLINE STA. 107+00.00

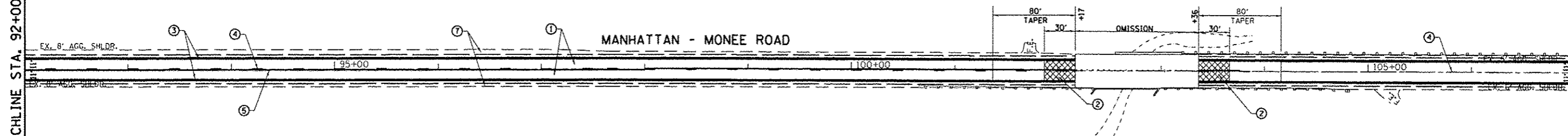

FILE NAME :	USER NAME : pyrzanoskiurb	DESIGNED -	REVISED -	STATE OF ILLINOIS DEPARTMENT OF TRANSPORTATION	MANHATTAN-MONEE ROAD (SCHOOLHOUSE RD. TO CENTER RD.) ROADWAY PLAN	F.A.P. RTE.	SECTION	COUNTY	TOTAL SHEETS	SHEET NO.	
si:\pwork\p\uidot\pyrzanoskiurb\0286800	10134111-shr-plan.dgn	DRAWN -	REVISED -			531	40X-RS-9	WILL	18	7	
	PLOT SCALE = 100.0000' / 1"	CHECKED -	REVISED -			CONTRACT NO. 60N71					
	PLOT DATE = 1/11/2013	DATE -	REVISED -			ILLINOIS FED. AID PROJECT					



MATCHLINE STA. 107+00.00

MATCHLINE STA. 122+00.00

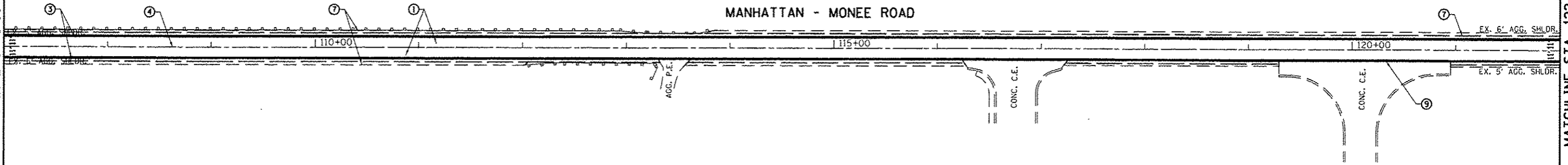

LEGEND

- ① PROPOSED HOT IN-PLACE RECYCLING, 1"
- ① PROPOSED HMA SURFACE COURSE, MIX "D", N70, 1 1/2"
- ② PROPOSED HOT-MIX ASPHALT BINDER COURSE, IL-19.0, N70, 2 1/2"
- ② PROPOSED HMA SURFACE REMOVAL BUTT JOINT
- ③ PROPOSED THERMOPLASTIC PAVEMENT MARKING 4", EDGE LINE, WHITE (TYPICAL)
- ④ PROPOSED THERMOPLASTIC PAVEMENT MARKING 4", SKIP DASH, YELLOW (TYPICAL)
- ⑤ PROPOSED THERMOPLASTIC PAVEMENT MARKING 4", SOLID, YELLOW (TYPICAL)
- ⑥ PROPOSED THERMOPLASTIC PAVEMENT MARKING 4", DOUBLE, YELLOW (TYPICAL)
- ⑦ PROPOSED AGGREGATE WEDGE SHOULDER, TYPE B (TYPICAL)
- ⑧ PROPOSED THERMOPLASTIC PAVEMENT MARKING 24", STOP BAR, WHITE (TYPICAL)
- ⑨ LIMIT OF RESURFACING (TYPICAL)

MATCHLINE STA. 122+00.00

MATCHLINE STA. 137+00.00

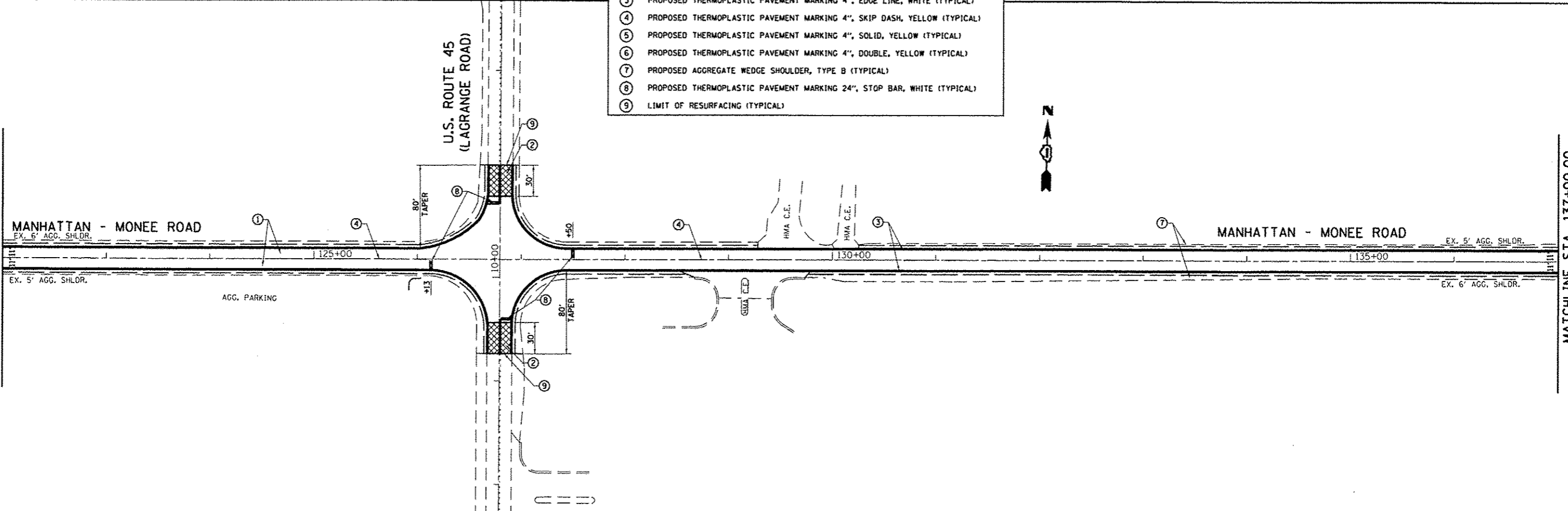

FILE NAME :	USER NAME :	DESIGNED :	REVISED :
ca:\pwr\work\puidot\pyr\zanowski\122828088	pyr\zanowski	DRAWN :	REVISED :
	ND124111-sht-plan.dgn	CHECKED :	REVISED :
	PLOT SCALE = 100.0000' / 1" in.	DATE :	REVISED :
	PLOT DATE = 1/11/2013		

**STATE OF ILLINOIS
DEPARTMENT OF TRANSPORTATION**

**MANHATTAN-MONEE ROAD (SCHOOLHOUSE RD. TO CENTER RD.)
ROADWAY PLAN**

SCALE: 1" = 50' SHEET OF SHEETS STA. 107+00.00 TO STA. 137+00.00

F.A.P. RTE.	SECTION	COUNTY	TOTAL SHEETS	SHEET NO.
531	40X-RS-9	WILL	18	8
CONTRACT NO. 60N71			ILLINOIS FED. AID PROJECT	

MATCHLINE STA. 137+00.00

MATCHLINE STA. 152+00.00

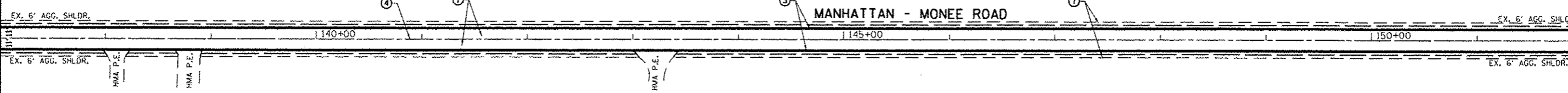

LEGEND

- ① PROPOSED HOT IN-PLACE RECYCLING, 1"
- ① PROPOSED HMA SURFACE COURSE, MIX "D", N70, 1 1/2"
- PROPOSED HOT-MIX ASPHALT BINDER COURSE, IL-19.0, N70, 2 1/2"
- ② PROPOSED HMA SURFACE REMOVAL BUTT JOINT
- ③ PROPOSED THERMOPLASTIC PAVEMENT MARKING 4", EDGE LINE, WHITE (TYPICAL)
- ④ PROPOSED THERMOPLASTIC PAVEMENT MARKING 4", SKIP DASH, YELLOW (TYPICAL)
- ⑤ PROPOSED THERMOPLASTIC PAVEMENT MARKING 4", SOLID, YELLOW (TYPICAL)
- ⑥ PROPOSED THERMOPLASTIC PAVEMENT MARKING 4", DOUBLE, YELLOW (TYPICAL)
- ⑦ PROPOSED AGGREGATE WEDGE SHOULDER, TYPE B (TYPICAL)
- ⑧ PROPOSED THERMOPLASTIC PAVEMENT MARKING 24", STOP BAR, WHITE (TYPICAL)
- ⑨ LIMIT OF RESURFACING (TYPICAL)



MATCHLINE STA. 152+00.00

MATCHLINE STA. 167+00.00

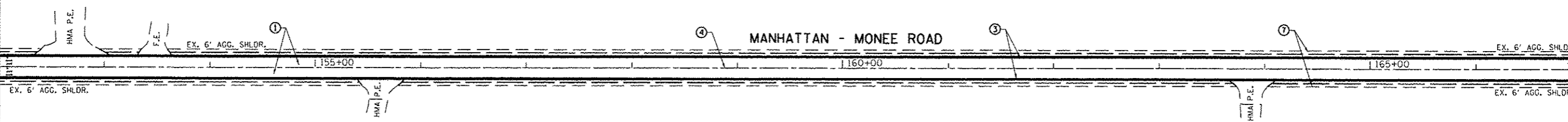

FILE NAME =	USER NAME = pyzanoski.rjb	DESIGNED -	REVISED -	STATE OF ILLINOIS DEPARTMENT OF TRANSPORTATION	MANHATTAN-MONEE ROAD (SCHOOLHOUSE RD. TO CENTER RD.) ROADWAY PLAN	F.A.P. RTE. =	SECTION	COUNTY	TOTAL SHEETS	SHEET NO.	
	ND134111-ahf-plan.dgn	DRAWN -	REVISED -			531	40X-RS-9	WILL	18	9	
	PLOT SCALE = 100.0000 / in.	CHECKED -	REVISED -			CONTRACT NO. 60N71					
	PLOT DATE = 1/11/2013	DATE -	REVISED -			ILLINOIS FED. AID PROJECT					
					SCALE: 1" = 50'		SHEET OF SHEETS		STA. 137+00.00 TO STA. 167+00.00		

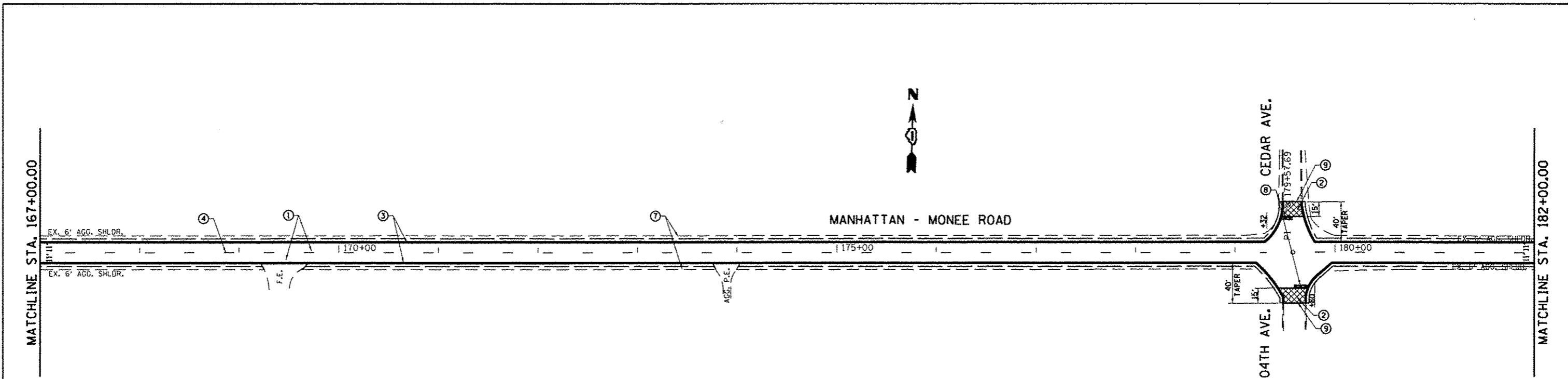

LEGEND

- ① PROPOSED HOT IN-PLACE RECYCLING, 1"
- ② PROPOSED HMA SURFACE COURSE, MIX "D", N70, 1 1/2"
- ③ PROPOSED HOT-MIX ASPHALT BINDER COURSE, IL-19.0, N70, 2 1/2"
- ④ PROPOSED HMA SURFACE REMOVAL BUTT JOINT
- ⑤ PROPOSED THERMOPLASTIC PAVEMENT MARKING 4", EDGE LINE, WHITE (TYPICAL)
- ⑥ PROPOSED THERMOPLASTIC PAVEMENT MARKING 4", SKIP DASH, YELLOW (TYPICAL)
- ⑦ PROPOSED THERMOPLASTIC PAVEMENT MARKING 4", SOLID, YELLOW (TYPICAL)
- ⑧ PROPOSED THERMOPLASTIC PAVEMENT MARKING 4", DOUBLE, YELLOW (TYPICAL)
- ⑨ PROPOSED AGGREGATE WEDGE SHOULDER, TYPE B (TYPICAL)
- ⑩ PROPOSED THERMOPLASTIC PAVEMENT MARKING 24", STOP BAR, WHITE (TYPICAL)
- ⑪ LIMIT OF RESURFACING (TYPICAL)

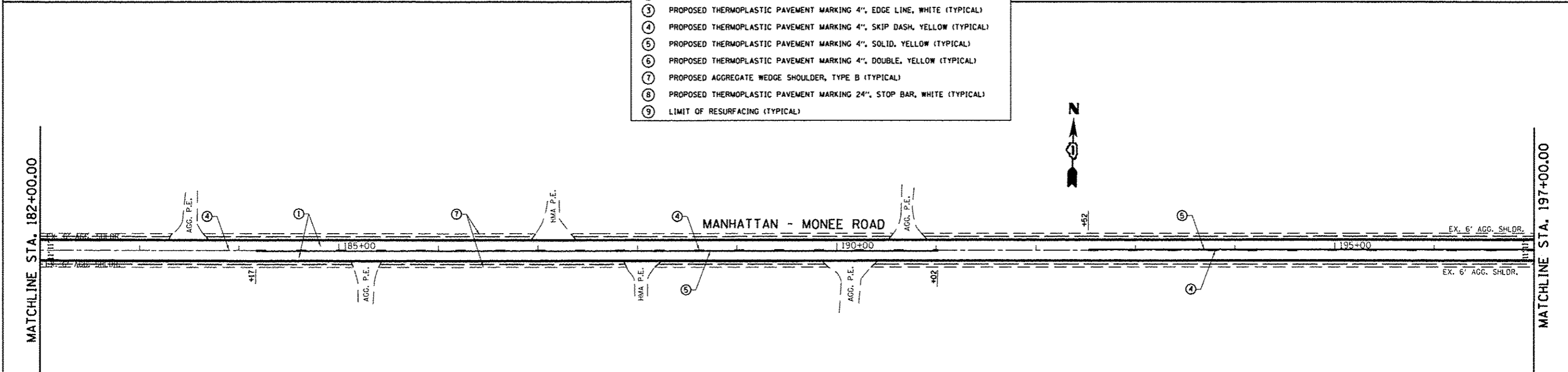

FILE NAME :	USER NAME : pyzanoskurb	DESIGNED -	REVISED -	STATE OF ILLINOIS DEPARTMENT OF TRANSPORTATION	MANHATTAN-MONEE ROAD (SCHOOLHOUSE RD. TO CENTER RD.) ROADWAY PLAN	F.A.P. RTE.:	SECTION	COUNTY	TOTAL SHEETS	SHEET NO.	
0:\pwork\pwork\pyzanoskurb\028668	10134111-ehs-plan.dgn	DRAWN -	REVISED -			531	40X-RS-9	WILL	18	10	
	PLOT SCALE = 1/8" = 50'	CHECKED -	REVISED -			CONTRACT NO. 60N7I					
	PLOT DATE = 1/11/2013	DATE -	REVISED -			ILLINOIS FED. AID PROJECT					



MATCHLINE STA. 197+00.00

MATCHLINE STA. 212+00.00

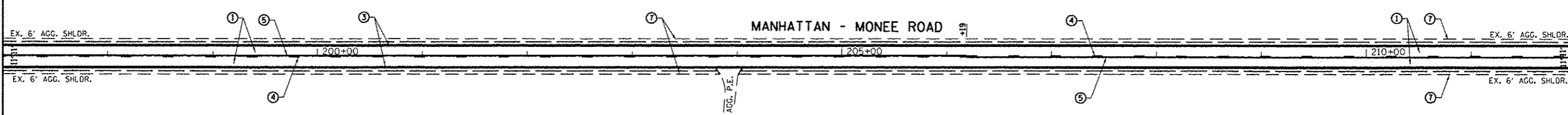

LEGEND	
	PROPOSED HOT IN-PLACE RECYCLING, 1"
①	PROPOSED HMA SURFACE COURSE, MIX "D", N70, 1 1/2"
	PROPOSED HOT-MIX ASPHALT BINDER COURSE, IL-19.0, N70, 2 1/2"
②	PROPOSED HMA SURFACE REMOVAL BUTT JOINT
③	PROPOSED THERMOPLASTIC PAVEMENT MARKING 4", EDGE LINE, WHITE (TYPICAL)
④	PROPOSED THERMOPLASTIC PAVEMENT MARKING 4", SKIP DASH, YELLOW (TYPICAL)
⑤	PROPOSED THERMOPLASTIC PAVEMENT MARKING 4", SOLID, YELLOW (TYPICAL)
⑥	PROPOSED THERMOPLASTIC PAVEMENT MARKING 4", DOUBLE, YELLOW (TYPICAL)
⑦	PROPOSED AGGREGATE WEDGE SHOULDER, TYPE B (TYPICAL)
⑧	PROPOSED THERMOPLASTIC PAVEMENT MARKING 24", STOP BAR, WHITE (TYPICAL)
⑨	LIMIT OF RESURFACING (TYPICAL)



MATCHLINE STA. 212+00.00

MATCHLINE STA. 227+00.00

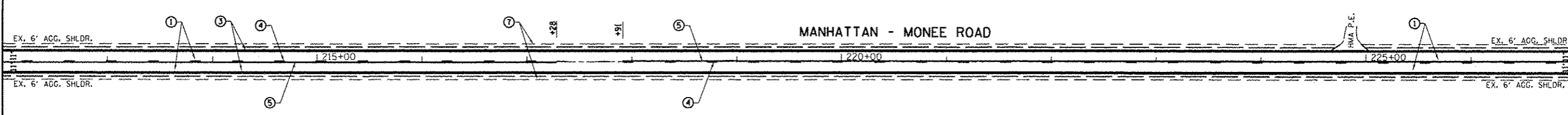

FILE NAME : e:\p\work\p\idots\pyrzanowskirb\0228080	USER NAME : pyrzanowskirb 0134111-shs-plan.dgn	DESIGNED - DRAWN -	REVISED - REVISED -	STATE OF ILLINOIS DEPARTMENT OF TRANSPORTATION	MANHATTAN-MONEE ROAD (SCHOOLHOUSE RD. TO CENTER RD.) ROADWAY PLAN	F.A.P. RTE. 531	SECTION 40X-RS-9	COUNTY WILL	TOTAL SHEETS 18	SHEET NO. 11	
PLOT SCALE = 100,000 / in.		CHECKED -	REVISED -			SCALE: 1" = 50'		SHEET OF SHEETS		STA. 197+00.00 TO STA. 227+00.00	
PLOT DATE = 1/11/2013		DATE -	REVISED -			CONTRACT NO. 60N71					
ILLINOIS FED. AID PROJECT											

MATCHLINE STA. 227+00.00

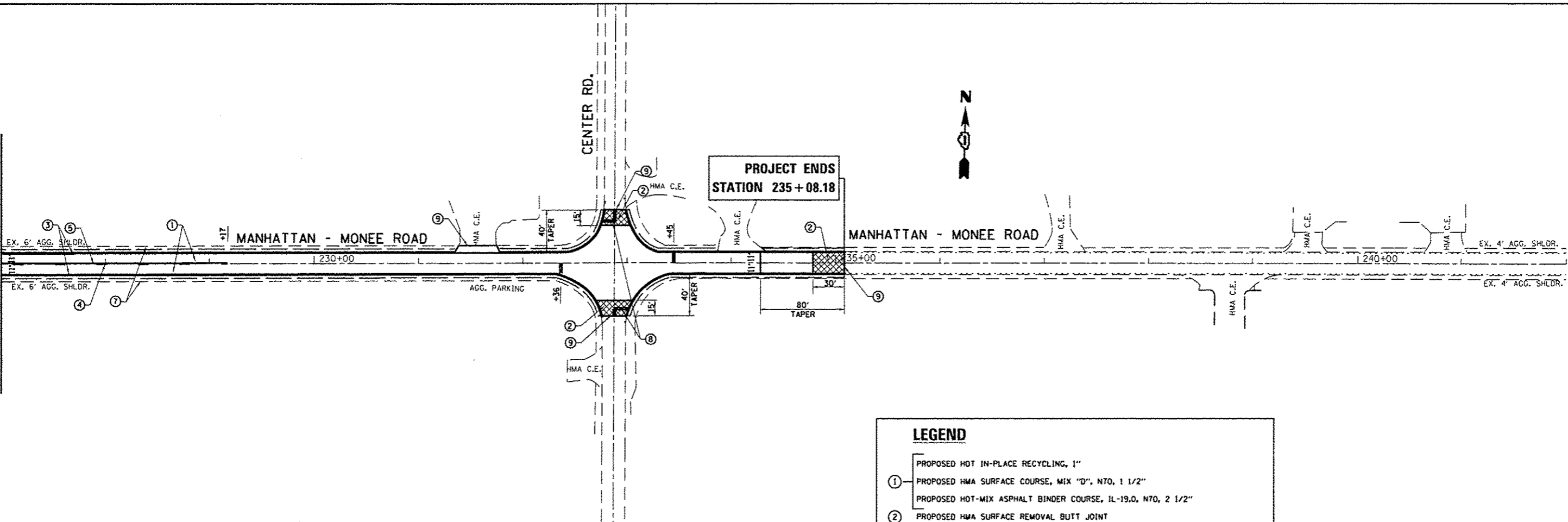

LEGEND

- PROPOSED HOT IN-PLACE RECYCLING, 1"
- ① PROPOSED HMA SURFACE COURSE, MIX "D", N70, 1 1/2"
- PROPOSED HOT-MIX ASPHALT BINDER COURSE, IL-19.0, N70, 2 1/2"
- ② PROPOSED HMA SURFACE REMOVAL BUTT JOINT
- ③ PROPOSED THERMOPLASTIC PAVEMENT MARKING 4", EDGE LINE, WHITE (TYPICAL)
- ④ PROPOSED THERMOPLASTIC PAVEMENT MARKING 4", SKIP DASH, YELLOW (TYPICAL)
- ⑤ PROPOSED THERMOPLASTIC PAVEMENT MARKING 4", SOLID, YELLOW (TYPICAL)
- ⑥ PROPOSED THERMOPLASTIC PAVEMENT MARKING 4", DOUBLE, YELLOW (TYPICAL)
- ⑦ PROPOSED AGGREGATE WEDGE SHOULDER, TYPE B (TYPICAL)
- ⑧ PROPOSED THERMOPLASTIC PAVEMENT MARKING 24", STOP BAR, WHITE (TYPICAL)
- ⑨ LIMIT OF RESURFACING (TYPICAL)

FILE NAME: d:\p\work\p\aidat\pyrzanovskirb\d228688	USER NAME: pyrzanovskirb	DESIGNED: -	REVISED: -
	VDI34111-ahp-plan.dgn	DRAWN: -	REVISED: -
	PLOT SCALE = 100.0000' / 1" =	CHECKED: -	REVISED: -
	PLOT DATE = 1/11/2013	DATE: -	REVISED: -

STATE OF ILLINOIS
DEPARTMENT OF TRANSPORTATION

MANHATTAN-MONEE ROAD (SCHOOLHOUSE RD. TO CENTER RD.)
ROADWAY PLAN

SCALE: 1" = 50' SHEET OF SHEETS STA. 227+00.00 TO STA. 242+00.00

F.A.P. RTE.	SECTION	COUNTY	TOTAL SHEETS	SHEET NO.
531	40X-RS-9	WILL	18	12
CONTRACT NO. 60N7I				
ILLINOIS FED. AID PROJECT				

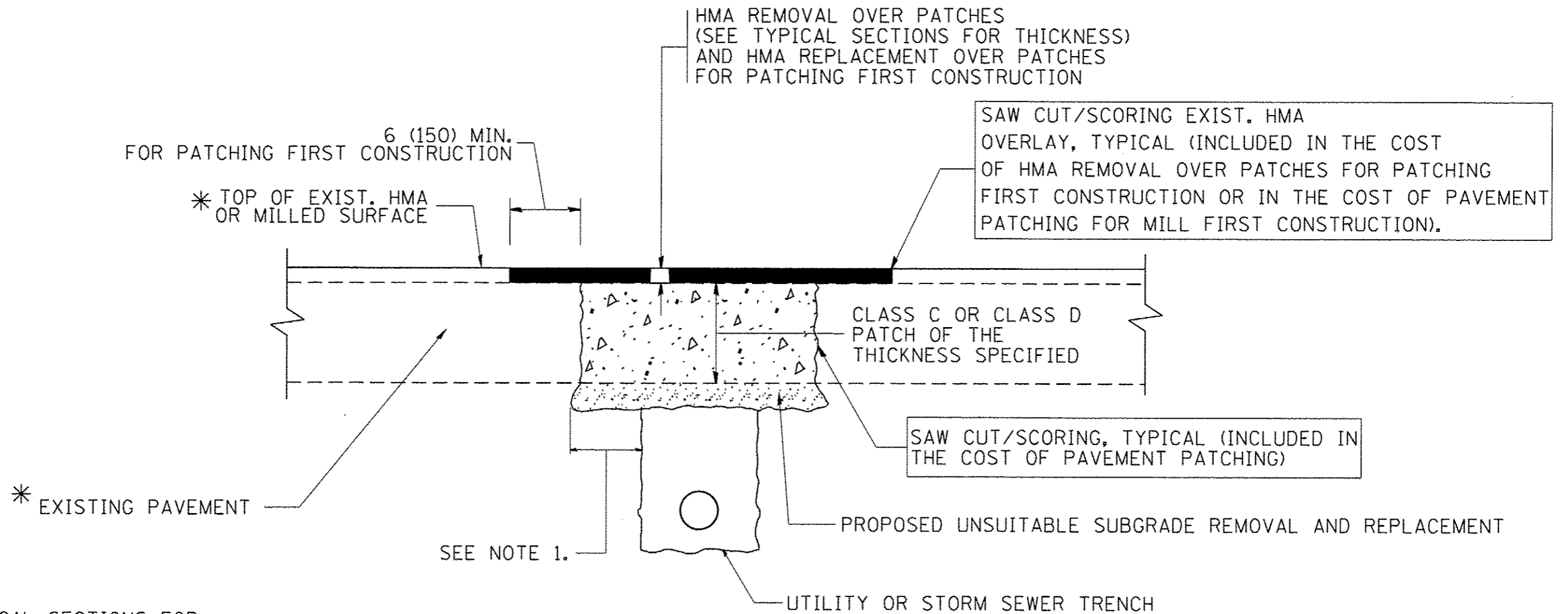

* SEE TYPICAL SECTIONS FOR THICKNESS AND MATERIALS

NOTES:

1. THE WIDTH OF THE FULL DEPTH PATCH OVER A TRENCH SHALL BE 12 (300) WIDER ON EACH SIDE OF THE TRENCH.
2. FOR METHOD OF MEASUREMENT AND BASIS OF PAYMENT, SEE RECURRING SPECIAL PROVISION "PATCHING WITH HOT-MIX ASPHALT OVERLAY REMOVAL".

SEQUENCE OF CONSTRUCTION (PATCHING FIRST)

1. REMOVE THE EXISTING HMA MATERIAL OVER THE AREA TO BE PATCHED.
2. REMOVE AND REPLACE WITH CLASS C OR D PATCH.
3. REPLACE HMA MATERIAL OVER THE AREA TO BE PATCHED.

SEQUENCE OF CONSTRUCTION (MILLING FIRST)

1. MILL HMA FIRST IF THERE IS AT LEAST 4 1/2 INCHES OR MORE OF HMA MATERIAL ON TOP OF THE EXISTING PAVEMENT OR IF THE PAVEMENT IS FULL DEPTH HMA. A MINIMUM OF 2 INCHES OF HMA MATERIAL SHALL BE IN PLACE AFTER MILLING.
2. REMOVE AND REPLACE WITH FULL DEPTH CLASS D PATCHES TO TOP OF MILLED SURFACE.

ALL DIMENSIONS ARE IN INCHES (MILLIMETERS) UNLESS OTHERWISE SHOWN.

FILE NAME : c:\pav\work\pavdot\pyrzanowskib\0928688\01st15of.dgn	USER NAME : pyrzanowskib	DESIGNED - R. SHAH	REVISED - A. ABBAS 04-27-98	STATE OF ILLINOIS DEPARTMENT OF TRANSPORTATION	PAVEMENT PATCHING FOR HMA SURFACED PAVEMENT			F.A.P. RTE.:	SECTION	COUNTY	TOTAL SHEETS	SHEET NO.	
		DRAWN -	REVISED - R. BORO 01-01-07		SCALE: NONE	SHEET NO. 1 OF 1 SHEETS	STA.	TO STA.	531	40X-RS-9	WILL	18	13
		CHECKED -	REVISED - R. BORO 09-04-07						BD400-04 (BD-22) CONTRACT NO. 60N71				
		DATE - 10-25-94	REVISED - K. ENG 10-27-08						FED. ROAD DIST. NO. 1 ILLINOIS FED. AID PROJECT				

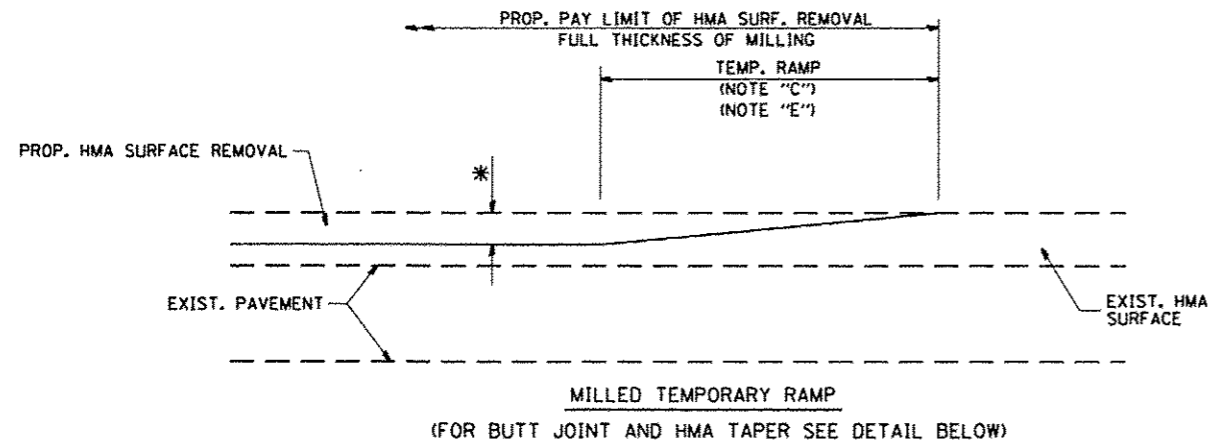

OPTION 1

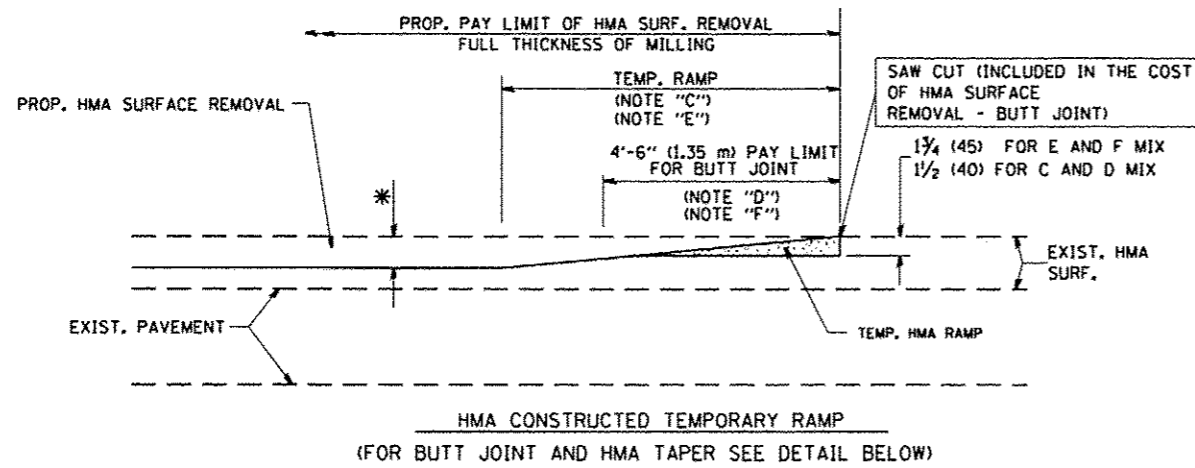

OPTION 2

TYPICAL TEMPORARY RAMP

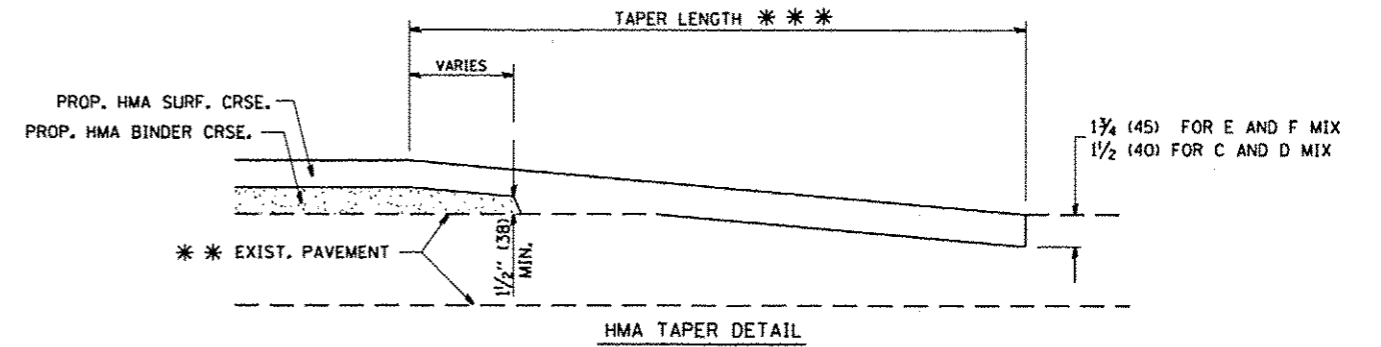
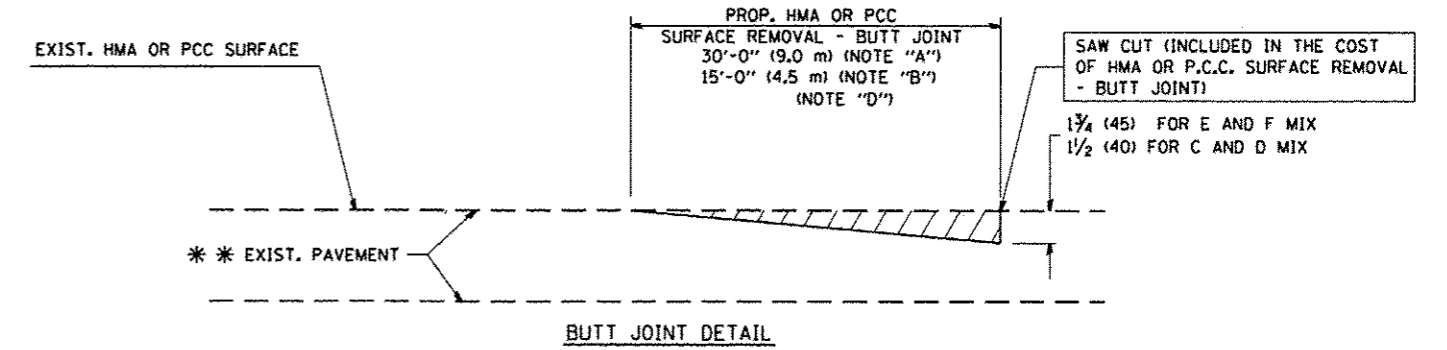

TYPICAL BUTT JOINT AND HMA TAPER FOR RESURFACING ONLY

*** PC CONCRETE, HMA OR HMA RESURFACED PAVEMENT.

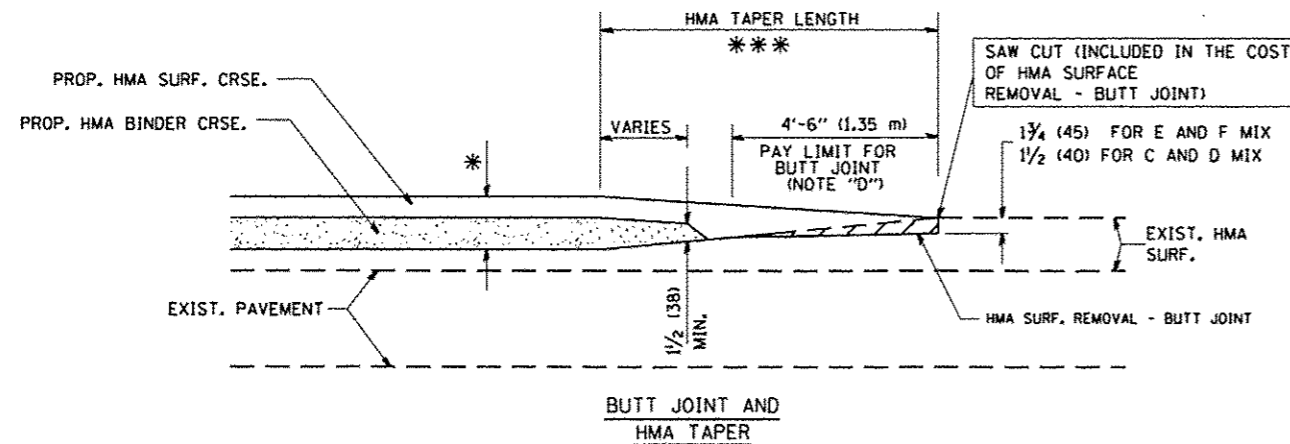

TYPICAL BUTT JOINT AND HMA TAPER FOR MILLING AND RESURFACING

NOTES

- A: MAINLINE ROADWAYS AND MAJOR SIDE ROADS.
- B: MINOR SIDE ROADS.
- C: THE TEMP. RAMP SHALL BE CONSTRUCTED IMMEDIATELY UPON REMOVAL OF THE EXISTING HMA SURFACE.
- D: THE BUTT JOINT SHALL BE CONSTRUCTED IMMEDIATELY PRIOR TO PLACING THE PROPOSED HMA COURSES.
- E: TAPER THE TEMP. RAMP AT A RATE OF 3'-0" (900 mm) PER 1 INCH (25 mm) OF MILLING THICKNESS.
- F: INSTALLATION AND REMOVAL OF THE 4'-6" (1.35 m) TEMP. RAMP IS INCLUDED IN COST OF HMA SURFACE REMOVAL - BUTT JOINT
- G: SEE ARTICLE 406.08 AND 406.14 OF THE STANDARD SPECIFICATIONS FOR "HMA AND/OR PCC SURFACE REMOVAL, BUTT JOINT".
- * SEE TYPICAL SECTIONS FOR MILLING THICKNESS.
- *** 20'-0" (6.1 m) PER 1 (25) RESURFACING (NOTE "A")
10'-0" (3.0 m) PER 1 (25) RESURFACING (NOTE "B")

BASIS OF PAYMENT:

THE BUTT JOINT WILL BE PAID FOR AT THE CONTRACT UNIT PRICE PER SQUARE YARD (SQUARE METER) FOR "HOT-MIX ASPHALT SURFACE REMOVAL - BUTT JOINT" OR FOR "PORTLAND CEMENT CONCRETE SURFACE REMOVAL - BUTT JOINT".

ALL DIMENSIONS ARE IN INCHES (MILLIMETERS) UNLESS OTHERWISE SHOWN.

FILE NAME :	USER NAME : pyzanzakrb	DESIGNED - M. DE YONG	REVISED - R. SHAH 10-25-94
e:\pwork\p1do\pyzanzakrb\d026698	DIETS\dgn	DRAWN -	REVISED - A. ABBAS 03-21-97
	PLOT SCALE = 100.0000' / 1"	CHECKED -	REVISED - M. GOMEZ 04-06-01
	PLOT DATE = 1/11/2013	DATE - 06-13-90	REVISED - R. BORO 01-01-07

**STATE OF ILLINOIS
DEPARTMENT OF TRANSPORTATION**

**BUTT JOINT AND
HMA TAPER DETAILS**

SCALE: NONE SHEET NO. 1 OF 1 SHEETS STA. TO STA.

F.A.P. RTE.	SECTION	COUNTY	TOTAL SHEETS	SHEET NO.
531	40X-RS-9	WILL	18	14
BD400-05 BD32			CONTRACT NO. 60N7I	
FED. ROAD DIST. NO. 1 ILLINOIS FED. AID PROJECT				

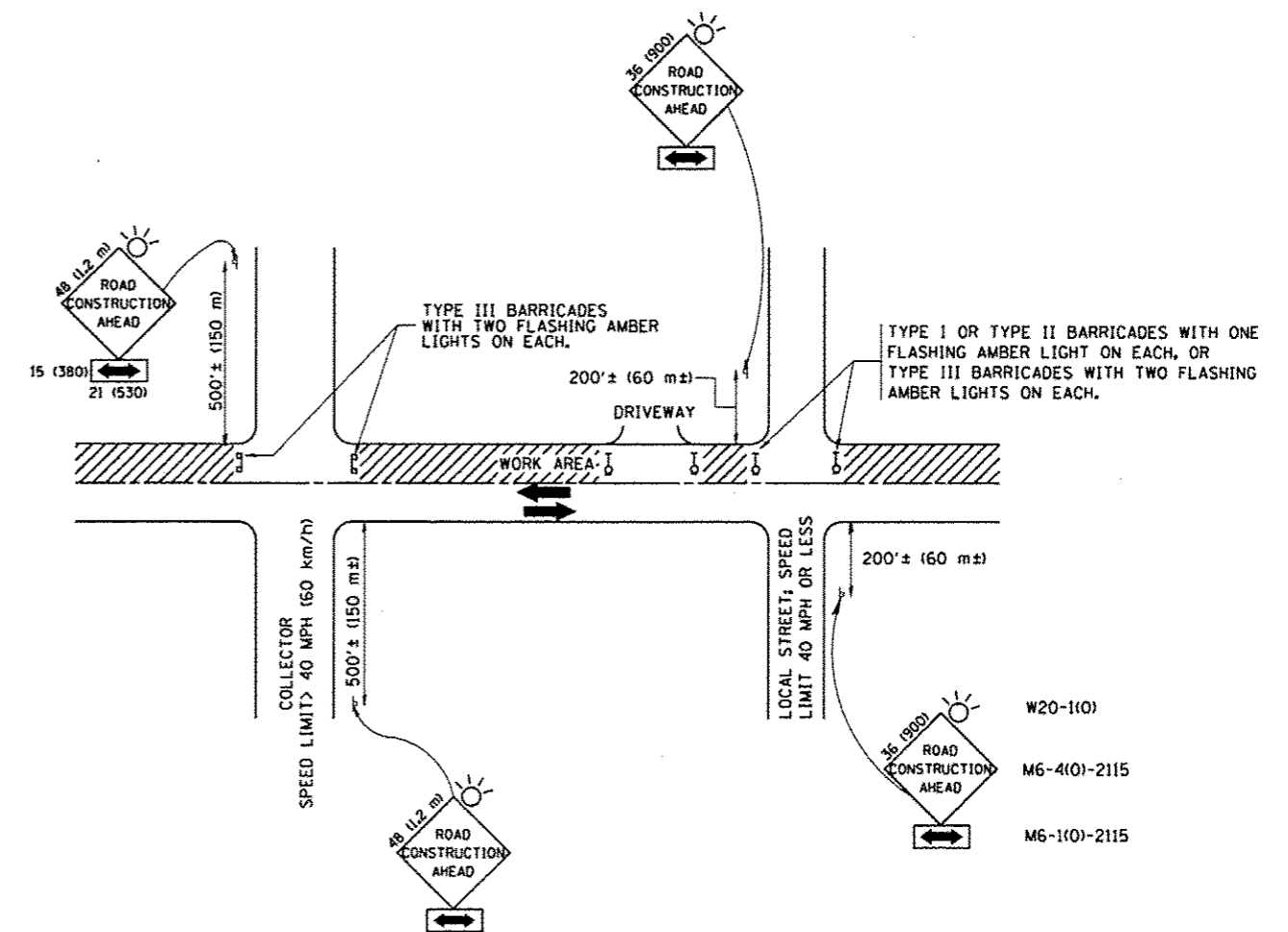

TRAFFIC CONTROL AND PROTECTION FOR SIDE ROADS, INTERSECTIONS, AND DRIVEWAYS

NOTES:

- A. FOR NO LANE RESTRICTION ON THE SIDE ROAD OR DRIVEWAYS
- SIDE ROAD WITH A SPEED LIMIT OF 40 MPH (60 km/h) OR LESS AS SHOWN ON THE DRAWING AND AS DIRECTED BY THE ENGINEER:
 - ONE ROAD CONSTRUCTION AHEAD SIGN 36 x 36 (900x900) WITH A FLASHER AND FLAG MOUNTED ON IT APPROXIMATELY 200' (60 m) IN ADVANCE OF THE MAIN ROUTE.
 - THE CLOSED PORTION OF THE MAIN ROUTE SHALL BE PROTECTED BY BLOCKING WITH TYPE I, TYPE II OR TYPE III BARRICADES, 1/3 OF THE CROSS SECTION OF THE CLOSED PORTION.
 - SIDE ROAD WITH A SPEED LIMIT GREATER THAN 40 MPH (60 km/h) AS SHOWN ON THE DRAWING AND AS DIRECTED BY THE ENGINEER:
 - ONE ROAD CONSTRUCTION AHEAD SIGN 48 x 48 (1.2 m x 1.2 m) WITH A FLASHER MOUNTED ON IT APPROXIMATELY 500' (150 m) IN ADVANCE OF THE MAIN ROUTE.
 - THE CLOSED PORTION OF THE MAIN ROUTE SHALL BE PROTECTED BY BLOCKING WITH TYPE III BARRICADES, 1/2 OF THE CROSS SECTION OF THE CLOSED PORTION.
3. WHEN THE SIDE ROAD LIES BETWEEN THE BEGINNING OF THE MAINLINE SIGNING AND THE WORK ZONE, A SINGLE HEADED ARROW (M6-1) SHALL BE USED IN LIEU OF THE DOUBLE HEADED ARROW (M6-4).
- B. FOR A LANE CLOSURE ON A SIDE ROAD OR DRIVEWAY:
- USE APPLICABLE PORTIONS OF THE TYPICAL APPLICATION OF TRAFFIC CONTROL DEVICES (STD. 701501, STD. 701606 OR THE APPROPRIATE STANDARD). THE SPACING OF SIGNS AND BARRICADES SHALL BE ADJUSTED FOR FIELD CONDITIONS AS DIRECTED BY THE ENGINEER. THE DIRECTIONAL ARROW SHALL BE COVERED OR REMOVED WHEN NO LONGER CONSISTENT WITH THE SIDE ROAD LANE CLOSURE.
- C. ADVANCE WARNING SIGNS ARE TO BE OMITTED ON DRIVEWAY UNLESS OTHERWISE NOTED.
- D. THE TRAFFIC CONTROL AND PROTECTION FOR SIDE ROADS, INTERSECTIONS, AND DRIVEWAYS SHALL BE INCIDENTAL TO THE COST OF SPECIFIED TRAFFIC CONTROL STANDARDS OR ITEMS.

All dimensions are in millimeters (inches) unless otherwise shown.

STATE OF ILLINOIS
DEPARTMENT OF TRANSPORTATION

TRAFFIC CONTROL AND PROTECTION FOR SIDE ROADS, INTERSECTIONS, AND DRIVEWAYS		F.A.P. RTE.	SECTION	COUNTY	TOTAL SHEETS	SHEET NO.
SCALE: NONE		531	40X-RS-9	WILL	18	15
SHEET NO. 1 OF 1 SHEETS		TC-10		CONTRACT NO. 60N71		
STA. TO STA.		FED. ROAD DIST. NO. 1 ILLINOIS FED. AID PROJECT				

FILE NAME :	USER NAME : pyzanoskrb	DESIGNED - LHA	REVISED - J. OBERLE 10-18-95
or:\pw\work\p1dot\pyzanoskrb\ud286888	\DistStd.dgn	DRAWN -	REVISED - A. HOUSEH 03-06-96
	PLOT SCALE * 100.0000 ' / in.	CHECKED -	REVISED - A. HOUSEH 10-15-96
	PLOT DATE * 1/11/2013	DATE - 06-89	REVISED - T. RAMMACHER 01-06-00

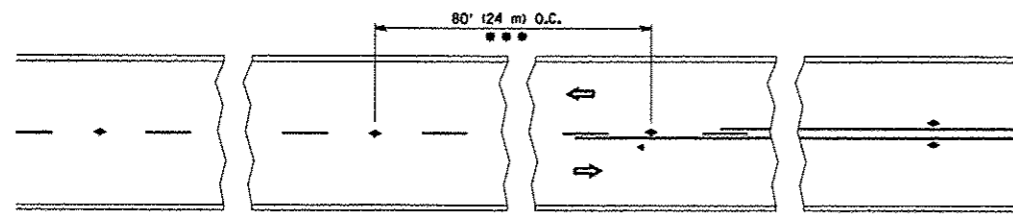

*** REDUCE TO 40' (12 m) O.C. ON CURVES WITH POSTED OR ADVISORY SPEED 45 M.P.H. (70 km/h) OR LESS.

TWO-LANE/TWO-WAY

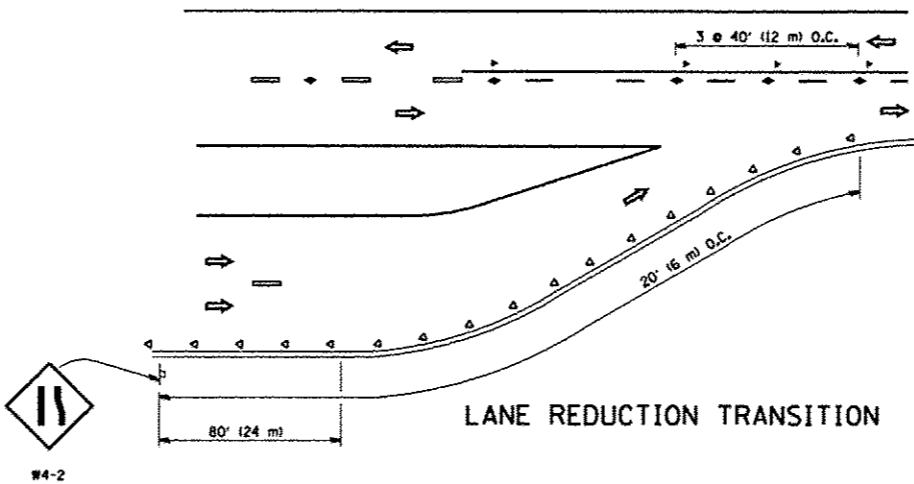

LANE REDUCTION TRANSITION

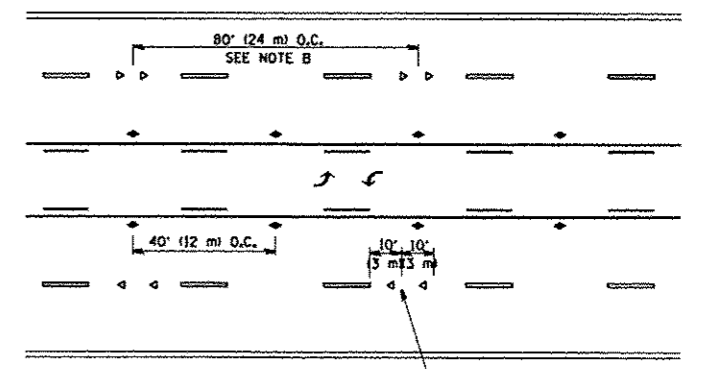

TWO-WAY LEFT TURN

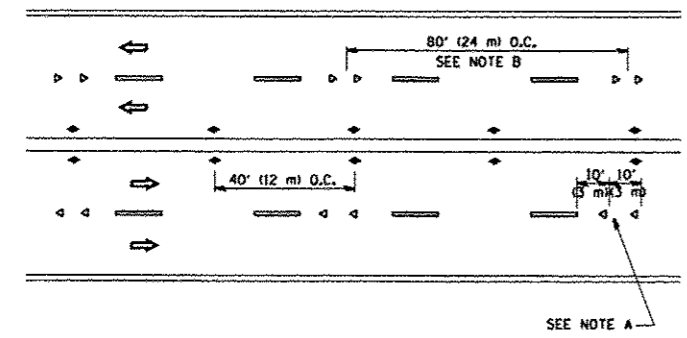

MULTI-LANE/UNDIVIDED

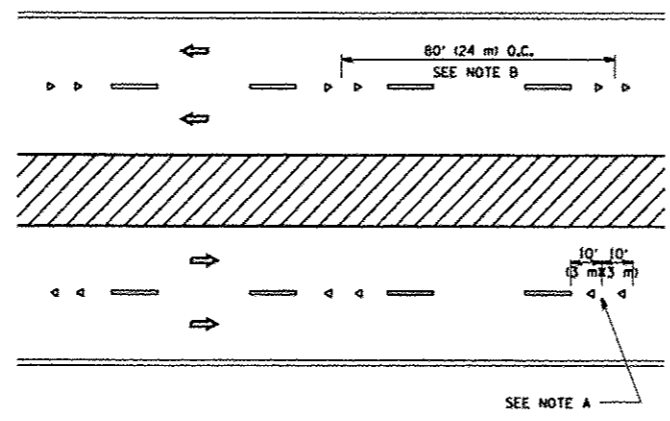

MULTI-LANE/DIVIDED

GENERAL NOTES

1. MARKERS USED WITH DASHED LINES SHALL BE CENTERED IN THE GAP BETWEEN SEGMENTS.
2. MARKERS USED ADJACENT TO SOLID LINES SHALL BE OFFSET 2 TO 3 (50 TO 75) TOWARD TRAFFIC AS SHOWN.
3. MARKERS THROUGH TANGENTS LESS THAN 500' (150 m) IN LENGTH BETWEEN CURVES SHALL BE INSTALLED AT THE LESSER OF THE TWO CURVE SPACINGS.

SYMBOLS

- YELLOW STRIPE
- WHITE STRIPE
- ◀ ONE-WAY AMBER MARKER
- ◀ ONE-WAY CRYSTAL MARKER (W/O)
- ↔ TWO-WAY AMBER MARKER

LANE MARKER NOTES

- A. USE DOUBLE LANE LINE MARKERS SPACED AS SHOWN.
- B. REDUCE TO 40' (12 m) O.C. ON CURVES WHERE ADVISORY SPEEDS ARE 10 M.P.H. (20 km/h) LOWER THAN POSTED SPEEDS.

DESIGN NOTES

1. DOUBLE LANE LINE MARKERS SHALL BE USED UNLESS SPECIFIED OTHERWISE.
2. EXCEPT AS SHOWN ON THE LANE REDUCTION TRANSITION AND FREEWAY EXIT RAMP DETAIL, MARKERS ARE NOT TO BE SPECIFIED ON RIGHT EDGE LINES.
3. THE EXACT MARKER LIMITS, SPACING, AND COLOR SHALL BE INCLUDED IN THE PLANS WHEN STANDARD SPECIFICATIONS ARE NOT BEING USED.
4. MARKERS SHOULD NOT BE USED ALONGSIDE CURBS EXCEPT FOR EXTREMELY SHORT SECTIONS OF CURBS WHERE NOT MORE THAN TWO MARKERS WOULD BE INVOLVED.

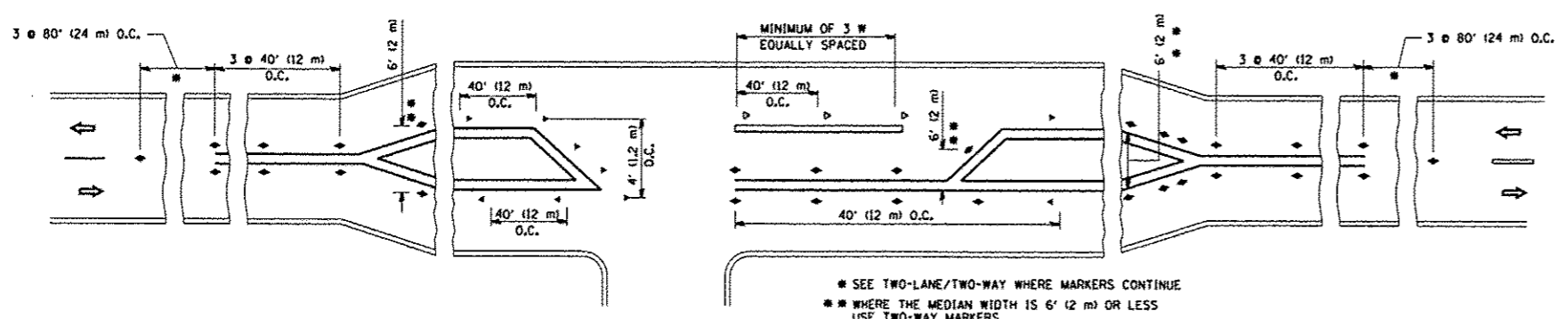

LEFT TURN

• SEE TWO-LANE/TWO-WAY WHERE MARKERS CONTINUE
 • WHERE THE MEDIAN WIDTH IS 6' (2 m) OR LESS USE TWO-WAY MARKERS.

All dimensions are in inches (millimeters) unless otherwise shown.

FILE NAME :	USER NAME : pyzanoskrb	DESIGNED -	REVISED - T, RAMMACHER 09-19-94	STATE OF ILLINOIS DEPARTMENT OF TRANSPORTATION	TYPICAL APPLICATIONS			F.A.P. RTE.	SECTION	COUNTY	TOTAL SHEETS	SHEET NO.
ei:\pwork\pwork\pyzanoskrb\d0286888\01st.dgn		DRAWN -	REVISED - T, RAMMACHER 03-12-99		RAISED REFLECTIVE PAVEMENT MARKERS (SNOW-PLOW RESISTANT)			531	40X-R5-9	WILL	18	16
PLOT SCALE = 100.0000 / 1"		CHECKED -	REVISED - T, RAMMACHER 01-06-00		SCALE: NONE	SHEET NO. 1 OF 1 SHEETS	STA. TO STA.	TC-11		CONTRACT NO. 60N71		
PLOT DATE = 1/11/2013		DATE -	REVISED - C, JUCIUS 09-09-09		FED. ROAD DIST. NO. 1 ILLINOIS FED. AID PROJECT							

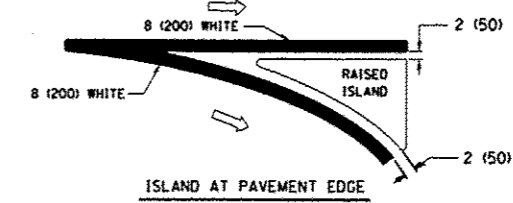
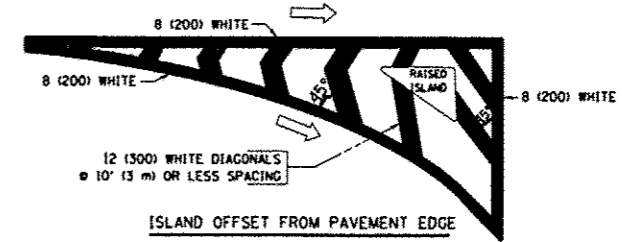
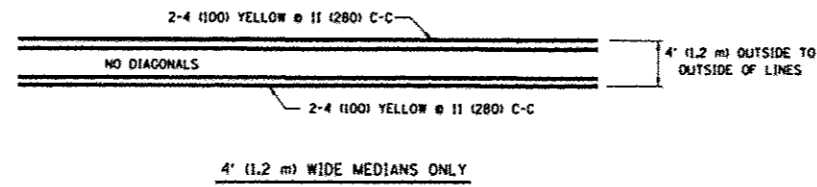
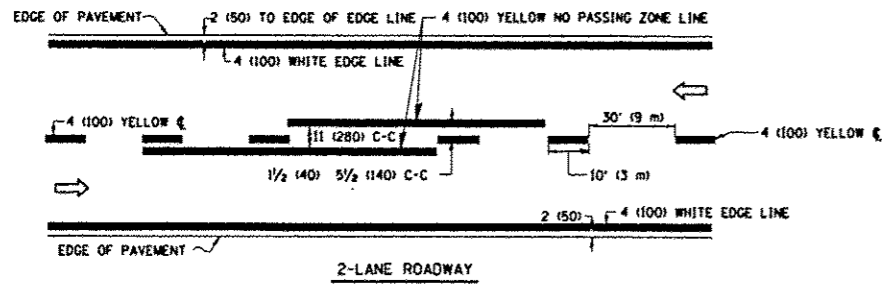

TYPICAL ISLAND MARKING

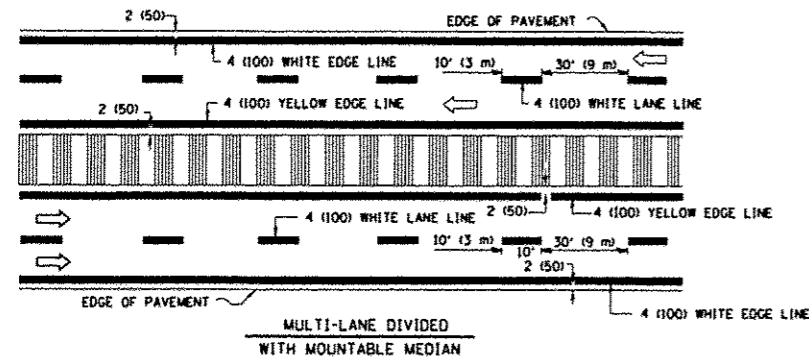
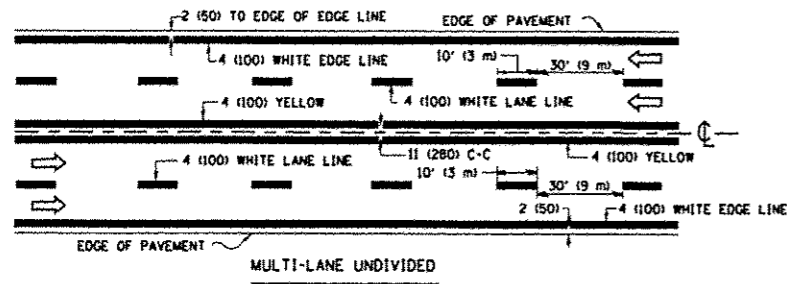

NOTE: MEDIANS WITH BARRIER CURB DO NOT REQUIRE AN EDGE LINE

TYPICAL LANE AND EDGE LINE MARKING

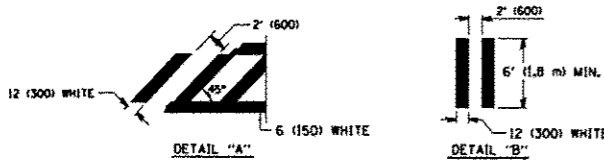
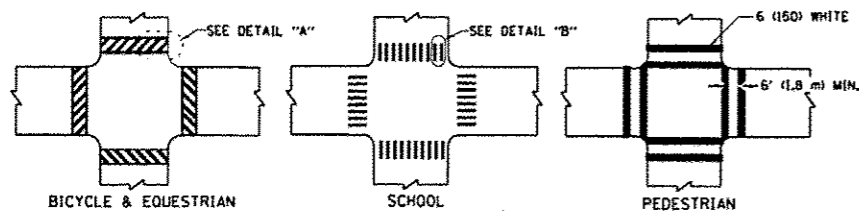

TYPICAL CROSSWALK MARKING

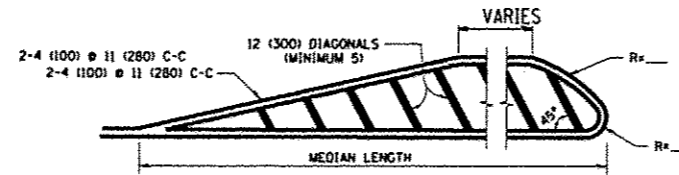

FOR MEDIAN LENGTHS WHERE DIAGONAL SPACING CANNOT BE ATTAINED, USE 5 (FIVE) EQUALLY SPACED DIAGONAL LINES.

DIAGONAL LINE SPACING: 50' (15 m) C-C (LESS THAN 30MPH (50 km/h))
75' (23 m) C-C 30MPH (50 km/h) TO 45MPH (70 km/h)
150' (45 m) C-C (MORE THAN 45MPH (70 km/h))

MEDIANS OVER 4' (1.2 m) WIDE

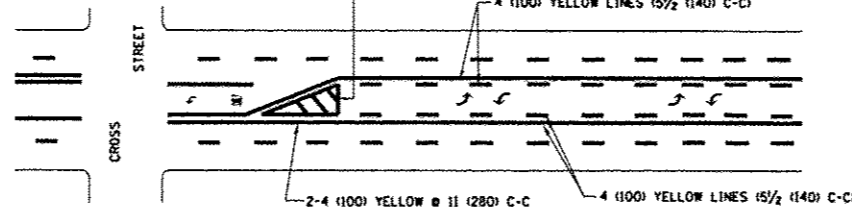

A MINIMUM OF TWO PAIRS OF TURN ARROWS SHALL BE USED, WHITE IN COLOR. ADDITIONAL PAIRS SHALL BE PLACED AT 200' (60 m) TO 300' (90 m) INTERVALS.



MEDIAN WITH TWO-WAY LEFT TURN LANE

TYPICAL PAINTED MEDIAN MARKING

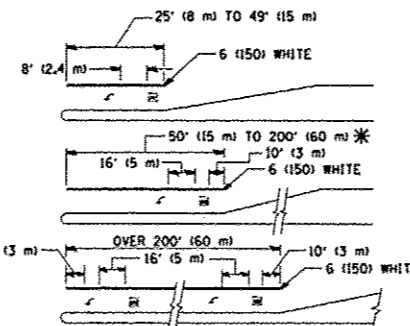

FULL SIZE LETTERS 8' (2.4 m) AND ARROWS SHALL BE USED.
AREA = 15.6 SQ. FT. (1.5 m²) AREA = 20.8 SQ. FT. (1.9 m²)

* TURN LANES IN EXCESS OF 400' (120 m) IN LENGTH MAY HAVE AN ADDITIONAL SET OF ARROW - "ONLY" INSTALLED MIDWAY BETWEEN THE OTHER TWO SETS OF ARROW - "ONLY".

TYPICAL LEFT (OR RIGHT) TURN LANE

TYPICAL TURN LANE MARKING

TYPE OF MARKING	WIDTH OF LINE	PATTERN	COLOR	SPACING / REMARKS
CENTERLINE ON 2 LANE PAVEMENT	4 (100)	SKIP-DASH	YELLOW	10' (3 m) LINE WITH 30' (9 m) SPACE
CENTERLINE ON MULTI-LANE UNDIVIDED PAVEMENT	2 @ 4 (100)	SOLID	YELLOW	11 (280) C-C
NO PASSING ZONE LINES FOR ONE DIRECTION	4 (100)	SOLID	YELLOW	5/2 (140) C-C FROM SKIP-DASH CENTERLINE
NO PASSING ZONE LINES FOR BOTH DIRECTIONS	2 @ 4 (100)	SOLID	YELLOW	11 (280) C-C OMIT SKIP-DASH CENTERLINE BETWEEN
LANE LINES	4 (100)	SKIP-DASH	WHITE	10' (3 m) LINE WITH 30' (9 m) SPACE
LANE LINES	5 (125) ON FREEWAYS	SKIP-DASH	WHITE	10' (3 m) LINE WITH 30' (9 m) SPACE
DOTTED LINES (EXTENSIONS OF CENTER, LANE OR TURN LANE MARKINGS)	SAME AS LINE BEING EXTENDED	SKIP-DASH	SAME AS LINE BEING EXTENDED	2' (600) LINE WITH 6' (1.8 m) SPACE
EDGE LINES	4 (100)	SOLID	YELLOW-LEFT WHITE-RIGHT	OUTLINE MOUNTABLE MEDIANS IN YELLOW; EDGE LINES ARE NOT USED NEXT TO BARRIER CURB
TURN LANE MARKINGS	6 (150) LINE; FULL SIZE LETTERS & SYMBOLS (8' (2.4m))	SOLID	WHITE	SEE TYPICAL TURN LANE MARKING DETAIL
TWO WAY LEFT TURN MARKING	2 @ 4 (100) EACH DIRECTION	SKIP-DASH AND SOLID IN PAIRS	YELLOW	10' (3 m) LINE WITH 30' (9 m) SPACE FOR SKIP-DASH 5/2 (140) C-C BETWEEN SOLID LINE AND SKIP-DASH LINE. SEE TYPICAL TWO-WAY LEFT TURN MARKING DETAIL.
TWO WAY LEFT TURN MARKING	8' (2.4m) LEFT ARROW		WHITE	
CROSSWALK LINES (PEDESTRIAN) A. DIAGONALS (BIKE & EQUESTRIAN) B. LONGITUDINAL BARS (SCHOOL)	2 @ 6 (150) 12 (300) @ 45° 12 (300) @ 90°	SOLID SOLID SOLID	WHITE WHITE WHITE	NOT LESS THAN 6' (1.8 m) APART 2' (600) APART 2' (600) APART SEE TYPICAL CROSSWALK MARKING DETAILS.
STOP LINES	24 (600)	SOLID	WHITE	PLACE 4' (1.2 m) IN ADVANCE OF AND PARALLEL TO CROSSWALK, IF PRESENT. OTHERWISE, PLACE AT DESIRED STOPPING POINT, PARALLEL TO CROSSROAD CENTERLINE, WHERE POSSIBLE.
PAINTED MEDIANS	2 @ 4 (100) WITH 12 (300) DIAGONALS @ 45° NO DIAGONALS USED FOR 4' (1.2 m) WIDE MEDIANS	SOLID	YELLOW TWO WAY TRAFFIC WHITE ONE WAY TRAFFIC	11 (280) C-C FOR THE DOUBLE LINE SEE TYPICAL PAINTED MEDIAN MARKING.
CORE MARKING AND CHANNELIZING LINES	8 (200) WITH 12 (300) DIAGONALS @ 45°	SOLID	WHITE	DIAGONALS: 15' (4.5 m) C-C (LESS THAN 30MPH (50 km/h)) 20' (6 m) C-C 30MPH (50 km/h) TO 45MPH (70 km/h) 30' (9 m) C-C (OVER 45MPH (70 km/h))
RAILROAD CROSSING	24 (600) TRANSVERSE LINES "RR" 15' (4.5 m) APART LETTERS: 16 (400) LINE FOR "X"	SOLID	WHITE	SEE STATE STANDARD 780001 AREA OF: "R" = 3.6 SQ. FT. (0.33 m ²) EACH "X" = 54.0 SQ. FT. (5.0 m ²)
SHOULDER DIAGONALS	12 (300) @ 45°	SOLID	WHITE - RIGHT YELLOW - LEFT	50' (15 m) C-C (LESS THAN 30MPH (50 km/h)) 75' (23 m) C-C (30 MPH (50 km/h) TO 45MPH (70 km/h)) 150' (45 m) C-C (OVER 45MPH (70 km/h))

FOR FURTHER DETAILS ON PAVEMENT MARKING REFER TO STANDARD SPECIFICATIONS FOR ROAD AND BRIDGE CONSTRUCTION AND STATE STANDARD 780001.

All dimensions are in inches (millimeters) unless otherwise shown.

FILE NAME: c:\pwwork\pwwork\pjrzanowski\028608	USER NAME: pjrzanowski	DESIGNED: EVERS	REVISED: T. RAMMACHER 10-27-94
		DRAWN:	REVISED: C. JUCIUS 09-09-09
	PLOT SCALE: 1/8" = 1'-0"	CHECKED:	REVISED:
	PLOT DATE: 1/11/2013	DATE: 03-19-90	REVISED:

STATE OF ILLINOIS
DEPARTMENT OF TRANSPORTATION

DISTRICT ONE		F.A.P. R.T.E. 531	SECTION 40X-RS-9	COUNTY WILL	TOTAL SHEETS 18	SHEET NO. 17
TYPICAL PAVEMENT MARKINGS		TC-13		CONTRACT NO. 60N7I		
SCALE: NONE	SHEET NO. 1 OF 1 SHEETS	STA. TO STA.	FED. ROAD DIST. NO. 1 ILLINOIS FED. AID PROJECT			

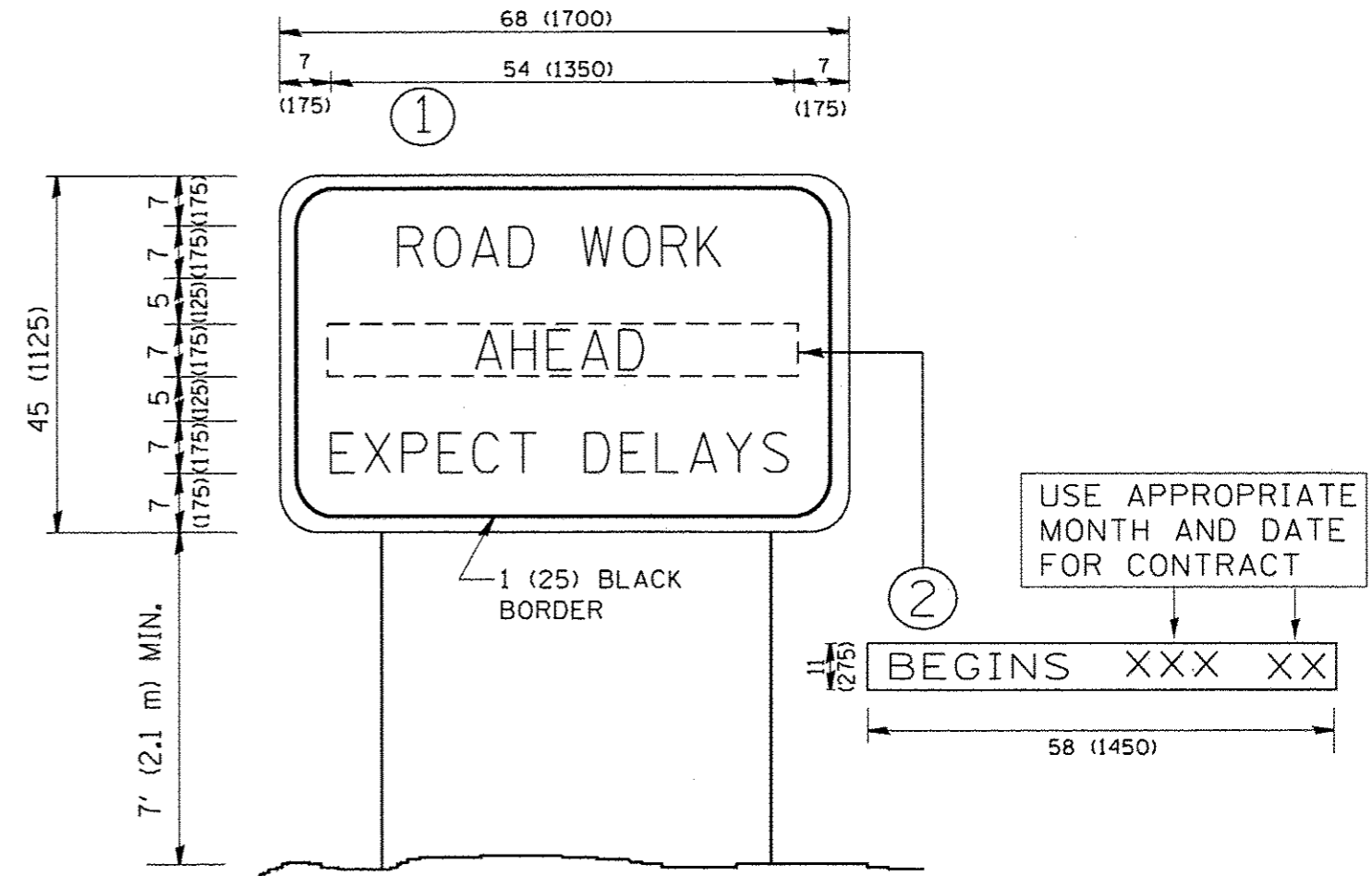

NOTES:

1. USE BLACK LETTERING ON ORANGE BACKGROUND.
2. ERECT SIGNS IN ADVANCE OF THE LOCATION FOR THE "ROAD CONSTRUCTION AHEAD" SIGN AT LOCATIONS AS DIRECTED BY THE ENGINEER.
3. ERECT SIGN ① WITH INSTALLED PANEL ② ONE WEEK PRIOR TO THE START OF CONSTRUCTION.
4. REMOVE PANEL ② SOON AFTER THE START OF CONSTRUCTION.
5. SEE SPECIAL PROVISION FOR "TEMPORARY INFORMATION SIGNING" FOR ADDITIONAL INFORMATION.
6. ONE SIGN ASSEMBLY EQUALS 25.70 SQ. FT. (2.3 SQ. M.)
7. SHALL BE PAID FOR AS TEMPORARY INFORMATION SIGNING.

ALL DIMENSIONS ARE IN INCHES (MILLIMETERS) UNLESS OTHERWISE SHOWN.

FILE NAME :	USER NAME : pyzzenovskirb	DESIGNED -	REVISED - R. MIRS 09-15-97	STATE OF ILLINOIS DEPARTMENT OF TRANSPORTATION	ARTERIAL ROAD INFORMATION SIGN		F.A.P. RTE.	SECTION	COUNTY	TOTAL SHEETS	SHEET NO.	
ei\pwork\pvidot\pyzzenovskirb\d026680	DistStd.dgn	DRAWN -	REVISED - R. MIRS 12-11-97		SCALE: NONE	SHEET NO. 1 OF 1 SHEETS	STA.	TO STA.	531	40X-RS-9	WILL	18 18
	PLOT SCALE = 100.0000 " / in.	CHECKED -	REVISED - T. RAMMACHER 02-02-99						TC-22		CONTRACT NO. 60N71	
	PLOT DATE = 1/11/2013	DATE -	REVISED - C. JUCIUS 01-31-07						FED. ROAD DIST. NO. 1	ILLINOIS	FED. AID PROJECT	