

| | | | | |
|---------------------|-----------------|------------------|--------------|-----------|
| F.A.P. RTE. | SECTION | COUNTY | TOTAL SHEETS | SHEET NO. |
| 307 | 130N-3 (11) | DUPAGE | 141 | 26 |
| STA. 6594+00 | TO STA. 6607+00 | | | |
| FED. ROAD DIST. NO. | ILLINOIS | FED. AID PROJECT | | |

60R46

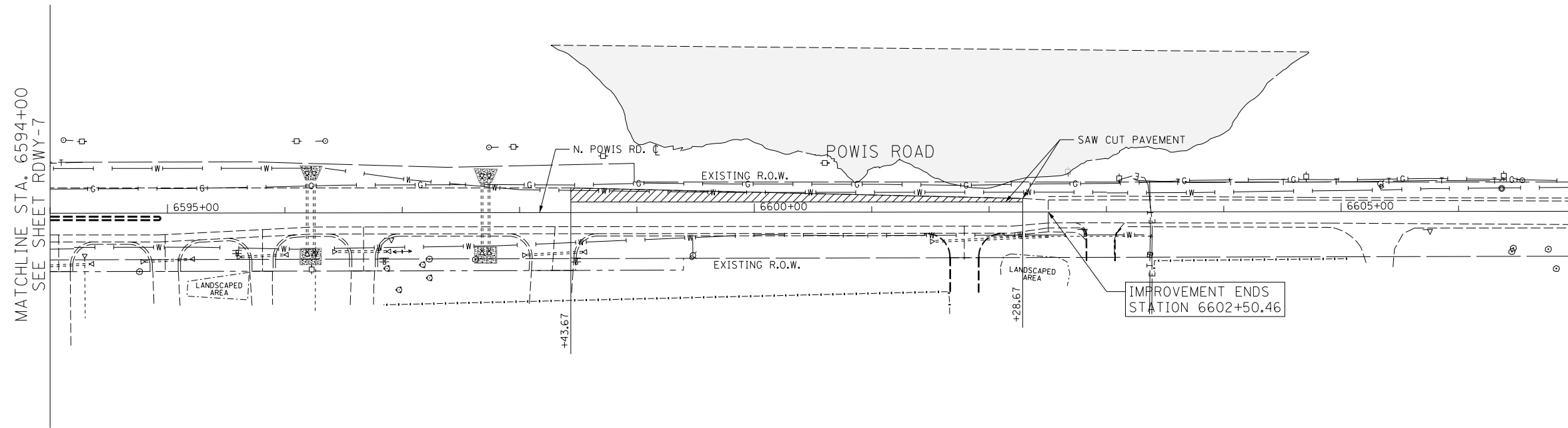

REMOVAL LEGEND:

- PAVEMENT REMOVAL
- COMB CURB GUTTER REMOVAL
- CLASS D PATCHES

EXISTING CONDITIONS AND REMOVALS

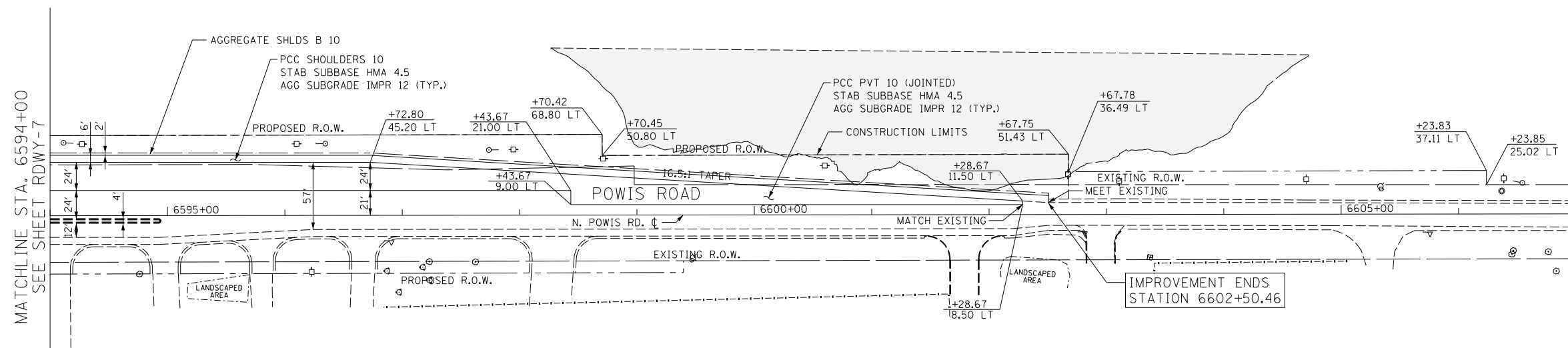

NOTE:

1. CONTRACTOR SHALL COORDINATE WITH CONTRACT 62410 FOR PREVIOUSLY CONSTRUCTED WORK.

RDWY-15



PROPOSED ROADWAY PLAN



| REVISIONS | |
|-----------|------|
| NAME | DATE |
| | |
| | |
| | |
| | |
| | |
| | |
| | |
| | |
| | |
| | |

ILLINOIS DEPARTMENT OF TRANSPORTATION
 F.A.P. ROUTE 307 (ILLINOIS ROUTE 64)

ROADWAY PLAN
 POWIS ROAD
 STA. 6594+00 TO STA. 6607+00

SCALE: 1" = 50'
 DATE: FEBRUARY 1, 2013

DRAWN BY: AFC
 CHECKED BY: NJH