

F.A.P. RTE.	SECTION	COUNTY	TOTAL SHEETS	SHEET NO.
307	130N-3 (11)	DUPAGE	141	34
STA.		TO STA.		
FED. ROAD DIST. NO.		ILLINOIS	FED. AID PROJECT	
60R46				

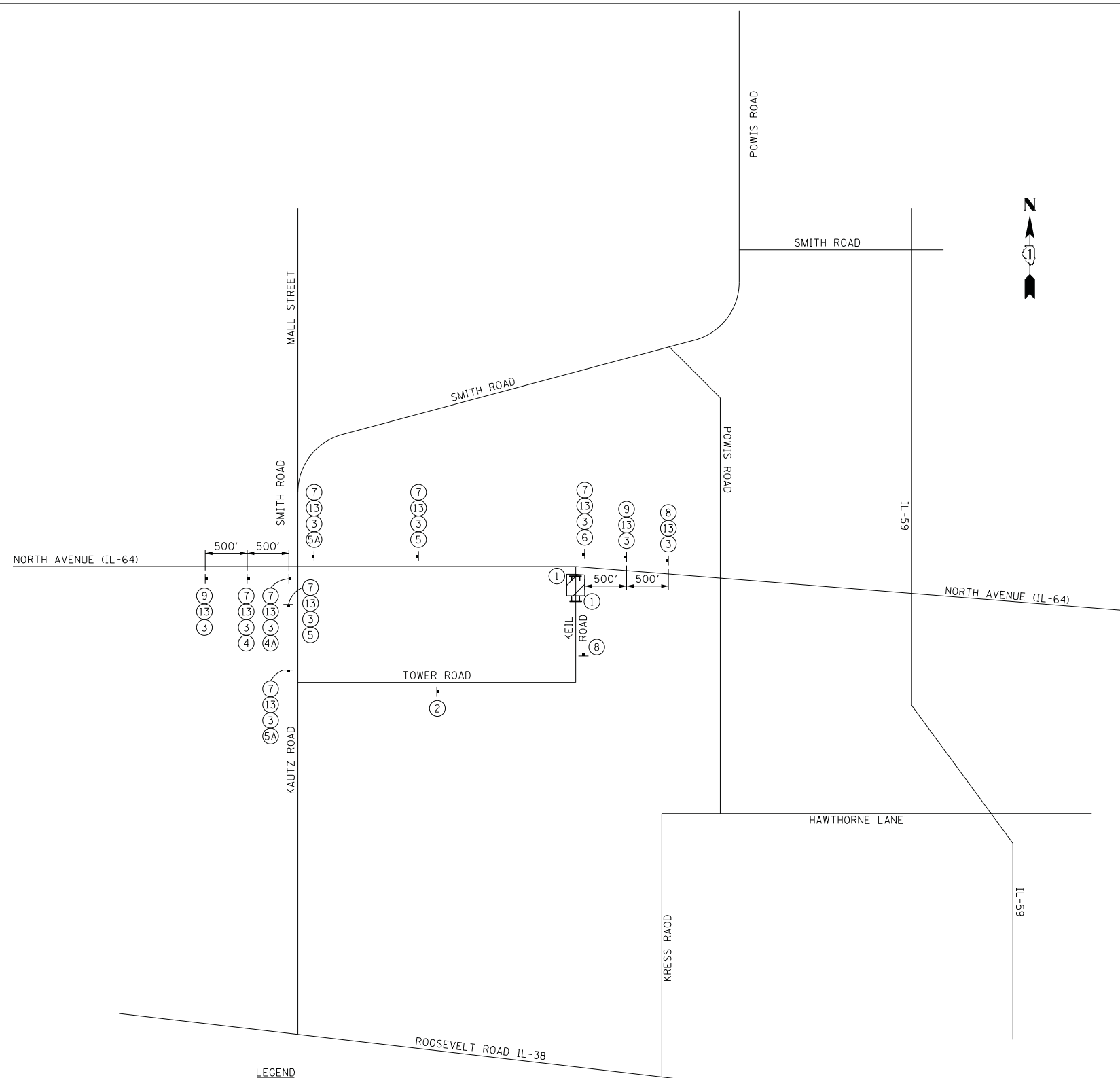

- ① R11-2 (48" x 30") ON TYPE III BARRICADE
- ② M4-8a (24" x 18")
- ③ 48" x 24" (6" LETTERS)
- ④ M5-1 (R) (21" x 15")
- ④A M6-1 (R) (21" x 15")
- ⑤ M5-1 (L) (21" x 15")
- ⑤A M6-1 (L) (21" x 15")
- ⑥ M6-3 (21" x 15")
- ⑦ M4-8 (24" x 12")
- ⑧ W20-3 (48" x 48")
- ⑨ W20-2 (48" x 48")
- ⑩ W20-3 (48" x 48")
- ⑪ R11-4 (60" x 30") ON TYPE III BARRICADE
- ⑫ M3-1 (24" x 12")
- ⑬ M3-3 (24" x 12")

LEGEND

- TYPE III BARRICADE
- ↓ DETOUR SIGN

NOTES
 ALL DETOUR SIGNING SHALL BE PAID FOR AS TEMPORARY INFORMATION SIGNING.



REVISIONS	
NAME	DATE

MOT-DET
 ILLINOIS DEPARTMENT OF TRANSPORTATION
 F.A.P. ROUTE 307 (ILLINOIS ROUTE 64)
 DETOUR PLAN
 KEIL ROAD / NORTH AVENUE

SCALE: VERT: NONE
 HORIZ: NONE
 DATE: FEBRUARY 1, 2013
 DRAWN BY: AFC
 CHECKED BY: NJH