

F.A.P. RTE.	SECTION	COUNTY	TOTAL SHEETS	SHEET NO.
307	130N-3 (11)	DUPAGE	141	82
STA. 3312+00		TO STA. 3325+00		
FED. ROAD DIST. NO.	ILLINOIS	FED. AID PROJECT		

60R46

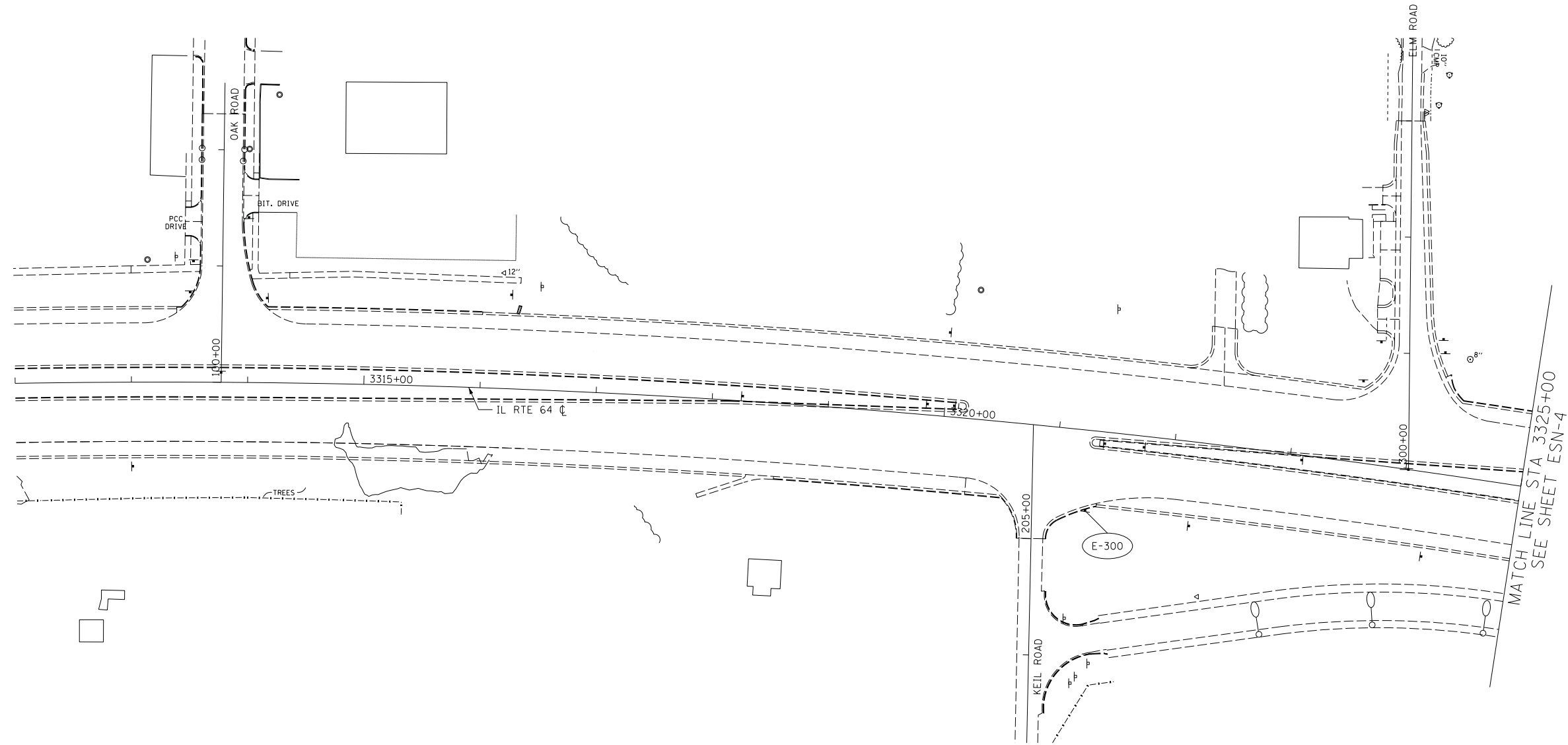
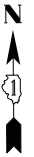

NOTES:

1. SHEET CALLOUTS ARE DETAILED IN THE EXISTING SIGN SCHEDULE.

ESN-3

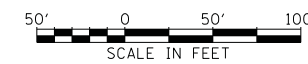

REVISIONS	
NAME	DATE

ILLINOIS DEPARTMENT OF TRANSPORTATION
 F.A.P. ROUTE 307 (ILLINOIS ROUTE 64)
 EXISTING SIGNING PLAN
 IL ROUTE 64
 STA. 3312+00 TO STA. 3325+00

SCALE: VERT: NONE
 HORIZ: 1"=50'
 DATE: FEBRUARY 1, 2013
 DRAWN BY: AFC
 CHECKED BY: NJH