



RECORD DRAWINGS

Date (MM/DD/YYYY) 9-22-2009
 Signed [Signature]
 Print(First Last) Lenny Venezia

INTERCONNECT SCHEMATIC LEGEND

- EXISTING INTERSECTION CONTROLLER
- PROPOSED INTERSECTION CONTROLLER
- EXISTING MASTER CONTROLLER
- PROPOSED MASTER CONTROLLER
- MASTER MASTER CONTROLLER
- EXISTING INTERSECTION & SAMPLING (SYSTEM) DETECTORS
- PROPOSED INTERSECTION & SAMPLING (SYSTEM) DETECTORS
- EXISTING INTERSECTION LOOP DETECTORS (SYSTEM) DETECTORS
- PROPOSED SAMPLING (SYSTEM) DETECTORS
- EXISTING SAMPLING (SYSTEM) DETECTORS
- PROPOSED SAMPLING (SYSTEM) DETECTORS
- EXISTING SAMPLING (SYSTEM) DETECTORS, PROPOSED INTERSECTION AND SAMPLING (SYSTEM) DETECTORS
- EXISTING SAMPLING (SYSTEM) DETECTORS, PROPOSED SAMPLING (SYSTEM) DETECTORS
- EXISTING PREFORMED INTERSECTION & SAMPLING (SYSTEM) DETECTORS
- PROPOSED PREFORMED INTERSECTION & SAMPLING (SYSTEM) DETECTORS
- EXISTING SAMPLING (SYSTEM) PREFORMED DETECTORS
- PROPOSED SAMPLING (SYSTEM) PREFORMED DETECTORS
- EXISTING FIBER OPTIC CABLE IN CONDUIT, NO. 62.5/125, MM12F SM12F
- PROPOSED FIBER OPTIC CABLE IN CONDUIT, NO. 62.5/125, MM12F SM12F
- EXISTING INTERCONNECT CABLE - NO. 62.5/125 12F FIBER OPTIC CABLE
- PROPOSED INTERCONNECT CABLE - NO. 62.5/125 12F FIBER OPTIC CABLE
- EXISTING INTERCONNECT CABLE - NO. 18 3 PAIR TWISTED, SHIELDED
- PROPOSED INTERCONNECT CABLE - NO. 18 3 PAIR TWISTED, SHIELDED
- EXISTING LOOP DETECTOR CABLE 2/C TWISTED, SHIELDED
- PROPOSED LOOP DETECTOR CABLE 2/C TWISTED, SHIELDED
- EXISTING ELECTRIC CABLE, 1/C (AS SPECIFIED)
- PROPOSED ELECTRIC CABLE, 1/C (AS SPECIFIED)
- EXISTING TELEPHONE CONNECTION
- PROPOSED TELEPHONE CONNECTION

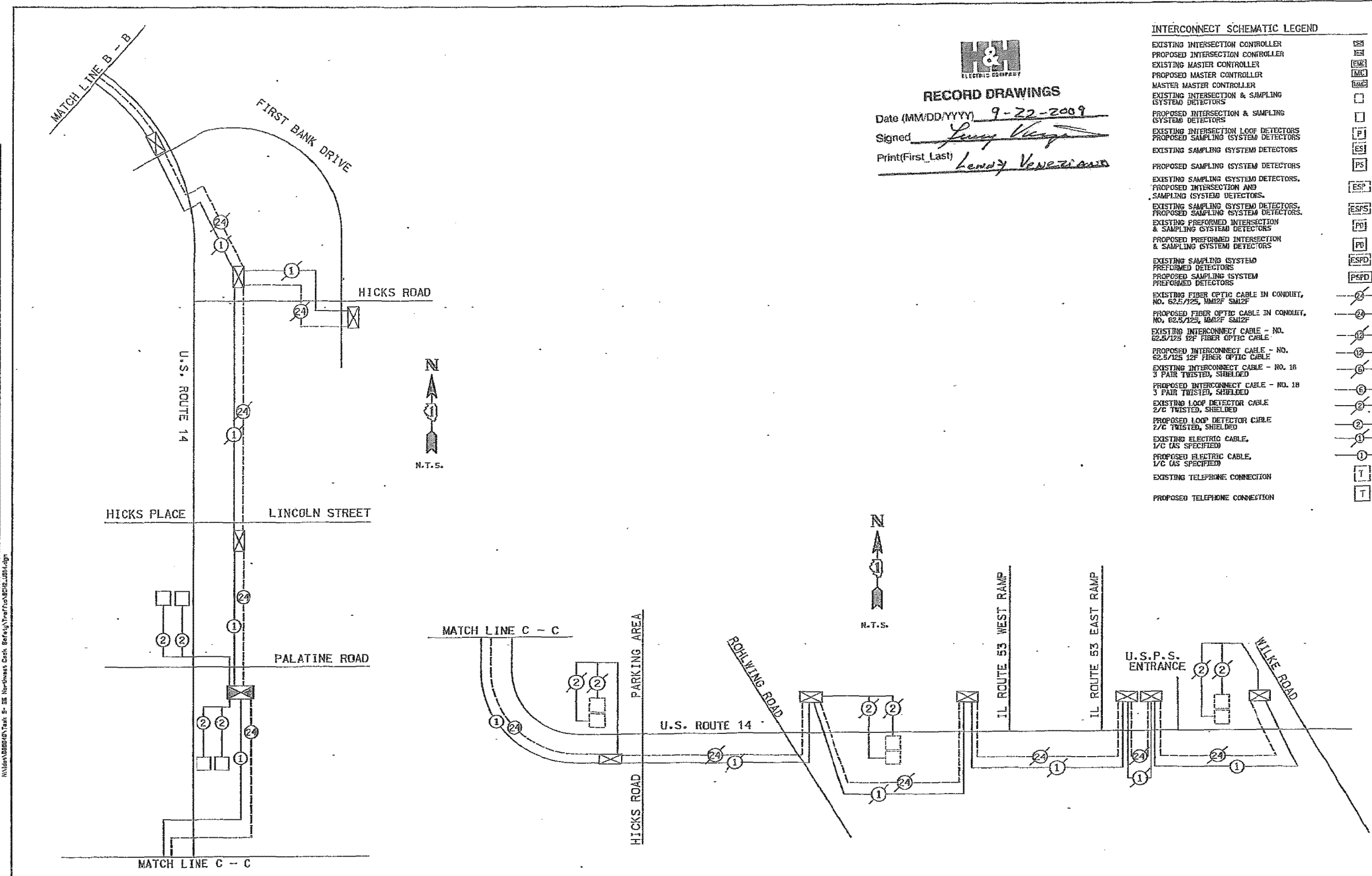

CURTIS D. BURKE ENGINEERING LTD.
 8075 West Hick's Road
 Rosemont, Illinois 60018
 (847) 825-0800
 N:\data\B0804\Task 5 - IL Northwest Cook, SoFar\Draw\Interconnect.dwg

FILE NAME = N:\data\B0804\Task 5 - IL Northwest Cook, SoFar\Draw\Interconnect.dwg	USER NAME = IPACOME	DESIGNED - ABR	REVISED -
		DRAWN - FFB / FCP	REVISED -
		CHECKED - MUT	REVISED -
		DATE -	REVISED -

**STATE OF ILLINOIS
DEPARTMENT OF TRANSPORTATION**

**INTERCONNECT SCHEMATIC
U.S. ROUTE 14 FROM BALDWIN ROAD TO WILKE ROAD
PALATINE, ILLINOIS**

F.A.U. R.T.E.	SECTION	COUNTY	TOTAL SHEETS	SHEET NO.
VAR	2009-042-TS	COOK	30	23
FED. ROAD DIST. NO.			ILLINOIS FED. AID PROJECT	
			CONTRACT NO. 60603	

FILE NAME = MICROST\352103\ INTERCONNECT SCH.DGN	USER NAME = JGC	DESIGNED - KK	REVISED -
		DRAWN - RDS/JGC	REVISED -
		CHECKED - BPT	REVISED -
		DATE - 03-07-13	REVISED -

**STATE OF ILLINOIS
DEPARTMENT OF TRANSPORTATION**

**INTERCONNECT SCHEMATIC
U.S. ROUTE 14 (NORTHWEST HWY./HICKS ROAD)**

F.A.U. R.T.E.	SECTION	COUNTY	TOTAL SHEETS	SHEET NO.
305	2012-042 TS	COOK	36	32
FED. ROAD DIST. NO.			ILLINOIS FED. AID PROJECT	
			CONTRACT NO. 60T90	

PREPARED BY:
CEMCON, Ltd.
 Consulting Engineers, Land Surveyors & Planners
 2280 White Oak Circle, Suite 100
 Aurora, Illinois 60504-9675
 Ph: 630.862.2100 Fax: 630.862.2199
 E-Mail: cadd@cemcon.com Website: www.cemcon.com