

NOTE:
UNLESS NOTED OTHERWISE, ALL STATIONS AND OFFSETS USED
ARE TAKEN FROM EITHER EXISTING EB AND WB I-290 BASELINES

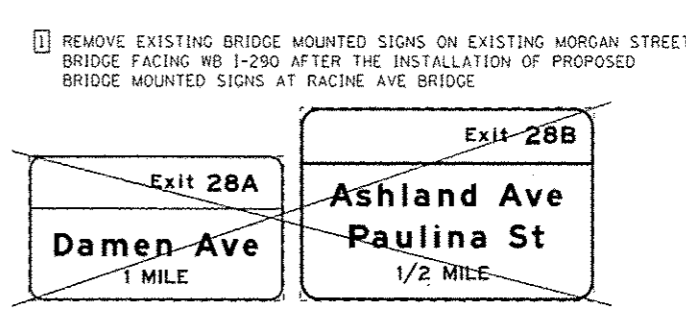
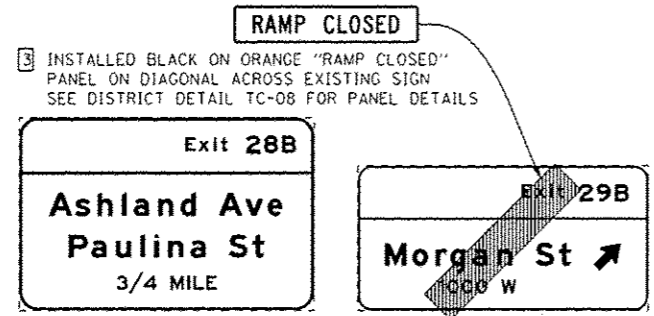
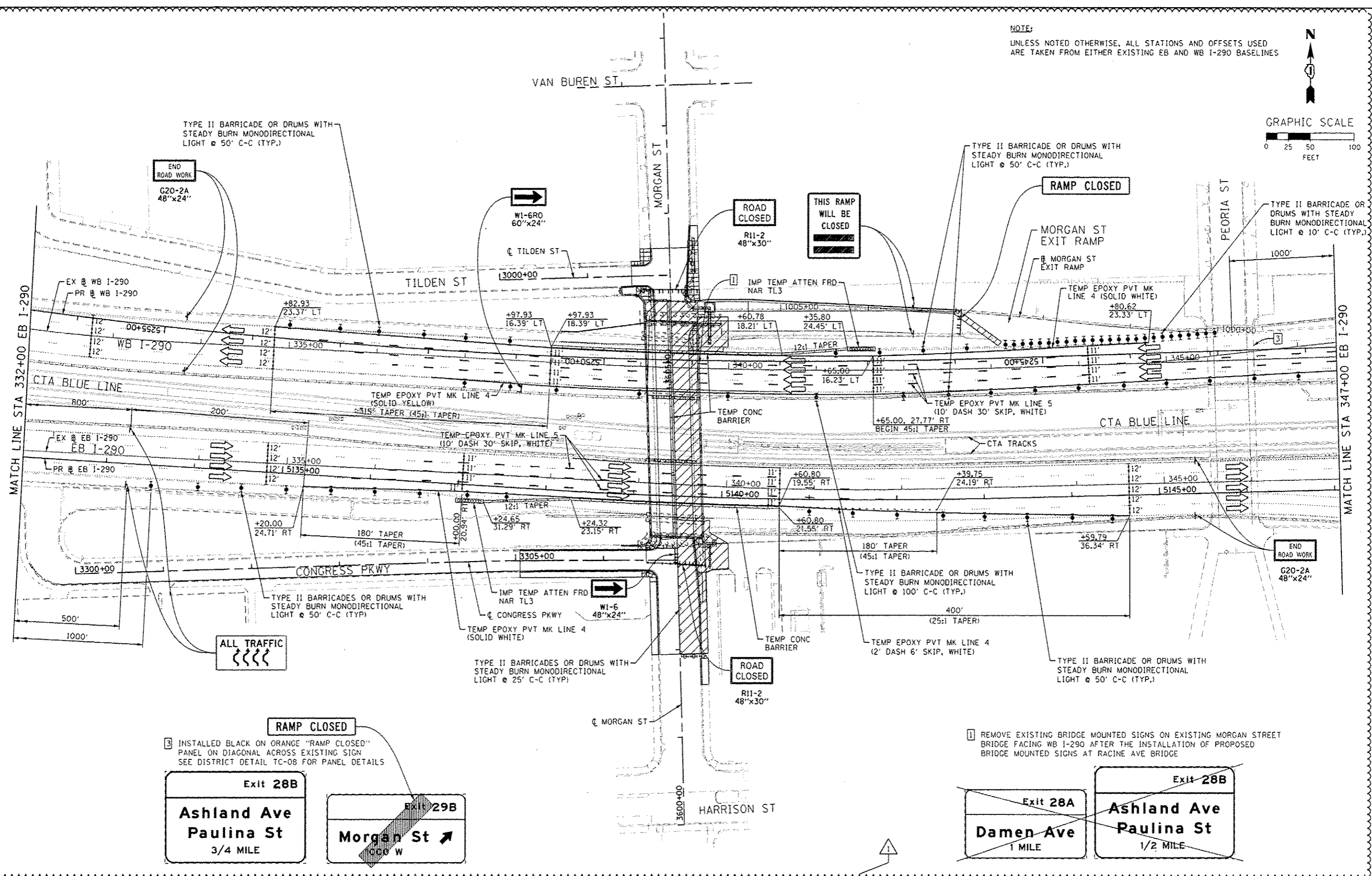
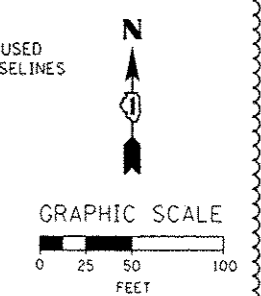

FILE PATH: C:\Users\Chuan\Desktop\60W25\60W25-29-1-Stage1-02.dgn

AECOM 303 EAST WACKER DRIVE, SUITE 1400 CHICAGO, IL 60601-3276 PHONE (312) 373-1700 FAX (312) 373-6800	016W25-Sht-Stage1-02.dgn	DESIGNED - OPS	REVISED - 7/19/2013
	USER NAME - chuan	DRAWN - PHP	REVISED -
	PLOT SCALE - 5/8"=1' - 1/4"	CHECKED - DBM	REVISED -
	PLOT DATE - 7/16/2013	DATE - 6/17/2013	REVISED -

**STATE OF ILLINOIS
DEPARTMENT OF TRANSPORTATION**

SUGGESTED STAGES OF CONSTRUCTION AND TRAFFIC CONTROL
STAGE 1
SCALE: 1" = 50' SHEET 2 OF 7 SHEETS STA. TO STA.

F.A.I. RTE. 90/94/290	SECTION 2013-007R	COUNTY COOK	TOTAL SHEETS 317	SHEET NO. 57
CONTRACT NO. 60W25				ILLINOIS FED. AID PROJECT