

NOTE:
UNLESS NOTED OTHERWISE, ALL STATIONS AND OFFSETS USED
ARE TAKEN FROM EITHER EXISTING EB AND WB I-290 BASELINES

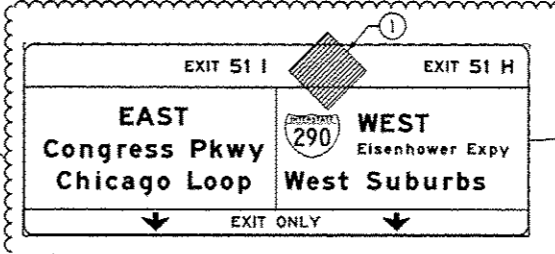

FILE PATH: C:\Users\chris\Documents\Projects\9029\9029.dwg

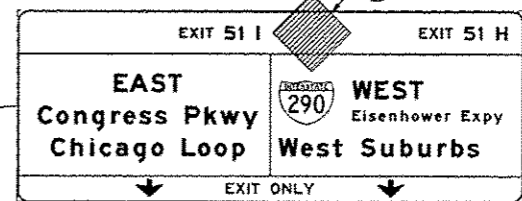
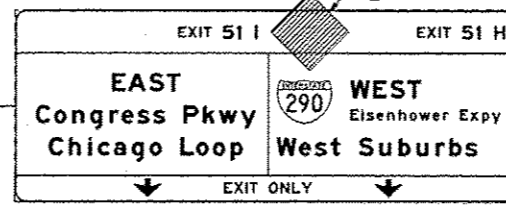
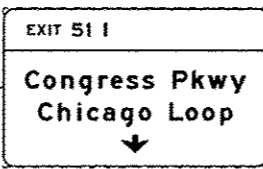
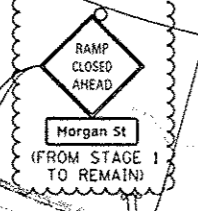
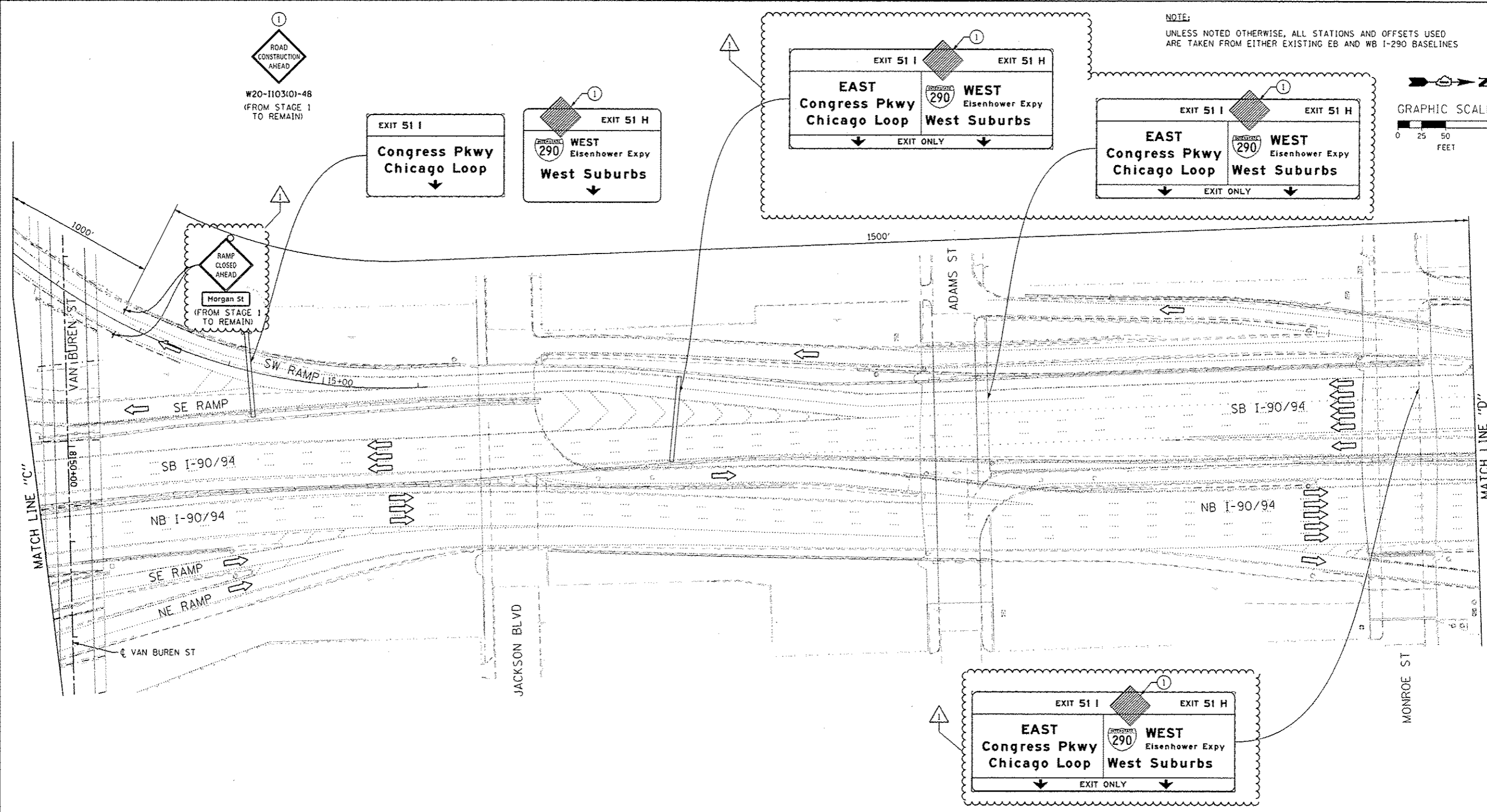
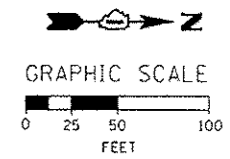

DWG: 9029-9029-Stage3-06.dwg	DESIGNED - OPS	REVISED - 7/19/2013
USER NAME: chris	DRAWN - PHP	REVISED -
PLT SCALE: 50.0000' / 1"	CHECKED - DBM	REVISED -
PLT DATE: 7/18/2013	DATE - 6/17/2013	REVISED -

STATE OF ILLINOIS
DEPARTMENT OF TRANSPORTATION

SUGGESTED STAGES OF CONSTRUCTION AND TRAFFIC CONTROL
STAGE 3

SCALE: 1" = 50' SHEET 6 OF 7 SHEETS STA. TO STA.

F.A.I. RTE.	SECTION	COUNTY	TOTAL SHEETS	SHEET NO.
90/94/290	2013-007R	COOK	317	75
CONTRACT NO. 60W25				
ILLINOIS FED. AID PROJECT				