

REMOVE, STORE, AND RE-ERECT OVERHEAD SIGN PANEL (SPECIAL) (RESTORE AFTER CONSTRUCTION IS COMPLETED - PAID FOR IN STAGE 1)

EXIT TO MORGAN ST PROHIBITED

(FROM STAGE 1 TO REMAIN)



Morgan St
STA. 18+90.00
(NW RAMP)

NOTE:

UNLESS NOTED OTHERWISE, ALL STATIONS AND OFFSETS USED ARE TAKEN FROM EITHER EXISTING EB AND WB I-290 BASELINES

(FROM STAGE TO REMAIN)

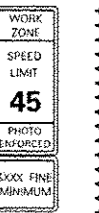

W2-1115(0)-3618
R2-1-3648
R10-190P-3618
R2-1106-3618
STA. 360+00.00
(EX WB I-290)

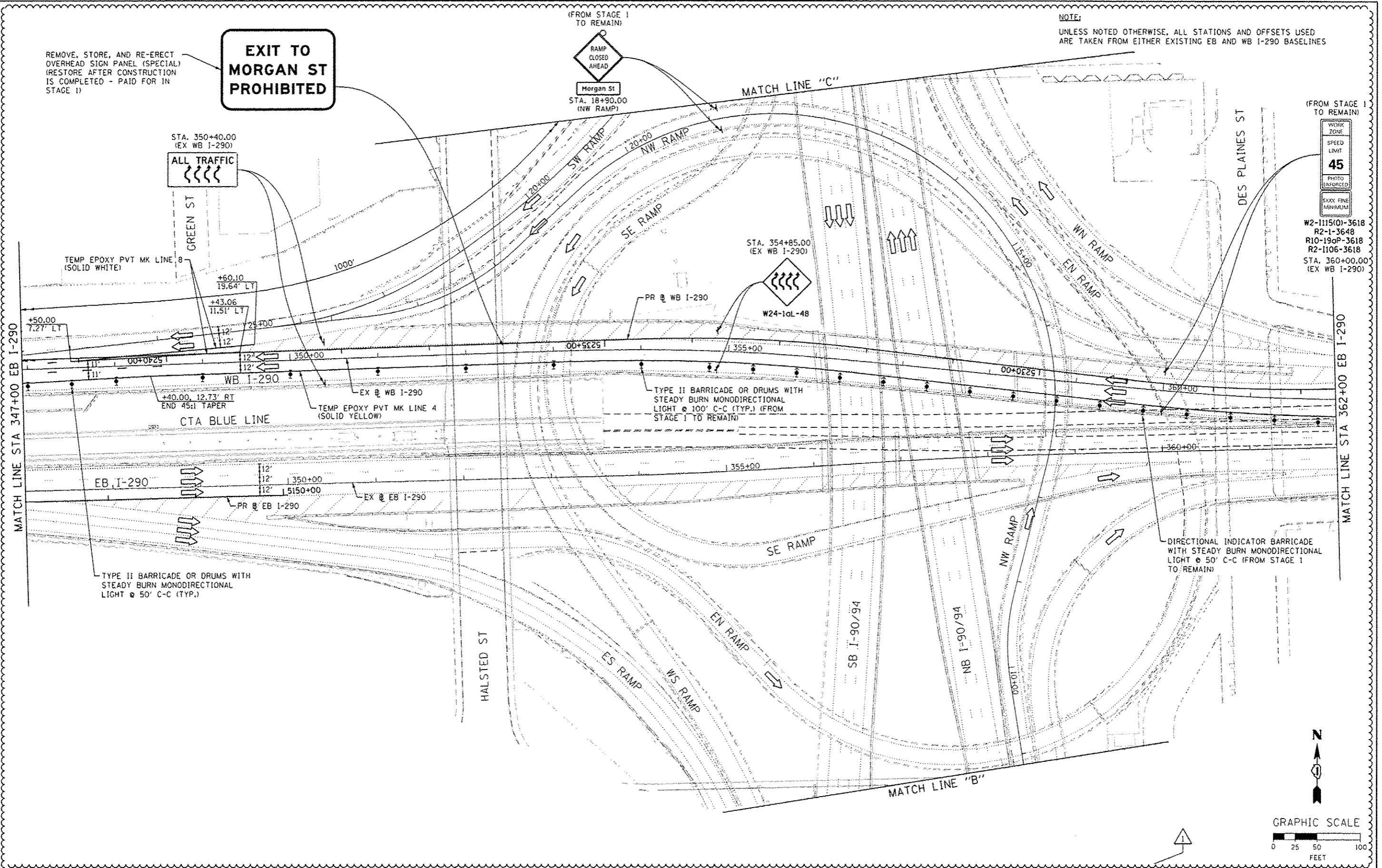

STA. 350+40.00
(EX WB I-290)



TEMP EPOXY PVT MK LINE 8
(SOLID WHITE)

+60.10
19.64' LT

+43.06
11.51' LT

+50.00
7.27' LT

+40.00, 12.73' RT
END 45:1 TAPER

CTA BLUE LINE

EB I-290

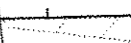

TYPE II BARRICADE OR DRUMS WITH STEADY BURN MONODIRECTIONAL LIGHT @ 50' C-C (TYP.)

TYPE II BARRICADE OR DRUMS WITH STEADY BURN MONODIRECTIONAL LIGHT @ 100' C-C (TYP.) (FROM STAGE 1 TO REMAIN)

DIRECTIONAL INDICATOR BARRICADE WITH STEADY BURN MONODIRECTIONAL LIGHT @ 50' C-C (FROM STAGE 1 TO REMAIN)



GRAPHIC SCALE



DIBW25-shr-Staging4-93.dgn
USER NAME = chlu
PLOT SCALE = 50.0000 1 / in.
PLOT DATE = 7/16/2013

DESIGNED - OPS	REVISED - 7/19/2013
DRAWN - PHP	REVISED -
CHECKED - DBM	REVISED -
DATE -	REVISED -

STATE OF ILLINOIS
DEPARTMENT OF TRANSPORTATION

SUGGESTED STAGES OF CONSTRUCTION AND TRAFFIC CONTROL
STAGE 4

SCALE: 1" = 50' SHEET 3 OF 7 SHEETS STA. TO STA.

F.A.I. RTE.	SECTION	COUNTY	TOTAL SHEETS	SHEET NO.
90/94/290	2013-007R	COOK	317	76C
CONTRACT NO. 60W25				
ILLINOIS FED. AID PROJECT				

FILE PATH: C:\Users\chlu\Desktop\2013\007R\007R\60W25-shr-Staging4-93.dgn