

COMED UTILITY SUPPORT - SEQUENCE OF CONSTRUCTION

1. BEFORE IDOT CONSTRUCTION COMMENCES:
 - a. COMED CONTRACTOR TO:
 - i. REMOVE EXISTING DUCT SUPPORT SYSTEM FROM EXISTING BRIDGE DECK.
 - ii. REMOVE EXISTING ASBESTOS INSULATION (INCLUDING ASBESTOS FROM CITY OF CHICAGO FACILITIES ON BRIDGE AND APPROACHES).
 - iii. REMOVE EXISTING CONDUITS AND ENCLOSE EXISTING CABLES IN WOODEN BOX.
 - iv. SUPPORT BOX OF DUCTS ON WOOD LAGGING PER IDOT SPECIFICATIONS (PROTECTIVE SHIELD SPECIAL) BETWEEN EXISTING STEEL W33 BRIDGE BEAMS.
2. IDOT CONTRACTOR REMOVES EXISTING EAST HALF OF CONCRETE BRIDGE DECK.
3. IDOT CONTRACTOR INSTALLS TEMPORARY SHORING TOWER AND EAST W36 TEMPORARY SUPPORT BEAMS PER HBK PLANS. COMED CONTRACTOR PROVIDES AND INSTALLS EAST W24 TEMPORARY SUPPORT BEAMS AND ALL WOODEN BOX SUPPORTS OF DUCTS AND ASSOCIATED CABLES ON W36 SUPPORT BEAM TO BE FURNISHED BY COMED AND INSTALLED BY IDOT CONTRACTOR.
4. IDOT CONTRACTOR TO REMOVE EXISTING W33 STEEL BEAMS FOR THE EAST HALF OF THE BRIDGE.
5. IDOT CONTRACTOR REMOVES TOP WALLS OF EXISTING ABUTMENTS FOR THE EAST HALF OF THE BRIDGE. EXISTING ABUTMENT STEMS TO REMAIN IN PLACE FOR SUPPORT OF COMED SUPPORT STRUCTURE.
6. IDOT CONTRACTOR TO REMOVE APPROACH SLAB ASPHALT/CONCRETE STRUCTURE.
7. COMED CONTRACTOR TO EXCAVATE TO BOTH EXISTING COMED DUCTS IN APPROACH AREA (EAST AND WEST SIDES) AND TIE UP WITH STEEL SUPPORT BEAM PER HBK PLANS.
8. IDOT CONTRACTOR TO EXCAVATE EXISTING APPROACH AREA.
9. COMED CONTRACTOR TO MANIPULATE THE CONDUITS / CABLES TO ALLOW FOR CAISSON DRILLING FOR ABUTMENTS.
10. IDOT CONTRACTOR TO CONSTRUCT NEW ABUTMENTS.
11. IDOT CONTRACTOR DEMOLISHES EXISTING EAST HALF OF THE PIERS.
12. COMED CONTRACTOR TO MANIPULATE THE CONDUITS / CABLES TO ALLOW FOR CAISSON DRILLING FOR EAST HALF OF PIERS.
13. IDOT CONTRACTOR CONSTRUCTS NEW EAST HALF OF PIERS INCLUDING FOUNDATIONS.
14. IDOT CONTRACTOR PLACES NEW STEEL W36X182 BEAMS AND DIAPHRAGMS FOR EAST HALF OF BRIDGE.
15. COMED CONTRACTOR SUPPORTS EAST BOX OF DUCTS ON WOOD LAGGING PER IDOT SPECIFICATIONS (PROTECTIVE SHIELD SPECIAL) BETWEEN NEW STEEL W36 BRIDGE BEAMS AND PROTECTS TOP OF WOOD BOX FROM DECK PLACEMENT WITH WOOD LAGGING PER IDOT SPECIFICATIONS (PROTECTIVE SHIELD SPECIAL).
16. IDOT CONTRACTOR REMOVES EAST SUPPORT BEAM.
17. IDOT CONTRACTOR FORMS NEW EAST DECK FOR MORGAN STREET BRIDGE AND PLACES INSERTS IN DECK FOR UTILITY SUPPORT. IDOT CONTRACTOR COMPLETES EAST DECK AND PROTECTS COMED CONDUITS.
18. COMED CONTRACTOR PLACES NEW EAST DUCT ON CONDUITS AND SUPPORTS DUCT WITH IDOT/COMED APPROVED DUCT SUPPORT SYSTEM FROM DECK INSERTS AFTER IDOT CONSTRUCTION OF THE EAST DECK IS COMPLETE.
19. IDOT CONTRACTOR WEST W36 TEMPORARY SUPPORT BEAMS PER HBK PLANS. COMED CONTRACTOR PROVIDES AND INSTALLS WEST W24 TEMPORARY SUPPORT BEAMS AND ALL WOODEN BOX SUPPORTS OF DUCTS AND ASSOCIATED CABLES
20. IDOT CONTRACTOR DEMOLISHES EXISTING WEST HALF OF THE PIERS.
21. COMED CONTRACTOR TO MANIPULATE THE CONDUITS / CABLES TO ALLOW FOR CAISSON DRILLING FOR WEST HALF OF PIERS.
22. IDOT CONTRACTOR CONSTRUCTS NEW WEST HALF OF PIERS INCLUDING FOUNDATIONS.
23. IDOT CONTRACTOR PLACES NEW STEEL W36X182 BEAMS AND DIAPHRAGMS FOR WEST HALF OF BRIDGE.
24. COMED CONTRACTOR SUPPORTS WEST BOX OF DUCTS ON WOOD LAGGING PER IDOT SPECIFICATIONS (PROTECTIVE SHIELD SPECIAL) BETWEEN NEW STEEL W36 BRIDGE BEAMS AND PROTECTS TOP OF WOOD BOX FROM DECK PLACEMENT WITH WOOD LAGGING PER IDOT SPECIFICATIONS (PROTECTIVE SHIELD SPECIAL).
25. IDOT CONTRACTOR REMOVES WEST SUPPORT BEAM.
26. IDOT CONTRACTOR FORMS NEW WEST DECK FOR MORGAN STREET BRIDGE AND PLACES INSERTS IN DECK FOR UTILITY SUPPORT. IDOT CONTRACTOR CONSTRUCTS WEST DECK AND PROTECTS COMED CONDUITS.
27. COMED CONTRACTOR PLACES NEW WEST DUCT ON CONDUITS AND SUPPORTS DUCT WITH IDOT/COMED APPROVED DUCT SUPPORT SYSTEM FROM DECK INSERTS AFTER IDOT CONSTRUCTION OF THE WEST DECK IS COMPLETE.

1 PARTIAL FOUNDATION LAYOUT
SCALE: 1/8" = 1' - 0"

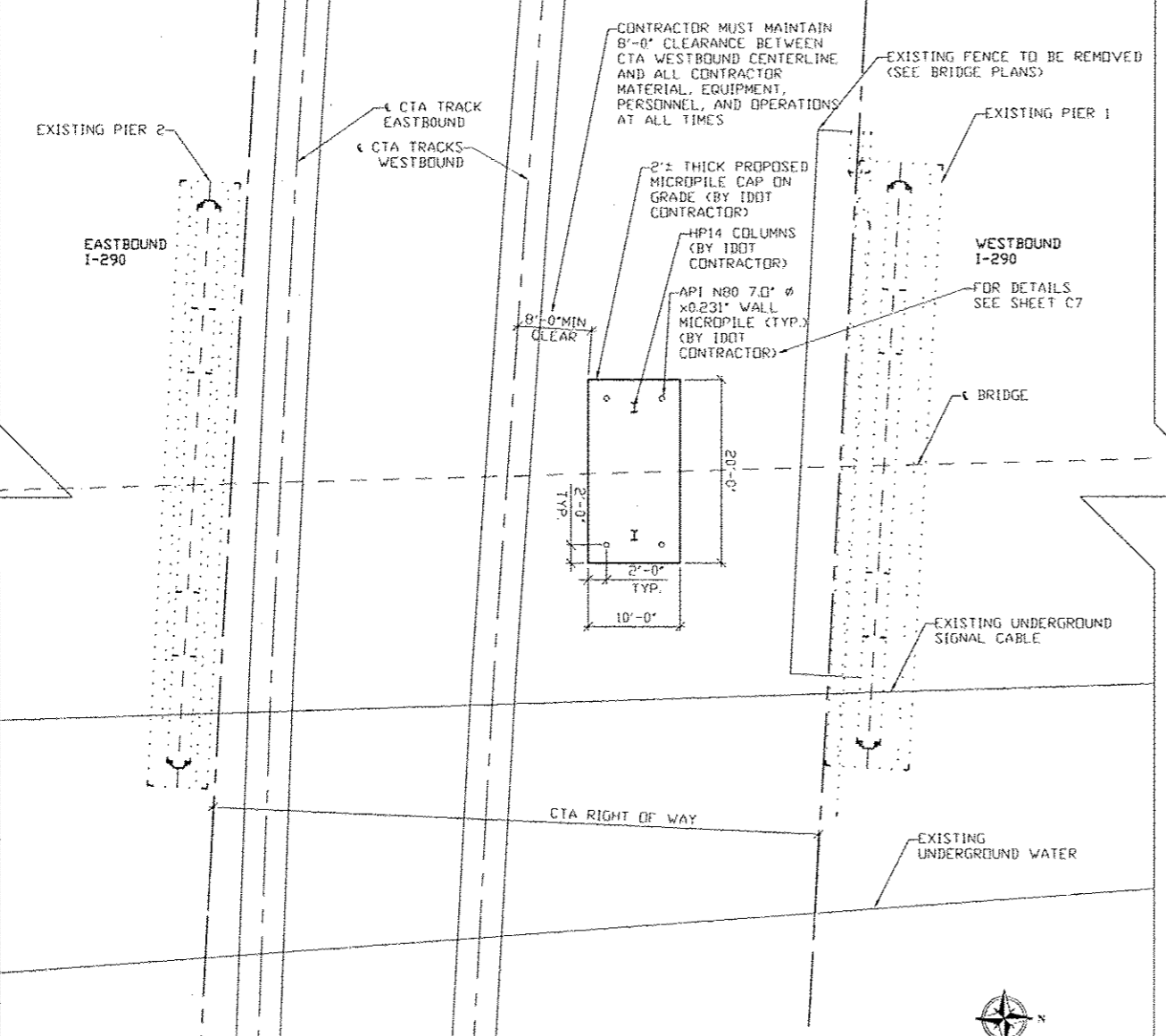

CONTRACTOR MUST MAINTAIN 8'-0" CLEARANCE BETWEEN CTA WESTBOUND CENTERLINE AND ALL CONTRACTOR MATERIAL, EQUIPMENT, PERSONNEL, AND OPERATIONS AT ALL TIMES

EXISTING FENCE TO BE REMOVED (SEE BRIDGE PLANS)

FOR DETAILS SEE SHEET C7



ANDREW J. SCHWARY
STRUCTURAL ENGINEER
EXPIRES 11-30-2014
SIGNATURE: Andrew J. Schwary
DATE: 07-19-2013

BRIERLEY ASSOCIATES
Creating Space Underground



HBK ENGINEERING, LLC
421 WEST VAN BUREN, SUITE 100
CHICAGO, IL 60607
PHONE: (312) 442-0074 FAX: (312) 442-0424
STATE OF ILLINOIS LICENSE NO. 081-002384
REGISTERED PROFESSIONAL ENGINEER

ANY MODIFICATION OR ADDITION TO THIS DRAWING BY ANY ORGANIZATION OTHER THAN HBK ENGINEERING IS NOT THE RESPONSIBILITY OF HBK ENGINEERING

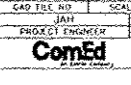

PROJECT NO. 13-503
SHEET 92B OF 317

REV	DESCRIPTION	P.D.	P.E.	DATE
07/21/13	ADDENDUM #1	JAH	AJS	AJS

T.S. NO.	AS NOTED	JAH
CAP. TEL. NO.	SCALE	PROJECT DESIGNER
PROJECT ENGINEER	EXTENSION	DATE
DWG. NO.	C2	SHEET 92B OF 317