

NOTES:

- ELEVATIONS ARE PROVIDED AT THE BACK OF CURB (C) AND FLOWLINE (F).
- 1:12 MAXIMUM RAMP SLOPE IS NOTED WHERE CITY OF CHICAGO DESIGN STANDARD (1:14) IS EXCEEDED.

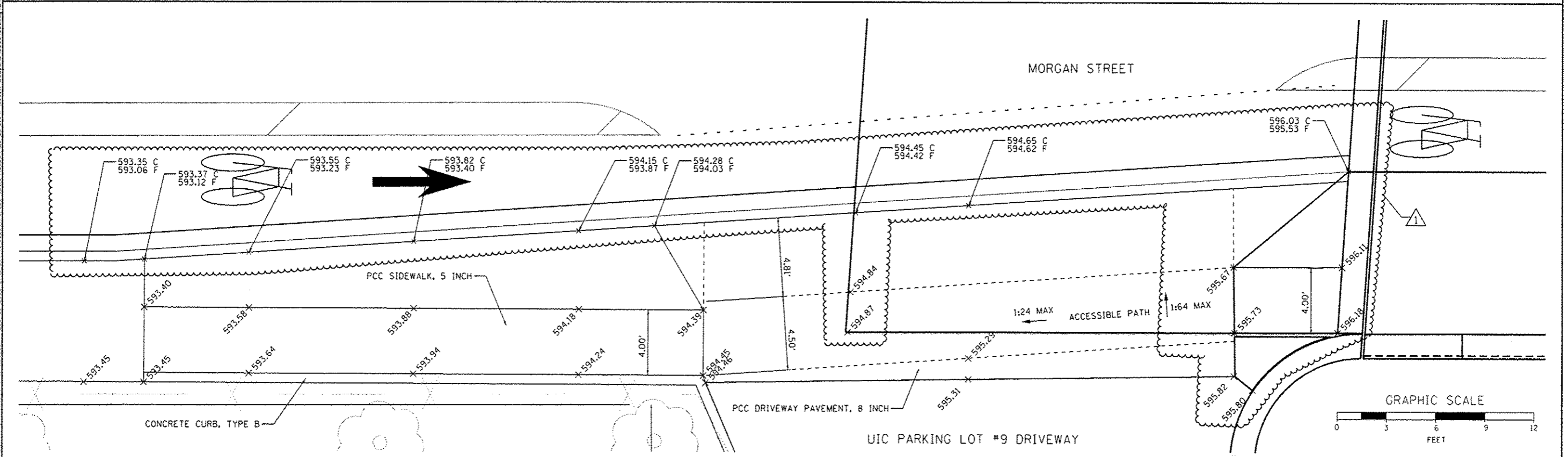

FILE PATH: \\p01\388533\p01\388533\assmnt\me\loc\p01\388533\Documents\B1_Ans\2013\Transportation\60W25\60W25_CurbRamp\60W25_CurbRamp.dwg
 USER: chrisa
 PLOT SCALE: 3/8" = 1' / 1" = 12'
 PLOT DATE: 7/15/2013

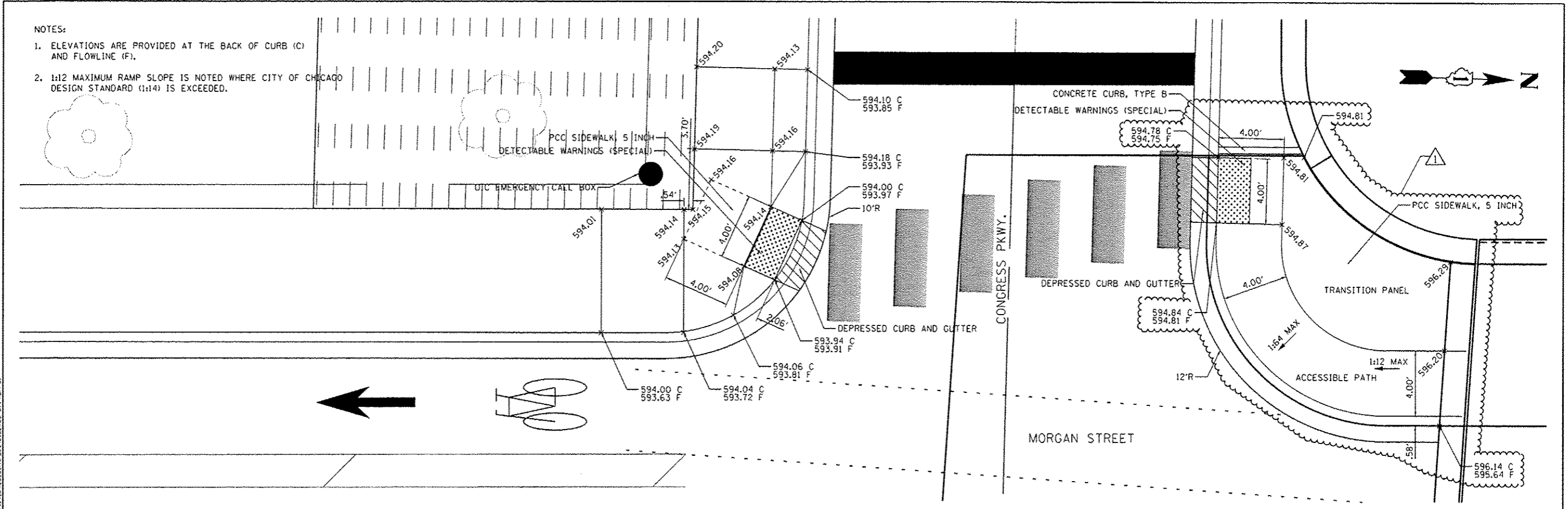

DWG NO: 60W25-shl-40A-01	DESIGNED - BMC	REVISED - 7/19/2013
USER NAME: chrisa	DRAWN - BMC	REVISED -
PLOT SCALE: 3/8" = 1' / 1" = 12'	CHECKED - AFC	REVISED -
PLOT DATE: 7/15/2013	DATE - 5/14/2013	REVISED -

STATE OF ILLINOIS
DEPARTMENT OF TRANSPORTATION

CURB RAMP DETAILS
MORGAN STREET AT CONGRESS PARKWAY
MORGAN STREET AT UIC PARKING LOT #9 DRIVEWAY

F.A.I. RTE. 90/94/290	SECTION 2013-007R	COUNTY COOK	TOTAL SHEETS 317	SHEET NO. 96
CONTRACT NO. 60W25				
ILLINOIS FED. AID PROJECT				

SCALE: 1" = 3' SHEET 1 OF 3 SHEETS STA. TO STA.