

"P-IKE-EB-3"
CURVE DATA
(F.A.I. Rte. I-290 EB)

P.I. Sta. = 5140+57.13
 $\Delta = 5^\circ 07' 22''$ (LT)
 $D = 1^\circ 00' 19''$
 $R = 5,700.00'$
 $T = 254.99'$
 $L = 509.63'$
 $E = 5.70'$
 $e = RC(2.00\%)$
 $T.R. = 96'$
 $S.E. Run = 96'$
 $P.C. Sta. = 5138+02.14$
 $P.T. Sta. = 5143+11.78$

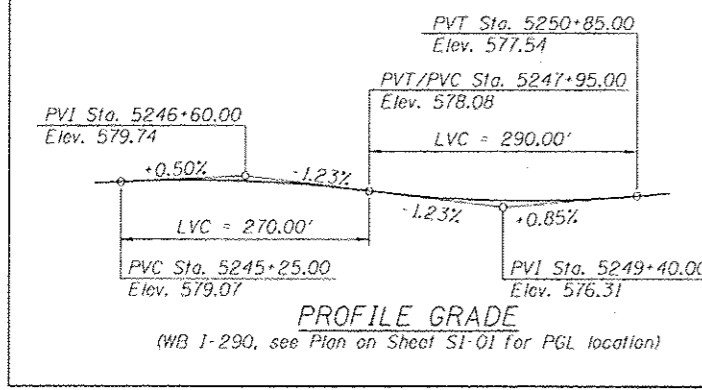

"P-IKE-WB-3"
CURVE DATA
(F.A.I. Rte. I-290 WB)

P.I. Sta. = 5251+25.31
 $\Delta = 9^\circ 58' 24''$ (RT)
 $D = 0^\circ 53' 03''$
 $R = 6,480.00'$
 $T = 565.40'$
 $L = 1,127.95'$
 $E = 24.62'$
 $e = RC(2.00\%)$
 $T.R. = 72'$
 $S.E. Run = 72'$
 $P.C. Sta. = 5245+59.91$
 $P.T. Sta. = 5256+87.86$

INDEX OF SHEETS

- SI-01 General Plan and Elevation
- SI-02 Index of Sheets, PGLs and Total Bill of Material
- SI-03 General Notes
- SI-04 Stages 1 and 2 Construction
- SI-04A Stages 3 and 4 Construction
- SI-05 Substructure Layout
- SI-06 Existing Structure Removal Plan and Elevation
- SI-07 Existing Structure Removal Details 1 of 2
- SI-08 Existing Structure Removal Details 2 of 2
- SI-09 Temporary Concrete Barrier
- SI-10 Top of Slab Elevation Locations
- SI-11 Top of Slab Elevations (Sheet 1 of 3)
- SI-12 Top of Slab Elevations (Sheet 2 of 3)
- SI-13 Top of Slab Elevations (Sheet 3 of 3)
- SI-14 Top of South Approach Slab Elevations
- SI-15 Top of North Approach Slab Elevations
- SI-16 Deck Plan and Cross Section
- SI-17 Parapet Elevations and Details
- SI-18 Deck Cross Sections, Details and Bill of Material
- SI-19 Preformed Joint Strip Seal
- SI-20 Decorative Railing Parapet Mounted Details
- SI-21 Bridge Fence Railing (Special) Elevations
- SI-21A Bridge Fence Railing (Special) Details
- SI-22 Framing Plan and Beam Elevation
- SI-23 Girder Moment and Reaction Tables
- SI-24 Structural Steel Details
- SI-25 Elastomeric Bearing Type I and Fixed Bearing
- SI-26 Elastomeric Bearing Type II
- SI-27 South Abutment Plan and Elevation
- SI-28 South Abutment Footing Plan and Sections
- SI-29 South Abutment Sections and Details
- SI-30 South Abutment Wingwalls
- SI-31 South Abutment Architectural Details
- SI-32 North Abutment Plan and Elevation
- SI-33 North Abutment Footing Plan and Sections
- SI-34 North Abutment Sections and Details
- SI-35 North Abutment Wingwalls
- SI-36 North Abutment Architectural Details
- SI-37 Pier 1 Plan and Elevation
- SI-38 Pier 1 Sections and Details
- SI-39 Pier 1 Architectural Details
- SI-40 Pier 2 Plan and Elevation
- SI-41 Pier 2 Sections and Details
- SI-42 Pier 2 Architectural Details
- SI-43 South Approach Slab Plan
- SI-44 South Approach Slab Sections and Details
- SI-45 North Approach Slab Plan
- SI-46 North Approach Slab Sections and Details
- SI-47 South and North Approach Pile Bent Support
- SI-48 Bar Splicer Assembly and Mechanical Splicer Details
- SI-49 Boring Logs I
- SI-50 Boring Logs II
- SI-51 Boring Logs III

TOTAL BILL OF MATERIAL

ITEM	UNIT	SUPER.	SUB.	TOTAL QUANTITY
Removal of Existing Structures No. 1	EACH	1	-	1
Protective Shield	SQ YD	1,439	-	1,439
Structure Excavation	CU YD	-	144	144
Concrete Structures	CU YD	-	853.7	853.7
Concrete Superstructure	CU YD	766.5	-	766.5
Bridge Deck Grooving	SQ YD	1,287	-	1,287
Form Liner Textured Surface	SQ FT	-	1,732	1,732
Protective Coat	SQ YD	2,237	-	2,237
Furnishing and Erecting Structural Steel	L. SUM	1	-	1
Stud Shear Connectors	EACH	10,044	-	10,044
Reinforcement Bars	POUND	-	351,016	351,016
Reinforcement Bars, Epoxy Coated	POUND	167,950	194,480	362,430
Bar Splicers	EACH	789	242	1,031
Name Plates	EACH	1	-	1
Permanent Casing	FOOT	-	5,113	5,113
Drilled Shaft in Soil	CU YD	-	1,470	1,470
Drilled Shaft in Rock	CU YD	-	42	42
Preformed Joint Strip Seal	FOOT	124	-	124
Elastomeric Bearing Assembly, Type I	EACH	24	-	24
Elastomeric Bearing Assembly, Type II	EACH	12	-	12
Anchor Bolts, 1"	EACH	72	-	72
Anchor Bolts, 1/2"	EACH	24	-	24
Concrete Sealer	SQ FT	-	8,728	8,728
Geocomposite Wall Drain	SQ YD	-	391	391
Pile Extraction	EACH	-	27	27
Decorative Railing Parapet Mounted	FOOT	639	-	639
Braced Excavation	CU YD	-	2,906	2,906
Bridge Fence Railing (Special)	FOOT	140	-	140
Granular Backfill for Structures	CU YD	-	608	608
Pipe Underdrains For Structures 6"	FOOT	-	203	203

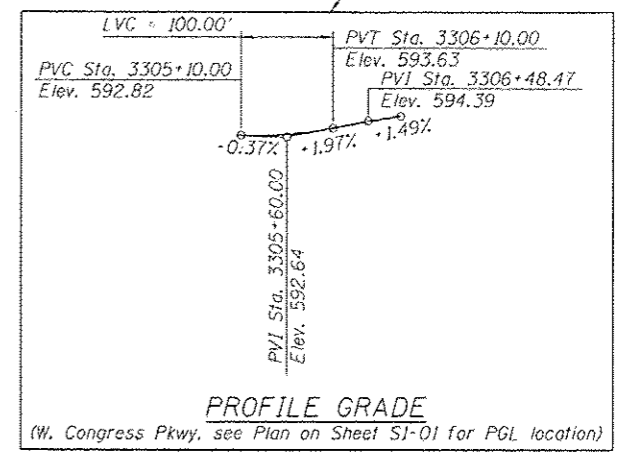
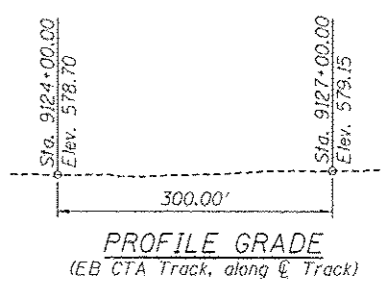
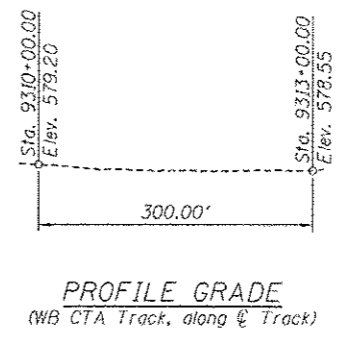
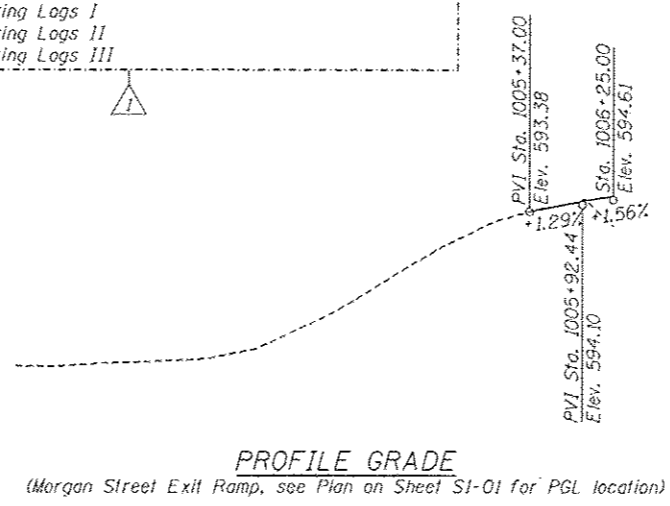

HBM
ENGINEERING GROUP, LLC
4415 WEST HARRISON ST.
SUITE 231
MILLSBORO, IL 60162
PHONE: (708) 236-0900
FAX: (708) 236-0901

0161709-60425-502-Ind-BOM
USER NAME = lisa.kalle...
PLOT SCALE = 01,0000 1" = 100'
PLOT DATE = 7/16/2013

DESIGNED BY - ME, JJS
DRAWN BY - JJS, LAB
CHECKED BY - MAI, MI, LAB
DATE - 6/17/2013

REVISIONS - 07/19/2013 MI, LAB
REVISIONS -
REVISIONS -
REVISIONS -

STATE OF ILLINOIS
DEPARTMENT OF TRANSPORTATION

INDEX OF SHEETS, PGLS AND TOTAL BILL OF MATERIAL
STRUCTURE NO. 016-1709

SCALE: SHEET SI-02 OF 51 SHEETS STA. TO STA.

F.A.I. RIF. 90/94/P90
SECTION 2013-007R
COUNTY COOK
TOTAL SHEETS 317
SHEET NO. 146
CONTRACT NO. 60W25
(ILLINOIS) FED. AID PROJECT