

FILE PATH = p:\388035-p\m\l\ecom\l\me\local\p\AECOM\0\Documents\01\_Americas\Transportation\60269938\_Circle\Phase\I\000\_CAD\006\_Roadway\Sheets\60W25-sht-Detour-02.dgn

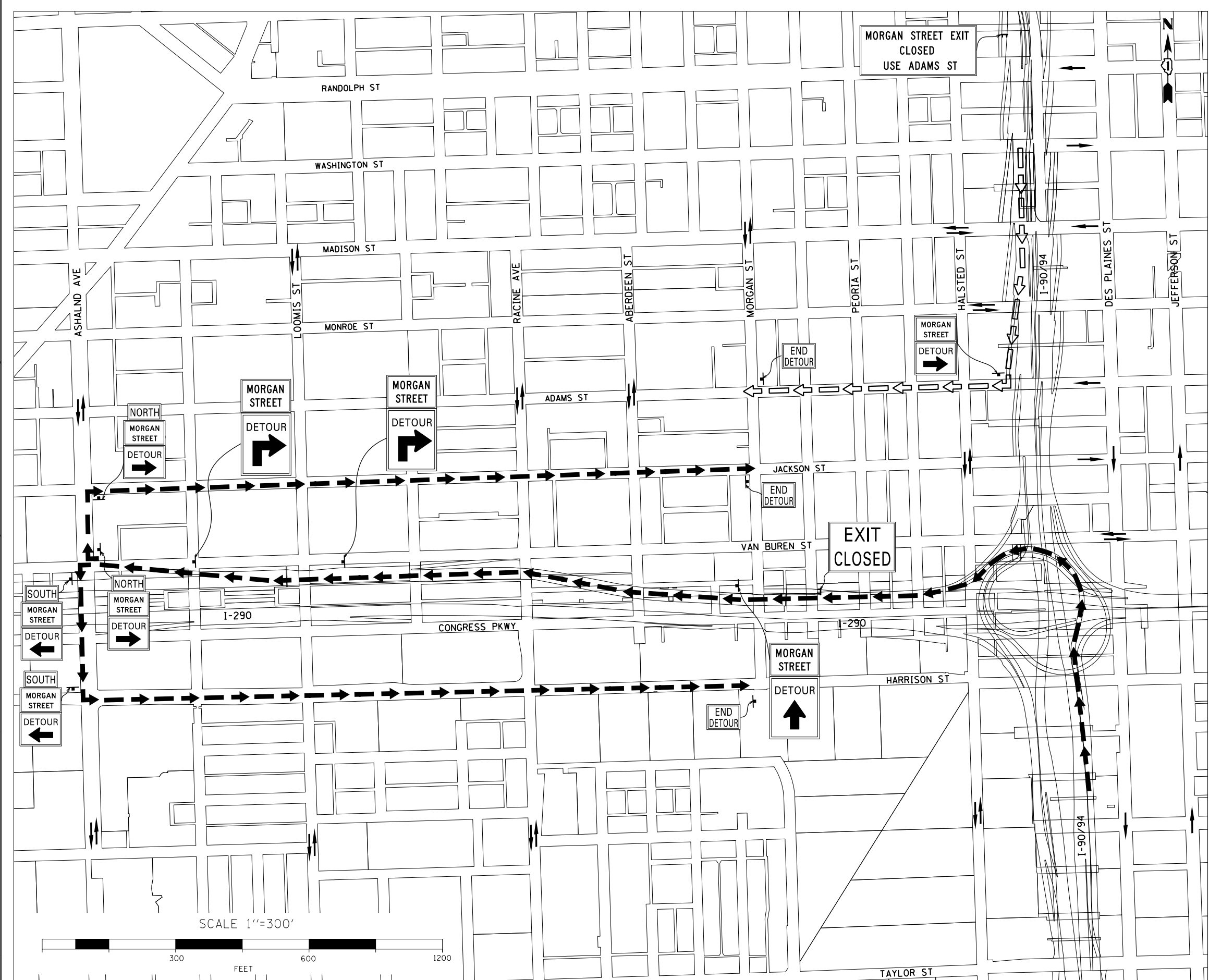

**TRAFFIC CONTROL NOTES**

1. Detour signing must be installed prior to closure of the Morgan Street Exit Ramp.
2. The contractor is responsible for coordination with other road work in the area.

**LEGEND**

- SOUTHBOUND SUGGESTED ALTERNATIVE ROUTE
- NORTHBOUND SUGGESTED ALTERNATIVE ROUTE
- ARROW BOARD
- TEMPORARY SIGN
- SIGN BARRICADE TYPE III
- ROADWAY DIRECTION

NORTH M3-1 24"x12"	SOUTH M3-3 24"x12"	MORGAN STREET CUSTOM SPECIAL BLACK LETTERS ON ORANGE BACKGROUND 30"x18"
DETOUR M4-9R 24"x30"	DETOUR M4-9L 24"x30"	DETOUR M4-9 24"x30"
DETOUR M4-9L 30"x24"	DETOUR M4-9R 30"x24"	EXIT CLOSED E5-2A 48"x36"
DETOUR M4-9R 36"x48"	DETOUR M4-9 48"x36"	END DETOUR M4-8A 24"x18"
MORGAN STREET EXIT CLOSED USE ADAMS ST CUSTOM SPECIAL BLACK LETTERS ON ORANGE BACKGROUND 84"x36"		MORGAN STREET CUSTOM SPECIAL BLACK LETTERS ON ORANGE BACKGROUND 36"x24"



D160W25-sht-Detour-02.dgn  
 USER NAME = brosej  
 PLOT SCALE = 300.0000' / in.  
 PLOT DATE = 5/15/2013

DESIGNED - JRB  
 DRAWN - JRB  
 CHECKED - SLW  
 DATE - 5/14/2013

REVISED -  
 REVISED -  
 REVISED -  
 REVISED -

**STATE OF ILLINOIS  
 DEPARTMENT OF TRANSPORTATION**

**MORGAN STREET EXIT RAMP DETOUR PLAN**

SCALE: 1"=300' SHEET 2 OF 2 SHEETS STA. TO STA.

F.A.I. R.E.	SECTION	COUNTY	TOTAL SHEETS	SHEET NO.
90/94/290	2013-007R	COOK	317	48
CONTRACT NO. 60W25				
ILLINOIS FED. AID PROJECT				