

NOTE:
UNLESS NOTED OTHERWISE, ALL STATIONS AND OFFSETS USED
ARE TAKEN FROM EITHER EXISTING EB AND WB I-290 BASELINES

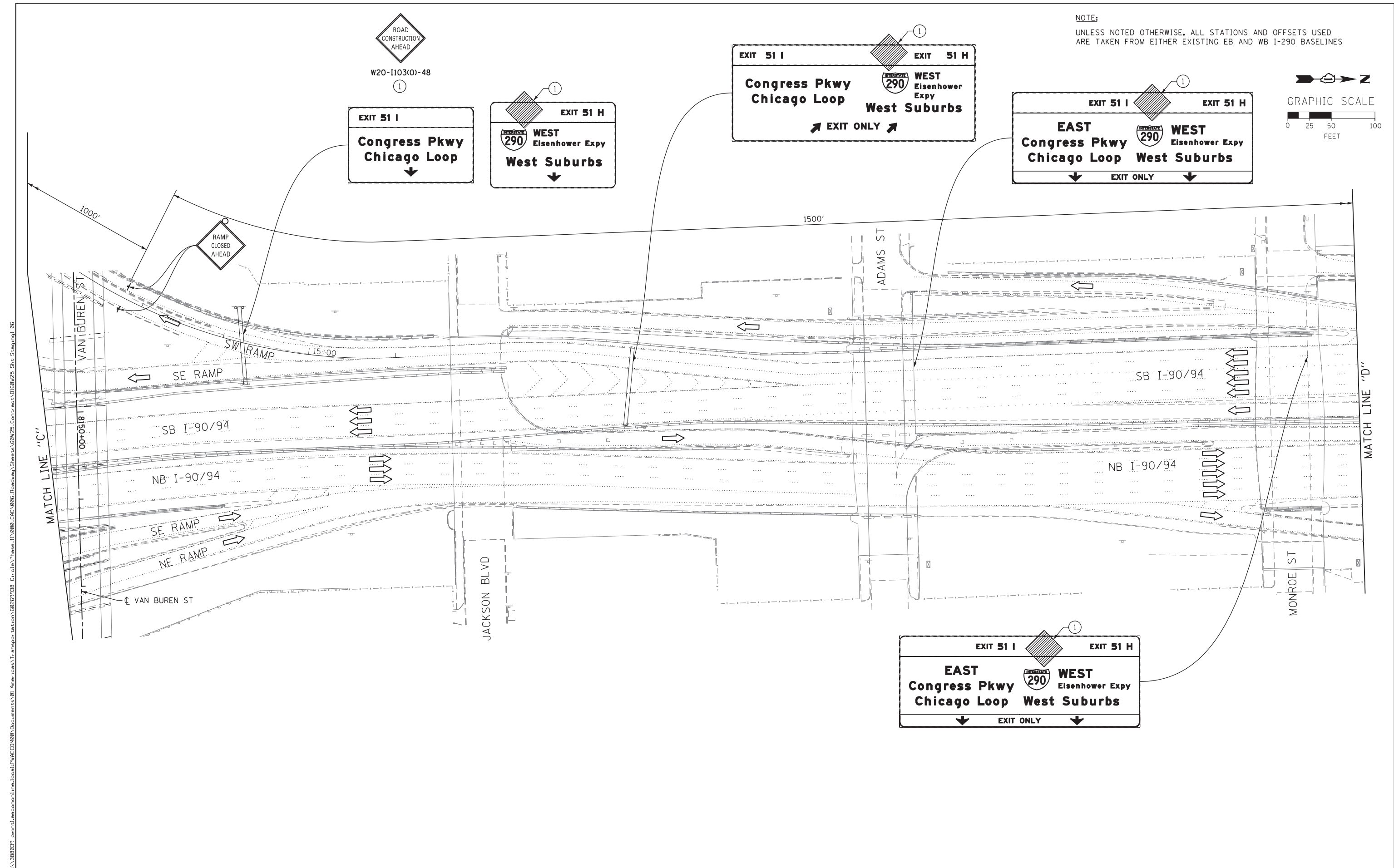

FILE PATH = ...\388035\pmt\escomon\me\local\AECOM\01\Documents\01_Americas\Transportation\60269938_Circle\Phase_1\000_CAD\006_Roadway\Sheets\60W25_Sht-Staging1-06

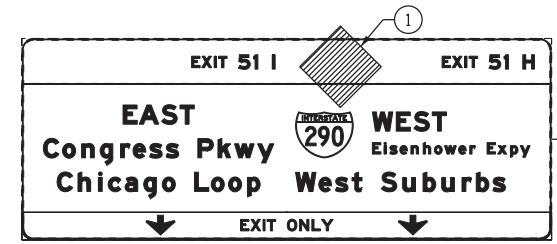
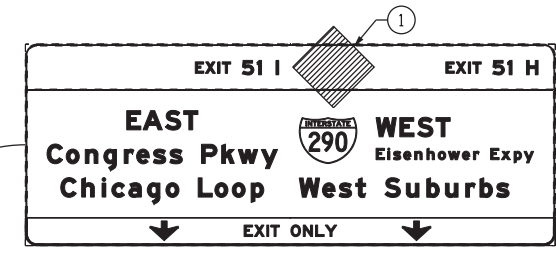
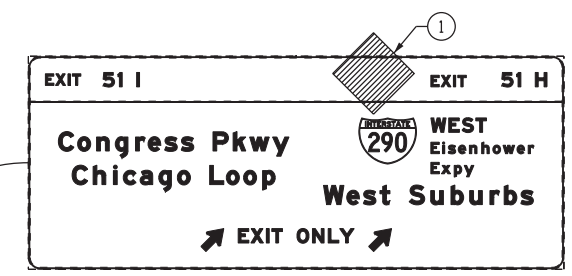
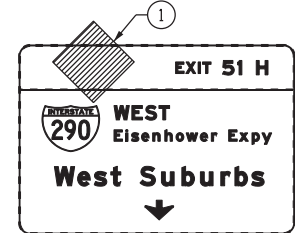
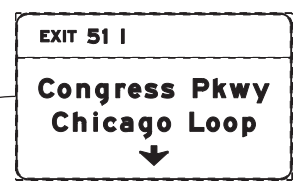
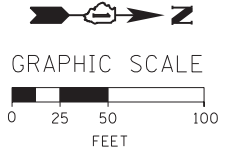

D160W25-Sht-Staging1-06
USER NAME = pimserno
PLOT SCALE = 50.0000' / in.
PLOT DATE = 6/14/2013

DESIGNED - OPS	REVISED -
DRAWN - PHP	REVISED -
CHECKED - DBM	REVISED -
DATE - 6/17/2013	REVISED -

STATE OF ILLINOIS
DEPARTMENT OF TRANSPORTATION

SUGGESTED STAGES OF CONSTRUCTION AND TRAFFIC CONTROL
STAGE 1
SCALE: 1" = 50' SHEET 6 OF 7 SHEETS STA. TO STA.

F.A.I. RTE. 90/94/290	SECTION 2013-007R	COUNTY COOK	TOTAL SHEETS 317	SHEET NO. 61
CONTRACT NO. 60W25				ILLINOIS FED. AID PROJECT