

NOTE:  
UNLESS NOTED OTHERWISE, ALL STATIONS AND OFFSETS USED  
ARE TAKEN FROM EITHER EXISTING EB AND WB I-290 BASELINES

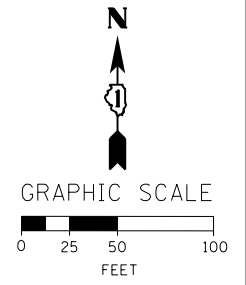

FILE PATH = ...\388035-par\1\escomon\1\local\AECOM\0\Documents\01\_Americas\Transportation\66269938\_Circle\Phase\_1\1\000\_CAD\006\_Roadway\_Sheets\60W25-sht-Staging-04

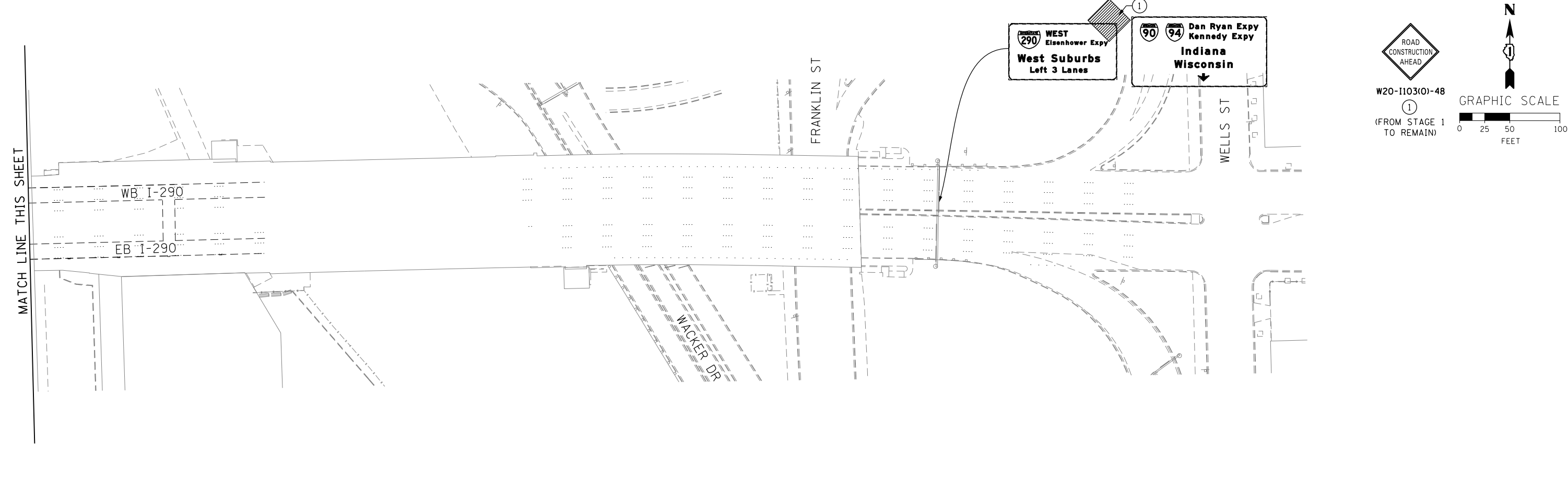
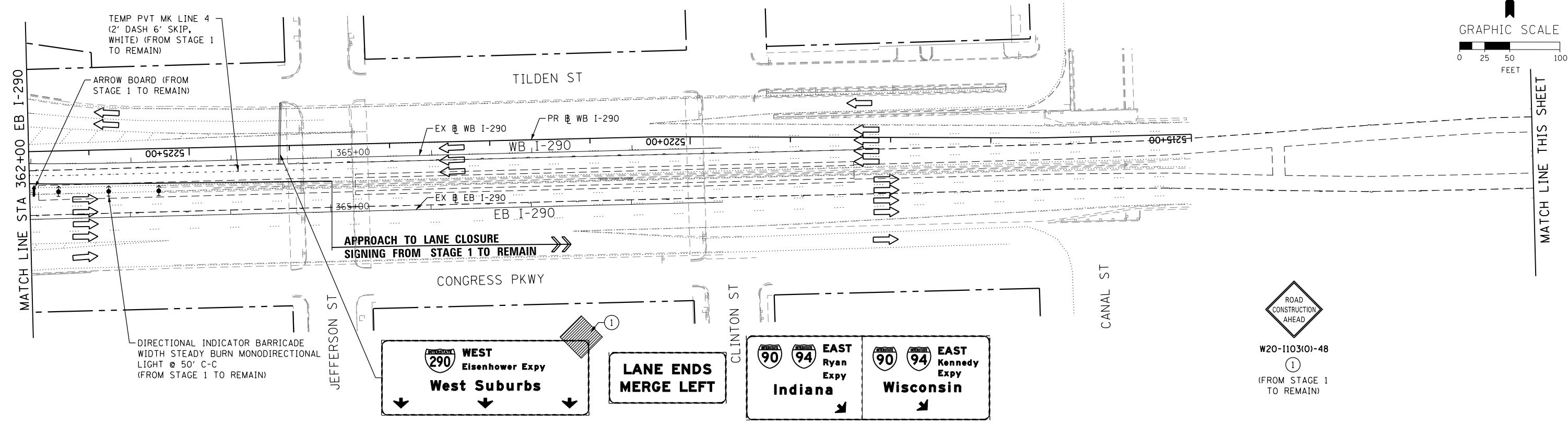
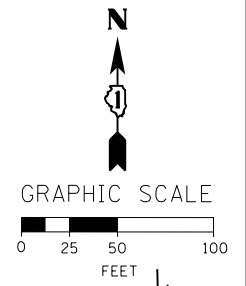

DI60W25-sht-Staging2-04  
USER NAME = potelp2  
PLOT SCALE = 50.0000' / in.  
PLOT DATE = 5/15/2013

DESIGNED - OPS	REVISED -
DRAWN - PHP	REVISED -
CHECKED - DBM	REVISED -
DATE - 5/14/2013	REVISED -

STATE OF ILLINOIS  
DEPARTMENT OF TRANSPORTATION

SUGGESTED STAGES OF CONSTRUCTION AND TRAFFIC CONTROL  
**STAGE 2**  
SCALE: 1" = 50' SHEET 4 OF 7 SHEETS STA. TO STA.

F.A.I. RTE.	SECTION	COUNTY	TOTAL SHEETS	SHEET NO.
90/94/290	2013-007R	COOK	317	66
CONTRACT NO. 60W25				
ILLINOIS FED. AID PROJECT				