

NOTE:
UNLESS NOTED OTHERWISE, ALL STATIONS AND OFFSETS USED
ARE TAKEN FROM EITHER EXISTING EB AND WB I-290 BASELINES

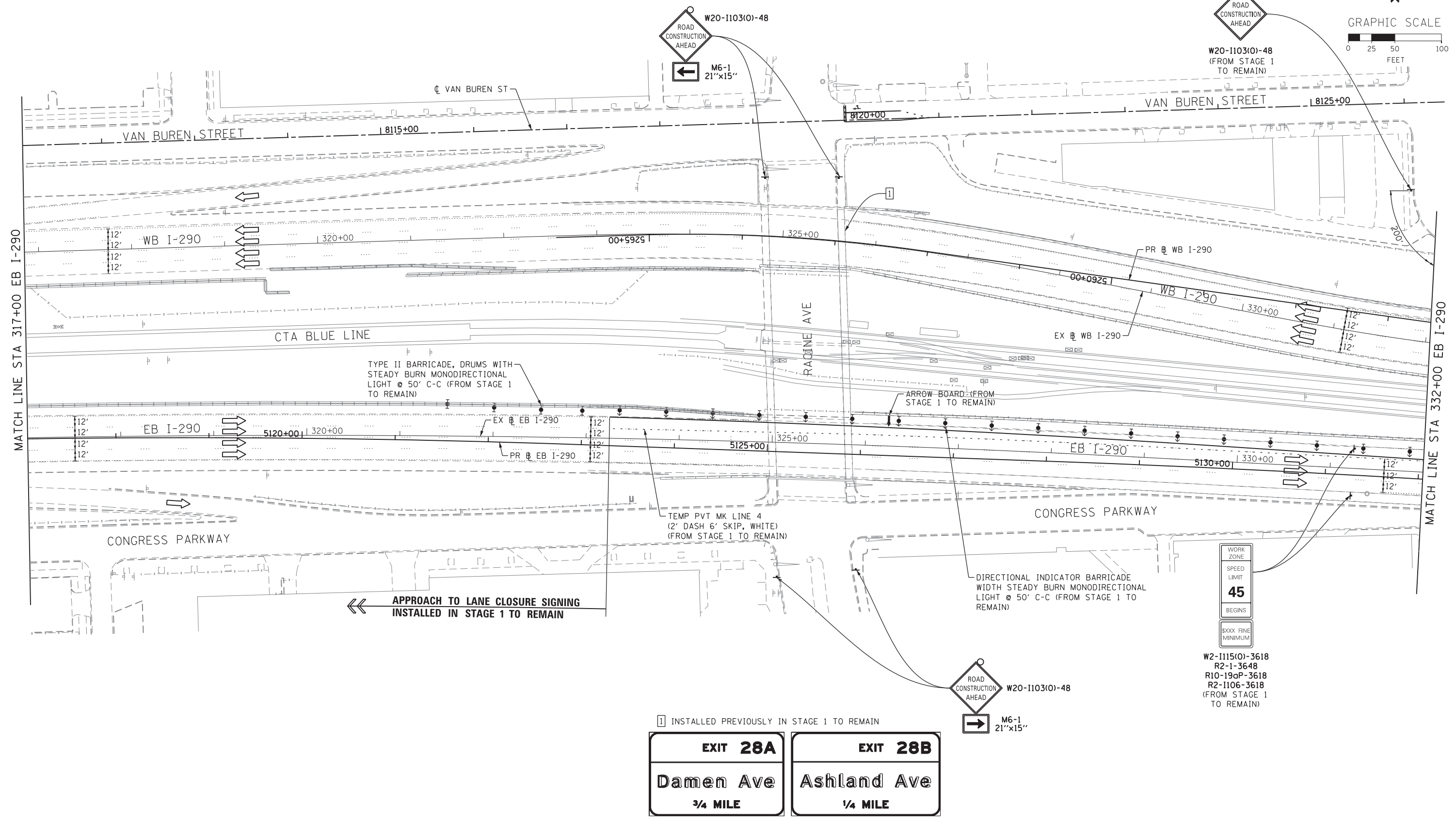
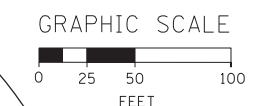

1 INSTALLED PREVIOUSLY IN STAGE 1 TO REMAIN

EXIT 28A	EXIT 28B
Damen Ave	Ashland Ave
3/4 MILE	1/4 MILE

WORK ZONE
SPEED LIMIT
45
BEGINS
XXXX FINE
MINIMUM

W2-1115(O)-3618
R2-1-3648
R10-190P-3618
R2-1106-3618
(FROM STAGE 1 TO REMAIN)

ROAD CONSTRUCTION AHEAD W20-1103(O)-48
M6-1 21"x15"

FILE PATH = ...\388039-par\1\escomon\line\local\PAEED\000\Documents\01_Americas\Transportation\60269938_Circle\Phase_1\1000_CAD\005_Roadway\Sheets\60W25-Sht-Staging3-01



D160W25-Sht-Staging3-01
USER NAME = potelp2
PLOT SCALE = 50.0000' / in.
PLOT DATE = 6/11/2013

DESIGNED - OPS	REVISED -
DRAWN - PHP	REVISED -
CHECKED - DBM	REVISED -
DATE - 6/17/2013	REVISED -

STATE OF ILLINOIS
DEPARTMENT OF TRANSPORTATION

SUGGESTED STAGES OF CONSTRUCTION AND TRAFFIC CONTROL

STAGE 3

SCALE: 1" = 50'	SHEET 1 OF 7 SHEETS	STA.	TO STA.
-----------------	---------------------	------	---------

F.A.I. RTE. 90/94/290	SECTION 2013-007R	COUNTY COOK	TOTAL SHEETS 317	SHEET NO. 70
CONTRACT NO. 60W25				ILLINOIS FED. AID PROJECT