

FILE PATH = p:\388035\pmt\escomon\me\local\AECOM\Documents\01_Americas\Transportation\60269938_Circle\Phase_1\000_CAD\016_Electrical\Sheets\60W25-Contract\DI60W25-sht-Light-02

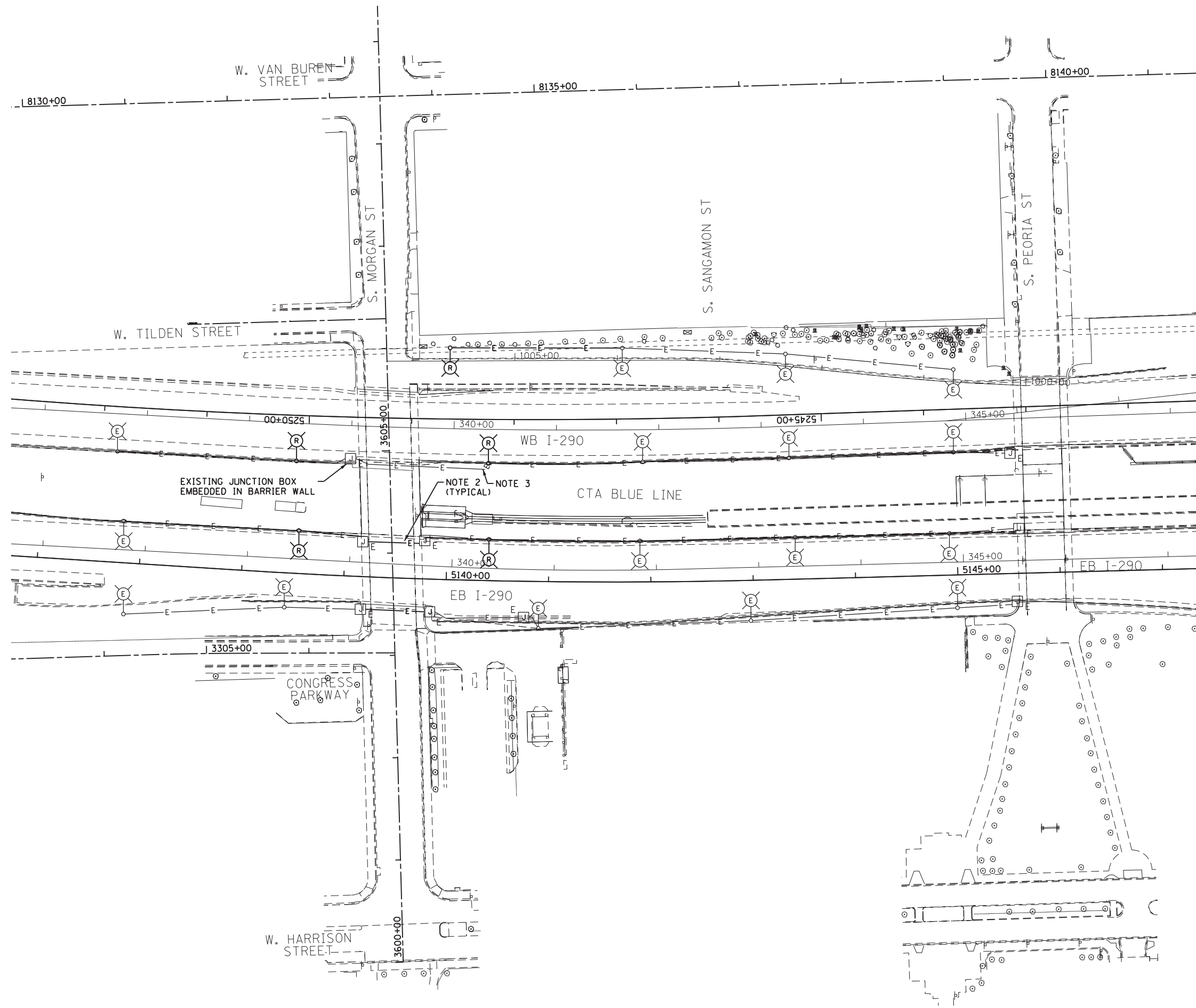

- NOTES:**
1. SEE DRAWING E-01 FOR IDOT ELECTRICAL SYMBOLS.
 2. THE EXISTING CONDUIT ATTACHED TO STRUCTURE FOR THE ROADWAY LIGHTING CIRCUITS CANNOT BE DISCONNECTED AND REMOVED UNTIL THE TEMPORARY FEED HAS BEEN INSTALLED. SEE DRAWING E-03 FOR THE TEMPORARY POWER PLANS.
 3. THE EXISTING ROADWAY LIGHTING CIRCUITS BETWEEN MEDIAN MOUNTED LIGHT POLES ON EITHER SIDE OF THE BRIDGE WILL BE DISRUPTED DURING THE MORGAN STREET BRIDGE CONSTRUCTION. PROVIDE A TEMPORARY LIGHTING FEED AS SHOWN ON DRAWING E-03.

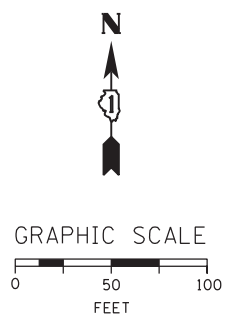

E-02



DI60W25-sht-Light-02
 USER NAME = myersc
 PLOT SCALE = 50.0000' / in.
 PLOT DATE = 6/10/2013

DESIGNED - WDS	REVISED -
DRAWN - CAM	REVISED -
CHECKED - JPC	REVISED -
DATE - 6/17/2013	REVISED -

**STATE OF ILLINOIS
 DEPARTMENT OF TRANSPORTATION**

**I-90 EXISTING/DEMOLITION
 LIGHTING PLAN**

SCALE: SHEET 2 OF 11 SHEETS STA. TO STA.

F.A.I. RTE.	SECTION	COUNTY	TOTAL SHEETS	SHEET NO.
90/94/290	2013-007R	COOK	317	123
CONTRACT NO. 60W25				
ILLINOIS FED. AID PROJECT				