

**NOTES:**

1. SEE DRAWING E-01 FOR IDOT ELECTRICAL SYMBOLS.
2. PROVIDE 3-1/C NO. 2 WITH 1/C NO. 4 GROUND XLP TYPE USE CABLES IN A 1 1/2" UNIT DUCT.
3. CONNECT THE AERIAL CABLES TO THE 3-1/C NO. 2 AND 1/C NO. 4 GROUND IN 3" DIAMETER PVCC RGS CONDUIT ROUTED ACROSS THE BRIDGE STRUCTURE FOR ROADWAY LIGHTING.
4. PROVIDE A TEMPORARY AERIAL CABLE FEED, 3-1/C NO. 2 WITH MESSENGER FROM JUNCTION BOX MOUNTED ON THE BRIDGE TO THE TEMPORARY LIGHTING UNIT AS SHOWN TO CONNECT THE ROADWAY LIGHTING CIRCUITS TO THE UNDERPASS LIGHTING SYSTEM.
5. SEE DRAWING NO. E-05 FOR THE MORGAN STREET UNDERPASS LIGHTING PLAN.
6. THIS DRAWING SHOWS THE FINAL CONDITION FOR THE TEMPORARY ROADWAY LIGHTING CONNECTIONS.

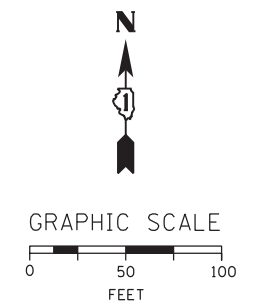
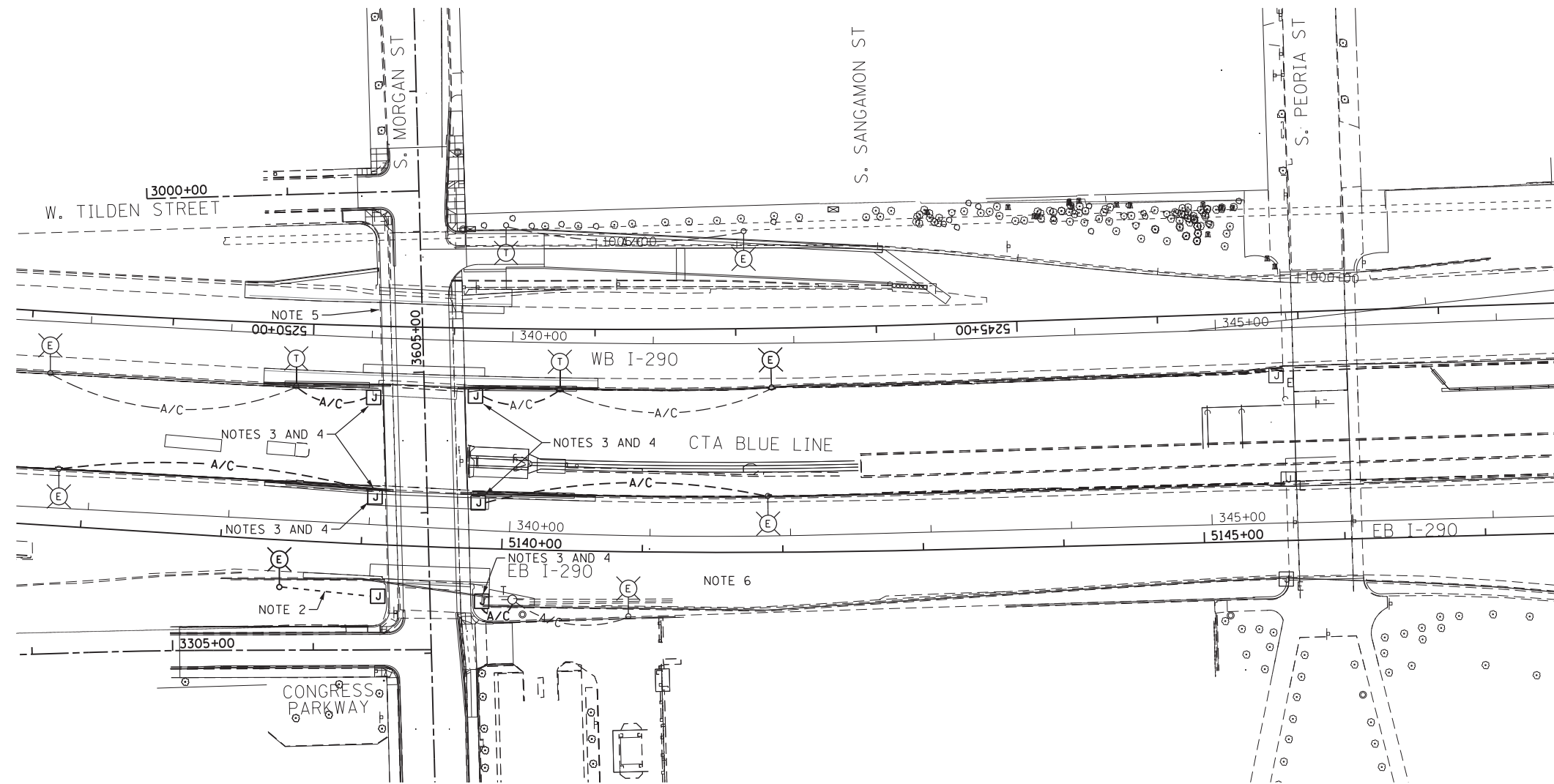

E-04

FILE PATH = ...\388035\pmt\escomon\me\local\PECD\00\Documents\01\_Americas\Transportation\60269938\_Circle\Phase\_1\1000\_CAD\016\_Electrical\Sheets\60W25\_Contract\0160W25-sht-Light-04



DI60W25-sht-Light-04  
 USER NAME = myersc  
 PLOT SCALE = 50.0000' / in.  
 PLOT DATE = 6/14/2013

DESIGNED - WDS	REVISED -
DRAWN - CAM	REVISED -
CHECKED - JPC	REVISED -
DATE - 6/17/2013	REVISED -

**STATE OF ILLINOIS  
 DEPARTMENT OF TRANSPORTATION**

**I-290 PROPOSED LIGHTING PLAN**

SCALE: SHEET 4 OF 11 SHEETS STA. TO STA.

F.A.I. RTE.	SECTION	COUNTY	TOTAL SHEETS	SHEET NO.
90/94/290	2013-007R	COOK	317	125
CONTRACT NO. 60W25				
ILLINOIS FED. AID PROJECT				