

c:\pwworking\aecom\00\myer.sc\d0207894\DIG0W25-shr-Light-07.dgn 8:39:00 AM 6/14/2013

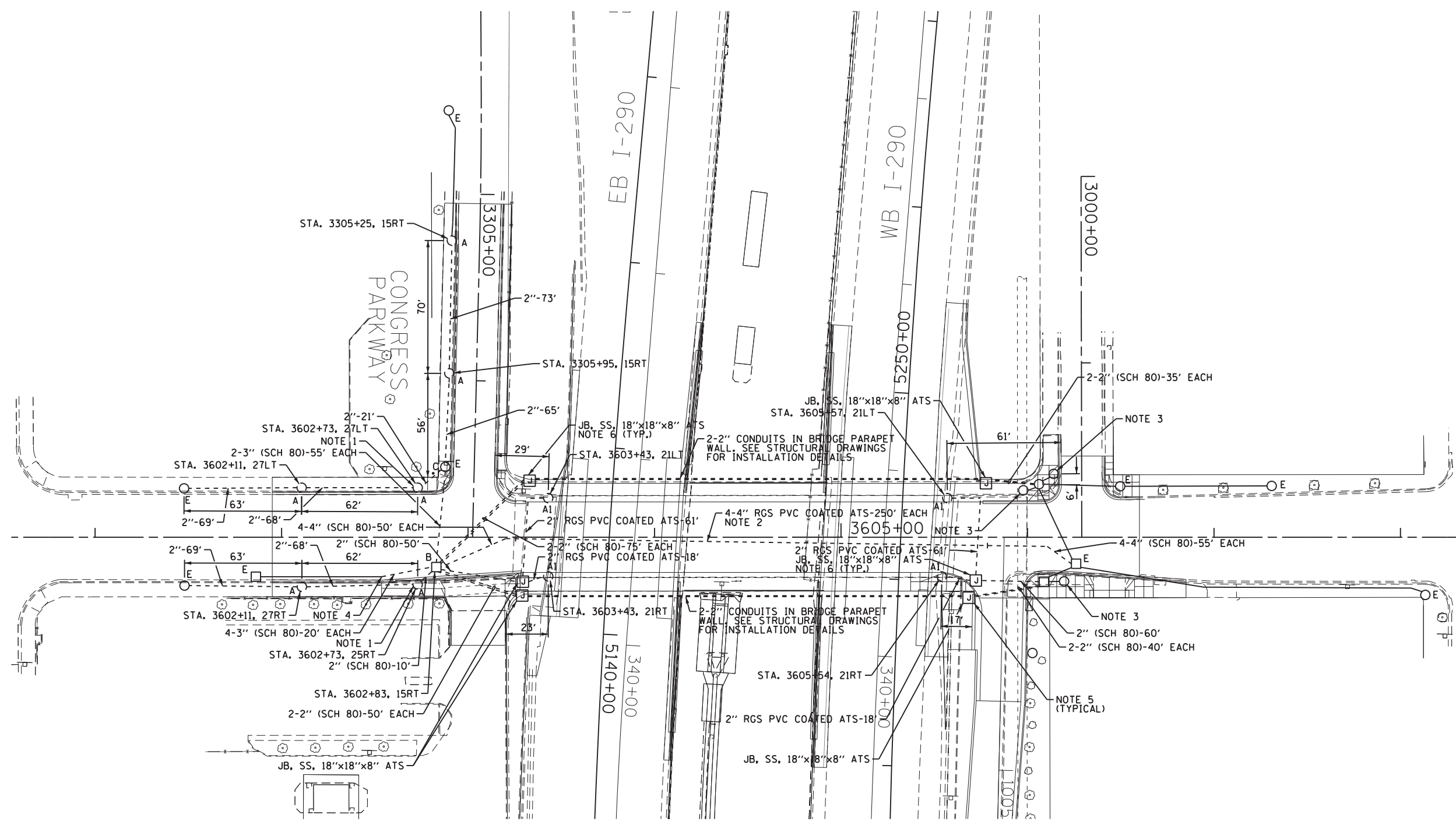

"A" PROVIDE 24"x7", 1-1/4" A.R., 15" B.C. FOUNDATION FOR RELOCATED LIGHT POLE, PER DWG. NOS. 818 AND 837.

"A1" LIGHT POLE FOUNDATION IS INTEGRAL TO THE BRIDGE STRUCTURE. SEE STRUCTURAL PLANS FOR DETAILS AND FINAL LOCATION OF FOUNDATION.

"B" PROVIDE 3'x4'x4" CONCRETE MANHOLE PER DWG. NO. 730 WITH 24" FRAME AND COVER.

"C" DRILL EXISTING MANHOLE/HANDHOLE.

"E" EXISTING TO REMAIN.

NOTES:

- INTERCEPT EXISTING LIGHTING CONDUIT TO EXISTING LIGHT POLE, CUT CONDUIT AND EXTEND END OF EXISTING CONDUIT TO NEW FOUNDATION.
- PROVIDE 4-4-INCH RIGID GALVANIZED STEEL PVC COATED CONDUITS ATTACHED TO STRUCTURE. THE CONDUITS SHALL BE MOUNTED UNDER THE BRIDGE DECK WITH THE ELECTRIC UTILITY (COMED) CONDUITS. SEE STRUCTURAL DRAWINGS.
- SEE THE TRAFFIC SIGNAL PLANS FOR LOCATION OF COMBINATION TRAFFIC SIGNAL/LIGHT POLE FOUNDATION.
- INTERCEPT EXISTING CONDUITS AND CONNECT TO NEW CONDUITS ROUTED TO PROPOSED MANHOLE.
- SEE DRAWING NO. E-10 FOR EMBEDDED CONDUIT EXITING PARAPET WALL DETAILS.
- COORDINATE THE LOCATION OF THE JUNCTION BOXES AND CONDUITS ROUTED THROUGH THE ABUTMENT WITH THE LOCATION OF THE CONDUIT SLEEVES OPENINGS SHOWN ON THE STRUCTURAL PLANS.

FOR LIGHTING CABLE AND EQUIPMENT INSTALLATION PLANS SEE DRAWING NO. E-08.

FOR LIGHTING REMOVAL PLANS SEE DRAWING NO. E-09.

CITY OF CHICAGO	
DEPARTMENT OF TRANSPORTATION DIVISION OF ENGINEERING	
CONSULTANT: AECOM <small>303 EAST WACKER DRIVE, SUITE 1400 CHICAGO, IL 60601-5276 PHONE: (312) 373-7700 FAX: (312) 373-6800</small>	
WORK ORDER NO. _____	DATE _____
COST ALLOCATION ACCOUNT _____	
APPROPRIATION ACCOUNT _____	MATERIAL _____ LABOR _____
MORGAN STREET LIGHTING CONDUIT AND FOUNDATION PLAN	
CITY OF CHICAGO DEPT. OF TRANSPORTATION DIVISION OF ELECTRICAL OPERATIONS	
DRAFTSMAN: CAM	ENGINEER: WDS
SUPERVISING ENGINEER: JPC	ELEC. DESIGN ENGR.
ENGINEER OF ELECTRICITY:	
GEN'L SUPT. OF ELECTRICITY:	
DEPUTY COMMISSIONER:	
SIZE: 22" 34"	SCALE: 1" = 30'
DATE: 6/17/2013	DWG. NO.:
C.D.O.T. PROJECT NO.:	

E-07