

TOTAL BILL OF MATERIAL

| CODE NUMBERS | ITEM | UNIT | SUPER. | SUB. | TOTAL QUANTITY |
|--------------|---|--------|---------|---------|----------------|
| 20700220 | Porous Granular Embankment | CU YD | - | 2,508 | 2,508 |
| 50100300 | Removal of Existing Structures No. 1 | EACH | 1 | - | 1 |
| 50157300 | Protective Shield | SQ YD | 1,895 | - | 1,895 |
| 50200100 | Structure Excavation | CU YD | - | 157 | 157 |
| 50300225 | Concrete Structures | CU YD | - | 848.6 | 848.6 |
| 50300255 | Concrete Superstructure | CU YD | 766.2 | - | 766.2 |
| 50300260 | Bridge Deck Grooving | SQ YD | 1,287 | - | 1,287 |
| 50300285 | Form Liner Textured Surface | SQ FT | - | 4,168 | 4,168 |
| 50300300 | Protective Coat | SQ YD | 2,237 | - | 2,237 |
| 50500105 | Furnishing and Erecting Structural Steel | L. SUM | 1 | - | 1 |
| 50500505 | Stud Shear Connectors | EACH | 10,044 | - | 10,044 |
| 50800205 | Reinforcement Bars, Epoxy Coated | POUND | 166,780 | 494,450 | 661,230 |
| 50800515 | Bar Splicers | EACH | 824 | 222 | 1,046 |
| 51500100 | Name Plates | EACH | 1 | - | 1 |
| 51602000 | Permanent Casing | FOOT | - | 5,113 | 5,113 |
| 51603000 | Drilled Shaft in Soil, 24" | CU YD | - | 112 | 112 |
| 51603000 | Drilled Shaft in Soil, 30" | CU YD | - | 132 | 132 |
| 51603000 | Drilled Shaft in Soil, 42" | CU YD | - | 1,226 | 1,226 |
| 51604000 | Drilled Shaft in Rock, 24" | CU YD | - | 4 | 4 |
| 51604000 | Drilled Shaft in Rock, 36" | CU YD | - | 38 | 38 |
| 52000110 | Preformed Joint Strip Seal | FOOT | 124 | - | 124 |
| 52100010 | Elastomeric Bearing Assembly, Type I | EACH | 24 | - | 24 |
| 52100020 | Elastomeric Bearing Assembly, Type II | EACH | 12 | - | 12 |
| 52100520 | Anchor Bolts, 1" | EACH | 96 | - | 96 |
| 58700300 | Concrete Sealer | SQ FT | - | 9,023 | 9,023 |
| 59100100 | Geocomposite Wall Drain | SQ YD | - | 391 | 391 |
| 81200230 | Conduit Embedded in Structure, 2" Dia., PVC | FOOT | 956 | - | 956 |
| X0322400 | Pile Extraction | EACH | - | 26 | 26 |
| X0326486 | Decorative Railing Parapet Mounted | FOOT | 644 | - | 644 |
| X2020502 | Braced Excavation | CU YD | - | 4,770 | 4,770 |
| X4240800 | Detectable Warnings (Special) | SQ FT | 18 | - | 18 |
| X5091730 | Bridge Fence Railing (Special) | FOOT | 180 | - | 180 |
| Z0046306 | Pipe Underdrains For Structures 6" | FOOT | - | 203 | 203 |
| Z0073002 | Temporary Soil Retention System | SQ FT | - | 1,332 | 1,332 |

INDEX OF SHEETS

- S1-01 General Plan and Elevation
- S1-02 Index of Sheets, PGLs and Total Bill of Material
- S1-03 General Notes and Miscellaneous Details
- S1-04 Stage Construction
- S1-05 Substructure Layout
- S1-06 Existing Structure Removal Plan and Elevation
- S1-07 Existing Structure Removal Details 1 of 2
- S1-08 Existing Structure Removal Details 2 of 2
- S1-09 Temporary Concrete Barrier
- S1-10 Top of Slab Elevation Locations
- S1-11 Top of Slab Elevations (Sheet 1 of 3)
- S1-12 Top of Slab Elevations (Sheet 2 of 3)
- S1-13 Top of Slab Elevations (Sheet 3 of 3)
- S1-14 Top of South Approach Slab Elevations
- S1-15 Top of North Approach Slab Elevations
- S1-16 Deck Plan and Cross Section
- S1-17 Parapet Elevations and Details
- S1-18 Deck Cross Sections, Details and Bill of Material
- S1-19 Preformed Joint Strip Seal
- S1-20 Decorative Railing Parapet Mounted Details
- S1-21 Bridge Fence Railing (Special)
- S1-22 Framing Plan and Beam Elevation
- S1-23 Girder Moment and Reaction Tables
- S1-24 Structural Steel Details
- S1-25 Elastomeric Bearing Type I and Fixed Bearing
- S1-26 Elastomeric Bearing Type II
- S1-27 South Abutment Plan and Elevation
- S1-28 South Abutment Footing Plan and Sections
- S1-29 South Abutment Sections and Details
- S1-30 South Abutment Wingwalls
- S1-31 South Abutment Architectural Details
- S1-32 North Abutment Plan and Elevation
- S1-33 North Abutment Footing Plan and Sections
- S1-34 North Abutment Sections and Details
- S1-35 North Abutment Wingwalls
- S1-36 North Abutment Architectural Details
- S1-37 Pier 1 Plan and Elevation
- S1-38 Pier 1 Sections and Details
- S1-39 Pier 1 Architectural Details
- S1-40 Pier 2 Plan and Elevation
- S1-41 Pier 2 Sections and Details
- S1-42 Pier 2 Architectural Details
- S1-43 Bar Splicer Assembly and Mechanical Splicer Details
- S1-44 Boring Logs I
- S1-45 Boring Logs II
- S1-46 Boring Logs III
- S1-47 South Approach Slab Plan
- S1-48 South Approach Slab Sections and Details
- S1-49 North Approach Slab Plan
- S1-50 North Approach Slab Sections and Details
- S1-51 South and North Approach Pile Bent Support

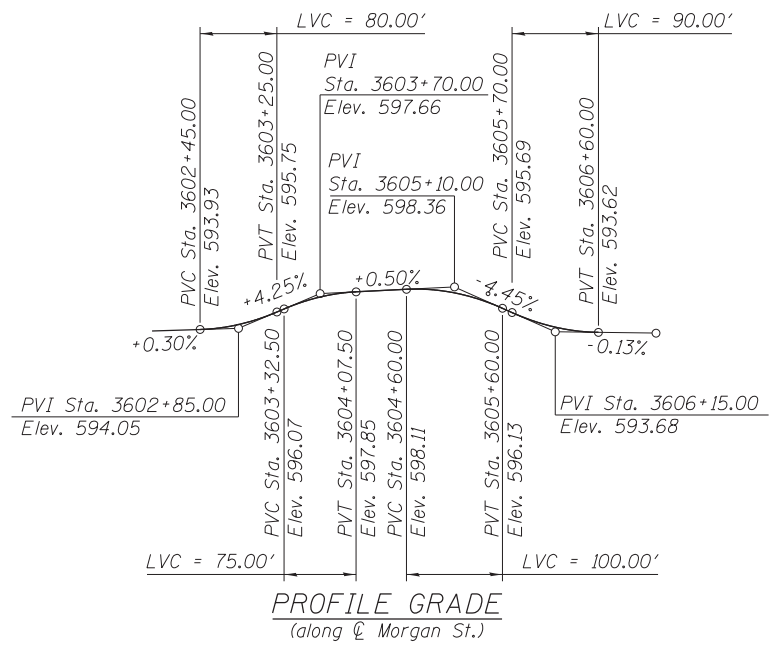

For information only
Part of future contract

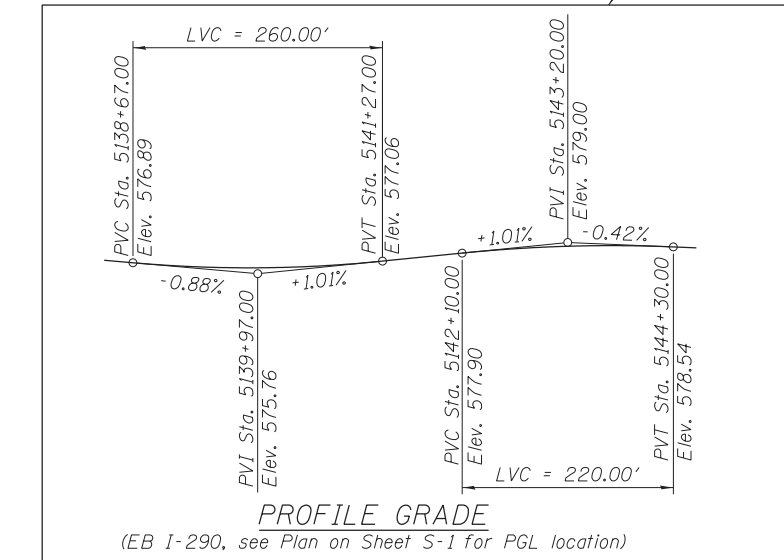

"P-IKE-EB-3"
CURVE DATA
(F.A.I. Rte. I-290 EB)
P.I. Sta. = 5140+57.13
 $\Delta = 5^\circ 07' 22''$ (LT)
D = 1° 00' 19"
R = 5,700.00'
T = 254.99'
L = 509.63'
E = 5.70'
e = RC (2.00%)
T.R. = 96'
S.E. Run = 96'
P.C. Sta. = 5138+02.14
P.T. Sta. = 5143+11.78

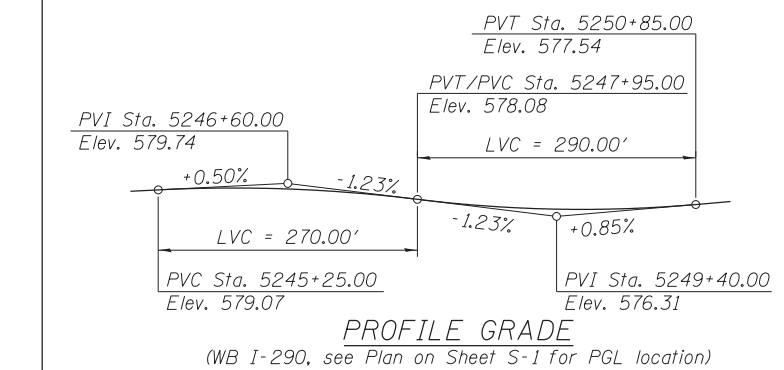

"P-IKE-WB-3"
CURVE DATA
(F.A.I. Rte. I-290 WB)
P.I. Sta. = 5251+25.31
 $\Delta = 9^\circ 58' 24''$ (RT)
D = 0° 53' 03"
R = 6,480.00'
T = 565.40'
L = 1,127.95'
E = 24.62'
e = RC (2.00%)
T.R. = 72'
S.E. Run = 72'
P.C. Sta. = 5245+59.91
P.T. Sta. = 5256+87.86

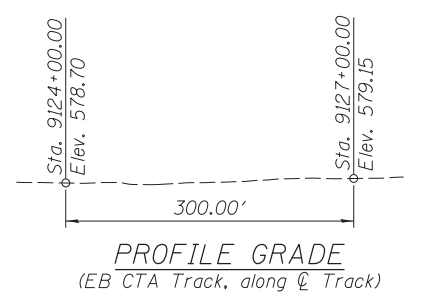
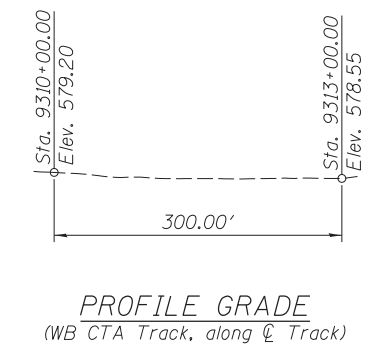
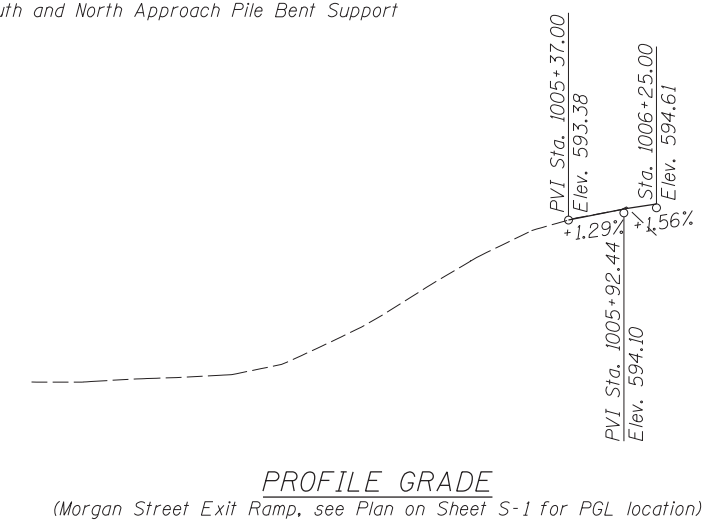

For information only
Part of future contract

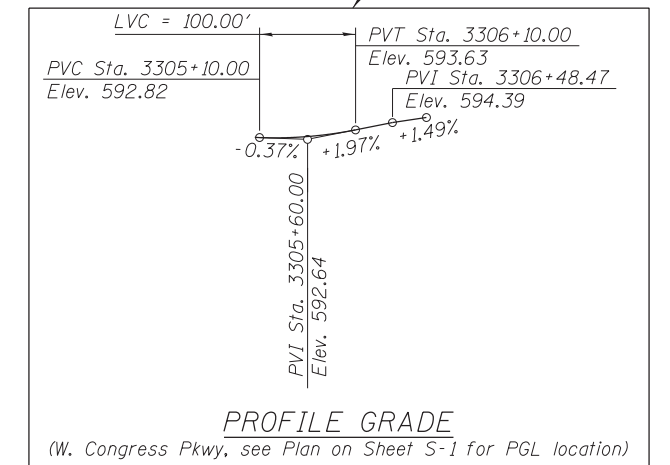

FILE PATH = C:\Users\willmar.douss\Desktop\Wmorgn\0161709-60W25-S02-IndexBDM.dgn

HBM
ENGINEERING GROUP, LLC.
CONSULTING & DESIGN
INSPECTION & RATING
RESEARCH & TESTING

4415 WEST HARRISON ST.
SUITE 231
HILLSIDE, IL 60162
PHONE: (708) 236-0900
FAX: (708) 236-0901

| | | |
|--------------------------------|------------------------|-----------|
| 0161709-60W25-S02-IndexBDM.dgn | DESIGNED - MI, JJS | REVISED - |
| USER NAME = willmar.douss | DRAWN - JJS, LAB | REVISED - |
| PLOT SCALE = 0:1.0000 '1' / 1" | CHECKED - MAI, MI, LAB | REVISED - |
| PLOT DATE = 6/14/2013 | DATE - 6/17/2013 | REVISED - |

STATE OF ILLINOIS
DEPARTMENT OF TRANSPORTATION

INDEX OF SHEETS, PGLS AND TOTAL BILL OF MATERIAL
STRUCTURE NO. 016-1709

SCALE: SHEET S1-02 OF 51 SHEETS STA. TO STA.

| | | | | |
|-----------------------|-------------------|-------------|---------------------------|---------------|
| F.A.I. RTE. 90/94/290 | SECTION 2013-007R | COUNTY COOK | TOTAL SHEETS 317 | SHEET NO. 146 |
| CONTRACT NO. 60W25 | | | ILLINOIS FED. AID PROJECT | |