

NOTES:

1. See sheet S1-50 for Sections C-C and D-D.
2. a120(E), a121(E), a122(E) and a123(E) bar spacings measured along \hat{C} Rdwy.
3. The joint opening shall be determined per Article 520.04 except that on jointless structures, the distance described as the bridge length between the nearest fixed bearings each way from the joint shall be taken as half the bridge length plus the approach slab length. The minimum dimension shall be 1/2" for installation purposes.
4. Provide 1/2" P.J.F. along the entire length of the North, East and West edges of the Approach Slab. See Detail A.

*** Cost included with Concrete Superstructure.

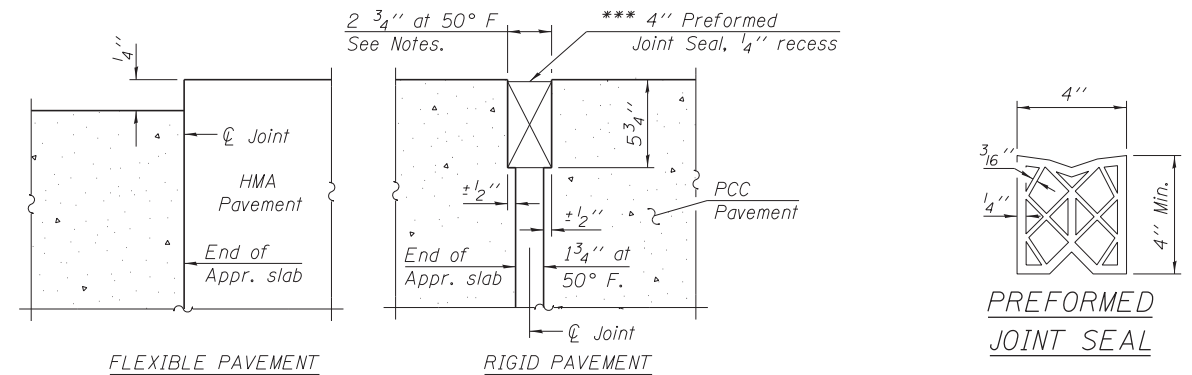

DETAIL A

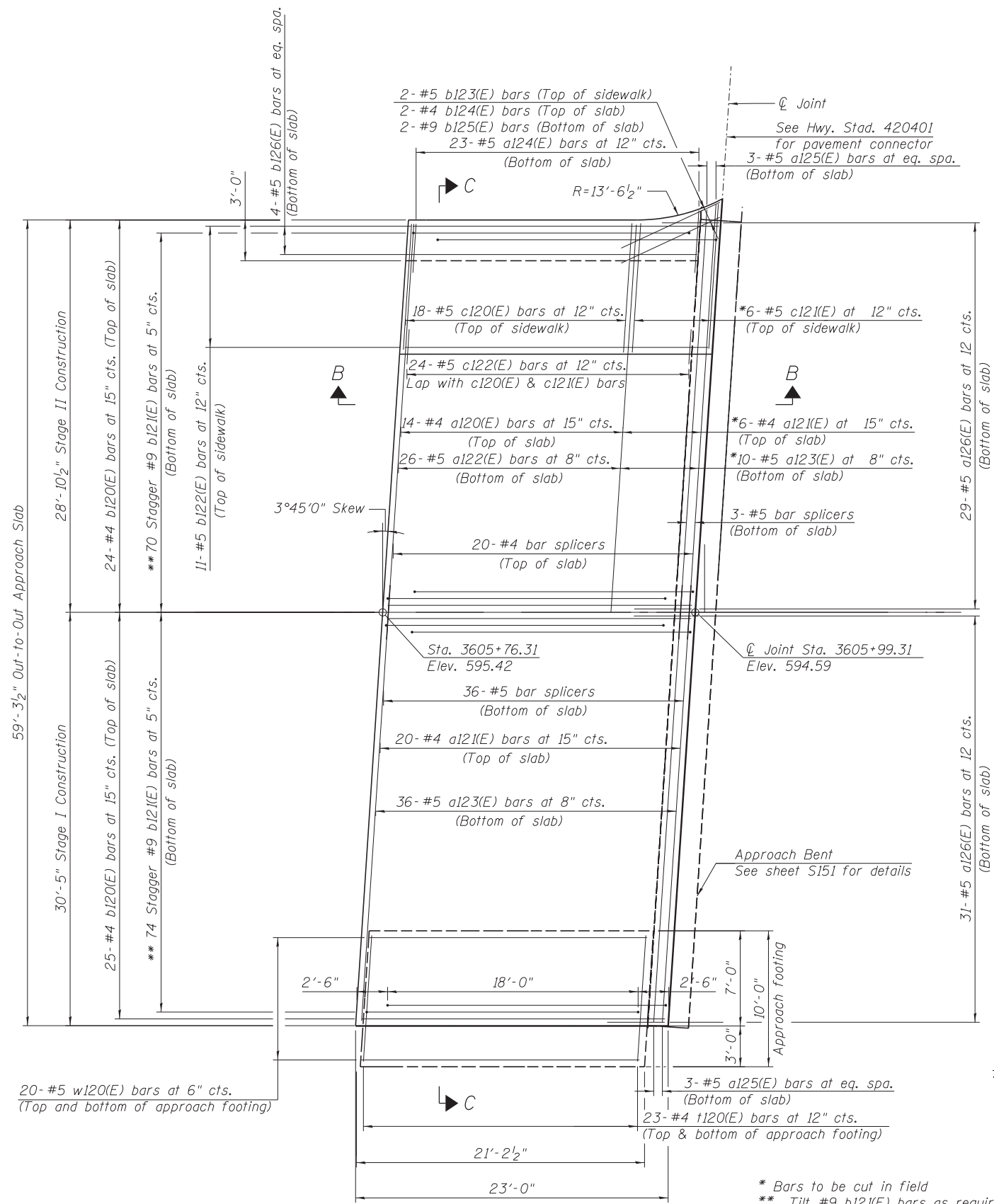

PLAN

* Bars to be cut in field
 ** Tilt #9 b121(E) bars as required to maintain clearance.

FILE PATH = C:\Users\will.moradous\Desktop\Mapgen\0161709-60W25-549-Nor-thAppr-Slab1.dgn

HBM
 ENGINEERING GROUP, LLC
 CONSULTING & DESIGN
 INSPECTION & RATING
 RESEARCH & TESTING

4415 WEST HARRISON ST.
 SUITE 231
 HILLSIDE, IL 60162
 PHONE: (708) 236-0900
 FAX: (708) 236-0901

0161709-60W25-549-Nor-thAppr-Slab1.dgn	DESIGNED - MI, PH, MWM	REVISED -
USER NAME = will.moradous	DRAWN - PH	REVISED -
PLOT SCALE = 5:8.0000 ' : 1"	CHECKED - MAI, MI, MWM	REVISED -
PLOT DATE = 6/14/2013	DATE - 6/17/2013	REVISED -

**STATE OF ILLINOIS
 DEPARTMENT OF TRANSPORTATION**

**NORTH APPROACH SLAB PLAN
 STRUCTURE NO. 016-1709**

SCALE: SHEET S1-49 OF 51 SHEETS STA. TO STA.

F.A.I. RTE.	SECTION	COUNTY	TOTAL SHEETS	SHEET NO.
90/94/290	2013-007R	COOK	317	193
CONTRACT NO. 60W25			ILLINOIS FED. AID PROJECT	