

CROSS SECTIONS, STATIONING AND OFFSETS SHOWN
REFERENCE THE PROPOSED WB I-290 BASELINE

DATE	
BY	
FINISHED SURVEY	
PLOTTED	
TEMPLATE	
NOTE BOOK	
AREAS CHECKED	
NO.	

DATE	
BY	
ORIGINAL SURVEY	
PLOTTED	
TEMPLATE	
NOTE BOOK	
AREAS CHECKED	
NO.	

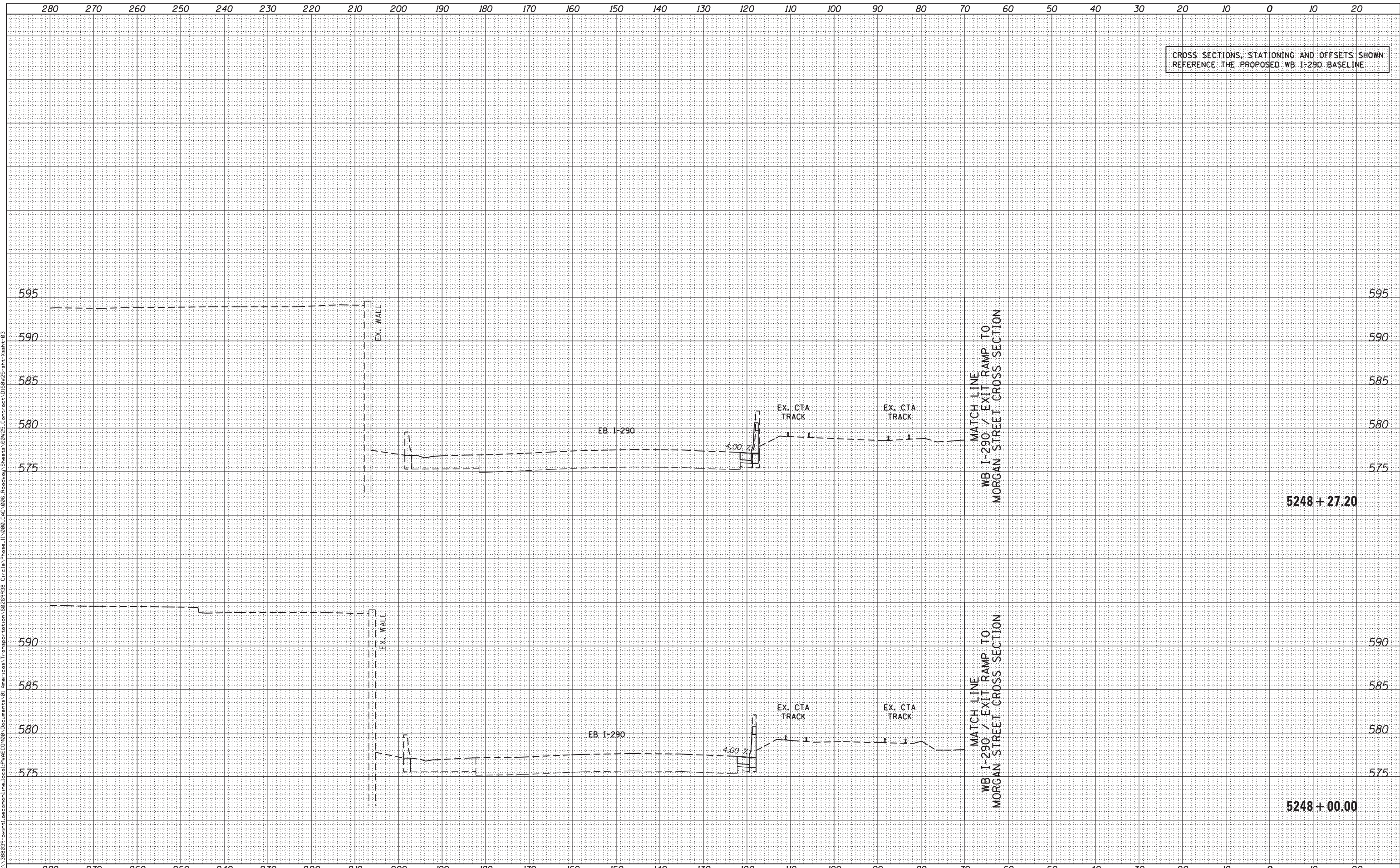

FILE PATH = p:\388039\print\atcomon\line\local\PM\AEC\000\Documents\01\Americas\Transportation\60269938_Circle\Phase_1\000_CAD\006_Roadway\Sheets\60W25_Contract\0160W25-sht-Xsht-03



D160W25-sht-Xsht-03	DESIGNED - AFC / KAM	REVISED -
USER NAME = pimsarno	DRAWN - AFC / KAM	REVISED -
PLOT SCALE = 10.0000' / in.	CHECKED - DBM	REVISED -
PLOT DATE = 6/14/2013	DATE - 6/17/2013	REVISED -

STATE OF ILLINOIS
DEPARTMENT OF TRANSPORTATION

EB I-290 / CONGRESS PARKWAY CROSS SECTION

SCALE: 1:5V, 1:10H SHEET 24 OF 33 SHEETS STA. 5248+00.00 TO STA. 5248+27.20

F.A.I. RTE.	SECTION	COUNTY	TOTAL SHEETS	SHEET NO.
90/94/290	2013-007R	COOK	317	296
CONTRACT NO. 60W25				
ILLINOIS FED. AID PROJECT				