

CROSS SECTIONS, STATIONING AND OFFSETS SHOWN  
 REFERENCE THE PROPOSED WB I-290 BASELINE

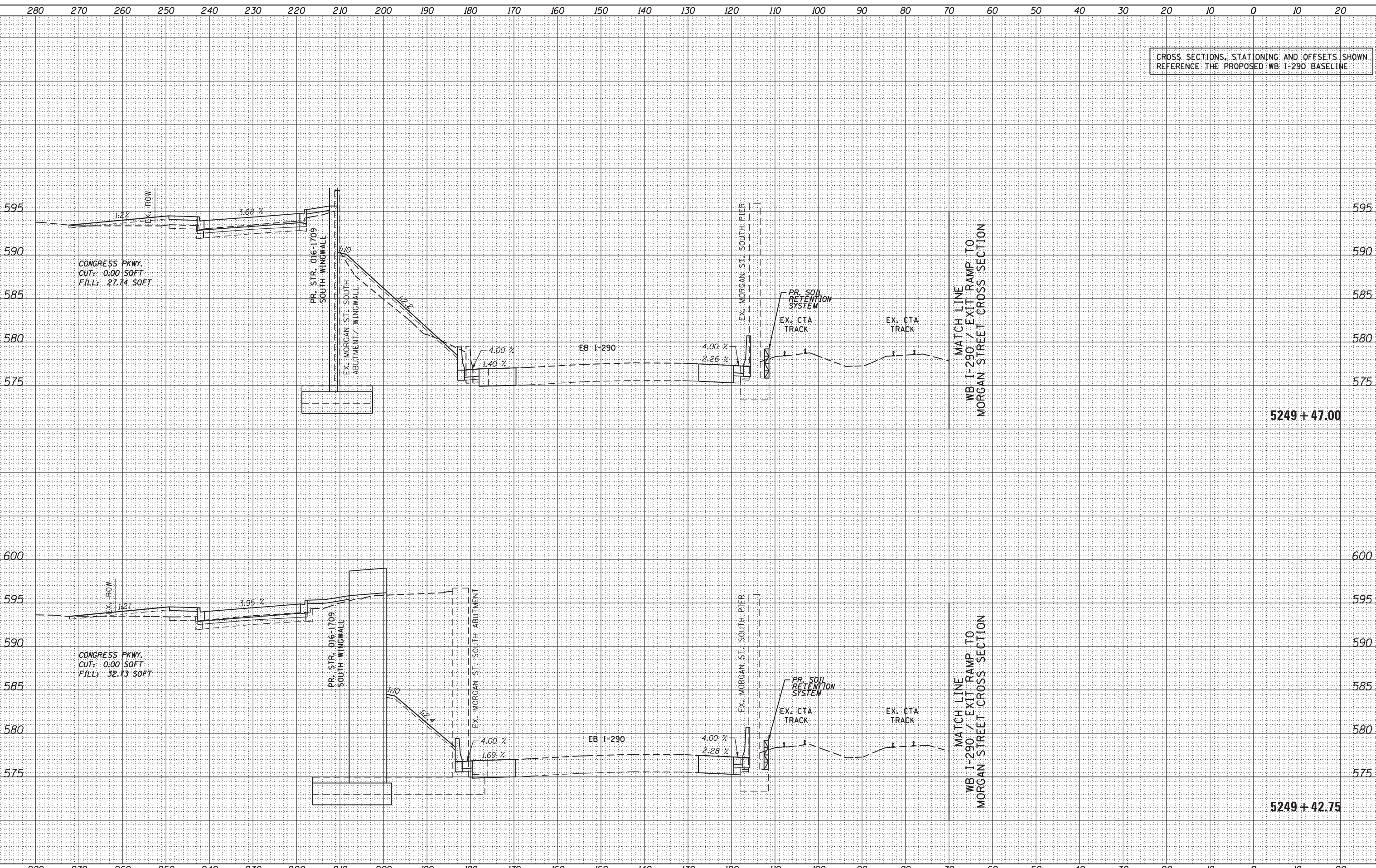

DATE	BY
ORIGINAL SURVEY	SURVEYED
NOTE BOOK	PLOTTED
	TEMPLATE
	AREAS CHECKED

DATE	BY
ORIGINAL SURVEY	SURVEYED
NOTE BOOK	PLOTTED
	TEMPLATE
	AREAS CHECKED

FILE PATH = p:\398033\pmt\lcomon\lme\local\pwe\CD\00\Documents\01\America\Transportation\62629938\_Circle\Phase1\000\_CDD\006\_Roadway\Sheets\60W25-shr-Xsht-03



D160W25-shr-Xsht-03		DESIGNED - AFC / KAM	REVISED -
USER NAME = pimsarno		DRAWN - AFC / KAM	REVISED -
PLOT SCALE = 10.0000' / in.		CHECKED - DBM	REVISED -
PLOT DATE = 6/14/2013		DATE - 6/17/2013	REVISED -

**STATE OF ILLINOIS  
 DEPARTMENT OF TRANSPORTATION**

**EB I-290 / CONGRESS PARKWAY CROSS SECTION**

SCALE: 1:5V, 1:10H SHEET 28 OF 33 SHEETS STA. 5249+42.75 TO STA. 5249+47.00

F.A.I. RTE. 90/94/290	SECTION 2013-007R	COUNTY COOK	TOTAL SHEETS 317	SHEET NO. 300
CONTRACT NO. 60W25				ILLINOIS FED. AID PROJECT