

Wrong Way Traffic Control for Half Diamond Interchange Exit Ramp

SIGNS MUST BE FIELD VERIFIED
AND ADJUSTED AS NEEDED BY
THE ENGINEER TO PROVIDE CLEAR
VISIBILITY OF THE SIGNS

(OPTIONAL) ADDITIONAL PAIRS
OF 'WRONG WAY' SIGNS MAY
BE INSTALLED INCLUDING NEAR
THE BEGINNING OF THE RAMP

SIGN CAN BE
PLACED IN MEDIAN
IF PRESENT



TRAILBLAZING SIGNS SHALL BE
PROVIDED TO DIRECT DRIVERS TO
THE CLOSEST ENTRANCE FOR
RAMP MOVEMENTS NOT PROVIDED
AT THIS INTERCHANGE

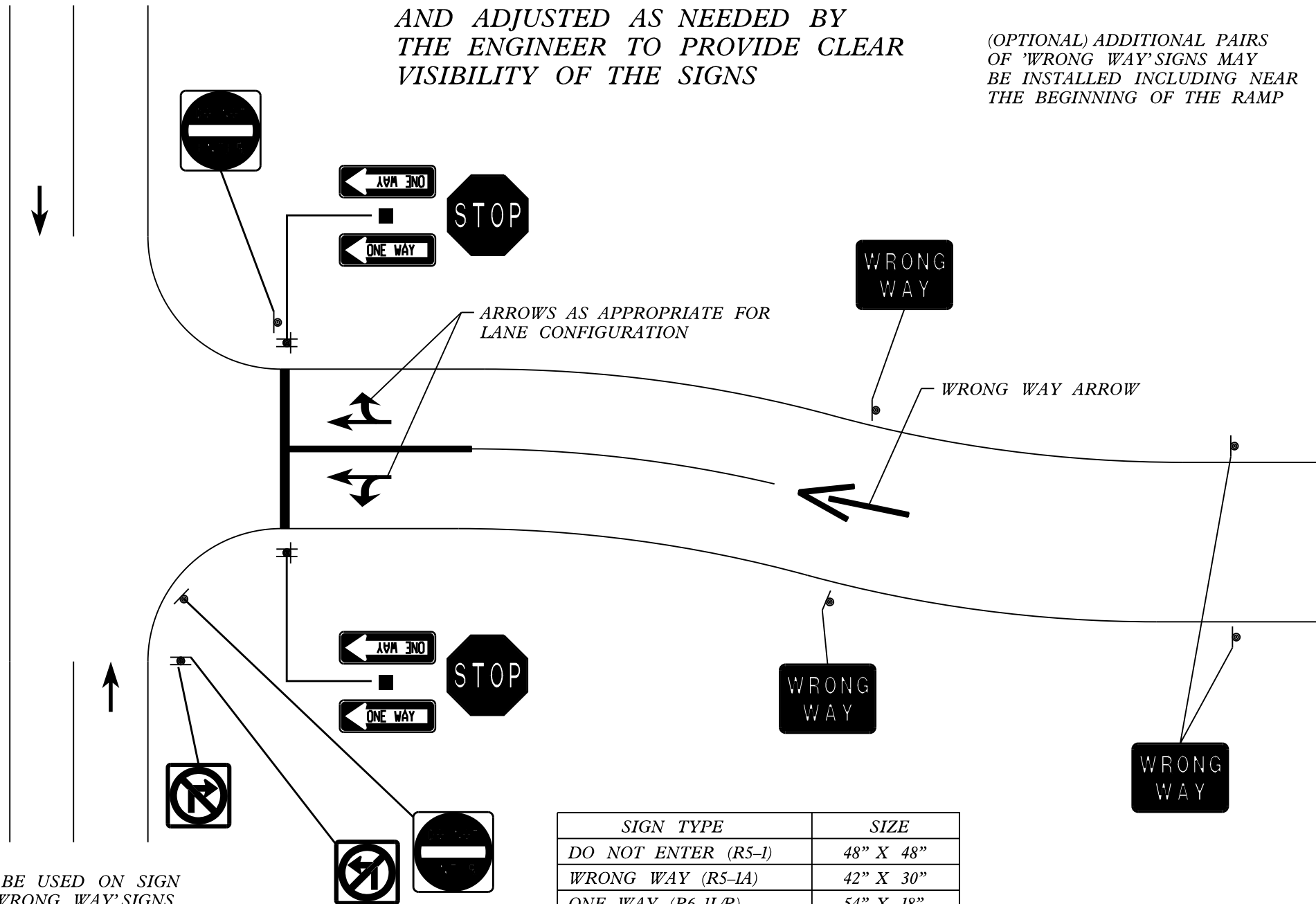

NOTES:
RETROREFLECTIVE SIGN PANEL SHALL BE USED ON SIGN
SUPPORTS FOR 'DO NOT ENTER' AND 'WRONG WAY' SIGNS