

STATE OF ILLINOIS
DEPARTMENT OF TRANSPORTATION
DIVISION OF HIGHWAYS

**PLANS FOR PROPOSED
FEDERAL AID HIGHWAY
FAU ROUTE 2509 (SLEEPY HOLLOW ROAD)**

FOR INDEX SHEETS, SEE SHEET NO. 2

FOR INDEX OF HIGHWAY STANDARDS, SEE SHEET NO. 2

PROJECT LOCATED IN THE VILLAGE OF SLEEPY HOLLOW

DESIGN DESIGNATION: BICYCLE PATH

DESIGN SPEED: 15 M.P.H.

TOWNSHIP SANCTUARY TO VILLAGE HALL

BICYCLE PATH

SECTION: NO. 10-00007-00-BT

PROJECT NO.: CMM-9003 (581)

JOB NO: C-91-358-10

**VILLAGE OF SLEEPY HOLLOW
KANE COUNTY**

FAU ROUTE	SECTION	COUNTY	TOTAL SHEETS	SHEET NO.
2509	10-00007-00-BT	KANE	23	1
STA: NA			TO STA: NA	
FED. ROAD DIST. NO.	ILLINOIS		FED. AID. PROJECT	

CONTRACT NO. 63839



PROGRAM AND OFFICE ENGINEER: CHARLES F. RIDDLE, P.E. 847-705-4406 SCHAUMBURG, IL

COPYRIGHT © 2010, BY GERALD L. HEINZ & ASSOCIATES, INC.

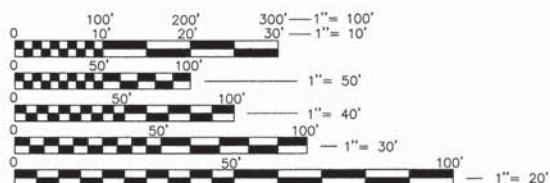

FULL SIZE PLANS HAVE BEEN PREPARED USING STANDARD ENGINEERING SCALES. REDUCED SIZED PLANS WILL NOT CONFORM TO STANDARD SCALES. IN MAKING MEASUREMENTS ON REDUCED PLANS, THE ABOVE SCALES MAY BE USED.

FAU 2509, BICYCLE PATH
PROJECT END
STA: 37+10

FAU 2509, BICYCLE PATH
PROJECT. OMISSION
STA: 22+26 TO 22+47

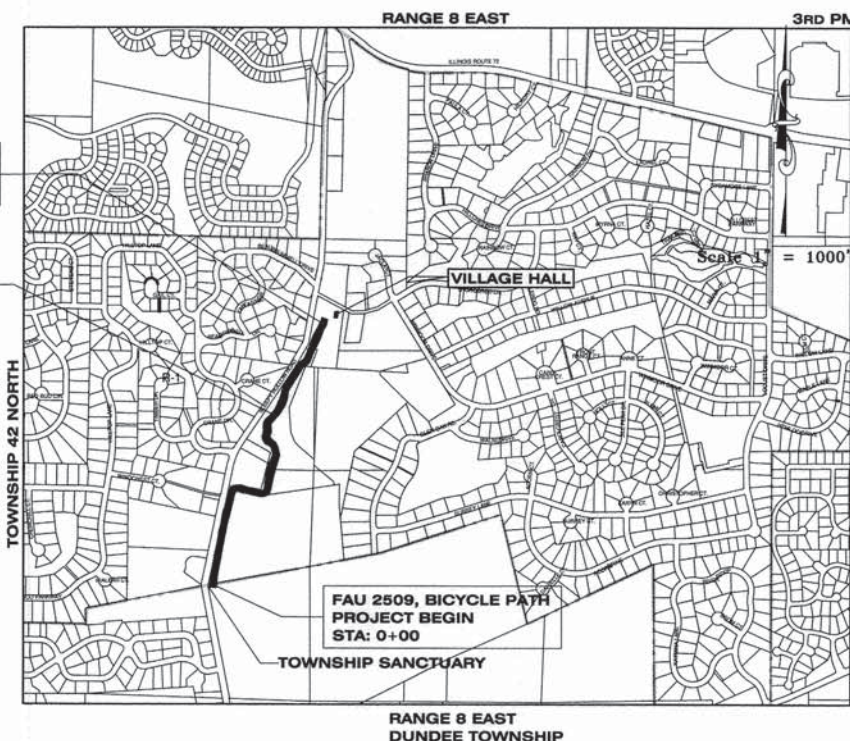

GROSS LENGTH OF IMPROVEMENT - 3710 FEET(0.7026 MILES)
NET LENGTH OF IMPROVEMENT - 3,689 FEET(0.6987 MILES)

GERALD L. HEINZ & ASSOCIATES, INC.

206 NORTH RIVER STREET
EAST DUNDEE, ILLINOIS
PHONE: (847) 426-4535

STATE OF ILLINOIS - PROFESSIONAL DESIGN FIRM
LICENSE NO. 184-002048 (EXPIRE 4-30-2015)



JEFFREY C. STEELE, P.E.
ILLINOIS REGISTERED PROFESSIONAL ENGINEER
NO. 60934 (LICENSE EXPIRES 11-30-13)

STATE OF ILLINOIS
DEPARTMENT OF TRANSPORTATION
DIVISION OF HIGHWAYS

APPROVED May 13th 20 13
Blair Scudlark
VILLAGE OF SLEEPY HOLLOW DIRECTOR OF PUBLIC WORKS

PASSED May 23 20 13
C. J. Hart
DISTRICT 1 ENGINEER OF LOCAL ROADS & STREETS

RELEASING FOR BID
BASED ON LIMITED
REVIEW May 23 20 13
John Robinson
DEPUTY DIRECTOR OF HIGHWAYS, REGION 1 ENGINEER

CONTRACT NO. 63839

J.U.L.I.E.
FOR UNDERGROUND UTILITY LOCATION
CALL J.U.L.I.E., TOLL FREE
PHONE NO.: 811

PRINTED BY THE AUTHORITY
OF THE STATE OF ILLINOIS

GENERAL NOTES

A. REFERENCED SPECIFICATIONS

1. ALL CONSTRUCTION SHALL BE IN ACCORDANCE WITH THE APPLICABLE SECTIONS OF THE FOLLOWING, EXCEPT AS MODIFIED HEREIN OR ON THE PROJECT PLANS OR SPECIFICATIONS:
 - STANDARD SPECIFICATIONS FOR ROAD AND BRIDGE CONSTRUCTION ADOPTED JANUARY 1, 2012 BY THE ILLINOIS DEPARTMENT OF TRANSPORTATION (DOT STANDARD SPECIFICATIONS).
 - VILLAGE OF SLEEPY HOLLOW STANDARDS.

B. NOTIFICATION

- IT SHALL BE THE CONTRACTOR'S RESPONSIBILITY TO NOTIFY THE FOLLOWING:
- THE DIRECTOR OF PUBLIC WORKS, ART SUNDERLAGE (847) 428-2404 AND THE VILLAGE ENGINEER, JEFFREY STEELE (847) 428-4335, FOR THE VILLAGE OF SLEEPY HOLLOW 48 HOURS PRIOR TO COMMENCEMENT OF CONSTRUCTION.
 - THE ELECTRIC, TELEPHONE, AND GAS UTILITIES PRIOR TO COMMENCEMENT OF CONSTRUCTION. (J.U.L.I.E. 811)

C. GENERAL NOTES

1. THE PROPOSED IMPROVEMENTS MUST BE CONSTRUCTED IN ACCORDANCE WITH THESE ENGINEERING PLANS AS PREPARED BY GERALD L. HEINZ & ASSOCIATES, INC. FOR THE VILLAGE. PROPER CONSTRUCTION TECHNIQUES AND SAFETY PROCEDURES REQUIRED BY OSHA MUST BE FOLLOWED DURING INSTALLATION OF IMPROVEMENTS INDICATED ON THE ENGINEERING PLANS.
2. LOCATION OF UNDERGROUND UTILITIES SHOWN ON THESE PLANS ARE BASED ON THE BEST INFORMATION AVAILABLE. THE CONTRACTOR SHALL BE RESPONSIBLE FOR CONTACTING JOINT UTILITY LOCATING INFORMATION FOR EXCAVATION (J.U.L.I.E.) AND THE VILLAGE OF SLEEPY HOLLOW AT LEAST FORTY-EIGHT (48) HOURS BEFORE COMMENCING CONSTRUCTION TO VERIFY IN THE FIELD THE LOCATION OF ALL UNDERGROUND INSTALLATIONS AND TO ARRANGE FOR THE ADJUSTMENT OR MOVING OF UTILITIES WHICH WILL CONFLICT WITH THE CONSTRUCTION OF THE PROPOSED IMPROVEMENT.
3. THE CONTRACTOR SHALL BE RESPONSIBLE FOR THE PROTECTION OF ALL UNDERGROUND OR SURFACE UTILITIES WHETHER OR NOT THEY ARE SHOWN ON THE PLANS. ANY UTILITY THAT IS DAMAGED DURING CONSTRUCTION SHALL BE REPAIRED TO THE SATISFACTION OF THE ENGINEER AND THE UTILITY OWNER. THE CONTRACTOR SHALL BE RESPONSIBLE FOR ALL EXPENSES INCURRED IN THE REPAIR OF DAMAGED UTILITY APPURTENANCES.
4. ALL EXISTING STORM SEWERS, CULVERTS, FIELD TILE DRAINS, CATCH BASINS, OR OTHER DRAINAGE STRUCTURES WHICH ARE DISTURBED BY CONSTRUCTION OPERATIONS SHALL BE REPLACED OR REPAIRED TO THE SATISFACTION OF THE ENGINEER. NO EXTRA COMPENSATION FOR THIS WORK SHALL BE ALLOWED.
5. THE CONTRACTOR SHALL BE RESPONSIBLE TO PROTECT AND PRESERVE ALL PROPERTY PINS WHICH ARE LOCATED AND MARKED BY THE VILLAGE ENGINEER PRIOR TO CONSTRUCTION. SHOULD IT BE NECESSARY THAT ANY OF THESE MARKED PROPERTY PINS BE REMOVED DUE TO THE CONSTRUCTION OPERATIONS, THE CONTRACTOR SHALL NOTIFY THE ENGINEER BEFORE PROCEEDING. THE ENGINEER SHALL TIE-IN THE PROPERTY CORNER BY OFFSET MEASUREMENTS AND SHALL BE RESPONSIBLE FOR RESETTING SAME. IF THE CONTRACTOR FAILS TO NOTIFY THE ENGINEER, THE CONTRACTOR, AT HIS EXPENSE, SHALL BE RESPONSIBLE FOR RESETTING THE PROPERTY PIN. THIS WORK SHALL BE PERFORMED BY AN ILLINOIS SURVEYOR APPROVED BY THE ENGINEER.
6. THE CONTRACTOR, AT HIS EXPENSE, WILL BE REQUIRED TO RELOCATE OR REMOVE AND REPLACE ANY ROAD OR STREET SIGNS WHICH INTERFERE WITH HIS CONSTRUCTION OPERATIONS AND TO TEMPORARILY RESET SUCH SIGNS DURING CONSTRUCTION OPERATIONS.
7. ALL WORK INVOLVING SIGNS SHALL BE GOVERNED BY THE FOLLOWING REQUIREMENTS:
 - A. SIGNS SHALL NOT BE MOVED UNTIL PROGRESS OF WORK NECESSITATES IT.
 - B. TRAFFIC CONTROL SIGNS REMOVED MUST BE RE-ERECTED AT TEMPORARY LOCATIONS IN A WORKMANLIKE MANNER AND VISIBLE TO TRAFFIC ON THE STREET OR HIGHWAY. ALL SUCH SIGNS MUST BE MAINTAINED STRAIGHT AND NEAT APPEARING FOR THE DURATION OF THE TEMPORARY SETTING.
8. THE CONTRACTOR SHALL AT ALL TIMES PROVIDE PROTECTION FOR THE TRAFFIC AS DIRECTED BY THE ENGINEER AND AS CALLED FOR IN THE TYPICAL APPLICATIONS OF THE TRAFFIC CONTROL DEVICES FOR ALL WORK ALONG EXISTING PAVEMENTS.
9. WHEN, DURING CONSTRUCTION OPERATIONS, ANY LOOSE MATERIAL IS DEPOSITED IN THE FLOW LINE OF DITCHES, GUTTERS OR DRAINAGE STRUCTURES SO THAT NATURAL FLOW OF WATER IS OBSTRUCTED, IT SHALL BE REMOVED AT THE CLOSE OF EACH WORKING DAY. AT THE CONCLUSION OF CONSTRUCTION OPERATIONS, ALL DRAINAGE STRUCTURES, EFFECTED BY THE WORK UNDER THIS CONTRACT SHALL BE CLEANED AND LEFT FREE FROM DIRT AND OTHER DEBRIS. THIS WORK COVERED IN THIS PROVISION SHALL NOT BE PAID FOR SEPARATELY, BUT SHALL BE CONSIDERED INCIDENTAL TO THE CONTRACT.
10. VERTICAL DATUM IS: NORTH AMERICAN VERTICAL DATUM OF 1988.











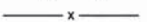

INDEX OF SHEETS

SHEET NO.	DESCRIPTION
1	COVER SHEET
2	INDEX OF SHEETS, GENERAL NOTES, LISTING OF HIGHWAY STANDARDS AND COMMITMENTS
3	TYPICAL SECTIONS & SUMMARY OF QUANTITIES
4	ALIGNMENT, TIES AND BENCHMARKS
5-12	PLAN AND PROFILE
13-16	EROSION & SEDIMENT CONTROL
17-23	CROSS SECTIONS

STANDARDS

000001-06	STANDARD SYMBOLS, ABBREVIATIONS AND PATTERNS
280001-07	TEMPORARY EROSION CONTROL SYSTEM
542301-03	PRECAST REINFORCED CONCRETE FLARED END SECTION
542311-04	TRAVERSABLE PIPE GRATE
701001-02	OFF-ROAD OPERATIONS, 2L, 2W, MORE THAN 15' A WAY
701801-05	SIDEWALK, CORNER OR CROSSWALK CLOSURE
701901-02	TRAFFIC CONTROL DEVICES

LEGEND

	EXISTING CONTOURS
	PROPOSED CONTOURS
	PROPOSED OVERLAND FLOW DIRECTION
	PROPOSED MAJOR OVERFLOW DIRECTION
	PERIMETER EROSION BARRIER
	TEMPORARY FENCE
	INLET FILTERS
	AGGREGATE (TYP.)
	SEEDING CLASS 1 & TOPSOIL FURNISH & PLACE, VAR. DEPTH
	EROSION CONTROL BLANKET
	EROSION CONTROL BLANKET
	AGGREGATE BICYCLE PATH
	EX. WETLAND
	SEEDING, CLASS 4B

TEMPORARY CRUSHED STONE ENTRANCE

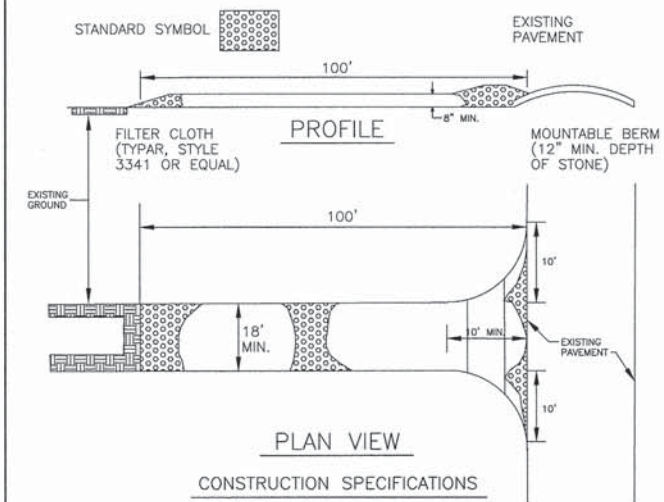

1. STONE SIZE - USE 3" CRUSHED STONE.
2. WIDTH - EIGHTEEN (18) FOOT MINIMUM, BUT NOT LESS THAN THE FULL WIDTH AT POINTS WHERE INGRESS OR EGRESS OCCURS.
3. FILTER CLOTH - WILL BE PLACED OVER THE ENTIRE AREA PRIOR TO PLACING OF STONE. COST OF FILTER CLOTH SHALL BE CONSIDERED INCIDENTAL TO THE COST PER TON OF CRUSHED STONE.
4. MAINTENANCE - THE ENTRANCE SHALL BE MAINTAINED IN A CONDITION WHICH WILL PREVENT TRACKING OR FLOWING OF SEDIMENT ONTO PUBLIC RIGHTS-OF-WAY. THIS MAY REQUIRE PERIODIC TOP DRESSING WITH ADDITIONAL STONE AS CONDITIONS DEMAND AND REPAIR AND/OR CLEANOUT OF ANY MEASURES USED TO TRAP SEDIMENT. ALL SEDIMENT SPILLED, DROPPED, WASHED OR TRACKED ONTO PUBLIC RIGHTS-OF-WAY MUST BE REMOVED IMMEDIATELY BY THE CONTRACTOR.
5. PAYMENT - COMPENSATION FOR THIS WORK SHALL BE MADE UNDER "TEMPORARY CRUSHED STONE ENTRANCE (3" GRADATION)" AT THE CONTRACT UNIT PRICE PER TON.

FILE NAME:
SH-1218

GERALD L. HEINZ & ASSOCIATES, INC.
CONSULTING ENGINEERS & LAND SURVEYORS
206 NORTH RIVER STREET
EAST DUNDEE, ILLINOIS 60118

USER NAME:
PLOT SCALE: NTS
PLOT DATE:

DESIGNED: JCS
DRAWN: PC
CHECKED: JDH
DATE: JANUARY 16, 2013

REVISED:
REVISED:
REVISED:
REVISED:

STATE OF ILLINOIS
DEPARTMENT OF TRANSPORTATION

INDEX OF SHEETS, GENERAL NOTES

SCALE: 1"= 20' SHEET NO. 1 OF 1 SHEETS STA: TO STA:

FAU ROUTE	SECTION	COUNTY	TOTAL SHEETS	SHEET NO.
2509	10-00007-60-BT	KANE	23	2

CONTRACT NO. 63839
FED. ROAD DIST. NO. ILLINOIS FED. AID. PROJECT

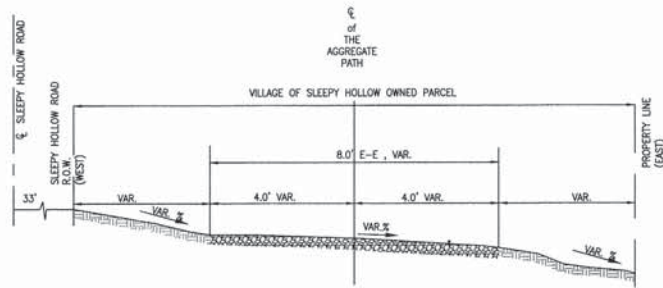

EXISTING AGGREGATE PATH
AT DUNDEE TOWNSHIP
BIRD SANCTUARY TRAIL HEAD
TYPICAL SECTION
NTS

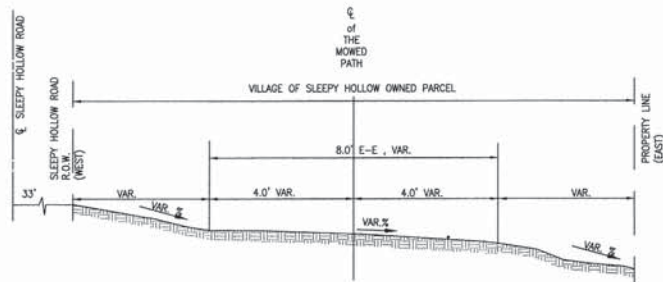

EXISTING MOWED PATH
TYPICAL SECTION
NTS

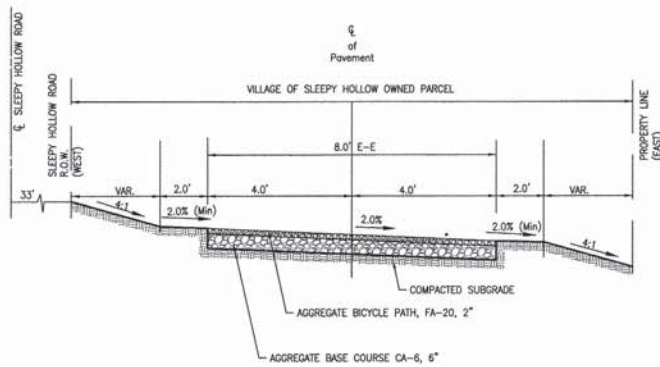

PROPOSED BICYCLE PATH
TYPICAL SECTION
NTS

SUMMARY OF QUANTITIES

CODE NO.	ITEM DESCRIPTION	UNIT	CONSTRUCTION TYPE CODE	
			80% FEDERAL/20% VILLAGE	FACILITIES FOR BICYCLE/PEDESTRIAN TRAILS 0028
			TOTAL QUANTITY	
20101200	TREE ROOT PRUNING	EACH	15	
20200100	EARTH EXCAVATION	CU YD	735	
20800150	TRENCH BACKFILL	CU YD	2.6	
21101600	TOPSOIL FURNISH AND PLACE, VARIABLE DEPTH	SQ YD	4947	
25000100	SEEDING, CLASS 1	ACRE	1	
25000314	SEEDING, CLASS 4B	ACRE	0.1	
25000400	NITROGEN FERTILIZER NUTRIENT	POUND	93	
25000500	PHOSPHORUS FERTILIZER NUTRIENT	POUND	93	
25000600	POTASSIUM FERTILIZER NUTRIENT	POUND	93	
25100630	EROSION CONTROL BLANKET	SQ YD	4947	
28000400	PERIMETER EROSION BARRIER	FOOT	2514	
28100105	STONE RIPRAP, CLASS A3	SQ YD	13	
28200200	FILTER FABRIC	SQ YD	13	
30300011	AGGREGATE SUBGRADE IMPROVEMENT	CU YD	30	
35101800	AGGREGATE BASE COURSE, TYPE B 6"	SQ YD	3298	
54213660	PRECAST REINFORCED CONCRETE FLARED END SECTIONS 15"	EACH	2	
542A0220	PIPE CULVERTS, CLASS A TYPE 1 15"	FOOT	23	
67100100	MOBILIZATION	L SUM	1	
70102640	TRAFFIC CONTROL AND PROTECTION, STANDARD 701801	L SUM	1	
XX002007	AGGREGATE BICYCLE PATH	SQ YD	3298	
Z0013797	STABILIZED CONSTRUCTION ENTRANCE	SQ YD	91	

* SPECIALTY ITEMS

EARTHWORK SCHEDULE

Station	Cut Area (Sq.Ft.)	Cut Volume (Cu.Yd)	Fill Area (Sq.Ft.)	Fill Volume (Cu.Yd)	Cum. Cut Vol. (Cu.Yd)	Cum. Fill Vol. (Cu.Yd)	Cum. Net Vol. (Cu.Yd) (0% SHRINKAGE FACTOR)
0+50.00	13.74	0	0	0	0	0	0
1+00.00	11.05	22.98	0	0	22.98	0	22.98
1+50.00	2.93	12.96	1.9	1.75	35.94	1.75	34.19
2+00.00	0	2.72	6.57	7.84	38.66	9.58	29.08
2+50.00	3.77	3.49	0.91	6.93	42.15	16.51	25.64
3+00.00	9.84	12.61	0	0.84	54.76	17.36	37.4
3+50.00	8.13	16.64	0.31	0.29	71.4	17.64	53.75
4+00.00	1.62	9.02	2.42	2.53	80.42	20.17	60.24
4+50.00	3.24	4.5	1.34	3.48	84.92	23.66	61.26
5+00.00	0.14	3.13	5.51	6.34	88.05	29.99	58.05
5+50.00	3.06	2.96	1.58	6.56	91	36.56	54.45
6+00.00	5.44	7.87	0.31	1.75	98.87	38.31	60.56
6+50.00	6.84	11.37	0.03	0.32	110.23	38.62	71.61
7+00.00	0.88	7.14	3.5	3.26	117.38	41.89	75.49
7+50.00	5.15	5.58	0.55	3.74	122.96	45.63	77.33
8+00.00	14.66	18.34	0	0.51	141.3	46.14	95.16
8+50.00	18.2	30.42	0	0	171.72	46.14	125.59
9+00.00	6.26	22.64	0.1	0.09	194.36	46.23	148.14
9+50.00	4.63	10.08	0.21	0.29	204.44	46.52	157.93
10+00.00	3.13	7.19	1.65	1.73	211.63	48.24	163.38
10+50.00	3.54	6.17	1.23	2.67	217.8	50.91	166.89
11+00.00	13.63	15.9	0	1.14	233.7	52.05	181.65
11+50.00	7.86	19.85	0	0	253.55	52.05	201.5
12+00.00	1.01	8.13	4.66	4.54	261.68	56.59	205.09
12+50.00	0	0.93	31.15	33.15	262.61	89.74	172.87
13+00.00	1.94	1.8	2.38	31.05	264.41	120.79	143.63
13+50.00	4.21	5.7	0.28	2.46	270.12	123.25	146.87
14+00.00	7.86	11.18	0	0.25	281.29	123.51	157.79
14+50.00	5.35	12.23	0.4	0.37	293.52	123.88	169.64
15+00.00	6.07	10.52	0	0.41	304.04	124.28	179.75
15+50.00	8.59	13.54	0	0	317.58	124.28	193.29
16+00.00	9.59	16.83	0	0	334.41	124.28	210.12
16+50.00	9.14	17.34	0	0	351.74	124.28	227.46
17+00.00	5.57	13.61	0.12	0.12	365.36	124.4	240.96
17+50.00	5.73	10.46	0	0.12	375.82	124.52	251.3
18+00.00	2.37	7.5	1.94	1.8	383.32	126.31	257
18+50.00	4.72	6.56	0.33	2.1	389.88	128.42	261.46
19+00.00	4.99	8.99	0.17	0.46	398.87	128.88	269.99
19+50.00	5.56	9.76	0	0.16	408.63	129.04	279.59
20+00.00	6.44	11.1	0	0	419.73	129.04	290.69
20+50.00	3.56	9.26	1.11	1.04	428.99	130.08	298.91
21+00.00	1.46	4.64	2.98	3.88	433.63	133.96	299.68
21+50.00	8.35	9.09	0	2.75	442.72	136.7	306.02
22+00.00	6.56	13.85	0	0	456.57	136.7	319.87
22+50.00	5.63	11.26	7.31	7.05	467.82	143.75	324.08
23+00.00	6.37	11.16	0	6.35	478.99	150.09	328.89
23+50.00	5.94	11.41	0	0	490.4	150.09	340.3
24+00.00	6.13	11.17	0	0	501.57	150.09	351.47
24+50.00	3.59	9	0.9	0.83	510.57	150.92	359.65
25+00.00	3.65	6.71	1.01	1.76	517.28	152.69	364.59
25+50.00	6.17	9.09	0	0.93	526.37	153.62	372.75
26+00.00	3.68	9.12	1.35	1.26	535.49	154.88	380.61
26+50.00	1.72	5	2.82	3.85	540.49	158.73	381.76
27+00.00	4.63	5.87	0.95	3.53	546.36	162.26	384.1
27+50.00	7.92	11.6	0.25	1.12	557.96	163.37	394.59
28+00.00	18.11	24.2	0	0.23	582.16	163.6	418.56
28+50.00	8.48	24.78	0.22	0.2	606.95	163.8	443.15
29+00.00	1.64	9.36	3.5	3.44	616.31	167.24	449.07
29+50.00	1.85	3.23	2.7	5.74	619.54	172.98	446.56
30+00.00	4.44	5.82	1.79	4.15	625.36	177.13	448.23
30+50.00	2.4	6.33	3.7	5.08	631.7	182.22	449.48
31+00.00	8.13	9.75	0.03	3.45	641.45	185.67	455.78
31+50.00	2.42	9.81	1.91	1.75	651.26	187.42	463.84
32+00.00	0	2.24	10.21	11.24	653.5	198.66	454.84
32+50.00	2.42	2.23	2.01	11.49	655.73	210.15	445.58
33+00.00	6.07	7.87	0.18	2.03	663.6	212.18	451.42
33+50.00	5.23	10.47	0.34	0.48	674.06	212.66	461.4
34+00.00	7.24	11.55	0.17	0.47	685.61	213.13	472.48
34+50.00	6.3	12.53	0.3	0.44	698.14	213.56	484.58
35+00.00	8.91	14.08	0	0.28	712.22	213.84	498.38
35+50.00	8.1	15.74	0	0	727.97	213.84	514.13
36+00.00	11.35	18.01	0	0	745.97	213.84	532.13
36+50.00	5.83	15.91	1.61	1.49	761.88	215.33	546.56
37+00.00	5.17	10.19	0.32	1.78	772.07	217.11	554.96

FILE NAME: SH-1218

GERALD L. HEINZ & ASSOCIATES, INC.
CONSULTING ENGINEERS & LAND SURVEYORS
206 NORTH RIVER STREET
EAST DUNDEE, ILLINOIS 60118

USER NAME:
PLOT SCALE: NTS
PLOT DATE:

DESIGNED: JCS
DRAWN: PC
CHECKED: JDH
DATE: JANUARY 16, 2013

REVISED:
REVISED:
REVISED:

STATE OF ILLINOIS
DEPARTMENT OF TRANSPORTATION

TYPICAL SECTIONS & SUMMARY OF QUANTITIES
EARTHWORK SCHEDULE

SCALE: 1" = 20'

SHEET NO. 1 OF 1 SHEETS STA. TO STA.

FAU ROUTE	SECTION	COUNTY	TOTAL SHEETS	SHEET NO.
2508	10-00007-00-BT	KANE	23	3
FED. ROAD DIST. NO.			ILLINOIS	
			FED. AID. PROJECT	

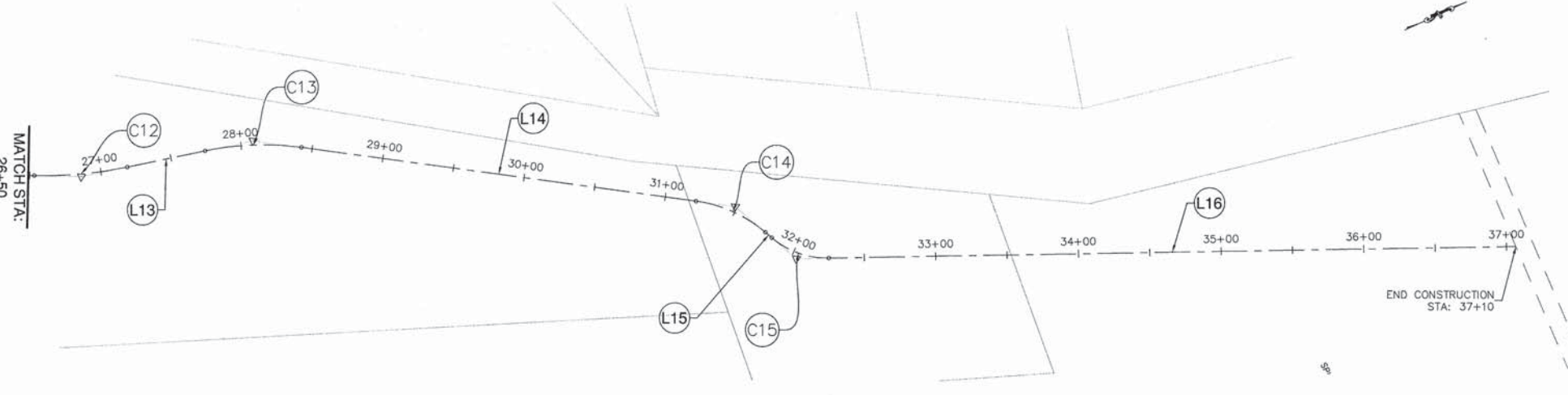
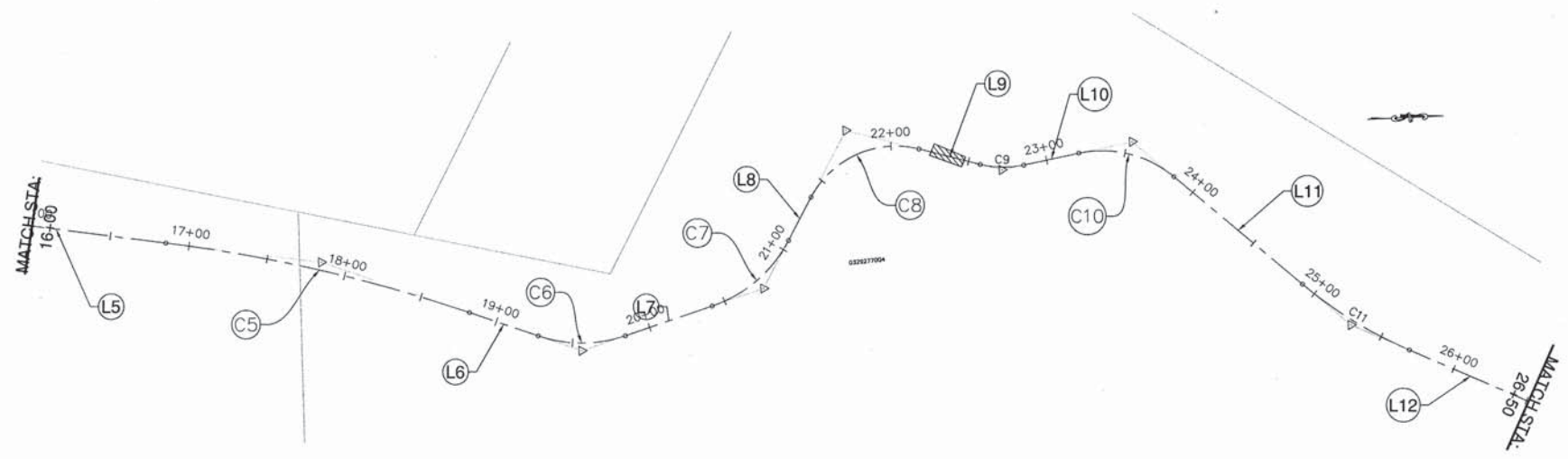
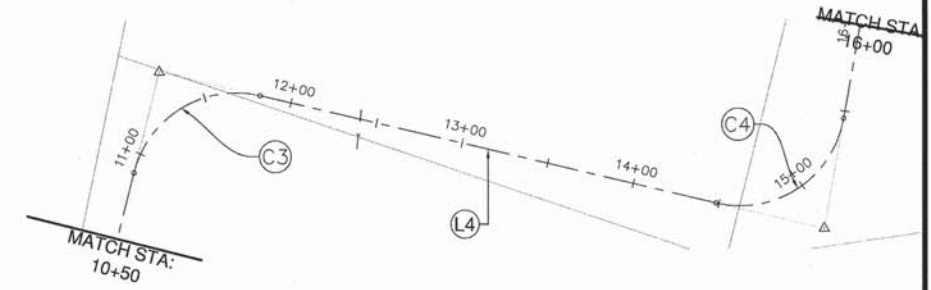
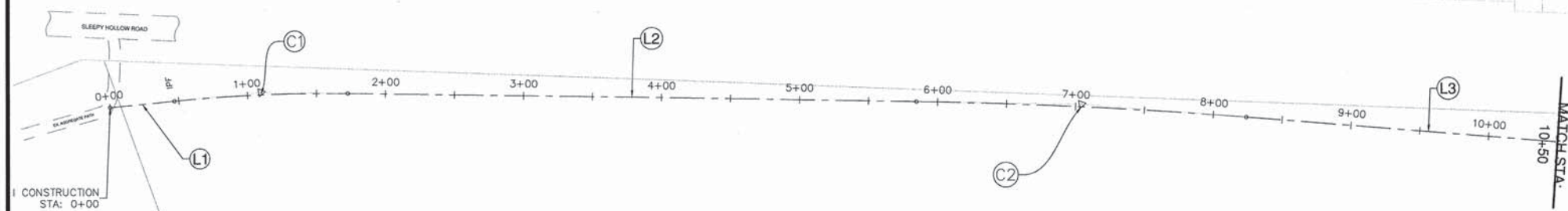

Line Table: Alignments

Line #	Length	Direction	Start Point	End Point
L1	46.84	N3° 58' 46.72"E	(987781.14, 1973555.95)	(987784.39, 1973602.68)
L2	411.99	N10° 31' 53.77"E	(987800.27, 1973727.39)	(987875.57, 1974132.44)
L3	264.89	N14° 08' 22.36"E	(987926.68, 1974366.16)	(987991.39, 1974623.02)
L4	266.31	S78° 52' 32.74"E	(988063.20, 1974666.80)	(988322.55, 1974606.33)
L5	139.52	N10° 00' 50.93"E	(988395.26, 1974654.33)	(988419.52, 1974791.72)
L6	45.75	N21° 38' 14.07"E	(988473.09, 1974980.71)	(988489.96, 1975023.24)
L7	57.82	N16° 05' 43.99"W	(988492.62, 1975078.15)	(988476.59, 1975133.70)
L8	30.79	N59° 54' 13.12"W	(988437.54, 1975183.68)	(988410.90, 1975199.12)
L9	39.84	N16° 51' 13.38"E	(988383.57, 1975268.42)	(988395.12, 1975306.55)
L10	35.47	N9° 31' 15.61"W	(988396.87, 1975333.87)	(988391.00, 1975368.85)
L11	105.71	N42° 45' 15.67"E	(988408.64, 1975427.95)	(988480.41, 1975505.58)
L12	83.53	N25° 54' 39.16"E	(988525.01, 1975570.89)	(988561.51, 1975646.02)
L13	55.65	N12° 57' 01.70"E	(988583.29, 1975707.75)	(988595.76, 1975761.98)
L14	279.36	N32° 25' 28.97"E	(988621.85, 1975824.40)	(988771.65, 1976060.21)
L15	5.84	N65° 00' 14.35"E	(988811.69, 1976095.38)	(988816.99, 1976097.84)
L16	481.52	N23° 32' 40.69"E	(988846.64, 1976128.26)	(989038.99, 1976569.69)

Curve Table: Alignments

Curve #	Radius	Length	Chord Direction	Start Point	End Point
C1	1100.00	125.79	N7° 15' 20.25"E	(987784.39, 1973602.68)	(987800.27, 1973727.39)
C2	3800.00	239.29	N12° 20' 08.07"E	(987875.57, 1974132.44)	(987926.68, 1974366.16)
C3	60.00	93.18	N58° 37' 54.81"E	(987991.39, 1974623.02)	(988063.20, 1974666.80)
C4	60.00	97.50	N56° 34' 09.10"E	(988322.55, 1974606.33)	(988395.26, 1974654.33)
C5	970.00	196.78	N15° 49' 32.50"E	(988419.52, 1974791.72)	(988473.09, 1974980.71)
C6	85.00	55.98	N2° 46' 15.04"E	(988489.96, 1975023.24)	(988492.62, 1975078.15)
C7	85.00	64.99	N37° 59' 58.56"W	(988476.59, 1975133.70)	(988437.54, 1975183.68)
C8	60.00	80.38	N21° 31' 29.87"W	(988410.90, 1975199.12)	(988383.57, 1975268.42)
C9	60.00	27.62	N3° 39' 58.88"E	(988395.12, 1975306.55)	(988396.87, 1975333.87)
C10	70.00	63.87	N16° 37' 00.03"E	(988391.00, 1975368.85)	(988408.64, 1975427.95)
C11	270.00	79.37	N34° 19' 57.41"E	(988480.41, 1975505.58)	(988525.01, 1975570.89)
C12	290.00	65.60	N19° 25' 50.43"E	(988561.51, 1975646.02)	(988583.29, 1975707.75)
C13	200.00	67.98	N22° 41' 15.34"E	(988595.76, 1975761.98)	(988621.85, 1975824.40)
C14	95.00	54.02	N48° 42' 51.66"E	(988771.65, 1976060.21)	(988811.69, 1976097.84)
C15	60.00	43.42	N44° 16' 27.52"E	(988846.64, 1976128.26)	(988846.64, 1976128.26)

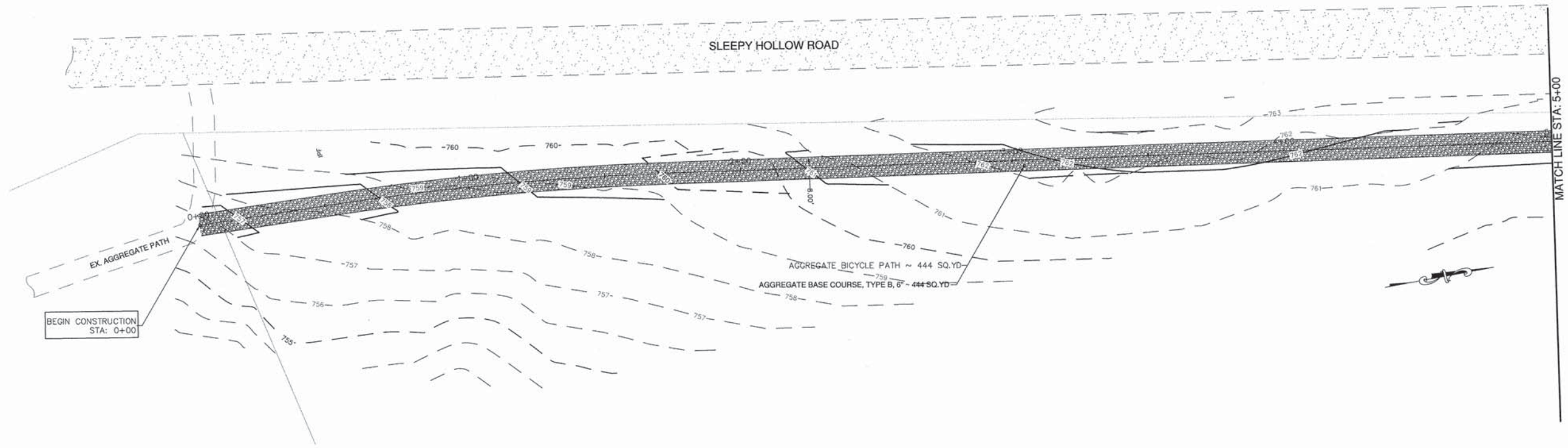

HIGH PT STA: 3+62.06
 HIGH PT ELEV: 762.13
 PVI STA: 3+00.00
 PVI ELEV: 762.50
 K: 84.01
 LVC: 200.00
 PVI: 2

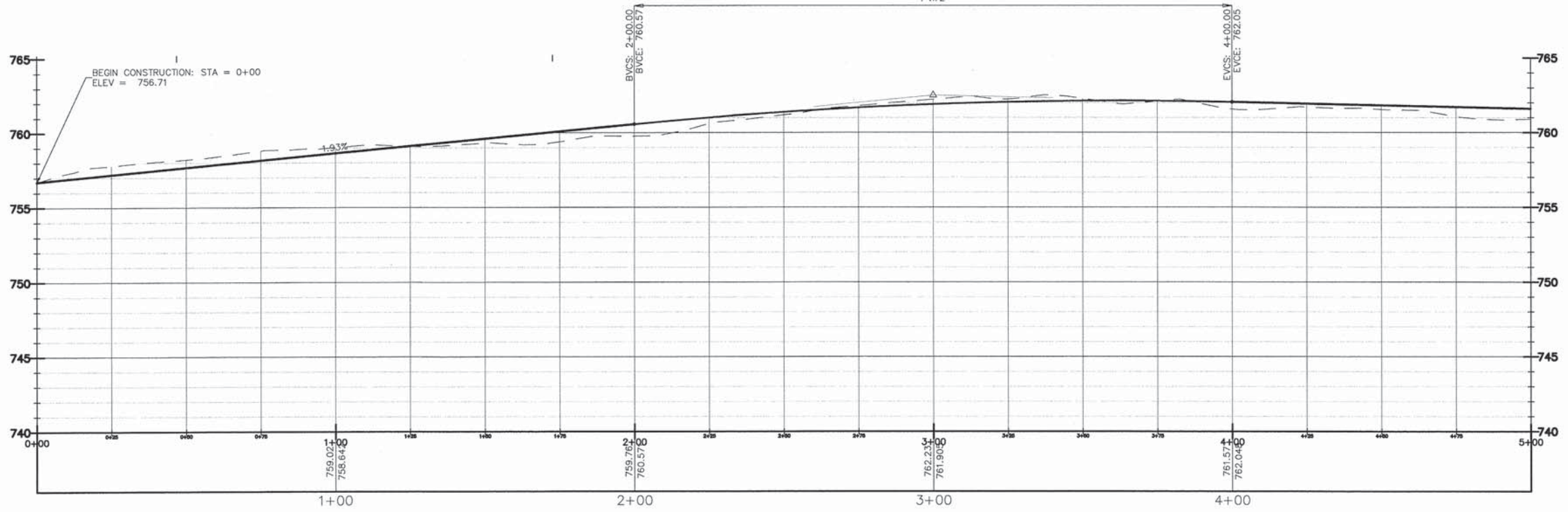

FILE NAME: SH-1218	GERALD L. HEINZ & ASSOCIATES, INC. CONSULTING ENGINEERS & LAND SURVEYORS 208 NORTH RIVER STREET EAST DUNDEE, ILLINOIS 60118	USER NAME:	DESIGNED: JCS	REVISED:	STATE OF ILLINOIS DEPARTMENT OF TRANSPORTATION	FINAL PLAN & PROFILE	FAU ROUTE:	SECTION:	COUNTY:	TOTAL SHEETS:	SHEET NO.:
		PLOT SCALE: 1" = 20'	CHECKED: JQH	REVISED:			2509	10-00007-00-BT	KANE	23	5
		PLOT DATE:	DATE: JANUARY 16, 2013	REVISED:	SCALE: 1" = 20'	SHEET NO. 1 OF 8 SHEETS	STA: 0+00 TO STA: 5+00	FED. ROAD DIST. NO.:	ILLINOIS	FED. AID. PROJECT	CONTRACT NO. 63839

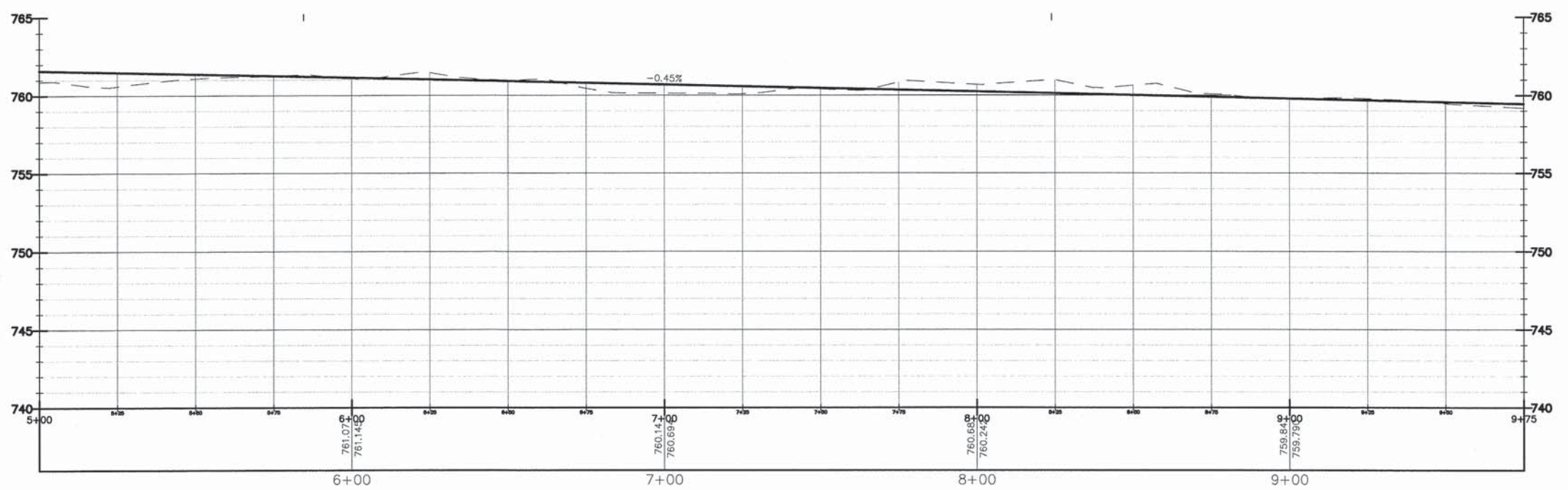
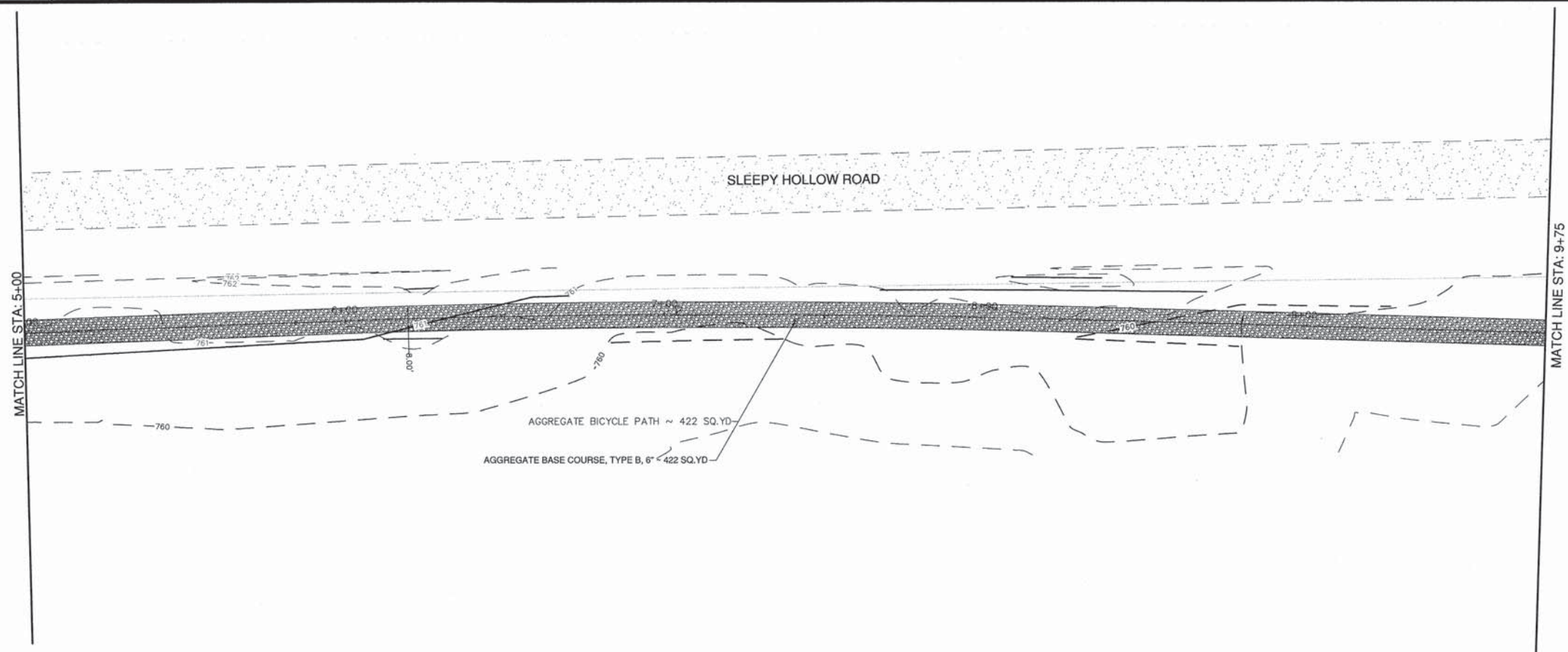

FILE NAME: SH-1218	GERALD L. HEINZ & ASSOCIATES, INC. CONSULTING ENGINEERS & LAND SURVEYORS 206 NORTH RIVER STREET EAST DUNDEE, ILLINOIS 60118	USER NAME:	DESIGNED: JCS	REVISED:	STATE OF ILLINOIS DEPARTMENT OF TRANSPORTATION	FINAL PLAN & PROFILE	SECTION	COUNTY	TOTAL SHEETS	SHEET NO.
		PLOT SCALE: 1" = 20'	CHECKED: JDH	REVISED:			10-00007-00-BT	KANE	23	6
		PLOT DATE:	DATE: JANUARY 16, 2013	REVISED:	SCALE: 1" = 20'	SHEET NO. 2 OF 8 SHEETS	STA: 5+00 TO STA: 9+75	FED. ROAD DIST. NO.	ILLINOIS	FED. AID. PROJECT

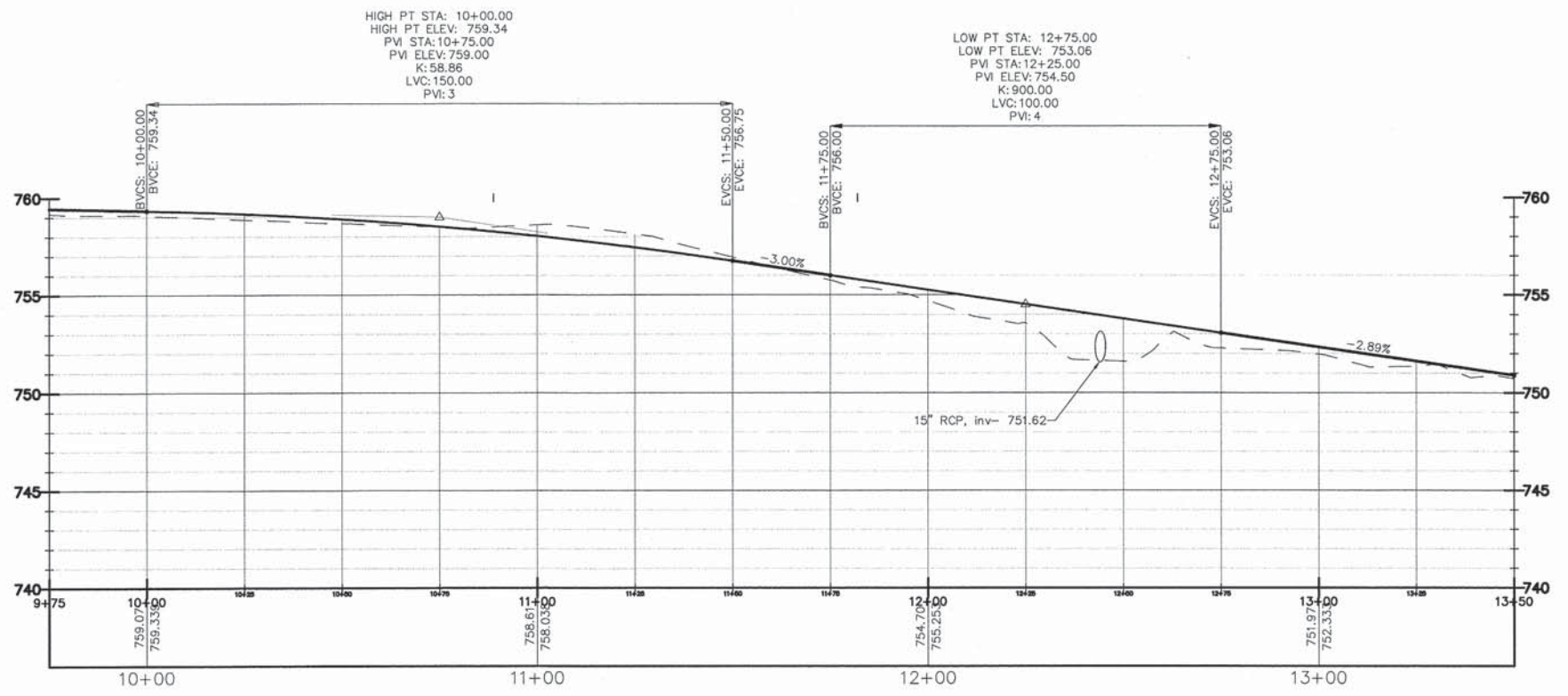
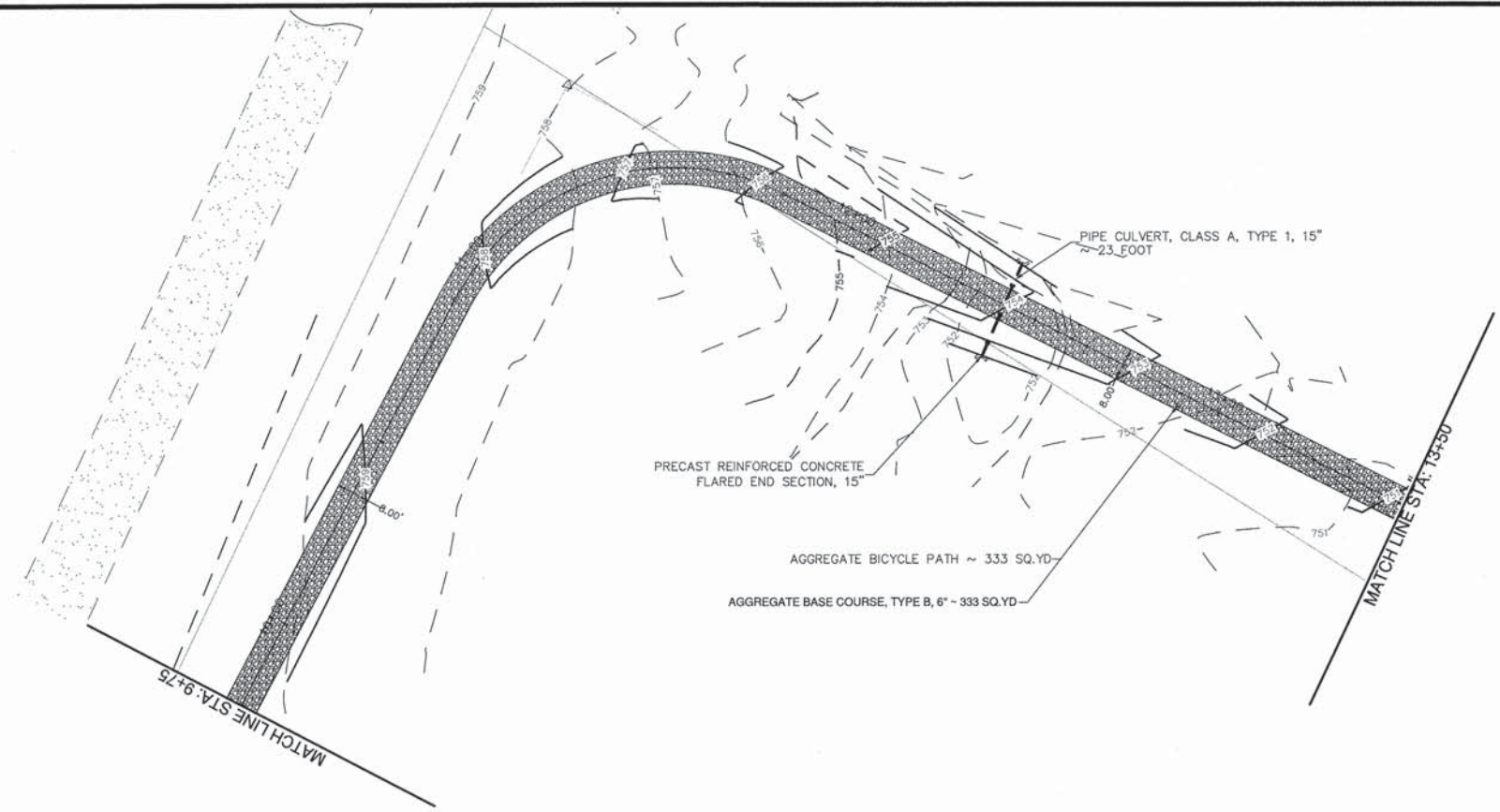

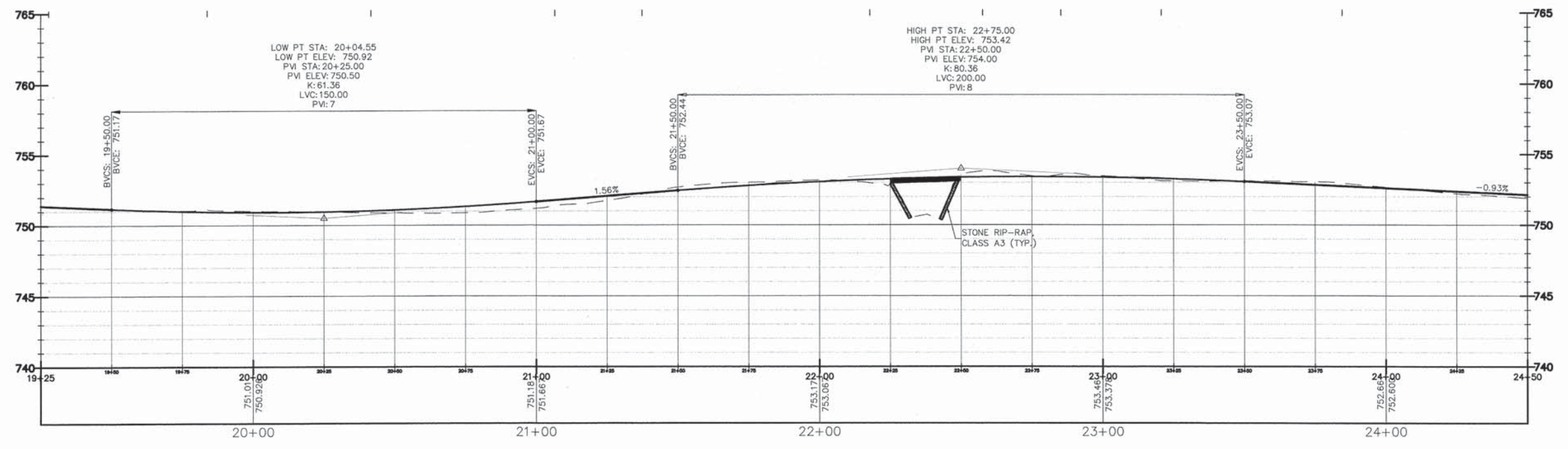
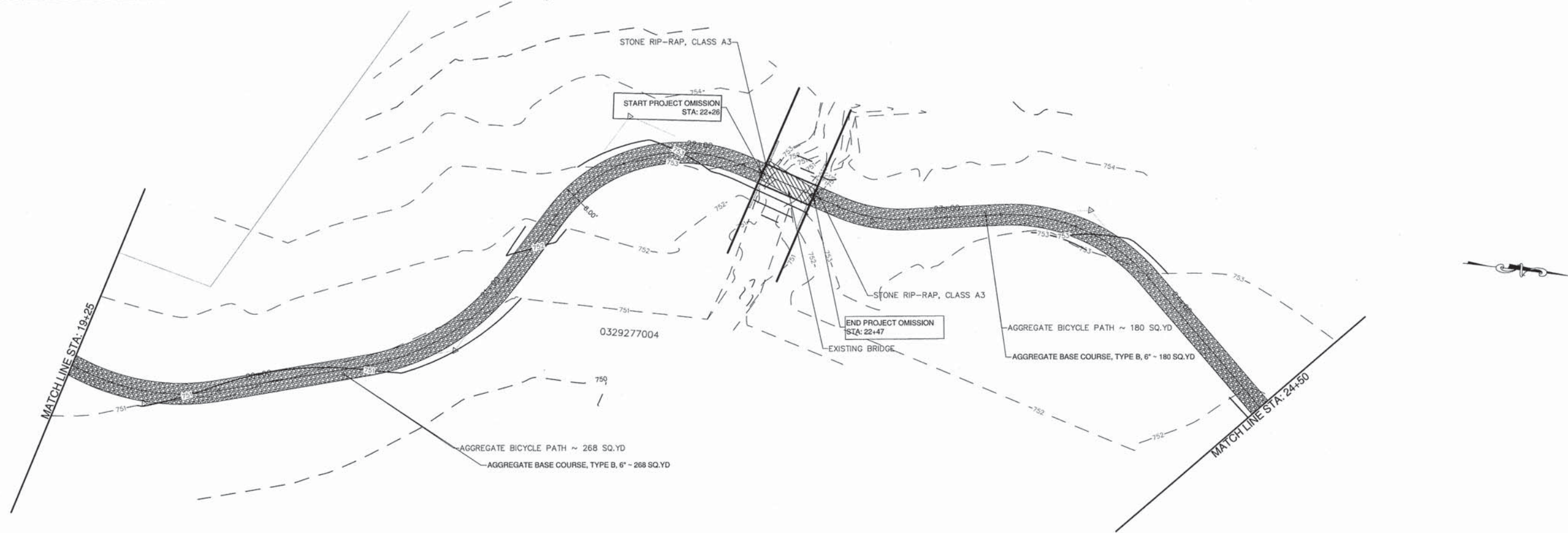

FILE NAME: SH-1218	GERALD L. HEINZ & ASSOCIATES, INC. CONSULTING ENGINEERS & LAND SURVEYORS 206 NORTH RIVER STREET EAST DUNDEE, ILLINOIS 60118	USER NAME:	DESIGNED: JCS	REVISED:	STATE OF ILLINOIS DEPARTMENT OF TRANSPORTATION	FINAL PLAN & PROFILE	FAU ROUTE:	SECTION	COUNTY	TOTAL SHEETS	SHEET NO.
		PLOT SCALE: 1" = 20'	CHECKED: JDH	REVISED:			2509	10-00007-00-BT	KANE	23	9
		PLOT DATE:	DATE: JANUARY 16, 2013	REVISED:		SCALE: 1" = 20'	SHEET NO. 5 OF 8 SHEETS	STA: 19+25 TO STA: 24+50	FED. ROAD DIST. NO.	ILLINOIS	FED. AID. PROJECT

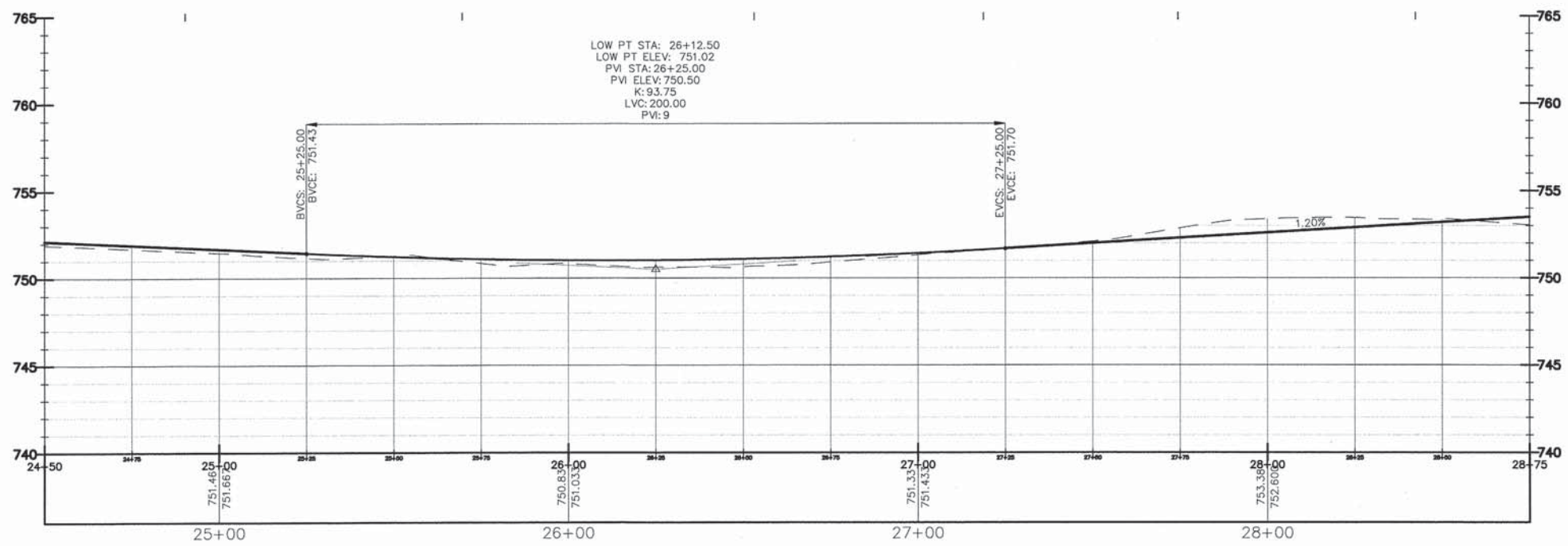
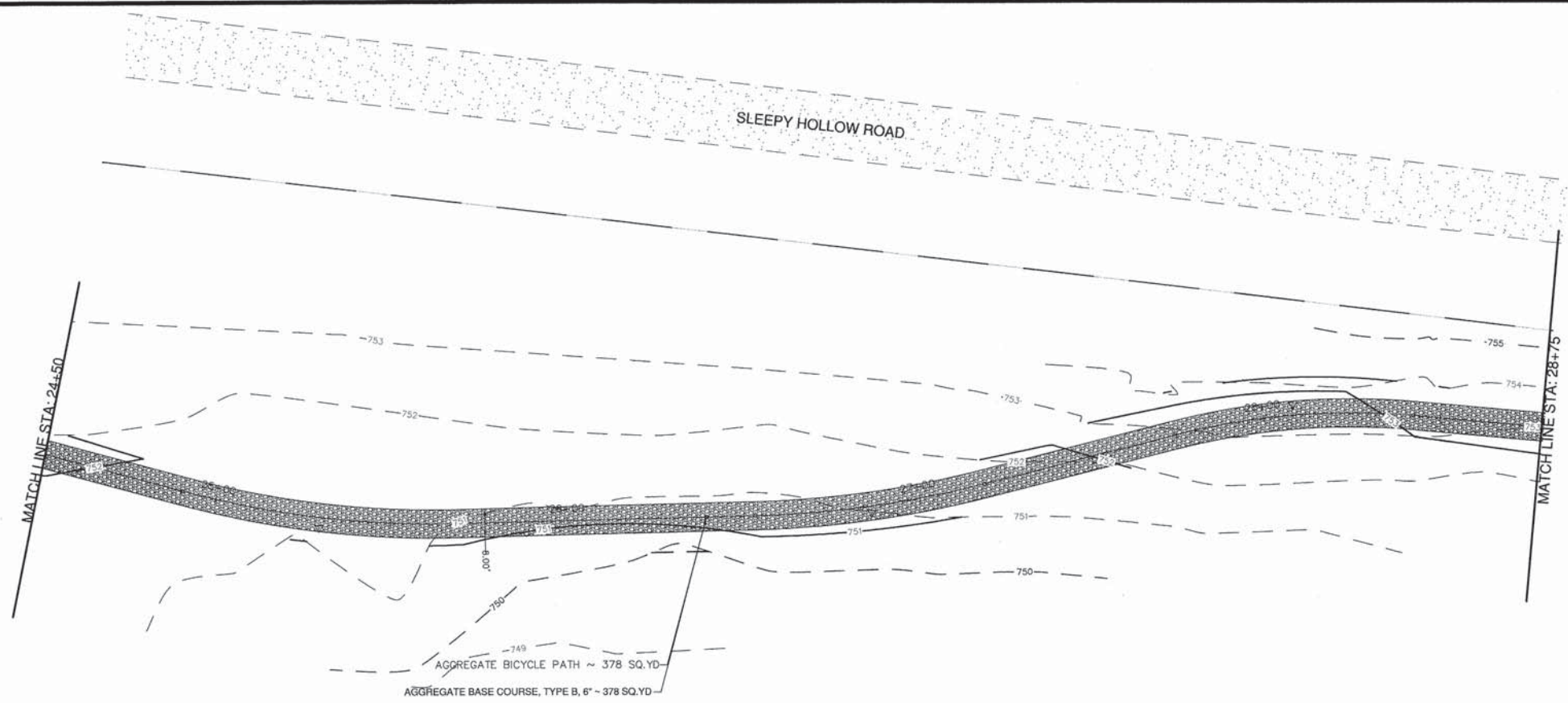

FILE NAME: SH-1218	GERALD L. HEINZ & ASSOCIATES, INC. CONSULTING ENGINEERS & LAND SURVEYORS 206 NORTH RIVER STREET EAST DUNDEE, ILLINOIS 60118	USER NAME:	DESIGNED: JCS	REVISED:	STATE OF ILLINOIS DEPARTMENT OF TRANSPORTATION	FINAL PLAN & PROFILE	PAU ROUTE	SECTION	COUNTY	TOTAL SHEETS	SHEET NO.	
		PLOT SCALE: 1" = 20'	CHECKED: JDH	REVISED:			2509	10-00007-00-BT	KANE	23	10	
		PLOT DATE:	DATE: JANUARY 16, 2013	REVISED:			CONTRACT NO. 63839					
							SCALE: 1" = 20'	SHEET NO. 6 OF 8 SHEETS	STA: 24+50 TO STA: 28+75	FED. ROAD DIST. NO.	ILLINOIS	FED. AID. PROJECT

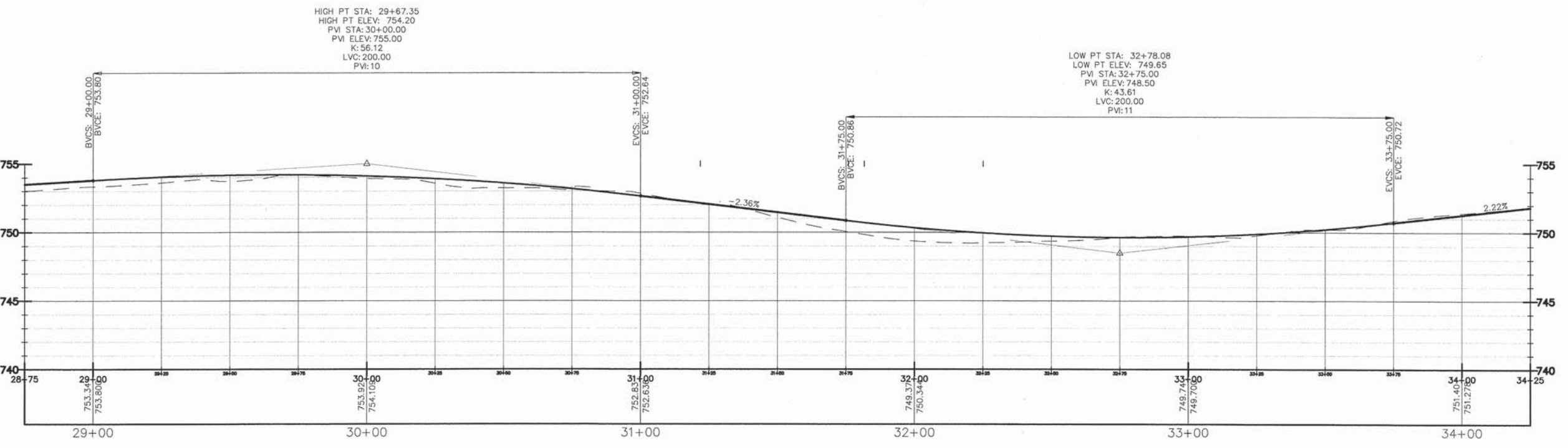
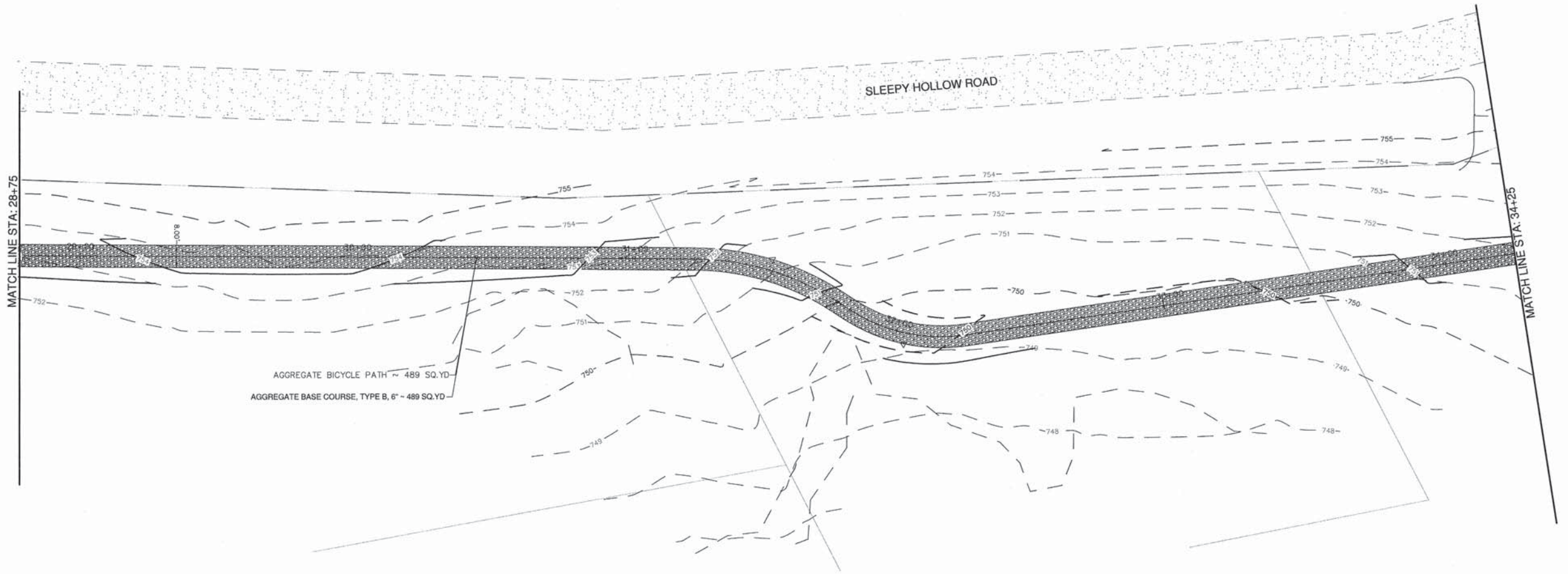



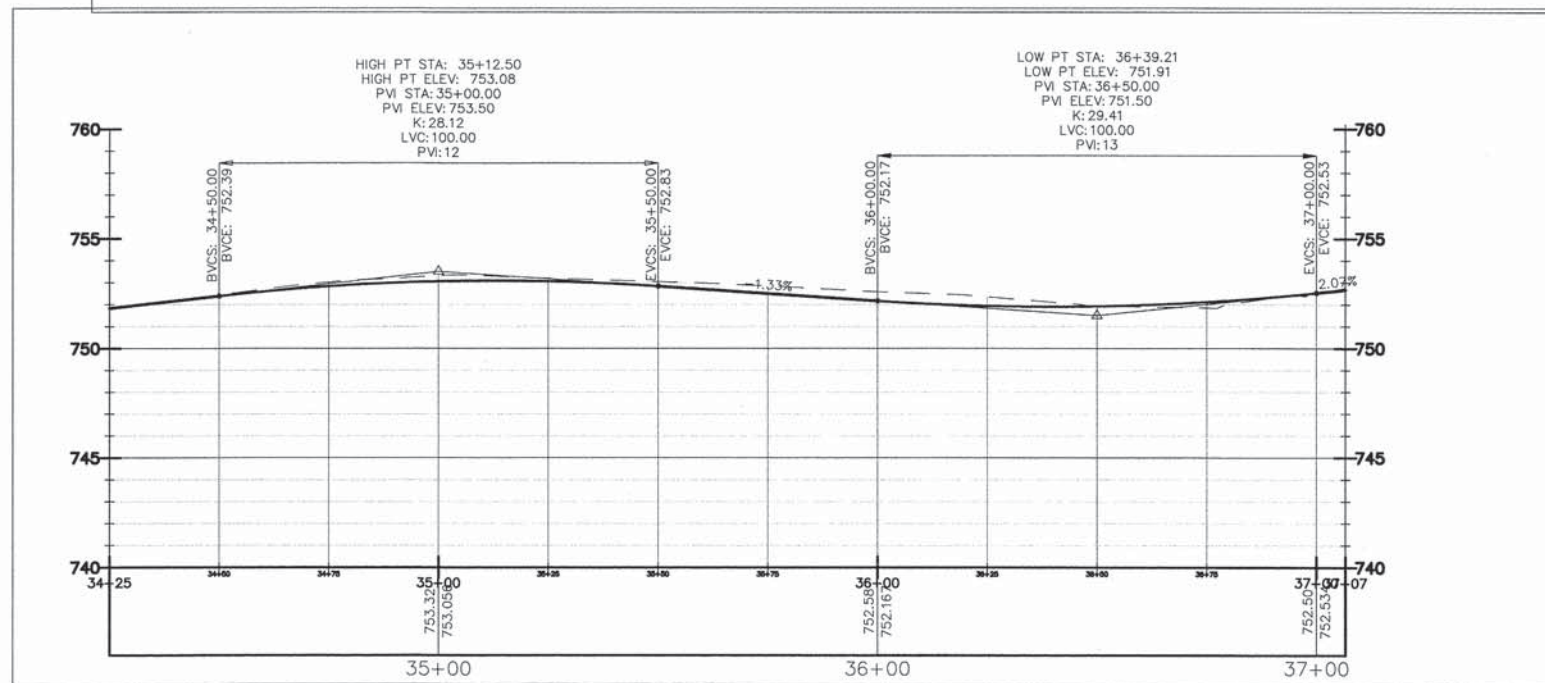
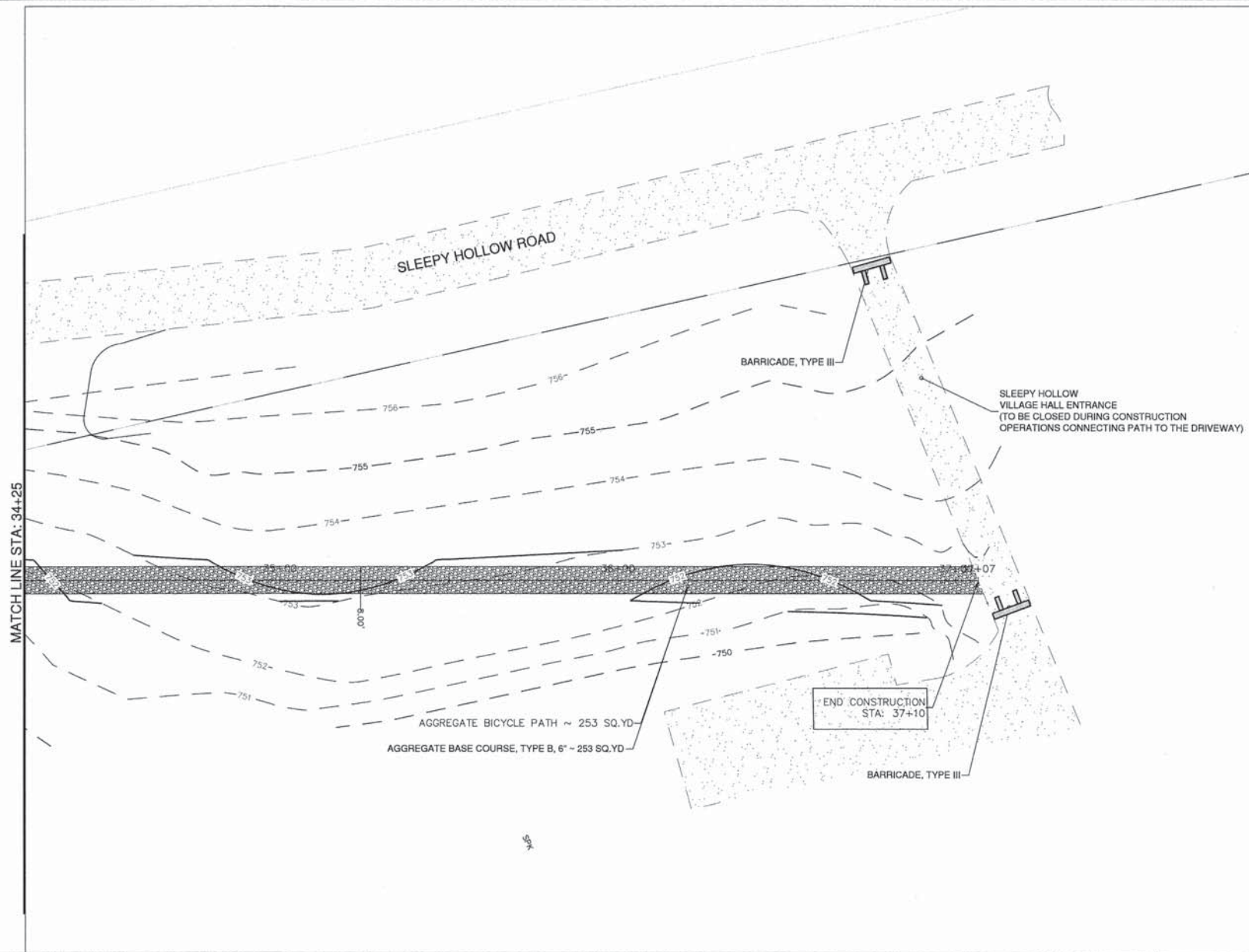

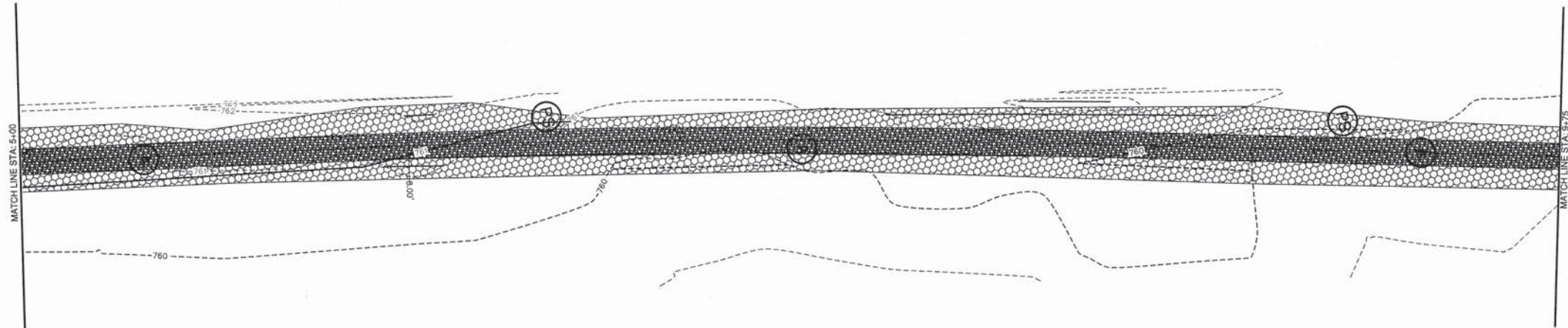
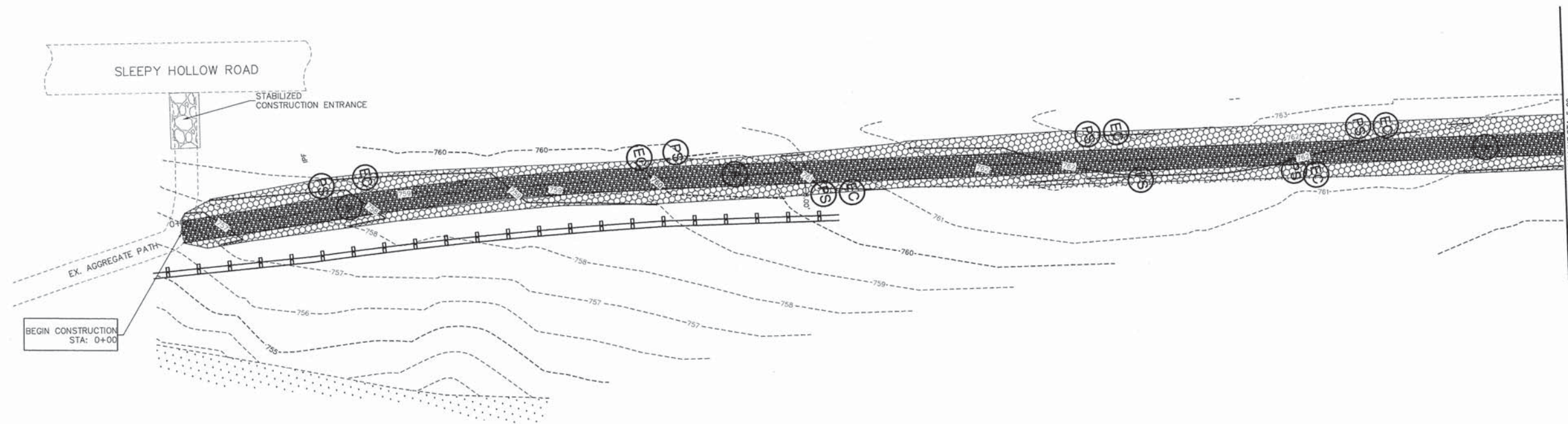







FILE NAME: SH-1218	GERALD L. HEINZ & ASSOCIATES, INC. CONSULTING ENGINEERS & LAND SURVEYORS 206 NORTH RIVER STREET EAST DUNDEE, ILLINOIS 60118	USER NAME: PLOT SCALE: 1" = 20" PLOT DATE:	DESIGNED: JCS DRAWN: PC CHECKED: JPH DATE: JANUARY 16, 2013	REVISED:	STATE OF ILLINOIS DEPARTMENT OF TRANSPORTATION	FINAL PLAN & PROFILE	FAU ROUTE: 2509	SECTION: 10-00007-00-BT	COUNTY: KANE	TOTAL SHEETS: 23	SHEET NO.: 11	CONTRACT NO. 63839	FED. ROAD DIST. NO.:	ILLINOIS	FED. AID. PROJECT
-----------------------	--------------------------------------------------------------------------------------------------------------------------------------	--------------------------------------------------	----------------------------------------------------------------------	----------	---------------------------------------------------	----------------------	--------------------	----------------------------	-----------------	---------------------	------------------	--------------------	----------------------	----------	-------------------





LEGEND

-  PROPOSED OVERLAND FLOW DIRECTION
-  PROPOSED MAJOR OVERFLOW DIRECTION
-  PERIMETER EROSION BARRIER
-  TEMPORARY FENCE
-  INLET FILTERS
-  AGGREGATE (TYP.)
-  SEEDING CLASS 1 & TOPSOIL FURNISH & PLACE, VAR. DEPTH
-  EROSION CONTROL BLANKET
-  EROSION CONTROL BLANKET
-  AGGREGATE BICYCLE PATH
-  EX. WETLAND
-  SEEDING, CLASS 4B

FILE NAME: SH-1218

GERALD L. HEINZ & ASSOCIATES, INC.
CONSULTING ENGINEERS & LAND SURVEYORS
205 NORTH RIVER STREET
EAST DUNDEE, ILLINOIS 60118

USER NAME:
PLOT SCALE: 1" = 20'
PLOT DATE:

DESIGNED: JCS
DRAWN: PC
CHECKED: JQH
DATE: JANUARY 16, 2013

REVISED:
REVISED:
REVISED:
REVISED:

STATE OF ILLINOIS
DEPARTMENT OF TRANSPORTATION

EROSION & SEDIMENT CONTROL

SCALE: 1" = 20'

SHEET NO. 1 OF 4 SHEETS STA: 0+00 TO STA: 9+75

FAU ROUTE	SECTION	COUNTY	TOTAL SHEETS	SHEET NO.
2509	10-00007-00-BT	KANE	23	13
FED. ROAD DIST. NO.			ILLINOIS	FED. AID. PROJECT
CONTRACT NO. 63839				

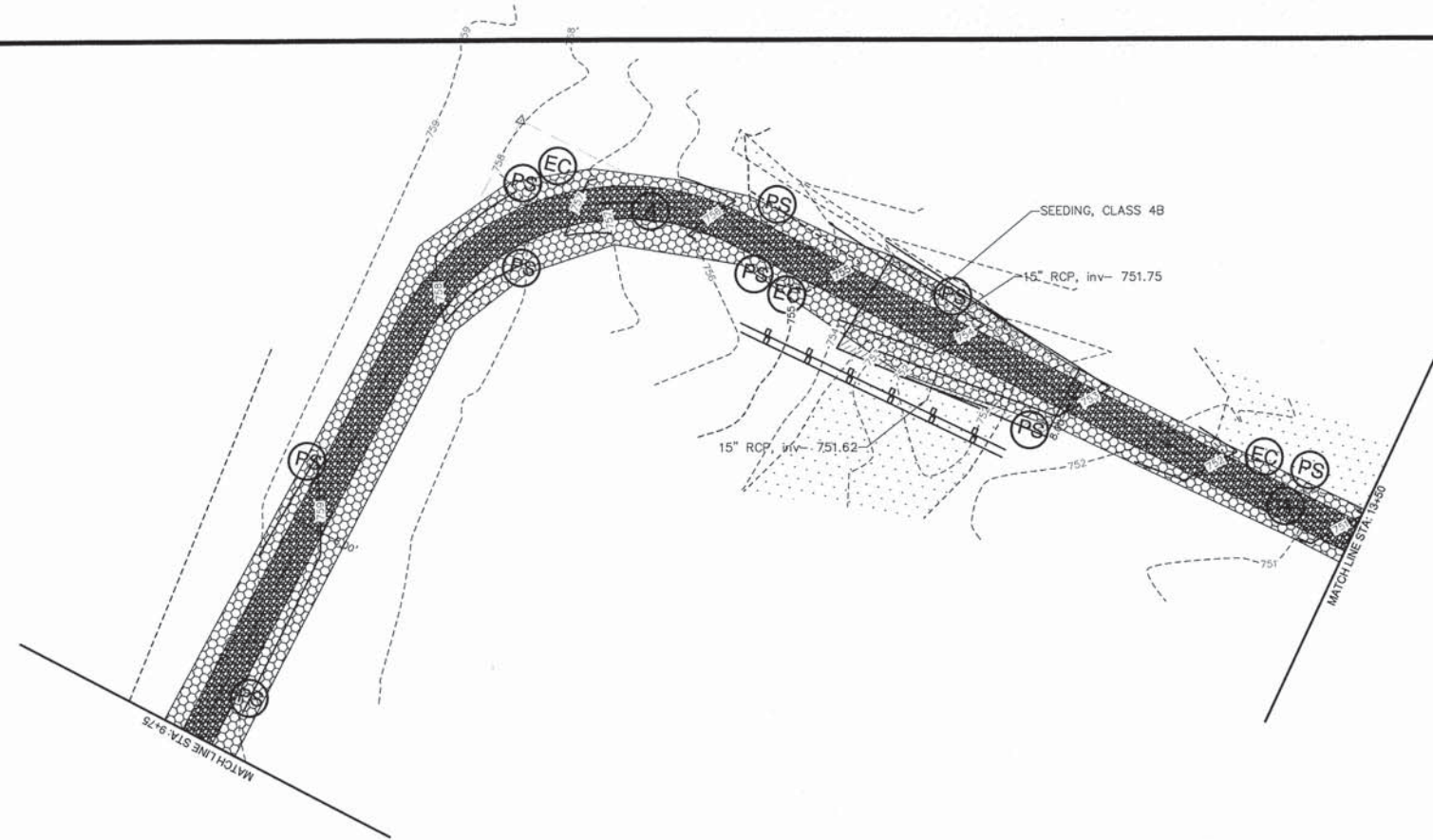

- LEGEND**
- ← PROPOSED OVERLAND FLOW DIRECTION
 - ← PROPOSED MAJOR OVERFLOW DIRECTION
 - PERIMETER EROSION BARRIER
 - x — TEMPORARY FENCE
 - ⊕ INLET FILTERS
 - (A) AGGREGATE (TYP.)
 - (PS) SEEDING CLASS 1 & TOPSOIL FURNISH & PLACE, VAR. DEPTH
 - (EC) EROSION CONTROL BLANKET
 - [Pattern] EROSION CONTROL BLANKET
 - [Pattern] AGGREGATE BICYCLE PATH
 - [Pattern] EX. WETLAND
 - [Pattern] SEEDING, CLASS 4B

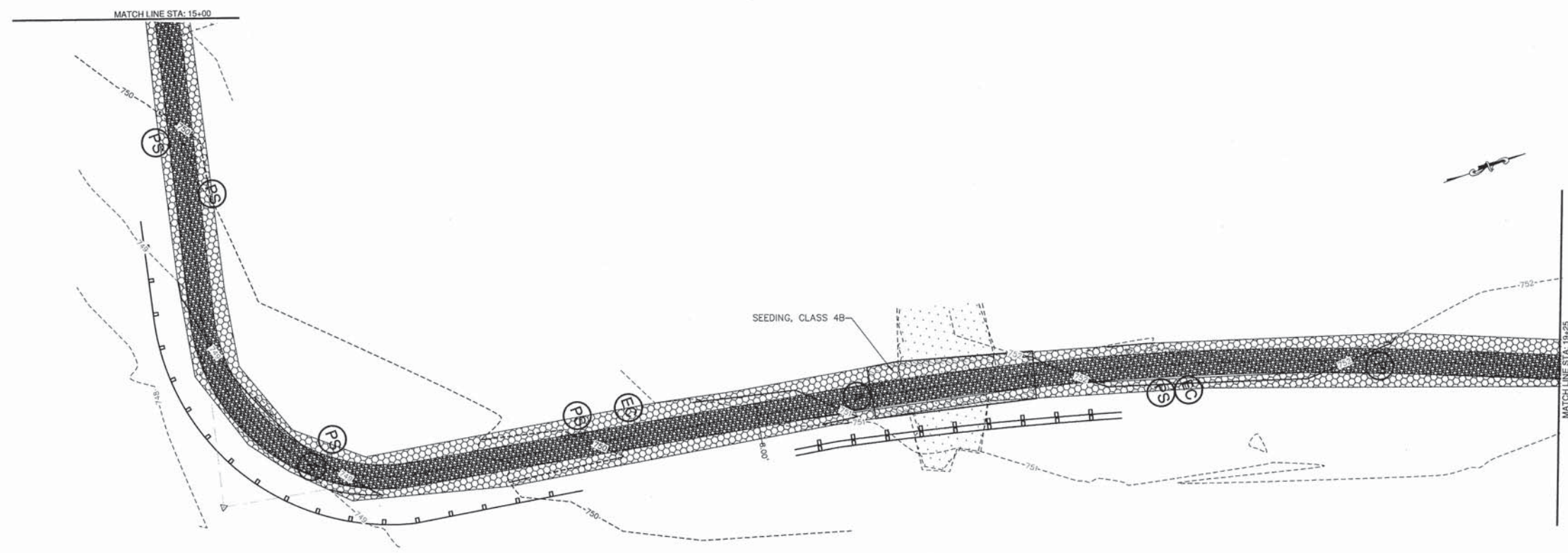

FILE NAME: SH-1218	GERALD L. HEINZ & ASSOCIATES, INC. CONSULTING ENGINEERS & LAND SURVEYORS 208 NORTH RIVER STREET EAST DUNDEE, ILLINOIS 60118	USER NAME:	DESIGNED: JCS	REVISED:	STATE OF ILLINOIS DEPARTMENT OF TRANSPORTATION	EROSION & SEDIMENT CONTROL	FAU ROUTE:	SECTION:	COUNTY:	TOTAL SHEETS:	SHEET NO.:
		PLOT SCALE: 1" = 20'	DRAWN: PC	REVISED:			2509	10-00007-00-BT	KANE	23	14
		PLOT DATE:	CHECKED: JGH	REVISED:	SCALE: 1" = 20'	SHEET NO. 2 OF 4 SHEETS	STA: 9+75 TO STA: 19+25	FED. ROAD DIST. NO.:	ILLINOIS	CONTRACT NO. 63839	FED. AID. PROJECT
			DATE: JANUARY 16, 2013	REVISED:							

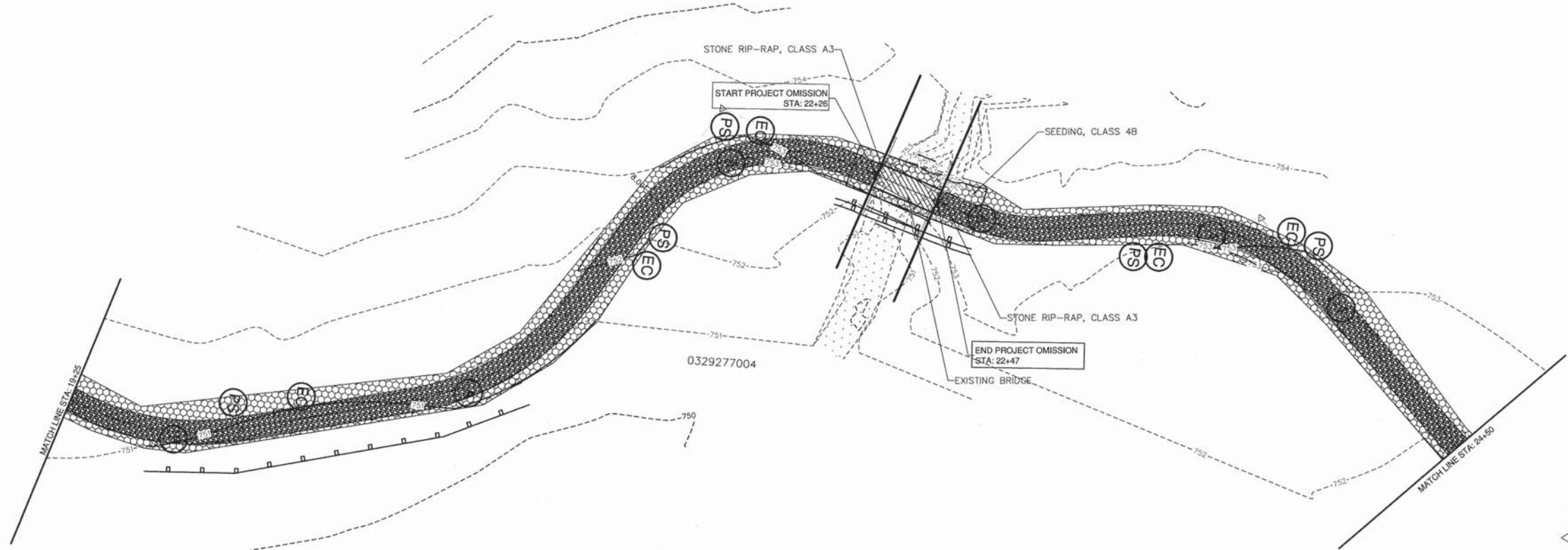

LEGEND



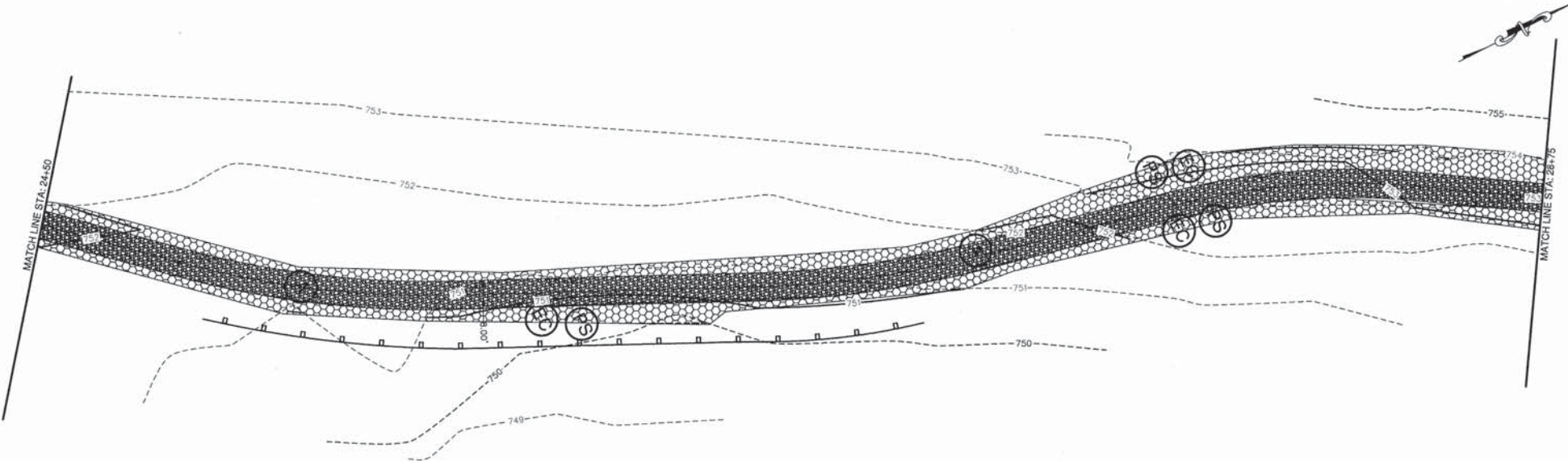



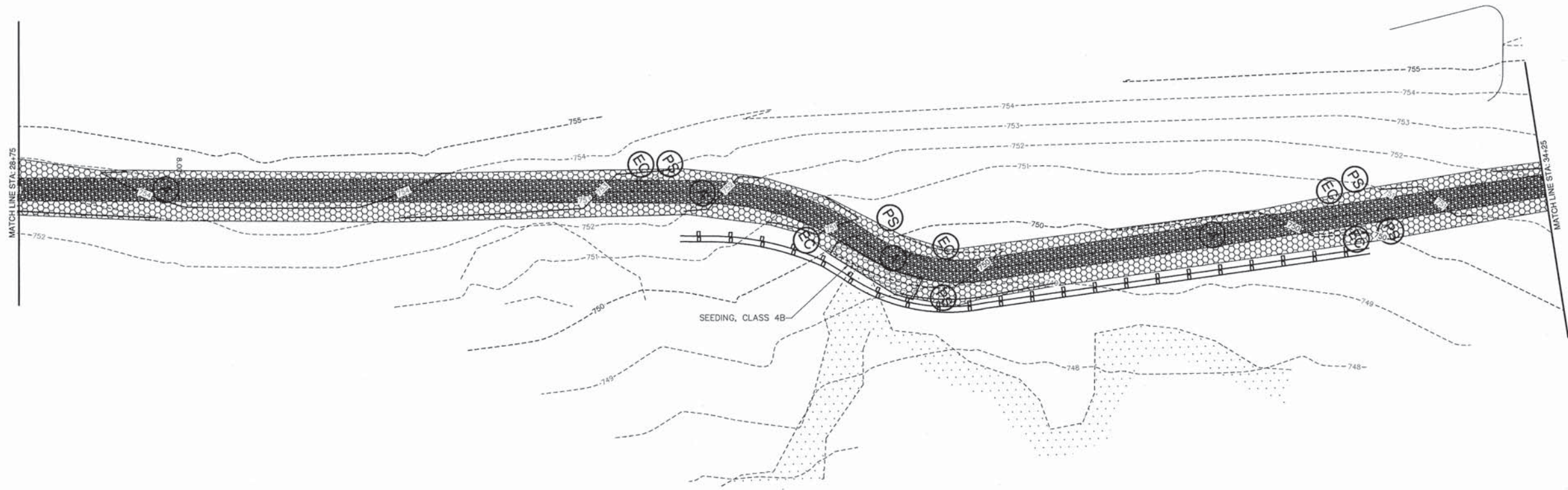





- PROPOSED OVERLAND FLOW DIRECTION
- PROPOSED MAJOR OVERFLOW DIRECTION
- PERIMETER EROSION BARRIER
- TEMPORARY FENCE
- INLET FILTERS
- AGGREGATE (TYP.)
- SEEDING CLASS 1 & TOPSOIL FURNISH & PLACE, VAR. DEPTH
- EROSION CONTROL BLANKET
- EROSION CONTROL BLANKET
- AGGREGATE BICYCLE PATH
- EX. WETLAND
- SEEDING, CLASS 4B



FILE NAME: SH-1218	GERALD L. HEINZ & ASSOCIATES, INC. CONSULTING ENGINEERS & LAND SURVEYORS 206 NORTH RIVER STREET EAST DUNDEE, ILLINOIS 60118	USER NAME:	DESIGNED: JCS	REVISED:	STATE OF ILLINOIS DEPARTMENT OF TRANSPORTATION	EROSION & SEDIMENT CONTROL	FAU ROUTE:	SECTION:	COUNTY:	TOTAL SHEETS:	SHEET NO.:
		PLOT SCALE: 1" = 20'	CHECKED: JDH	REVISED:			2509	10-00007-00-BT	KANE	23	15
		PLOT DATE:	DATE: JANUARY 16, 2013	REVISED:	SCALE: 1" = 20'	SHEET NO. 3 OF 4 SHEETS	STA: 19+25 TO STA: 28+75	FED. ROAD DIST. NO.:	ILLINOIS	FED. AID. PROJECT	CONTRACT NO. 63839



LEGEND

-  PROPOSED OVERLAND FLOW DIRECTION
-  PROPOSED MAJOR OVERFLOW DIRECTION
-  PERIMETER EROSION BARRIER
-  TEMPORARY FENCE
-  INLET FILTERS
-  AGGREGATE (TYP.)
-  SEEDING CLASS 1 & TOPSOIL FURNISH & PLACE, VAR. DEPTH
-  EROSION CONTROL BLANKET
-  EROSION CONTROL BLANKET
-  AGGREGATE BICYCLE PATH
-  EX. WETLAND
-  SEEDING, CLASS 4B

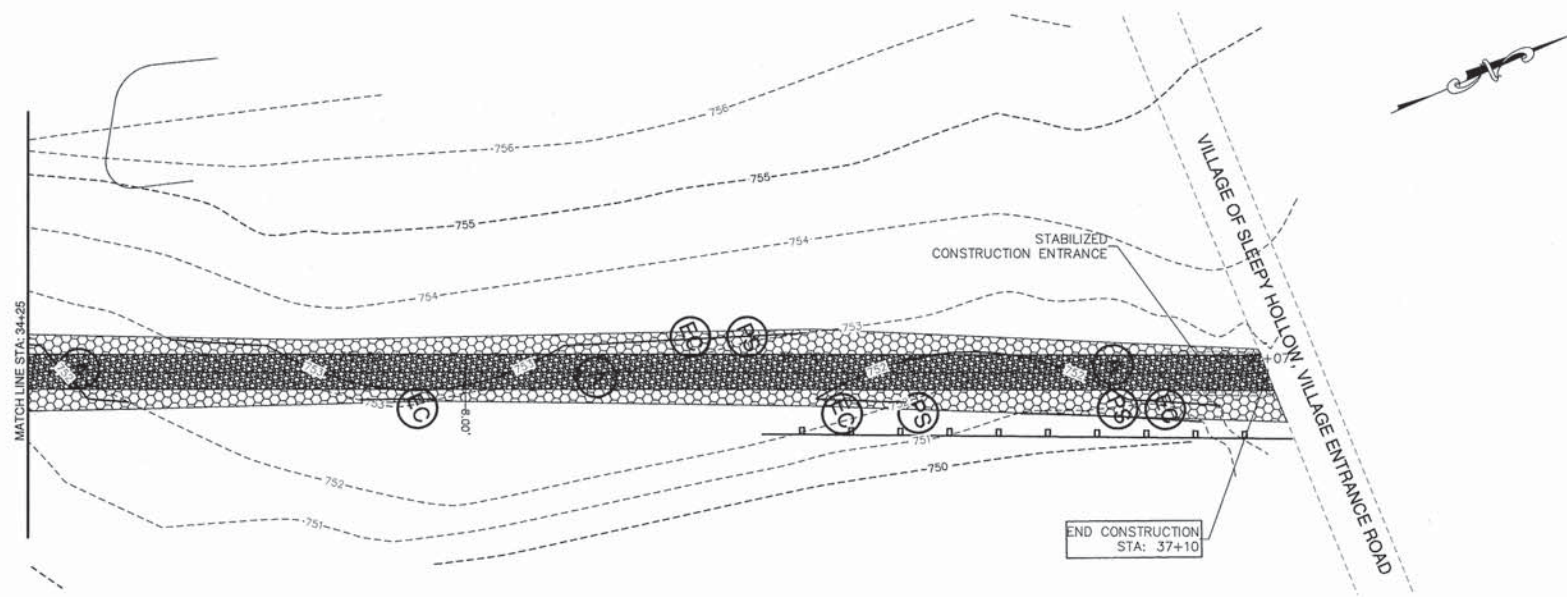

FILE NAME: SH-1218	GERALD L. HEINZ & ASSOCIATES, INC. CONSULTING ENGINEERS & LAND SURVEYORS 208 NORTH RIVER STREET EAST DUNDEE, ILLINOIS 60118	USER NAME:	DESIGNED: JCS	REVISED:	STATE OF ILLINOIS DEPARTMENT OF TRANSPORTATION	EROSION & SEDIMENT CONTROL	FAU ROUTE: 2509	SECTION: 10-00007-00-BT	COUNTY: KANE	TOTAL SHEETS: 23	SHEET NO.: 16
		PLOT SCALE: 1" = 20'	CHECKED: JDH	REVISED:			CONTRACT NO. 63839				
		PLOT DATE:	DATE: JANUARY 16, 2013	REVISED:	SCALE: 1" = 20' SHEET NO. 4 OF 4 SHEETS STA: 28+75 TO STA: 37+10		FED. ROAD DIST. NO. ILLINOIS		FED. AID. PROJECT		

DESIGNED:	SURVEYED:	BY:	DATE:
DRAWN:	PLOTTED:		
CHECKED:	TEMPLATE:		
NOTE BOOK:	DATE:		
NO.:	AREAS:		
	AREAS:		

DESIGNED:	SURVEYED:	BY:	DATE:
DRAWN:	PLOTTED:		
CHECKED:	TEMPLATE:		
NOTE BOOK:	DATE:		
NO.:	AREAS:		
	AREAS:		

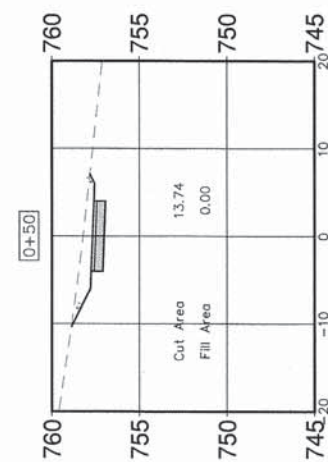
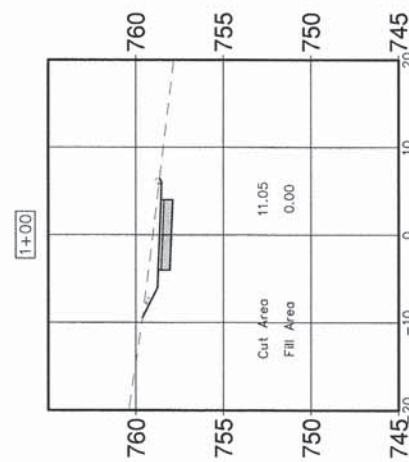
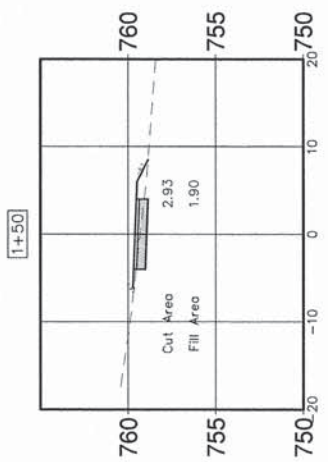
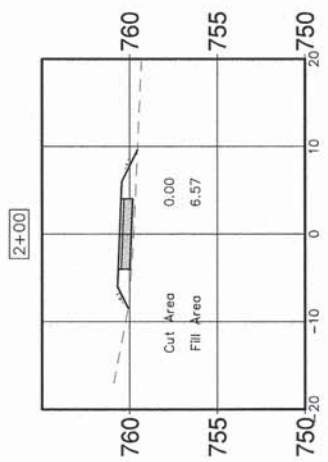
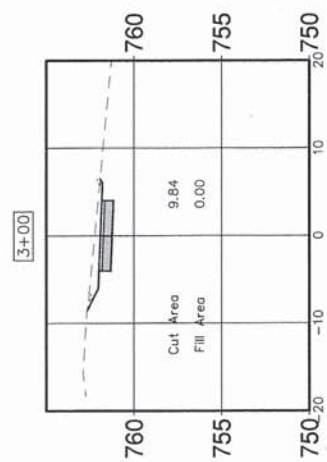
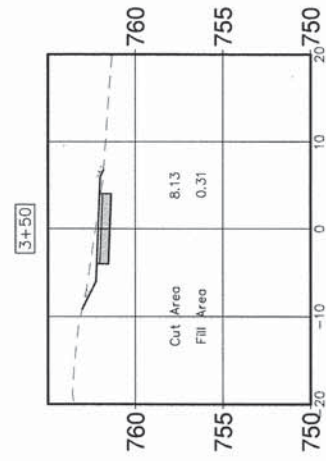
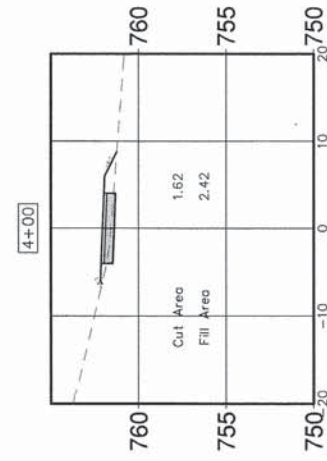
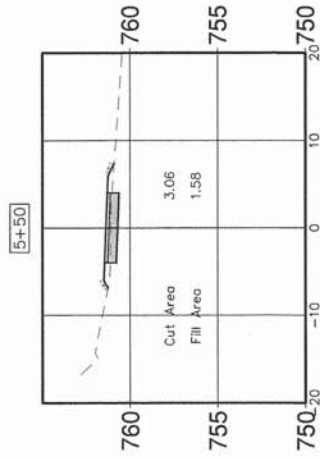
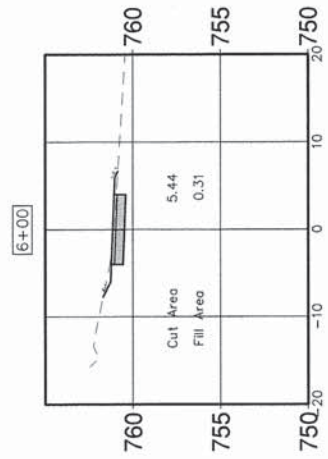

FILE NAME: SH-1218

GERALD L. HEINZ & ASSOCIATES, INC.
 CONSULTING ENGINEERS & LAND SURVEYORS
 206 NORTH RIVER STREET
 EAST DUNDEE, ILLINOIS 60118

USER NAME:
 PLOT SCALE: 1" = 20'
 PLOT DATE:

DESIGNED: JCS
 DRAWN: PC
 CHECKED: JDH
 DATE: JANUARY 16, 2013

REVISED:
 REVISED:
 REVISED:
 REVISED:

STATE OF ILLINOIS
 DEPARTMENT OF TRANSPORTATION

CROSS SECTIONS

SCALE: 1" = 20' SHEET NO. 1 OF 7 SHEETS STA: 0+00 TO STA: 37+10

FAU ROUTE	SECTION	COUNTY	TOTAL SHEETS	SHEET NO.
2509	10-00007-00-BT	KANE	23	17
FED. ROAD DIST. NO.			ILLINOIS	
			CONTRACT NO. 63839	
			FED. AID. PROJECT	

DESIGNED:	SURVEYED:	BY:	DATE:
DRAWN:	PLOTTED:		
CHECKED:	TEMPLATE:		
NOTE BOOK:	DATE:		
NO.:	DATE:		

DESIGNED:	SURVEYED:	BY:	DATE:
DRAWN:	PLOTTED:		
CHECKED:	TEMPLATE:		
NOTE BOOK:	DATE:		
NO.:	DATE:		

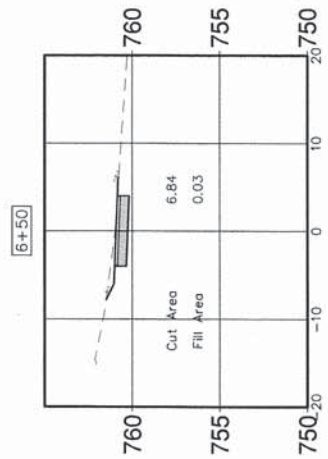
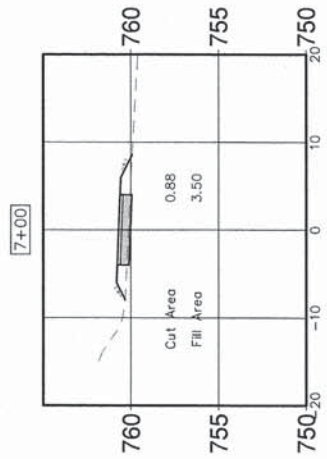
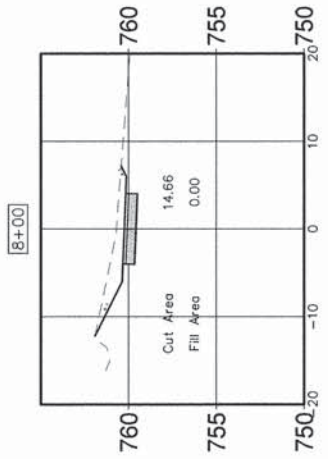
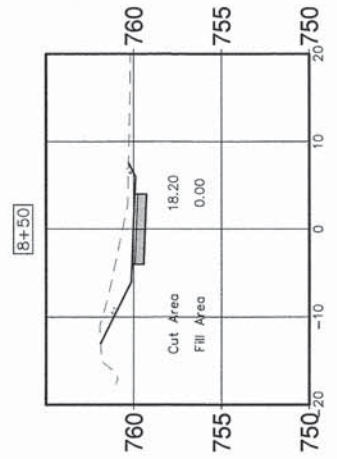
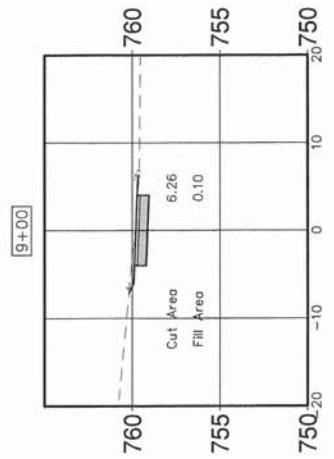
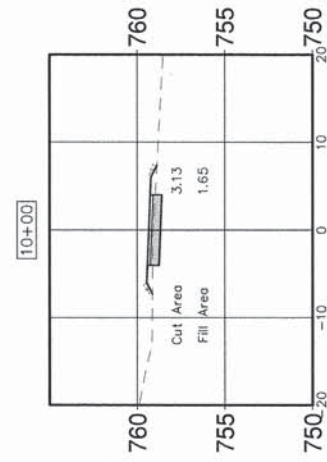
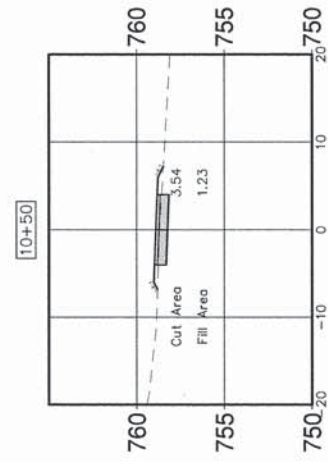
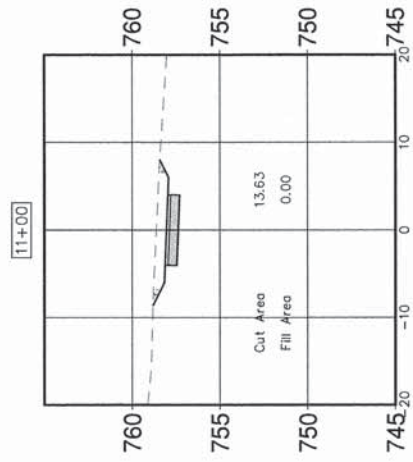
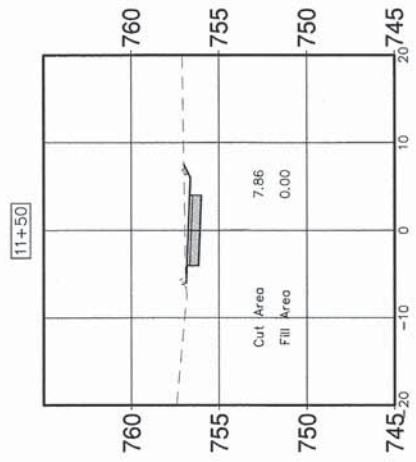
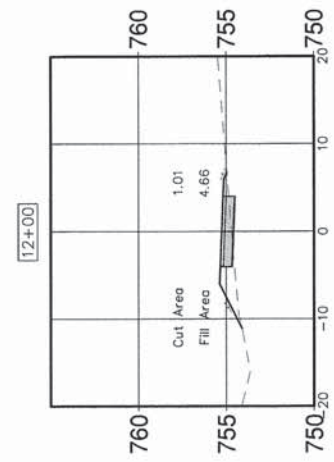

FILE NAME: SH-1218

GERALD L. HEINZ & ASSOCIATES, INC.
CONSULTING ENGINEERS & LAND SURVEYORS
206 NORTH RIVER STREET
EAST DUNDEE, ILLINOIS 60118

USER NAME:
PLOT SCALE: 1" = 20"
PLOT DATE:

DESIGNED: JCS
DRAWN: PC
CHECKED: JQH
DATE: JANUARY 16, 2013

REVISED:
REVISED:
REVISED:
REVISED:

STATE OF ILLINOIS
DEPARTMENT OF TRANSPORTATION

CROSS SECTIONS

SCALE: 1" = 20' SHEET NO. 2 OF 7 SHEETS STA: 6+00 TO STA: 37+10

FAU ROUTE	SECTION	COUNTY	TOTAL SHEETS	SHEET NO.
2509	10-00007-00-BT	KANE	23	18
FED. ROAD DIST. NO.			CONTRACT NO. 63839	
ILLINOIS			FED. AID. PROJECT	

DESIGNED:	JCS	DESIGNED:	JCS
DRAWN:	PC	DRAWN:	PC
CHECKED:	JDH	CHECKED:	JDH
DATE:	JANUARY 16, 2013	DATE:	JANUARY 16, 2013

DESIGNED:	JCS	DESIGNED:	JCS
DRAWN:	PC	DRAWN:	PC
CHECKED:	JDH	CHECKED:	JDH
DATE:	JANUARY 16, 2013	DATE:	JANUARY 16, 2013

DESIGNED:	JCS	DESIGNED:	JCS
DRAWN:	PC	DRAWN:	PC
CHECKED:	JDH	CHECKED:	JDH
DATE:	JANUARY 16, 2013	DATE:	JANUARY 16, 2013

FILE NAME: SH-1218

GERALD L. HEINZ & ASSOCIATES, INC.
CONSULTING ENGINEERS & LAND SURVEYORS
206 NORTH RIVER STREET
EAST DUNDEE, ILLINOIS 60118

USER NAME:
PLOT SCALE: 1" = 20'
PLOT DATE:

DESIGNED: JCS
DRAWN: PC
CHECKED: JDH
DATE: JANUARY 16, 2013

REVISIONS:
NO. DESCRIPTION DATE

STATE OF ILLINOIS
DEPARTMENT OF TRANSPORTATION

CROSS SECTIONS

SCALE: 1" = 20' SHEET NO. 3 OF 7 SHEETS STA: 0+00 TO STA: 37+10

SECTION	COUNTY	TOTAL SHEETS	SHEET NO.
10-00007-00-BT	KANE	23	19
FED. ROAD DIST. NO.		CONTRACT NO. 63839	
ILLINOIS		FED. AID. PROJECT	

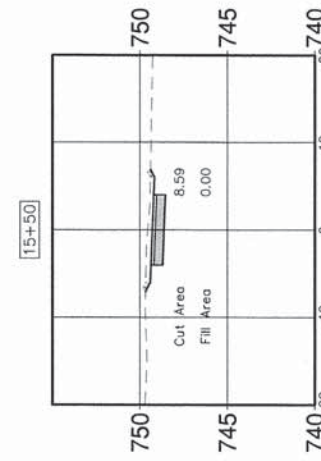
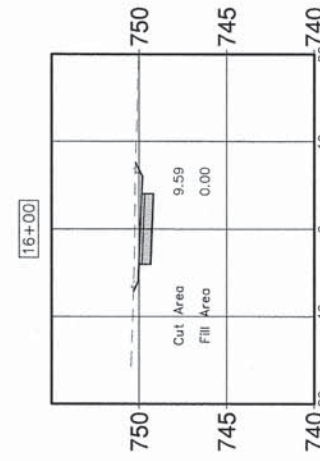
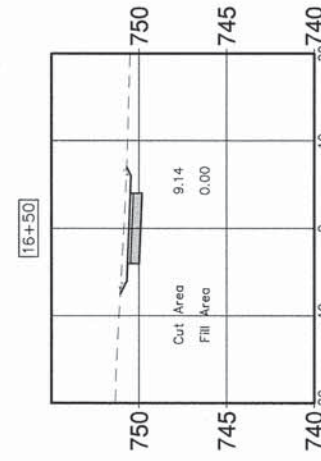
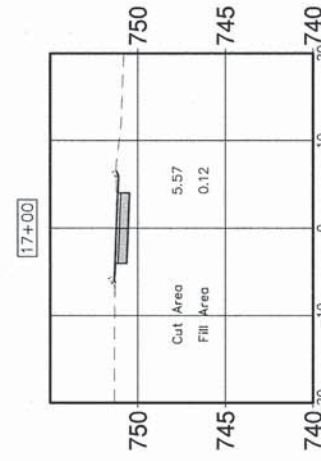
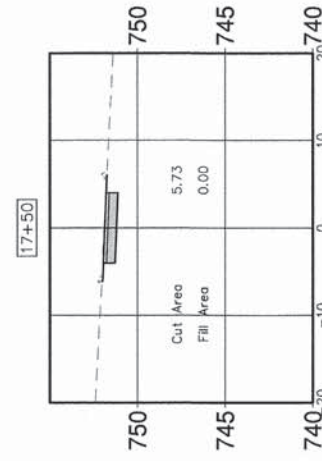
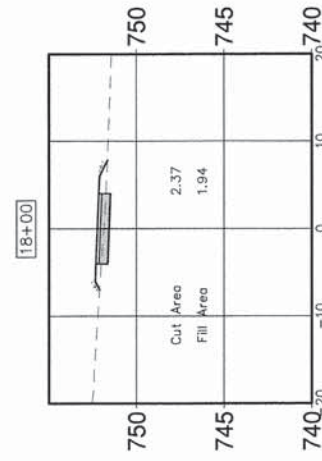
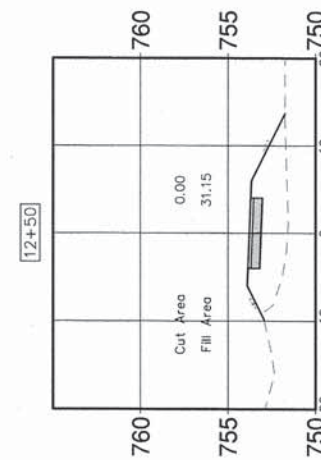
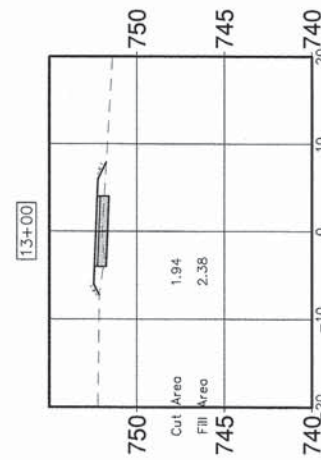
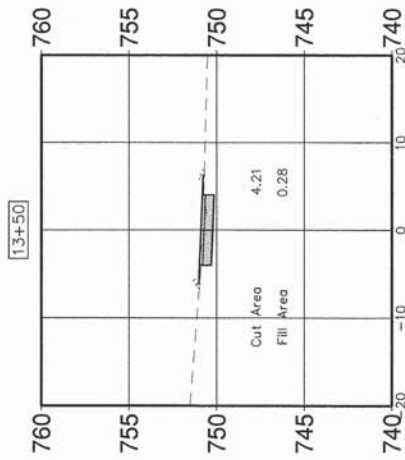
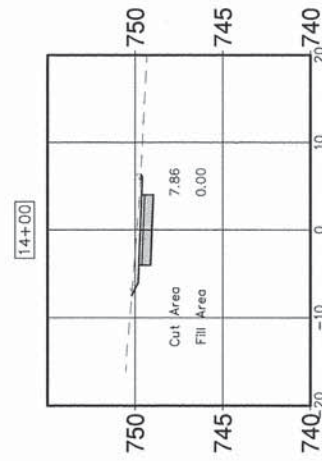
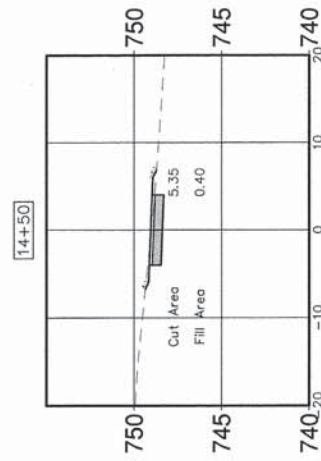
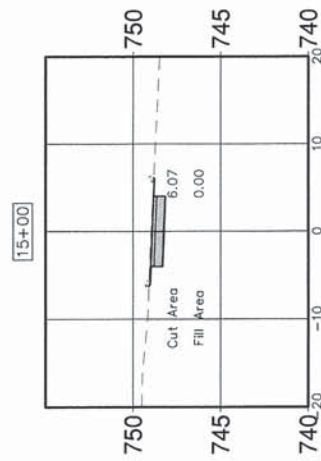

DESIGNED:	JCS	DATE:	
DRAWN:	PC	DATE:	
CHECKED:	JOH	DATE:	
DATE:	JANUARY 16, 2013	DATE:	

DESIGNED:	JCS	DATE:	
DRAWN:	PC	DATE:	
CHECKED:	JOH	DATE:	
DATE:	JANUARY 16, 2013	DATE:	

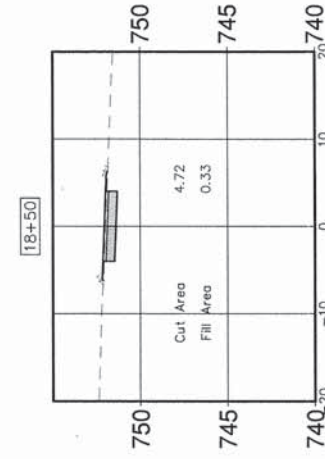
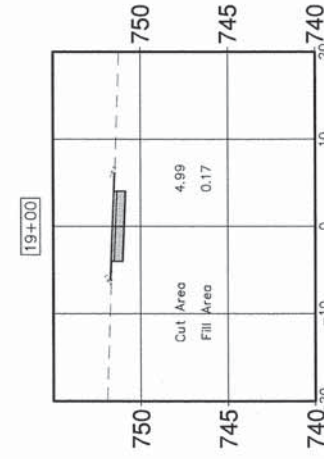
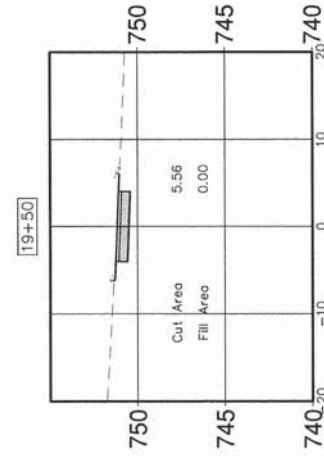
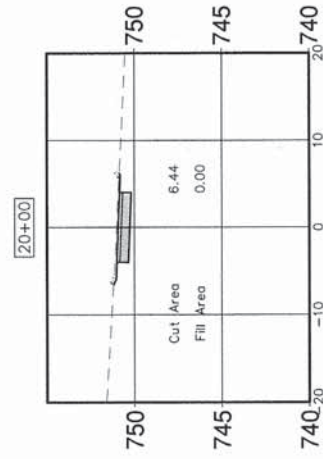
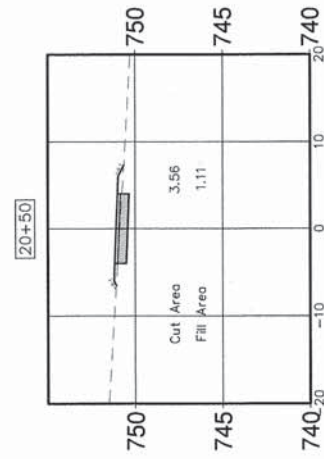
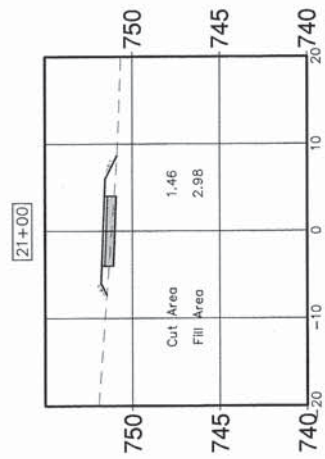
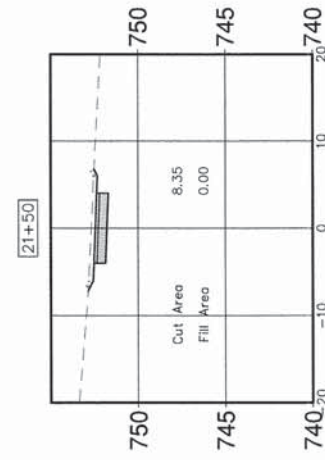
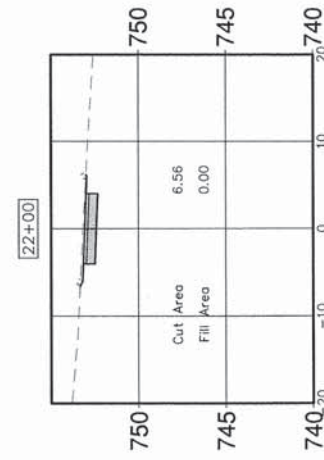
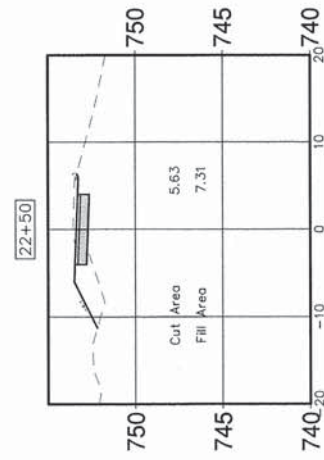
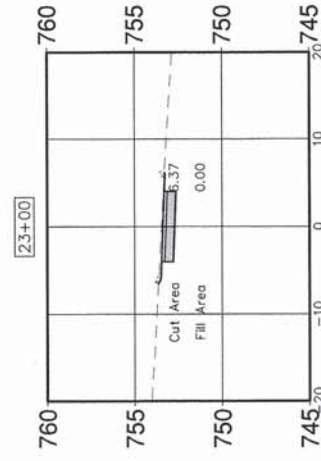
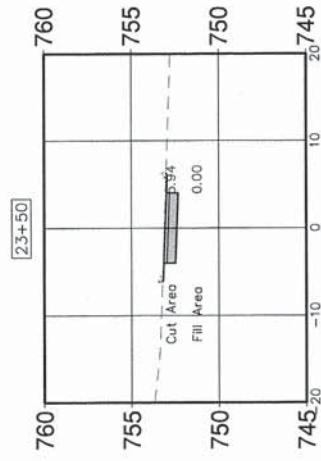
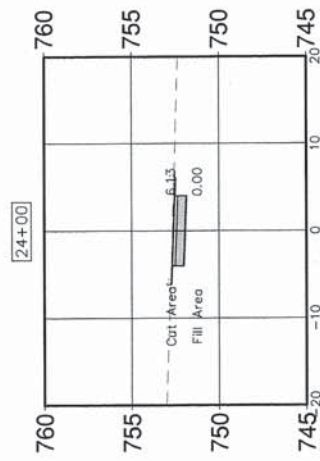

FILE NAME: SH-1218

GERALD L. HEINZ & ASSOCIATES, INC.
CONSULTING ENGINEERS & LAND SURVEYORS
206 NORTH RIVER STREET
EAST DUNDEE, ILLINOIS 60118

USER NAME:

DESIGNED: JCS
DRAWN: PC
CHECKED: JOH
DATE: JANUARY 16, 2013

REVISED:

STATE OF ILLINOIS
DEPARTMENT OF TRANSPORTATION

CROSS SECTIONS

SCALE: 1" = 20'
SHEET NO. 4 OF 7 SHEETS
STA: 0+00 TO STA: 37+10

FAU ROUTE	SECTION	COUNTY	TOTAL SHEETS	SHEET NO.
2509	10-00007-00-BT	KANE	23	20
FED. ROAD DIST. NO.			ILLINOIS	
FED. AID. PROJECT			CONTRACT NO. 63839	

DESIGNED:	SURVEYED:	BY:	DATE:
DRAWN:	PLOTTED:		
CHECKED:	TEMPLATE:		
NO.:	DATE:		
AREAS:	AREAS:		

DESIGNED:	SURVEYED:	BY:	DATE:
DRAWN:	PLOTTED:		
CHECKED:	TEMPLATE:		
NO.:	DATE:		
AREAS:	AREAS:		

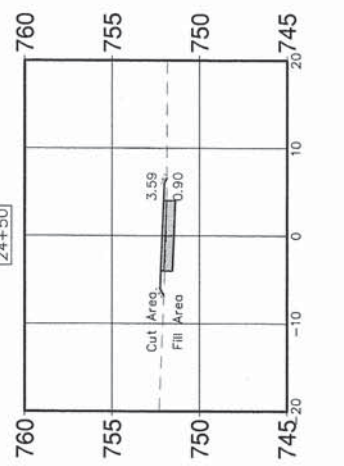
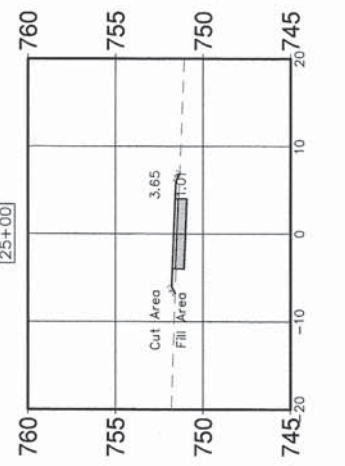
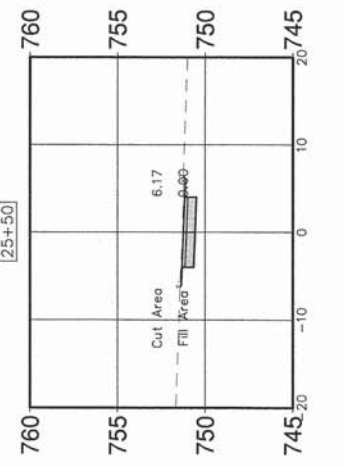
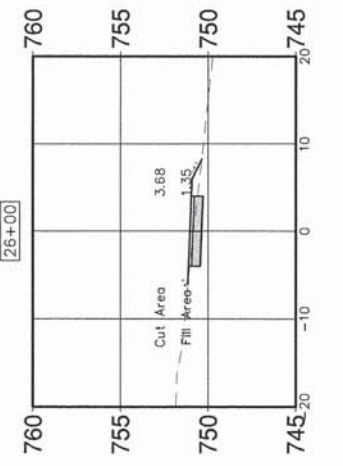
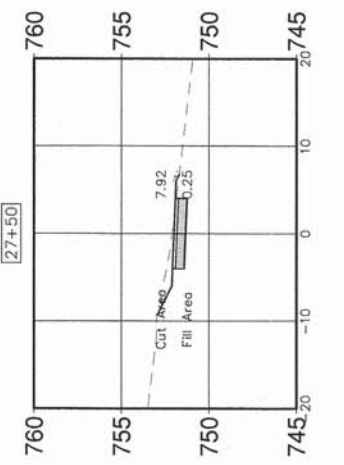
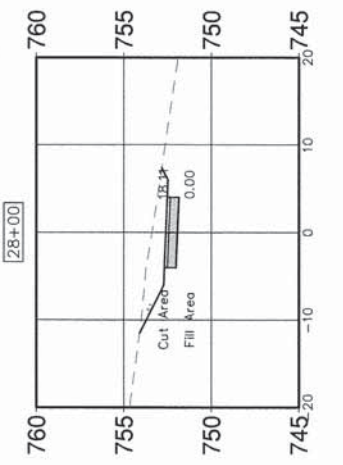
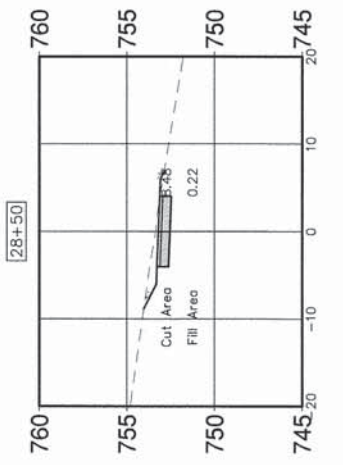
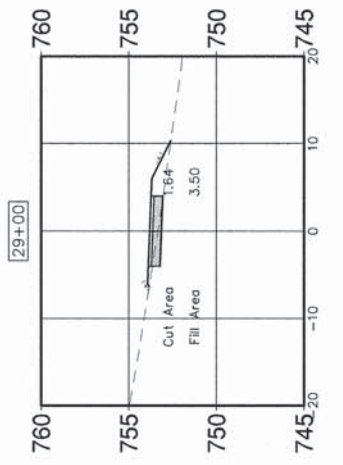
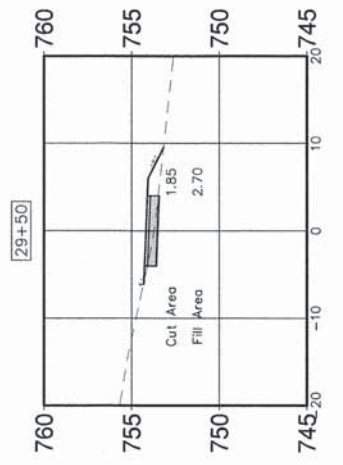

DESIGNED:	SURVEYED:	BY:	DATE:
DRAWN:	PLOTTED:		
CHECKED:	TEMPLATE:		
NOTE BOOK:	DATE:		
NO.:	AREAS:		
	AREAS:		

DESIGNED:	SURVEYED:	BY:	DATE:
DRAWN:	PLOTTED:		
CHECKED:	TEMPLATE:		
NOTE BOOK:	DATE:		
NO.:	AREAS:		
	AREAS:		

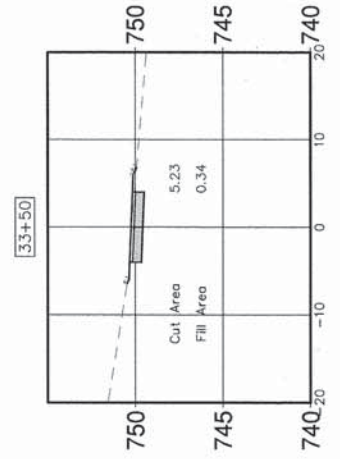
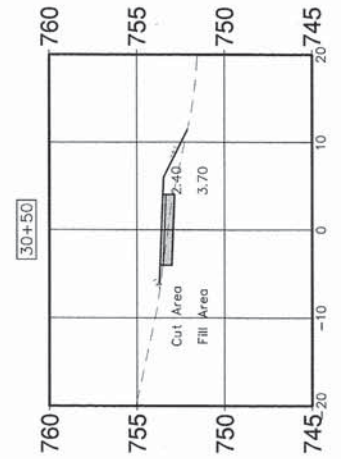
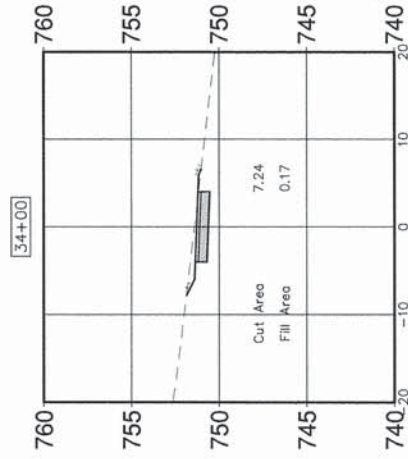
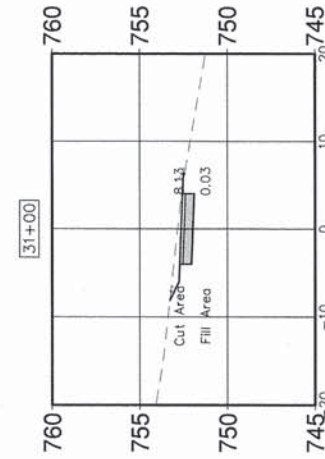
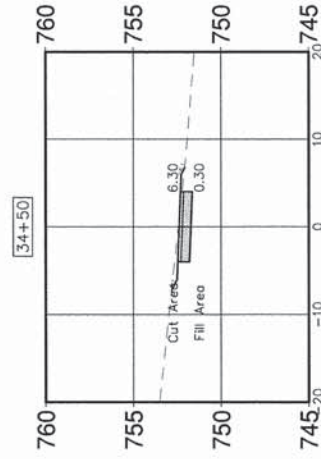
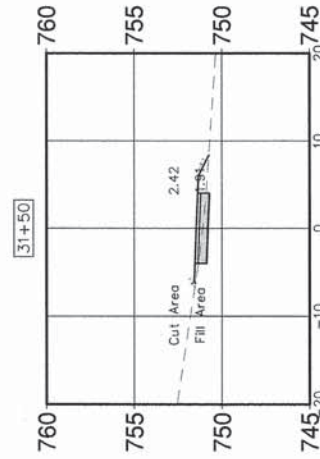
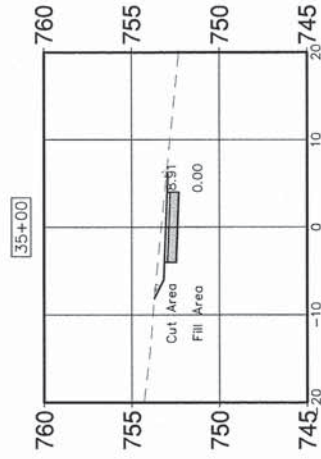
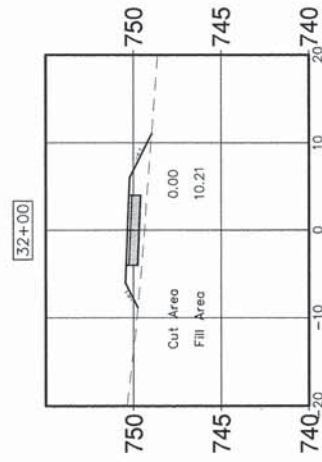
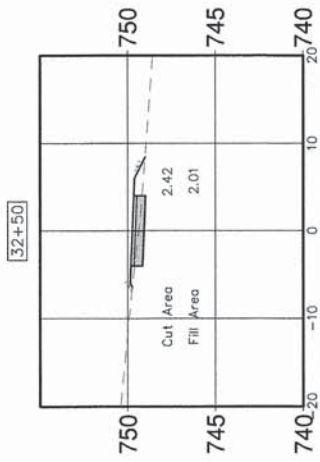
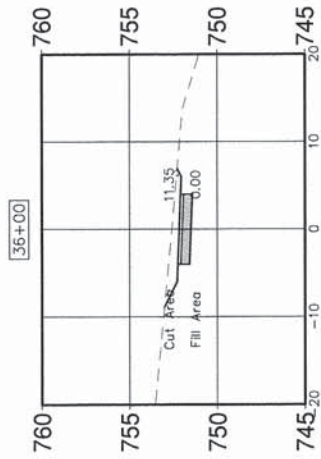
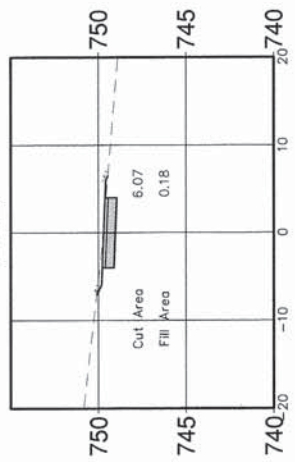

FILE NAME: SH-1218

GERALD L. HEINZ & ASSOCIATES, INC.
CONSULTING ENGINEERS & LAND SURVEYORS
206 NORTH RIVER STREET
EAST DUNDEE, ILLINOIS 60118

USER NAME:
PLOT SCALE: 1" = 20'
PLOT DATE:

DESIGNED: JCS
DRAWN: PC
CHECKED: JDH
DATE: JANUARY 16, 2013

REVISED:
REVISED:
REVISED:
REVISED:

STATE OF ILLINOIS
DEPARTMENT OF TRANSPORTATION

CROSS SECTIONS

SCALE: 1" = 20' SHEET NO. 6 OF 7 SHEETS STA: 0+00 TO STA: 37+10

FAU ROUTE	SECTION	COUNTY	TOTAL SHEETS	SHEET NO.
2509	10-00007-00-BT	KANE	23	22
FED. ROAD DIST. NO.			CONTRACT NO. 63839	
ILLINOIS			FED. AID. PROJECT	

DESIGNED:	SURVEYED:	BY:	DATE:
DRAWN:	PLOTTED:		
CHECKED:	TEMPLATE:		
DATE:	AREAS:		
NO.:	DATE:		

DESIGNED:	SURVEYED:	BY:	DATE:
DRAWN:	PLOTTED:		
CHECKED:	TEMPLATE:		
DATE:	AREAS:		
NO.:	DATE:		

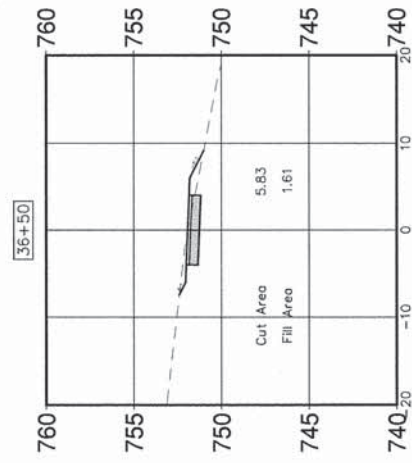
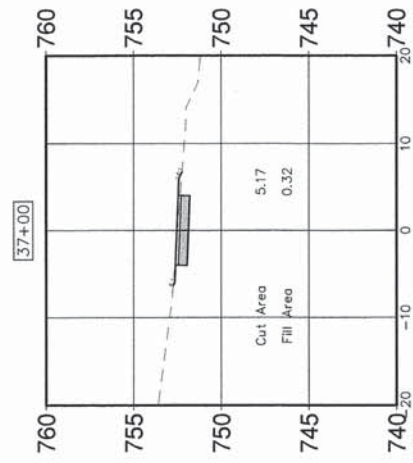

FILE NAME:
SH-1218

GERALD L. HEINZ & ASSOCIATES, INC.
CONSULTING ENGINEERS & LAND SURVEYORS
206 NORTH RIVER STREET
EAST DUNDEE, ILLINOIS 60118

USER NAME:
PLOT SCALE: 1" = 20'
PLOT DATE:

DESIGNED: JCS
DRAWN: PC
CHECKED: JQH
DATE: JANUARY 16, 2013

REVISED:
REVISED:
REVISED:
REVISED:

STATE OF ILLINOIS
DEPARTMENT OF TRANSPORTATION

CROSS SECTIONS

SCALE: 1" = 20' SHEET NO. 7 OF 7 SHEETS STA: 0+00 TO STA: 37+10

ROUTE	SECTION	COUNTY	TOTAL SHEETS	SHEET NO.
2509	10-00007-00-BT	KANE	23	23
FED. ROAD DIST. NO.			CONTRACT NO. 63839	
ILLINOIS			FED. AID. PROJECT	