

08-02-13 LETTING ITEM 040

FOR INDEX OF SHEETS  
SEE SHEET NO. 2

	JACKSON AVENUE
2013 ADT -	1150
POSTED SPEED LIMIT -	25 mph
DESIGN PERIOD -	20 YEARS
DESIGN SPEED LIMIT -	25 mph
STREET CLASSIFICATION -	MAJOR COLLECTOR

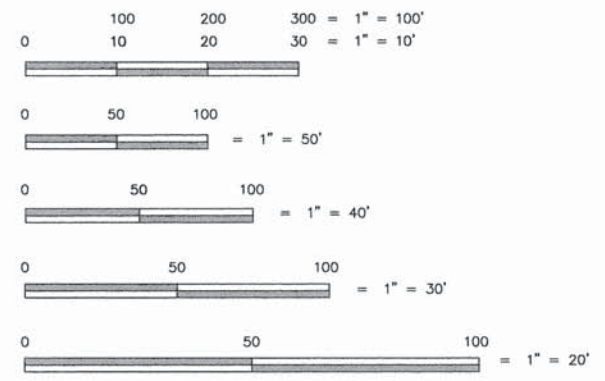

FULL SIZE PLANS HAVE BEEN PREPARED USING STANDARD ENGINEERING SCALES. REDUCED SIZE PLANS WILL NOT CONFORM TO STANDARD SCALES. IN MAKING MEASUREMENTS ON REDUCED SIZE PLANS, THE ABOVE SCALES MAY BE USED.

Call Before You Dig  
**JULIE**  
ILLINOIS ONE-CALL SYSTEM  
Call: 811 OR 1-800-892-0123

JOINT UTILITY LOCATING INFORMATION FOR EXCAVATORS  
48 hours before you dig (EXCLUDING SAT., SUN. & HOL.)

CONTRACT NO. 63844

ILLINOIS PROFESSIONAL DESIGN FIRM NO. 184-002235

**TECH 3** Consulting Group, Inc.

JOB NO. 12307  
ENGINEERS 737 West Exchange St. Crete, IL 60417  
SURVEYORS ph 708.672.4994 fax 708.672.3739

STATE OF ILLINOIS  
DEPARTMENT OF TRANSPORTATION  
DIVISION OF HIGHWAYS

PLANS FOR PROPOSED  
FEDERAL AID HIGHWAY

FAU ROUTE 1082 (JACKSON AVENUE)  
FAU 1633 (SAUK TRAIL) TO FAU 1632 (26 TH STREET)  
ROADWAY RESURFACING  
PROJECT NO.: M4003(184)  
L.A. SECTION NO.: 13-00062-00-RS  
VILLAGE OF SOUTH CHICAGO HEIGHTS  
COOK COUNTY  
C-91-246-13

R 14 E 3RD PRINCIPAL MERIDIAN

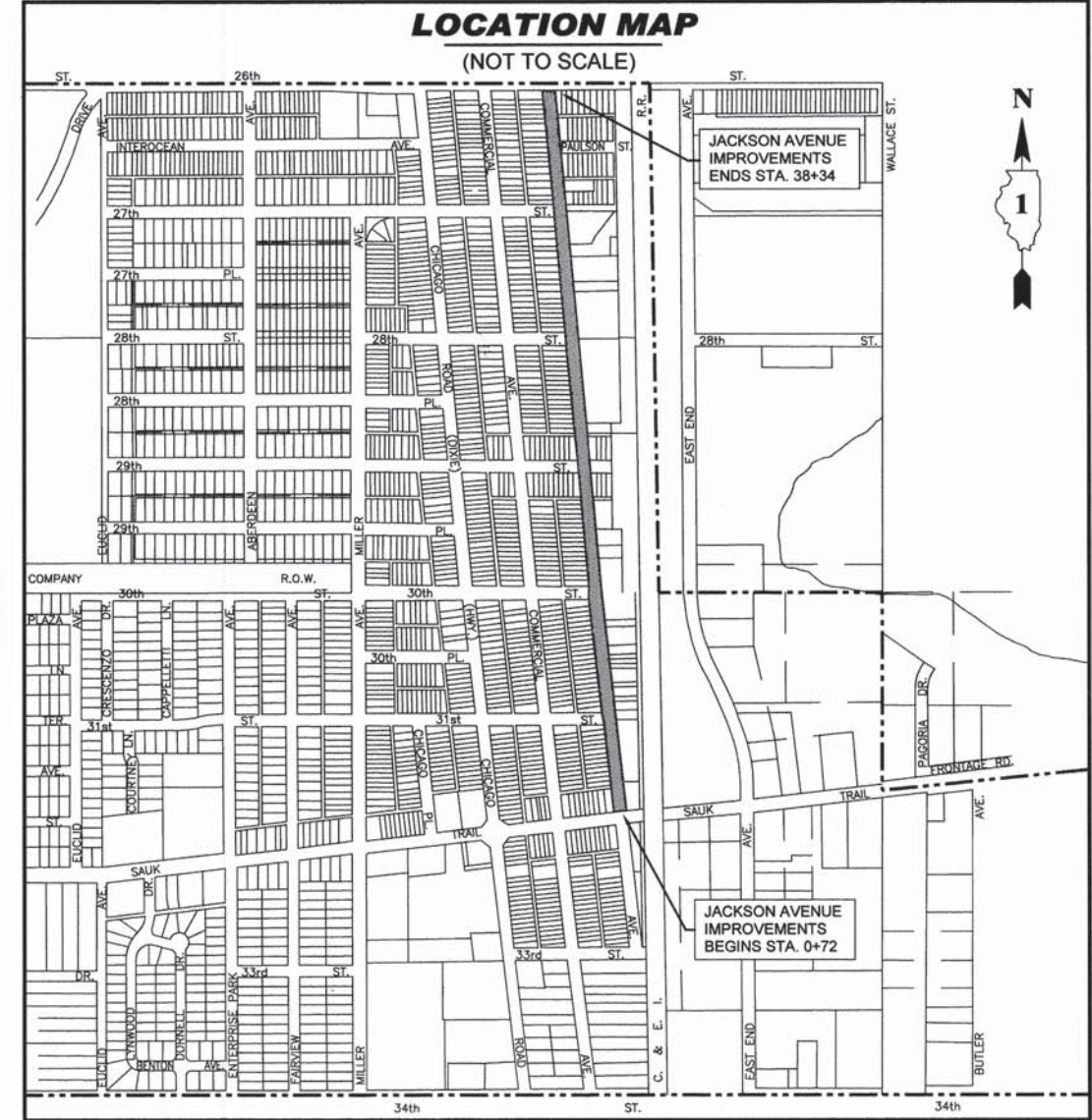

GROSS AND NET LENGTH OF IMPROVEMENT = 3,762 LINEAL FEET OR 0.71 MILES

F.A.U. RTE.	SECTION	COUNTY	TOTAL SHEETS	SHEET NO.
1082	13-00062-00-RS	COOK	19	1
FED. ROAD DIST. NO. 1 ILLINOIS		CONTRACT NO. 63844		

CONTRACT # 63844

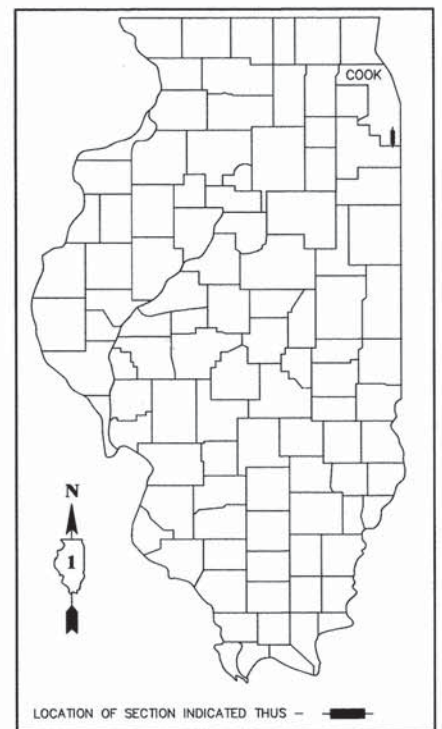

STATE OF ILLINOIS  
DEPARTMENT OF TRANSPORTATION  
DIVISION OF HIGHWAYS

APPROVED MAY 22 20 13  
*Quinn L. Owsen*  
PRESIDENT, VILLAGE OF SOUTH CHICAGO HEIGHTS

PASSED MAY 31 20 13  
*C. J. Holt*  
DISTRICT 1 ENGINEER OF LOCAL ROADS AND STREETS

RELEASED FOR BID  
BASED ON LIMITED  
REVIEW May 31 20 13  
*J. H. Feltner*  
DEPUTY DIRECTOR OF HIGHWAYS, REGION 1 ENGINEER

*Robert W. Matthey*  
ROBERT W. MATTHEY, P.E.  
LICENSE NO. 062 - 39765  
LICENSE EXPIRES: 11/30/13  
TECH 3 CONSULTING GROUP, INC.

PRINTED BY THE AUTHORITY  
OF THE STATE OF ILLINOIS

PROGRAM AND OFFICE ENGINEER: CHARLES F. RIDDLE, P.E. (847) 705-4406 SCHAUMBURG, IL

SHEET NO.	INDEX OF SHEETS DESCRIPTION
1.	COVER SHEET
2.	INDEX OF SHEETS, HIGHWAY STANDARDS & GENERAL NOTES
3.	SUMMARY OF QUANTITIES
4.	TYPICAL SECTIONS
5.-8.	PAVEMENT PLAN - STA. 0+72 TO 38+34
9.	26TH STREET SIDEWALK DETAIL PLAN
10.-13.	PAVEMENT MARKING PLAN - STA. 0+72 TO 38+34
14.	DETAILS FOR FRAMES AND LIDS ADJUSTMENT WITH MILLING (BD-08)
15.	PAVEMENT PATCHING FOR HMA SURFACED PAVEMENT (BD-22)
16.	CURB OR CURB AND GUTTER REMOVAL AND REPLACEMENT (BD-24)
17.	BUTT JOINT AND HMA TAPER DETAILS (BD-32)
18.	TRAFFIC CONTROL AND PROTECTION FOR SIDE ROADS, INTERSECTIONS AND DRIVEWAYS (TC-10)
19.	DISTRICT ONE TYPICAL PAVEMENT MARKINGS (TC-13)

INDEX OF STATE STANDARDS	
000001-06	STANDARD SYMBOLS, ABBREVIATIONS AND PATTERNS
424001-07	PERPENDICULAR CURB RAMPS FOR SIDEWALKS
442201-03	CLASS C AND D PATCHES
606001-05	CONCRETE CURB TYPE B AND COMBINATION CONCRETE CURB AND GUTTER
701301-04	LANE CLOSURE, 2L, 2W, SHORT TIME OPERATIONS
701501-06	URBAN LANE CLOSURE, 2L, 2W, UNDIVIDED
701606-08	URBAN LANE CLOSURE, MULTILANE, 2W, WITH MOUNTABLE MEDIAN
701801-05	SIDEWALK, CORNER OR CROSSWALK CLOSURE
701901-02	TRAFFIC CONTROL DEVICES

**GENERAL NOTES**

- BEFORE STARTING ANY EXCAVATION THE CONTRACTOR SHALL CALL "J.U.L.I.E." AT (800) 892-0123 OR 811 AND (312) 744-7000 FOR FIELD LOCATIONS OF BURIED ELECTRIC, TELEPHONE AND GAS UTILITIES. (48 HOUR NOTIFICATION REQUIRED).
  - UTILITIES INDICATED ON THE PLANS ARE PROVIDED FOR THE CONTRACTOR'S USE AND ARE BASED UPON INFORMATION AVAILABLE AT THE TIME OF THE ADVERTISEMENT FOR BIDS. THE OWNER AND ENGINEER DO NOT GUARANTEE THE ACCURACY OF UTILITY INFORMATION.
  - IT SHALL BE THE CONTRACTOR'S RESPONSIBILITY TO VERIFY ALL DIMENSIONS AND CONDITIONS EXISTING IN THE FIELD PRIOR TO CONSTRUCTION AND ORDERING OF MATERIALS.
  - THE THICKNESS OF HMA MIXTURE STATED IN THE SPECIFICATIONS IS THE NORMAL THICKNESS. DEVIATIONS FROM THE NOMINAL THICKNESS WILL BE PERMITTED WHEN SUCH DEVIATIONS OCCUR DUE TO IRREGULARITIES IN THE EXISTING SURFACE OR BASE ON WHICH THE HMA SURFACE IS PLACED.
5. THE REMOVAL AND/OR REPLACEMENT ON ANY DRIVEWAYS, PAVEMENT, CURB SIDEWALK, ETC. SHALL BE ACCOMPLISHED BY MEANS OF A SAW CUT JOINT, AT THE DIRECTION OF THE ENGINEER. THIS WORK WILL NOT BE PAID FOR SEPARATELY, BUT SHALL BE INCLUDED IN THE UNIT PRICE FOR THE VARIOUS ITEMS.
6. ANY LOOSE MATERIAL DEPOSITED IN THE FLOW LINE OF DITCHES, GUTTERS OR OTHER DRAINAGE STRUCTURES SHALL BE REMOVED BY THE END OF EACH DAY BY THE CONTRACTOR AT THEIR EXPENSE.
7. THE CONTRACTOR SHALL COORDINATE CONSTRUCTION ACTIVITIES WITH UTILITY COMPANIES AND THE VILLAGE OF SOUTH CHICAGO HEIGHTS.
- BUTT JOINTS WILL BE INSTALLED AT THE ENDS OF ALL RESURFACING (WHERE RESURFACING MEETS EXISTING PAVEMENT) IN ACCORDANCE WITH THE "BUTT JOINT AND HMA TAPER DETAILS" SHEET INCLUDED IN PLANS, UNLESS OTHERWISE SPECIFIED.
  - ALL EXISTING ROADWAY PAVEMENT REMOVED DUE TO THE REMOVAL AND REPLACEMENT OF COMBINATION CURB AND GUTTER SHALL BE REPLACED WITH A PATCH CONSISTING OF HMA BINDER WITH A MINIMUM DEPTH OF FIVE INCHES (5") TO A POINT NOT LESS THAN TWO AND A QUARTER INCHES (2 1/4") BELOW THE EDGE OF PAVEMENT. THE HMA PATCHING SHALL BE PAID FOR AT THE CONTRACT UNIT PRICE BID PER FOOT OF "COMBINATION CONCRETE CURB AND GUTTER REMOVAL AND REPLACEMENT".

**SUMMARY OF QUANTITIES**

S. I.	PAY ITEM CODE #	DESCRIPTION	UNIT	QUANTITY	CONSTRUCTION TYPE CODE 0005
	20800150	TRENCH BACKFILL	CU. YD.	10	10
	21101615	TOPSOIL FURNISH AND PLACE 4"	SQ. YD.	140	140
	25200110	SODDING, SALT TOLERANT	SQ. YD.	140	140
	40600100	BITUMINOUS MATERIALS (PRIME COAT)	GALLON	1,173	1,173
	40600300	AGGREGATE (PRIME COAT)	TON	18	18
	40600400	MIXTURE FOR CRACKS, JOINTS, AND FLANGEWAYS	TON	9	9
	40600827	POLYMERIZED LEVELING BINDER (MACHINE METHOD), IL-4.75, N50	TON	493	493
	40600982	HOT-MIX ASPHALT SURFACE REMOVAL - BUTT JOINT	SQ. YD.	138	138
	40603335	HOT-MIX ASPHALT SURFACE COURSE, MIX "D", N50	TON	985	985
	42300400	PORTLAND CEMENT CONCRETE DRIVEWAY PAVEMENT, 8 INCH	SQ. YD.	7	7
	42400200	PORTLAND CEMENT CONCRETE SIDEWALK 5 INCH	SQ. FT.	1380	1380
	42400800	DETECTABLE WARNINGS	SQ. FT.	180	180
	44000157	HOT-MIX ASPHALT SURFACE REMOVAL, 2"	SQ. YD.	11,725	11,725
	44000200	DRIVEWAY PAVEMENT REMOVAL	SQ. YD.	220	220
	44000600	SIDEWALK REMOVAL	SQ. FT.	1270	1270
	44201705	CLASS D PATCHES, TYPE II , 5 INCH	SQ. YD.	25	25
	44201709	CLASS D PATCHES, TYPE III , 5 INCH	SQ. YD.	50	50
	44201711	CLASS D PATCHES, TYPE IV , 5 INCH	SQ. YD.	1400	1400
	550A2310	STORM SEWERS, RUBBER GASKET, CLASS A, TYPE 1 10"	FOOT	21	21
	60206905	CATCH BASINS, TYPE C, TYPE 1 FRAME, OPEN LID	EACH	1	1

\* INDICATES SPECIALTY ITEMS (S.I.)

**SUMMARY OF QUANTITIES**

S. I.	PAY ITEM CODE #	DESCRIPTION	UNIT	QUANTITY	CONSTRUCTION TYPE CODE 0005
	60250200	CATCH BASINS TO BE ADJUSTED	EACH	13	13
	60252800	CATCH BASINS TO BE RECONSTRUCTED	EACH	1	1
	60255500	MANHOLES TO BE ADJUSTED	EACH	2	2
	60255800	MANHOLES TO BE ADJUSTED WITH NEW TYPE 1 FRAME, CLOSED LID	EACH	1	1
	60266100	VALVE VAULTS TO BE RECONSTRUCTED	EACH	1	1
	67100100	MOBILIZATION	L SUM	1	1
	70102620	TRAFFIC CONTROL AND PROTECTION, STANDARD 701501	L SUM	1	1
	70102625	TRAFFIC CONTROL AND PROTECTION, STANDARD 701606	L SUM	1	1
	70102640	TRAFFIC CONTROL AND PROTECTION, STANDARD 701801	L SUM	1	1
	* 78000400	THERMOPLASTIC PAVEMENT MARKING - LINE 6"	FOOT	338	338
	* 78000650	THERMOPLASTIC PAVEMENT MARKING - LINE 24"	FOOT	102	102
	* 78001180	PAINT PAVEMENT MARKING - LINE 24"	FOOT	13	13
	X6030310	FRAMES AND LIDS TO BE ADJUSTED (SPECIAL)	EACH	11	11
	Z0004522	HOT-MIX ASPHALT DRIVEWAY PAVEMENT, 6"	SQ.YD.	215	215
	Z0004562	COMBINATION CONCRETE CURB AND GUTTER REMOVAL AND REPLACEMENT	FOOT	1076	1076

\* INDICATES SPECIALTY ITEMS (S.I.)

**TECH 3** Consulting Group, Inc.  
 ENGINEERS SURVEYORS  
 737 West Exchange St. Suite. IL 60417  
 PH: 708.672.4994 FAX: 708.672.3738  
 ILLINOIS PROFESSIONAL DESIGN FIRM NO. 184-002235

USER NAME =	DESIGNED - PJC	REVISED - 5/03/2013 PER IDOT
PLOT SCALE =	DRAWN - EGH	REVISED - 5/22/13 PER IDOT
PLOT DATE =	CHECKED - WJS	REVISED -
	DATE -	REVISED -

**STATE OF ILLINOIS  
 DEPARTMENT OF TRANSPORTATION**

 **VILLAGE of SOUTH CHICAGO HEIGHTS**  
 3317 CHICAGO ROAD  
 COOK COUNTY, ILLINOIS

**JACKSON AVENUE RESURFACING  
 SAUK TRAIL TO 26th STREET  
 SUMMARY OF QUANTITIES**

F.A.U. RTE. 1082	SECTION 13-00062-00-RS	COUNTY COOK	TOTAL SHEETS 19	SHEET NO. 3
SCALE: NONE		SHEET NO. 3 OF 19 SHEETS		STA. - TO STA. -
FED. ROAD DIST. NO. 1		ILLINOIS		FED. AID PROJECT:

CONTRACT NO. 63844

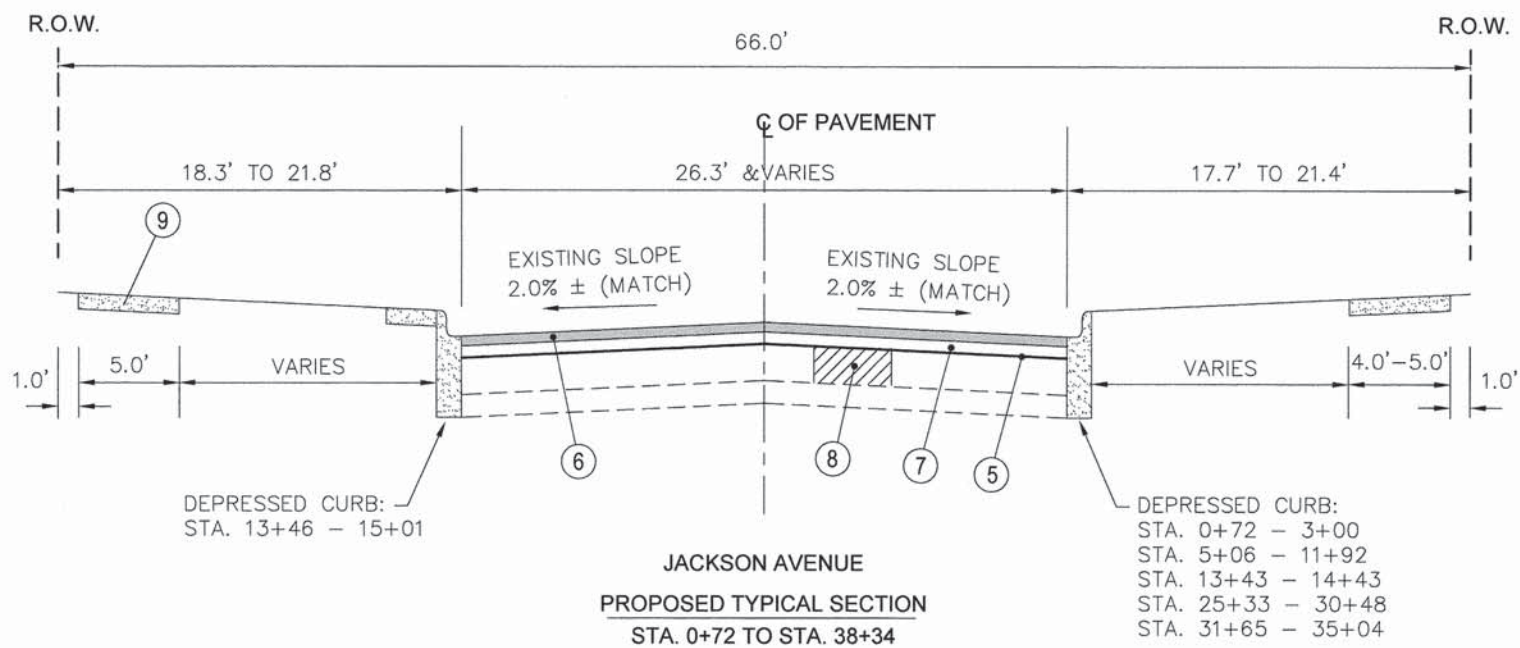
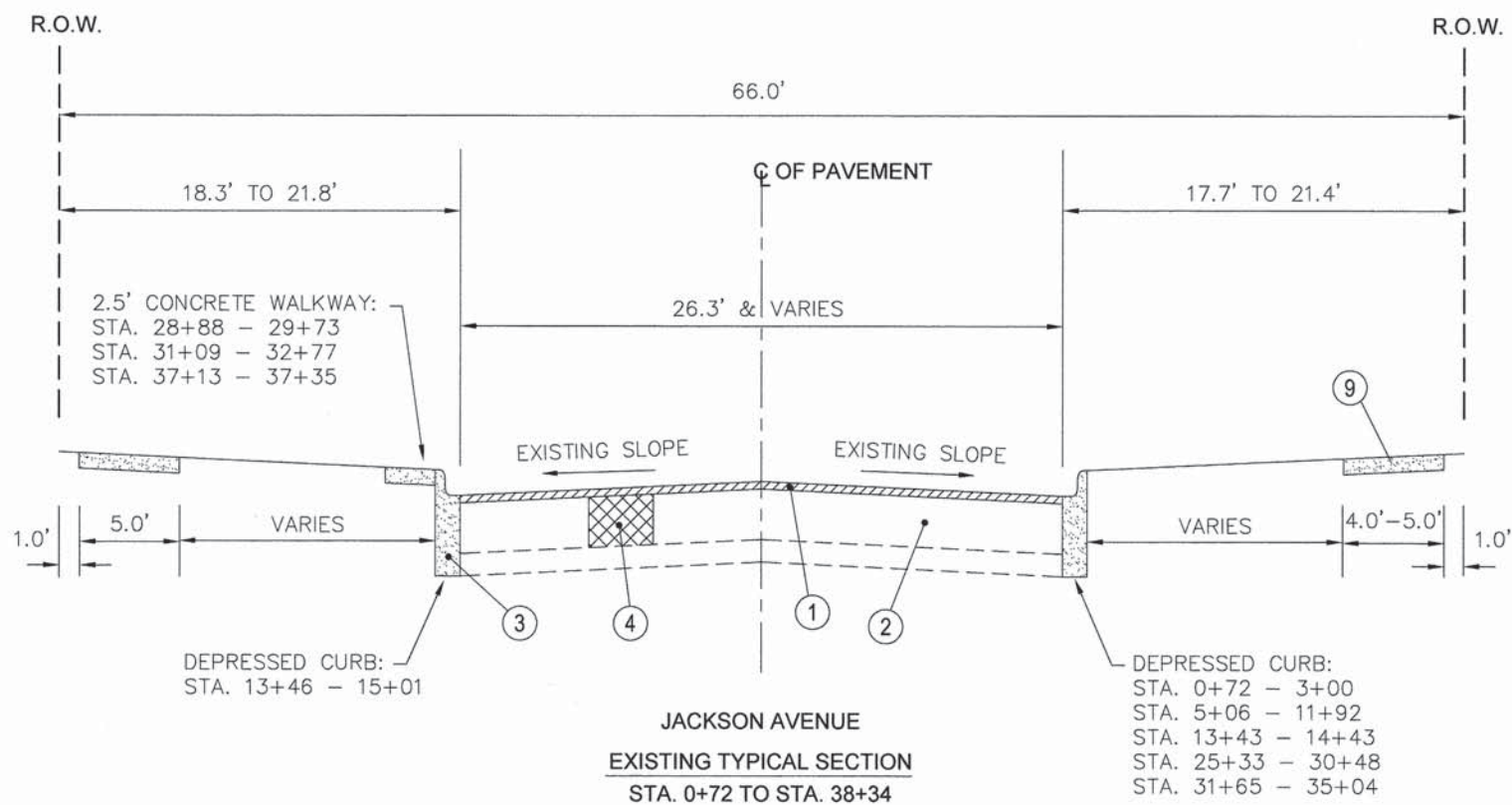

**TYPICAL SECTION**

(NOT TO SCALE)

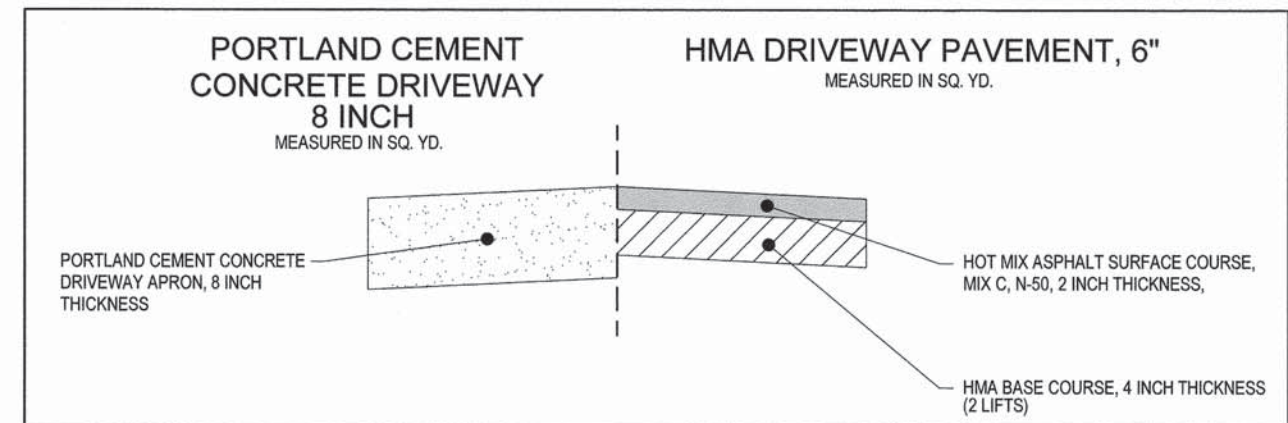

- LEGEND**
- ① EXISTING HOT-MIX ASPHALT SURFACE REMOVAL, 2"
  - ② EXISTING PAVEMENT
  - ③ EXISTING CONCRETE CURB & GUTTER TO BE REMOVED AT LOCATIONS ON THE PLANS OR DIRECTED BY THE ENGINEER
  - ④ PAVEMENT REMOVAL FOR CLASS 'D' PATCHES AT LOCATIONS ON THE PLANS OR DIRECTED BY THE ENGINEER
  - ⑤ BITUMINOUS MATERIALS (PRIME COAT) (0.10 GAL./S.Y.)
  - ⑥ HOT MIX ASPHALT SURFACE COURSE, MIX "D", N50, 1 1/2"
  - ⑦ POLYMERIZED LEVELING BINDER (MACHINE METHOD), IL-4.75, N50, 3/4"
  - ⑧ CLASS D PATCHES, 5" (TO BE DELINEATED IN FIELD BY ENGINEER)
  - ⑨ EXISTING P.C.C. SIDEWALK, BITUMINOUS PAVEMENT & GROUND (VARIES)

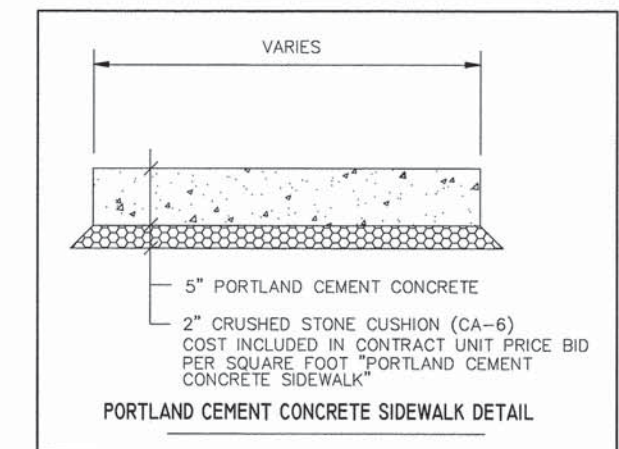

NOTE: CONTRACTOR SHALL MILL BEFORE PATCHING

HOT-MIX ASPHALT MIXTURE REQUIREMENTS	
MIXTURE TYPE	AIR VOIDS (%)
<b>PAVEMENT RESURFACING:</b>	
HOT-MIX ASPHALT SURFACE COURSE, MIX "D", N50, (IL 9.5mm) 1 1/2"	4% @ 50 GYR.
POLYMERIZED LEVELING BINDER (MACHINE METHOD), IL-4.75, N50 3/4"	3.5% @ 50 GYR.
<b>PATCHING</b>	
CLASS 'D' PATCHES TYPE II, III, OR IV - HOT-MIX ASPHALT BINDER IL-19mm - 5" (2 LIFTS)	4% @ 70 GYR.
<b>DRIVEWAYS</b>	
HOT-MIX ASPHALT SURFACE COURSE, MIX "C", N50, (IL 9.5 mm) 2"	4% @ 50 GYR.
HOT-MIX ASPHALT BASE COURSE, IL-19.0, N50, (2 LIFTS) 4"	4% @ 50 GYR.

NOTES:  
THE UNIT WEIGHT USED TO CALCULATE ALL HMA SURFACE MIXTURE QUANTITIES IS 112 LBS/SQ. YD./IN. FOR "AC TYPE" AND "PERCENT RAP" SEE DISTRICT ONE SPECIAL PROVISIONS.

THE "AC TYPE" FOR POLYMERIZED HMA MIXES SHALL BE "SBS/SBR PG 76-28/-22" AND FOR NON-POLYMERIZED HMA THE "AC TYPE" SHALL BE "PG 64-22" UNLESS MODIFIED BY DISTRICT ONE SPECIAL PROVISIONS. FOR "PERCENT OF RAP" SEE DISTRICT ONE SPECIAL PROVISIONS.

CLASS D PATCHES, TYPE II, III, AND IV AT APPROXIMATE STATIONS AS SHOWN ON THE PLANS OR AS DIRECTED BY THE ENGINEER.

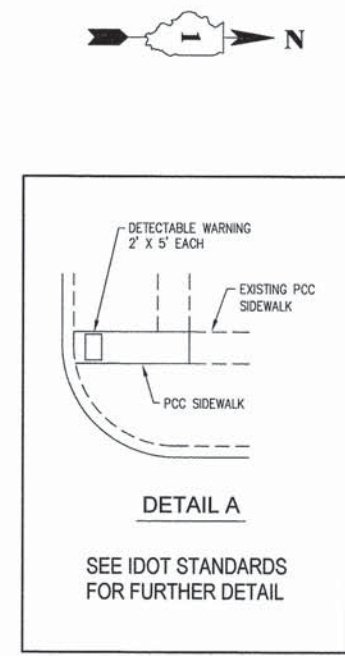
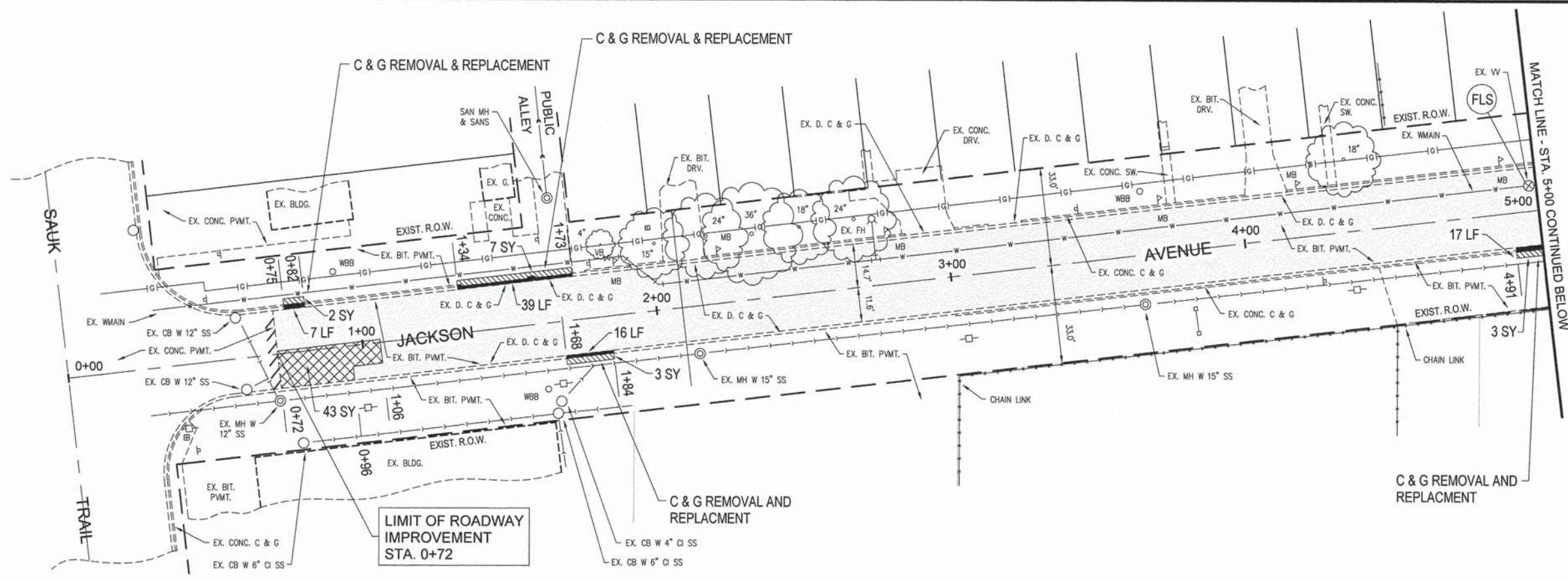

LIMIT OF RESURFACING  
41' LT.

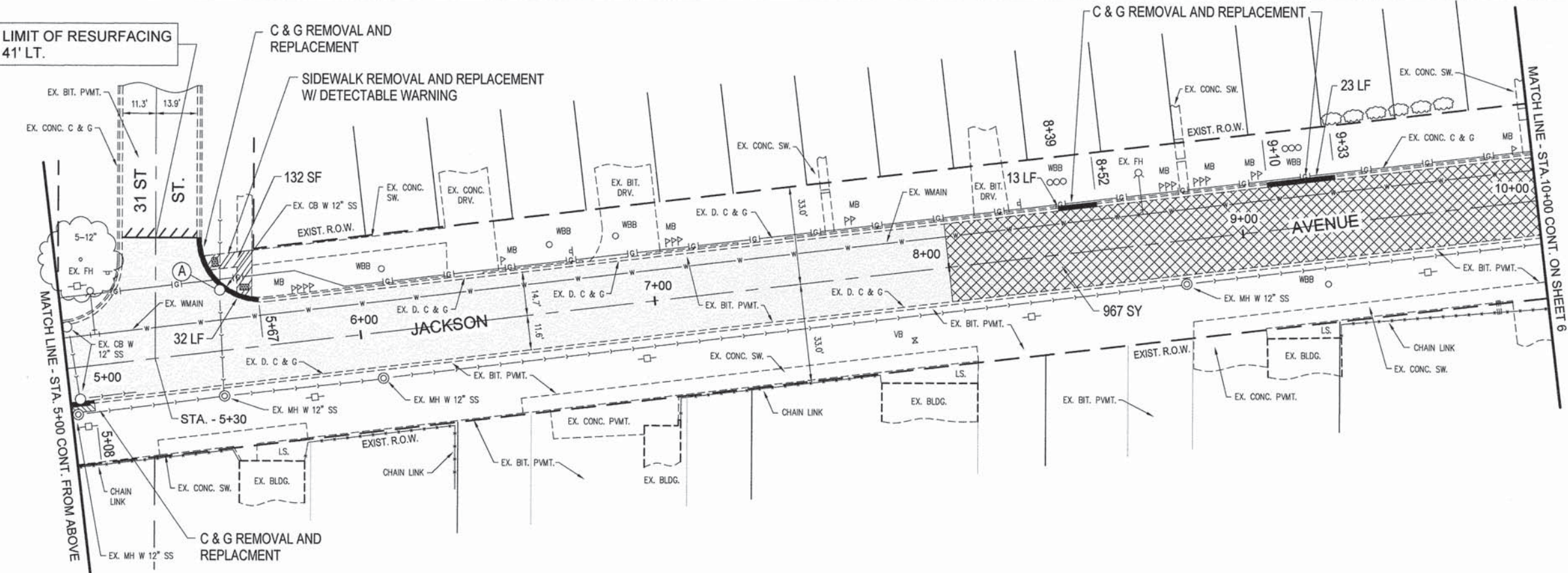

PAVEMENT PLAN LEGEND	
	COMBINATION CONCRETE CURB AND GUTTER REMOVAL AND REPLACEMENT
	APPROXIMATE LOCATIONS OF CLASS "D" PATCHES, TYPE I, II, III, OR IV, 5 INCH
	HMA DRIVEWAY PAVEMENT REMOVAL AND REPLACEMENT
	CONCRETE DRIVEWAY PAVEMENT REMOVAL AND REPLACEMENT
	DETECTABLE WARNINGS
	SIDEWALK REMOVAL AND REPLACEMENT
	HOT MIX ASPHALT SURFACE COURSE, MIX "D", N50, (I/L 9.5mm) 1 1/2"
	BUTT JOINTS
A	CATCH BASINS TO BE ADJUSTED - MANHOLES TO BE ADJUSTED
FLS	FRAMES & LIDS TO BE ADJUSTED (SPECIAL)
R	CATCH BASINS TO BE RECONSTRUCTED - VALVE VAULTS TO BE RECONSTRUCTED

**TECH 3 Consulting Group, Inc.**  
ENGINEERS SURVEYORS  
737 West Exchange St., Chicago, IL 60611  
ph 708.672.4954 fax 708.672.3739  
ILLINOIS PROFESSIONAL DESIGN FIRM NO. 194-002235

USER NAME =	DESIGNED - PJC	REVISED - 5/03/2013 PER IDOT
PLOT SCALE =	DRAWN - EGH	REVISED - 5/22/13 PER IDOT
PLOT DATE =	CHECKED - WJS	REVISED -
	DATE -	REVISED -

**STATE OF ILLINOIS**  
**DEPARTMENT OF TRANSPORTATION**

**VILLAGE of SOUTH CHICAGO HEIGHTS**  
3317 CHICAGO ROAD  
COOK COUNTY, ILLINOIS

**JACKSON AVENUE RESURFACING**  
SAUK TRAIL TO 26th STREET  
PAVEMENT PLAN - STA. 0+72 TO 10+00

F. A. U. RTE.	SECTION	COUNTY	TOTAL SHEETS	SHEET NO.
1082	13-00062-00-RS	COOK	19	5
		CONTRACT NO. 63844		
		FED. ROAD DIST. NO. 1	ILLINOIS	FED. AID PROJECT:

SCALE: 1" = 20' SHEET NO. 5 OF 19 SHEETS STA. 0+72 TO STA. 10+00

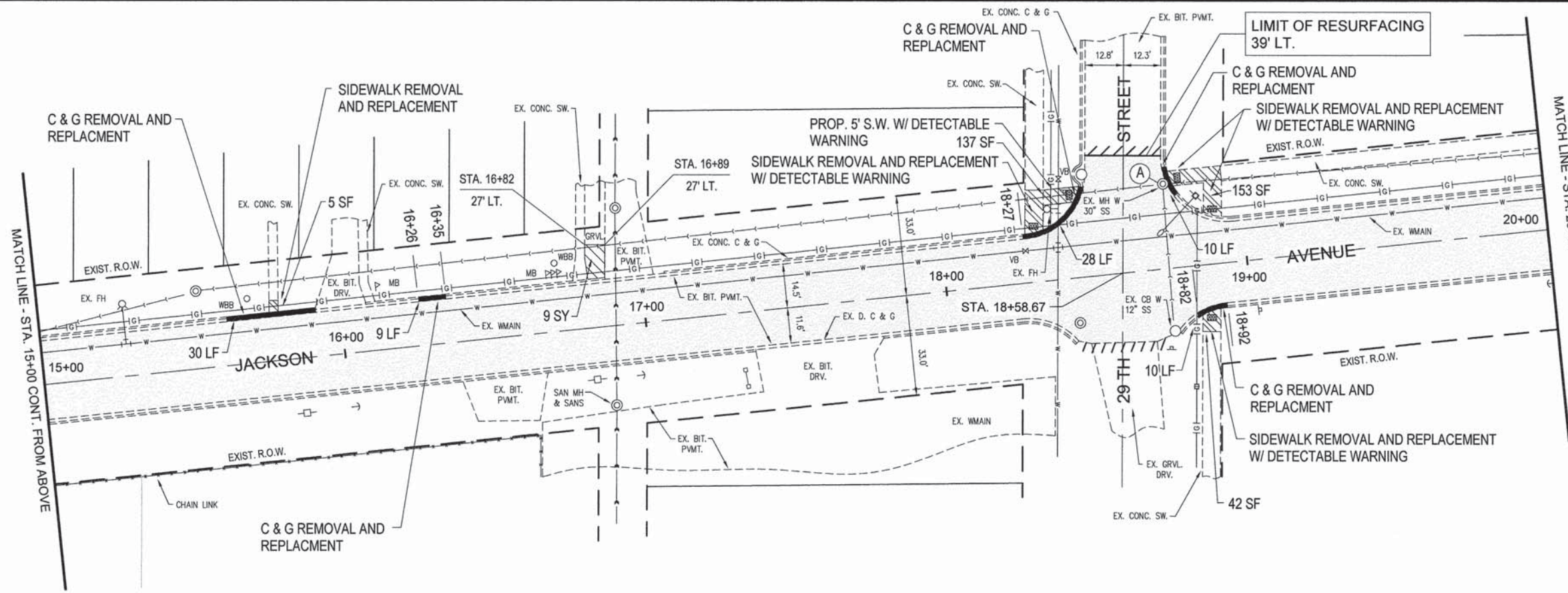
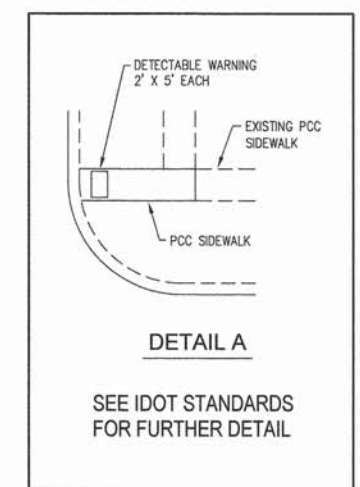
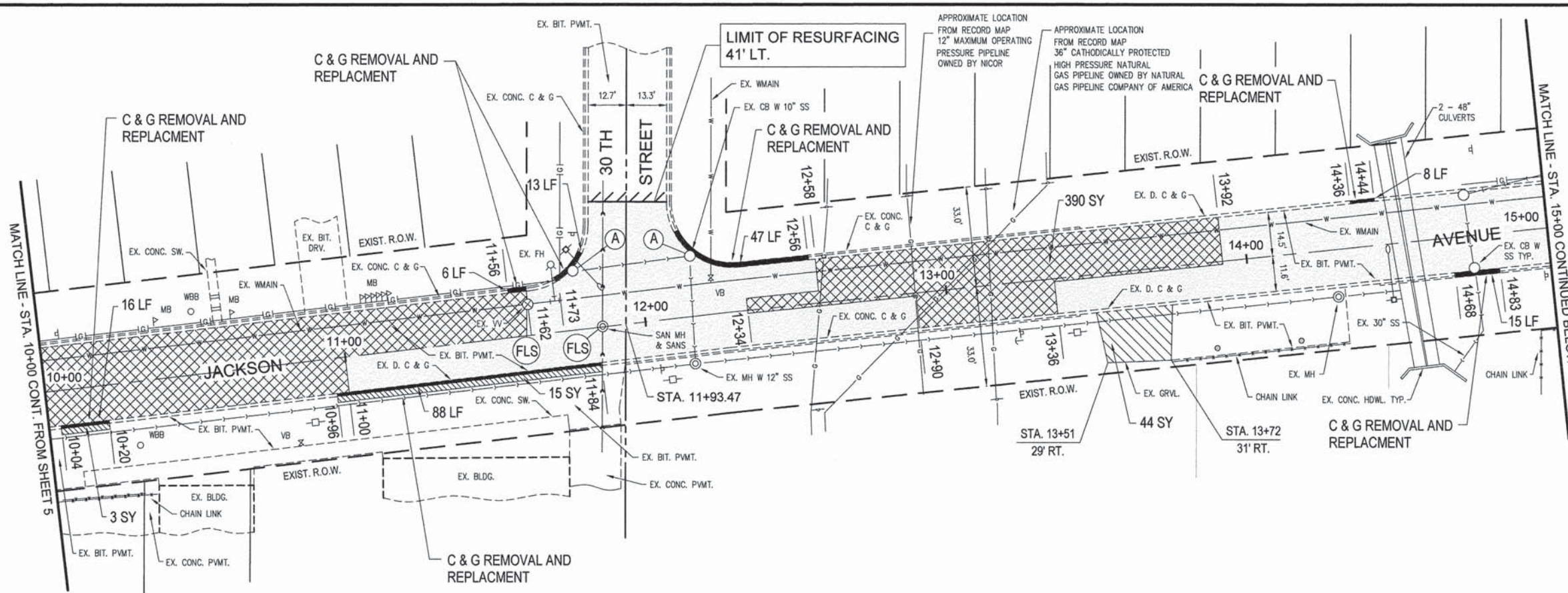

PAVEMENT PLAN LEGEND	
	COMBINATION CONCRETE CURB AND GUTTER REMOVAL AND REPLACEMENT
	APPROXIMATE LOCATIONS OF CLASS "D" PATCHES, TYPE I, II, III, OR IV, 5 INCH
	HMA DRIVEWAY PAVEMENT REMOVAL AND REPLACEMENT
	CONCRETE DRIVEWAY PAVEMENT REMOVAL AND REPLACEMENT
	DETECTABLE WARNINGS
	SIDEWALK REMOVAL AND REPLACEMENT
	HOT MIX ASPHALT SURFACE COURSE, MIX "D", N50, (I.L. 9.5mm) 1 1/2"
	BUTT JOINTS
A	CATCH BASINS TO BE ADJUSTED - MANHOLES TO BE ADJUSTED
FLS	FRAMES & LIDS TO BE ADJUSTED (SPECIAL)
R	CATCH BASINS TO BE RECONSTRUCTED - VALVE VAULTS TO BE RECONSTRUCTED

**TECH 3 Consulting Group, Inc.**  
 ENGINEERS SURVEYORS  
 737 West Exchange St. Orem, IL 60417  
 ph 708.672.4994 fax 708.672.3739  
 ILLINOIS PROFESSIONAL DESIGN FIRM NO. 184-022235

USER NAME =	DESIGNED - PJC	REVISED - 5/03/2013 PER IDOT
PLOT SCALE =	DRAWN - EGH	REVISED - 5/22/13 PER IDOT
PLOT DATE =	CHECKED - WJS	REVISED -
	DATE -	REVISED -

**STATE OF ILLINOIS**  
**DEPARTMENT OF TRANSPORTATION**

**VILLAGE of SOUTH CHICAGO HEIGHTS**  
 3317 CHICAGO ROAD  
 COOK COUNTY, ILLINOIS

**JACKSON AVENUE RESURFACING**  
**SAUK TRAIL TO 26th STREET**  
**PAVEMENT PLAN - STA. 10+00 TO 20+00**

F. A. U. RTE	SECTION	COUNTY	TOTAL SHEETS	SHEET NO.
10B2	13-00062-00-RS	COOK	19	6
FED. ROAD DIST. NO. 1		ILLINOIS	CONTRACT NO. 63844	
FED. AID PROJECT:				

SCALE: 1" = 20' SHEET NO. 6 OF 19 SHEETS STA. - 10+00 TO STA. - 20+00

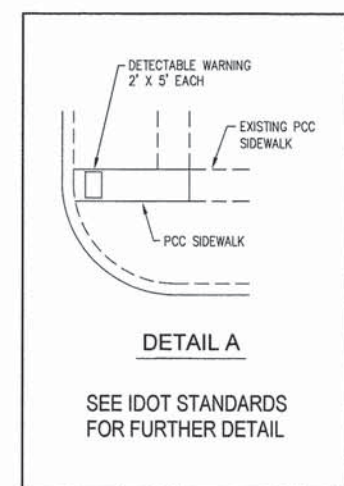
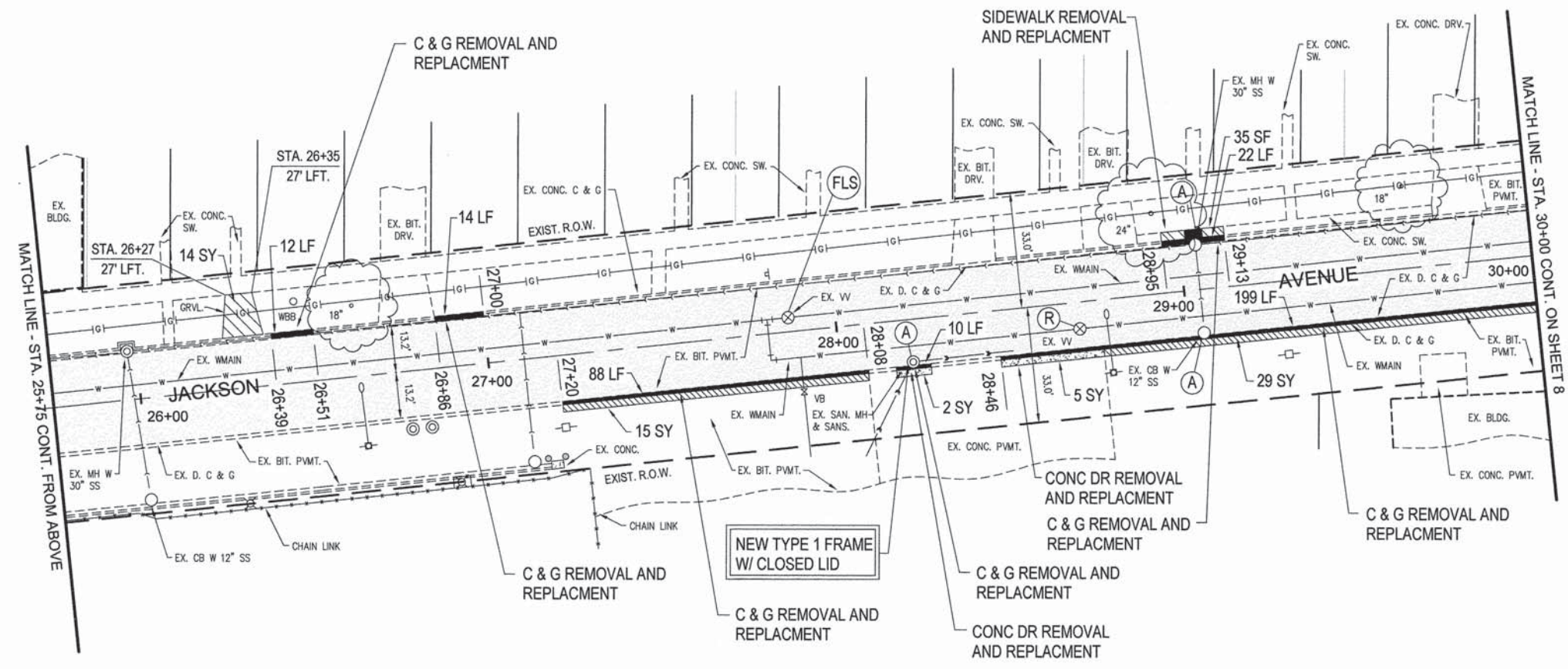
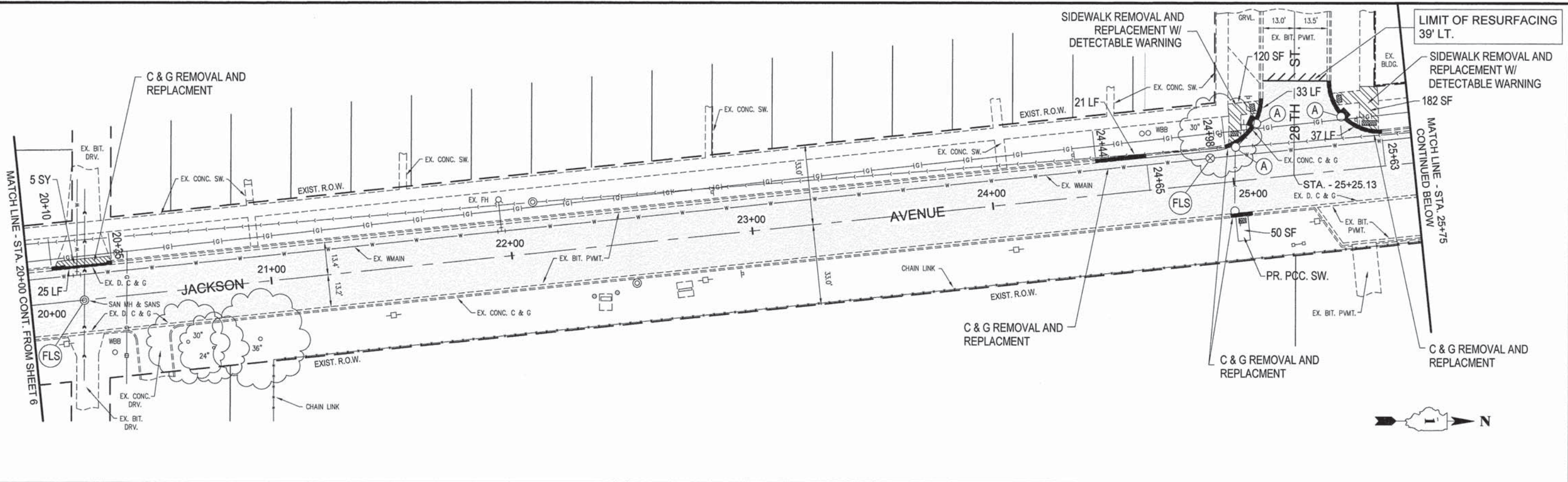

PAVEMENT PLAN LEGEND	
	= COMBINATION CONCRETE CURB AND GUTTER REMOVAL AND REPLACEMENT
	= APPROXIMATE LOCATIONS OF CLASS "D" PATCHES, TYPE I, II, III, OR IV, 5 INCH
	= HMA DRIVEWAY PAVEMENT REMOVAL AND REPLACEMENT
	= CONCRETE DRIVEWAY PAVEMENT REMOVAL AND REPLACEMENT
	= DETECTABLE WARNINGS
	= SIDEWALK REMOVAL AND REPLACEMENT
	= HOT MIX ASPHALT SURFACE COURSE, MIX "D", N50, (IL 9.5mm) 1 1/2"
	= BUTT JOINTS
A	= CATCH BASINS TO BE ADJUSTED - MANHOLES TO BE ADJUSTED
FLS	= FRAMES & LIDS TO BE ADJUSTED (SPECIAL)
R	= CATCH BASINS TO BE RECONSTRUCTED VALVE VAULTS TO BE RECONSTRUCTED

SEE IDOT STANDARDS FOR FURTHER DETAIL

<b>TECH 3 Consulting Group, Inc.</b> ENGINEERS SURVEYORS 737 West Exchange St. Chgo, IL 60617 ph 708.672.4994 fax 708.672.3739 ILLINOIS PROFESSIONAL DESIGN FIRM NO. 184-002235	USER NAME =	DESIGNED - PJC	REVISED - 5/03/2013 PER IDOT	<b>STATE OF ILLINOIS</b> <b>DEPARTMENT OF TRANSPORTATION</b>	<b>VILLAGE OF SOUTH CHICAGO HEIGHTS</b> 3317 CHICAGO ROAD COOK COUNTY, ILLINOIS	<b>JACKSON AVENUE RESURFACING</b> <b>SAUK TRAIL TO 26th STREET</b> <b>PAVEMENT PLAN - STA. 20+00 TO 30+00</b>	F.A.U. RITE	SECTION	COUNTY	TOTAL SHEETS	SHEET NO.
	PLOT SCALE =	CHECKED - WJS	REVISED - 5/22/13 PER IDOT				1082	13-00062-00-RS	COOK	19	7
	PLOT DATE =	DATE -	REVISED -				CONTRACT NO. 63844				
							SCALE: 1" = 20'		SHEET NO. 7 OF 19 SHEETS		STA. - 20+00 TO STA. - 30+00

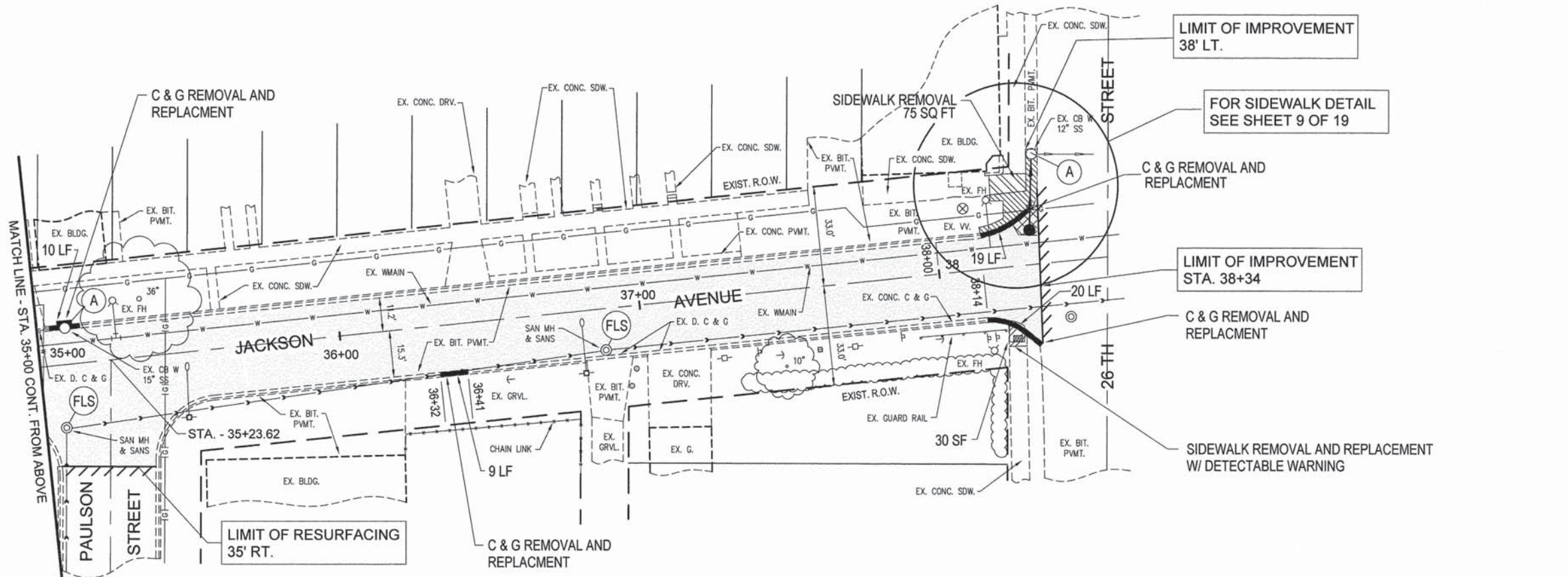
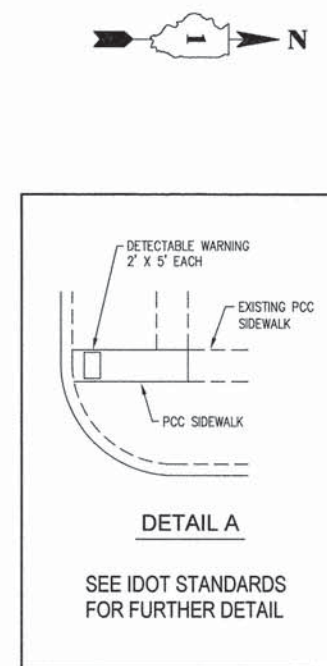
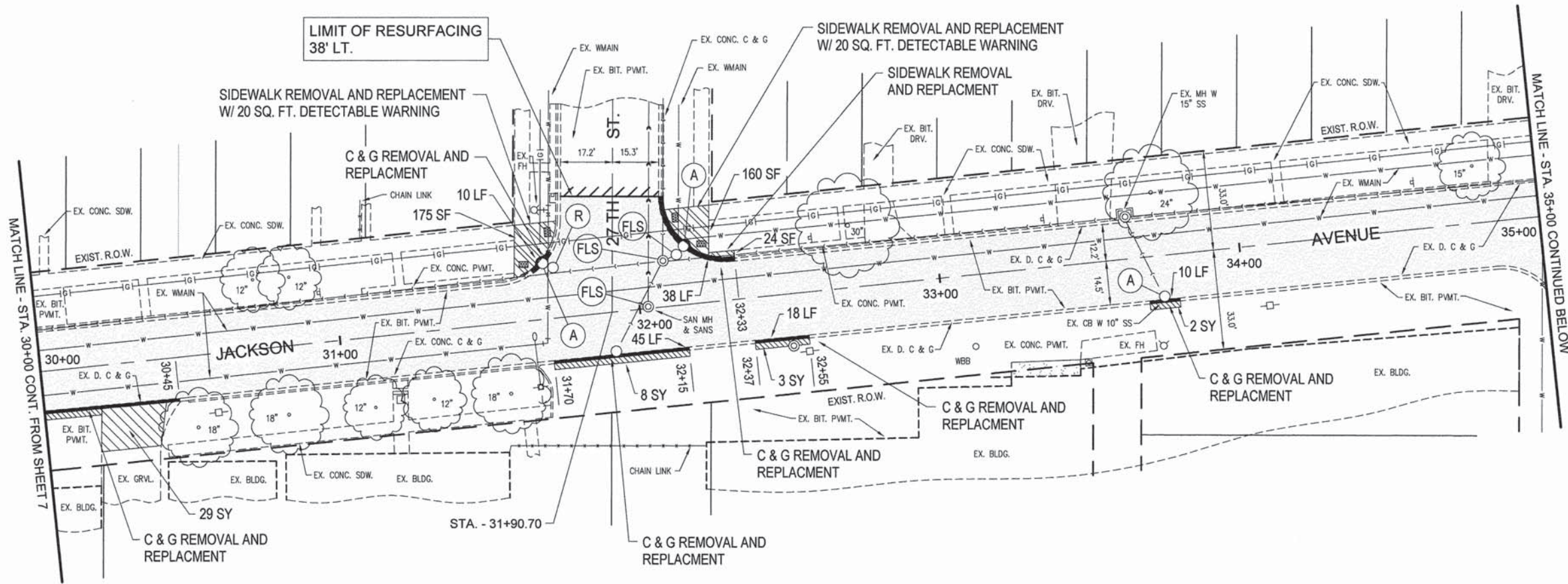

**PAVEMENT PLAN LEGEND**

- = COMBINATION CONCRETE CURB AND GUTTER REMOVAL AND REPLACEMENT
- = APPROXIMATE LOCATIONS OF CLASS "D" PATCHES, TYPE I, II, III, OR IV, 5 INCH
- = HMA DRIVEWAY PAVEMENT REMOVAL AND REPLACEMENT
- = CONCRETE DRIVEWAY PAVEMENT REMOVAL AND REPLACEMENT
- = DETECTABLE WARNINGS
- = SIDEWALK REMOVAL AND REPLACEMENT
- = HOT MIX ASPHALT SURFACE COURSE, MIX "D", N50, (IL 9.5mm) 1 1/2'
- = BUTT JOINTS
- A** = CATCH BASINS TO BE ADJUSTED - MANHOLES TO BE ADJUSTED
- FLS** = FRAMES & LIDS TO BE ADJUSTED (SPECIAL)
- R** = CATCH BASINS TO BE RECONSTRUCTED - VALVE VAULTS TO BE RECONSTRUCTED

**TECH 3 Consulting Group, Inc.**  
 ENGINEERS SURVEYORS  
 737 West Exchange St. Chgo, IL 60647  
 PH 708.672.4994 FAX 708.672.3799  
 ILLINOIS PROFESSIONAL DESIGN FIRM NO. 184-002235

USER NAME =	DESIGNED - PJC	REVISED -5/03/2013 PER IDOT
PLOT SCALE =	DRAWN - EGH	REVISED -5/22/2013 PER IDOT
PLOT DATE =	CHECKED - WJS	REVISED -
	DATE -	REVISED -

**STATE OF ILLINOIS**  
**DEPARTMENT OF TRANSPORTATION**

**VILLAGE of SOUTH CHICAGO HEIGHTS**  
 3317 CHICAGO ROAD  
 COOK COUNTY, ILLINOIS

**JACKSON AVENUE RESURFACING**  
**SAUK TRAIL TO 26th STREET**  
**PAVEMENT PLAN: STA. 30+00 TO 38+34**

F. A. U. RTE.	SECTION	COUNTY	TOTAL SHEETS	SHEET NO.
1082	13-00062-00-RS	COOK	19	8
		CONTRACT NO. 63844		
FED. ROAD DIST. NO. 1		ILLINOIS		
		FED. AID PROJECT:		

SCALE: 1" = 20' SHEET NO. 8 OF 19 SHEETS STA. -30+00 TO STA. -38+34







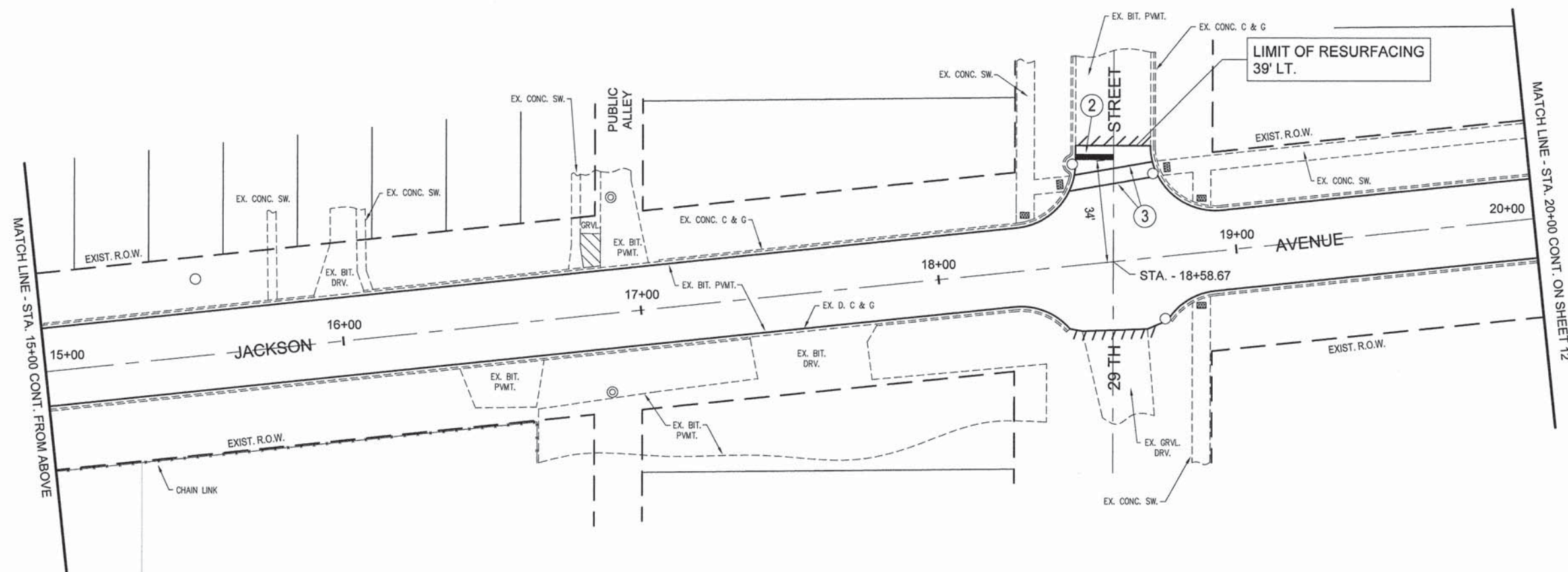
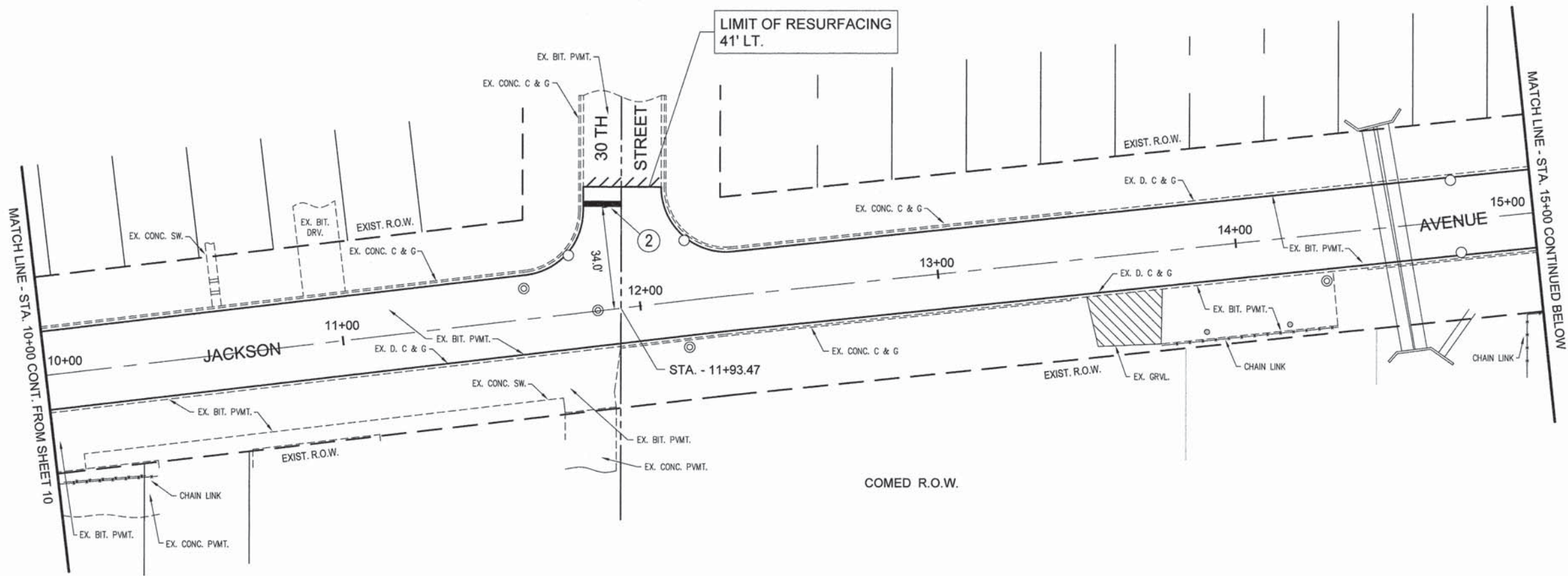

LEGEND FOR PAVEMENT MARKING PLAN				
①	PAINT PAVEMENT MARKING - LINE 6", WHITE			
②	THERMOPLASTIC PAVEMENT MARKING LINE 24", WHITE STOP BAR			
③	THERMOPLASTIC PAVEMENT MARKING LINE 6", WHITE			

**TECH 3 Consulting Group, Inc.**  
 ENGINEERS SURVEYORS  
 737 West Exchange St. Chgo, IL 60617  
 PH 708.672.4994 FAX 708.672.3739  
 ILLINOIS PROFESSIONAL DESIGN FIRM NO. 184-002235

USER NAME =	DESIGNED - PJC	REVISED - 5/03/2013 PER IDOT
PLOT SCALE =	DRAWN - EGH	REVISED -
PLOT DATE =	CHECKED - WJS	REVISED -
	DATE -	REVISED -

**STATE OF ILLINOIS**  
**DEPARTMENT OF TRANSPORTATION**

**VILLAGE of SOUTH CHICAGO HEIGHTS**  
 3317 CHICAGO ROAD  
 COOK COUNTY, ILLINOIS

**JACKSON AVENUE RESURFACING**  
**SAUK TRAIL TO 26th STREET**  
**PAVEMENT MARKING PLAN - STA. 10+00 TO 20+00**

F.A.U. RTE.	SECTION	COUNTY	TOTAL SHEETS	SHEET NO.
1082	13-00062-00-RS	COOK	19	11
CONTRACT NO. 63844				
FED. ROAD DIST. NO. 1		ILLINOIS		FED. AID PROJECT:

SCALE: 1" = 20' SHEET NO. 11 OF 19 SHEETS STA. 10+00 TO STA. 20+00

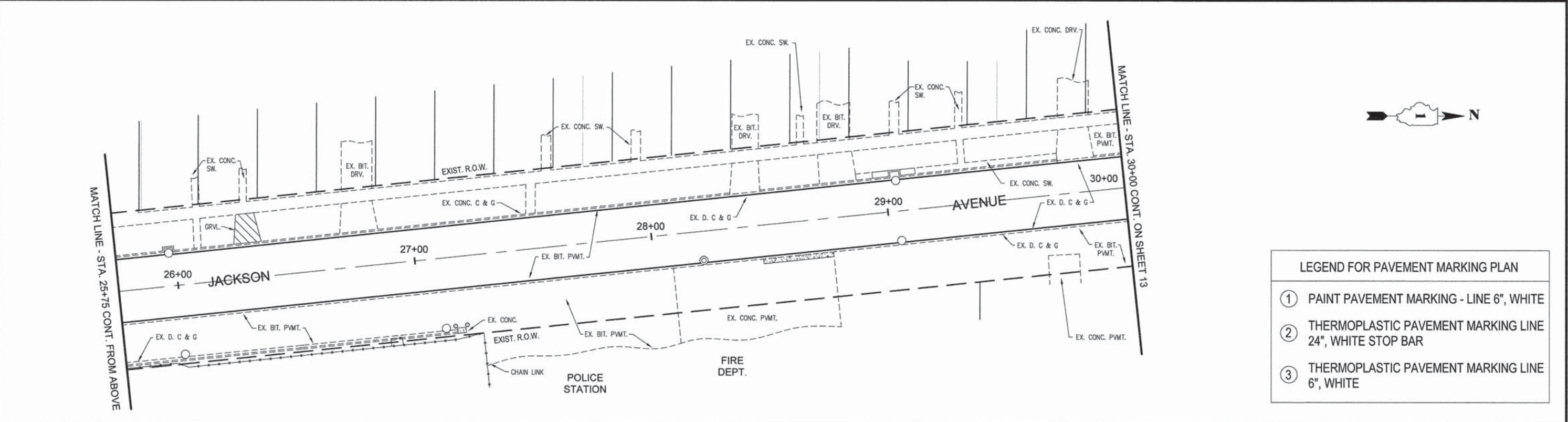
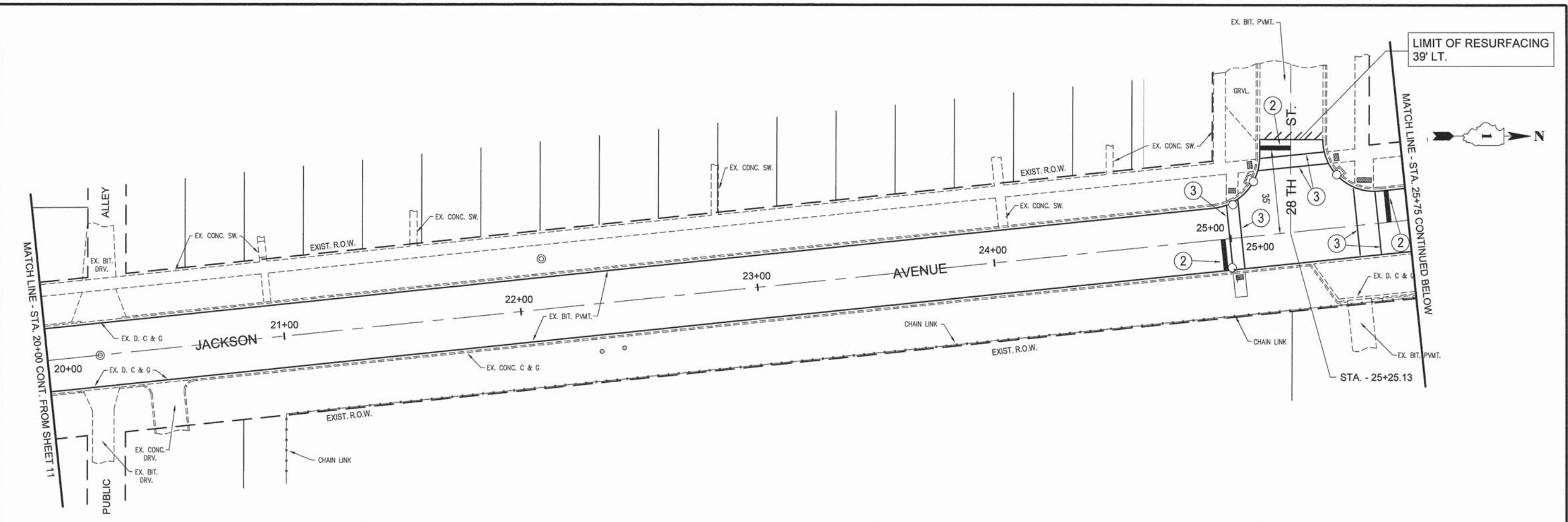

LEGEND FOR PAVEMENT MARKING PLAN	
①	PAINT PAVEMENT MARKING - LINE 6", WHITE
②	THERMOPLASTIC PAVEMENT MARKING LINE 24", WHITE STOP BAR
③	THERMOPLASTIC PAVEMENT MARKING LINE 6", WHITE

<b>TECH 3</b> Consulting Group, Inc. ENGINEERS SURVEYORS 737 West Exchange St. Crete, IL 60417 ph 708.672.4594 fax 708.672.3739 ILLINOIS PROFESSIONAL DESIGN FIRM NO. 184-002235	USER NAME =	DESIGNED - PJC	REVISED - 5/03/2013 PER IDOT	<b>STATE OF ILLINOIS</b> <b>DEPARTMENT OF TRANSPORTATION</b>	<b>VILLAGE of SOUTH CHICAGO HEIGHTS</b> 3317 CHICAGO ROAD COOK COUNTY, ILLINOIS	<b>JACKSON AVENUE RESURFACING</b> <b>SAUK TRAIL TO 26th STREET</b> <b>PAVEMENT MARKING PLAN - STA. 20+00 TO 30+00</b>	F.A.U. RTE.	SECTION	COUNTY	TOTAL SHEETS	SHEET NO.
	PLOT SCALE =	CHECKED - WJS	REVISED -				1082	13-00062-00-RS	COOK	19	12
	PLOT DATE =	DATE -	REVISED -				CONTRACT NO. 63844				
							SCALE: 1" = 20'	SHEET NO. 12 OF 19 SHEETS	STA. - 20+00 TO STA. - 30+00	FED. ROAD DIST. NO. 1	ILLINOIS



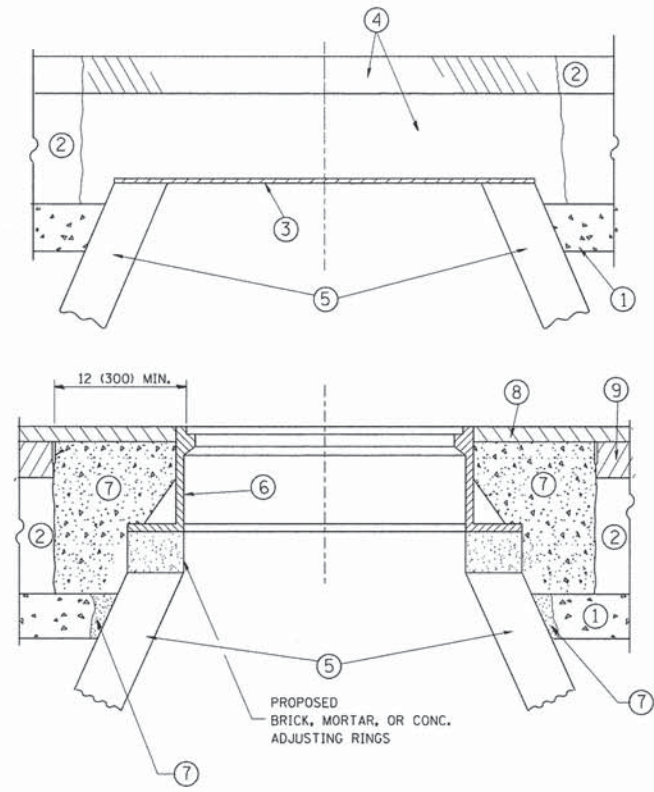

**CONSTRUCTION PROCEDURES**

**STAGE 1 (BEFORE PAVEMENT MILLING)**

- A) REMOVE A MINIMUM OF 12 (300) OF THE PAVEMENT FROM AROUND THE STRUCTURE.
- B) REMOVE THE EXISTING FRAME AND LID FROM THE STRUCTURE.
- C) COVER THE STRUCTURE OPENING WITH A 36 (900) DIAMETER METAL PLATE.
- D) BACKFILL WITH CRUSHED STONE AND A MINIMUM 1/2 (40) THICK HMA SURFACE MIX APPROVED BY THE ENGINEER.

**STAGE 2 (AFTER PAVEMENT MILLING)**

- A) REMOVE THE HMA SURFACE MIX AND CRUSHED STONE.
- B) INSTALL THE FRAME AND LID; ADJUST THE FRAME TO ITS FINAL SURFACE ELEVATION.
- C) THE SURROUNDING SPACE SHALL BE FILLED WITH CLASS PP-1\* CONCRETE TO THE ELEVATION OF THE SURFACE OF THE EXISTING BASE COURSE OR THE BINDER COURSE.

\* UNLESS OTHERWISE SPECIFIED IN THE PLANS.

THE PROCEDURE EXPLAINED ABOVE SHALL CONFORM TO THE APPLICABLE PORTIONS OF SECTIONS 353, 406, 602, AND 603 OF THE STANDARD SPECIFICATIONS EXCEPT THAT "THE CONTRACTOR SHALL ADJUST THE STRUCTURES TO THE FINISHED PAVEMENT ELEVATION NO MORE THAN 5 CALENDAR DAYS PRIOR TO PLACEMENT OF THE FINAL LIFT OF SURFACE UNLESS APPROVED BY THE ENGINEER."

**LEGEND**

- ① SUB-BASE GRANULAR MATERIAL
- ② EXISTING PAVEMENT
- ③ 36 (900) DIAMETER METAL PLATE
- ④ PROPOSED CRUSHED STONE AND HMA SURFACE MIX
- ⑤ EXISTING STRUCTURE
- ⑥ FRAME AND LID (SEE NOTES)
- ⑦ CLASS PP-1\* CONCRETE
- ⑧ PROPOSED HMA SURFACE COURSE
- ⑨ PROPOSED HMA BINDER COURSE

**LOCATION OF STRUCTURES:**

THE CONTRACTOR WILL BE REQUIRED TO KEEP A RECORD OF THE LOCATIONS OF THE BURIED STRUCTURES ACCORDING TO THE STATION AND DISTANCE LEFT OR RIGHT OF THE CENTERLINE OF PAVEMENT. UPON COMPLETION OF THE WORK, THE CONTRACTOR WILL DELIVER THE RECORD TO THE ENGINEER.

**BASIS OF PAYMENT:**

REMOVING FRAMES AND LIDS ON DRAINAGE AND UTILITY STRUCTURES IN THE PAVEMENT PRIOR TO MILLING, AND ADJUSTING TO FINAL GRADE PRIOR TO PLACING THE SURFACE COURSE, WILL BE PAID FOR AT THE CONTRACT UNIT PRICE EACH FOR "FRAMES AND LIDS TO BE ADJUSTED (SPECIAL)."

THIS WORK WILL NOT BE PAID FOR WHEN DRAINAGE AND UTILITY STRUCTURES ARE SPECIFIED FOR PAYMENT AS STRUCTURE RECONSTRUCTION.

NEW FRAMES AND LIDS, WHEN SPECIFIED, WILL BE PAID FOR SEPARATELY.

**NOTES:**

EXISTING BROKEN FRAMES AND LIDS SHALL BE REMOVED AND DISPOSED OF BY THE CONTRACTOR AND SHALL BE REPLACED AS DIRECTED BY THE ENGINEER. REPLACEMENT FRAMES AND LIDS WILL BE PAID FOR IN ACCORDANCE WITH ARTICLE 109.04 OF THE STANDARD SPECIFICATIONS UNLESS A SEPARATE PAY ITEM HAS BEEN PROVIDED.

IF THE EXISTING LIDS ARE OPEN, THE FRAME WILL BE ADJUSTED TO THE ELEVATION OF THE MILLED PAVEMENT SURFACE PRIOR TO THE MILLING OPERATION. THE FRAME WILL NOT BE REMOVED AND COVERED BY THE METAL PLATE.

CITY OF CHICAGO CASTINGS ARE THE PROPERTY OF THE CITY AND THE CONTRACTOR SHALL NOTIFY THE CITY FOR REMOVAL AND DISPOSITION OF THE CASTINGS.

THE METAL PLATE USED TO COVER THE STRUCTURE SHALL REMAIN THE PROPERTY OF THE CONTRACTOR.

WHEN STRUCTURES ARE TO BE ADJUSTED OR RECONSTRUCTED, THE LOWERING AND RAISING OF THE FRAMES AND LIDS WILL NOT BE PAID FOR SEPARATELY BUT WILL BE INCLUDED IN THE COST OF THE CORRESPONDING PAY ITEM.

**DETAILS FOR FRAMES AND LIDS ADJUSTMENT WITH MILLING**

ALL DIMENSIONS ARE IN INCHES (MILLIMETERS) UNLESS OTHERWISE SHOWN

FILE NAME =	USER NAME = bauerdl	DESIGNED - R. SHAH	REVISED - R. WIEDEMAN 05-14-04	<b>STATE OF ILLINOIS DEPARTMENT OF TRANSPORTATION</b>	<b>DETAILS FOR FRAMES AND LIDS ADJUSTMENT WITH MILLING</b>	F.A. RTE. 1082	SECTION 13-00062-00-RS	COUNTY COOK	TOTAL SHEETS 19	SHEET NO. 14	
ci\pw_work\pwwork\baueardl\d0109315\bd08.dgn		DRAWN -	REVISED - R. BORO 01-01-07			SCALE: NONE	SHEET NO. 1 OF 1 SHEETS	BD600-03 (BD-8)		CONTRACT NO. 63844	
	PLOT SCALE = 1/648.5000" = 1' / m	CHECKED -	REVISED - R. BORO 03-09-11				STA. TO STA.	FED. ROAD DIST. NO. 1 (ILLINOIS) FED. AID PROJECT			
	PLOT DATE = 12/6/2011	DATE - 10-25-94	REVISED - R. BORO 12-06-11								

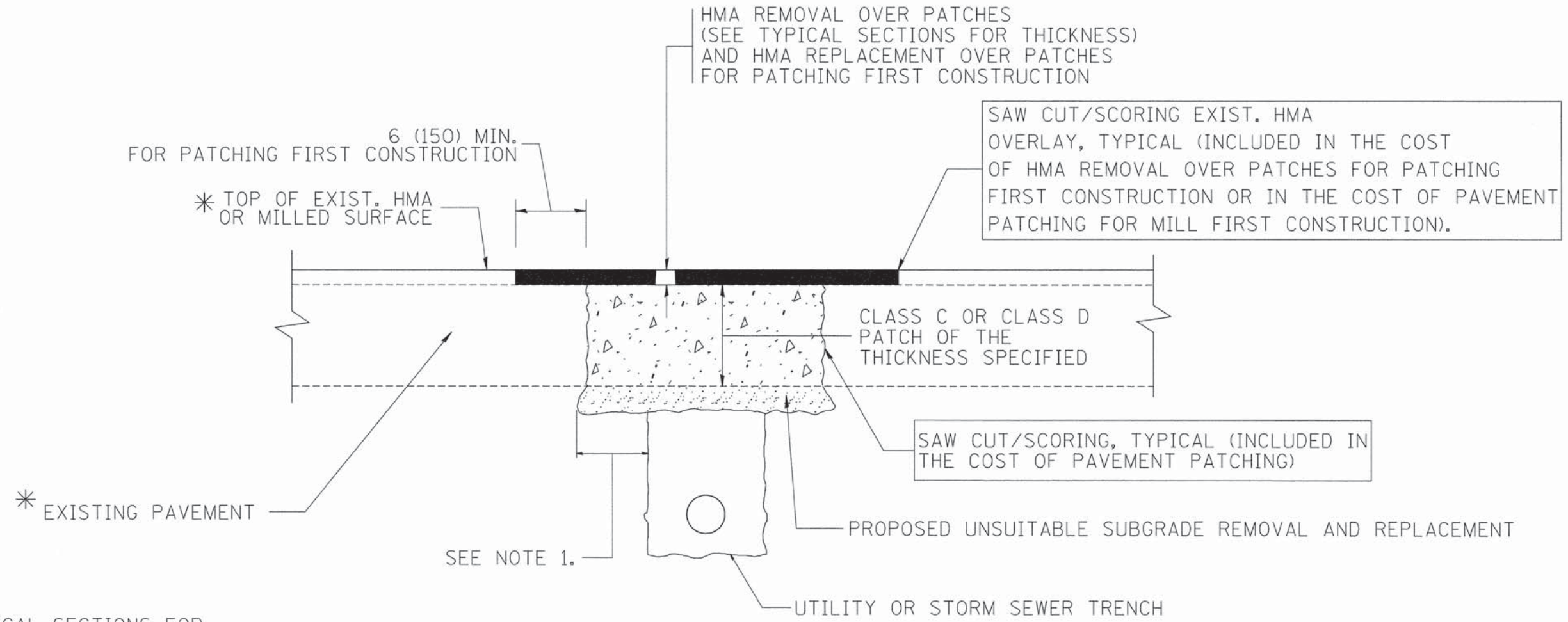

\* SEE TYPICAL SECTIONS FOR THICKNESS AND MATERIALS

**NOTES:**

1. THE WIDTH OF THE FULL DEPTH PATCH OVER A TRENCH SHALL BE 12 (300) WIDER ON EACH SIDE OF THE TRENCH.
2. FOR METHOD OF MEASUREMENT AND BASIS OF PAYMENT, SEE RECURRING SPECIAL PROVISION "PATCHING WITH HOT-MIX ASPHALT OVERLAY REMOVAL".

SEQUENCE OF CONSTRUCTION (PATCHING FIRST)

1. REMOVE THE EXISTING HMA MATERIAL OVER THE AREA TO BE PATCHED.
2. REMOVE AND REPLACE WITH CLASS C OR D PATCH.
3. REPLACE HMA MATERIAL OVER THE AREA TO BE PATCHED.

SEQUENCE OF CONSTRUCTION (MILLING FIRST)

1. MILL HMA FIRST IF THERE IS AT LEAST 4 1/2 INCHES OR MORE OF HMA MATERIAL ON TOP OF THE EXISTING PAVEMENT OR IF THE PAVEMENT IS FULL DEPTH HMA. A MINIMUM OF 2 INCHES OF HMA MATERIAL SHALL BE IN PLACE AFTER MILLING.
2. REMOVE AND REPLACE WITH FULL DEPTH CLASS D PATCHES TO TOP OF MILLED SURFACE.

ALL DIMENSIONS ARE IN INCHES (MILLIMETERS) UNLESS OTHERWISE SHOWN.

FILE NAME = c:\projects\diststd22x34\bd22.dgn	USER NAME = bauerdl	DESIGNED - R. SHAH	REVISED - A. ABBAS 04-27-98	<b>STATE OF ILLINOIS DEPARTMENT OF TRANSPORTATION</b>	<b>PAVEMENT PATCHING FOR HMA SURFACED PAVEMENT</b>	F.A. RTE. *	SECTION	COUNTY	TOTAL SHEETS	SHEET NO.
		DRAWN -	REVISED - R. BORO 01-01-07			1082	13-00062-00-RS	COOK	19	15
		PLOT SCALE = 50.000' / IN.	REVISED - R. BORO 09-04-07			<b>BD400-04 (BD-22)</b>		CONTRACT NO. 63844		
		PLOT DATE = 10/27/2008	REVISED - K. ENG 10-27-08			SCALE: NONE	SHEET NO. 1 OF 1 SHEETS	STA.	TO STA.	FED. ROAD DIST. NO. 1 (ILLINOIS) FED. AID PROJECT

VARIABLE - TO MEET EXISTING DIMENSIONS AND FIELD CONDITIONS (SEE NOTE ②)

PROP. CONC. CURB OR CURB AND GUTTER REPLACEMENT IN ACCORDANCE WITH STATE STANDARD 606001. (SEE NOTE ②)

SAW CUT FULL DEPTH - INCLUDED IN THE COST OF SIDEWALK, DRIVEWAY OR MEDIAN SURFACE REMOVAL PAY ITEM.

SEE STATE STANDARD 606001

18" (450) MAX.

EXISTING OR PROPOSED HMA SURFACE (IF APPLICABLE)

1/4" (5) \*\*

EXISTING SIDEWALK, DRIVEWAY, MEDIAN SURFACE, SOD OR GROUND.

PROPOSED SIDEWALK, DRIVEWAY PAVEMENT, MEDIAN SURFACE OR SODDING SALT TOLERANT WITH TOP SOIL, 4" (100) SOD RESTORATION (SEE NOTE ①).

EXISTING CONCRETE PAVEMENT, CONCRETE BASE COURSE OR FLEXIBLE PAVEMENT

3" (75) MIN.

SUITABLE BACKFILL MATERIAL (INCLUDED IN THE COST OF CURB OR CURB AND GUTTER REMOVAL AND REPLACEMENT)

PROPOSED 3/4" (20) PREFORMED EXPANSION JOINT AT CONCRETE SIDEWALKS, DRIVEWAYS, AND MEDIANS. (INCLUDED IN THE COST OF CURB OR CURB AND GUTTER REMOVAL AND REPLACEMENT.)

\* 3" (75) MINIMUM FROM TOP AND BOTTOM OF THE CONCRETE PAVEMENT OR BASE COURSE.

\*\* IF THE FINAL SURFACE OF THE PAVEMENT IS CONCRETE, THE GUTTER IS TO BE FLUSH WITH THE PAVEMENT.

UNSUITABLE SUB-BASE MATERIAL TO BE REMOVED, IF DIRECTED BY THE ENGINEER, SHALL BE REPLACED WITH EITHER SUB-BASE GRANULAR MATERIAL, TYPE B OR ADDITIONAL THICKNESS OF CONCRETE.

REMOVAL AND REPLACEMENT 4" (100) OR LESS IS INCLUDED IN THE COST OF CURB OR CURB AND GUTTER REMOVAL AND REPLACEMENT.

REMOVAL AND REPLACEMENT IN EXCESS OF 4" (100) WILL BE PAID FOR IN ACCORDANCE WITH ARTICLE 109.04 OF THE STANDARD SPECIFICATIONS.

NOTE: ① SIDEWALK, DRIVEWAY PAVEMENT OR MEDIAN SURFACE SHALL BE SIMILAR TO THE MATERIAL BEING REMOVED AND WILL BE PAID FOR SEPARATELY.

SODDING, SALT TOLERANT AND TOP SOIL, FURNISH AND PLACE 4" WILL BE PAID FOR SEPARATELY.

② FERTILIZER FOR THE PLACEMENT OF THE SOD IS NOT REQUIRED

③ CURB OR CURB AND GUTTER REPLACEMENT SHALL MATCH THE SHAPE OF THE EXISTING CURB OR CURB AND GUTTER UNLESS OTHERWISE SPECIFIED.

④ FOR CURB OR CURB AND GUTTER REMOVAL AND REPLACEMENT ADJACENT TO FLEXIBLE PAVEMENT DELETE EPOXY COATED TIE BARS.

⑤ LONGITUDINAL BARS, IF ENCOUNTERED IN THE EXISTING CURB OR CURB AND GUTTER, ARE NOT TO BE REPLACED. CUTTING AND REMOVING LONGITUDINAL BARS SHALL BE INCLUDED IN THE COST OF CURB OR CURB AND GUTTER REMOVAL AND REPLACEMENT.

⑥ THE COST OF HMA SURFACE REMOVAL IN THE EXISTING GUTTER FLAG SHALL BE INCLUDED IN THE COST OF THE CURB AND GUTTER REMOVAL AND REPLACEMENT.

⑦ THE REMOVAL AND REPLACEMENT OF THE EXISTING CURB OR CURB AND GUTTER SHALL BE DONE IN ACCORDANCE WITH THE APPLICABLE PORTIONS OF SECTION 440 AND 606 OF THE STANDARD SPECIFICATIONS.

⑧ THE LOCATIONS OF REMOVAL AND REPLACEMENT OF EXISTING CURB OR CURB AND GUTTER SHALL BE DETERMINED BY THE RESIDENT ENGINEER AT THE TIME OF CONSTRUCTION.

PROPOSED #6 (20) EPOXY COATED TIE BARS 24" (600) LONG AT 24" (600) CENTERS WILL NOT BE PAID FOR SEPARATELY. DELETE EPOXY COATED TIE BARS IF EXISTING TIE BARS ARE USUABLE AS DETERMINED BY THE ENGINEER. (SEE NOTE ③).

**BASIS OF PAYMENT:**

THIS WORK WILL BE PAID FOR AT THE CONTRACT UNIT PRICE PER FOOT (METER) FOR "CURB REMOVAL AND REPLACEMENT" OR "COMBINATION CONCRETE CURB AND GUTTER REMOVAL AND REPLACEMENT".

# CURB OR CURB AND GUTTER REMOVAL AND REPLACEMENT

ALL DIMENSIONS ARE IN INCHES (MILLIMETERS) UNLESS OTHERWISE SHOWN.

FILE NAME *	USER NAME * drivakosgn	DESIGNED - A. HOUSEH	REVISED - R. SHAH 10-03-96
ct:\pwork\pwidot\drivakosgn\d0108315\bd24.dgn		DRAWN -	REVISED - A. ABBAS 03-21-97
	PLOT SCALE = 50,000' / IN.	CHECKED -	REVISED - M. GOMEZ 01-22-01
	PLOT DATE = 12/15/2009	DATE - 03-11-94	REVISED - R. BORO 12-15-09

**STATE OF ILLINOIS  
DEPARTMENT OF TRANSPORTATION**

**CURB OR CURB AND GUTTER  
REMOVAL AND REPLACEMENT**

SCALE: NONE SHEET NO. 1 OF 1 SHEETS STA. TO STA.

F.A. RTE.	SECTION	COUNTY	TOTAL SHEETS	SHEET NO.
1082	13-00062-00-RS	COOK	19	16
BD600-06 (BD-24)		CONTRACT NO. 63844		
FED. ROAD DIST. NO. 1 ILLINOIS FED. AID PROJECT				



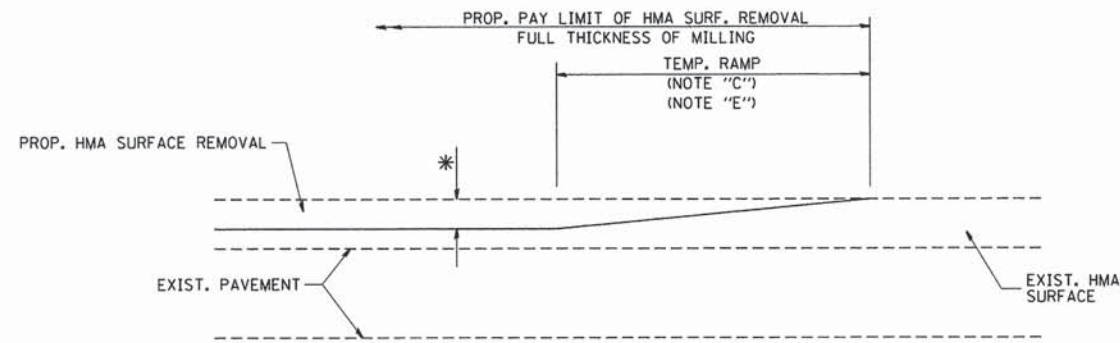

MILLED TEMPORARY RAMP  
(FOR BUTT JOINT AND HMA TAPER SEE DETAIL BELOW)

**OPTION 1**

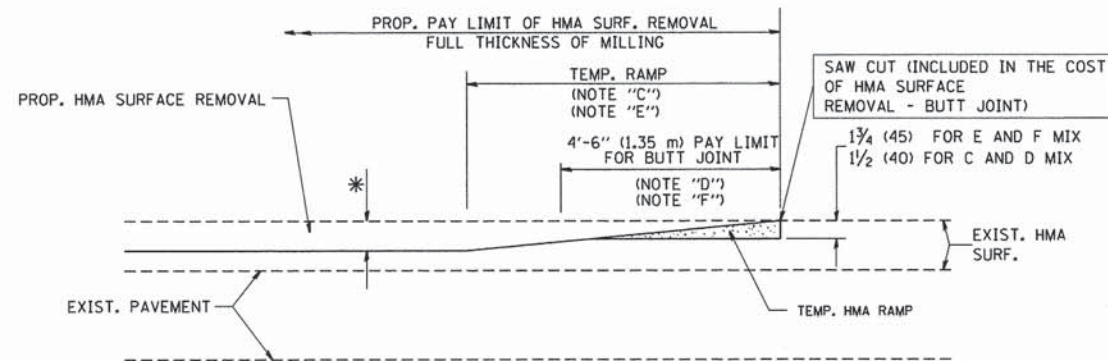

HMA CONSTRUCTED TEMPORARY RAMP  
(FOR BUTT JOINT AND HMA TAPER SEE DETAIL BELOW)

**OPTION 2**  
**TYPICAL TEMPORARY RAMP**

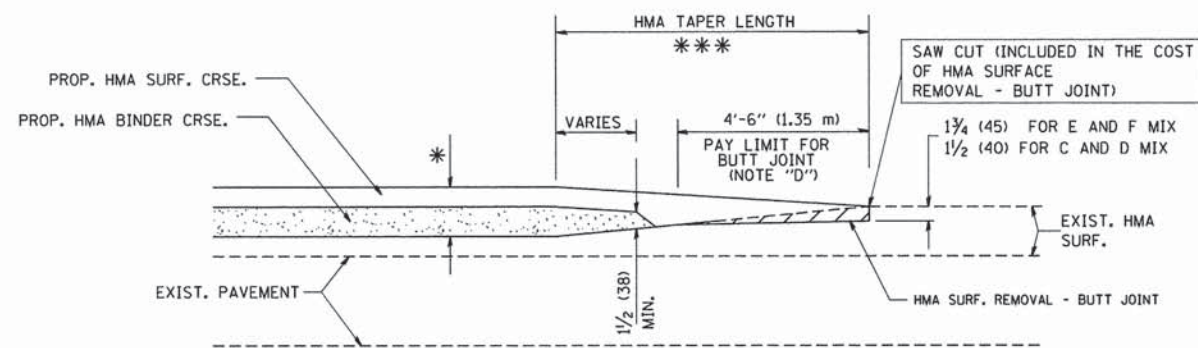

**TYPICAL BUTT JOINT AND HMA TAPER**  
**FOR MILLING AND RESURFACING**

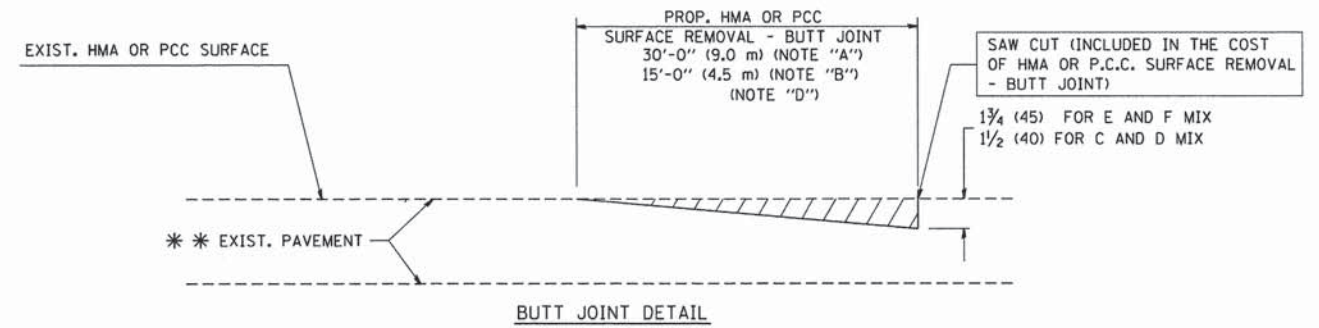

**BUTT JOINT DETAIL**

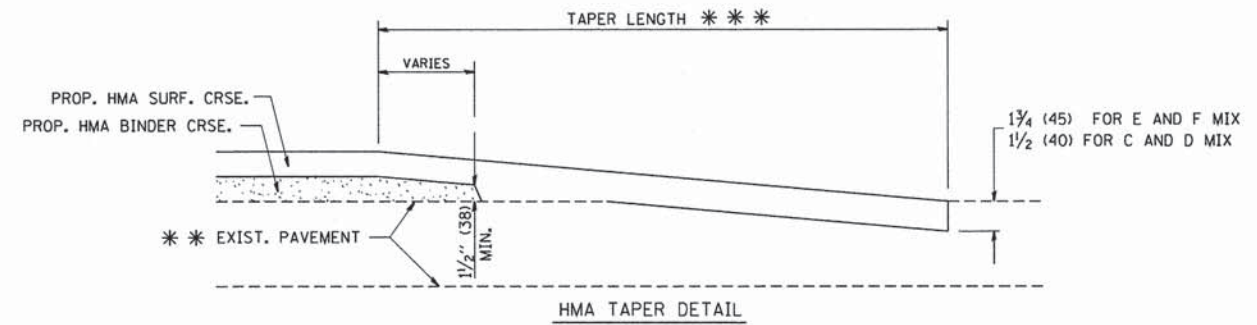

**TYPICAL BUTT JOINT AND HMA TAPER**  
**FOR RESURFACING ONLY**

\*\*\* PC CONCRETE, HMA OR HMA RESURFACED PAVEMENT.

**NOTES**

- A: MAINLINE ROADWAYS AND MAJOR SIDE ROADS.
- B: MINOR SIDE ROADS.
- C: THE TEMP. RAMP SHALL BE CONSTRUCTED IMMEDIATELY UPON REMOVAL OF THE EXISTING HMA SURFACE.
- D: THE BUTT JOINT SHALL BE CONSTRUCTED IMMEDIATELY PRIOR TO PLACING THE PROPOSED HMA COURSES.
- E: TAPER THE TEMP. RAMP AT A RATE OF 3'-0" (900 mm) PER 1 INCH (25 mm) OF MILLING THICKNESS.
- F: INSTALLATION AND REMOVAL OF THE 4'-6" (1.35 m) TEMP. RAMP IS INCLUDED IN COST OF HMA SURFACE REMOVAL - BUTT JOINT
- G: SEE ARTICLE 406.08 AND 406.14 OF THE STANDARD SPECIFICATIONS FOR "HMA AND/OR PCC SURFACE REMOVAL, BUTT JOINT".
- \* SEE TYPICAL SECTIONS FOR MILLING THICKNESS.
- \*\*\* 20'-0" (6.1 m) PER 1 (25) RESURFACING (NOTE "A")  
10'-0" (3.0 m) PER 1 (25) RESURFACING (NOTE "B")

**BASIS OF PAYMENT:**

THE BUTT JOINT WILL BE PAID FOR AT THE CONTRACT UNIT PRICE PER SQUARE YARD (SQUARE METER) FOR "HOT-MIX ASPHALT SURFACE REMOVAL - BUTT JOINT" OR FOR "PORTLAND CEMENT CONCRETE SURFACE REMOVAL - BUTT JOINT".

ALL DIMENSIONS ARE IN INCHES (MILLIMETERS) UNLESS OTHERWISE SHOWN.

FILE NAME = W:\diststd\22+34\bd32.dgn

USER NAME = goglianobt	DESIGNED - M. DE YONG	REVISED - R. SHAH 10-25-94
PLOT SCALE = 50.0000' / IN.	CHECKED -	REVISED - A. ABBAS 03-21-97
PLOT DATE = 1/4/2008	DATE - 06-13-90	REVISED - M. GOMEZ 04-06-01
		REVISED - R. BORO 01-01-07

**STATE OF ILLINOIS**  
**DEPARTMENT OF TRANSPORTATION**

<b>BUTT JOINT AND HMA TAPER DETAILS</b>	
SCALE: NONE	SHEET NO. 1 OF 1 SHEETS
STA.	TO STA.

F.A. RTE.	SECTION	COUNTY	TOTAL SHEETS	SHEET NO.
1082	13-00062-00-RS	COOK	19	17
BD400-05 BD32		CONTRACT NO. 63844		
FED. ROAD DIST. NO. 1 ILLINOIS FED. AID PROJECT				

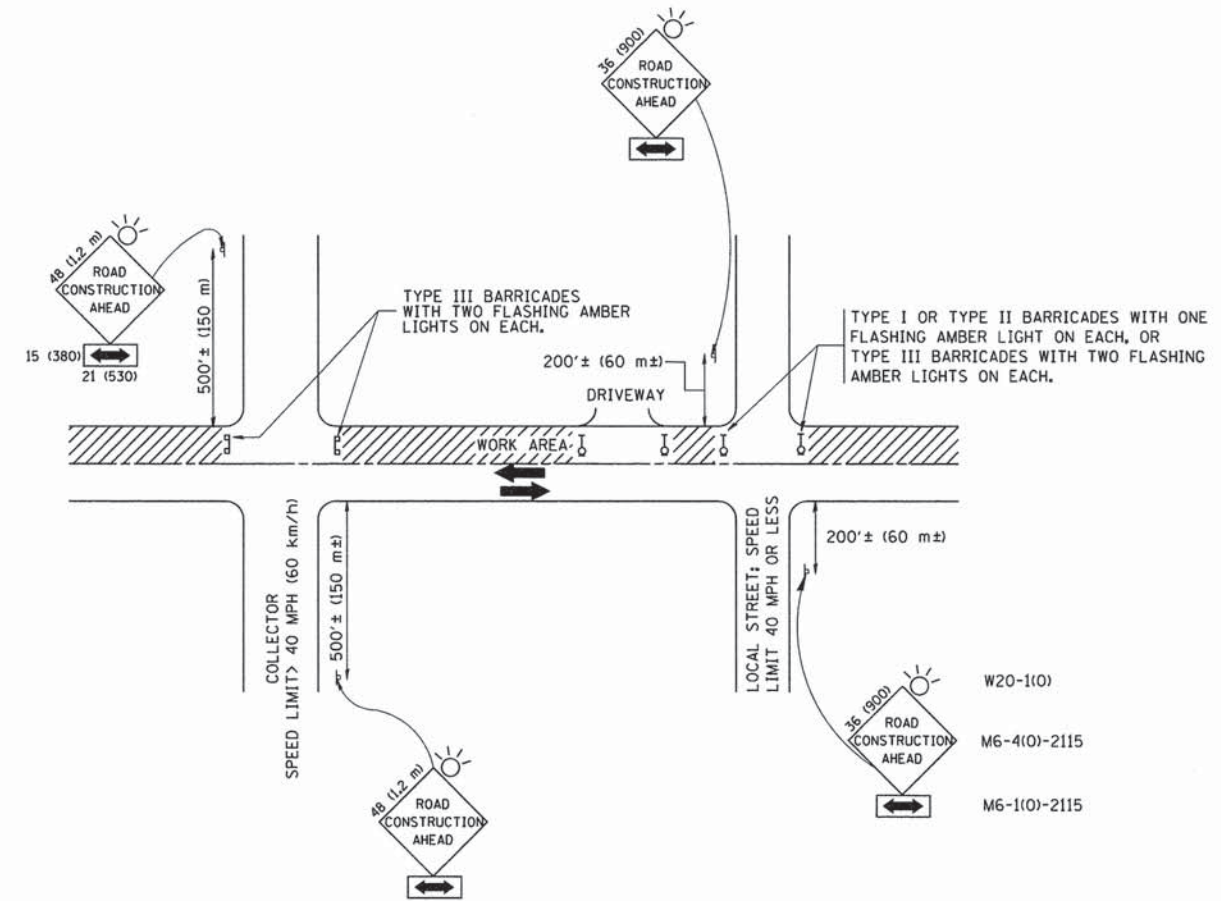

TRAFFIC CONTROL AND PROTECTION FOR SIDE ROADS, INTERSECTIONS, AND DRIVEWAYS

NOTES:

A. FOR NO LANE RESTRICTION ON THE SIDE ROAD OR DRIVEWAYS

1. SIDE ROAD WITH A SPEED LIMIT OF 40 MPH (60 km/h) OR LESS AS SHOWN ON THE DRAWING AND AS DIRECTED BY THE ENGINEER:
  - a) ONE ROAD CONSTRUCTION AHEAD SIGN 36 x 36 (900x900) WITH A FLASHER AND FLAG MOUNTED ON IT APPROXIMATELY 200' (60 m) IN ADVANCE OF THE MAIN ROUTE.
  - b) THE CLOSED PORTION OF THE MAIN ROUTE SHALL BE PROTECTED BY BLOCKING WITH TYPE I, TYPE II OR TYPE III BARRICADES, 1/3 OF THE CROSS SECTION OF THE CLOSED PORTION.
2. SIDE ROAD WITH A SPEED LIMIT GREATER THAN 40 MPH (60 km/h) AS SHOWN ON THE DRAWING AND AS DIRECTED BY THE ENGINEER:
  - a) ONE ROAD CONSTRUCTION AHEAD SIGN 48 x 48 (1.2 m x 1.2 m) WITH A FLASHER MOUNTED ON IT APPROXIMATELY 500' (150 m) IN ADVANCE OF THE MAIN ROUTE.
  - b) THE CLOSED PORTION OF THE MAIN ROUTE SHALL BE PROTECTED BY BLOCKING WITH TYPE III BARRICADES, 1/2 OF THE CROSS SECTION OF THE CLOSED PORTION.
3. WHEN THE SIDE ROAD LIES BETWEEN THE BEGINNING OF THE MAINLINE SIGNING AND THE WORK ZONE, A SINGLE HEADED ARROW (M6-1) SHALL BE USED IN LIEU OF THE DOUBLE HEADED ARROW (M6-4).

B. FOR A LANE CLOSURE ON A SIDE ROAD OR DRIVEWAY:

USE APPLICABLE PORTIONS OF THE TYPICAL APPLICATION OF TRAFFIC CONTROL DEVICES (STD. 701501, STD. 701606 OR THE APPROPRIATE STANDARD). THE SPACING OF SIGNS AND BARRICADES SHALL BE ADJUSTED FOR FIELD CONDITIONS AS DIRECTED BY THE ENGINEER. THE DIRECTIONAL ARROW SHALL BE COVERED OR REMOVED WHEN NO LONGER CONSISTENT WITH THE SIDE ROAD LANE CLOSURE.

C. ADVANCE WARNING SIGNS ARE TO BE OMITTED ON DRIVEWAY UNLESS OTHERWISE NOTED.

D. THE TRAFFIC CONTROL AND PROTECTION FOR SIDE ROADS, INTERSECTIONS, AND DRIVEWAYS SHALL BE INCIDENTAL TO THE COST OF SPECIFIED TRAFFIC CONTROL STANDARDS OR ITEMS.

All dimensions are in millimeters (inches) unless otherwise shown.

FILE NAME = W:\diststd\22x34\1010.dgn	USER NAME = gaglienobt	DESIGNED - LHA	REVISED - J. OBERLE 10-18-95
		DRAWN -	REVISED - A. HOUSEH 03-06-96
	PLOT SCALE = 50.000' / IN.	CHECKED -	REVISED - A. HOUSEH 10-15-96
	PLOT DATE = 1/4/2008	DATE - 06-89	REVISED - T. RAMMACHER 01-06-00

STATE OF ILLINOIS  
DEPARTMENT OF TRANSPORTATION

TRAFFIC CONTROL AND PROTECTION FOR  
SIDE ROADS, INTERSECTIONS, AND DRIVEWAYS

SCALE: NONE SHEET NO. 1 OF 1 SHEETS STA. TO STA.

F.A. RTE.	SECTION	COUNTY	TOTAL SHEETS	SHEET NO.
1082	13-00062-00-RS	COOK	19	18
TC-10			CONTRACT NO. 63844	
FED. ROAD DIST. NO. 1 ILLINOIS FED. AID PROJECT				

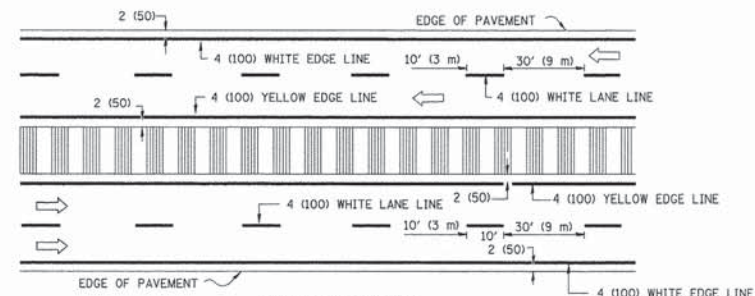
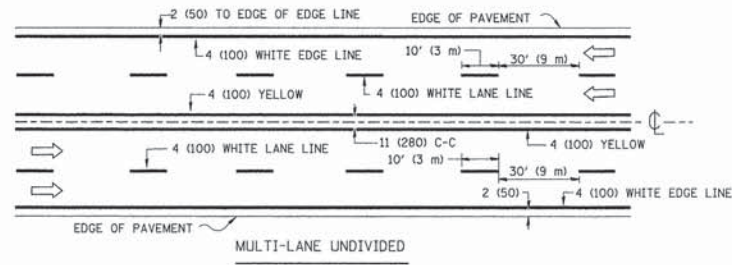
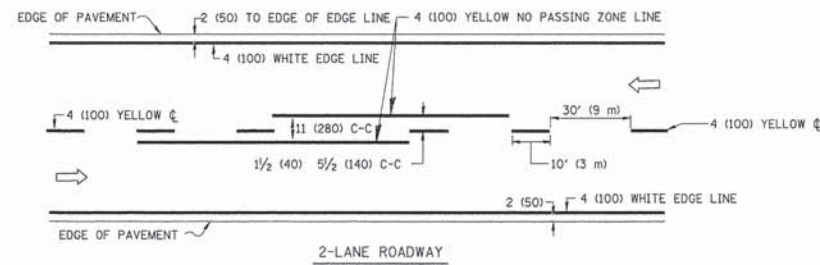

NOTE: MEDIANS WITH BARRIER CURB DO NOT REQUIRE AN EDGE LINE

TYPICAL LANE AND EDGE LINE MARKING

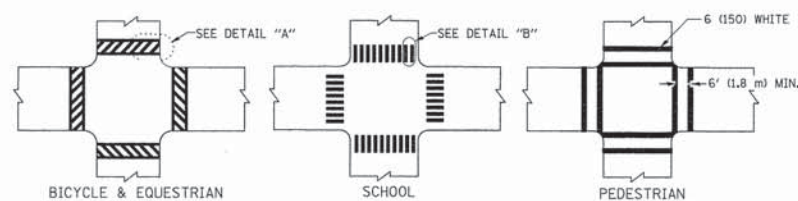

TYPICAL CROSSWALK MARKING

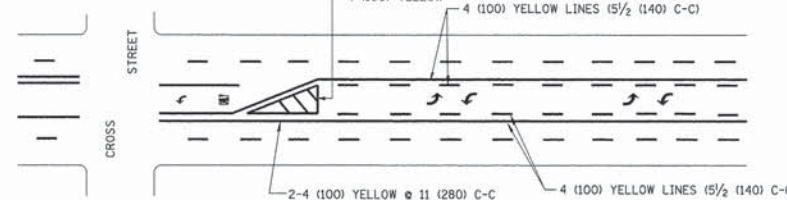
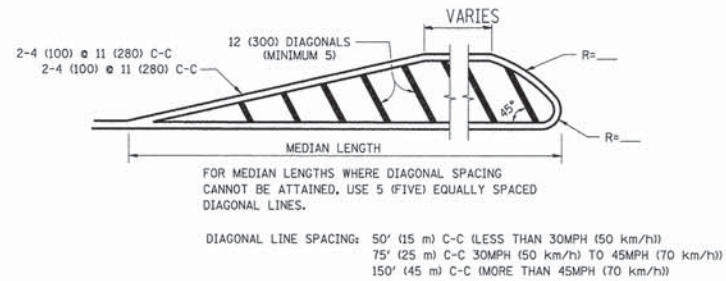
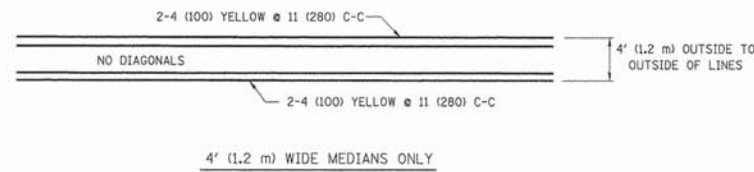

TYPICAL PAINTED MEDIAN MARKING

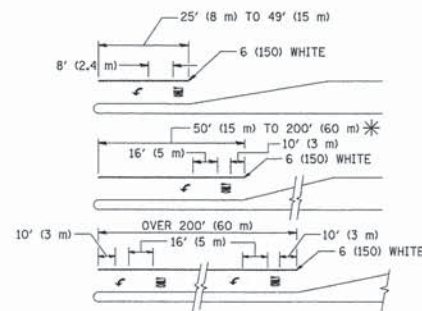

TYPICAL LEFT (OR RIGHT) TURN LANE

TYPICAL TURN LANE MARKING

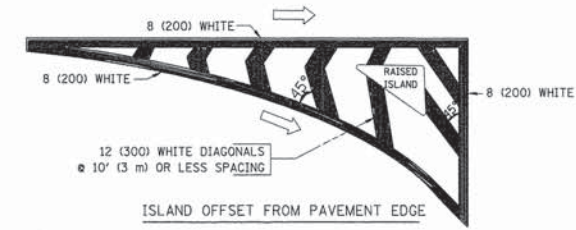

ISLAND OFFSET FROM PAVEMENT EDGE

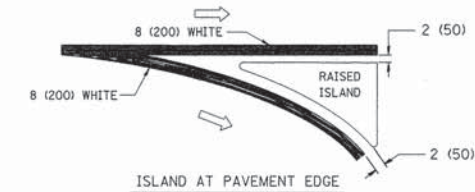

ISLAND AT PAVEMENT EDGE

TYPICAL ISLAND MARKING

TYPE OF MARKING	WIDTH OF LINE	PATTERN	COLOR	SPACING / REMARKS
CENTERLINE ON 2 LANE PAVEMENT	4 (100)	SKIP-DASH	YELLOW	10' (3 m) LINE WITH 30' (9 m) SPACE
CENTERLINE ON MULTI-LANE UNDIVIDED PAVEMENT	2 @ 4 (100)	SOLID	YELLOW	11 (280) C-C
NO PASSING ZONE LINES: FOR ONE DIRECTION FOR BOTH DIRECTIONS	4 (100) 2 @ 4 (100)	SOLID SOLID	YELLOW YELLOW	5 1/2 (140) C-C FROM SKIP-DASH CENTERLINE 11 (280) C-C OMIT SKIP-DASH CENTERLINE BETWEEN
LANE LINES	4 (100) 5 (125) ON FREEWAYS	SKIP-DASH SKIP-DASH	WHITE WHITE	10' (3 m) LINE WITH 30' (9 m) SPACE
DOTTED LINES (EXTENSIONS OF CENTER, LANE OR TURN LANE MARKINGS)	SAME AS LINE BEING EXTENDED	SKIP-DASH	SAME AS LINE BEING EXTENDED	2' (600) LINE WITH 6' (1.8 m) SPACE
EDGE LINES	4 (100)	SOLID	YELLOW-LEFT WHITE-RIGHT	OUTLINE MOUNTABLE MEDIANS IN YELLOW; EDGE LINES ARE NOT USED NEXT TO BARRIER CURB
TURN LANE MARKINGS	6 (150) LINE; FULL SIZE LETTERS & SYMBOLS (8' (2.4m))	SOLID	WHITE	SEE TYPICAL TURN LANE MARKING DETAIL
TWO WAY LEFT TURN MARKING	2 @ 4 (100) EACH DIRECTION 8' (2.4m) LEFT ARROW	SKIP-DASH AND SOLID IN PAIRS	YELLOW WHITE	10' (3 m) LINE WITH 30' (9 m) SPACE FOR SKIP-DASH 5 1/2 (140) C-C BETWEEN SOLID LINE AND SKIP-DASH LINE SEE TYPICAL TWO-WAY LEFT TURN MARKING DETAIL
CROSSWALK LINES (PEDESTRIAN) A. DIAGONALS (BIKE & EQUESTRIAN) B. LONGITUDINAL BARS (SCHOOL)	2 @ 6 (150) 12 (300) @ 45° 12 (300) @ 90°	SOLID SOLID SOLID	WHITE WHITE WHITE	NOT LESS THAN 6' (1.8 m) APART 2' (600) APART 2' (600) APART SEE TYPICAL CROSSWALK MARKING DETAILS.
STOP LINES	24 (600)	SOLID	WHITE	PLACE 4' (1.2 m) IN ADVANCE OF AND PARALLEL TO CROSSWALK, IF PRESENT. OTHERWISE, PLACE AT DESIRED STOPPING POINT, PARALLEL TO CROSSROAD CENTERLINE, WHERE POSSIBLE
PAINTED MEDIANS	2 @ 4 (100) WITH 12 (300) DIAGONALS @ 45° NO DIAGONALS USED FOR 4' (1.2 m) WIDE MEDIANS	SOLID	YELLOW; TWO WAY TRAFFIC WHITE; ONE WAY TRAFFIC	11 (280) C-C FOR THE DOUBLE LINE SEE TYPICAL PAINTED MEDIAN MARKING.
GORE MARKING AND CHANNELIZING LINES	8 (200) WITH 12 (300) DIAGONALS @ 45°	SOLID	WHITE	DIAGONALS: 15' (4.5 m) C-C (LESS THAN 30MPH (50 km/h)) 20' (6 m) C-C (30MPH (50 km/h) TO 45MPH (70 km/h)) 30' (9 m) C-C (OVER 45MPH (70 km/h))
RAILROAD CROSSING	24 (600) TRANSVERSE LINES; "RR" IS 6' (1.8 m) LINE FOR "X"	SOLID	WHITE	SEE STATE STANDARD 780001 AREA OF: "R"=3.6 SQ. FT. (0.33 m <sup>2</sup> ) EACH "X"=54.0 SQ. FT. (5.0 m <sup>2</sup> )
SHOULDER DIAGONALS	12 (300) @ 45°	SOLID	WHITE - RIGHT YELLOW - LEFT	50' (15 m) C-C (LESS THAN 30MPH (50 km/h)) 75' (25 m) C-C (30 MPH (50 km/h) TO 45MPH (70 km/h)) 150' (45 m) C-C (OVER 45MPH (70 km/h))

FOR FURTHER DETAILS ON PAVEMENT MARKING REFER TO STANDARD SPECIFICATIONS FOR ROAD AND BRIDGE CONSTRUCTION AND STATE STANDARD 780001.

All dimensions are in inches (millimeters) unless otherwise shown.

FILE NAME =	USER NAME = drivakosgn	DESIGNED - EVERS	REVISED - T. RAMMACHER 10-27-94
c:\pwwork\pwwork\drivakosgn\d0108315\103.dgn		DRAWN -	REVISED - C. JUCIUS 09-09-09
	PLOT SCALE = 58.000' / IN.	CHECKED -	REVISED -
	PLOT DATE = 9/9/2009	DATE - 03-19-90	REVISED -

STATE OF ILLINOIS  
DEPARTMENT OF TRANSPORTATION

DISTRICT ONE		F.A. RTE.	SECTION	COUNTY	TOTAL SHEETS	SHEET NO.
TYPICAL PAVEMENT MARKINGS		1082	13-00062-00-RS	COOK	19	19
SCALE: NONE		SHEET NO. 1 OF 1 SHEETS		STA.	TO STA.	

CONTRACT NO. 63844		FED. ROAD DIST. NO. 1 ILLINOIS FED. AID PROJECT	
--------------------	--	---	--