

PARTIAL DEPTH PATCH

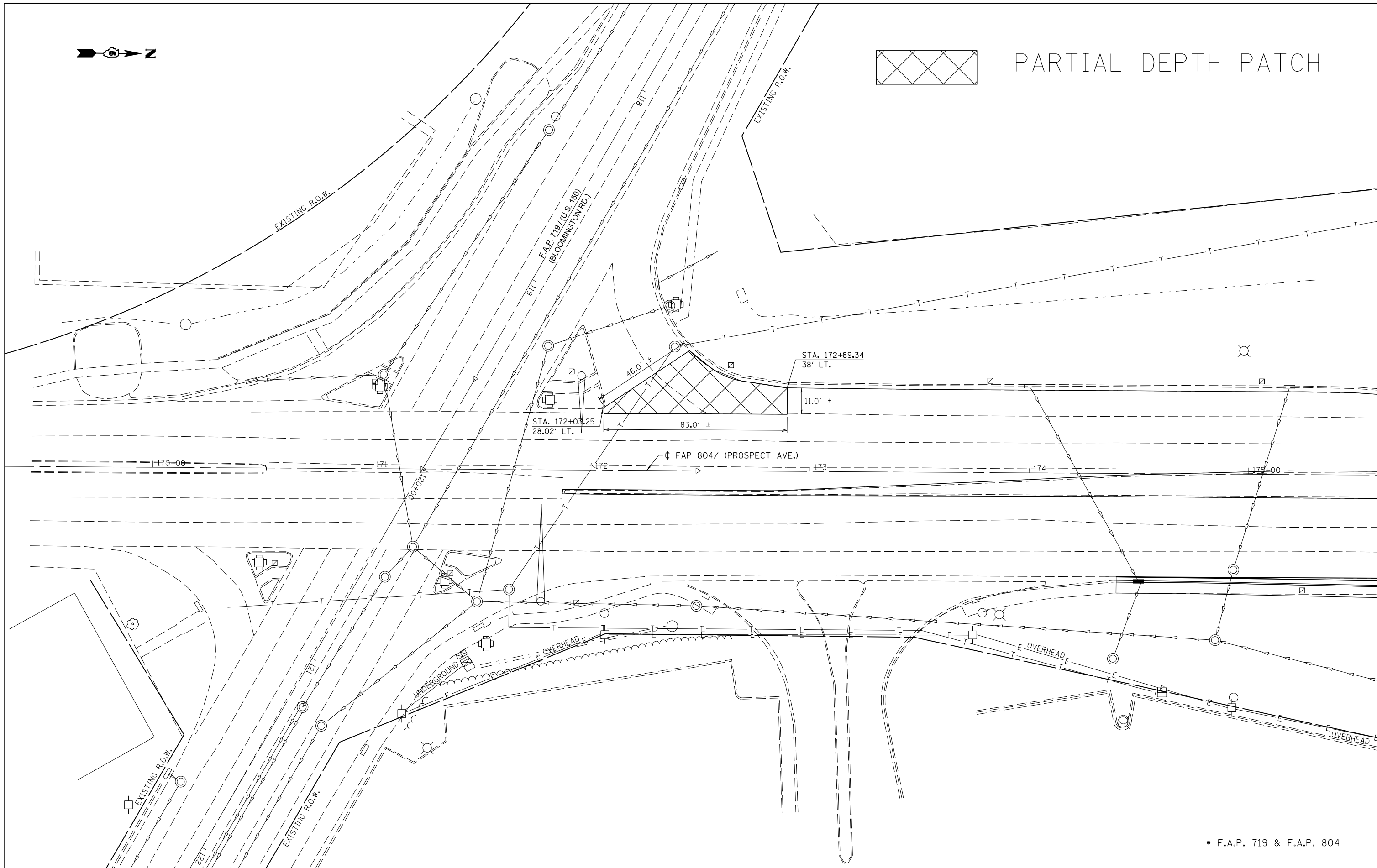

* F.A.P. 719 & F.A.P. 804

| | | | |
|--|-----------------------------|------------|-----------|
| FILE NAME = | USER NAME = bakercr | DESIGNED - | REVISED - |
| ei:\pw\work\p\dot\bakercr\d0345555\0570437-sht-details.dgn | | DRAWN - | REVISED - |
| | PLOT SCALE = 40.0000' / in. | CHECKED - | REVISED - |
| \$MODELNAME\$ | PLOT DATE = 5/22/2013 | DATE - | REVISED - |

STATE OF ILLINOIS
DEPARTMENT OF TRANSPORTATION

PLAN DETAIL FOR F.A.P. 804 / (PROSPECT AVE.)
LOCATOIN #2

SCALE: SHEET 1 OF 1 SHEETS STA. TO STA.

| F.A.P. RTE. | SECTION | COUNTY | TOTAL SHEETS | SHEET NO. |
|---------------------------|--------------------|-----------|--------------------|-----------|
| • | D5 PATCHING 2014-3 | CHAMPAIGN | 9 | 8 |
| | | | CONTRACT NO. 70A37 | |
| ILLINOIS FED. AID PROJECT | | | | |