

STATE OF ILLINOIS
DEPARTMENT OF TRANSPORTATION
DIVISION OF HIGHWAYS

**PROPOSED
HIGHWAY PLANS**

**F.A.P. RTE. 719 / (U.S. 150) & F.A.P. RTE. 804 / (PROSPECT AVE.)
SECTION D5 PATCHING 2014-3
PATCHING
CHAMPAIGN COUNTY**

C-95-028-13
I-57 TO MATTIS AVE. AND SOUTHBOUND TURN LANE AT BLOOMINGTON ROAD

F.A.P. RTE.	SECTION	COUNTY	TOTAL SHEETS	SHEET NO.
•	D5 PATCHING 2014-3	CHAMPAIGN	9	1
		ILLINOIS	CONTRACT NO. 70A37	

• F.A.P. 719 & F.A.P. 804

05-95-028-13

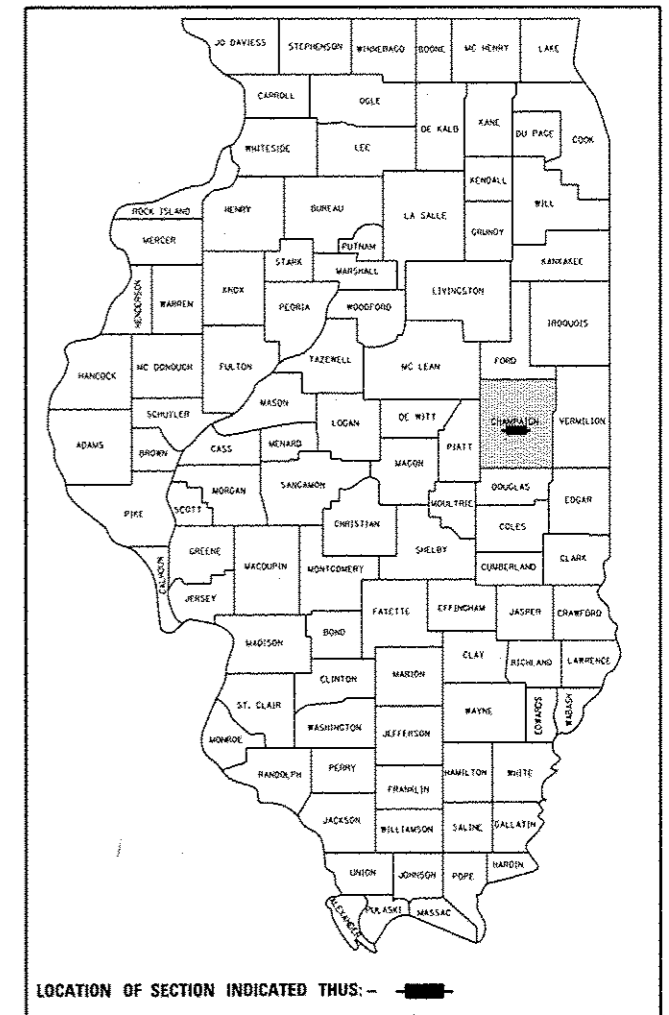

FOR INDEX OF SHEETS, SEE SHEET NO. 2
FOR SUMMARY OF QUANTITIES, SEE SHEET NO. 4

CURRENT TRAFFIC DATA

- LOCATION #1: F.A.P. RTE. 719 / (U.S. 150)
FROM I-57 OVERPASS TO MATTIS AVE.
AVERAGE ADT = 8,100
- LOCATION #2: F.A.P. RTE. 804 / (PROSPECT AVE.)
FROM I-74 EB RAMPS TO U.S. 150
(BLOOMINGTON RD.)
AVERAGE ADT = 28,300

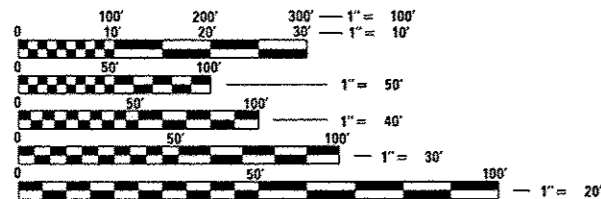
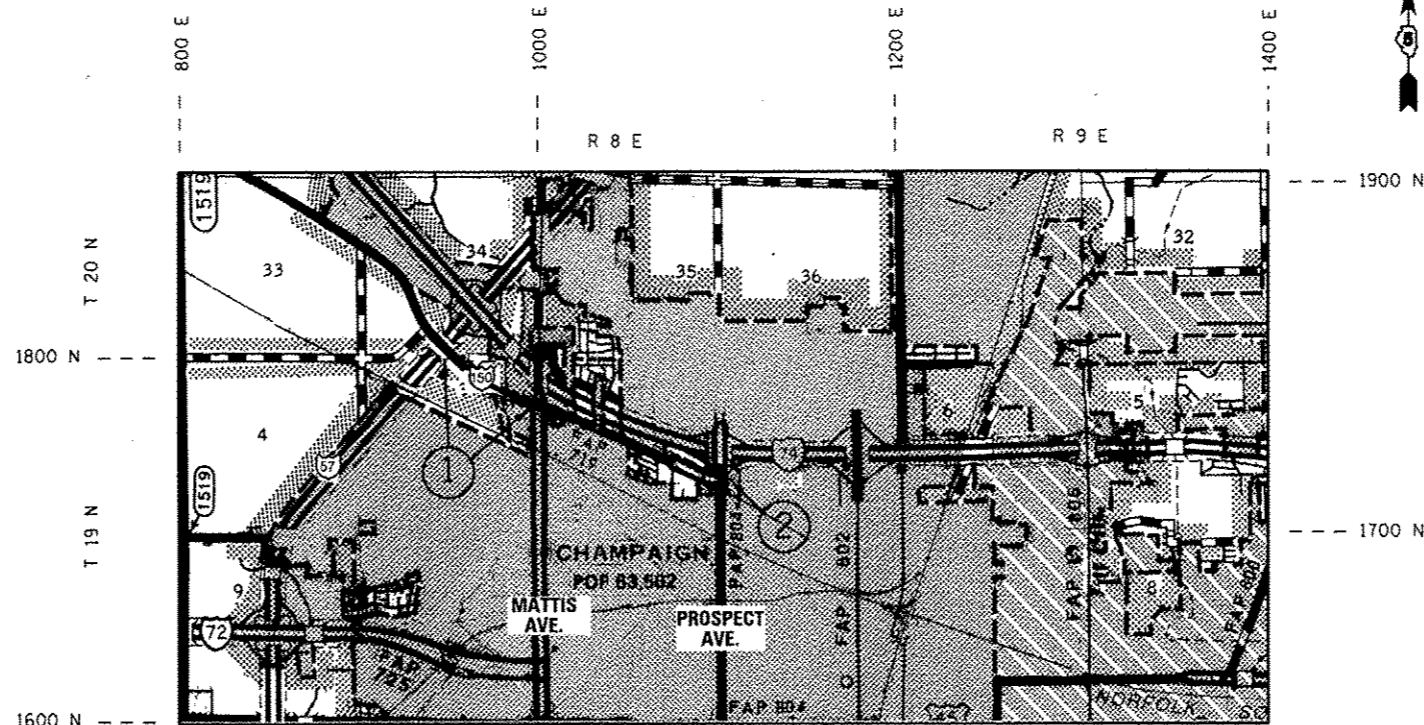

FULL SIZE PLANS HAVE BEEN PREPARED USING STANDARD ENGINEERING SCALES. REDUCED SIZED PLANS WILL NOT CONFORM TO STANDARD SCALES. IN MAKING MEASUREMENTS ON REDUCED PLANS, THE ABOVE SCALES MAY BE USED.

J.U.L.I.E.
JOINT UTILITY LOCATION INFORMATION FOR EXCAVATION
1-800-892-0123
OR 811

PROJECT ENGINEER: JASON STULTS
SQUAD LEADER: GREG EAGLIN
DESIGNER: CARL BAKER
PHONE NUMBER: (217)-465-4181

CONTRACT NO. 70A37

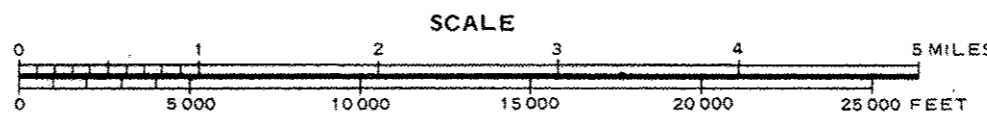

GROSS LENGTH = 4889.10 FT. = 0.926 MILES
NET LENGTH = 3148.90 FT. = 0.596 MILES

SEE PAGE 3 FOR LOCATION MAPS, GROSS & NET LENGTHS OF PROJECT BY LOCATION

STATE OF ILLINOIS
DEPARTMENT OF TRANSPORTATION
DIVISION OF HIGHWAYS

SUBMITTED 0522 20 13

Joseph E. Crowe, CK4G
DEPUTY DIRECTOR OF HIGHWAYS, REGION ENGINEER

John D. Raramelli, PE
ENGINEER OF DESIGN AND ENVIRONMENT

June 28 20 13

Omer Osman, PE
DIRECTOR OF HIGHWAYS, CHIEF ENGINEER

**PRINTED BY THE AUTHORITY
OF THE STATE OF ILLINOIS**

INDEX OF SHEETS

SHEET NO.	DESCRIPTION
1	COVER SHEET
2	INDEX OF SHEETS
2	LIST OF STANDARDS
2	GENERAL NOTES
3	LOCATION MAPS
4	SUMMARY OF QUANTITIES
5-6	EXISTING TYPICAL CROSS SECTIONS
7	SCHEDULE OF QUANTITIES
8	PLAN DETAIL FOR F.A.P. 804 / (PROSPECT AVE.)
9	PCC PARTIAL DEPTH HOT-MIX ASPHALT PATCHING

LIST OF STANDARDS

STANDARD NO.	NAME OF STANDARD
000001-06	STANDARD SYMBOLS, ABBREVIATIONS AND PATTERNS
001001-02	AREAS OF REINFORCEMENT BARS
001006	DECIMAL OF AN INCH AND OF A FOOT
420001-07	PAVEMENT JOINTS
420701-02	PAVEMENT FABRIC
442101-07	CLASS B PATCHES
701501-06	URBAN LANE CLOSURE, 2L, 2W, UNDIVIDED
701701-08	URBAN LANE CLOSURE, MULTILANE INTERSECTION
701901-02	TRAFFIC CONTROL DEVICES

GENERAL NOTES

G.N. -100
ENGLISH UNITS OF MEASUREMENT SHALL GOVERN OVER AND SUPERSEDE ANY METRIC UNITS SHOWN IN THIS CONTRACT. WHERE INCLUDED, METRIC UNITS ARE FOR INFORMATION ONLY.

G.N. -100A
ELECTRONIC FILES AND/OR ELECTRONIC SURVEY INFORMATION INCLUDING CADD FILES WILL NOT BE AVAILABLE TO THE CONTRACTOR.

G.N. -406H
Mixture Requirements

Location	Prospect Ave.	Prospect Ave.
Mixture Use	Partial Depth Patch (top 1 1/2")	* Partial Depth Patch (bottom 4")
AC/PG	SBS PG 70-22	SBS PG 70-22
RAP % (Max)	See RAP-RAS S.P.	See RAP-RAS S.P.
Design Air Voids	4.0% @ Ndes=90	4.0% @ Ndes=90
Mix Comp(Gradation)	IL 9.5	IL 19.0 FG
Friction Aggregate	Mix D	N.A.

* Polymer Mix D N90 may be used for the entire thickness of the partial depth patch at the contractor's option. If surface mix is used for the total thickness the maximum allowed lift will be 2".

G.N.-442B --PATCHING SCHEDULES
THE PATCHING SCHEDULES INCLUDED IN THE PLANES REPRESENT THE BEST INFORMATION AVAILABLE AT THE TIME OF COMPLETION OF THE PLANS FOR LETTING. VARIATIONS IN LOCATION AND SIZES OF BOTH FULL-DEPTH AND PARTIAL-DEPTH PATCHES MAY OCCUR.

G.N. 1004.01
COARSE AGGREGATE GRADATION CA-10 MAY BE USED WHENEVER COARSE AGGREGATE CA-6 IS SPECIFIED IN THE STANDARD SPECIFICATIONS.

NO COMMITMENTS

• F.A.P. 719 & F.A.P. 804

FILE NAME :	USER NAME : bakercr	DESIGNED -	REVISED -	STATE OF ILLINOIS DEPARTMENT OF TRANSPORTATION	INDEX OF SHEETS /LIST OF STANDARDS GENERAL NOTES	F.A.P.	SECTION	COUNTY	TOTAL SHEETS	SHEET NO.
c:\pwork\pwidet\bakercr\0345555\057637-shs-gennote.dgn	DRAWN -	REVISED -	*			05 PATCHING 2014-3	CHAMPAIGN	9	2	
PLOT SCALE : 40,0000' / in.	CHECKED -	REVISED -				CONTRACT NO. 70A37				
PLOT DATE : 5/22/2013	DATE -	REVISED -	SCALE:			SHEET 1 OF 1 SHEETS	STA. TO STA.	ILLINOIS FED. AID PROJECT		

LOCATION MAP #1
F.A.P. RTE. 719 / (U.S. 150)



LOCATION #1 BEGINS:
 STA. 140+00.00

STRUCTURE OMISSION:
 S.N. 010-0050
 STA. 149+59.31 TO
 STA. 166+99.51

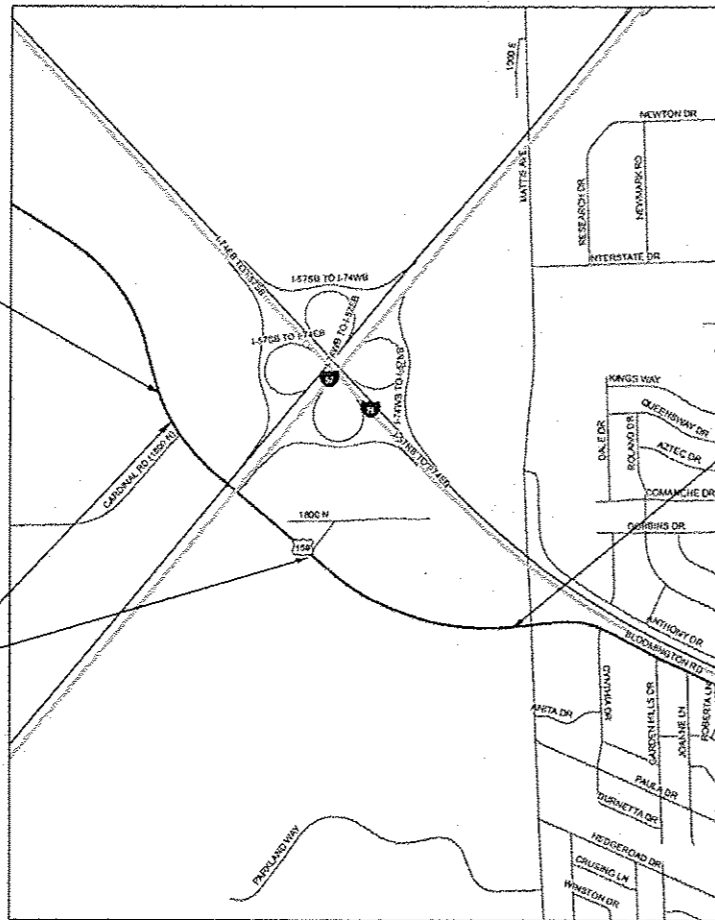

LOCATION #1 ENDS:
 STA. 183+94.00

CHAMPAIGN
 TOWNSHIP

GROSS LENGTH OF LOCATION #1 = 4394.00 FT = 0.832 MILES
 NET LENGTH OF LOCATION #1 = 2653.80 FT = 0.503 MILES

LOCATION MAP #2
F.A.P. RTE. 804 / (PROSPECT AVE.)



LOCATION #1 ENDS:
 STA. 176+98.35

LOCATION #2 BEGINS:
 STA. 172+03.25

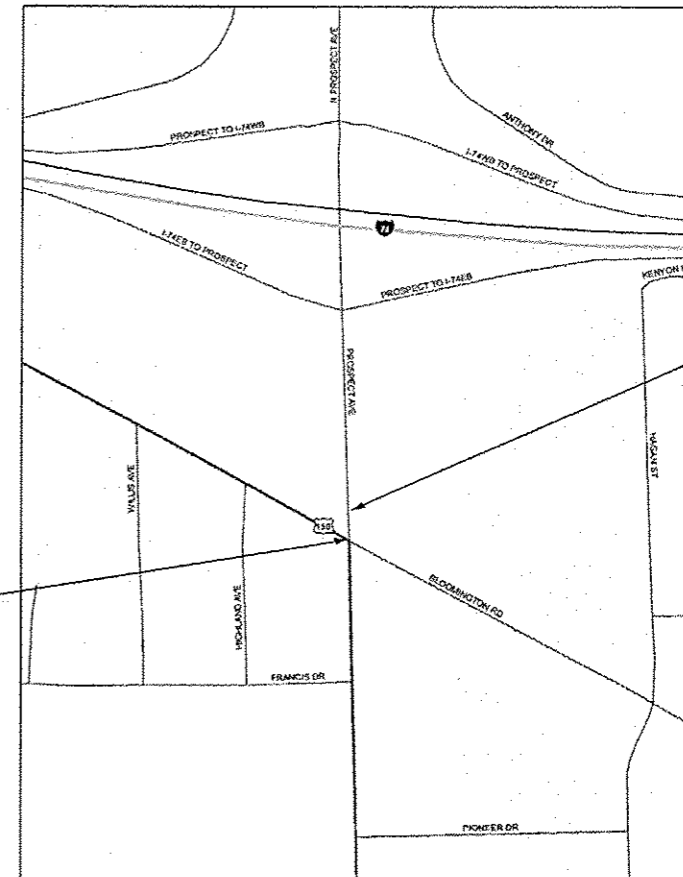

CHAMPAIGN
 TOWNSHIP

GROSS LENGTH OF LOCATION #1 = 495.10 FT = 0.094 MILES
 NET LENGTH OF LOCATION #1 = 495.10 FT = 0.094 MILES

*F.A.P. 719 & F.A.P. 804

FILE NAME :	USER NAME :	DESIGNED -	REVISED -
c:\p\work\p\dot\baker\100345555\0571	137-shr-location map.dgn	DRAWN -	REVISED -
	PLOT SCALE = 40,0000 1/ in.	CHECKED -	REVISED -
#MODELNAME :	PLOT DATE = 5/22/2013	DATE -	REVISED -

STATE OF ILLINOIS
 DEPARTMENT OF TRANSPORTATION

LOCATION MAPS

SCALE: SHEET 1 OF 1 SHEETS STA. TO STA.

F.A.P. RTE.	SECTION	COUNTY	TOTAL SHEETS	SHEET NO.
*	DS PATCHING 2014-3	CHAMPAIGN	9	3
CONTRACT NO. 70A37				
ILLINOIS FED. AID PROJECT				

SUMMARY OF QUANTITIES

LOCATION OF WORK:	LOCATION #1 F.A.P. ROUTE 719 U.S. 150	LOCATION #2 F.A.P. ROUTE 804 PROSPECT AVE
COUNTY:	CHAMPAIGN URBAN PATCHING	CHAMPAIGN URBAN PATCHING
FUNDING BREAK OUT:	100% STATE	100% STATE
CONSTRUCTION TYPE CODE:	0005	0005

CODE NO.	ITEM	UNIT	TOTAL QUANTITY	QUANTITY	QUANTITY
44022039	PARTIAL DEPTH REMOVAL 5 1/2"	SQ YD	150.0	0.0	150.0
44200956	CLASS B PATCHES, TYPE II, 9 INCH	SQ YD	731.0	731.0	0.0
44200964	CLASS B PATCHES, TYPE IV, 9 INCH	SQ YD	153.0	153.0	0.0
44201299	DOWEL BARS, 1 1/2"	EACH	1881.0	1881.0	0.0
44213100	PAVEMENT FABRIC	SQ YD	153.0	153.0	0.0
44213200	SAW CUTS	FOOT	5529.0	5529.0	0.0
44213204	TIE BARS, 3/4"	EACH	125.0	125.0	0.0
67100100	MOBILIZATION	L SUM	1.0	0.8	0.2
70102620	TRAFFIC CONTROL AND PROTECTION, STANDARD 701501	L SUM	1.0	1.0	0.0
70102635	TRAFFIC CONTROL AND PROTECTION, STANDARD 701701	L SUM	1.0	0.0	1.0
X4421000	PARTIAL DEPTH PATCHING	TON	47.0	0.0	47.0
X7015005	CHANGEABLE MESSAGE SIGN	CAL DA	5.0	0.0	5.0

* F.A.P. 719 & F.A.P. 804

FILE NAME *	USER NAME * baker	DESIGNED -	REVISED -	STATE OF ILLINOIS DEPARTMENT OF TRANSPORTATION	SUMMARY OF QUANTITIES			F.A.P. RTE.	SECTION	COUNTY	TOTAL SHEETS	SHEET NO.	
c:\pwork\puidot\baker\140345555\0570	137-shl-500.dgn	DRAWN -	REVISED -		SCALE:	SHEET 1	OF 1	SHEETS	STA.	TO STA.	CHAMPAIGN	9	4
	PLOT SCALE * 40.0000 / / in.	CHECKED -	REVISED -		CONTRACT NO. 70A37								
#MODELNAME*	PLOT DATE * 5/22/2013	DATE -	REVISED -		ILLINOIS FED. AID PROJECT								

① EXISTING TYPICAL CROSS SECTION

F.A.P. RTE. 719 / (U.S. 150)

STATION 140+00.00 TO STATION 173+50.00 ②

STRUCTURE OMISSION:
S. N. 010-0050
STA. 149+59.31 TO
STA. 166+99.51

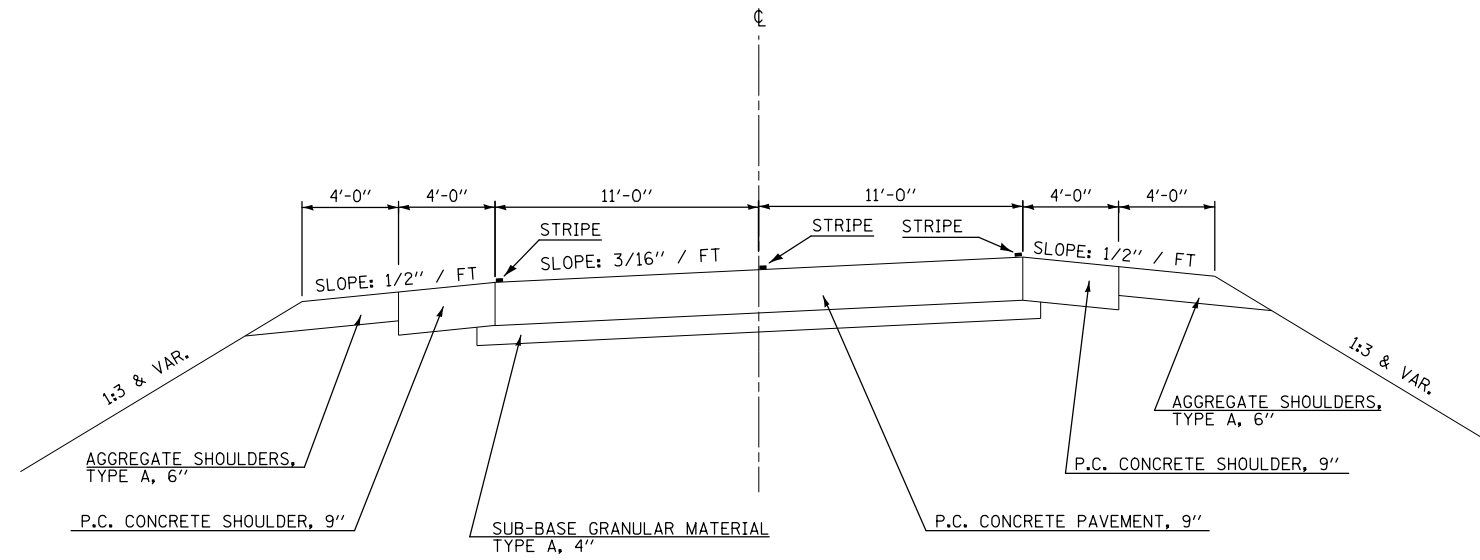

② EXISTING TYPICAL CROSS SECTION

F.A.P. RTE. 719 / (U.S. 150)

STATION ① 173+50.00 TO STATION 183+94.00

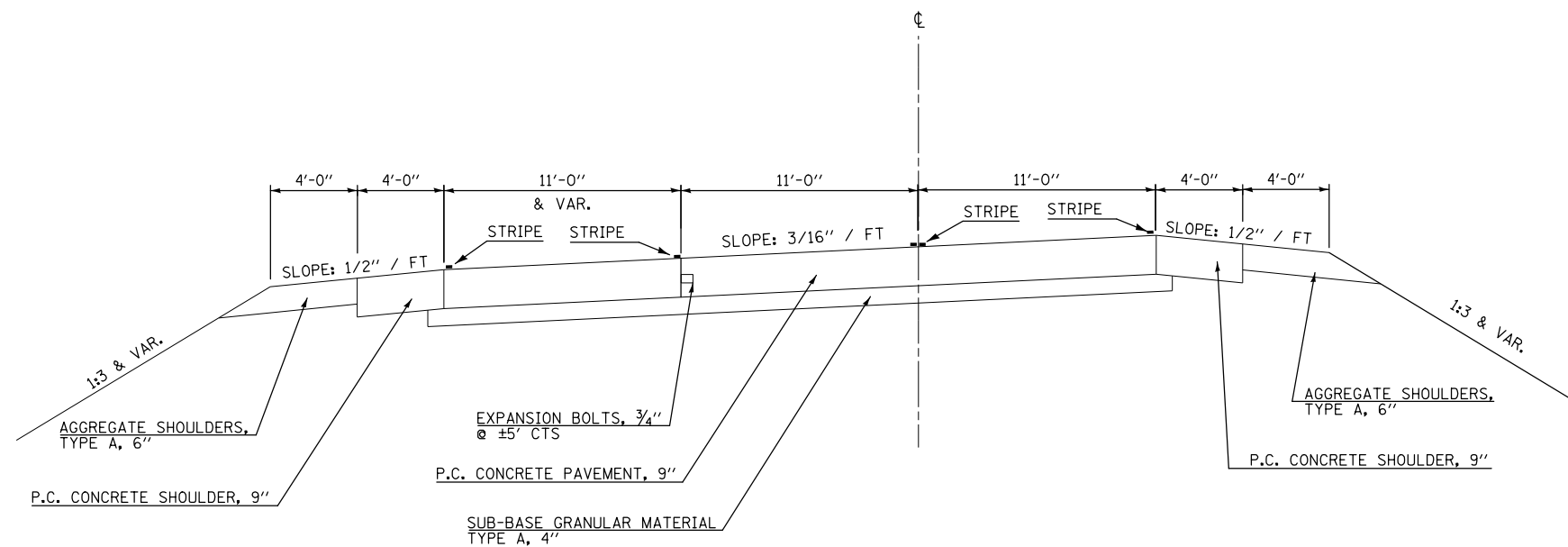

* F.A.P. 719 & F.A.P. 804

FILE NAME =	USER NAME = bakercr	DESIGNED -	REVISED -	STATE OF ILLINOIS DEPARTMENT OF TRANSPORTATION	EXISTING TYPICAL CROSS SECTION F.A.P. RTE. 719 / (U.S.150)			F.A.P. RTE.	SECTION	COUNTY	TOTAL SHEETS	SHEET NO.
et:\pw\work\p\dot\bakercr\d0345555\0570437-sht-typical.dgn	PLOT SCALE = 40.0000' / in.	DRAWN -	REVISED -					•	D5 PATCHING 2014-3	CHAMPAIGN	9	5
#MODELNAME#	PLOT DATE = 5/22/2013	CHECKED -	REVISED -		SCALE:	SHEET 1	OF 1 SHEETS	STA.	TO STA.	CONTRACT NO. 70A37		
		DATE -	REVISED -							ILLINOIS FED. AID PROJECT		

① EXISTING TYPICAL CROSS SECTION

F.A.P. RTE. 804 / (PROSPECT AVE.)

STATION 172+03.25 TO STATION 174+82.23 ②

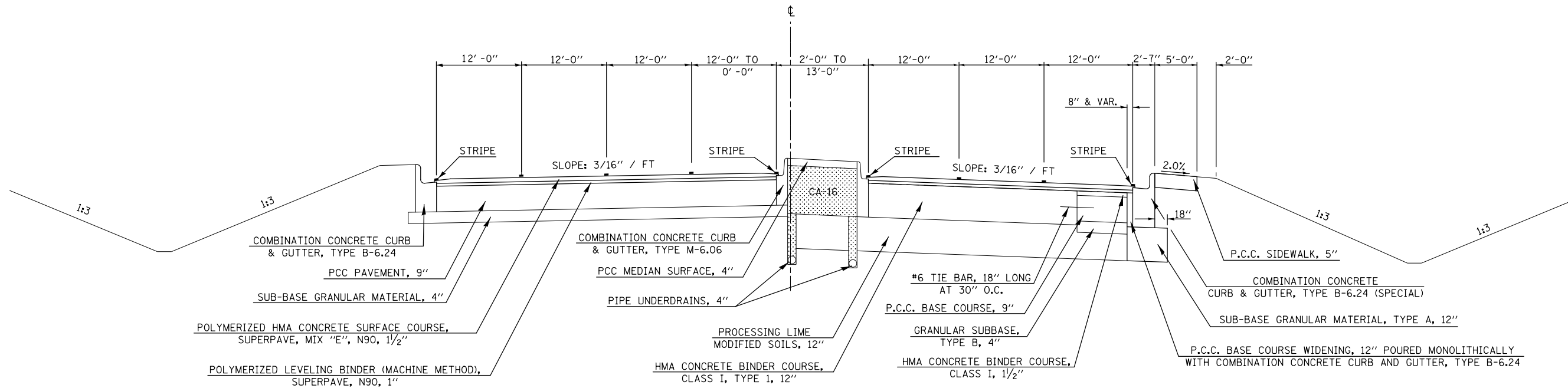

② EXISTING TYPICAL CROSS SECTION

F.A.P. RTE. 804 / (PROSPECT AVE.)

① STATION 174+82.23 TO STATION 176+98.35

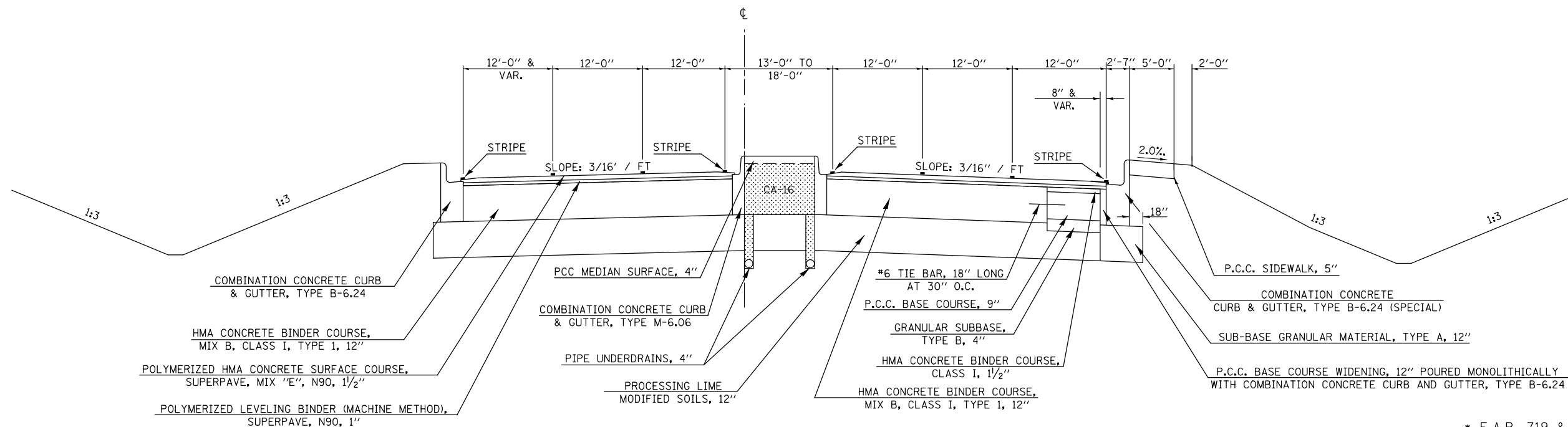

* F.A.P. 719 & F.A.P. 804

FILE NAME =	USER NAME = bakercr	DESIGNED -	REVISED -	STATE OF ILLINOIS DEPARTMENT OF TRANSPORTATION	EXISTING TYPICAL CROSS SECTION F.A.P. RTE. 804 / (PROSPECT AVE.)			F.A.P. RTE.	SECTION	COUNTY	TOTAL SHEETS	SHEET NO.
et:\pwork\pwork\bakercr\d0345555\0570437-sht-typical.dgn		DRAWN -	REVISED -		SCALE:	SHEET 1	OF 1	SHEETS	STA.	TO STA.	ILLINOIS	FED. AID PROJECT
		CHECKED -	REVISED -									
		DATE -	REVISED -									

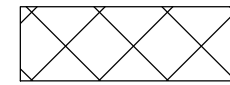

PARTIAL DEPTH PATCH

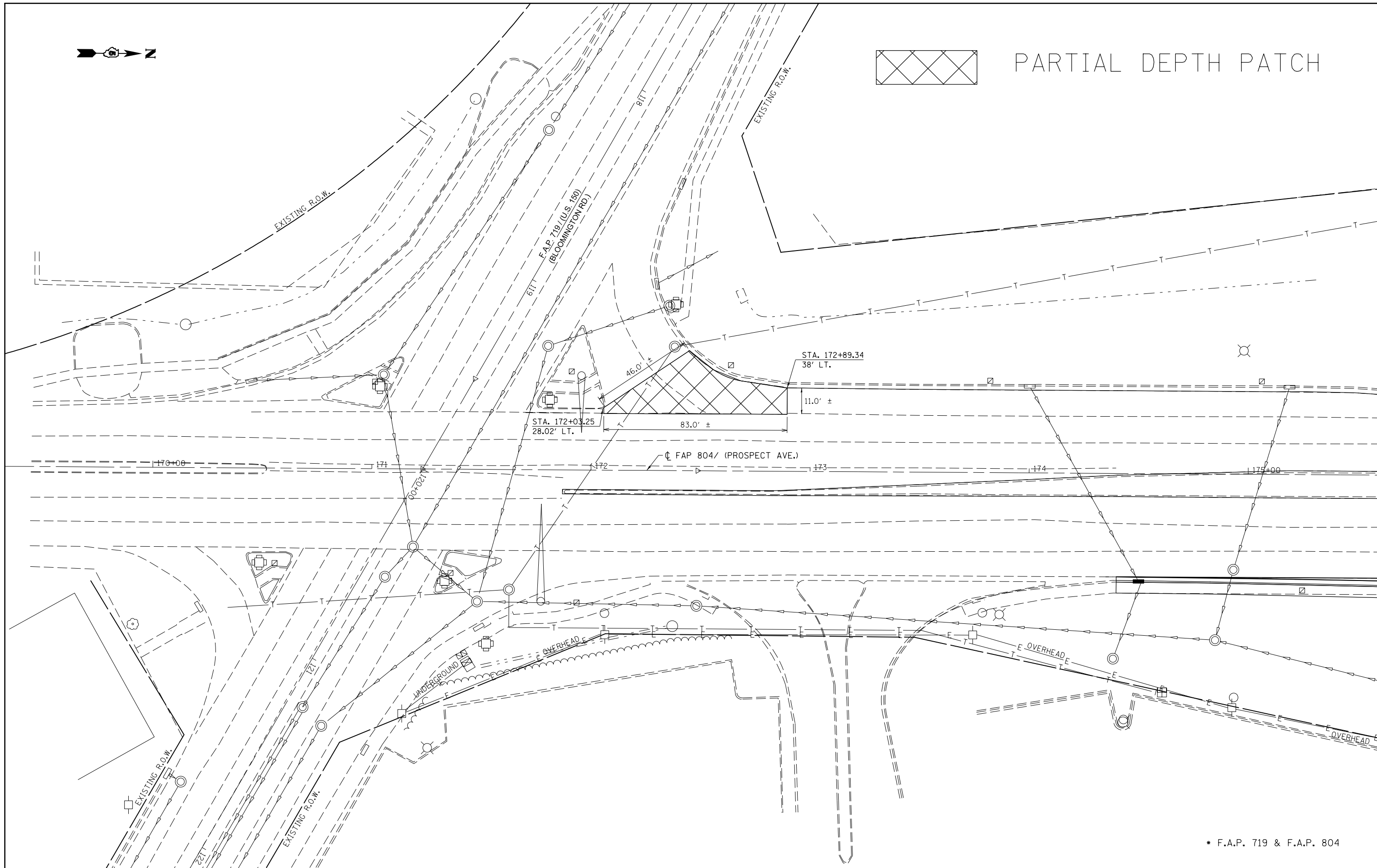

* F.A.P. 719 & F.A.P. 804

FILE NAME =	USER NAME = bakercr	DESIGNED -	REVISED -
ei:\pw\work\p\idot\bakercr\d0345555\0570437-sht-details.dgn		DRAWN -	REVISED -
\$MODELNAME\$	PLOT SCALE = 40.0000' / in.	CHECKED -	REVISED -
	PLOT DATE = 5/22/2013	DATE -	REVISED -

**STATE OF ILLINOIS
DEPARTMENT OF TRANSPORTATION**

**PLAN DETAIL FOR F.A.P. 804 / (PROSPECT AVE.)
LOCATOIN #2**

SCALE: SHEET 1 OF 1 SHEETS STA. TO STA.

F.A.P. RTE.	SECTION	COUNTY	TOTAL SHEETS	SHEET NO.
*	D5 PATCHING 2014-3	CHAMPAIGN	9	8
			CONTRACT NO. 70A37	
ILLINOIS FED. AID PROJECT				

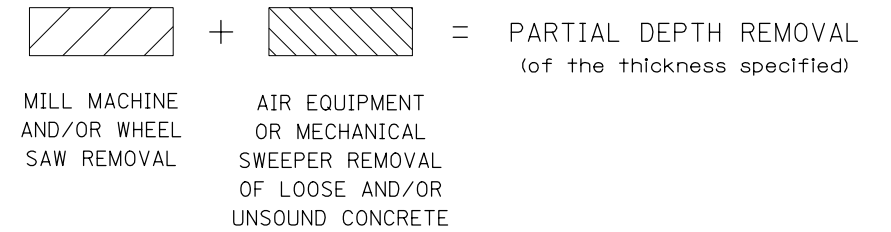
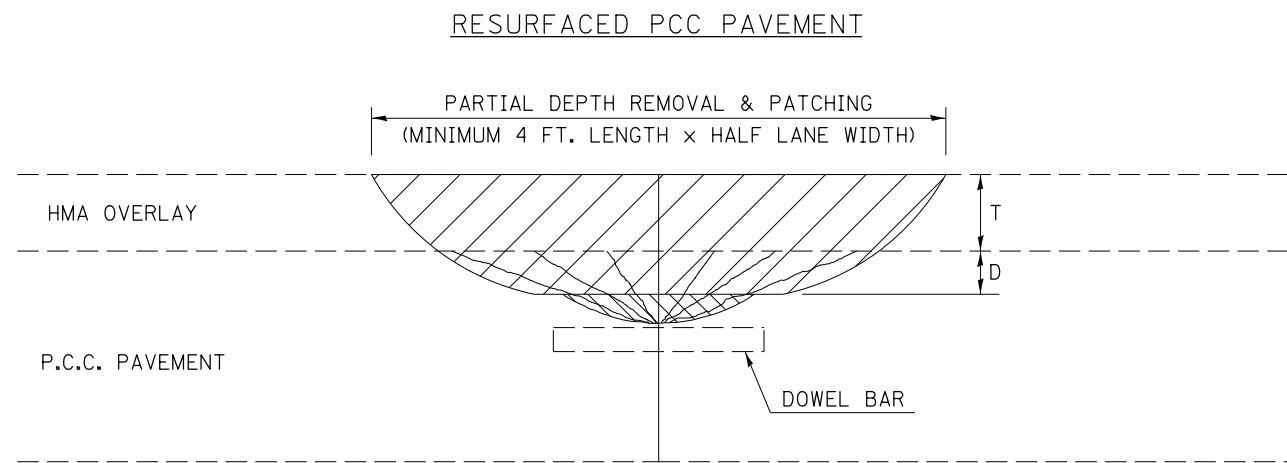

DESIGN NOTES

PARTIAL DEPTH HMA PATCHING SHALL NOT BE USED WHEN HMA OVERLAY THICKNESS (T) ON PCC PAVEMENT EXCEEDS 4 3/4 INCHES (121 mm) OR ON CRC PAVEMENT.

GENERAL NOTES

ALL VOLUME OF PARTIAL DEPTH REMOVAL SHALL BE REPLACED WITH HOT-MIX ASPHALT (HMA) AND PAID FOR AT THE CONTRACT UNIT PRICE PER TON FOR PARTIAL DEPTH PATCHING.

T = THICKNESS OF HMA OVERLAY(S). SEE EXISTING TYPICAL CROSS SECTION.

GENERAL NOTE 406H SHALL INCLUDE MIXTURE REQUIREMENTS FOR PARTIAL DEPTH PATCHING.

HMA REPLACEMENT IN RESURFACED PCC PAVEMENT LOCATIONS SHALL BE ACCORDING TO SECTION 406 OF THE STANDARD SPECIFICATIONS.

D = DEPTH OF PARTIAL DEPTH REMOVAL INTO EXISTING PCC PAVEMENT. (3" (75 mm) ± OR TO SOUND CONCRETE)

TRANSVERSE CONTRACTION JOINT SHOWN - OTHER LOCATIONS SIMILAR.

* F.A.P. 719 & F.A.P. 804

Note: All dimensions are in INCHES (millimeters) unless otherwise shown.

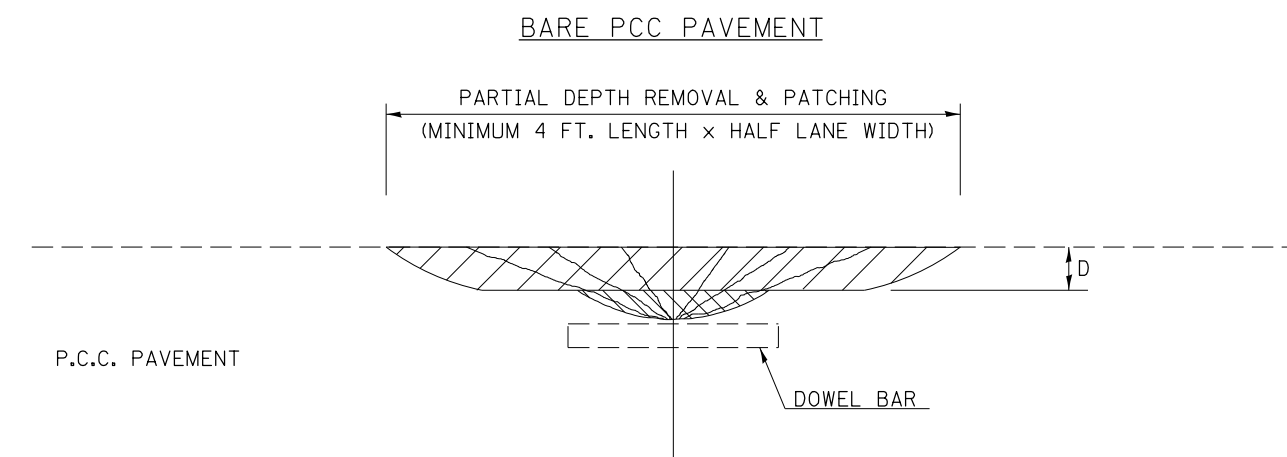

FILE NAME =	USER NAME = bakercr	DESIGNED -	REVISED - 11/06
et:\pw\work\p\idot\bakercr\d0345555\0570437-sht-details.dgn		DRAWN -	REVISED - 10/10
	PLOT SCALE = 40.0000' / in.	CHECKED -	REVISED -
	PLOT DATE = 5/22/2013	DATE -	REVISED -

**STATE OF ILLINOIS
DEPARTMENT OF TRANSPORTATION**

PCC PARTIAL DEPTH HOT-MIX ASPHALT PATCHING

SCALE: SHEET NO. 1 OF 1 SHEETS STA. TO STA.

DISTRICT 5 DETAIL NO. XX442100

F.A.P. RTE.	SECTION	COUNTY	TOTAL SHEETS	SHEET NO.
*	D5 PATCHING 2014-3	CHAMPAIGN	9	9
FED. ROAD DIST. NO. ILLINOIS FED. AID PROJECT			CONTRACT NO. 70A37	