

PLAN	SURVEYED	DATE
	ALIGNED	
	NOTED	
	CHECKED	
	FILED	
	NO.	

PROFILE	SURVEYED	DATE
	GRADES	
	CHECKED	
	STRUCTURE	
	NOTATIONS	
	CHKD	
	NO.	

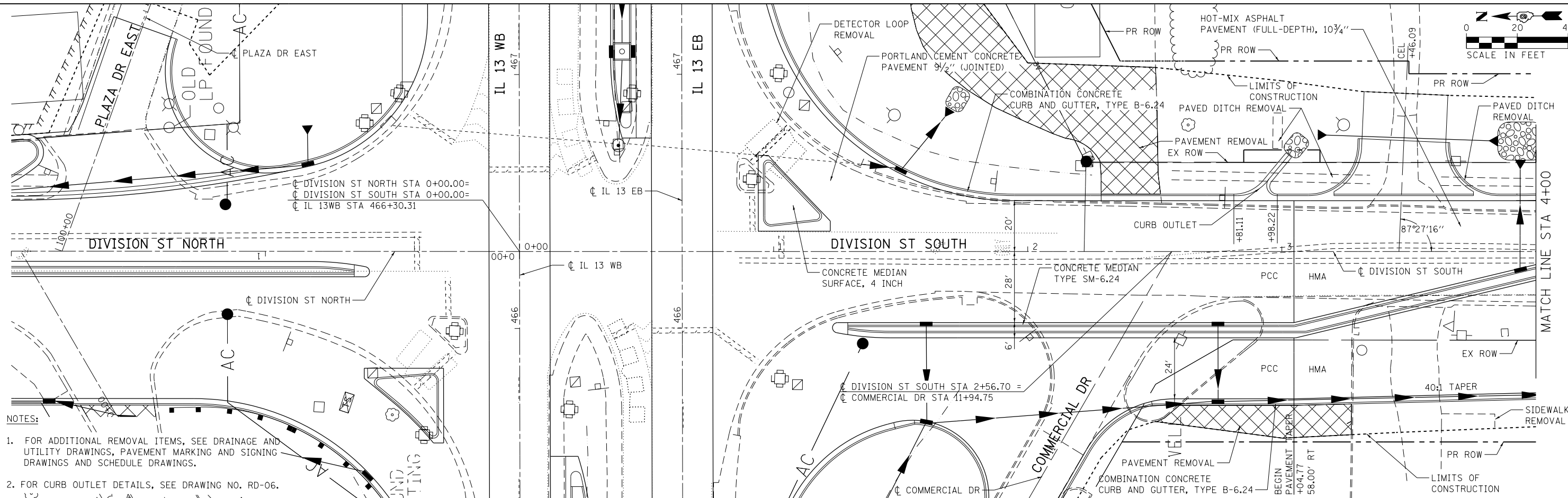

- NOTES:
- FOR ADDITIONAL REMOVAL ITEMS, SEE DRAINAGE AND UTILITY DRAWINGS, PAVEMENT MARKING AND SIGNING DRAWINGS AND SCHEDULE DRAWINGS.
 - FOR CURB OUTLET DETAILS, SEE DRAWING NO. RD-06.

BENCHMARK		
BENCHMARK	ELEVATION	DESCRIPTION
BM10	440.60	CUT SQUARE ON THE SE CORNER OF THE FOUNDATION OF AN ABOVE GROUND SIGNAL CONTROL BOX IN THE NW QUADRANT OF RTE 13 WBL AND DIVISION ST, AT CARTERVILLE 69.05' LEFT OF THE CL OF RTE 13 WBL @ STA. 465+73.58

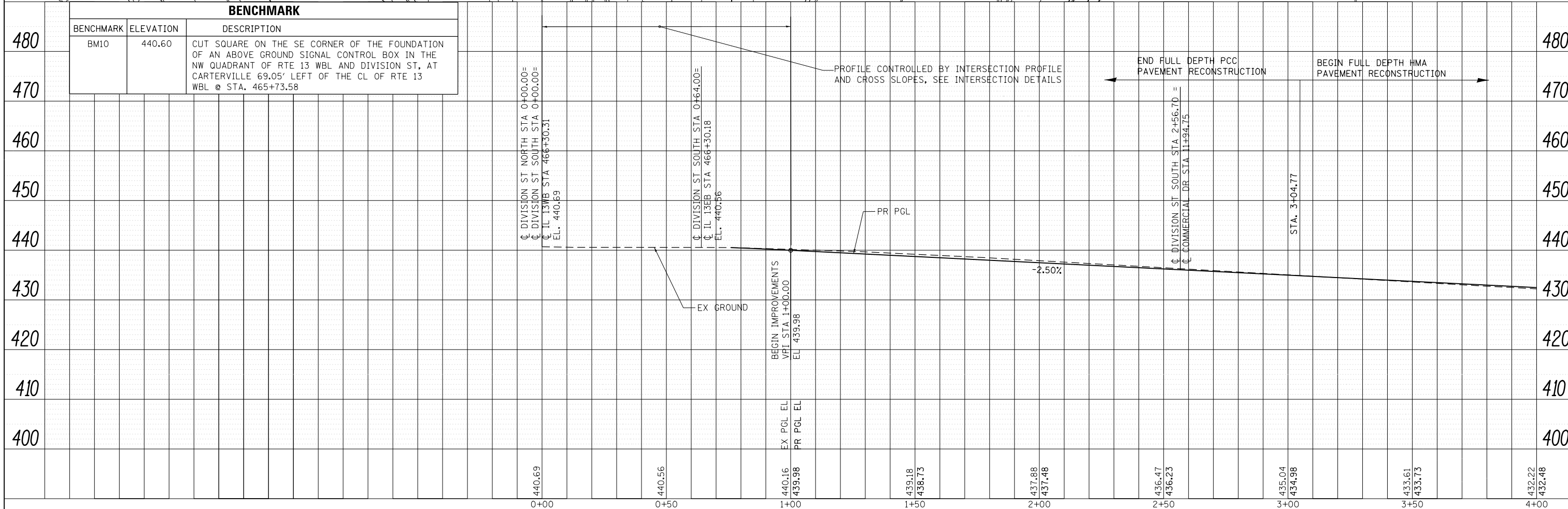

FILE NAME = D978258-sh1-plnprf-17.dgn
CH2MHILL

USER NAME = mfox
 PLOT SCALE = 40.0000' / in.
 PLOT DATE = 3/11/2013

DESIGNED - KN
 DRAWN - AS
 CHECKED -
 DATE -

REVISED -
 REVISED -
 REVISED -
 REVISED -

**STATE OF ILLINOIS
 DEPARTMENT OF TRANSPORTATION**

**ROADWAY PLAN AND PROFILE
 DIVISION STREET SOUTH**

SCALE: SHEET NO. 17 OF 32 SHEETS STA. 0+00.00 TO STA. 4+00.00

F.A.P. RTE.	SECTION	COUNTY	TOTAL SHEETS	SHEET NO.
331	(1-4)R-2, N-4, TS-4	WILLIAMSON	381	113
DRAWING NO. PL-17		CONTRACT NO. 78258		
ILLINOIS FED. AID PROJECT				