

| | |
|---------------|--|
| DATE | |
| BY | |
| SURVEYED | |
| PLOTTED | |
| TEMPLATE | |
| NOTE BOOK | |
| AREAS CHECKED | |
| NO. | |

| | |
|---------------|--|
| DATE | |
| BY | |
| SURVEYED | |
| PLOTTED | |
| TEMPLATE | |
| NOTE BOOK | |
| AREAS CHECKED | |
| NO. | |

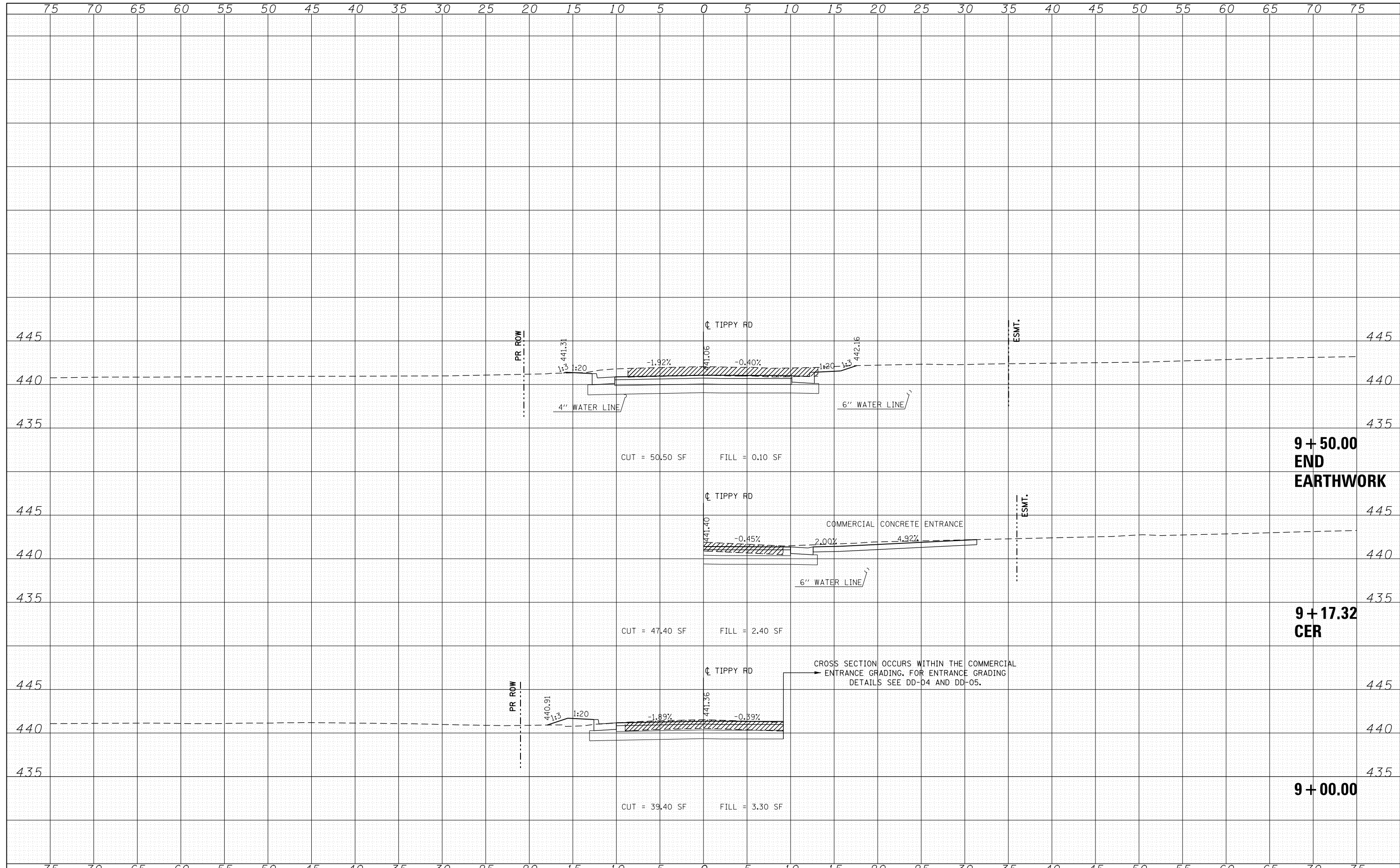

FILE NAME = D978258-sh-t-xssht-Tippy.dgn
CH2MHILL

| | | |
|-----------------------------|---------------|-----------|
| USER NAME = mfox | DESIGNED - KN | REVISED - |
| | DRAWN - AS | REVISED - |
| PLOT SCALE = 10.0000' / in. | CHECKED - | REVISED - |
| PLOT DATE = 1/31/2013 | DATE - | REVISED - |

**STATE OF ILLINOIS
DEPARTMENT OF TRANSPORTATION**

**PROPOSED CROSS SECTIONS
TIPPY ROAD**

SCALE: SHEET NO. 2 OF 2 SHEETS STA. 9+00.00 TO STA. 9+50.00

| F.A.P. RTE. | SECTION | COUNTY | TOTAL SHEETS | SHEET NO. |
|---------------------------|---------------------|------------|--------------------|-----------|
| 331 | (1-4)R-2, N-4, TS-4 | WILLIAMSON | 381 | 352 |
| DRAWING NO. XS-084 | | | CONTRACT NO. 78258 | |
| ILLINOIS FED. AID PROJECT | | | | |