

SUMMARY OF QUANTITIES

PAY ITEM NUMBER	PAY ITEM	UNIT	QUANTITY	CONST. TYPE CODE
20200100	EARTH EXCAVATION	CU.YD.	785	0021
*20800150	TRENCH BACKFILL	CU.YD.	2	2
28000510	INLET FILTERS	EACH	40	40
*42400800	DETECTABLE WARNINGS	SQ.FT.	440	440
44000200	DRIVEWAY PAVEMENT REMOVAL	SQ.YD.	272	272
44000600	SIDEWALK REMOVAL	SQ.FT.	5,162	5,162
44201676 Δ	CLASS D PATCHES, TYPE IV, 2 INCH	SQ.YD.	74	74
44201692 A	CLASS D PATCHES, TYPE II, 4 INCH	SQ.YD.	11	11
*55080040	STORM SEWERS, CLASS B, TYPE 1, 10"	FOOT	217	217
*55080070	STORM SEWERS, CLASS B, TYPE 1, 15"	FOOT	133	133
56109210 Δ	WATER VALVES TO BE ADJUSTED	EACH	1	1
60100915	PIPE DRAINS, 6"	FOOT	10	10
60100925	PIPE DRAINS, 8"	FOOT	4	4
60100935	PIPE DRAINS, 10"	FOOT	5	5
*60108300	PIPE UNDERDRAINS 8" (SPECIAL)	FOOT	2	2
*60236200	INLETS, TYPE A, TYPE B GRATE	EACH	4	4
71100100	MOBILIZATION	L.SUM	1	1
70102620	TRAFFIC CONTROL AND PROTECTION, STANDARD 701501	L.SUM	1	1
70102640	TRAFFIC CONTROL AND PROTECTION, STANDARD 701801	L.SUM	1	1
72400500	RELOCATE SIGN PANEL ASSEMBLY - TYPE A	EACH	8	8
78001130 Δ	PAINT PAVEMENT MARKING - LINE 6"	FOOT	1,098	1,098
78001150 Δ	PAINT PAVEMENT MARKING - LINE 12"	FOOT	179	179
*X4240420	PORTLAND CEMENT CONCRETE SIDEWALK 4 INCH, SPECIAL	SQ.FT.	29,741	29,741
*X4240440	PORTLAND CEMENT CONCRETE SIDEWALK 6 INCH, SPECIAL	SQ.FT.	4,575	4,575
*X4402400	CURB REMOVAL (SPECIAL)	FOOT	5	5
*X6024240	INLETS, SPECIAL	EACH	2	2
*XX006425	RESTORATION	SQ.YD.	3,075	3,075

* INDICATES SPECIAL PROVISION
 Δ INDICATES SPECIALTY ITEMS

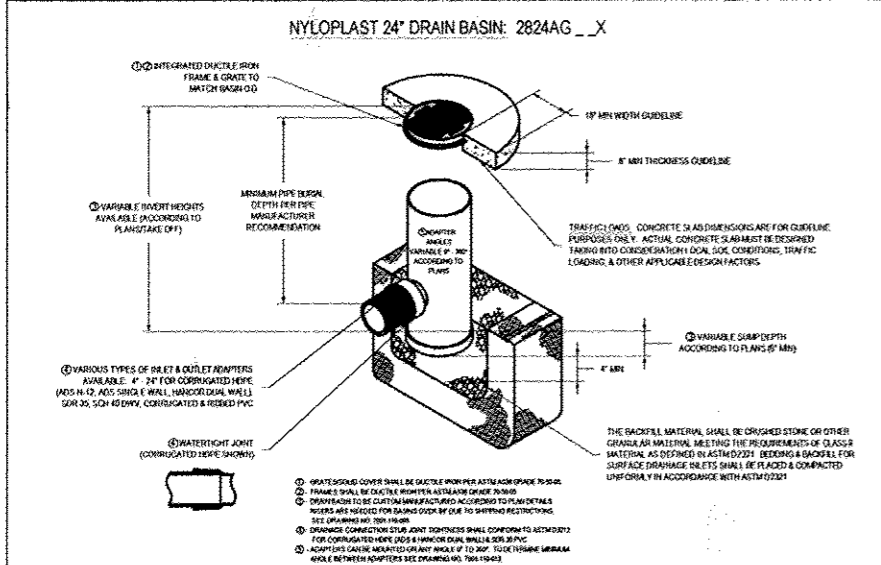

Section 2721
Engineered Surface Drainage Products

GENERAL
 PVC surface drainage inlets shall include the drain basin type as indicated on the contract drawing and referenced within the contract specifications. The ductile iron grates for each of these fittings are to be considered an integral part of the surface drainage inlet and shall be furnished by the same manufacturer. The surface drainage inlets shall be as manufactured by Nyloplast, a division of Advanced Drainage Systems, Inc., or prior approved equal.

MATERIALS
 The drain basins required for this contract shall be manufactured from PVC pipe stock, utilizing a thermo-molding process to reform the pipe stock to the specified configuration. The drainage pipe connection stubs shall be manufactured from PVC pipe stock and formed to provide a watertight connection with the specified pipe system. This joint tightness shall conform to ASTM D3212 for joints for drain and sewer plastic pipe using flexible elastomeric seals. The flexible elastomeric seals shall conform to ASTM F477. The pipe bolt spigot shall be joined to the main body of the drain basin or catch basin. The raw material used to manufacture the pipe stock that is used to manufacture the main body and pipe stubs of the surface drainage inlets shall conform to ASTM D1784 cell class 12454.

The grates and frames furnished for all surface drainage inlets shall be ductile iron for sizes 8", 10", 12", 15", 18", 24", and 30" and shall be made specifically for each basin so as to provide a round bottom flange that closely matches the diameter of the surface drainage inlet. Grates for drain basins shall be capable of supporting H-20 wheel loading for traffic areas or H-10 loading for pedestrian areas. 12" and 15" square grates will be hinged to the frames using pins. Metal used in the manufacture of the castings shall conform to ASTM A536 grade 70-50-05 for ductile iron. Grate shall be provided painted black.

INSTALLATION
 The specified PVC surface drainage inlet shall be installed using conventional flexible pipe backfill materials and procedures. The backfill material shall be crushed stone or other granular material meeting the requirements of class 2 material as defined in ASTM D2321. Bedding and backfill for surface drainage inlets shall be placed and compacted uniformly in accordance with ASTM D2321. The drain basin body will be cut at the time of the final grade. No brick, stone or concrete block will be required to set the grate to the final grade height. For H-20 load rated installations, a concrete ring will be poured under and around the grate and frame. The concrete slab must be designed taking into the consideration local soil conditions, traffic loading, and other applicable design factors. For other installation considerations such as migration of fines, ground water, and soft foundations refer to ASTM D2321 guidelines.

DESIGNED BY	C.A. NATIONAL	DATE	5-10-06
APPROVED BY	C.A. PROJECT NO. 2006	DATE	5-10-06
DRW. NO.	A	SCALE	1/8" = 1'-0"

GRATE OPTIONS	LOAD RATING	PART #	DRAWING #
24\"/>			

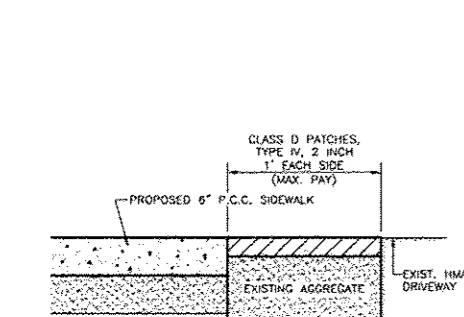

HMA DRIVEWAY PATCH SECTION A-A
 N.T.S.

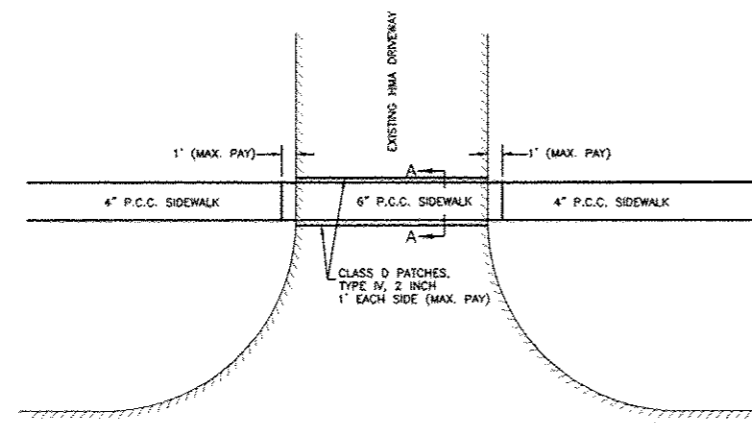

P.C.C. SIDEWALK DETAIL CROSSING AND ABUTTING HMA DRIVEWAYS
 N.T.S.

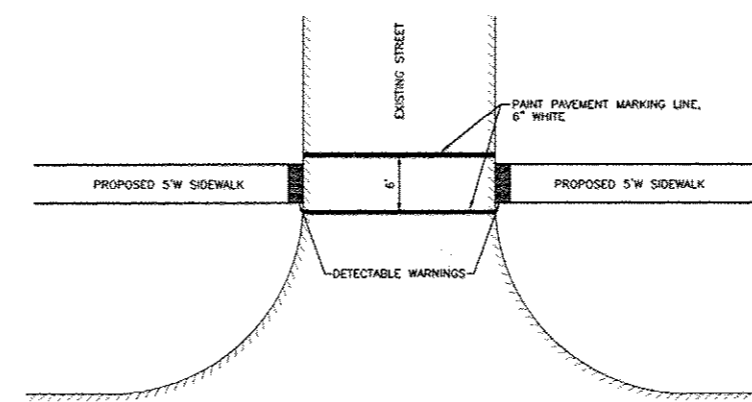

LOW VOLUME CROSSWALK DETAIL
 N.T.S.

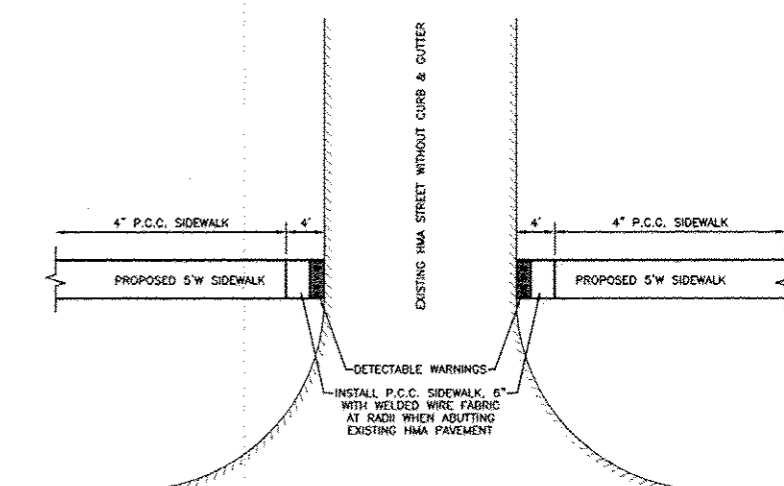

ABUTTING EXISTING HMA PAVEMENT P.C.C. SIDEWALK DETAIL
 N.T.S.

LEGEND

EXISTING SECTION LINE	---
EXISTING RIGHT-OF-WAY	---
EXISTING WATER MAIN	W
EXISTING STORM SEWER	S
EXISTING SANITARY SEWER	C
EXISTING TELEPHONE LINE	T
EXISTING OVERHEAD ELECTRIC	OE
EXISTING GAS MAIN	G
EXISTING FENCE LINE	X
PROPOSED STORM SEWER	○
EXISTING IRON PIPE FOUND	○
EXISTING IRON ROD FOUND	○
EXISTING CATCH BASIN	□
EXISTING INLET	□
EXISTING WATER METER	○
EXISTING WATER SERVICE VALVE	○
EXISTING WATER VALVE	○
EXISTING FIRE HYDRANT	○
EXISTING GAS VALVE	○
EXISTING LIGHT STANDARD	○
EXISTING TELEPHONE PEDESTAL	○
EXISTING UTILITY POLE	○
EXISTING GUY WIRE	○
EXISTING SIGN	○
EXISTING FENCE POST	○
EXISTING MAILBOX	○
EXISTING FLAG POLE	○
EXISTING BUSH	○
EXISTING DECIDUOUS TREE W/ SIZE	○
EXISTING EVERGREEN TREE W/ SIZE	○
EXISTING STUMP	○
PROPOSED SIGN	○
PROPOSED INLET	□
PROPOSED INLET PROTECTION	□

HMA MIXTURE REQUIREMENTS

	HMA PATCH
PG GRADE	PG64-22
DESIGN AIR VOIDS	4.0% ± NSO
MIXTURE COMPOSITION	IL 19.0
FRICTION AGGREGATE	
DENSITY TEST METHOD	CORES

** When more than 20% RAP is used, a softer asphalt binder (PG58-22) may be required as determined by the Engineer.

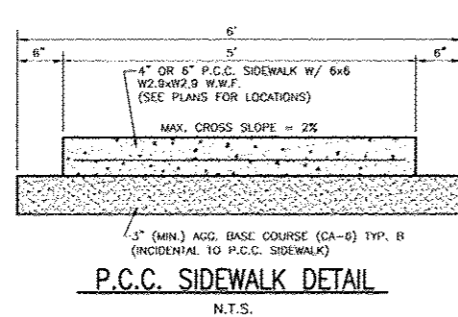

P.C.C. SIDEWALK DETAIL
 N.T.S.

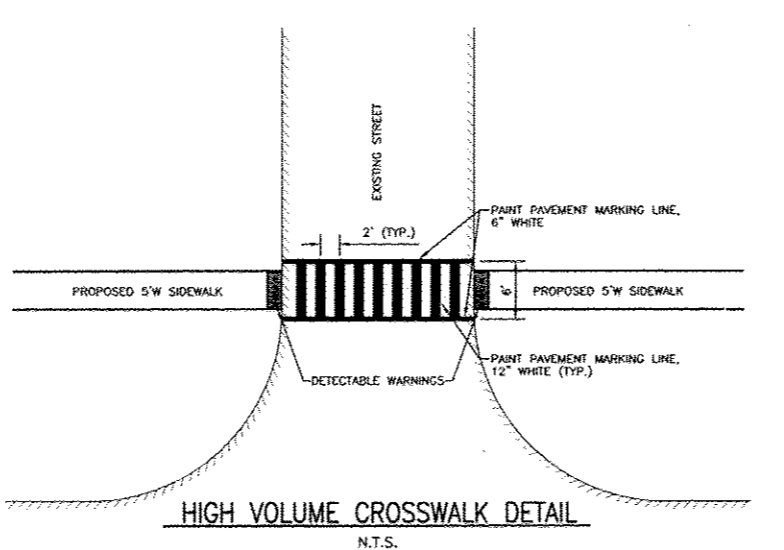

HIGH VOLUME CROSSWALK DETAIL
 N.T.S.

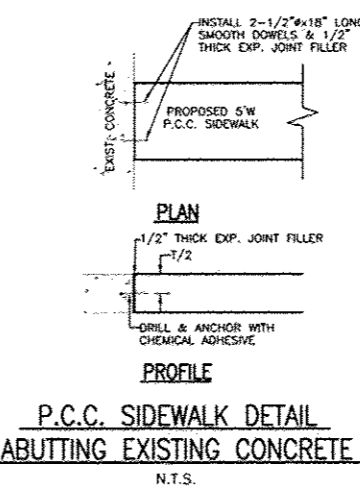

P.C.C. SIDEWALK DETAIL ABUTTING EXISTING CONCRETE
 N.T.S.

GENERAL NOTES

FOR STABILIZATION, ALL TYPE III BARRICADES SHALL REQUIRE A MINIMUM OF FOUR SAND BAGS PER LEG.

ANY REFERENCE TO A STANDARD IN THESE PLANS SHALL BE INTERPRETED TO MEAN THE EDITION AS INDICATED BY THE SUBNUMBER SHOWN IN THE LIST OF STANDARDS INCLUDED IN THESE PLANS.

MEMBERS OF J.U.L.I.E. KNOWN TO BE WITHIN THE LIMITS OF THE IMPROVEMENT ARE:
 A.T.&T. (SBC) (800)244-4444
 COM ED (800)334-7661
 NICOR GAS (888)642-6748
 MEDIACOM (855)633-4226
 VILLAGE OF BRACEVILLE WATER & SEWER DEPARTMENT (815)237-8655

DRAWN BY: RGP	LEVEL	BY	DATE	REVISIONS	DESCRIPTION
CHECKED BY: RTS	1	RGP	5/1/13	REVISED PER IDOT REVIEW	
CREATED: 1/17/13	2	RGP	5/20/13	REVISED PER IDOT REVIEW	

CHAMLIN ASSOCIATES, INC.
 PERU MORRIS
 ILLINOIS

SAFE ROUTES TO SCHOOL
 VILLAGE OF BRACEVILLE, GRUNDY COUNTY, ILLINOIS

DETAILS AND SUMMARY OF QUANTITIES

APPROVED FOR CONSTRUCTION
 CURRENT AS OF: 05/20/13
 SCALE: NONE
 SHEET 2 OF 14
 FILE NO.: 13427

SCHEDULE OF QUANTITIES									
	EARTH EXCAVATION (CU. YDS.)	P.C.C. SIDEWALK REMOVAL (SQ. FT.)	P.C.C. SIDEWALK, 4" (SQ. FT.)	P.C.C. SIDEWALK, 6" (SQ. FT.)	DETECTABLE WARNINGS (SQ. FT.)	CL. D PATCHES (SQ. YD.)	PAINT, 6" (FOOT)	PAINT, 12" (FOOT)	RESTORATION (SQ. YD.)
NORTH STREET									
STA. 9+94.5 TO STA. 10+18 (LT.)	2	59	126						12
STA. 10+22 (LT.)	1		20	10			45		
STA. 10+22 TO STA. 10+44 (LT.)	0								
STA. 10+44 (LT.)	1		20	10					
STA. 10+44 TO STA. 10+92 (LT.)	6		221						22
STA. 10+92 TO STA. 11+12 (LT.)			100		5				
STA. 11+12 TO STA. 11+75 (LT.)	8		313						28
STA. 11+95 TO STA. 12+36 (LT.)	7		256						23
STA. 12+36 TO STA. 12+49 (LT.)	2		65						
STA. 12+49 TO STA. 13+94 (LT.)	19		727						66
STA. 13+99 (LT.)	1		20	10			54		
STA. 13+99 TO STA. 14+25 (LT.)	0								
STA. 14+25 (LT.)	1		20	10					
STA. 14+29 TO STA. 15+87 (LT.)	21		796						72
STA. 15+87 TO STA. 16+03 (LT.)	3		80						
STA. 16+03 TO STA. 16+81 (LT.)	10		391						37
STA. 16+81 TO STA. 17+01 (LT.)	3		100						
STA. 17+01 TO STA. 17+68 (LT.)	9		335						32
STA. 17+72 (LT.)	1		20	10					
STA. 17+72 TO STA. 18+00 (LT.)	0						58		
STA. 18+00 (LT.)	1		20	10					
STA. 18+04 TO STA. 19+26 (LT.)	16		608						56
STA. 19+26 TO STA. 19+57 (LT.)	5		155						
STA. 19+57 TO STA. 20+49 (LT.)	12		460						42
STA. 20+49 TO STA. 20+59 (LT.)			50		2				
STA. 20+59 TO STA. 21+46 (LT.)	11		436						41
STA. 21+50 (LT.)	1		20	10			58		
STA. 21+50 TO STA. 21+78 (LT.)	0								
STA. 21+78 (LT.)	1		20	10					
STA. 21+82 TO STA. 21+87 (LT.)	1		26						3
STA. 21+87 TO STA. 22+73 (RT.)		460	182						38
STA. 22+73 TO STA. 22+90 (RT.)		85	85						
STA. 22+90 TO STA. 25+05 (RT.)		1075	1075						95
STA. 25+09 (RT.)		67	67	20	10				3
STA. 25+09 TO STA. 25+54 (RT.)	0						90	89	
STA. 25+58 (RT.)	1		20	10					
STA. 25+64 (RT.)	0								
STA. 25+58 TO STA. 26+33 (RT.)	10	21	374						21
STA. 26+33 TO STA. 26+50 (RT.)	3		85						
STA. 26+50 TO STA. 27+72 (RT.)	16		611						55
STA. 27+72 TO STA. 27+83 (RT.)			55		3				
STA. 27+83 TO STA. 28+24 (RT.)	5		207						19
STA. 28+24 TO STA. 28+41 (RT.)			85		4				
STA. 28+41 TO STA. 29+28 (RT.)	11		434						39
STA. 29+28 TO STA. 29+39 (RT.)	2		55						62
STA. 29+39 TO STA. 30+76 (RT.)	18		706						
STA. 30+76 TO STA. 30+99 (RT.)			115		5				
STA. 30+99 TO STA. 32+32 (RT.)	17		671						58
STA. 32+36 (RT.)	1		20	10			58		
STA. 32+36 TO STA. 32+64 (RT.)	0								
STA. 32+64 (RT.)	1		20	10					
STA. 32+68 TO STA. 33+84 (RT.)	15		584						54
STA. 33+84 TO STA. 34+04 (RT.)			100						
STA. 34+04 TO STA. 34+80 (RT.)	10		382						34
STA. 34+91 TO STA. 35+65 (RT.)	10		384						34
STA. 35+65 TO STA. 35+87 (RT.)			110						
STA. 35+87 TO STA. 36+36.3 (RT.)	8		318						30
STA. 36+36.3 (RT.)	1		20	10					
WEST GOULD STREET									
STA. 70+49.7 TO STA. 73+10 (RT.)	35		1361						120
STA. 73+14 (RT.)	1		20				33		
STA. 73+14 TO STA. 73+30 (RT.)	0								
STA. 73+30 (RT.)	1		20	10					
STA. 73+34 TO STA. 73+59 (RT.)	3		131						52
STA. 73+59 TO STA. 73+68 (RT.)	2		45						
STA. 73+68 TO STA. 74+32 (RT.)	8		320						108
STA. 74+32 TO STA. 74+41 (RT.)	2		45						
STA. 74+41 TO STA. 75+17 (RT.)	10		383						119
STA. 75+17 TO STA. 75+42 (RT.)	4		125						11
STA. 75+42 TO STA. 76+86 (RT.)	19		721						65
STA. 76+90 (RT.)	1		20	10					
STA. 76+90 TO STA. 77+07 (RT.)	0								
STA. 77+07 (RT.)	1		20	10					
STA. 77+11 TO STA. 78+99 (RT.)	25		949						86
STA. 78+99 TO STA. 79+24 (RT.)	4		125						
STA. 79+24 TO STA. 80+61 (RT.)	18		686			6			60
STA. 80+65 (RT.)	1		20	10					
STA. 80+65 TO STA. 80+89 (RT.)	0								
STA. 80+89 (RT.)	1		20	10					
STA. 80+93 TO STA. 81+00 (RT.)	1		35						4
STA. 80+47 TO STA. 80+61 (LT.)	2		69						7
STA. 80+65 (LT.)	1		20	10					
STA. 80+65 TO STA. 80+95 (LT.)	0								
STA. 81+00 (LT.)			50	20					

	EARTH EXCAVATION (CU. YDS.)	P.C.C. SIDEWALK REMOVAL (SQ. FT.)	P.C.C. SIDEWALK, 4" (SQ. FT.)	P.C.C. SIDEWALK, 6" (SQ. FT.)	DETECTABLE WARNINGS (SQ. FT.)	CL. D PATCHES (SQ. YD.)	PAINT, 6" (FOOT)	PAINT, 12" (FOOT)	RESTORATION (SQ. YD.)
EAST GOULD STREET									
STA. 88+30 (RT.)	0			20	10				
STA. 88+30 (RT.) TO STA. 88+29 (LT.)	0						80	90	
STA. 88+32 TO STA. 88+79 (LT.)							95		
STA. 88+82 (LT.)	0	114		114	20		66		
STA. 88+82 (LT.) TO STA. 88+81 (RT.)									
STA. 88+81 (RT.)	60	20		20	10				
STA. 90+89 TO STA. 95+54 (LT.)	1		2324	20	10				205
STA. 95+58 (LT.)									
MAIN STREET									
STA. 100+44 (LT.)	1			35	10				
STA. 100+52 TO STA. 102+09 (LT.)	23	770	788	881		31			70
STA. 102+09 TO STA. 103+57 (LT.)									12
STA. 103+57 TO STA. 103+74 (LT.)		79	84						8
SOUTH RAILROAD STREET									
STA. 130+09 TO STA. 130+21 (RT.)	2			61					7
STA. 130+25 (RT.)	1			20	10				
STA. 130+25 TO STA. 130+40 (RT.)	0						33		
STA. 130+40 (RT.)	1			20	10				
STA. 130+44 TO STA. 132+71 (RT.)	29			1132					102
STA. 130+74 TO STA. 132+13 (RT.)									131
STA. 132+90 TO STA. 133+29 (RT.)	5			190					17
STA. 133+29 TO STA. 133+49 (RT.)						5			
STA. 133+49 TO STA. 134+27 (RT.)	10			392					37
STA. 134+31 (RT.)	1			20	10				
STA. 134+31 TO STA. 134+46 (RT.)	0						33		
STA. 134+46 (RT.)	1			20	10				
STA. 134+50 TO STA. 135+58 (RT.)	14			538					50
STA. 135+58 TO STA. 135+90 (RT.)	5			160					
STA. 135+90 TO STA. 137+46 (RT.)	20			777					70
LENNOX STREET									
STA. 50+54 TO STA. 52+05 (RT.)	20			775					69
MERRILL STREET									
STA. 60+41 (RT.)	1			35	10				
STA. 60+48 TO STA. 62+91 (RT.)	23	1160	1188	235		9			106
STA. 62+91 TO STA. 63+38 (RT.)		33							
STA. 63+38 TO STA. 63+85 (RT.)	2	159	235	20	10				22
STA. 63+89 (RT.)	1			20	10				
STA. 63+89 TO STA. 64+23 (RT.)	0						68		
STA. 63+77 TO STA. 63+85 (LT.)	1			38					5
STA. 63+89 (LT.)	1			20	10				
STA. 63+89 TO STA. 64+09 (LT.)	0						41		
STA. 64+09 (LT.)	1			20	10				
STA. 64+13 TO STA. 64+23 (LT.)	1	77	50	20	10				6
STA. 65+36 TO STA. 65+77 (RT.)	1	92	206						19
STA. 65+77 TO STA. 65+89 (RT.)	2	59	60						
STA. 65+89 TO STA. 67+59 (RT.)	1	790	850						75
STA. 67+63 (RT.)	1			20	10				
STA. 67+63 TO STA. 67+95 (RT.)	0						64		
STA. 67+95 (RT.)	1			20	10				3
MCCOY STREET									
STA. 110+13 (LT.)	1			20	10				
STA. 110+17 TO STA. 111+79 (LT.)	20			784					71
STA. 111+79 TO STA. 111+97 (LT.)	3			90					
STA. 111+97 TO STA. 112+47 (LT.)	7			251					23
STA. 112+47 TO STA. 112+98 (LT.)	8			225					
STA. 112+98 TO STA. 113+63 (LT.)	8			301					28
STA. 113+67 (LT.)	1			20	10				
STA. 113+67 TO STA. 113+88 (LT.)	0						45		
STA. 113+88 (LT.)	1			20	10				
STA. 113+92 TO STA. 114+91 (LT.)	13								

F.A. RTE.	SECTION	COUNTY	TOTAL SHEETS	SHEET NO.
VARIOUS	12-00009-00-SW	GRUNDY	14	4
FED. ROAD DIST. NO.	ILLINOIS	CONTRACT NO. 87541		

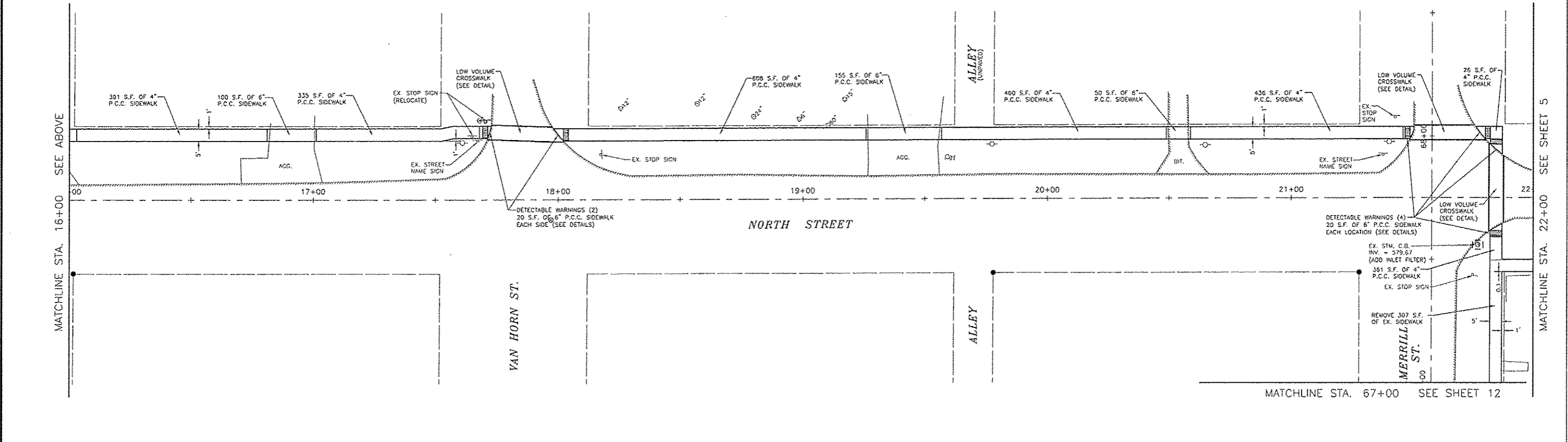
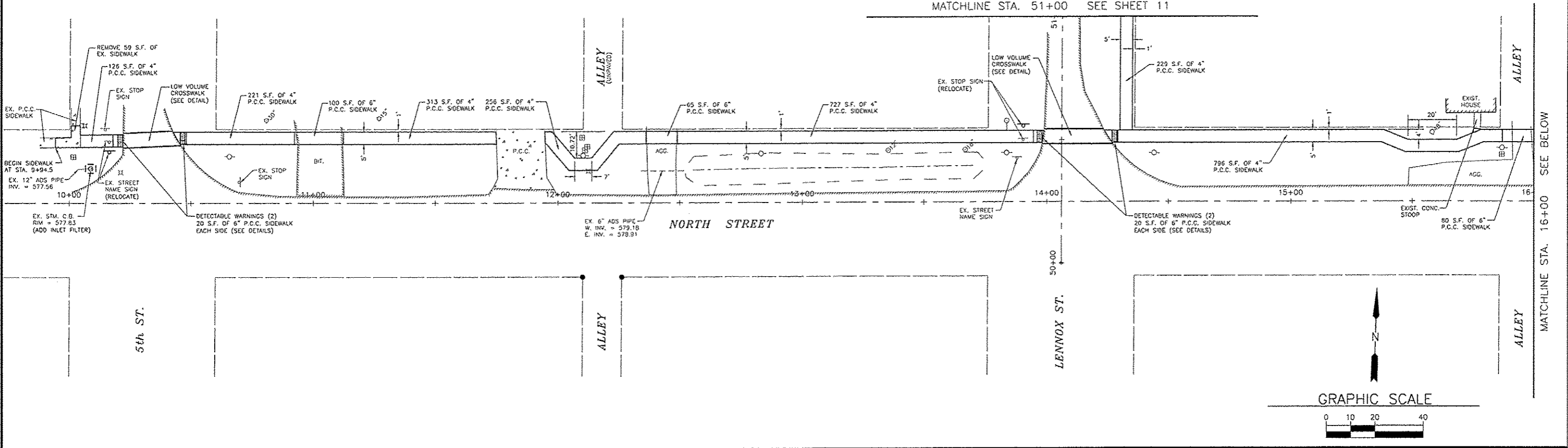

CHAMBLIN & ASSOCIATES, INC. © 2009
 Drawing No: HVA058\1414102-01\12.dwg User: MAB Date: May 20, 2013 9:30pm Plotted on: May 20, 2013 9:40am by rmp

DRAWN BY: MAB	REVISIONS			
CHECKED BY: RTS	LEVEL	BY	DATE	DESCRIPTION
CREATED: 9/14/12	1	RGP	5/1/13	REVISED PER IDOT REVIEW
	2	RGP	5/20/13	REVISED PER IDOT REVIEW

CHAMBLIN & ASSOCIATES, INC.
 PERU ILLINOIS MORRIS ILLINOIS

SAFE ROUTES TO SCHOOL
 VILLAGE OF BRACEVILLE, GRUNDY COUNTY, ILLINOIS

NORTH STREET

APPROVED FOR CONSTRUCTION
 CURRENT AS OF: 05/20/13
 SCALE: 1" = 20'
 FILE NO.: 13427
 SHEET 4 OF 14

F.A. R.T.E.	SECTION	COUNTY	TOTAL SHEETS	SHEET NO.
VARIOUS	12-00009-00-SW	GRUNDY	14	5
FED. ROAD DIST. NO. -	ILLINOIS	CONTRACT NO. 87541		

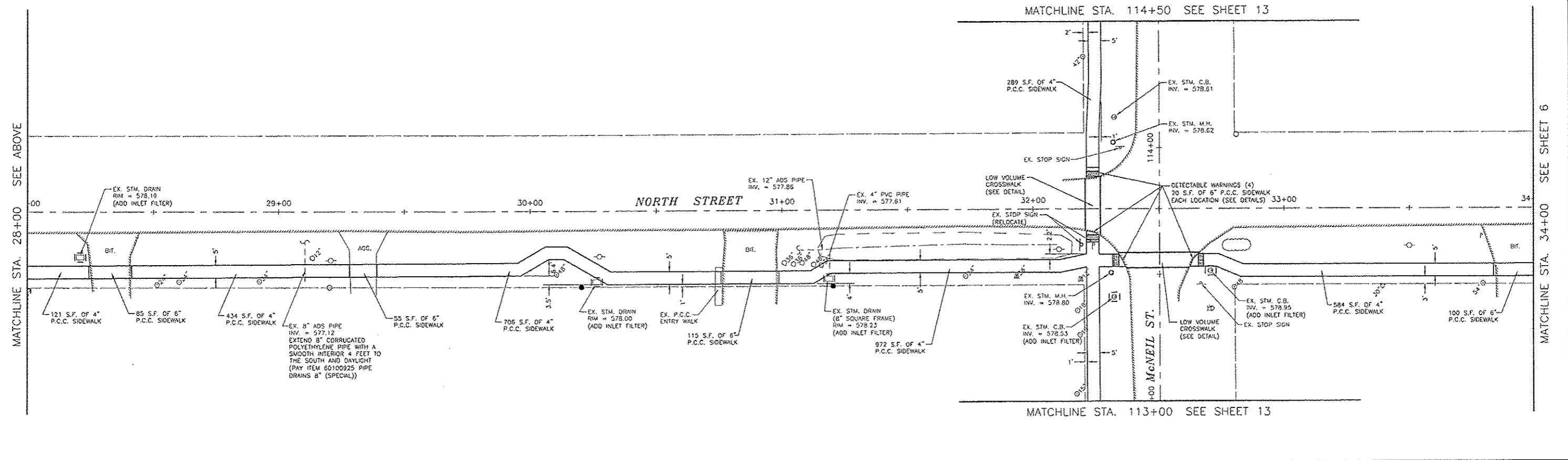
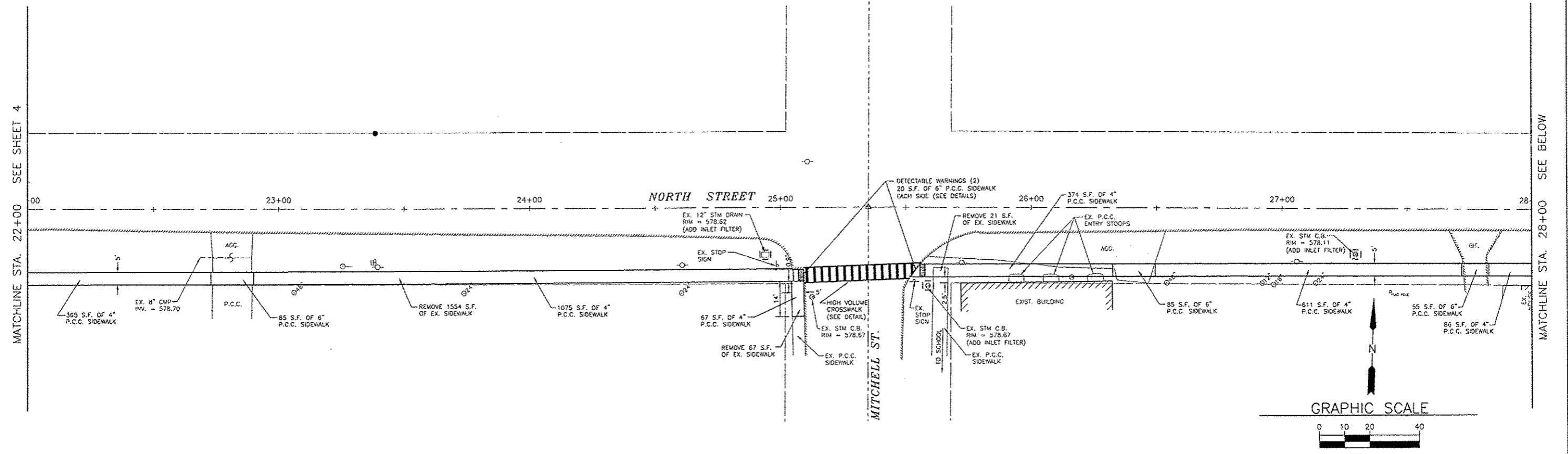

CHAMLIN & ASSOCIATES, INC. © 2009
 Drawing Name: H:\A08\1614102-01\F000 8-3-12.dwg Last Modified: May 20, 2013 - 10:07am Plotted on: May 20, 2013 - 11:02am by rmp

DRAWN BY: MAB	REVISIONS			
CHECKED BY: RTS	LEVEL	BY	DATE	DESCRIPTION
CREATED: 9/14/12	1	RGP	5/1/13	REVISED PER IDOT REVIEW
	2	RGP	5/20/13	REVISED PER IDOT REVIEW

CHAMLIN & ASSOCIATES, INC.
 PERU MORRIS ILLINOIS

SAFE ROUTES TO SCHOOL
 VILLAGE OF BRACEVILLE, GRUNDY COUNTY, ILLINOIS

NORTH STREET

APPROVED FOR CONSTRUCTION

CURRENT AS OF: 05/20/13	SHEET 5
SCALE: 1" = 20'	OF 14
FILE NO.: 13427	

F.A. RTE.:	SECTION	COUNTY	TOTAL SHEETS	SHEET NO.
VARIOUS	12-00009-00-SW	GRUNDY	14	6
FED. ROAD DIST. NO.:	ILLINOIS	CONTRACT NO. 87541		

MATCHLINE STA. 34+00 SEE SHEET 5

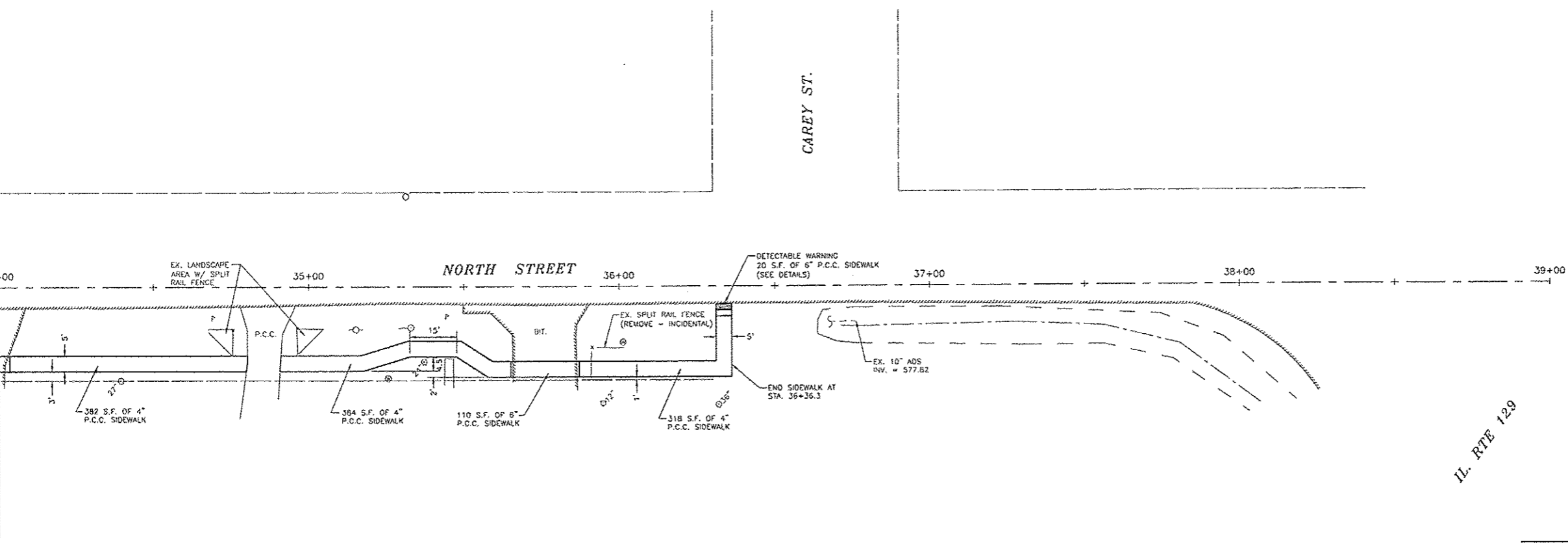

ILL. RTE 129

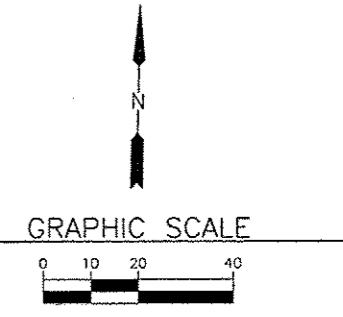

CHAMLIN & ASSOCIATES, INC. © 2009
 Drawing No. 12-00009-00-SW-06
 8-3-12.dwg last Modified: May 20, 2013 - 9:39am Plotted on: May 20, 2013 - 9:40am by: rmp

DRAWN BY: MAB		REVISIONS	
LEVEL	BY	DATE	DESCRIPTION
1	RGP	5/1/13	REVISED PER IDOT REVIEW
2	RGP	5/20/13	REVISED PER IDOT REVIEW
CHECKED BY: RTS			
CREATED: 9/14/12			

CHAMLIN & ASSOCIATES, INC.
 PERU MORRIS ILLINOIS

SAFE ROUTES TO SCHOOL
 VILLAGE OF BRACEVILLE, GRUNDY COUNTY, ILLINOIS

NORTH STREET

APPROVED FOR CONSTRUCTION

CURRENT AS OF: 05/20/13	
SCALE: 1" = 20'	SHEET 6
FILE NO.: 13427	OF 14

F.A. RTE	SECTION	COUNTY	TOTAL SHEETS	SHEET NO.
VARIOUS	12-00009-00-SW	GRUNDY	14	7
FED. ROAD DIST. NO.	ILLINOIS	CONTRACT NO. 87541		

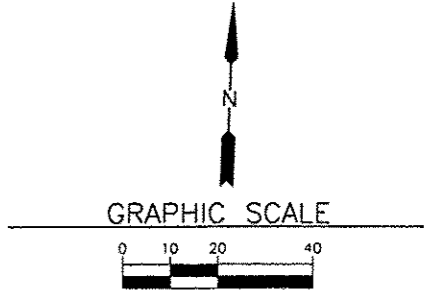
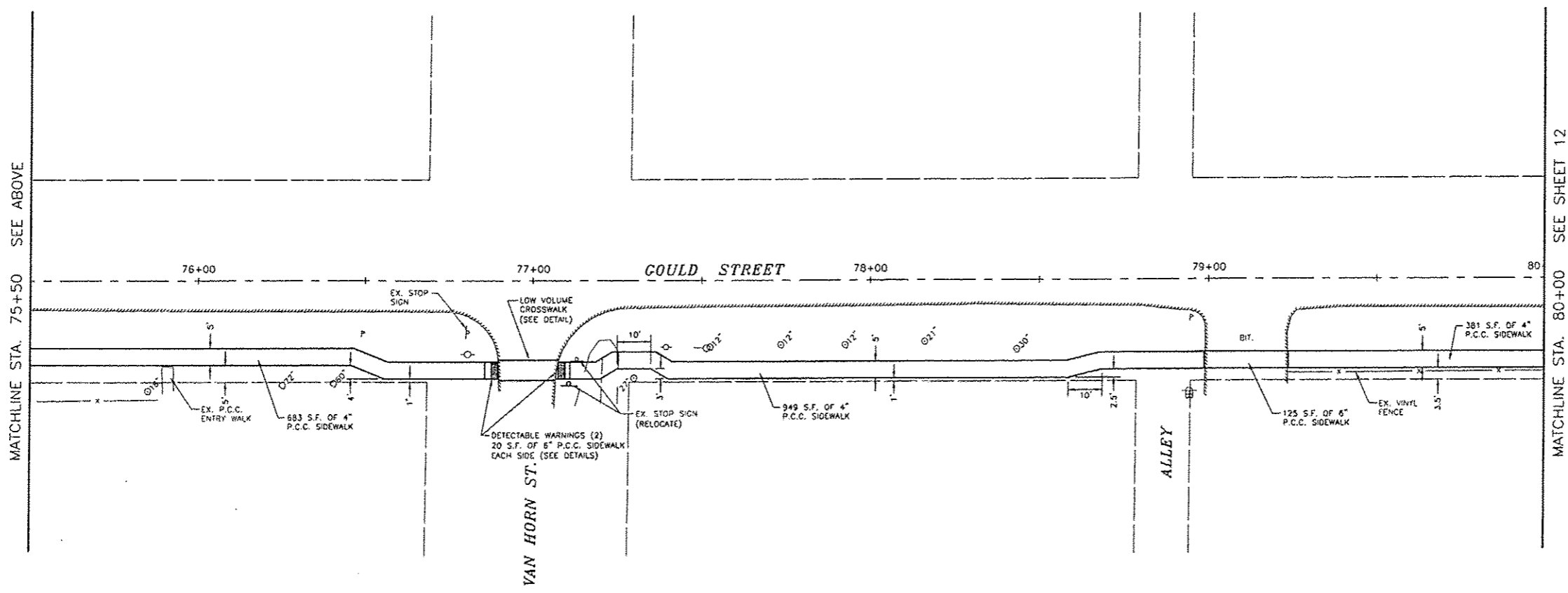
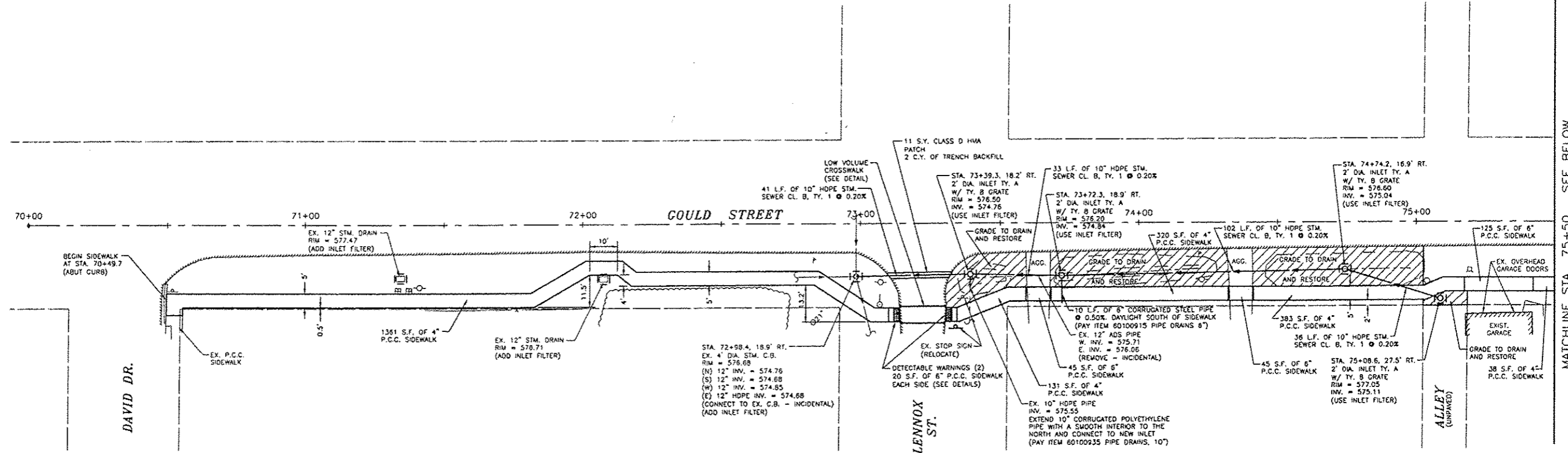

DRAWN BY: MAB
 CHECKED BY: RTS
 CREATED: 9/14/12
 CHAMBLIN ASSOCIATES, INC. PERU MORRIS ILLINOIS
 SAFER & ASSOCIATES, INC. © 1995
 Grounds: Normal, IL 62556-1411; 618-222-2010; NETOPD 8-1-12; 12.dwg; L511; Modified: May 20, 2013 - 10:07am; Plotted: on: May 20, 2013 - 11:26am; by: rmp

REVISIONS				
NO.	BY	DATE	DESCRIPTION	
1	RGP	5/1/13	REVISED PER IDOT REVIEW	
2	RGP	5/20/13	REVISED PER IDOT REVIEW	

CHAMBLIN & ASSOCIATES, INC.
 PERU MORRIS ILLINOIS

SAFE ROUTES TO SCHOOL
 VILLAGE OF BRACEVILLE, GRUNDY COUNTY, ILLINOIS

WEST GOULD STREET

APPROVED FOR CONSTRUCTION

CURRENT AS OF: 05/20/13	
SCALE: 1" = 20'	SHEET 7
FILE NO.: 13427	OF 14

F.A. RTE.	SECTION	COUNTY	TOTAL SHEETS	SHEET NO.
VARIOUS	12-00009-00-SW	GRUNDY	14	8
FED. ROAD DIST. NO. -	ILLINOIS	CONTRACT NO. 87541		

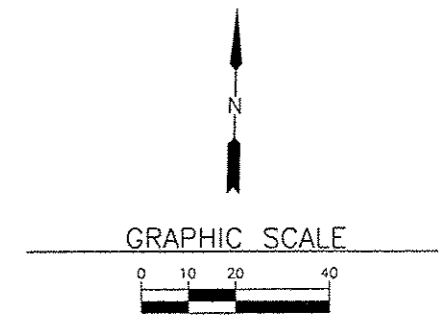
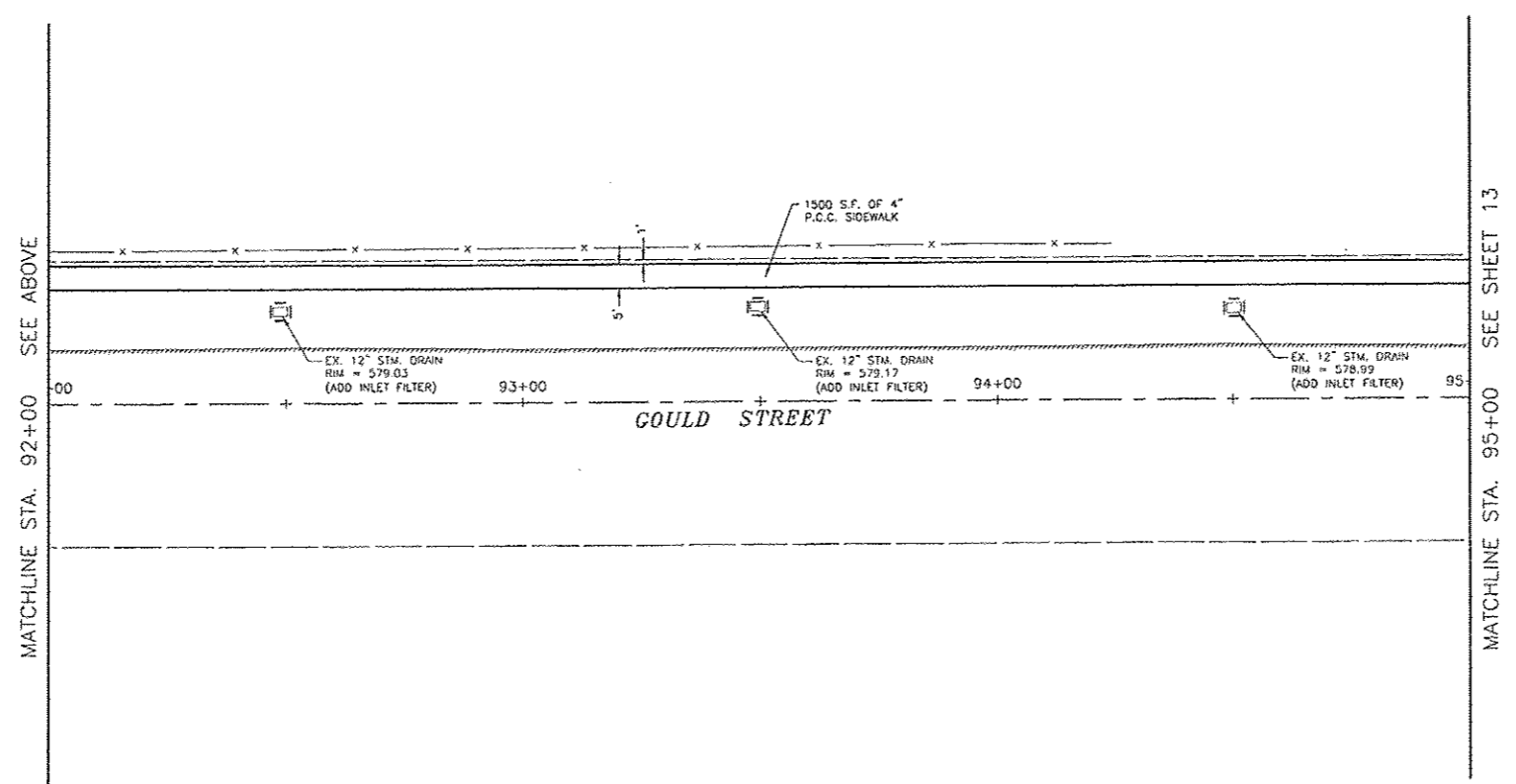
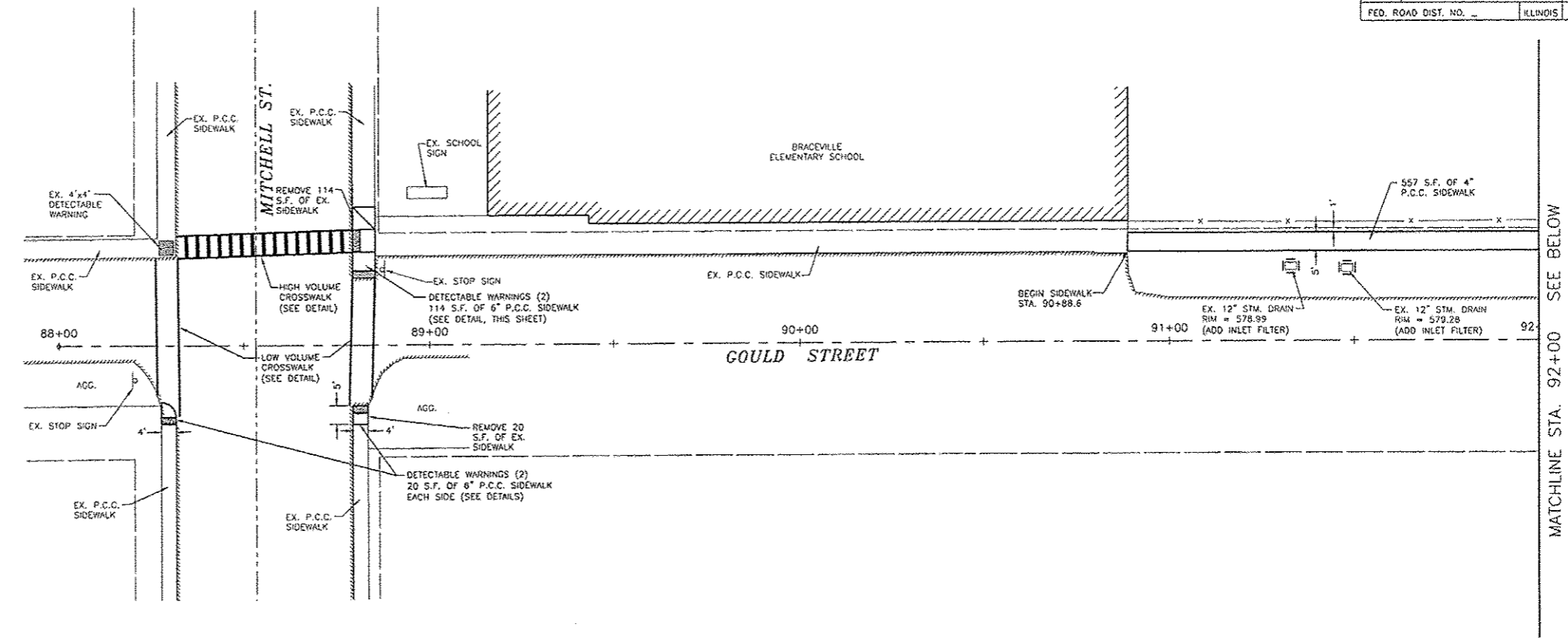
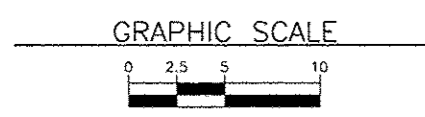
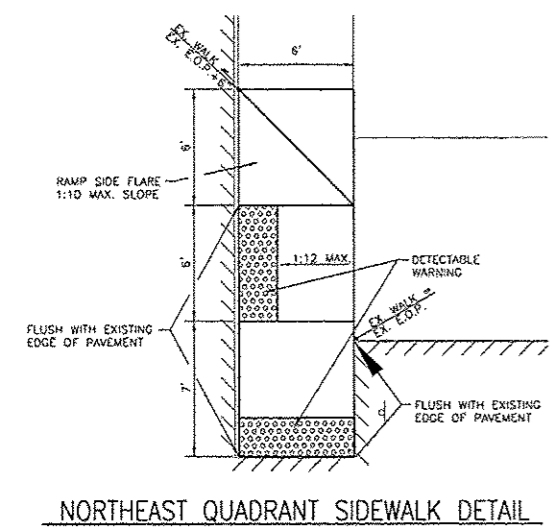

CHAMBLIN & ASSOCIATES, INC. © 2009
 Drawings: H:\AUGUST\14\14102-01\12000 8-3-12.dwg Issued: May 20, 2013 9:30am Plotted on: May 20, 2013 9:40am by: rmp

DRAWN BY: MAB	REVISIONS			
CHECKED BY: RTS	LEVEL	BY	DATE	DESCRIPTION
CREATED: 9/14/12	1	RGP	5/1/13	REVISED PER IDOT REVIEW
	2	RGP	5/20/13	REVISED PER IDOT REVIEW

CHAMBLIN & ASSOCIATES, INC.
 PERU MORRIS ILLINOIS

SAFE ROUTES TO SCHOOL
 VILLAGE OF BRACEVILLE, GRUNDY COUNTY, ILLINOIS

EAST GOULD STREET

APPROVED FOR CONSTRUCTION

CURRENT AS OF: 05/20/13	SHEET 8
SCALE: 1" = 20'	OF 14
FILE NO.: 13427	

F.A. RTE.	SECTION	COUNTY	TOTAL SHEETS	SHEET NO.
VARIOUS	12-00009-00-SW	GRUNDY	14	10
FED. ROAD DIST. NO. _	ILLINOIS	CONTRACT NO. 87541		

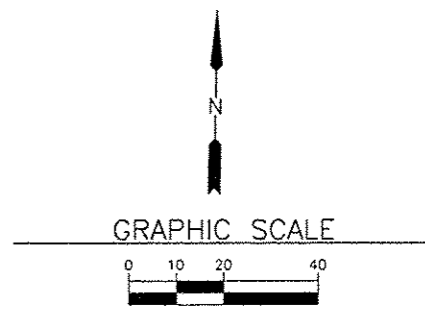
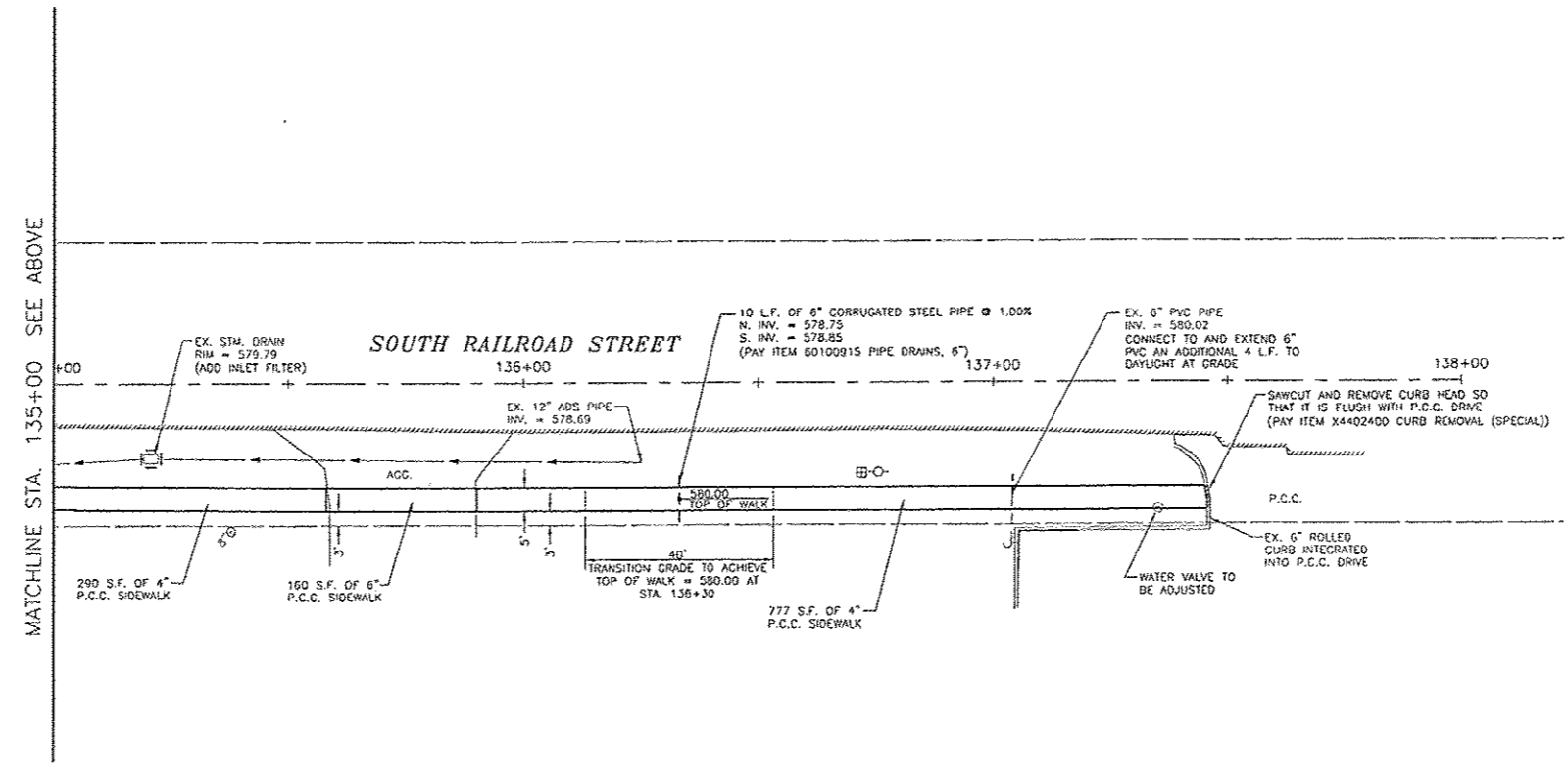
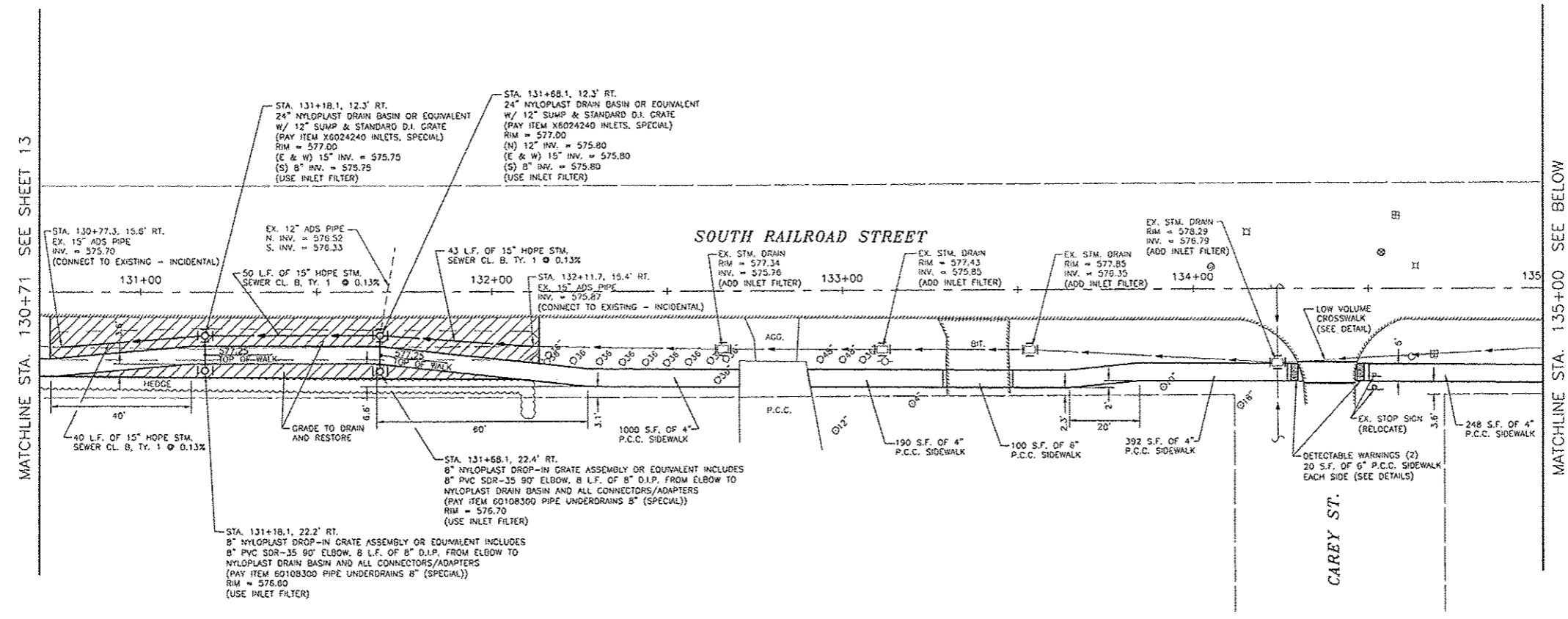

CHAMLIN & ASSOCIATES, INC. © 2009
 Drawing Number: HVA-0811A-14102-01-12-090 8-3-12.dwg User: Medfres: May 20, 2013 - 9:38am Plotted on: May 20, 2013 - 9:41am by rmp

DRAWN BY: MAB	REVISIONS			
CHECKED BY: RTS	LEVEL	BY	DATE	DESCRIPTION
CREATED: 9/14/12	1	RGP	5/1/13	REVISED PER IDOT REVIEW
	2	RGP	5/20/13	REVISED PER IDOT REVIEW

CHAMLIN & ASSOCIATES, INC.
 PERU MORRIS ILLINOIS

SAFE ROUTES TO SCHOOL
 VILLAGE OF BRACEVILLE, GRUNDY COUNTY, ILLINOIS

SOUTH RAILROAD STREET

APPROVED FOR CONSTRUCTION
 CURRENT AS OF: 05/20/13
 SCALE: 1" = 20'
 FILE NO.: 13427
 SHEET 10 OF 14

F.A. RTE.	SECTION	COUNTY	TOTAL SHEETS	SHEET NO.
VARIOUS	12-00009-00-SW	GRUNDY	14	11
FED. ROAD DIST. NO. -	ILLINOIS	CONTRACT NO. 87541		

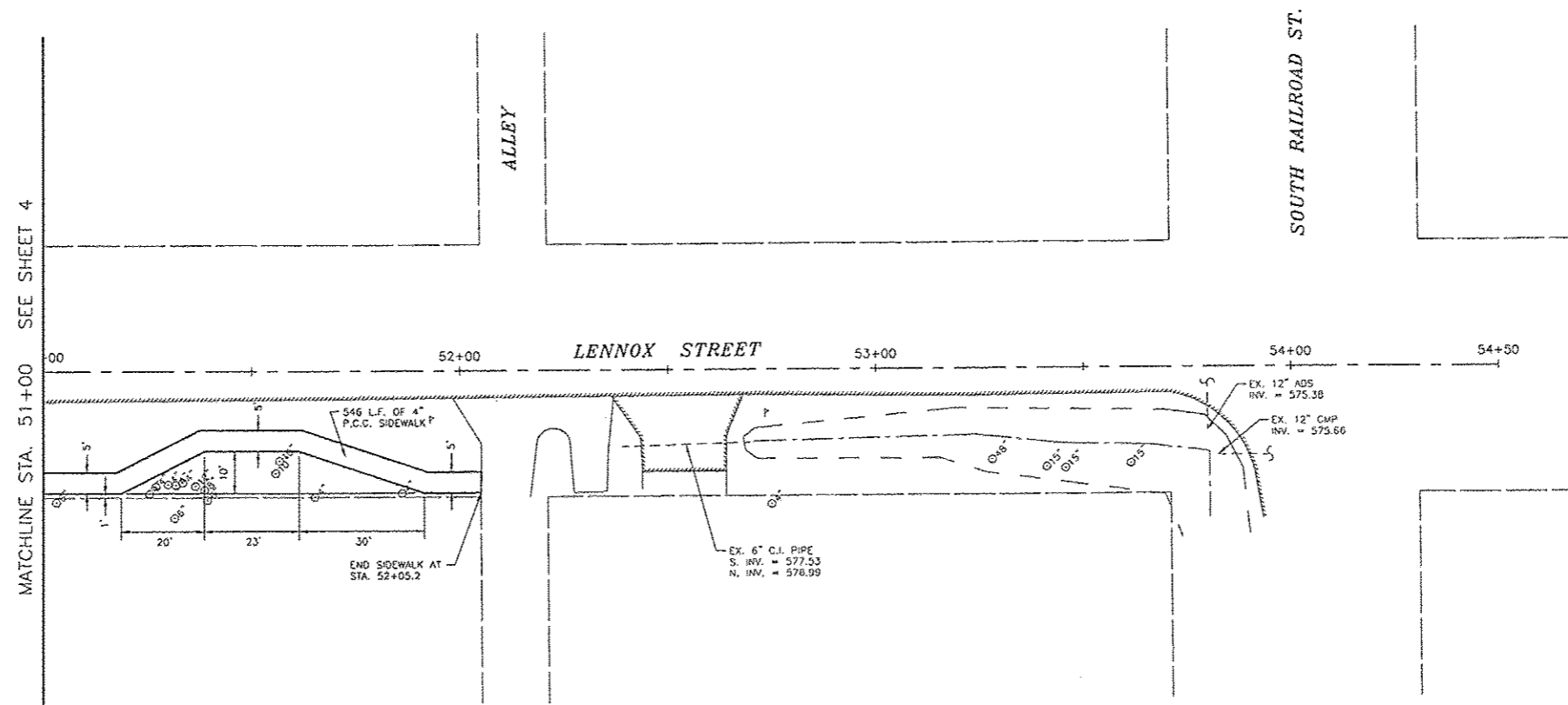

GRAPHIC SCALE

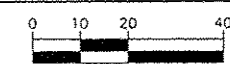

CHAMLIN & ASSOCIATES, INC. © 2009
 Drawing Number: R:\V\2013\114102-DIV\10200_8-3-12.dwg
 Last Modified: May 20, 2013 - 8:39am
 Plotted on: May 20, 2013 - 8:39am
 Plotted by: csp

DRAWN BY: MAB		REVISIONS	
LEVEL	BY	DATE	DESCRIPTION
1	RGP	5/1/13	REVISED PER IDOT REVIEW
2	RGP	5/20/13	REVISED PER IDOT REVIEW
CHECKED BY: RTS			
CREATED: 9/14/12			

CHAMLIN & ASSOCIATES, INC.
 PERU MORRIS ILLINOIS

SAFE ROUTES TO SCHOOL
 VILLAGE OF BRACEVILLE, GRUNDY COUNTY, ILLINOIS

LENNOX STREET

APPROVED
 FOR CONSTRUCTION

CURRENT AS OF: 05/20/13	
SCALE: 1" = 20'	SHEET 11
FILE NO.: 13427	OF 14

F.A. RTE.	SECTION	COUNTY	TOTAL SHEETS	SHEET NO.
VARIOUS	12-00009-00-SW	GRUNDY	14	12
FED. ROAD DIST. NO. -	ILLINOIS	CONTRACT NO. 87541		

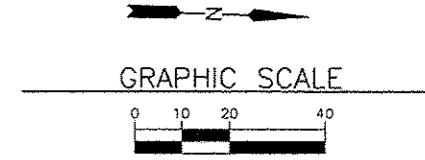
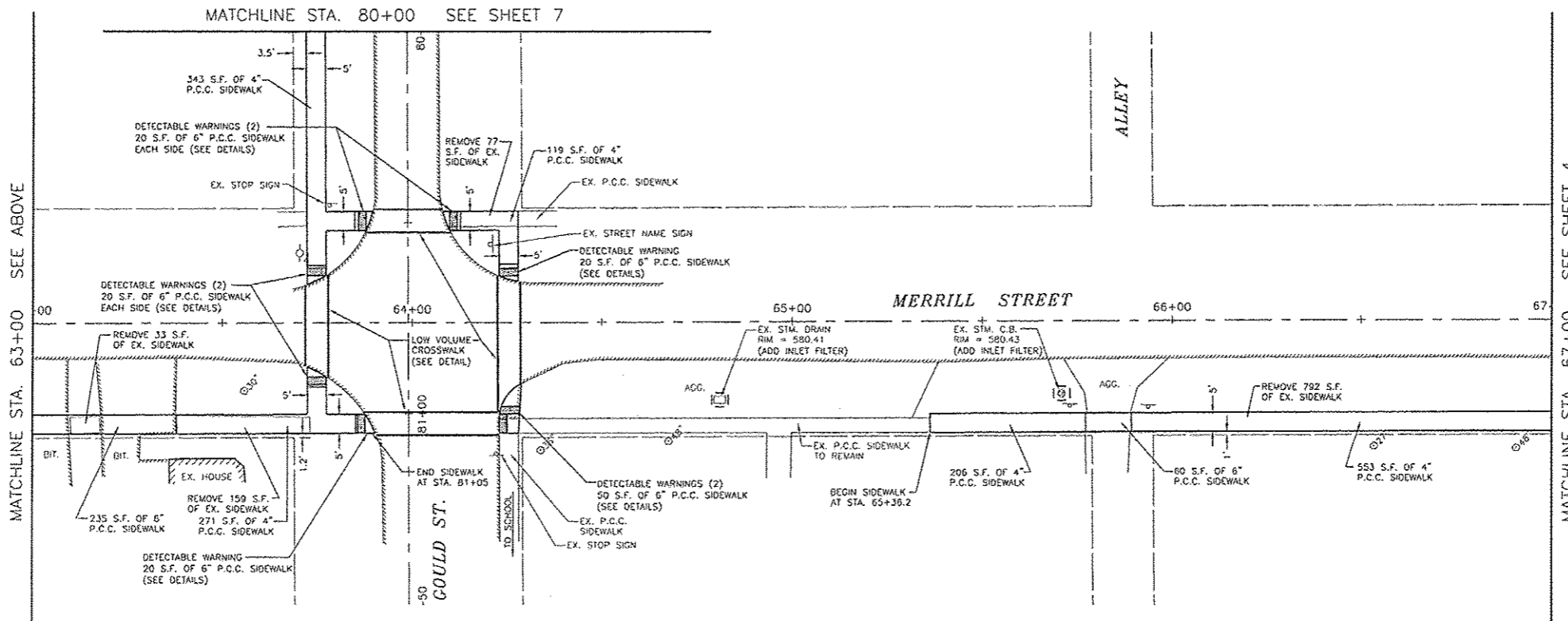
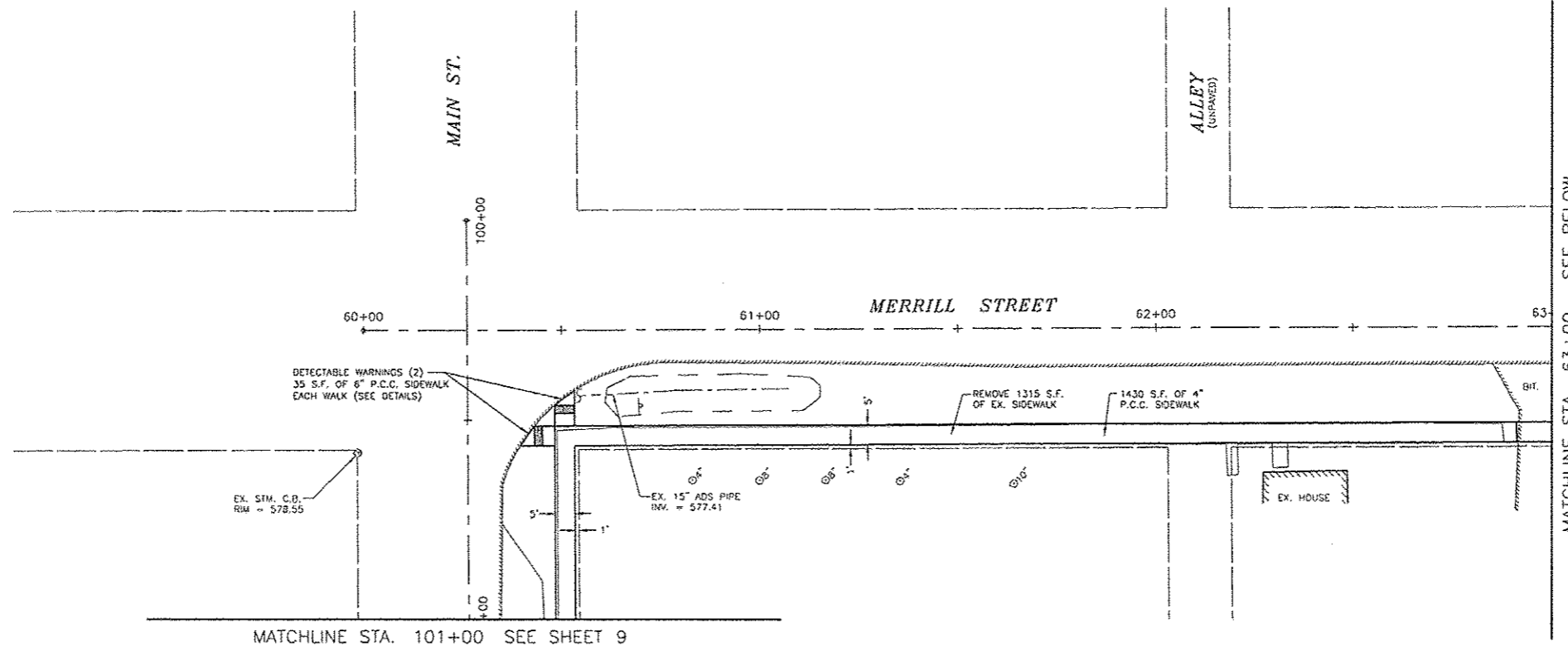

CHAMLIN & ASSOCIATES, INC. © 2009
 3000 N. W. 14th St., Ft. Lauderdale, FL 33309
 954.581.1111
 8-3-12.dwg last modified: May 20, 2013 - 8:15am Plotted on: May 20, 2013 - 8:41am by ramp

DRAWN BY: MAB		REVISIONS		
LEVEL	BY	DATE	DESCRIPTION	
1	RGP	5/1/13	REVISED PER IDOT REVIEW	
2	RGP	5/20/13	REVISED PER IDOT REVIEW	
CHECKED BY: RTS				
CREATED: 9/14/12				

CHAMLIN & ASSOCIATES, INC.
 PERU MORRIS
 ILLINOIS

SAFE ROUTES TO SCHOOL
 VILLAGE OF BRACEVILLE, GRUNDY COUNTY, ILLINOIS

MERRILL STREET

APPROVED
 FOR CONSTRUCTION

CURRENT AS OF: 05/20/13	SHEET 12
SCALE: 1" = 20'	OF 14
FILE NO.: 13427	

F.A. RTE.	SECTION	COUNTY	TOTAL SHEETS	SHEET NO.
VARIOUS	12-00009-00-SW	GRUNDY	14	13
FED. ROAD DIST. NO.	ILLINOIS	CONTRACT NO. 87541		

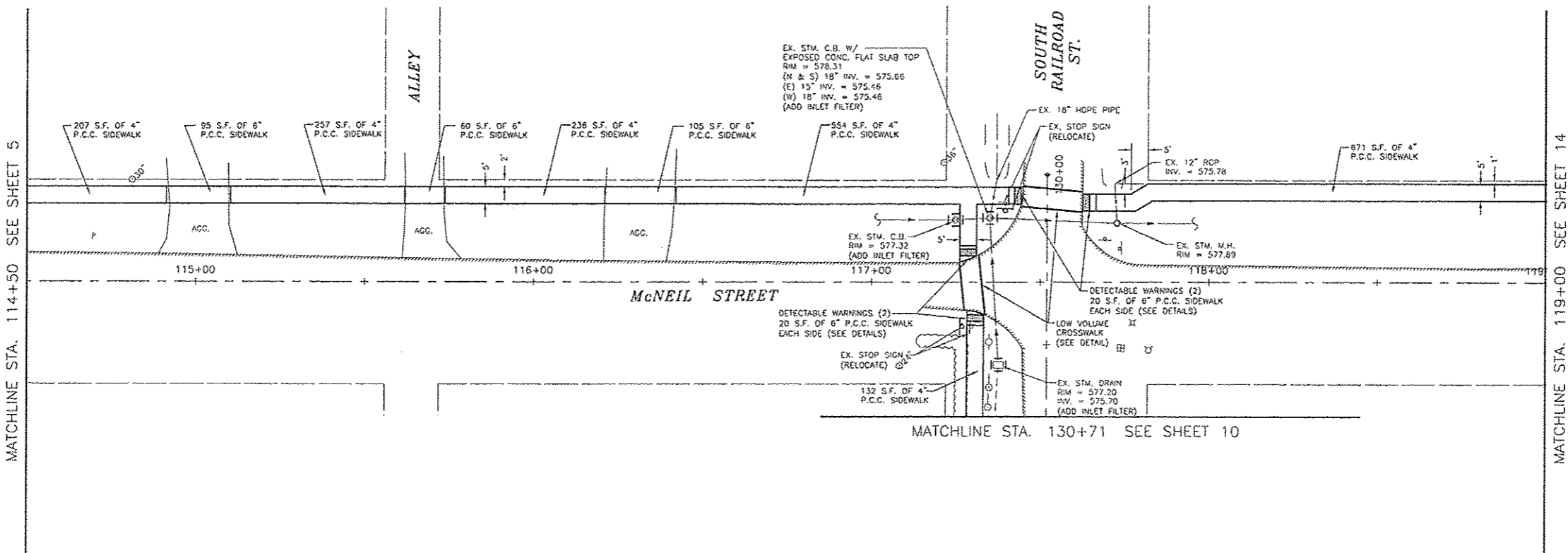
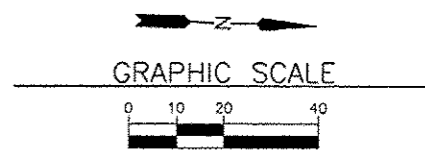
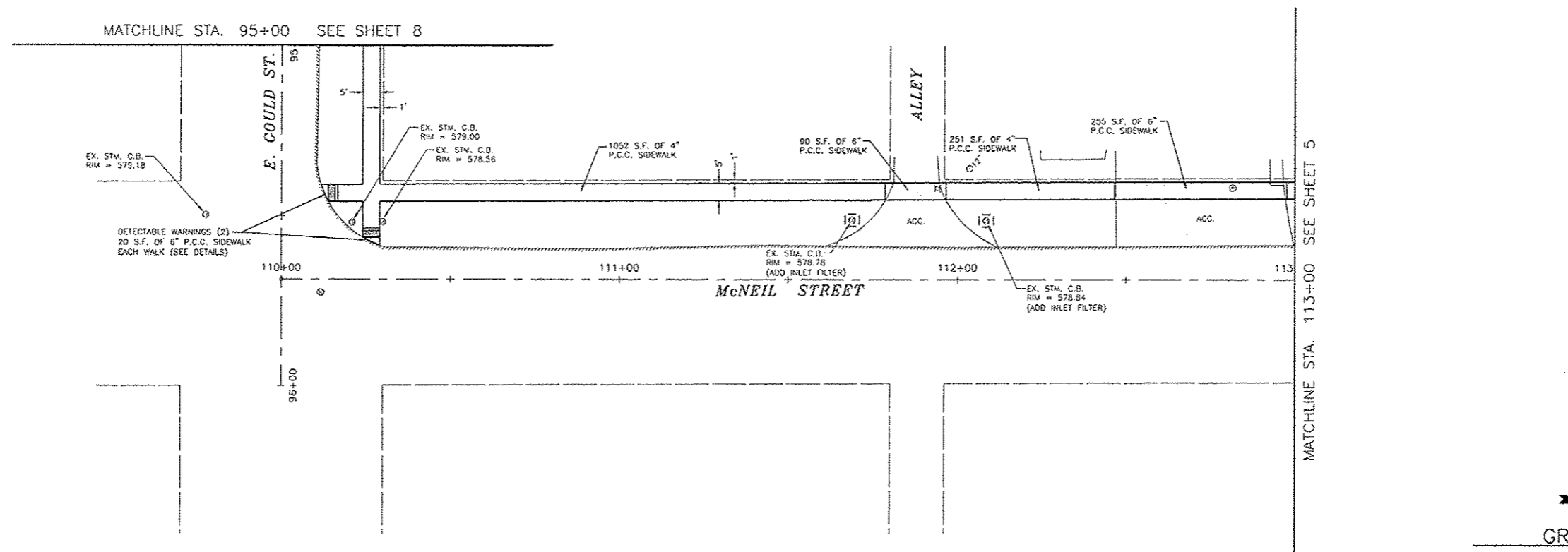

CHAMBLIN & ASSOCIATES, INC. © 2009
 Drawing Name: R14208\14141025-01\10208-8-3-12.dwg Last Modified: May 20, 2013 - 9:29am Plotted on: May 20, 2013 - 9:41am by repp

DRAWN BY: MAB		REVISIONS	
CHECKED BY: RTS	LEVEL	BY	DATE
CREATED: 9/14/12	1	RCP	5/1/13
	2	RGP	5/20/13
			REVISOR
			DESCRIPTION
			REVISED PER IDOT REVIEW
			REVISED PER IDOT REVIEW

CHAMBLIN & ASSOCIATES, INC.
 PERU MORRIS
 ILLINOIS

SAFE ROUTES TO SCHOOL
 VILLAGE OF BRACEVILLE, GRUNDY COUNTY, ILLINOIS

McNEIL STREET

APPROVED FOR CONSTRUCTION

CURRENT AS OF: 05/20/13	
SCALE: 1" = 20'	SHEET 13
FILE NO.: 13427	OF 14

F.A. RTE.	SECTION	COUNTY	TOTAL SHEETS	SHEET NO.
VARIOUS	12-00009-00-5W	GRUNDY	14	14
FED. ROAD DIST. NO.	ILLINOIS	CONTRACT NO. 87541		

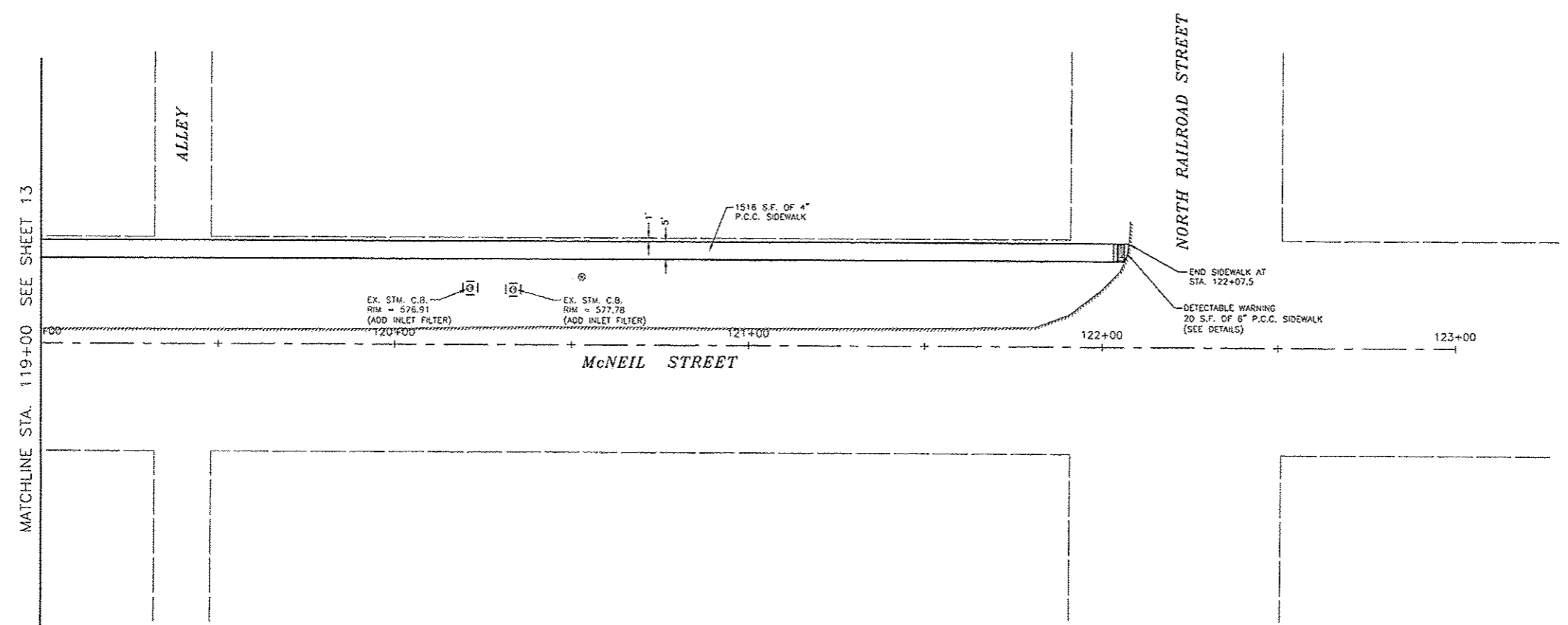
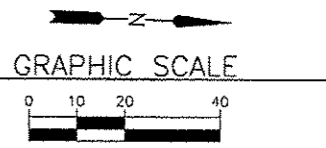

CHAMBLIN & ASSOCIATES, INC. © 2009
 Drawing Number: RA-2013-141102-00-VT009 & 1-12.dwg
 Last Modified: May 20, 2013 - 9:35am
 Plotted on: May 20, 2013 - 9:35am
 Plotted by: rop

DRAWN BY: MAB		REVISIONS	
LEVEL	BY	DATE	DESCRIPTION
1	RGP	5/1/13	REVISED PER IDOT REVIEW
2	RGP	5/20/13	REVISED PER IDOT REVIEW

CHAMBLIN & ASSOCIATES, INC.
 PERU MORRIS
 ILLINOIS

SAFE ROUTES TO SCHOOL
 VILLAGE OF BRACEVILLE, GRUNDY COUNTY, ILLINOIS

McNEIL STREET

APPROVED FOR CONSTRUCTION
 CURRENT AS OF: 05/20/13
 SCALE: 1" = 20'
 FILE NO.: 13427
 SHEET 14 OF 14