

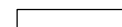



LEGEND

-  EXISTING PAVEMENT
-  EXISTING BUILDING
-  CONSTRUCTION STAGING AREA
-  CONSTRUCTION ACCESS AND HAUL ROUTE
-  PROPOSED WORK AREA 2
-  PROPOSED BARRICADES

0' 150' 300' 600'
 HALF SIZE SCALE: 1" = 600'
 FULL SIZE SCALE: 1" = 300'

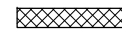
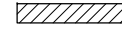
RUNWAY/TAXIWAY CLOSURE DISTANCES	
LOCATION	DISTANCE FROM CENTERLINE
RUNWAY 9-27	250'
RUNWAY 18-36	125'
ALL TAXIWAYS	65.5'

WORK AREA 2 NOTES

- WORK AREA 2 INCLUDES INSTALLATION OF AIRFIELD LIGHTING ALONG TAXIWAY A WEST OF THE RAMP TO THE RUNWAY 9-27 SAFETY AREA. WORK WILL BE OUTSIDE OF THE RUNWAY 9-27 SAFETY AREA. TAXIWAY A WEST OF THE RAMP WILL BE CLOSED FOR THE DURATION OF THE WORK FOR THIS PHASE. THE WEST PART OF THE RAMP WILL BE CLOSED WHEN WORKING IN THIS AREA. RUNWAY 18-36 WILL BE OPEN. RUNWAY 9-27 WILL BE OPEN.
- IT IS ANTICIPATED THAT CONSTRUCTION OF THE PROPOSED ELECTRICAL VAULT AND BEACON MAY OCCUR CONCURRENTLY WITH OTHER SCOPE ITEMS IN MULTIPLE WORK AREAS. THEREFORE THE VAULT WORK IS EXCLUDED FROM THE INDIVIDUAL WORK AREA CONTRACT TIME DURATIONS, BUT SHALL BE COMPLETED WITHIN THE OVERALL PROJECT CONTRACT TIME.
- THE CONTRACTOR SHALL HAVE A MAXIMUM OF 10 CALENDAR DAYS TO COMPLETE THE WORK IN WORK AREA 2, OR A TOTAL OF 42 CALENDAR DAYS TO COMPLETE THE WORK IN WORK AREAS 1 AND 2.
- CLOSURE CROSSES AND BARRICADES SHALL BE IN PLACE PRIOR TO BEGINNING CONSTRUCTION.
- AT ALL TIMES, THE CONTRACTOR'S OPERATIONS SHALL BE SUCH AS TO MINIMIZE CLOSURES.
- PER THE DIRECTION OF THE FAA IF A TAXIWAY IS CLOSED FOR MORE THAN THREE DAYS PROVIDE A TAXIWAY CLOSURE MARKER AT THE RUNWAY/TAXIWAY INTERSECTION USING TEMPORARY MARKING PAINT. AVOID THE USE OF TAXIWAY CLOSURE MARKERS CONSTRUCTED OF TEMPORARY PAVEMENT TAPE, PLYWOOD, PLASTIC SHEETS AND/OR TARPS WITH SANDBAGS, WHERE THE MARKERS ARE LOCATED WITHIN THE RUNWAY SAFETY AREA. TEMPORARY MARKING PAINT SHALL BE SUITABLE FOR THE APPLICATION AND REMOVABLE WITH WATER OR A PRESSURE WASHER TO AVOID DAMAGE TO THE PAVEMENT. TEMPORARY MARKING PAINT SHALL BE SEYMOUR PAINT HI VIZ YELLOW TEMPORARY MARKER 20-636, OR APPROVED EQUAL.

CRITICAL POINTS				
POINT #	DESCRIPTION	GROUND ELEVATION	LATITUDE	LONGITUDE
1	CRITICAL PT. 1	685.0	N 040° 30' 59.58"	W 090° 39' 20.05"
2	CRITICAL PT. 2	685.0	N 040° 31' 00.53"	W 090° 39' 18.79"
3	CRITICAL PT. 3	694.5	N 040° 31' 08.43"	W 090° 39' 27.81"

HEIGHT OF CONSTRUCTION EQUIPMENT

THE MAXIMUM ANTICIPATED HEIGHT OF THE CONSTRUCTION EQUIPMENT WILL BE 70 FEET, WHICH IS EXPECTED TO BE A CRANE TO SET THE VAULT OR A BUCKET TRUCK TO WORK ON THE BEACON TOWER. THE MAXIMUM ANTICIPATED HEIGHT OF THE CONSTRUCTION EQUIPMENT AT ALL OTHER LOCATIONS WILL BE 25 FEET, WHICH IS EXPECTED TO BE A CONCRETE TRUCK OR A LINE TRUCK. THE CRANE OR BUCKET TRUCK SHALL BE USED DURING THE DAYLIGHT HOURS AND VFR CONDITIONS ONLY AND SHALL BE LOWERED WHEN NOT IN USE, DURING THE HOURS BETWEEN SUNSET AND SUNRISE, AND/OR DURING IFR WEATHER CONDITIONS. WHEN IN USE, THE CRANE OR BUCKET TRUCK SHALL BE MARKED WITH THE 3' SQUARE CHECKERED FLAG.

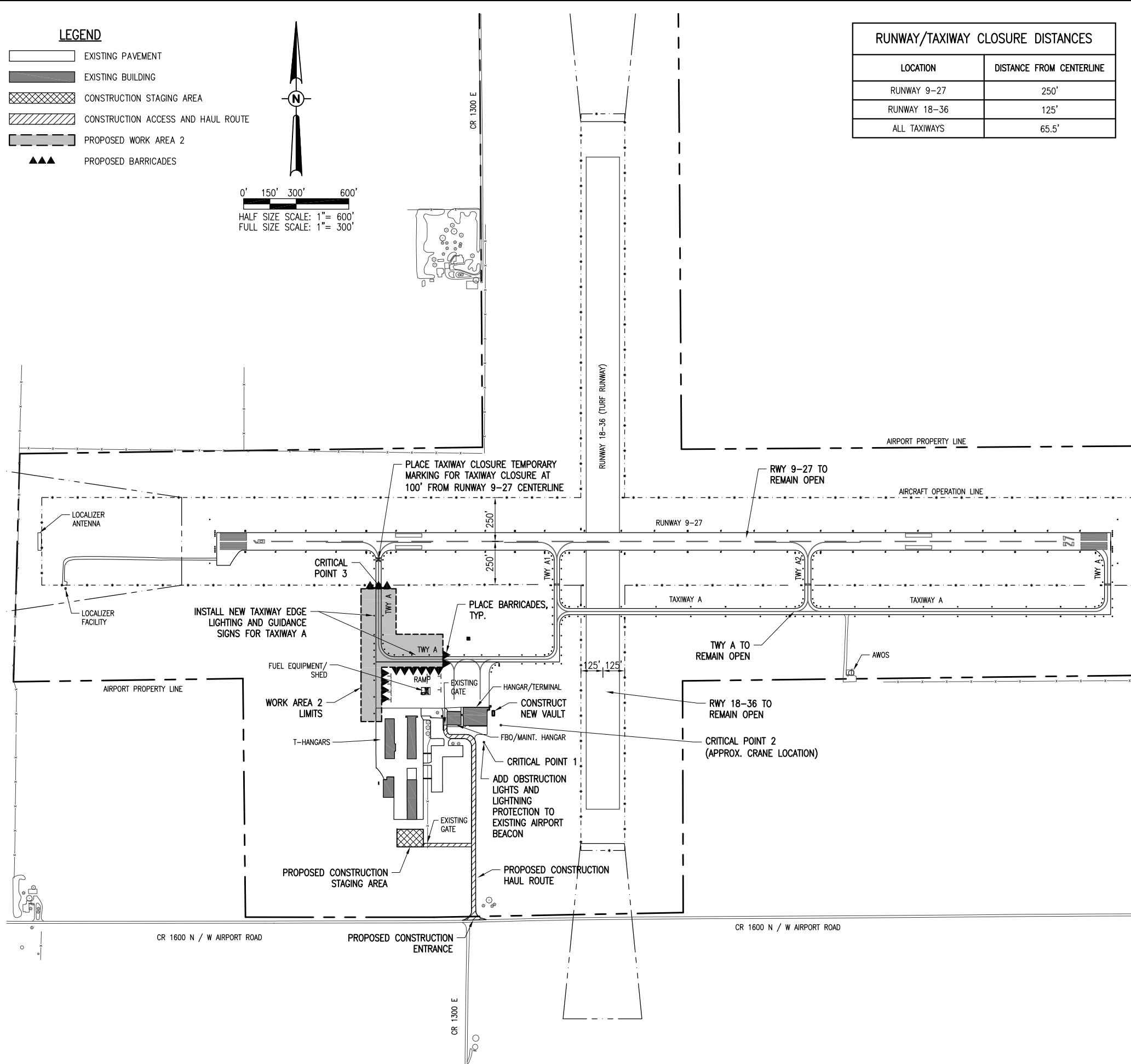

REVISION	DATE

MACOMB MUNICIPAL AIRPORT
 MACOMB, ILLINOIS

BLOCK GRANT PROJ.: 3-17-0064-B21
 ILL PROJ.: MOB-4206

DESCRIPTION	DATE
LAYOUT	01/28/13
DRAWN	01/28/13
REVIEWED	02/04/13



© Copyright Hanson Professional Services Inc. 2013
 Hanson Professional Services Inc.
 1525 South Main Street
 Springfield, Illinois 62703-2886

REPLACE VAULT, AIRFIELD LIGHTING AND GUIDANCE SIGNS
 PROPOSED SAFETY AND PHASING PLAN - WORK AREA 2

JUN 17, 2013 12:11 PM HARR01115
 p:\s\spi-svr306\hanson\dom\hanson\Projects\Documents\12\1053\12A0053D\CAD\Airport\Sheet\G-005-SFY