

JUN 17, 2013 12:35 PM HARR001115  
 pw:\s\spi-svr306\hanson\Documents\Projects\120053\120053D\CAD\Airport\Sheet\C-142-ELE

MATCHLINE - STA. 129+50 RUNWAY 9-27

MATCHLINE - STA. 140+50 RUNWAY 9-27

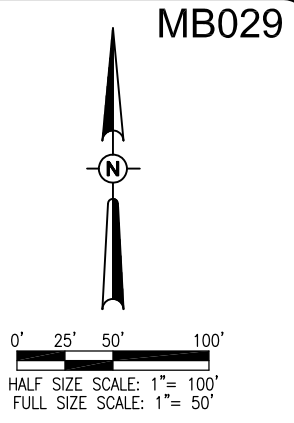
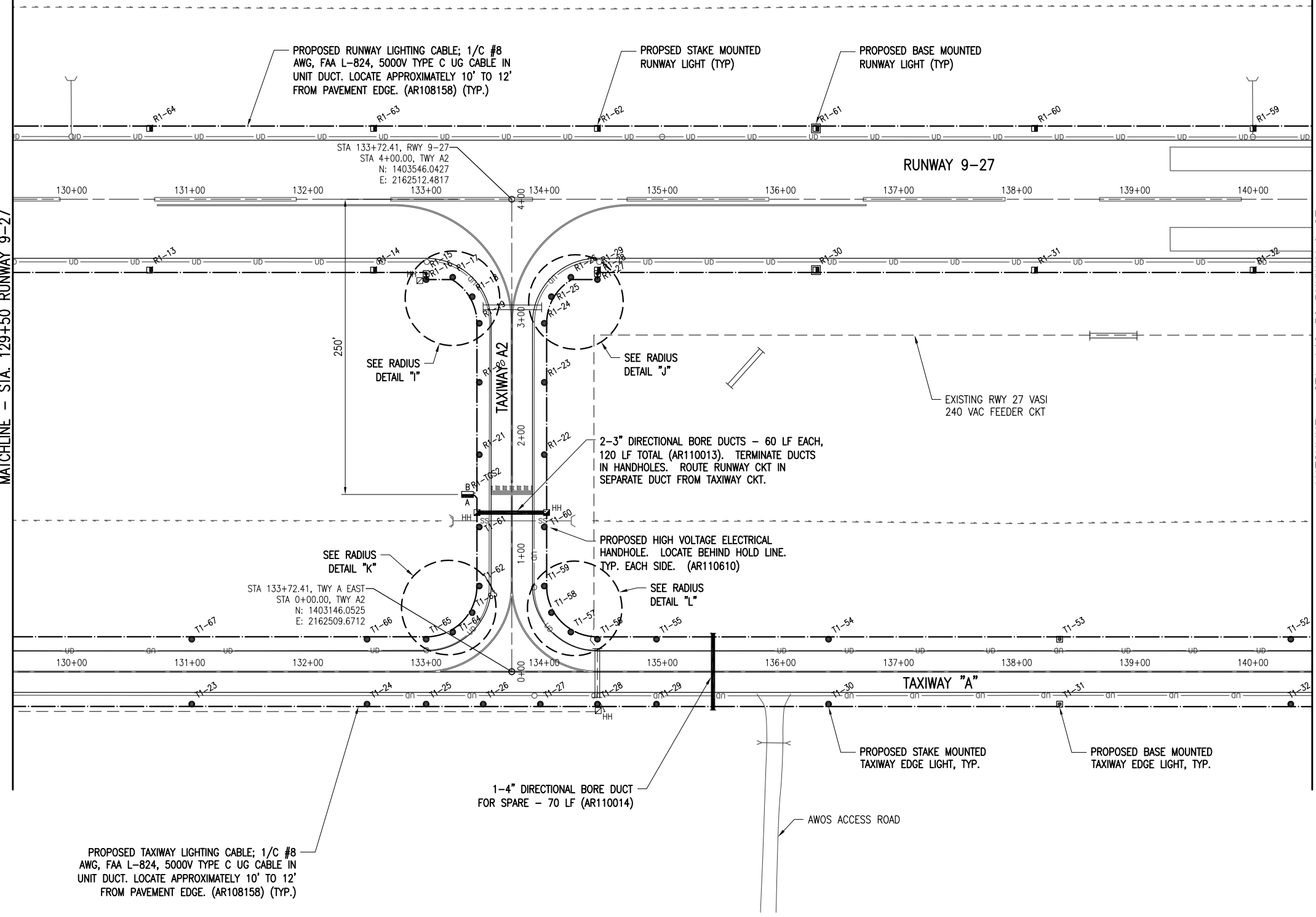

**LEGEND**

- EXISTING PAVEMENT
- EXISTING BUILDING
- EXISTING ELECTRICAL DUCT
- PROPOSED ELECTRICAL DUCT
- EXISTING DRAINAGE DITCH
- EXISTING ELECTRIC
- PROPOSED 1/C #8 AWG, FAA L-824, 5000 VOLT TYPE C UNDERGROUND CABLE UNIT DUCT
- PROPOSED 2-1/C #8 AWG, FAA L-824, 5000V TYPE C UNDERGROUND CABLE IN UNIT DUCT.
- PROPOSED 3-1/C #6 XLP-USE 600V UG CABLE IN UNIT DUCT
- EXISTING WATER
- EXISTING TELEPHONE
- EXISTING UNDERDRAIN
- EXISTING STORM SEWER
- EXISTING SANITARY
- EXISTING UNDERGROUND ELECTRIC UTILITY PRIMARY
- PROPOSED REIL
- PROPOSED WIND CONE
- EXISTING TAXI GUIDANCE SIGN
- PROPOSED TAXI GUIDANCE SIGN
- PROPOSED STAKE MOUNTED TAXIWAY LIGHT
- PROPOSED BASE MOUNTED TAXIWAY LIGHT
- PROPOSED STAKE MOUNTED RUNWAY LIGHT
- PROPOSED BASE MOUNTED RUNWAY LIGHT
- PROPOSED STAKE MOUNTED THRESHOLD LIGHT
- PROPOSED BASE MOUNTED THRESHOLD LIGHT
- PROPOSED ELECTRICAL HANDHOLE
- PROPOSED ELECTRICAL MANHOLE
- EXISTING UTILITY TRANSFORMER
- PROPOSED UTILITY TRANSFORMER
- EXISTING AIRPORT ROTATING BEACON

PROPOSED TAXIWAY LIGHTING CABLE: 1/C #8 AWG, FAA L-824, 5000V TYPE C UG CABLE IN UNIT DUCT. LOCATE APPROXIMATELY 10' TO 12' FROM PAVEMENT EDGE. (AR108158) (TYP.)

PROPOSED RUNWAY LIGHTING CABLE: 1/C #8 AWG, FAA L-824, 5000V TYPE C UG CABLE IN UNIT DUCT. LOCATE APPROXIMATELY 10' TO 12' FROM PAVEMENT EDGE. (AR108158) (TYP.)

PROPOSED STAKE MOUNTED RUNWAY LIGHT (TYP)

PROPOSED BASE MOUNTED RUNWAY LIGHT (TYP)

SEE RADIUS DETAIL "I"

SEE RADIUS DETAIL "J"

SEE RADIUS DETAIL "K"

SEE RADIUS DETAIL "L"

2-3" DIRECTIONAL BORE DUCTS - 60 LF EACH, 120 LF TOTAL (AR110013). TERMINATE DUCTS IN HANDHOLES. ROUTE RUNWAY CKT IN SEPARATE DUCT FROM TAXIWAY CKT.

PROPOSED HIGH VOLTAGE ELECTRICAL HANDHOLE. LOCATE BEHIND HOLD LINE. TYP. EACH SIDE. (AR110610)

1-4" DIRECTIONAL BORE DUCT FOR SPARE - 70 LF (AR110014)

PROPOSED STAKE MOUNTED TAXIWAY EDGE LIGHT, TYP.

PROPOSED BASE MOUNTED TAXIWAY EDGE LIGHT, TYP.

AWOS ACCESS ROAD

REVISION	DATE	ADDED END INDICATORS
02/19/13		PER IDA REVIEW
06/12/13		REMOVED PAPI'S/VASI'S TO REMAIN

MACOMB MUNICIPAL AIRPORT  
 MACOMB, ILLINOIS  
 IL PROJ.: MGB-4206  
 BLOCK GRANT PROJ.: 3-17-0064-B21

Hanson Proj. No. 120053	01/26/13
Filename: C-142-ELE.dwg	01/28/13
Scale: AS SHOWN	02/04/13
Date: 06/17/13	
LAYOUT	MLH/KNL
DRAWN	TRR
REVIEWED	KNL/CAH



REPLACE VAULT, AIRFIELD LIGHTING AND GUIDANCE SIGNS  
 PROPOSED ELECTRICAL PLAN  
 STA. 129+50 TO 140+50