

REVISION	DATE	DESCRIPTION
06/12/13		REMOVED PARTS/VASIS TO REMAIN

MACOMB MUNICIPAL AIRPORT
MACOMB, ILLINOIS

IL PROJ.: MQB-4206 BLOCK GRANT PROJ.: 3-17-0064-B21

Hanson Proj. No. 12A0053	02/01/13
Filename C-521-DTL.dwg	MLH/KNL
Scale AS SHOWN	MLH
Date 06/17/13	02/01/13
LAYOUT	REVIEWED
MLH/KNL	KNL/CAH
MLH	02/04/13

© Copyright Hanson Professional Services Inc. 2013
Hanson Professional Services Inc.
1525 South Main Street
Springfield, Illinois 62703-2886

REPLACE VAULT, AIRFIELD LIGHTING AND GUIDANCE SIGNS

SIDEWALK JOINTING PLAN AND DETAILS

JUN 17, 2013 12:12 PM HARR01115
pw:\sps-svr306\hanson\dom\hanson\Projects\Documents\12\1053\12A0053D\CAD\Airport\Sheet\C-521-DTL

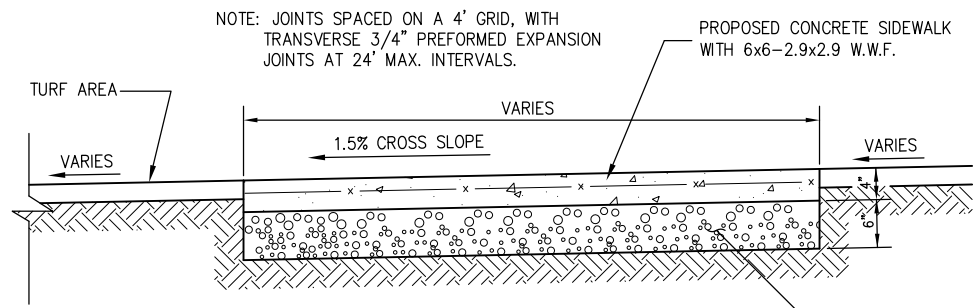
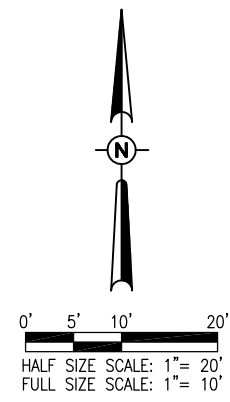
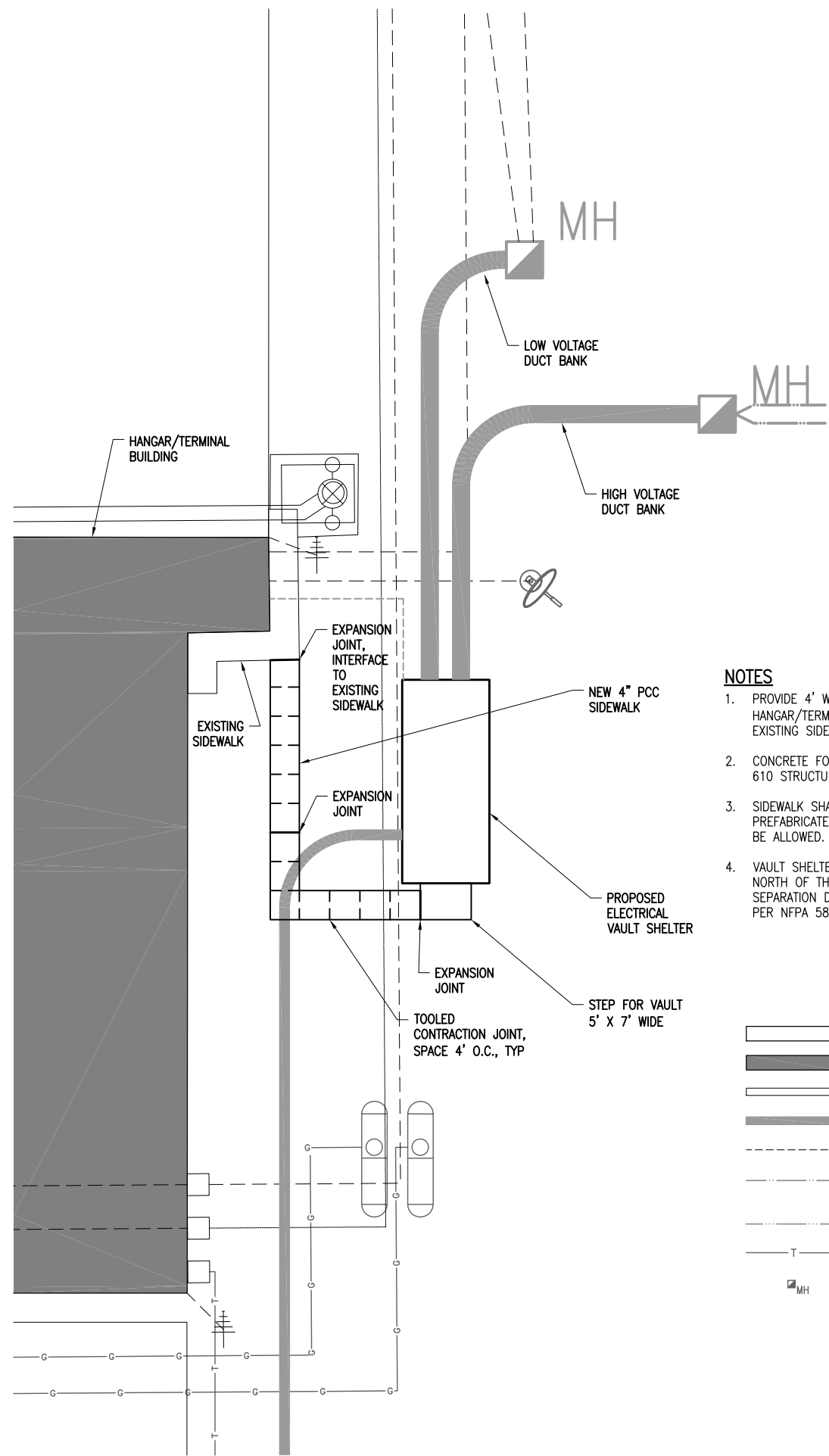

NOTE: JOINTS SPACED ON A 4' GRID, WITH TRANSVERSE 3/4" PREFORMED EXPANSION JOINTS AT 24' MAX. INTERVALS.

CRUSHED AGGREGATE BASE COURSE, 6 INCH, ITEM AR209606

SIDEWALK CROSS SECTION DETAIL

NOTES

1. PROVIDE 4' WIDE SIDEWALK FROM VAULT ENTRY TO HANGAR/TERMINAL BLDG EAST SIDE DOOR. INTERFACE TO EXISTING SIDEWALK.
2. CONCRETE FOR SIDEWALK SHALL BE IN ACCORDANCE WITH ITEM 610 STRUCTURAL PORTLAND CEMENT CONCRETE.
3. SIDEWALK SHALL BE INCIDENTAL TO ITEM AR109110 ERECT PREFABRICATED VAULT, AND NO ADDITIONAL COMPENSATION WILL BE ALLOWED.
4. VAULT SHELTER SHALL BE LOCATED APPROXIMATELY 30 FEET NORTH OF THE PROPANE TANKS TO MAINTAIN THE MINIMUM SEPARATION DISTANCE BETWEEN THE TANKS AND THE BUILDING PER NFPA 58 LIQUIFIED PETROLEUM GAS CODE.

LEGEND

- EXISTING PAVEMENT
- EXISTING BUILDING
- EXISTING ELECTRICAL DUCT
- PROPOSED ELECTRICAL DUCT
- EXISTING ELECTRIC
- PROPOSED 2-1/C #8 AWG, FAA L-824, 5000V TYPE C UNDERGROUND CABLE IN UNIT DUCT.
- PROPOSED 3-1/C #6 XLP-USE 600V UG CABLE IN UNIT DUCT
- EXISTING TELEPHONE
- PROPOSED ELECTRICAL MANHOLE

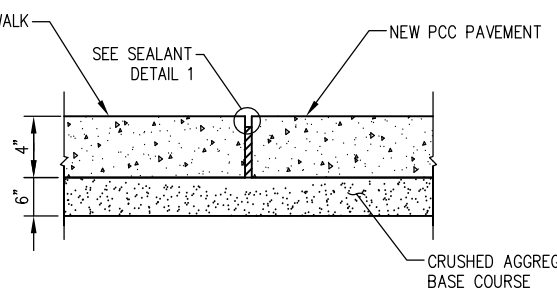

EXPANSION JOINT

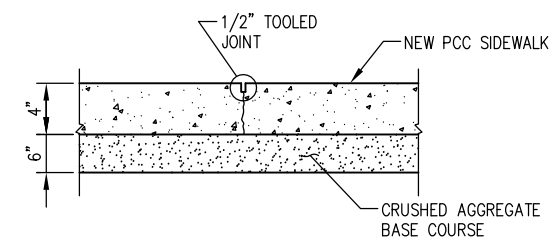

TOOLED CONTRACTION JOINT

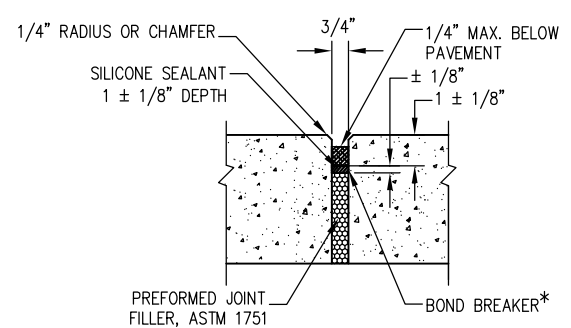

* POLYETHYLENE OR POLYESTER TAPE (3 MIL. MIN.) OR MARKING TAPE, RUBBER TAPE, 1/8" WIDER THAN WIDTH OF JOINT.

JOINT SEALER SHALL MEET THE REQUIREMENTS OF ASTM D 6690-STANDARD SPECIFICATION FOR JOINT AND CRACK SEALANTS, HOT APPLIED, FOR CONCRETE AND ASPHALT PAVEMENT.

DETAIL 1 - SEALANT